

Contents Checklist

Please check the box contents after unpacking.
If any components are missing, please contact the dealer.

- CONTENTS**
- 📱 Device × 1
 - 📖 Manual × 1
 - 🔌 Adapter × 1
 - 📄 Printing Paper (40mm) × 1

Usage And Security Tips ⚠️

- Waterproof Tips**
- Please keep the device turned off before wiping it clean.
 - Do not use corrosive liquids for cleaning.
 - Do not immerse the device in water or liquid.
 - Do not spray water or cleaner into Card Reader or Keypad.



BE	BG	CZ	DK	DE	EE	IE	EL
ES	FR	HR	IT	CY	LV	LT	LU
HU	MT	NL	AT	PL	PT	RO	SI
SK	FI	SE	NO	IS	LI	CH	TR

In all EU member states, operation of 5150-5350 MHz is restricted to indoor use only.

Declaration:

This user manual is applicable to the four different bases mentioned.



Model: SK210

Android Smart Mini kiosk.

User Manual

SK210

Made in China



Specification

OS	Android 13
Processor	ARM Cortex A53 2.0 GHz
Memory	2GB LPDDR4x + 32GB Flash 3GB + 32GB / 4GB + 64 GB (optional)
Display	10.1 800 × 1280 HD TFT capacitive touch screen
Printer	Print speed: 100mm/s Paper Roll: 58*60mm
Camera	5 MP AF Front Camera
Physical Key	Power × 1
Barcode Scanner	Professional 1D+2D with high performance
LED	Printer indicate LED × 1 Scan Indicator LED × 1
Mobile Network	4G / 3G / 2G
Wireless	WiFi 2.4GHz / 5GHz BT BLE5.1
Card Slots	TF Card × 1 Nano SIM × 1 (eSIM optional)
Audio	Speaker × 1 MIC × 1
Positioning	GPS, GLONASS and BEIDOU
Port	2 × USB 2.0 Type A 1 × USB 2.0 Type C 1 × RJ45 1 × DC Jack 1 × Audio Jack
Power	Output: 12V / 3A
Physical	429*190*80.4mm 1520g
Environment	Operating temp: -15°C ~ 60°C Storage temp: -20°C ~ 70°C Relative humidity: 5%~95% (Non-condensing)
Certifications	GMS Rohs CE Aviation Certification Anatel

Product

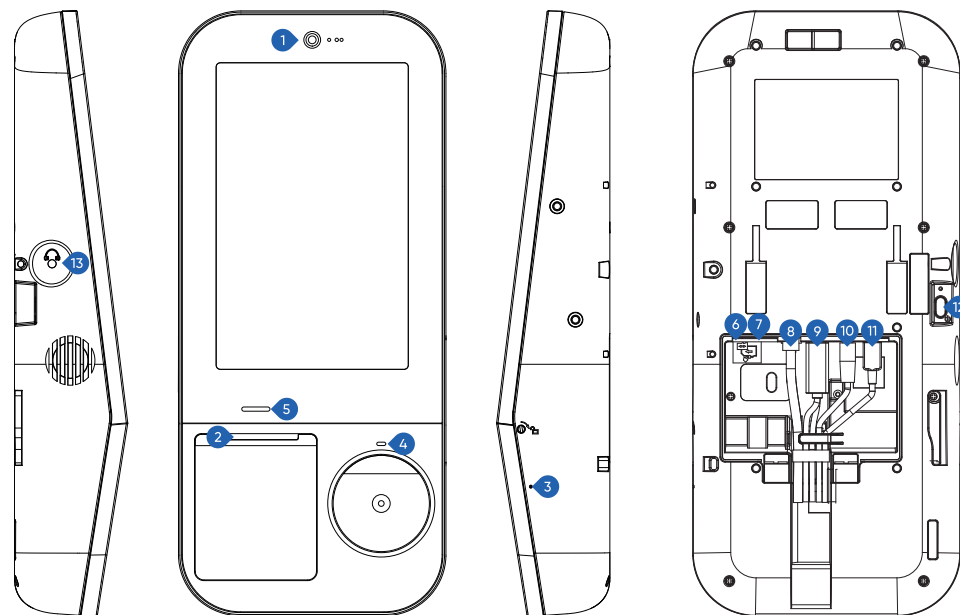

- 1 Camera
- 2 Printer
- 3 MIC
- 4 Scan Indicator LED
- 5 Printer Indicate LED

- 6 SIM card slot
- 7 TF card slot
- 8 RJ45
- 9 USB 2.0 Type A
- 10 DC Jack

- 11 USB 2.0 Type C
- 12 Power key
- 13 Audio Jack

Usage

Power ON/OFF

1. Connecting DC Power Cables
2. Power ON: Press and keep the power key until LCD screen lights up.
3. Power OFF: Press and keep the power key until LCD screen off.

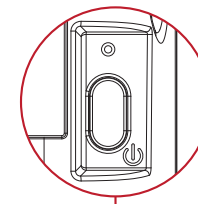

1

Card slot

1. SIM Card is placed in the lower layer
2. TF Card is placed in the upper layer

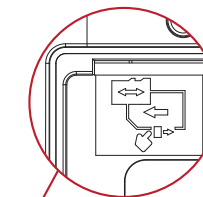

Printer

1. Use the tool to open the paper bin
2. Place the paper roll according to the diagram
3. Pull out part of the paper

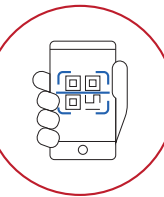
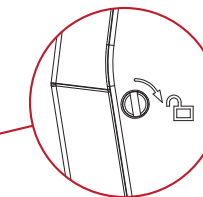

QR code