



# Instant Pocket Camera



## Take picture

**5** **Select**

**Indoors**  
2-8 ft  
(.6 m - 2.4 m)

**Outdoor: Sunny**  
2 ft - ∞  
(.6 m - ∞)

**Outdoor: Cloudy**  
2 ft - ∞  
(.6 m - ∞)

## Load Film

Use Polaroid I-Zone instant pocket films.  
Save this sheet for reference

**1** **Press button.**

**2** **Load film.**

**3** **Close door. Make sure it's closed.**

**4** **Pull tab straight, firmly, and quickly. Do not stop.**

**6** **Wait. Ready light glows.**

**7** **Aim. Best pictures from 2-8 ft. (.6-2.4 m).**

**8** **Press the button.**

**9** **Shade from bright sun and pull tab straight, firmly, and quickly. Do not stop.**

**10** **Have Fun! DO NOT CUT INTO PHOTOS. To prevent exposure to caustic paste, cut where indicated.**



# Load batteries

Use two AA alkaline batteries. Change the batteries when the ready light does not glow, or if it takes longer than 20 seconds to glow. To save battery power, the camera shuts off after each picture.

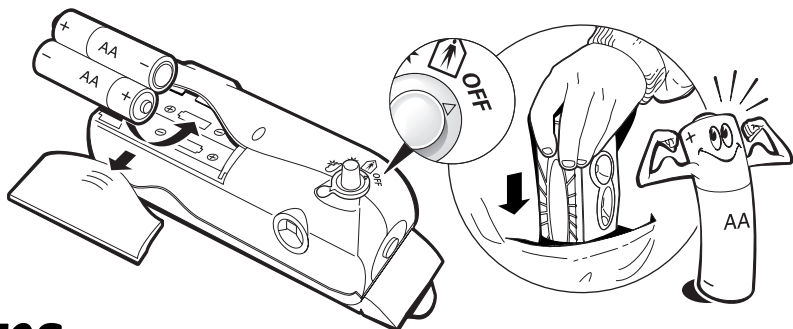

## Tips

### Light blue blotches or marks on the photo

- Shade camera from bright sunlight.
- When pulling tab, pull straight and firmly. Do not stop.

### Picture too dark

- Too far from subject or wrong setting.



### Picture too light

- Too close to subject or wrong setting.



If you need information or help, please call Polaroid Customer service or visit us at [www.polaroid.com](http://www.polaroid.com) or [izone.polaroid.com](http://izone.polaroid.com).

### USA

Toll Free 1-800-343-5000

### Australia

1800 242 643

(02) 9950 7134 (if in Sydney metropolitan area)

### New Zealand

(09) 303 1479

**Limited Warranty:** Polaroid will, at our option, repair or replace any camera found defective in manufacture within the warranty period (12 months). The warranty period is determined by the date of camera purchase. Keep the receipt as proof of purchase. Otherwise the warranty period is determined by the date of manufacture. **This warranty does not apply to damage caused by accident, misuse or tampering and excludes all consequential damages except in jurisdictions not allowing such exclusions or limitations.**

Polaroid will replace any film that is defective in manufacture, labeling or packaging, provided representative samples are returned to a Polaroid dealer or office. **This warranty excludes all consequential damages except in jurisdictions not allowing such exclusions or limitations.**

**Caution:** This camera is battery operated. Closely supervise children when they are operating the camera or when you are using it in their presence. To prevent electrical shock, the camera should not be exposed to or immersed in water or other fluids, disassembled, or operated if dropped and damaged. Follow local legal requirements for disposing of or recycling the non-hazardous, AA alkaline batteries.

**Film Caution:** This process uses a caustic paste. If any paste appears, avoid contact with skin, eyes and mouth and keep away from children and animals. If you get some paste on your skin, wipe it off immediately and wash with water to avoid an alkali burn. If eye or mouth contact occurs, quickly wash the area with plenty of water and see a doctor.

© Copyright 1999 Polaroid Corporation, Cambridge, MA 02139 U.S.A., owner of the trademarks "Polaroid" and "Polaroid I-Zone" (and design).