

INALSA

STEAM IRON

Flair Onyx 2200

— + —
**Instruction Manual
Cum
Warranty Card**



Dear Customer,

Congratulations! On the purchase of your INALSA Steam Iron, this is designed to include many superior features that permit you the fullest expression of your ironing skill and enthusiasm. You are now on the threshold of a whole new world of ironing pleasure.

At INALSA, we have a reputation of manufacturing innovative, high quality appliances such as Food Processors, Mixer Grinders, Juicer Mixer Grinders, Juice Extractors, Sandwich Toasters, Oven Toaster Grillers, Hand Blenders, Electric Kettles, Rice Cookers, and Electric Chimneys. Your newly acquired INALSA Steam Iron bears the same distinctive hallmark of excellence.

It is all the result of vigorous quality consciousness in INALSA's design and development where uncompromising standards are maintained and rigid quality control measures are exercised on raw materials, components and finally, the finished product.

Your INALSA Steam Iron has a lot of thoughtful features built in to make your ironing convenient. Please read these instructions carefully, so that you may get the best out of the power packed features in your INALSA Steam Iron.

Welcome to the INALSA world of ironing pleasure!!

Part's Identification

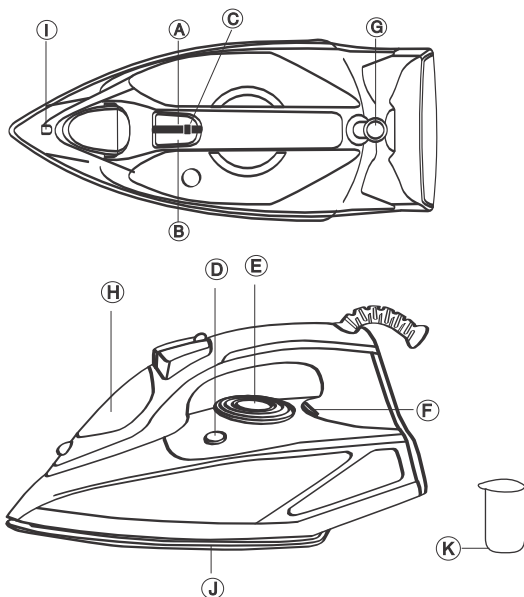

A	Steam burst button	G	Cord holder
B	Spray button	H	Water inlet cover
C	Variable steam knob	I	Spray nozzle
D	Self-cleaning button	J	Sole plate
E	Temperature control knob	K	Water pouring cup
F	Indicator light		

Technical Specification*

Product	Steam Iron	
Model	Flair	Onyx 2200
Voltage	240V, 50Hz AC	
Wattage	2200W	
Cord Plug	Cotton braided cord with 3 pin moulded plug	
Sole plate coating	Ceramic coated	
Anti Drip Function	Yes	
Anti Calc Function	Yes	

*Due to continuous improvements in product, specifications are subject to change without prior notice.

Important

1. Ensure that the supply voltage is the same as that specified on rating plate.
2. The iron should always be turned off before plugging or unplugging from the mains supply.
3. Never pull the cord to disconnect from the mains supply, instead grasp plug and pull to disconnect.
4. Never use the appliance if it is damaged in anyway.
5. When leaving, even for a short while, always unplug the iron.
6. Close supervision is necessary for any appliances being used by or near children.
7. Do not leave the iron unattended.
8. Burns can occur from touching the hot metal parts, hot water or steam.
9. Use caution when you turn a steam iron upside down, there may be hot water in the water tank.
10. Never immerse the iron in water or any solution.
11. Always place the iron with its back on a firm flat surface while interrupted ironing and after use.
12. Keep the sole plate smooth, avoid hard contact with metal objects.
13. The cord should not be allowed to touch the sole plate when it is hot.
14. Remove the main plug from the mains supply before unfilling the water.
15. Prevent water overflow, do not fill over maximum level.
16. When using the iron for the first time, test on an old piece of fabric to ensure the sole plate and water tank are completely clean.
17. Please do not use hard water as it might lead to corrosion/scaling in the appliance and subsequently the steam mechanism may stop working.
18. After the ironing is finished, the iron should be emptied and dried before storing.
19. **Some parts of the iron have been slightly greased. That is why the iron may produce slight smoke when switched "ON" for the first time.**

How to Use

Before Use

1. Make sure that all product's packaging has been removed.
2. Prepare the appliance according to the function you wish to use.

Setting the Temperature

1. Keep the iron upright/vertical position.
2. Set the temperature control knob (E) to desired ironing temperature (according to the type of fabric). Recommended temperature setting for different fabrics are as below:
 - Temperature for synthetic fibres (Polyester, Nylon...).
 - Temperature for silk and wool.
 - Temperature for cotton. (Minimum temperature for steam ironing). Max Temperature for linen.

NOTE:1) If the fabric consists of various kinds of fabrics, always select the temperature required by the most delicate fabric.

2) Iron the clothes first which requires low temperature than the clothes which require high temperature to iron, because iron gets hot faster than cooling.

Dry Ironing

1. Set the temperature control knob (E) to desired position.
2. Keep the iron on its heel.
3. Insert the main plug into the mains supply.
4. After the indicator light (F) has gone out and come on again, you may start ironing. The indicator light will go on & off from time to time during ironing.
5. If desired, you may use the spray function during dry ironing.

Filling of Water

1. Ensure that the iron is disconnected from the power supply.
2. Turn the variable steam knob (C) to "0" (NO steam position).
3. Pull up the water inlet cover (H), fill the water. (Do not fill more than the "MAX level mark" on the water tank.)
4. Close the water inlet cover (H).

Steam Ironing

1. Set the temperature control knob (E) at maximum (•••) for steam function. Never use steam function at any other setting of temperature control knob.
2. Ensure that there is enough water in the water tank.
3. Stand the iron on its heel.
4. Insert the main plug into the mains supply.
5. Wait a little while for the indicator light (F) to go out and come on again.
6. Set the variable steam knob (C) to desired steam position.

NOTE: If sole plate does not attain the desired temperature, water may leak from the sole plate. That is not harmful but the ironing will not be comfortable.

Steam Burst

1. This function proportions extra steam for eliminating wrinkles.
2. Press the steam burst button (A). Wait a few seconds until vapor penetrates the fibres of the garment before pushing the button again. For optimum steam quality, do not apply more than three successive blasts.
3. The steam burst button has to be pressed repeatedly to release the first shot.

NOTE: If temperature setting is low, water may leak from sole plate. To obtain a good flow of steam burst several times, maintain few seconds gap between each burst to enable the sole plate to recover the temperature, it has lost.

Vertical Steaming

1. It is possible to iron hanging curtains, items of clothing on his hanger, etc. To do so, follow the instructions.
2. Select the maximum temperature of the iron, while turning the temperature control knob of the iron in a clockwise direction (Fig 2).
3. Move the iron in a top to bottom direction while pressing the steam control.

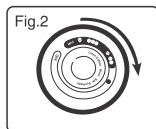

NOTE: For cotton and linen, its recommended to put the iron base in contact with the material. For other more delicate fibres, it's recommended to keep the iron base at some centimetres of distance.

Self Cleaning

Self clean function is used to clean the sole plate after its use of few days.

1. Fill water tank as described in "FILLING OF WATER".
2. Plug the iron and set the temperature control knob at maximum (**), plug out the iron when the pilot light gets off.
3. Press the self clean button (D) for 1 min.
4. Hold the iron horizontally allowing steam to flow through sole plate vents until the water tank is emptied.
5. Plug in the iron in order to dry the water from sole plate.
6. Clean the sole plate with a soft cloth.

NOTE: It is recommended that after every five usage, use this function to prevent the iron from harmful minerals build-up during steam ironing.

Spray Ironing

1. The spray can be used in both steam and dry ironing.
2. Press the spray button (B) to use this operation.
3. The spray button has to be pressed repeatedly to release the first spray.

Anti Drip

- The anti drip system controls the water flow to the sole plate at all times. Below a certain temperature, the anti- drip function cuts off the flow of water and stops the iron from dripping onto the laundry.

NOTE: During use, anti drip system may emit a loud clicking sound, particularly during heat - up or whilst cooling down. This is perfectly normal and indicates that the system is functioning correctly.

Anti - Calc Function

- The anti - calc function is designed to reduce the build up of lime scale, which occurs during steam ironing. This feather prolongs the working life of your iron.

Once you have finished using the appliance

1. Select the minimum position (MIN) using the thermostat control.
2. Unplug the appliance from the mains.
3. Remove the water from the water tank.
4. Clean the appliance.

Cleaning

1. Before cleaning the iron, ensure that it is disconnected from the power supply and has been cooled down completely. Deposits on the sole plate may be removed with a rough cloth soaked in a vinegar water solution.
2. The sole plate should may be wiped with a damp cloth and then with a dry one.
3. Do not use abrasives on the sole plate.
4. Keep the sole plate smooth; avoid hard contact with metal objects.
5. If the power cord is damaged, it must be replaced by a service representative only.

Storage

1. Remove the main plug from the mains supply.
2. Pour out any remaining water in the water tank.
3. Set the steam knob to no steam position.
4. Keep the iron upright and let it cool down.

WARRANTY

The "INALSA" steam iron is fully warranted against any manufacturing defect for a period of **Two Years** from the date of purchase. Should any defect develop in the steam iron during the warranty period, **Tuareg Marketing Pvt. Ltd.** undertakes to get the steam iron or any part thereof, repaired at any of its Authorised Service Center.

The above warranty shall be subject to the following terms and conditions:-

1. Any defective product or part thereof will be repaired within the above stated warranty period on receipt of the same with this card duly filled in and stamped by dealer from whom the product was purchased along with the purchase bill/invoice, provided the product is brought to our nearest service center freight paid and packed securely.
2. In the event of repairs/ replacement of any part of product, this warranty will thereafter continue and remain in force only for the unexpired period of warranty.
3. This warranty is valid only when:-
 - The product is purchased from the company's authorized dealer and accompanied by this warranty card / cash memo.
 - The product has been serviced by the INALSA authorized service personnel.
 - The product has been installed, used and maintained in accordance with the instruction manual.
4. The warranty does not apply to :-
 - Normal wear and tear of the product
 - Damage due to chipping, peeling, plating and denting.
 - Damages arising due to running of the appliances on the alternate sources of power such as Inverter, generator or any such auxiliary power supply aid resulting in variation/ fluctuating voltage.
 - Breakage or damage to components made of ABS, SAN, Bakelite, Glass and such plastic/rubber parts, cord, bulbs and surface coating.
 - Damages resulting from accidents, mishandling or negligence on the part of the customer.
 - Product if used for the commercial purposes.
 - Product, the serial number of which has been removed obliterated or altered on the specification plate.
5. The warranty is in lieu of all other warranty, expressed or implied and does not cover indirect or consequential damages/ loss.

WARRANTY CARD

Product : Steam Iron
Model : Flair / Onyx 2200
Serial No :
Date of Purchase :
Bill/ Cash Memo No. :
Purchaser's Name :
Address :
.....
.....

Dealer's stamp and Signature



Scan and Download
INALSA Connect App
to Register your Warranty

E-mail- customercare@inalsa.co.in

Customer Care Number (Open on all 7 Days* from 9:30 to 6:30)

9773982065

INALSA

TUAREG MARKETING PVT. LTD.
154, Bhalswa, Delhi- 110033