

# SPACEKEY

Dehumidifier

User Manual

Read and save these instructions before use

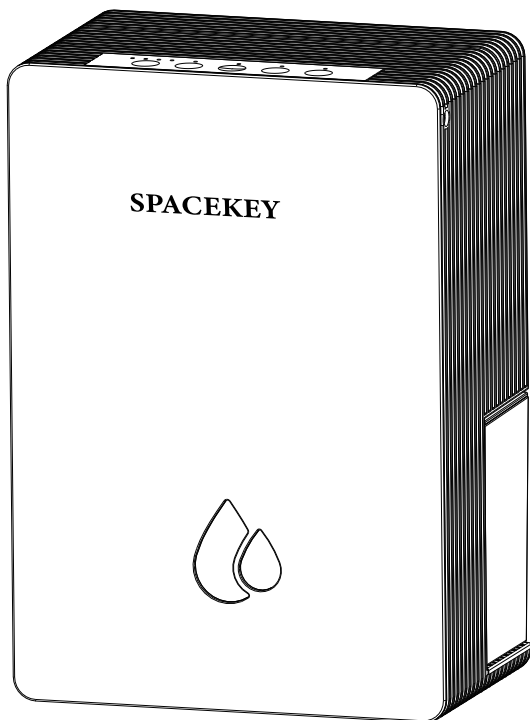

---

Model: QIG-D04

---

# CUSTOMER SERVICE

Our customer service team is standing by to assist you, if you have any questions or concerns.

## WARRANTY TERMS AND CONDITIONS:

### **30-Day Return/Exchange Policy for Any Reason:**

We offer a 30-day return/exchange policy for any reason. If you are not completely satisfied with your purchase, you may return the undamaged product and packaging within 30 days of purchase for a full refund or exchange.

### **12-Month Warranty for Quality-Related Issues:**

For quality-related issues, we provide a 12-month warranty. Within this period, SPACEKEY will replace a replacement for free or a full refund if preferred, and we will cover any associated return shipping costs.

 [www.spacekeyshop.com](http://www.spacekeyshop.com)

 [support@spacekeyshop.com](mailto:support@spacekeyshop.com)

 1-866-668-5801

# TABLE OF CONTENTS

IMPORTANT SAFEGUARDS ----- 1

HOW A DEHUMIDIFIER WORKS ----- 2

SELECTING A LOCATION ----- 3

PRODUCT OVERVIEW ----- 4

OPERATION GUIDE ----- 5

DRAINING THE WATER ----- 5

ADD ESSENTIAL OIL ----- 7

CLEANING & MAINTENANCE ----- 7

TROUBLESHOOTING ----- 8



# IMPORTANT SAFEGUARDS

---

**WARNING: READ AND SAVE THESE INSTRUCTIONS BEFORE USING THIS PRODUCT.**

The user of electrical products may create hazards that include, but are not limited to injury, fire, electrical shock. Failure to follow these instructions may damage and/ or impair its operation and void the warranty.

**When using electrical appliances, basic safety precautions should always be followed:**

1. Before operating, remove all packaging material and check for any damage that may have occurred during shipping.
2. Check the household voltage to ensure it matches the appliance's specification.
3. **DO NOT** touch the dehumidifier or the electrical plug with wet hands.
4. **DO NOT** operate any product with a damaged cord or plug.
5. **DO NOT** use an extension cord with this appliance.
6. **DO NOT** run power cord under carpeting, or cover it with rugs or runners. Keep the cord away from areas where it may be tripped over.
7. **DO NOT** use the product in areas where gasoline, paint or other flammable goods and objects are used or stored.
8. **DO NOT** attempt to repair or adjust any electrical or mechanical functions of the dehumidifier, as this may cause danger and void the warranty.
9. **DO NOT** cover the air inlet or outlet on the appliance as this may cause the unit to fail.
10. **DO NOT** insert or allow objects to enter any ventilation or exhaust opening as this may damage the product and could cause electrical shock or fire.
11. Never install the product near a bathtub or any water container.
12. **DO NOT** let children play with this appliance, packaging or included plastic bag.
13. Always unplug the dehumidifier before emptying the water tank.
14. Always unplug the dehumidifier and remove the water from the water tank before cleaning, servicing or relocating the unit.
15. Always place the dehumidifier on a leveled floor.

## IMPORTANT SAFEGUARDS

---

16. The water collected in the tank must be discarded. The water should never be used for drinking.
17. Remove the power cord from the electrical receptacle by grasping and pulling on the power cord plug-end only, never pull the cord.
18. This appliance has been manufactured for use in domestic environments and must not be used for other purposes.
19. This dehumidifier is designed for indoor residential applications only. It should not be used for commercial or industrial applications.
20. If the unit is damaged or it malfunctions, do not continue to operate it. Unplug the product from the electrical outlet. Refer to the troubleshooting section and contact the customer support center.
21. Store in a dry area, away from direct sunlight, when not in use.
22. This appliance and its packaging materials are not intended for use by persons (including children or elderly) with reduced physical, sensory or mental capabilities, or lack of experience and knowledge, unless they have been given supervision or instructions concerning the use of the appliance by a person responsible for their safety.

### SAVE THIS INSTRUCTIONS

## HOW A DEHUMIDIFIER WORKS

---

When the dehumidifier is switched ON, a fan pulls moisture-laden air into the dehumidifier where it passes through dehumidifying coils inside the unit. These coils condense moisture from the air and collect it in the water tank. The dry air is then exhausted from the dehumidifier. The air flows through the air vents of the dehumidifier into the room as dry, warm air.

**IMPORTANT:** The dehumidifier is designed to operate between 59°F (15°C) and 104°F (40°C). The dehumidifier's performance may be greatly reduced if room temperature is beyond this temperature range

## SELECTING A LOCATION

- For optimal efficiency, the dehumidifier must be operated in an enclosed area. Keep all doors, windows and other outside entrances to the room closed.

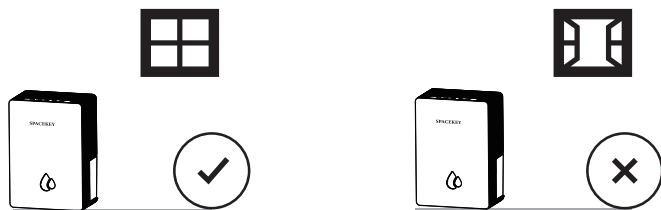

- Place the dehumidifier in an area where the temperature will not drop below 59°F (15°C).
- Place the dehumidifier at least 17.7 inches (45 cm) away from other objects (e.g. curtains or furniture) that may restrict airflow from the back or through the air vents of the unit.
- The dehumidifier must be positioned on a level floor.

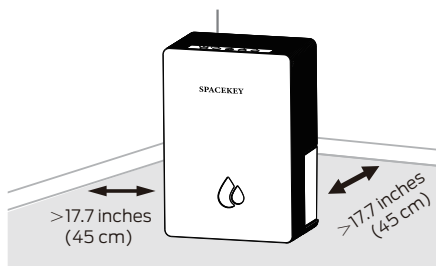

**IMPORTANT:** The effectiveness of the dehumidifier can be influenced by different factors. One factor is the rate at which new, moisture-laden air enters the room and the amount of air circulating in and out of the area to be dehumidified. For example, if a door to a basement is constantly opened, letting new, moisture-laden air into the room, dehumidification will take longer than if the door was kept closed. If the dehumidifier is in a room with a storage closet or cabinets, it will have little or no effect in drying the inside of the storage closet or cabinets unless there is adequate circulation of air in and out of these spaces. To dehumidify these spaces, open the storage door or cabinet doors to allow air circulation. You may find that installing a second dehumidifier may be required for larger enclosed areas.

# PRODUCT OVERVIEW

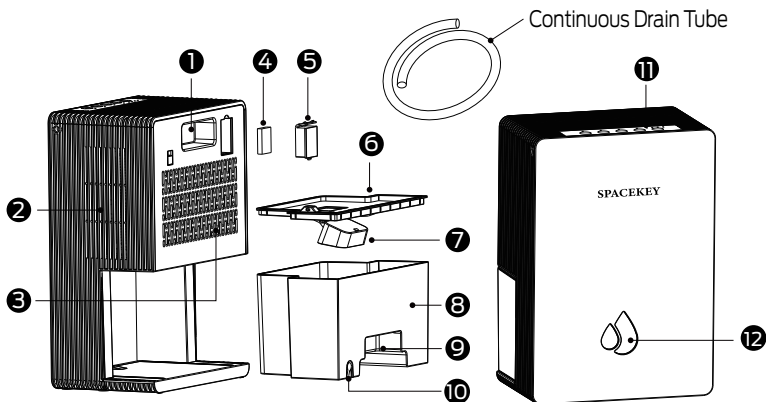

- |                |                 |                      |                   |
|----------------|-----------------|----------------------|-------------------|
| 1. Unit Handle | 4. Aroma Pad    | 7. Plastic Foat      | 10. Drain Outlet  |
| 2. Air Outlet  | 5. Aroma Tray   | 8. Water Tank        | 11. Control Panel |
| 3. Air Intake  | 6. Splash Guard | 9. Water Tank Handle | 12. Ambient Light |

## Package Contents

- |                 |                 |               |
|-----------------|-----------------|---------------|
| 1× Dehumidifier | 1× Splash Guard | 1× Aroma Pad  |
| 1× Water tank   | 1× User Manual  | 1× Drain tube |

## Specifications







Product	Dehumidifier
Model	QIG-D04
Power Supply	100-240V~50/60Hz
Rated Power	88W
Dimensions	8.2×5.6×13.8 inches
Weight	2.3kg / 5.1 lb



### Notice:

If product is damaged or missing any parts, call customer service at 1-866-668-5801.

## 5 OPERATION GUIDE

Button	Symbol	Function Description
Power Control		Press to turn the dehumidifier on and off .
Sleep Mode		Press to turn on or off the sleep mode. When sleep mode is selected, the unit will operate with <b>low speed and low dehumidification efficiency</b> . In sleep mode, only the sleep mode indicator light is on and the other indicator lights are off.  <b>Soud OFF/ON</b> You can also press and hold the button about 3 seconds to turn OFF or ON the button soud.
Light control		The startup ambient light is turned on by default, with a 7-color cycle display (red, orange, yellow, green, cyan Blue and purple). To display a fixed color, press the light button while the color is displayed. Press the light button again to turn off the lights.
Timer		Cycle through timer options by press this button, the unit can be timed to operate for 2, 4, 6, 8 hours. Once the timer ends, the unit will turn off.
Child Lock		Press and hold the button for 3 seconds to turn child lock ON or OFF. When child lock is ON, the buttons on the control panel will be locked.

## DRAINING THE WATER

The unit provides two drainage methods. You can choose the one you need.

### 1. Draining water collected in the water tank.



**WARNING:** Always drain and discard water collected from dehumidification.  
The water is not clean and cannot be used for drinking.

The condensed water can be collected directly into the water tank. When the water tank is full, the dehumidifier will automatically shut OFF, the red ambient light and the power indicator will flash followed by a beeping sound.

**⚠ IMPORTANT:** Do not move the dehumidifier when the Water Tank is full as it will be heavy and can cause water spillage.

**11** Locate the water tank at the back of the dehumidifier. Gently pull the water tank out.

**12** Grip the handle inside the water tank and carry the water tank to a sink to empty.

**13** Replace the empty water tank back into the back of the dehumidifier. Please make sure that the tank is properly positioned.

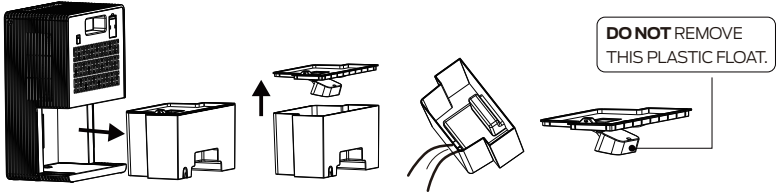

**⚠ IMPORTANT:** There is a Plastic Float inside the water tank that senses the water level to automatically stop dehumidification when the water tank is full. Make sure the float is positioned correctly inside the water tank.

## 2. Continuous Water Drainage

To activate the continuous water draining function, you will require a suitable water drain (e.g. sink or drain hole at floor level) near the dehumidifier.

Locate the drain outlet at the back of the unit and pull the rubber stopper out. (Fig. 1)

**Insert and screw** the continuous water drain tube into the direct drain outlet. (Fig. 2)

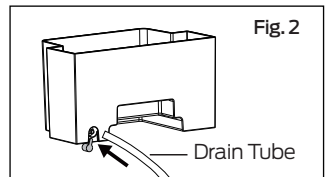
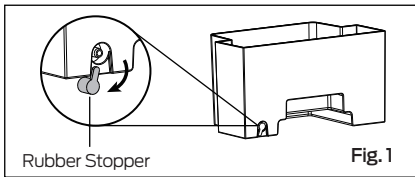

**⚠ CAUTION:** When using the water tank to collect water, ensure the Rubber Stopper is securely installed in the drainage outlet. A missing or improperly inserted plug **may cause leakage**.

Position the other end of the continuous water drain tube in the sink or drain. Make sure the tube is not **bent or kinked** which might stop the water flow. Make sure the tube is secured over the drain and will not fall out of place causing unwanted water spillage.

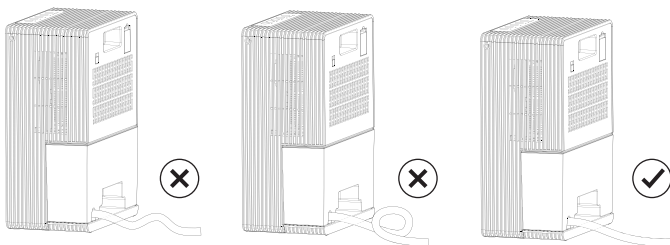

## ADD ESSENTIAL OIL

To fresh your home, you can add essential oil.

1. Put out the aroma tray to open it.
2. Drip the essential oil evenly onto the aroma pad until it is **fully saturated**, add more for stronger scent.
3. Put the aroma tray back into the unit and press to lock it.

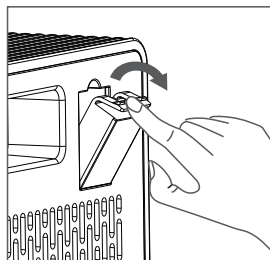

**Note:** The fragrance will gradually fade over time. Re-drip the essential oil to maintain the desired scent intensity.

## CLEANING & MAINTENANCE

**⚠ WARNING:** Always switch OFF the dehumidifier and unplug it from the electrical outlet before attempting any cleaning or maintenance of this product.

### Appliance Maintenance:

- Switch OFF the appliance before disconnecting the power supply.
- Only use a soft cloth to clean the appliance.

### End of Season Storage & Maintenance:



**If the appliance will not be used for an extended period of time:**

- Switch OFF the unit and unplug from the electrical power outlet.
- Empty the water tank and let it dry.
- Make sure all parts of the dehumidifier and accessories are dry before storage.
- Cover the dehumidifier with a cloth/ plastic bag before storage, to protect the surface from dust and scratches.
- It is recommended to coil the power cord and store it off the floor to ensure it is protected from bends and kinks.
- Store the unit upright in a dry location, away from direct sunlight.

The following troubleshooting guide addresses the most common problems. If problems persist, call customer service.

PROBLEM	POSSIBLE CAUSE	SOLUTION
Noise	Fan is working.	Wind from the fan can create sounds during operation. This is a normal sound. You can use low speed during rest
	The fan is damaged.	Please call 1-866-668-5801.
Dehumidifier does not start.	No electricity	Check for power.
	The power cord is not properly plugged in.	Remove and reconnect the power cord.
	The water tank is not in the correct position.	Position the water tank correctly into the unit. Unit will not operate until the water tank is secure in place.
	The unit is broken.	Please call 1-866-668-5801.
Unit runs but the humidity level does not decrease.	A door or window is open, letting in new moisture.	Make sure all windows or doors to the outside are closed and tightly sealed.
	The temperature in the room is too low.	The dehumidifier is designed to operate between 59°F (15°C) and 104°F (40°C). Moisture removal is greatly reduced if room temperatures exceed this temperature range.
	Air outlet or intake is blocked.	Remove blockage.
	Area to be dehumidified is too large.	The capacity of your dehumidifier may not be adequate for the room it is used in. It is recommended to add an extra dehumidifier for large areas.
The unit stops working, the power indicator and the red ambient light are flashing.	When the water tank is full, the unit will automatically stop working.	Empty the water tank and put it back in to the unit.
Unit runs but there is no water in the water tank.	The ambient humidity is too low.	The higher the ambient humidity, the more water the tank collects.
	The unit has entered sleep mode.	Turn off sleep mode.
	The unit is broken.	Please call 1-866-668-5801.

# SPACEKEY

-  [www.spacekeyshop.com](http://www.spacekeyshop.com)
-  [support@spacekeyshop.com](mailto:support@spacekeyshop.com)
-  1-866-668-5801



Made in China