

3 POINT CULTIPACKER

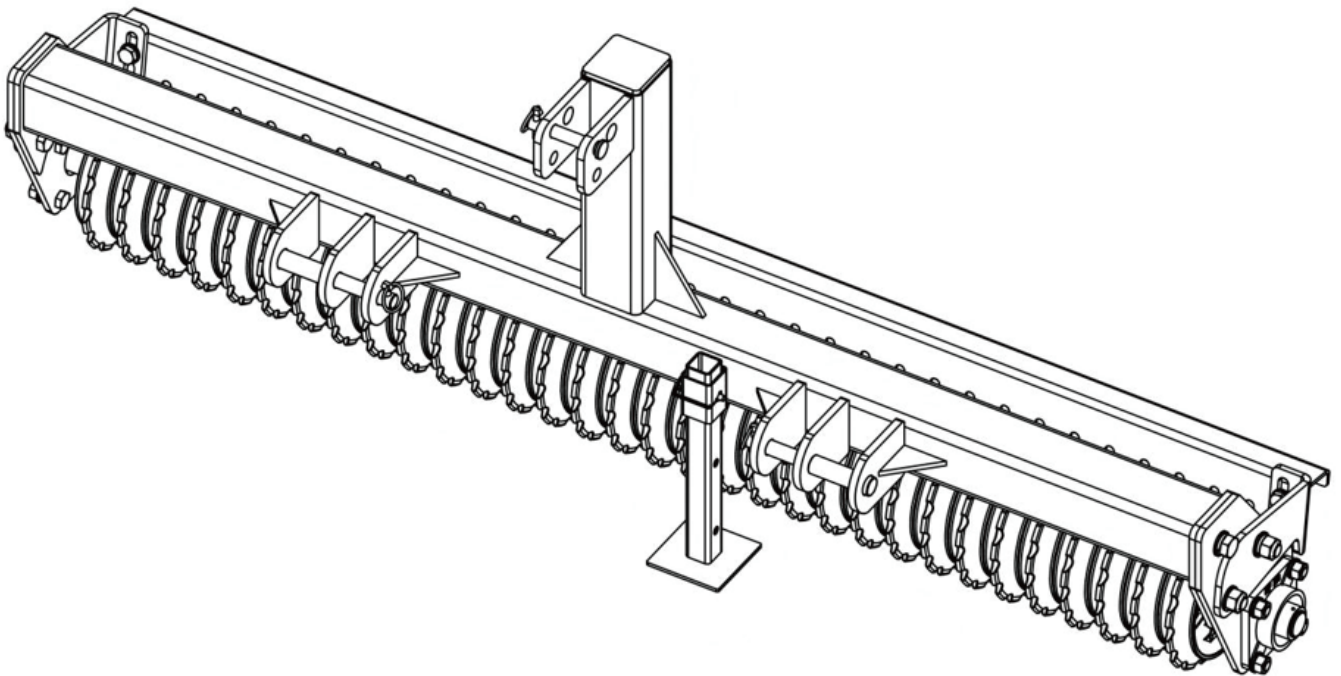

**Model: TCP1060, TCP1072,
TCP1084**



Operator's Manual

MechMaxx

www.mechmaxx.com



TABLE OF CONTENTS

TABLE OF CONTENTS	1	TRANSPORT AND STORAGE	8
INTRODUCTION	2	TRANSPORT	8
SAFETY INFORMATION	3	STORAGE	8
SAFETY ALERT SYMBOL AND SIGNAL WORDS	3	MAINTENANCE AND LUBRICATION	9
GENERAL SAFETY RULES	3	MAINTENANCE SCHEDULE	9
EQUIPMENT SAFETY GUIDELINES	4	LUBRICATION POINTS	9
OPERATIONAL SAFETY	4	HARDWARE RETENTION AND REPLACEMENT	9
MAINTENANCE SAFETY	4	TROUBLESHOOTING	10
ASSEMBLY INSTRUCTIONS	5	TORQUE GUIDELINES	10
SCRAPER BAR ASSEMBLY	5	SOIL PULVERIZER PARTS ASSEMBLY (TSP60, TSP72, TSP84)	12
DELIVERY CHECKLIST	6	PARTS LIST (TSP60, TSP72, TSP84)	13
TRACTOR REQUIREMENTS AND COMPATIBILITY	6		
TRACTOR HOOK-UP	6		
OPERATION	7		
OPERATOR RESPONSIBILITIES	7		
PRE-OPERATION INSPECTION	7		
START-UP AND FIELD OPERATION	7		
OPERATING TIPS	7		



INTRODUCTION

This manual provides safety, assembly, operation, adjustment, maintenance, and storage information for a 3-point hitch cultipacker. Read and understand this manual before attempting to assemble, transport, operate, or service this implement. Keep this manual with the machine at all times.

The 3 Point Cultipacker is a ground-engaging implement designed to firm and level soil surfaces after tillage or seeding operations. It is used to press seed into the soil, break remaining small clods, and create a smooth, firm seedbed to promote consistent seed-to-soil contact. The implement is equipped with heavy-duty ductile iron packer rollers to provide uniform ground pressure and long service life. A full-width scraper bar is standard equipment to help minimize soil buildup on the roller surface during operation.

Common applications include:

- Final seedbed firming after primary tillage
- Firming soil after broadcast seeding or drilling to improve seed-to-soil contact
- Breaking remaining small soil clods and pressing loose stones into the soil surface
- Leveling and smoothing cultivated fields, pastures, lawns, food plots, and landscaped areas
- Preparing soil surfaces prior to planting grass seed, small grains, or similar crops

Not recommended for:

- Primary tillage, deep ripping, or any operation requiring significant soil penetration
- Operating in areas containing large rocks, stumps, roots, or other immovable objects
- Breaking, removing, or leveling concrete, asphalt, blacktop, or compacted road surfaces
- High-speed operation over rough or uneven terrain that may cause loss of control or equipment damage
- Using the implement as a transport roller or applying excessive downforce beyond normal operating conditions



SAFETY INFORMATION



THE FOLLOWING SAFETY PRECAUTIONS SHOULD BE THOROUGHLY UNDERSTOOD BEFORE ATTEMPTING TO BEGIN ASSEMBLING THIS MACHINE

SAFETY ALERT SYMBOL AND SIGNAL WORDS

A safety alert symbol is used to identify safety messages. When you see a safety message, be alert to the possibility of injury. Follow recommended precautions and safe operating practices.

⚠ WARNING

CRUSHING CAN CAUSE SERIOUS INJURY OR DEATH

- Keep all bystanders away from equipment when operating.
- Fully lower the implement before leaving the operator's seat.

⚠ CAUTION ⚠

THE FOLLOWING SAFETY PRECAUTIONS SHOULD BE THOROUGHLY UNDERSTOOD BEFORE ATTEMPTING TO BEGIN ASSEMBLING THIS MACHINE

1. Select an area for assembly that is clean and free of any debris which might cause persons working on the assembly to trip.
2. Do not lift heavy parts or assemblies. Use crane, jack, tackle, fork trucks or other mechanical devices.
3. Never put hands, or any part or body, under blocked up assemblies if at all possible.
4. After completing assembly, thoroughly inspect the machine to be sure that all nuts, bolts or any other fastened assemblies have been thoroughly tightened.
5. Before operating equipment—if you have any questions regarding the proper assembly or operation, contact your dealer or the manufacturer.

⚠ WARNING

To Prevent Serious Injury or Death:

- Avoid unsafe operation or maintenance.
- Do Not operate or work on this machine without reading and understanding the Operator's Manual.
- If manual is lost, contact your nearest dealer for a new manual.

⚠ WARNING ⚠

PINCH POINT HAZARD

TO AVOID INJURY
KEEP HANDS AND FEET CLEAR



⚠ WARNING

Falling hazard

- Do not stand on roller.

Failure to follow these instructions could result in serious injury.

GENERAL SAFETY RULES

1. Select an area for assembly that is clean and free of any debris which might cause persons working on the assembly to trip.
2. Do not lift heavy parts or assemblies. Use crane, jack, tackle, fork trucks, or other mechanical devices.
3. Preview the assembly instructions in your operator's manual before proceeding further.
4. If the assembly instructions call for parts or assemblies to be blocked up, use only blocking material that is in good condition and is capable of handling the weight of the assembly to be blocked. Also ensure that the blocking material is on a clean, dry surface.
5. Never put hands, or any part of the body, under blocked-up assemblies if at all possible.
6. After completing assembly, thoroughly inspect the machine to be sure that all nuts, bolts, hydraulic fittings, or any other fastened assemblies have been thoroughly tightened.
7. Before operating the machine, thoroughly read the operation section of your operator's manual.
8. Before operating, read the machine section of your operator's manual to be sure that any parts requiring lubrication are properly lubricated to avoid any possible damage.
9. Before operating the equipment — if you have any questions regarding the proper assembly or operation, contact your dealer or representative.



EQUIPMENT SAFETY GUIDELINES

1. Never use alcoholic beverages or drugs which can hinder alertness or coordination while operating this equipment. Consult your doctor about operating this machine while taking prescription medications.
2. Review the safety instructions with all users annually.
3. This equipment is dangerous to children and persons unfamiliar with its operation. The operator should be a responsible adult familiar with your machinery and trained in this equipment's operations. Do not allow persons to operate or assemble this unit until they have read this manual and have developed a thorough understanding of the safety precautions and of how it works.
4. Never exceed the limits of a piece of machinery.
5. Do not modify the equipment in any way. Unauthorized modification may impair the function and could affect the life of the equipment.

OPERATIONAL SAFETY

1. The use of this equipment is subject to certain hazards which cannot be protected against by mechanical means or product design. All operators of this equipment must read and understand this entire manual, paying particular attention to the operating procedures prior to use. If there is something in this manual you do not understand, ask your supervisor or your dealer to explain it to you.
2. Personal protection equipment, including hard hat, safety glasses, safety shoes, and gloves, is recommended during assembly.
3. Never permit any person to ride or board the implement at any time.
4. A heavy load can cause instability in driving a tractor. Make sure the front or rear of the tractor is properly counter-balanced with weights. Always drive slowly — especially around turns. An unstable tractor could steer badly and possibly tip over, causing injury or death.
5. Most accidents occur because of neglect or carelessness. Keep all helpers and bystanders at a safe distance.
6. Do not operate close to ditches or creeks. Slow down when operating over rough ground.
7. Keep hands, feet, and clothing away from moving parts and pinch points.
8. Be careful to avoid catching the implement on stumps or other immovable objects.

MAINTENANCE SAFETY

1. Keep all persons away from the operator control area while performing adjustments, service, or maintenance.
2. Periodically tighten all bolts, nuts, and screws and check that all cotter pins are properly installed to ensure the unit is in a safe condition.
3. Never use your hands to locate a hydraulic leak on attachments. Use a small piece of cardboard or wood.
4. Never replace hex bolts with less than grade five bolts unless otherwise specified. Refer to the bolt torque chart for head identification markings.

ALWAYS OBEY ALL SAFETY RULES!
ALWAYS BE CAREFUL!



ASSEMBLY INSTRUCTIONS

Assembly procedures vary by model. If assembly is required, use appropriate lifting equipment and follow safe handling practices. Loosely assemble components first, align parts, and then tighten hardware to final torque.

ASSEMBLY

1. Scraper Bar Assembly (Refer to Figure 1)

1. Remove all scraper bar components from the crate.
2. Position the scraper bar connection plates and scraper bar on the main frame and secure them using the provided bolts and nuts.

Note: The bolts used to attach the scraper bar components are shipped pre-installed in the corresponding holes of the kit.

3. Install all supplied hitch pins onto the implement.
4. Tighten all hardware to the specified torque values.

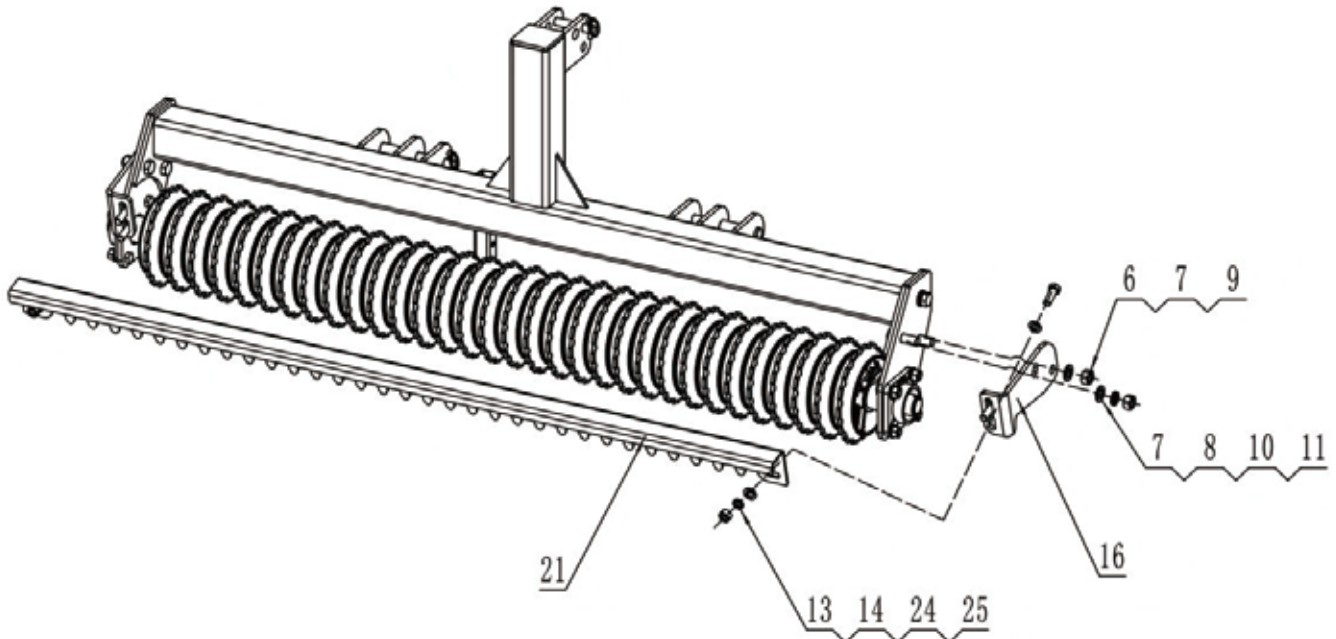

FIG. 1

No.	DESCRIPTION	Qty
6	Bolt M20*55	2
7	Flat washer φ20	4
8	Spring washer φ20	2
9	Lock Nut M20	2
10	Nut M20	2
11	Bolt M20*60	2

No.	DESCRIPTION	Qty
13	Flat washer φ16	8
14	Bolt M16*45	4
16	Scraper Bar Connection Plate	2
21	Scraper Bar	1
24	Spring washer φ16	4
25	Nut M16	4

DELIVERY CHECKLIST

Use the following checklist prior to delivery or prior to first use:

- All components are included.
- Grease fittings checked and lubricated as needed.
- Safety guards in place.
- All hardware tight.
- Bolts torqued correctly.
- Attached unit to tractor.
- Field adjusted.
- Test run.

TRACTOR REQUIREMENTS AND COMPATIBILITY

Ensure the tractor and implement are properly matched before use.

- 3-point hitch category must match the implement (Category 1 or Category 2).
- Tractor horsepower must be within the implement's rating.
- Tractor must be adequately ballasted to maintain steering control and stability.
- Tire track width and 3-point geometry must provide clearance for turns and transport.
- Use ROPS and seat belt as recommended by tractor manufacturer.

TRACTOR HOOK-UP

Follow this sequence for safe and correct attachment:

- Back tractor to implement and align lower lift arms with hitch points.
- Set parking brake, shut off engine, remove key, and dismount.
- Attach lower lift arms using correct hitch pins; secure with retaining clips/lynch pins.
- Attach the top link to the implement A-frame/top mast using the top hitch pin; secure with retaining clip.
- Adjust sway/limit chains or stabilizers to reduce side-to-side movement.
- Slowly raise the implement a few inches and check for interference with tires, drawbar, or other tractor components.
- Level implement side-to-side using the tractor's leveling box/turnbuckle.
- Adjust top link to set desired implement pitch so rollers contact the ground evenly.

OPERATION

OPERATOR RESPONSIBILITIES

The operator must be trained and competent to operate the tractor and implement. Keep all bystanders at a safe distance. Never allow riders on the tractor or implement.

PRE-OPERATION INSPECTION

Before each use, perform a complete inspection and service check to ensure the tractor and cultipacker are in safe working condition. Do not operate if any condition affecting safe operation is found.

Cultipacker inspection items

- All safety decals present and legible
- Hitch pins properly installed and retained
- No cracks in hitch and frame; weldments intact
- All frame bolts in place and tightened to specification
- Roller rotates freely; no binding or abnormal noise
- Bearings lubricated and retained
- Scraper Bar securely fastened and properly aligned
- Roller surface clear of mud, vegetation, and debris

START-UP AND FIELD OPERATION

Recommended operating sequence:

- Clear the area of obstacles and foreign objects before starting work.
- Lower the implement slowly to the ground before beginning forward motion.
- Begin at a low ground speed; increase speed only as conditions allow and the desired finish is achieved.
- Use straight passes with slight overlap to avoid ridges.
- Avoid sharp turns while the roller is fully engaged on the ground; lift slightly before turning.

OPERATING TIPS

- Dry to moderately moist soil generally produces the best finish. Overly wet soil may stick to the roller and scraper.
- Multiple light passes are generally preferable to one aggressive pass in compacted soil.
- If the roller slips or rides on top of loose soil, reduce speed and make additional passes.
- If soil buildup occurs, stop in a safe area, shut off the tractor, and clean the roller and Scraper Bar as needed.

TRANSPORT AND STORAGE

TRANSPORT

Follow these guidelines when transporting the tractor and implement:

- Raise the implement to a safe transport height and ensure adequate ground clearance.
- Reduce speed and use extra caution on turns, slopes, and rough ground.
- Do not allow anyone to ride on the implement.
- Comply with all federal, state, and local roadway requirements; use lighting and marking as required.

STORAGE

- Clean the implement thoroughly and remove mud, vegetation, and debris.
- Inspect for worn or damaged parts and repair before storage.
- Lubricate all grease points prior to storage.
- Lower the implement to the ground on a firm, level surface; block securely if needed.
- Protect exposed metal surfaces with rust preventive if stored outdoors or for extended periods.
- Store away from human activity and keep children away from the stored implement.



MAINTENANCE AND LUBRICATION

MAINTENANCE SCHEDULE (MINIMUM RECOMMENDATIONS)

Before each use:

- Inspect for loose fasteners, cracked welds, and missing hardware.
- Inspect the roller for damage and debris buildup; clean as needed.
- Inspect Scraper Bar (scraper) for wear and proper adjustment/clearance.

After first 10 hours of use and every 10 hours thereafter:

- Lubricate roller bearings (both ends) with multi-purpose grease (as required).
- Re-check fastener tightness and re-torque critical hardware.
- Inspect bearings for noise, heat, or looseness; replace if needed.

LUBRICATION POINTS

Lubricate all grease fittings at recommended intervals. Use a high-quality multi-purpose grease compatible with your operating environment.

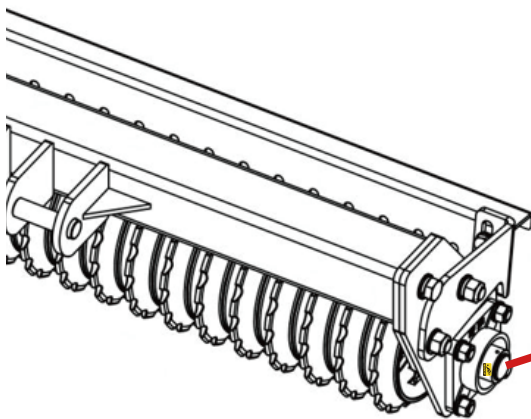

Insert lubrication illustration (grease points).

Location	Interval	Lubricant	Quantity	Notes
Rear roller bearing (each end)	10 hours	Multi-purpose grease	As required	Wipe fitting clean before greasing

HARDWARE RETENTION AND REPLACEMENT

Periodically tighten all bolts, nuts, and screws. Replace damaged fasteners with equivalent grade hardware. Use new cotter pins/retainers after removal.



TROUBLESHOOTING

Use the table below to diagnose common operating issues.







Problem	Likely Cause	Corrective Action
Roller(s) bouncing or not staying on ground	Ground speed too high; uneven terrain; improper top link setting	Reduce speed, lift slightly before turns, level implement, and adjust top link/pitch.
Excessive soil buildup on roller	Soil too wet; Scraper Bar not adjusted; debris accumulation	Operate in suitable soil moisture, adjust scraper clearance, and clean roller/scraper as needed.
Uneven finish (ridges/low spots)	Implement not level; overlap inconsistent; operating speed inconsistent	Level implement side-to-side and maintain consistent overlap and speed.
Excessive vibration/noise from roller area	Bearing dry/damaged; debris wrapped on roller; loose fasteners	Clean roller, lubricate bearings, tighten hardware, and replace bearings if noise persists
Scraper (Scraper Bar) wear or bending	Operating in rocky conditions; impact with obstacles; incorrect clearance	Avoid impacts, inspect for damage, correct clearance, and replace worn components.

TORQUE GUIDELINES

The tables shown below give the correct torque values for various bolts and cap screws. Tighten all bolts to the torques specified unless otherwise noted. Check tightness of bolts periodically, using bolt torque chart as a guide. Replace hardware with the same length and grade of bolt.



TORQUE VALUES CHART FOR COMMON BOLT SIZES

Bolt Size (Inches) in-tpi ¹	Bolt Head Identification						Bolt Size (Inches) mm x pitch ⁴	Bolt Head Identification					
													
	Grade 2		Grade 5		Grade 8			Class 5.8		Class 8.8		Class 10.9	
	N.m ²	ft-lb ³		ft-lb	N.m	ft-lb	N.m	ft-lb	N.m	ft-lb	N.m	ft-lb	
1/4"-20	7.4	5.6	11	8	16	12	M5X0.8	4	3	6	5	9	7
1/4"-28	8.5	6	13	10	18	14	M6X1	7	5	11	8	15	11
5/16"-18	15	11	24	17	33	25	M8X 1.25	17	12	26	19	36	27
5/16"-24	17	13	26	19	37	27	M8X1	18	13	28	21	39	29
3/8" -16	27	20	42	31	59	44	M10X 1.5	33	25	52	39	72	53
3/8" -24	31	22	47	35	67	49	M10X0.75	39	29	61	45	85	62
7/16" -14	43	32	67	49	95	70	M12X 1.75	58	42	91	67	125	93
7/16"-20	49	36	75	55	105	78	M12X 1.5	60	44	95	70	130	97
1/2" -13	66	49	105	76	145	105	M12X1	90	66	105	77	145	105
1/2" -20	75	55	115	85	165	120	M14 X2	92	68	145	105	200	150
9/16"-12	95	70	150	110	210	155	M14 X 1.5	99	73	155	115	215	160
9/16"-18	105	79	165	120	235	170	M16X2	145	105	225	165	315	230
5/8" - 11	130	97	205	150	285	210	M16X 1.5	155	115	240	180	335	245
5/8" -18	150	110	230	170	325	240	M18 X 2.5	195	145	310	230	405	300
3/4" -10	235	170	360	265	510	375	M18 X 1.5	220	165	350	260	485	355
3/4" -16	260	190	405	295	570	420	M20 X 2.5	280	205	440	325	610	450
7/8" -9	225	165	585	430	820	605	M20 X 1.5	310	230	650	480	900	665
7/8" -14	250	185	640	475	905	670	M24X3	480	355	760	560	1050	780
1"-8	340	250	875	645	1230	910	M24 X2	525	390	830	610	1150	845
1"-12	370	275	955	705	1350	995	M30 X 3.5	960	705	1510	1120	2100	1550
1-1/8"-7	480	355	1080	795	1750	1290	M30x2	1060	785	1680	1240	2320	1710
1-1/8" -12	540	395	1210	890	1960	1440	M36 X3.5	1730	1270	2650	1950	3660	2700
1-1/4"-7	680	500	1520	1120	2460	1820	M36X2	1880	1380	2960	2190	4100	3220
1-1/4" -12	750	555	1680	1240	2730	2010							
1-3/8"-6	890	655	1990	1470	3230	2380							
1-3/8" -12	1010	745	2270	1670	3680	2710							
1-1/2" -6	1180	870	2640	1950	4290	3160							
1-1/2" -12	1330	980	2970	2190	4820	3560							

¹ in-tpi = nominal thread diameter in inches-threads per inch
² N.m= newton-meters
³ ft-lb= foot pounds
⁴mm x pitch = nominal thread diameter in millimeters x thread pitch

Torque tolerance +0%,-15% of torquing values. Unless otherwise specified use torque values listed above.

Torque figures indicated above are valid for non-greased or non-oiled threads and heads otherwise specified. Therefore, do not grease or oil bolts or cap screws unless otherwise specified in this manual. When using locking elements, increase torque values by 5%

CULTIPACKER PARTS ASSEMBLY

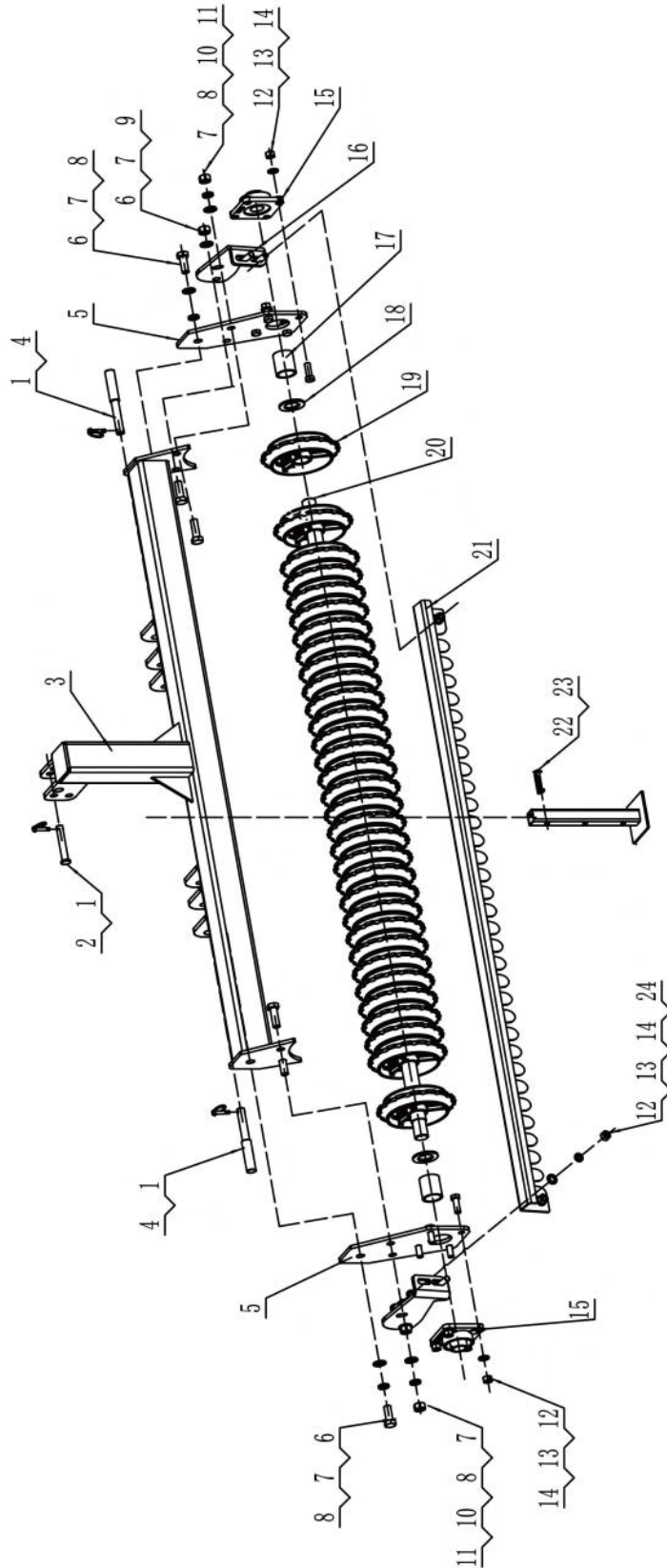

PARTS LIST

No.	DESCRIPTION	Qty
1	O Pin	3
2	Pin ϕ 19	1
3	Frame	2
4	Pin ϕ 22	2
5	Connection	2
6	Bolt M20*55	4
7	Flat washer ϕ 20	6
8	Spring washer ϕ 20	4
9	Lock Nut M20	2
10	Nut M20	2
11	Bolt M20*60	2
12	Lock Nut M16	12
13	Flat washer ϕ 16	16
14	Bolt M16*45	12
15	UCF 208	2
16	Scraper Bar Connection Plate	2
17	Spacer 1	2
18	Spacer 2	2
19	Rake	26/32/37
20	Alex	1
21	Scraper Bar	1
22	Lock Pin	1
23	Stand	1
24	Spring washer ϕ 16	4

MechMaxx

info@mechmaxx.com

