

The Haier logo is displayed in white text on a dark grey rectangular background in the top right corner of the page.

Haier

Chest Freezer

HCF420W, HCF520W, HCF720W

USER & INSTALLATION GUIDE | NZ AU

SAFETY AND WARNINGS

⚠ WARNING!



Risk of fire/flammable material

- This appliance contains flammable refrigerant isobutane (R600a).

READ AND SAVE THIS GUIDE

- * This appliance can be used by children aged from 8 years and above and persons with reduced physical, sensory or mental capabilities or lack of experience and knowledge if they have been given supervision or instruction concerning use of the appliance in a safe way and understand the hazards involved.
- * Children shall not play with the appliance.
- * Children must not clean or maintain the appliance without supervision.
- * Cleaning and user maintenance shall not be made by children without supervision.
- * The appliance must be positioned so that the plug is accessible.
- * If the supply cord is damaged, it must be replaced by the manufacturer, its service agent or similarly qualified persons in order to avoid a hazard.
- * **WARNING:** Keep ventilation openings, in the appliance enclosure or in the built in structure, clear of obstruction.
- * **WARNING:** Do not use mechanical devices or other means to accelerate the defrosting process, other than those recommended by the manufacturer.
- * **WARNING:** Do not damage the refrigerant circuit.
- * **WARNING:** Do not use electrical appliances inside the food storage compartments of the appliance, unless they are of the type recommended by the manufacturer.
- * If the light is damaged, it must be replaced by the manufacturer, a service agent, or a qualified technician.
Do not store explosive substances such as aerosol cans with a flammable propellant in this appliance.
- * This chest freezer is suitable for unheated rooms and outbuildings, provided temperatures do not fall below -15°C.
This appliance uses flammable refrigerant. Please install, handle, and service it strictly according to the instructions. Contact a professional or our after-sales service for disposal.
- * A built-in switch controls the light in models equipped with lighting. The light turns on automatically when the door is opened and off when closed. (Not available in all models.)
- * Regulations require this appliance to be earthed.
- * The  on the product or packaging indicates that it must not be disposed of with household waste. Instead, take it to a designated collection point for recycling electrical and electronic equipment.
- * **WARNING:** When positioning the appliance, ensure the supply cord is not trapped or damaged.
- * **WARNING:** Do not locate multiple portable socket outlets or portable power supplies at the rear of the appliance.
- * Children aged 3 to 8 may load and unload the appliance only under supervision.
- * This appliance is intended to be used in household and similar applications such as:
 - * staff kitchen areas in shops, offices and other working environments;

SAFETY AND WARNINGS

- * farm houses and by clients in hotels, motels and other residential type environments;
- * bed and breakfast type environments;
- * catering and similar non retail applications.
- * To avoid food contamination, follow these instructions:
 - * Avoid keeping the door open for long periods, as this raises the internal temperature.
 - * Regularly clean surfaces that come into contact with food, as well as any accessible drainage systems.
 - * Store raw meat and fish in sealed containers to prevent contact with or dripping onto other food.
 - * If the appliance will be unused for a long time, switch it off, defrost, clean, dry, and leave the door open to prevent mould growth.
- * To ensure safe food storage, keep instant foods and raw meat or fish stored separately.
- * This refrigerating appliance is not intended to be used as a built in appliance.
- * It is hazardous for anyone other than an Authorised Service Person to service this appliance. In Queensland – the authorized Service Person MUST hold a Gas Work Authorisation for hydrocarbon refrigerants, to carry out Servicing or repairs which involve the removal of covers.
- * **WARNING:** Risk of child entrapment. Before you throw away your old refrigerator or freezer, the doors and panels should be removed and the racks left in place so that children may not easily climb inside

Before Use

- * This appliance is intended strictly for household use, for storing food only.
- * If the appliance is damaged when unpacked, please contact your dealer.
- * Ensure the power supply matches the specifications on the appliance's rating plate.

OVERVIEW

Control Panel



Product Overview

A	Door
B	Gasket
C	Cabinet
D	Storage compartment
E	Ventilation grille
F	Control panel
G	Basket
H	Compressor compartment
I	Compressor
J	Fan*
K	External condenser*
L	Drain plug
M	Light

*some models only

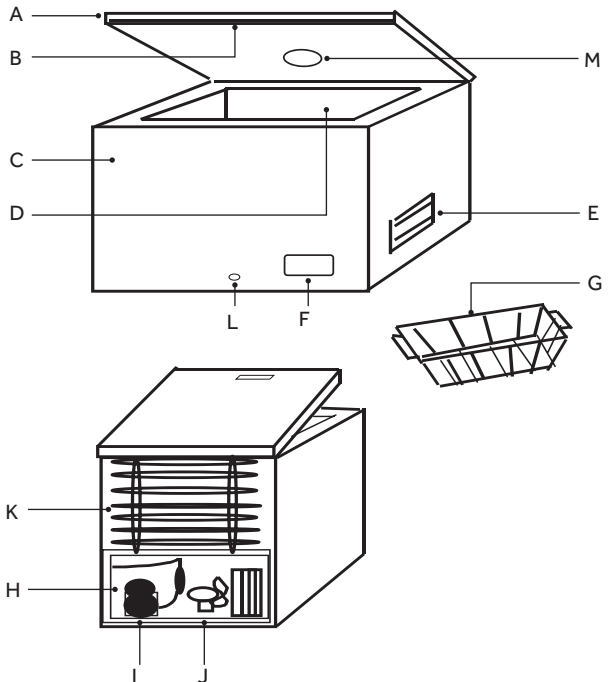

INSTALLATION

- * Fully unpack the appliance and remove all packaging materials. Dispose of packaging safely and keep it out of reach of children.
- * Install the appliance in a dry, well-ventilated area. Avoid direct sunlight and keep it away from heat sources.
- * The electricity supply must match the rating plate and comply with local regulations.
- * Wait at least two hours after installation before switching on the appliance. This allows the refrigerant circuit to stabilise.
- * Install the appliance in a location with an ambient temperature matching the climate class shown on the rating plate.

Climate Class	Ambient Temperature
SN	+10 °C to 32°C
N	+16 °C to 32°C
ST	+16 °C to 38°C
T	+16 °C to 43°C

- * Insert the plug in the socket. Wait until all indicators light up and turn off. The temperature will then be displayed.
- * Allow two hours for the internal temperature to stabilise before placing food inside.

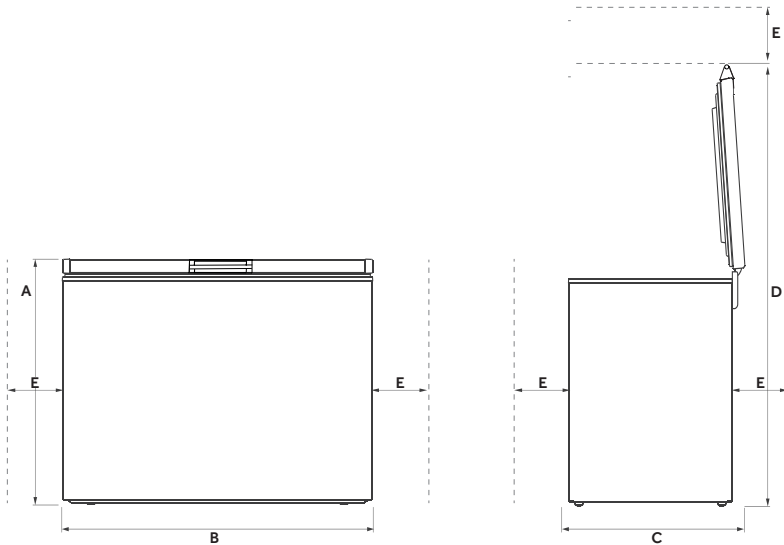

Dimensions		HCF420W	HCF520W	HCF720W
		MM	MM	MM
A	Height	845	845	845
B	Width	1320	1545	2042
C	Depth (including handle)	750	750	780
D	Overall height (lid open)	1530	1530	1555
E	Clearances (front, rear, sides, top of lid when open)	50	50	50

INSTALLATION

Installing the door handles (if required)



1. Use a screwdriver to remove the mounting screws from the front of the door. Keep these nearby.

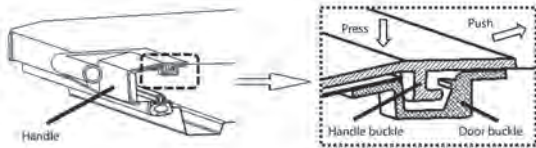

2. Align the handle buckle with the holes in the top of the door, and push the handle against the door.

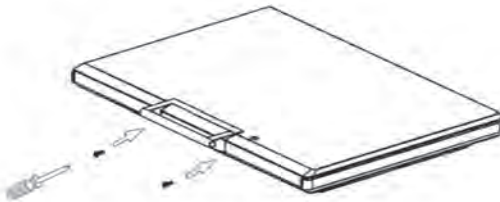

3. Use the mounting screws that were removed in Step 1 to fix the handle to the door.

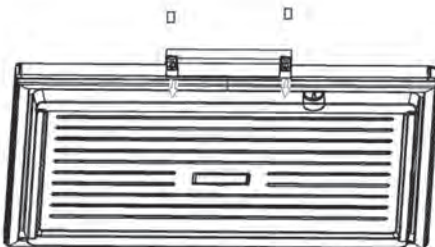

4. Attach the screw covers to the bottom of the handle.

FIRST USE

Guidance on Freezing Food

- * Wrap or seal food in aluminium foil, airtight containers, or freezer-safe storage bags before freezing.
- * Allow hot food to cool prior to placing it in the appliance.
- * Smaller portions freeze faster. The recommended maximum portion size is 2.5 kg.
- * Avoid placing warm food directly against frozen items. This could cause defrosting and reduce shelf life.
- * The capacity of the appliance, as shown on the rating plate, should not be exceeded.
- * When freezing large amounts of fresh food, activate the Super Freeze function (if available) at least 24 hours in advance.
- * Storage times for frozen products vary by type and packaging. Always follow the instructions on the label.

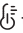

Adjusting the temperature

Press the **Temp. Set** button  to adjust the temperature.

The default recommended setting is -18°C .

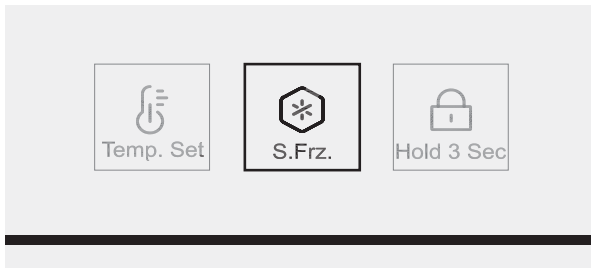

Setting Super Freeze

Press **S. Frz.** button  until the indicator lights up

The Super Freeze function will switch off automatically after 71 hours to save energy. Power consumption will increase while Super Freeze is active.

While in Super Freeze mode, the temperature inside the freezer will target -26°C .

Note: actual temperature reached will be dependent on factors like ambient temperature.



Locking the control panel

To lock or unlock the control panel, press **Hold 3 Sec** button  for 3 seconds.

CLEANING AND MAINTENANCE

Cleaning

- * Always switch off the power and unplug the appliance before performing any maintenance or cleaning.
- * If the appliance will be unused for a long time, leave the door open to prevent unpleasant odours.
- * To ensure food safety, use and clean the freezer regularly as described below.
- * Clean the inside of your freezer at least once a year.
 - * Use warm water and baking soda solution about a tablespoon of baking soda to litre/quart of water. Rinse thoroughly with water and wipe dry.
 - * Do not use cleaning powders or other abrasive cleaners.
 - * Do not wash removable parts in a dishwasher.
- * Do not use harsh chemicals, abrasives, ammonia, chlorine bleach, concentrated detergents, solvents, or metal scouring pads. These may damage or discolour the freezer.
- * Never use metallic scouring pads, brushes, abrasive cleaners, or alkaline solutions on any surface.
- * Clean the door gasket every three months with the baking soda solution as above. Keep it clean and flexible to ensure a proper seal. For areas like seams, slots, and holes, use simple tools such as soft brushes to clean. If needed, removable shelves, trays, drawers, and similar accessories can be taken out and washed in the sink.

Defrosting

- * The appliance should be defrosted once the thickness of ice on the walls reaches 5–6 mm.
- * Do not use sharp or powered tools to assist in defrosting, unless they are approved by the manufacturer or service centre.
- * To remove ice from the inner walls, use a plastic or wood scraper without sharp edges. Never use a metal scraper. Follow the below guidance:
 - * Unplug the appliance.
 - * Dry your hands thoroughly to prevent injury from ice. Gloves are recommended.
 - * Transfer all frozen food to a container or cool box. Place ice blocks on top to keep items cold, and store in a cool, dry area.
 - * Place a tray or towel in front of the drain plug at the front of the product.
 - * Remove the drain plug from the front of the appliance and then remove the drain plug from the interior of the appliance to allow excess water to drain out.
 - * Gently scrape ice from the interior and place it in the kitchen sink to melt.
 - * Thoroughly clean the inside of the appliance compartment, rinse it with warm water and remove any spilt food or liquids.
 - * Replace the drain plug (if applicable).
 - * Close the appliance door, replace the plug in the socket and turn the appliance on.
 - * Refill the appliance.
 - * To prevent food from thawing, complete the defrosting process within two hours to avoid temperature increases that can reduce shelf life.

Energy Saving Tips

- * Over time, frost or ice may form on the interior walls, increasing energy use. To maintain efficiency, defrost the freezer regularly.

TROUBLESHOOTING

Is the door difficult to open?

- After closing the door, it may be difficult to open again for a few minutes. This is normal and indicates the seal is functioning properly. Wait a few minutes, and the door will open easily.

Appliance not operating (not running or cooling)

- Is there a power failure.
- Is the plug undamaged and firmly connected to the socket?

Appliance isn't cooling properly / 'HH' appears on display

- Is the door of the appliance closed properly?
- Is there heavy ice formation on the inner walls?
- Is the appliance exposed to direct sunlight or heat?
- Has too much warm food been placed in the appliance?
- You can find the climate class on the rating label on the back of the appliance. It shows the ambient temperatures suitable for proper operation.

Climate Class	Ambient Temperature
SN	+10 °C to 32°C
N	+16 °C to 32°C
ST	+16 °C to 38°C
T	+16 °C to 43°C

The appliance makes noise

- This sound comes from the compressor motor and refrigerant moving through the system. These noises are normal.

Condensation builds up on the outer walls

- Under certain atmospheric conditions, condensation can form on the appliance's outer walls. This is normal and won't affect performance.

CUSTOMER SERVICE

We recommend our Haier Customer Service and the use of original spare parts.

If you have a problem with your appliance, please first check the Troubleshooting section. If you cannot find a solution there, please contact:

- Your local dealer
- The Service & Support area at **www.haier.com.au** or **www.haier.co.nz**

where you can activate the service claim and also find FAQs.

To contact our Service, ensure that you have the following data available. The information can be found on the rating plate at the door.

Model _____

Serial No. _____

Complete and keep for safe reference:

Model _____

Serial No. _____

Purchase Date _____

Purchaser _____

Dealer _____

Suburb _____

Town _____

Country _____

Haier

WWW.HAIER.COM.AU
WWW.HAIER.CO.NZ

条形码尺寸40*8mm, 由厂家生成。

0070521052 06.25

