

Criterion®

User's Manual

Refrigerator-Freezer

MODEL: CSBR260M4S

Before using your product, please read this manual carefully and keep it for future reference.

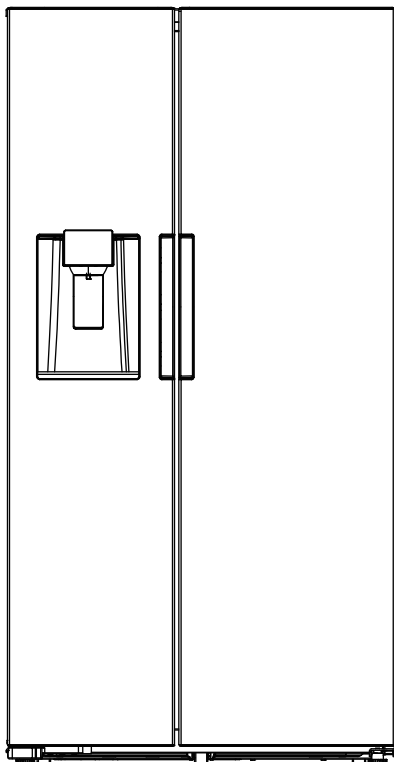

CONTENTS

1.SAFETY INFORMATION	1
2.PROPER USE OF REFRIGERATOR	8
2.1 Placement	8
2.2 Energy Saving Tips.....	9
2.3 Changing The Light	9
2.4 Start To Use	9
2.5 Names Of Components	10
2.6 Functions	11
2.7 Fetching Water And Ice	15
2.8 Leveling Feet	17
2.9 Leveling Door.....	17
2.10 Connect To Water.....	18
3.MAINTENANCE OF REFRIGERATOR	20
3.1 Overall Cleaning	20
3.2 Defrosting	21
3.3 Out Of Operation.....	21
3.4 Cleaning Of Glass Shelf	21
3.5 Cleaning Of Door Tray.....	22
3.6 Clean The Ice Container	22
4.TROUBLE SHOOTING	23

1. SAFETY INFORMATION

YOUR SAFETY AND THE SAFETY OF OTHERS ARE VERY IMPORTANT

To prevent injury to the user or other people and property damage, the instructions shown here must be followed. Incorrect operation due to ignoring of instructions may cause harm or damage, including death.

The level of risk is shown by the following indications.



Prohibition symbol

This is a prohibition symbol.

Any in compliance with instructions marked with this symbol may result in damage to the product or endanger the personal safety of the user.



Warning symbol

This is a warning symbol.

It is required to operate in strict observance of instructions marked with this symbol; or otherwise damage to the product or personal injury may be caused.



Cautioning symbol

This is a cautioning symbol.

Instructions marked with this symbol require special caution. Insufficient caution may result in slight or moderate injury, or damage to the product.

IMPORTANT SAFETY INSTRUCTIONS



Risk Of Fire / Flammable Materials



WARNING

- This appliance is intended to be used in household and similar applications such as staff kitchen areas in shops, offices and other working environments; farm houses and by clients in hotels, motels and other residential type environments; bed and breakfast type environments; catering and similar non-retail applications.
- This appliance is not intended for use by persons (including children) with reduced physical, sensory or mental capabilities, or lack of experience and knowledge, unless they have been given supervision or instruction concerning use of the appliance by a person responsible for their safety.

- Children should be supervised to ensure that they do not play with the appliance.
- If the supply cord is damaged, it must be replaced by the manufacturer, its service agent or similarly qualified persons in order to avoid a hazard.
- Do not store explosive substances such as aerosol cans with a flammable propellant in this appliance.
- The appliance has to be unplugged after use and before carrying out user maintenance on the appliance.
- **WARNING:** Keep ventilation openings, in the appliance enclosure or in the built-in structure, clear of obstruction.
- **WARNING:** Do not use mechanical devices or other means to accelerate the defrosting process, other than those recommended by the manufacturer.
- **WARNING:** Do not damage the refrigerant circuit.
- **WARNING:** Do not use electrical appliances inside the food storage compartments of the appliance, unless they are of the type recommended by the manufacturer.
- **WARNING:** Please abandon the refrigerator according to local regulators for its use flammable blowing gas and refrigerant.
- **WARNING:** When positioning the appliance, ensure the supply cord is not trapped or damaged.
- **WARNING:** Do not locate multiple portable socket-outlets or portable power supplies at the rear of the appliance.
- Do not use extension cords or ungrounded two prong adapters.
- **WARNING:** Connect to potable water supply only. (suitable for ice cube maker)



DANGER

- The refrigerator must be disconnected from the source of electrical supply before attempting the installation of accessory.
- Refrigerant and cyclopentane foaming material used for the appliance are flammable. Therefore, when the appliance is scrapped, it shall be kept away from any fire source and be recovered by a special recovering company with corresponding qualification other than be disposed by combustion, so as to prevent damage to the environment or any other harm.



WARNING

- Risk of child entrapment. Before you throw away your old refrigerator or freezer:
 - Take off the doors.
 - Leave the shelves in place so that children may not easily climb inside.

SAVE THESE INSTRUCTIONS

THIS APPLIANCE IS FOR HOUSEHOLD USE ONLY

State of California Proposition 65 Warnings:

 **WARNING:** Cancer and Reproductive Harm
-www.P65Warnings.ca.gov.

PROPER DISPOSAL

WARNING

Suffocation Hazard

Before you throw away your old freezer or refrigerator:

- Remove the door or lid so that children cannot hide or get trapped inside your old appliance.
- Leave any shelves in place so that children may not easily climb inside.
- Failure to follow these instructions can result in death or brain damage.

IMPORTANT:

Flammable gas and refrigerant used. It is the consumer's responsibility to comply with Federal and Local regulations when disposing of this product. Refrigerants must be evacuated by a licensed, EPA certified refrigerant technician in accordance with established procedures.

ELECTRICITY RELATED WARNINGS

- Do not pull the power cord when pulling the power plug of the refrigerator. Please firmly grasp the plug and pull out from the socket.
- To ensure safe use, do not damage the power cord or use the power cord when it is damaged or worn.
- Please use a dedicated power socket; the power socket shall not be shared with other electrical appliances.

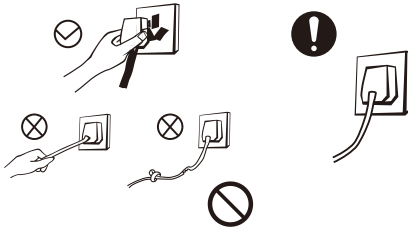

- The power cord should be firmly contacted with the socket, otherwise fire may be caused.
- Please ensure that the grounding electrode of the power socket is equipped with a reliable grounding line .
- Please turn off the valve of leaking gas and then open doors and windows in case of leakage of gas and other flammable substances. Do not unplug the refrigerator and other electrical appliances considering that spark may cause a fire.

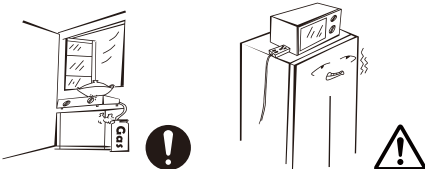

- Do not use electrical appliances on top of the appliance, unless they are of the type recommended by the manufacturer.

WARNINGS RELATED TO PLACING ITEMS

- Do not place flammable, explosive, volatile and highly corrosive items in the refrigerator to prevent damages to the product or fire accidents.
- Do not place flammable items near the refrigerator to avoid fires.

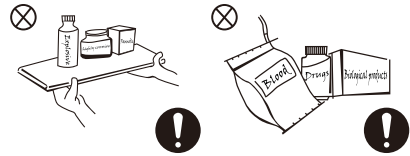

- This product is a household refrigerator and is only suitable for the storage of foods. According to national standards, a household refrigerator shall not be used for other purposes, such as storage of blood, drugs or biological products.
- Do not store beer, beverages or other fluids contained in bottles or enclosed containers in the freezing chamber of the refrigerator, otherwise the bottles or enclosed containers may crack due to freezing and cause damages.



WARNINGS FOR USE

- Do not arbitrarily disassemble or reconstruct the refrigerator, nor damage the refrigerant circuit; maintenance of the appliance must be conducted by a specialist.
- A damaged power cord must be replaced by the manufacturer, its maintenance department or related professionals in order to avoid danger.
- Do not allow children to enter or climb inside the refrigerator to prevent that children are sealed in the refrigerator or injured by the falling refrigerator.
- Do not spray or wash the refrigerator; do not place the refrigerator in moist places easy to be splashed with water so as not to affect the electrical insulation properties of the refrigerator.

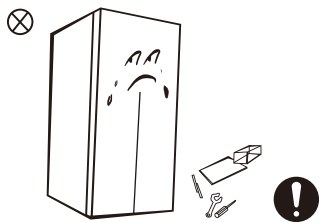

- The gaps between refrigerator doors and between doors and refrigerator body are small, do not place your hands in these areas to prevent squeezing your fingers. Please be gentle when opening the refrigerator door to avoid articles falling out.
- Do not pick up food or containers with wet hands in the freezing chamber when the refrigerator is running, especially metal containers in order to avoid frostbite.

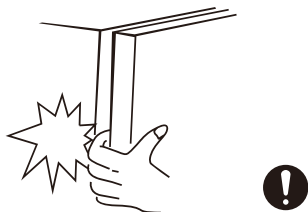

- Do not place heavy objects on top of the refrigerator considering that objects may fall when opening the door, and accidental injuries might be caused.
- Please pull out the plug in case of power failure or cleaning. Do not connect the refrigerator to power supply within five minutes to prevent damages to the compressor due to successive starts.

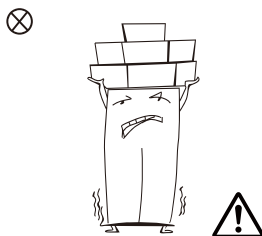

ENERGY WARNINGS

- 1.** Refrigerating appliances might not operate consistently (possibility of defrosting of contents or temperature becoming too warm in the frozen food compartment) when set for an extended period of time below the cold end of the temperature range for which the refrigerating appliance is designed.
- 2.** Effervescent drinks should not be stored in food freezer compartments or cabinets or in low-temperature compartments or cabinets because some products such as water ice should not be consumed too cold;
- 3.** Do not exceed the storage time(s) recommended by the food manufacturers for any kind of food and particularly for commercially quick-frozen food in food-freezer and frozen-food storage compartments or cabinets
- 4.** Prevent an undue rise in temperature of frozen food while defrosting the refrigerating appliance, such as wrapping the frozen food in several layers of newspaper.
- 5.** A rise in temperature of frozen food during manual defrosting, maintenance or cleaning can shorten the storage life

DISPOSAL



Refrigerant and cyclopentane foaming material used for the refrigerator are flammable. Therefore, when the refrigerator is scrapped, it shall be kept away from any fire source and be recovered by a special recovering company with corresponding qualification other than be disposed by combustion, so as to prevent damage to the environment or any other harm.



When the refrigerator is scrapped, disassemble the doors, and remove gasket of door and shelves; put the doors and shelves in a proper place, so as to prevent trapping of any child.

Correct Disposal of this product:



This marking indicates that this product should not be disposed with other household waste. To prevent possible harm to the environment or human health from uncontrolled waste disposal, recycle it responsibly to promote the sustainable reuse of material resources. To return your used device, please use the return and collection systems or contact the retailer where the product was purchased. They take this product in for environmental safe recycling.

2. PROPER USE OF REFRIGERATOR

2.1 PLACEMENT

- Before use, remove all packing materials, including bottom pads, foam pads and tapes inside of the refrigerator; tear off the protective film on the doors and the refrigerator body.

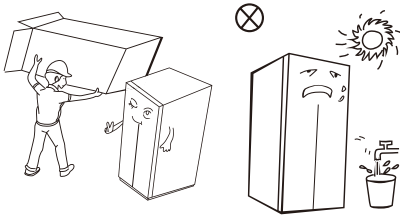

- Keep away from heat and avoid direct sunlight. Do not place the freezer in moist or wet places to prevent rust or reduction of the insulating effect.
- Do not spray or wash the refrigerator; do not put the refrigerator in moist places easy to be splashed with water so as not to affect the electrical insulation properties of the refrigerator.

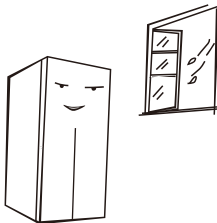

- The space on top of the refrigerator shall be greater than 10cm, and the refrigerator should be placed against a wall with a distance of more than 10cm to facilitate heat dissipation.

Spare enough space for convenient opening of the doors and drawers or statement by the distributor.

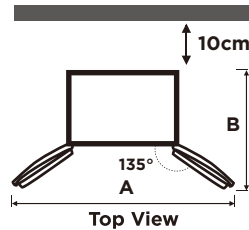
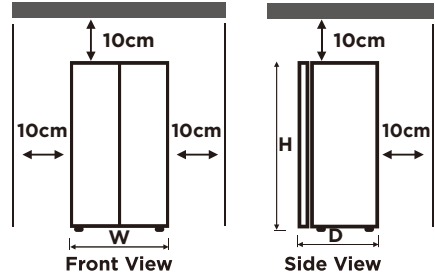

Width "w"	911
Depth "D" (without handle)	860
Height "H"	1775
A	1560
B	1226

(unit: mm)

The measurements in the above table may differ, depending on the measuring method.

NOTE

This refrigerator needs to be installed independently and cannot be used as a built-in. Otherwise, it will cause problems such as failure to install into the cabinet, the performance and life of the product are reduced. And the manufacturer does not provide basic product warranty.

2.2 ENERGY SAVING TIPS

- The appliance should be located in the coolest area of the room, away from heat producing appliances or heating ducts, and out of the direct sunlight.
- Let hot foods cool down to room temperature before placing it in the appliance. Overloading the appliance forces the compressor to run longer. Foods that freezes too slowly may lose quality, or spoil.
- Be sure to wrap foods properly, and wipe containers dry before placing them in the appliance. This cuts down on frost build-up inside the appliance.
- Appliance storage bins should not be lined with tin foil, wax paper, or paper toweling. Liners interfere with cold air circulation, making the appliance less efficient.
- Organize and label food to reduce door openings and extended searches. Remove as many items as needed at one time, and close the door as soon as possible

2.3 CHANGING THE LIGHT

- Any replacement or maintenance of the LED lamps is intended to be made by the manufacturer, its service agent or similar qualified person.

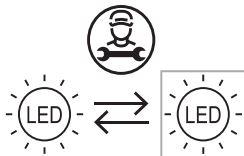

2.4 START TO USE

- Before initial start, keep the refrigerator still for two hours before connecting it to power supply.
- Before placing any fresh or frozen foods, the refrigerator should have run for 2 - 3 hours, or for above 4 hours in summer when the ambient temperature is high.

NOTE

This product is not recommended for use with sockets or main switch with the A/GFCI function, otherwise it may cause false tripping.

- 1. it's not pose a safety risk when tripped.**
- 2. If tripping persists, it is recommended to replace the sockets or main switch without A/GFCI function.**

2.5 NAMES OF COMPONENTS

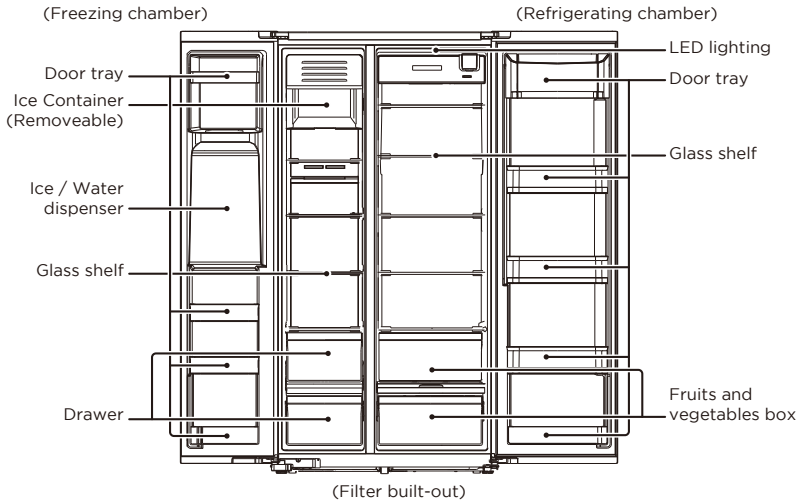

The picture above is only for reference. The actual configuration will depend on the physical product or statement by the distributor

Refrigerating chamber

- The Refrigerating Chamber is suitable for storage of a variety of fruits, vegetables, beverages and other food consumed in the short term, suggested storage time 3 days to 5 days.
- Cooking foods shall not be put in the refrigerating chamber until cooled to room temperature.
- Foods are recommended to be sealed up before putting into the refrigerator.
- The glass shelves can be adjusted up or down for a proper storage space and easy use.

Freezing chamber

- The low temperature freezing chamber may keep food fresh for a long time and it is mainly used to store frozen foods and making ice.
- The freezing chamber is suitable for storage of meat, fish, rice balls and other foods not to be consumed in short term.
- Chunks of meat are preferably to be divided into small pieces for quick freezing and easy access. Please be noted food shall be consumed within the shelf time.
- The temperature shall be set at "quick freezing" in the process of quick-freezing food

NOTE

Storage of too much food during operation after the initial connection to power may adversely affect the freezing effect of the refrigerator. Foods stored shall not block the air outlet; or otherwise the freezing effect will also be adversely affected.

2.6 FUNCTIONS

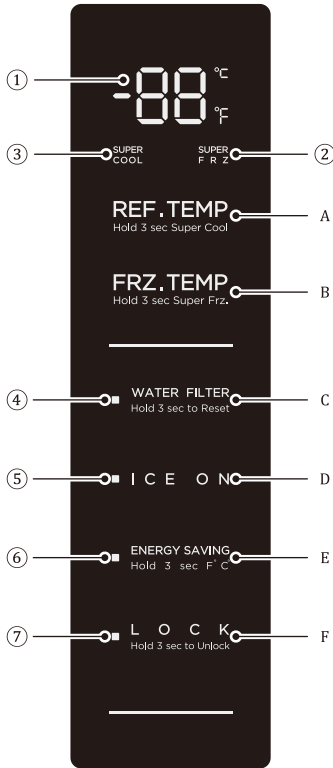

Display

- ① Refrigerating/freezing temperature diagram
- ② Quick freezing
- ③ Quick refrigerating
- ④ Filter time reset icon
- ⑤ Ice machine on/off icon
- ⑥ ENERGY SAVING mode icon
- ⑦ Lock/unlock icon
- ⑧ Whole ice mode icon
- ⑨ Water outlet mode icon
- ⑩ Crushed ice mode icon

TYPE A

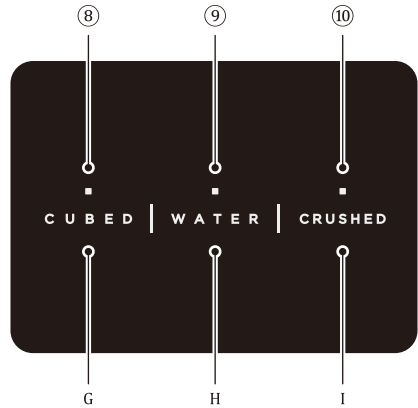

TYPE B

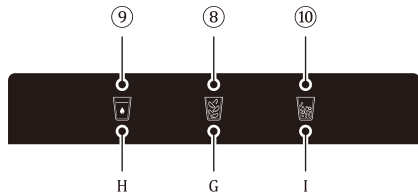

Button operation

- A. Refrigerating temperature adjustment
- B. Freezing temperature adjustment
- C. Filter time reset button
- D. Ice machine on/off control button
- E. ENERGY SAVING mode button
- F. Lock/unlock button
- G. Whole ice mode
- H. Water outlet mode
- I. Crushed ice mode

Operating instructions

- **Display**

Display control on the door

When the power is on for the first time, full display shall last for 3 seconds, the start-up tone shall sound at the same time and then enter into the normal operation display;

(When the power is on for the first time, the set temperature for the refrigerating chamber and freezing chamber is 39 Fahrenheit degree and 0 Fahrenheit degrees respectively, ice maker opens by default and the default temperature of the first power on is Fahrenheit).

The fault code shall be displayed when there is a fault (cyclic display); the set temperature of the refrigerating chamber shall be displayed when there is no fault.

Under normal circumstances, the display shall be locked after 30 seconds without door opening and button operation, and the display screen shall go off after 30 seconds in the locking state; when the display screen does not light up, the display screen shall normally light up when there is a button operation; When there is a fault of "fault code visible" type, the display shall light up and shall go out after 30 seconds.

Ice making display control

When the power is on for the first time, full display shall last for 3 seconds, then enter the normal operation display; (when the power is on for the first time, water outlet function is the default.)

When the communication between the distributor board and

the ice machine board fails, the indicator light of whole ice mode, the indicator light of water outlet mode and the indicator light of crushed ice mode shall flash at the same time. When there is no fault, the current state of distributor board shall be displayed;

- **Lock / unlock**

In the non-lock state, keep pressing the **L O C K** for 3 seconds to enter the lock state, the buzzer for lock shall sound and then the lock icon shall light up.

In the lock state, keep pressing the **L O C K** for 3 seconds to enter the lock state, the buzzer for unlock shall sound and then the lock icon shall go out.

It shall automatically enter the lock state when there is no button operation after 30 seconds.

The alarm sound release operation can be carried out in the lock state while all other button operations must be carried out in the non-lock state. An error beep prompt shall be given in case of operation in the lock state.

- **Mode setting**

Long press the **REF.TEMP** **3S** to set/cancel the quick refrigerating mode; long press the **FRZ.TEMP** **3S** to set/cancel the quick freezing mode; short press the **ENERGY SAVING** to set/cancel the **ENERGY SAVING** mode.

When the quick refrigerating mode is set, the refrigerating shall be automatically set to 1°C/34°F; when the quick freezing mode is exited, the set temperature in the refrigerating chamber shall be automatically restored to the set temperature before the quick refrigerating mode.

When the quick freezing mode is set, the freezing shall be automatically set to $-22^{\circ}\text{C}/-7^{\circ}\text{F}$; when the quick freezing mode is exited, the set temperature in the freezing chamber shall be automatically restored to the set temperature before the quick freezing mode.

When the ENERGY SAVING mode is set, the refrigerating shall be automatically set to $7^{\circ}\text{C}/44^{\circ}\text{F}$ while the freezing shall be automatically set to $-14^{\circ}\text{C}/7^{\circ}\text{F}$; when the ENERGY SAVING mode is exited, the set temperature in the refrigerating and freezing chamber shall be automatically restored to the set temperature before the ENERGY SAVING mode.

when the ENERGY SAVING mode setting is valid, the ENERGY SAVING indicator shall light up otherwise it shall go out.

* If the refrigerator is powered on, it shall remember the quick refrigerating/quick freezing, the chambers shall be restored to the default temperature after exiting;

- **Refrigerating chamber temperature setting**

Press the REF. TEMP
Hold 3 sec Super Cool to select the refrigerating temperature zone, and then press the REF. TEMP
Hold 3 sec Super Cool to adjust the refrigerating chamber temperature. Each time the refrigerating chamber button is pressed, the temperature shall drop $1^{\circ}\text{C} / 1^{\circ}\text{F}$; after the temperature reaches $1^{\circ}\text{C} / 34^{\circ}\text{F}$, press the REF. TEMP
Hold 3 sec Super Cool again and the refrigerating chamber setting range is $1-7^{\circ}\text{C} / 34-44^{\circ}\text{F}$; the setting is valid after locking;

- **Freezing chamber temperature setting**

Press the FRZ. TEMP
Hold 3 sec Super Frz to select the freezing temperature zone,

and then press the FRZ. TEMP
Hold 3 sec Super Frz to adjust the freezing chamber temperature. Each time the freezing chamber button is pressed, the temperature shall drop $1^{\circ}\text{C} / 1^{\circ}\text{F}$; after the temperature reaches $1^{\circ}\text{C} / 34^{\circ}\text{F}$, press the FRZ. TEMP
Hold 3 sec Super Frz again and the freezing chamber setting range is $1-7^{\circ}\text{C} / 34-44^{\circ}\text{F}$; the setting is valid after locking;

- **Distributor state setting**

Soft touch the button of corresponding mode to select whole ice mode/water outlet mode/crushed ice mode, and the corresponding mode indicator light shall light up after selecting the corresponding function; the setting shall take effect immediately with no locking required:

- **Distributor light control**

When the distributor switch is pressed, the distributor light is lit; and when the distributor switch is disconnected, the distributor light is delayed by 3 seconds to extinguish.

- **Conversion between Celsius and Fahrenheit**

Long press ENERGY SAVING
Hold 3 sec F °C for 3 seconds to achieve the conversion between Celsius and Fahrenheit.

- **Filter time reset**

The working time of the power-on filter accumulates. When the filter works for 150 days, the filter icon shall light up to prompt the user to replace the filter and shall flash to prompt the user to replace the filter after 180 days. Long press the WATER FILTER
Hold 3 sec to Reset for 3 seconds to perform the function of "FILTER RESET". At this time the filter timing shall be reset;

NOTE

The accumulative timing unit of filter working time is every 24 hours, and stored in EEPROM with power off memory function.

- **Ice machine mode**

Short press the ICE ON of the ice machine to set/cancel the function of ice machine; When the function setting of ice machine is effective, the indicator light of ice machine shall light up, otherwise it shall go off;

- **Power off storage**

When the power is cut off, the instantaneous working state shall be locked, which can be maintained to power-on;

- **Operation of door opening prompt and alarm control**

When the refrigerator door is open, a prompt tone shall sound. If it is not closed after 2 minutes, the buzzer shall sound, and shall sound once every second until the door is closed.

- **Fault indicator**

When the following prompt appears on the display screen, it indicates that the refrigerator is out of order. Although the refrigerating / freezing function of the refrigerator can still work in the following fault conditions, the user should contact the maintenance personnel to ensure the normal use of the refrigerator.

Fault Code	Fault Description
E0	Ice machine fault
E1	Fault of temperature sensor in refrigerating chamber
E2	Fault of temperature sensor in freezing chamber
E5	Fault of defrosting sensor in freezing chamber
E6	Communication fault of display board of main board
E7	Ambient temperature fault
EH	Temperature sensor fault
EE	Ice machine sensor fault
CA	Communication fault of ice making board of mainboard
EP	Ice making machine off-ice fault

2.7 FETCHING WATER AND ICE

- Sounds will be produced during making ice cubes and crushed ice: Water valve will produce buzzing sounds; water's flowing into ice vessel will produce sounds; grinding machine's grinding ice into small pieces or product ice's falling into the container will produce sounds. The sounds are normal.
- Scratching noises may be produced when taking out the ice cubes. Nothing to worry about this. The ice in the container may be stuck together. In such cases, please take out the ice container and separate stuck ice into pieces by means of, for instance, using plastic or wooden spoons to push hard on the ice carefully.
- Other possibilities are illustrated in the chapter "ice container cleaning". To avoid overheating of the ice-making machine's engine, please fetch ice about 1 minute after the stopping. Please wait for a while until the engine's temperature reaches working temperature. Please fetch the ice from the ice container if you need a lot of ice.
- The chapter "ice container cleaning" explains how to remove ice container from freezer compartment. If there is no enough ice in the ice container, the ice cannot be taken out. Please wait for a while until new ice is made. To prevent ice smell or bad taste of the ice, please clean the ice container regularly.
- Ice and water can only be fetched when the door of freezer compartment is closed. In the process of fetching water and ice, if you open the freezer door, that process will automatically end.
- When it displays  or  goes out, you click the buttons of water dispenser again.

TYPE A

- Fetching cold water

Keep pressing the buttons **W A T E R** until the indicator turns on.



Push the container in the direction of fetching water cushion, Cold water starts to flow into the container, remove the container from fetching water cushion and end the exporting of water.

- Fetching crushed ice

Keep pressing the buttons of **CRUSHED** until the signal turns up.

Make the container tight with mouth of water dispenser to prevent the side jet.

Press the container in the direction of fetching water cushion . Fill the container with crushed ice.

Remove the container from fetching water cushion and end the exporting of water.

- Fetching ice cubes

Keep pressing the buttons **c u b e d** until the signal lights up.

Push the container in the direction of fetching water cushion.

Ice cubes start to fall into the container.

Remove the container from fetching water cushion and end the exporting of ice.

TYPE B

- Fetching cold water

Keep pressing the buttons  until the indicator turns on.



Push the container in the direction of fetching water cushion, Cold water starts to flow into the container, remove the container from fetching water cushion and end the exporting of water.

- Fetching crushed ice

Keep pressing the buttons of  until the signal turns up.

Make the container tight with mouth of water dispenser to prevent the side jet.

Press the container in the direction of fetching water cushion . Fill the container with crushed ice.

Remove the container from fetching water cushion and end the exporting of water.

- Fetching ice cubes

Keep pressing the buttons  until the signal lights up.

Push the container in the direction of fetching water cushion.

Ice cubes start to fall into the container.

Remove the container from fetching water cushion and end the exporting of ice.

2.8 LEVELING FEET

- Precautions before operation:

Before operation of accessories, it shall be ensured that the refrigerator is disconnected from power.

Before adjusting the leveling feet, precautions shall be taken to prevent any personal injury.

- Schematic diagram of the leveling feet

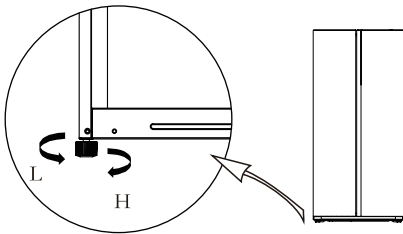

- Adjusting procedures:
 - a. Turn the feet clockwise to raise the refrigerator;
 - b. Turn the feet counterclockwise to lower the refrigerator;
 - c. Adjust the right and left feet based on the procedures above to a horizontal level.

The picture above is only for reference. The actual configuration will depend on the physical product or statement by the distributor

2.9 LEVELING DOOR

- Precautions before operation:

Before operation of accessories, it shall be ensured that the refrigerator is disconnected from power.

Before adjusting the door, precautions shall be taken to prevent any personal injury.

- Schematic diagram of leveling the door

List of tools to be provided by the user	
	wrench

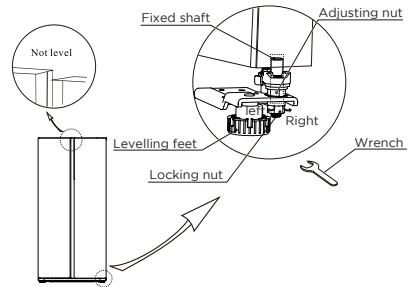

- Adjusting procedures:

Low refrigerating door:

First, turn the locking nut clockwise and loose, then turn the adjusting nut counter-clockwise to adjust, and lock the locking nut after adjusting;

High refrigerating door:

Turn the adjusting nut clockwise to adjust, adjust the locking nut counterclockwise and then lock.

The picture above is only for reference. The actual configuration will depend on the physical product or statement by the distributor

2.10 CONNECT TO WATER

- A cold water supply with water pressure of between 30 and 100 psi (207 and 689 kPa) is required to operate the water dispenser and ice maker. If you have questions about your water pressure, call a licensed, qualified plumber.

IMPORTANT:

- **Connect only to a drinking (potable) water supply.**
- **Plumbing shall be installed in accordance with the International Plumbing Code and any local codes and ordinances.**

- **Connect to Water Line**
Gather the required tools and parts before starting installation.
 - Flat-blade screwdriver
 - ½" Wrench or 2 Adjustable wrenches
 - Cordless drill
 - ¼" saddle-type shutoff valve(1)
 - ¼" Drill bit
 - ¼" Compression nut (2)
 - Ferrule (sleeve) (2)
 - ¼" Copper tube
- Find a ½" to 1¼" (12.7 mm to 31.8 mm) vertical cold water pipe near the refrigerator.
IMPORTANT: Make sure it is a cold water pipe.
NOTE: Horizontal pipe will work; however, you must drill on the top side of the pipe, not the bottom. Drilling on the top side will keep water away from the drill and keep normal sediment from collecting in the valve.
- Determine the length of copper tubing you need. Measure from the connection on the back of the refrigerator to the water pipe. Add 7 ft(2.1 m) to allow for cleaning.

Use ¼"(6.35 mm) O.D. (outside diameter) copper tubing. Be sure both ends of copper tubing are cut square.

- Using a cordless drill, drill a ¼" (6.35 mm) hole in the cold water pipe.
- Fasten the shutoff valve to the cold water pipe with the pipe clamp. Be sure the outlet end is solidly in the ¼" (6.35 mm) drilled hole in the water pipe and that the washer is under the pipe clamp.
- Tighten the packing nut. Tighten the pipe clamp screws slowly and evenly so the washer makes a watertight seal. Do not overtighten.
- Slip the compression sleeve and compression nut on the copper tubing as shown. Insert the end of the tubing into the outlet end squarely as far as it will go. Screw compression nut onto outlet end with adjustable wrench. Do not overtighten or you may crush the water line.
- Place the free end of the tubing in a container or sink, and then turn ON the main water supply. Flush the tubing until water is clear. Turn OFF the shutoff valve on the water pipe.

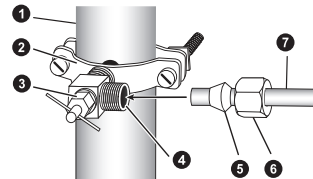

- | | |
|--------------------------|---------------------|
| 1. Household supply line | 5. Ferrule (sleeve) |
| 2. Saddle valve | 6. Compression nut |
| 3. Packing nut | 7. ¼" Copper tube |
| 4. Shutoff valve | |

Connect to Refrigerator

- 1. Unplug refrigerator or disconnect power.
- 2. Close shut-off valve.
- 3. Thread a brass compression nut and ferrule (sleeve) onto the free end of the copper tube.
- 4. Remove the plastic cap from the end of the refrigerator water line.
- 5. Insert the water line directly into the fitting on the end of the refrigerator water line. Tighten the compression nut. Do not overtighten.
- 6. Confirm connection is secure by gently pulling on the water line.
- 7. Turn on the water supply to refrigerator and check for leaks. Correct any leaks.

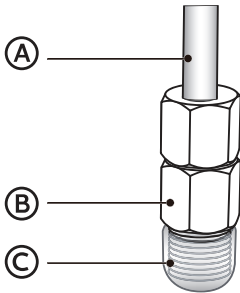

- A. Refrigerator water line
- B. Compression nut
- C. Plastic cap

Complete the installation

WARNING

Electrical shock hazard
Plug into a grounded 3 prong outlet.

- Do not use an adapter.
- Do not use an extension cord.
- Failure to do so can result in death, fire or electrical shock.
- Do not remove the ground prong from the power cord plug.

Plug into a grounded 3 prong outlet.
NOTE: This refrigerator begins operating as soon as it is connected to the power supply.
Move the refrigerator into its final location, making sure to maintain the recommended clearance.

3. MAINTENANCE OF REFRIGERATOR

3.1 OVERALL CLEANING

- Dust behind the refrigerator and on the floor must be cleaned to improve the cooling effect and energy saving.
- Check the door gasket regularly to make sure there is no debris. Clean the door gasket with a soft cloth dampened with soapy water or diluted detergent.
- The interior of the refrigerator should be cleaned regularly to avoid odors.
- Please turn off the power before cleaning the interior, remove all foods, drinks ,shelves, drawers, etc.
- Use a soft cloth or sponge to clean the inside of the refrigerator, with two tablespoons of baking soda and a quart of warm water. Then rinse with water and wipe clean. After cleaning, open the door and let it dry naturally before turning on the power.
- For areas that are difficult to clean inside the refrigerator (such as narrow places, gaps or corners), we recommend to wipe them regularly with a soft rag, soft brush, etc. and when necessary, with some tools (such as thin sticks) to ensure no contaminants or bacterial accumulation in these areas.
- Do not use soap, detergent, scrub powder, spray cleaner, etc., as these may cause odors inside the refrigerator or contaminat food.
- Clean the door tray, shelves and drawers with a soft cloth dampened with soapy water or diluted detergent. Dry with a soft cloth or dry naturally.
- Wipe the outer surface of the refrigerator with a soft cloth dampened with soapy water, detergent, etc., and then wipe dry.
- Do not use hard brushes, scouring pads, wire brushes, abrasives (such as toothpaste), organic solvents (such as alcohol, acetone, banana oil, etc.), boiling water, acid or alkaline items, which may damage the fridge surface and interior. Boiling water and organic solvents such as benzene may deform or damage plastic parts..
- Do not rinse directly with water or other liquids during cleaning to avoid short circuit or affect electrical insulation after immersion.



Please unplug the freezer for defrost and cleaning.

3.2 DEFROSTING

- The refrigerator is made based on the air-cooling principle and thus has automatic defrosting function. Frost formed due to change of season or temperature may also be manually removed by disconnection of the appliance from power supply or by wiping with a dry towel.

3.3 OUT OF OPERATION

- Power failure: In case of power failure, even if it is in summer, foods inside the appliance can be kept for several hours; during the power failure, the times of door opening shall be reduced, and no more fresh food shall be put into the appliance.
- Long-time nonuse: The appliance shall be unplugged and then cleaned; then the doors are left open to prevent odor.
- Moving: Before the refrigerator is moved, take all objects inside out, fix the glass partitions, vegetable holder, freezing chamber drawers and etc. with tape, and tighten the leveling feet; close the doors and seal them with tape. During moving, the appliance shall not be laid upside down or horizontally, or be vibrated; the inclination during movement shall be no more than 45°.

IMPORTANT:

The appliance shall run continuously once it is started. Generally, the operation of the appliance shall not be interrupted; otherwise the service life may be impaired

3.4 CLEANING OF GLASS SHELF

- As the innermost part of the refrigerator liner where contacting the shelves has a backstop, you shall raise the shelves upward, then you can be able to take it out.
- Adjust or clean the shelves according to your requirement.

Soft towels or sponge dipped in water and non-corrosive neutral detergents are suggested for cleaning. The freezer of shall be finally cleaned with clean water and dry cloth. Open the door for natural drying before the power is turned on.

Do not use hard brushes, clean steel balls, wire brushes, abrasives, such as toothpastes, organic solvents (such as alcohol, acetone, banana oil, etc.), boiling water, acid or alkaline items clean refrigerator considering that this may damage the fridge surface and interior.

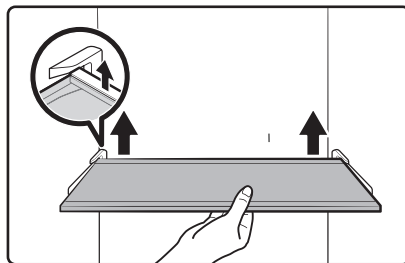

The picture above is only for reference. The actual configuration will depend on the physical product or statement by the distributor

3.5 CLEANING OF DOOR TRAY

- In order to conveniently take off tray, punch the bottom of right part of tray for several times and again punch the bottom of left part of tray for several times, as shown in the figure;
- Tray can be smoothly taken off after it has been loosened.

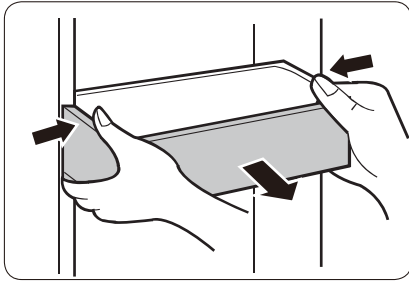

3.6 CLEAN THE ICE CONTAINER

- Ice in the ice container may block the outlet because of lumping or other reasons. In this case the ice container needs cleaning or eliminating block.

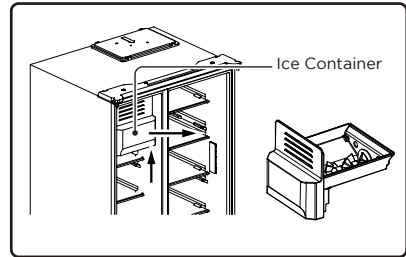

- Ice on lights go out, hold the ice storage box in both hands and pull it upwards and outwards horizontally.
- Clean as needed, and install it in the opposite direction that the ice storage box was taken down.
- Close the freezing chamber door

4. TROUBLE SHOOTING

The following simple issues can be handled by the user. Please call the after-sale service department if the issues are not solved.

Failed operation	<p>Check whether the appliance is connected to power or whether the plug is in well contact</p> <p>Check whether the voltage is too low</p> <p>Check whether there is a power failure or partial circuits have tripped</p>
Odor	<p>Odorous foods shall be tightly wrapped</p> <p>Check whether there is any rotten food</p> <p>Clean the inside of the refrigerator</p>
Long-time operation of the compressor	<p>Long operation of the refrigerator is normal in summer when the ambient temperature is high It is not suggestible having too much food in the appliance at the same time</p> <p>Food shall get cool before being put into the appliance</p> <p>The doors are opened too frequently</p>
Light fails to get lit	<p>Check whether the refrigerator is connected to power supply and whether the illuminating light is damaged</p> <p>Have the light replaced by a specialist</p>
Door can not be properly closed	<p>The door is stuck by food packages Too much food is placed</p> <p>The refrigerator is tilted.</p>
Loud noises	<p>Check whether the floor is level and whether the refrigerator is placed stably</p> <p>Check whether accessories are placed at proper locations</p>
Door seal fails to be tight	<p>Remove foreign matters on the door seal</p> <p>Heat the door seal and then cool it for restoration (or blow it with an electrical drier or use a hot towel for heating)</p>
Water pan overflows	<p>There is too much food in the chamber or food stored contains too much water,resulting in heavy defrosting</p> <p>The doors are not closed properly, resulting in frosting due to entry of air and increased water due to defrosting</p>
Hot housing	<p>Heat dissipation of the built-in condenser via the housing, which is normal</p> <p>When housing becomes hot due to high ambient temperature, storage of too much food or shutdown of the compressor is shut down, provide sound ventilation to facilitate heat dissipation</p>
Surface condensation	<p>Condensation on the exterior surface and door seals of the refrigerator is normal when the ambient humidity is too high. Just wipe the condensate with a clean towel.</p>
Abnormal noise	<p>Buzz: The compressor may produce buzzes during operation, and the buzzes are loud particularly upon start or stop. This is normal.</p> <p>Creak: Refrigerant flowing inside of the appliance may produce creak, which is normal.</p>

Criterion® Refrigerator Warranty

Your product is protected by this warranty:

Warranty service must be obtained from Midea Consumer Services or an authorized Midea servicer.

Warranty

- One year full warranty from original purchase date, includes compressor, parts and labor only.

Midea, through its authorized servicers will:

- Pay all costs for repairing or replacing parts of this appliance which prove to be defective in materials or workmanship.

Midea is not responsible for:

- Diagnostics, removal, transportation and reinstallation cost required because of service.
- Costs of service calls that are a result of items listed under **NORMAL RESPONSIBILITIES OF THE CONSUMER****

Midea replacement parts shall be used and will be warranted only for the period remaining on the original warranty.

NORMAL RESPONSIBILITIES OF THE CONSUMER**

This warranty applies only to products in ordinary household use, and the consumer is responsible for the items listed below:

1. Proper use of the appliance in accordance with instructions provided with the product.
2. Routine maintenance and cleaning necessary to keep the good working condition.
3. Proper installation by an authorized service professional in accordance with instructions provided with the appliance and in accordance with all local plumbing, electrical and / or gas codes.
4. Proper connection to a grounded power supply of sufficient voltage, replacement of blown fuses, repair of loosened connections or defects in house wiring.
5. Expenses for making the appliance accessible for servicing.
6. Damages to finish after installation.

EXCLUSIONS

This warranty does not cover the following:

1. Failure caused by damage to the unit while in your possession (other than damage caused by defect or malfunction), by its improper installation, or by unreasonable use of the product, including without limitation, failure to provide reasonable and necessary maintenance or to follow the written Installation and Operating Instructions.
2. Products purchased "as-is" or refurbished are not covered by this warranty.
3. Food loss caused by refrigerator or freezer failure.
4. Service calls to repair or replace consumables such as water filters, light bulbs air filters etc., or handles, knobs and other cosmetic parts.
5. Product that has been transferred from its original owner.
6. Interior or exterior rust on the unit.
7. Damages caused by services performed by persons other than authorized Midea servicers; use of parts other than Midea replacement parts; obtained from persons other than such Midea customer service; or external causes such as abuse, misuse, inadequate power supply or acts of God.
8. Service calls resulting from improper installation of your product.
9. Service calls to instruct you on the use of your product.
10. Surcharges including, but not limited to, any after hour, weekend, or holiday service calls, tolls, ferry trip charges, or mileage expense for service calls to remote areas, including the state of Alaska.
11. If the unit is put to commercial, business, rental, or other use or application other than for consumer use, we make no warranties, express or implied, including but not limited to, any implied warranty of merchantability or fitness for particular use or purpose.
12. Product that has been removed outside the USA or Canada.
13. Products without original serial numbers or products that have serial numbers which have been altered or cannot be readily determined.

Note: Some states do not allow the exclusion or limitation of incidental or consequential damages. So this limitation or exclusion may not apply to you.

IF YOU NEED SERVICE

Keep your bill of sale, delivery slip, and other appropriate payment record.

The date on the bill established the warranty period should service be required.

If service is performed, it is your best interest to obtain and keep all receipts.

This written warranty gives you specific legal rights. You may also have other rights that vary from state to state.

Service under this warranty must be obtained by following these steps, in order:

1. Contact Midea Consumer Services or an authorized Midea servicer at 1-866-646-4332
2. If there is a question as to where to obtain service, contact our consumer relations Department.

1-866-646-4332

Su producto está protegido por esta garantía:
Midea o por un representante autorizado de Midea.
Para comunicarse con un Representante de Servicio al Cliente, tenga la bondad de llamar por teléfono
sin cargo alguno a Midea, al número:
Su producto está garantizado por Midea. Cualquier obligación de proporcionar servicio o
reparos establecida en esta garantía deberá ser cumplida por los Servicios al consumidor de

Garantía

1-866-646-4332

Your product is protected by this warranty:
Midea Consumer Services or an authorized Midea service
representative. Call Midea TOLL FREE
to contact a Customer Service Representative.
Your appliance is warranted by Midea. Any obligations for services and parts under this warranty must

Product Warranty

Product Warranty Card
Tarjeta de Garantía de Producto



Criterion®



Postage
Required.
Post Office will
not deliver
without proper
postage.

PLACE
STAMP
HERE

Criterion®



Product Support
Midea America Corp.
759 Bloomfield Ave. # 386
West Caldwell, NJ 07006



Criterion®

CSBR260M4S