

User Manual

X10

Version: 1.0

1. Overview

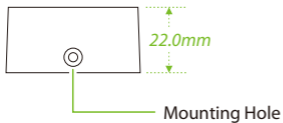
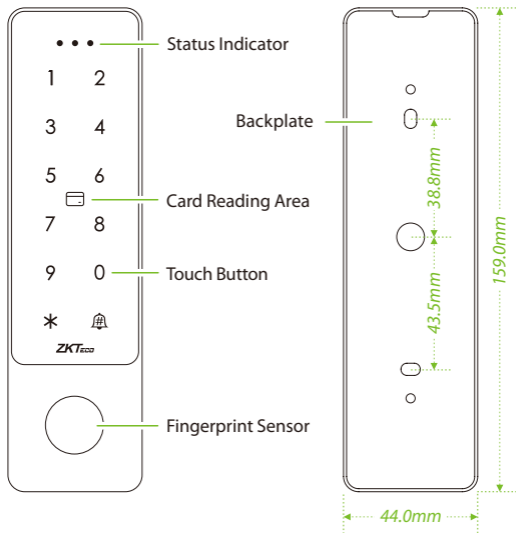

2. Device Installation

Install on the wall

- ① Attach the mounting template sticker to the wall, and drill holes according to the mounting paper.
- ② Fix the backplate on the wall with the wall mounting screws.
- ③ After passing the wires through the wiring hole and connecting them to the device, and then snap the device onto the backplate and push it down into place.
- ④ Fasten the device to the backplate with a security screw.

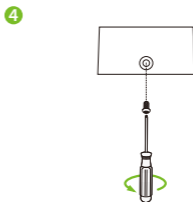
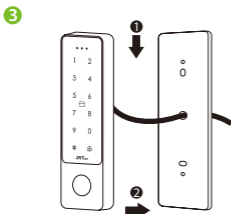
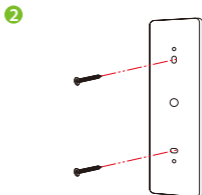
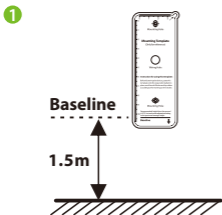

3. Terminal Block

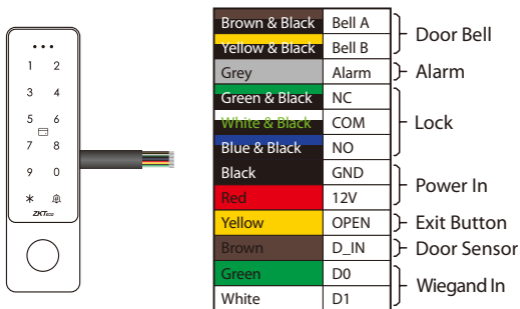

4. Configuration



5. Power Connection

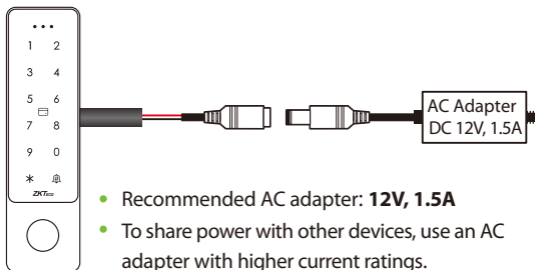

6. Exit Button, Door Sensor & Alarm Connection

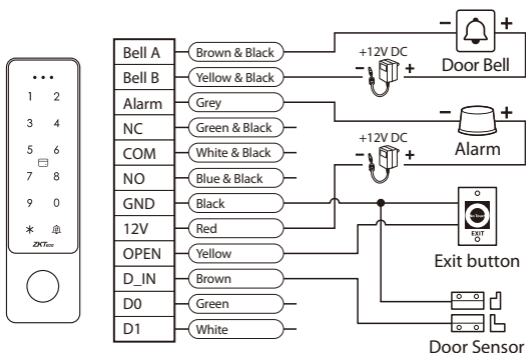

Note: Supports 24V DC, 1A max for 2-wire doorbells. Do not connect to AC power or exceed the specified load to prevent relay damage.

7. Lock Relay Connection

The system supports both **Normally Opened Lock** and **Normally Closed Lock**. The **NO LOCK** (normally opened at power on) is connected with '**NO**' and '**COM**' terminals, and the **NC LOCK** (normally closed at power on) is connected with '**NC**' and '**COM**' terminals. Take NC Lock as an example below:

 Do not reverse the polarity.

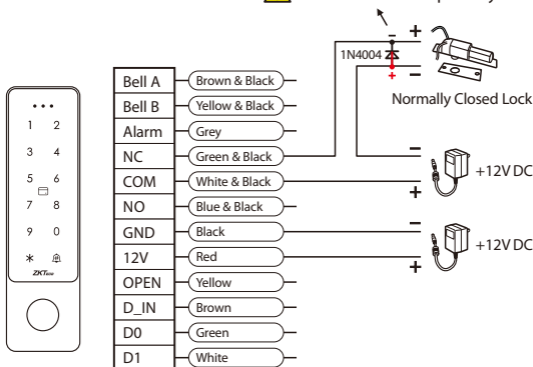

Note: Protection diode model: **1N4004**, standard configuration.

***Restore factory settings:** Power off the device. Then, connect the yellow wire (OPEN) to the black wire (GND). After 5 seconds, the device will emit a single beep. Disconnect the wires. The device will reset to factory defaults, and the administrator password will revert to the default password (123456).

Note: User data and the binding relationship between the X10 and the app will remain unchanged after the reset.

8. Wiegand Connection

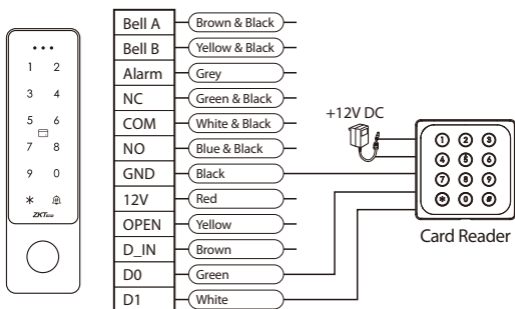

9. Indicator and Buzzer Instructions

Operating Status	Indicator Light	Buzzer
Standby Mode	Red steady	/
Valid Key Press	/	Beep —
Enter Programming	Red slow flash	Beep —
Enter Settings	Orange steady	Beep
Operation Error	/	Beep-beep-beep
Unlock	Green	Beep —
Alarm	Red fast flash	Alarm sound

10. Key Operation Instructions

● Enter administrator programming mode

Programming Step	Key Combination
Enter programming mode	* [Administrator Password] # (The factory default is 123456)
Exit programming mode	*

● Modify administrator password

Programming Step	Key Combination
Enter programming mode	* [Administrator Password] #
Initiate password change	0 [New Password #] [Repeat New Password #] (Password is 6-digit)
Exit programming mode	*

● Unlock time setting

Unlock time setting range: 1 to 100 seconds, factory default 5 seconds.

Programming Step	Key Combination
Enter programming mode	* [Administrator Password] #
Set unlock time	3 (1 - 100) #
Exit programming mode	*

● Alarm time setting

The factory default setting is 1 minute.

Programming Step	Key Combination
Enter programming mode	* [Administrator Password] #
Enter the alarm duration	5 (0 - 3 minutes) #
Exit programming mode	*

● Safe mode settings

Lockout Mode: If an invalid card or password is entered 10 times within 10 minutes, the machine will lock out for 10 minutes.

Alarm Mode: If an invalid card or password is entered 10 times within 10 minutes, the buzzer will sound an alarm.

Programming Step	Key Combination
Enter programming mode	* [Administrator Password] #
Disable Safe Mode	6 (0) # (Factory default)
Enable Lockout Mode	6 (1) #
Enable Alarm Mode	6 (2) #
Disable Door Sensor Alarm	6 (3) # (Default)
Enable Door Sensor Alarm	6 (4) #
Exit programming mode	*

● Indicator light and sound settings

The brown wire (D_IN) is the green light control line, and the yellow wire (OPEN) is the buzzer control line, which is active at a low level.

Programming Step	Key Combination
Enter programming mode	* [Administrator Password] #
Buzzer mute	7 (0) #
Turn buzzer volume on	7 (1) # (Default)
Turn off red light	7 (2) #
Turn on red light	7 (3) # (Default)
Turn off keypad light	7 (4) #
Turn on keypad light	7 (5) #
Keypad light turns off after 20 seconds	7 (6) # (Default)
Exit programming mode	*

● Alarm disarm method

When the machine triggers a tamper or door sensor alarm, enter the administrator password followed by #, or use a valid user card or password followed by # to disarm the alarm.

● Garbled code input instructions

Garbled code input only applies to 6-digit password entry for door opening. The total garbled code length must not exceed 10 digits. For example, if you set your password to **666666**, entering the garbled code 123**666666**9 on the device will still pass verification successfully.

11. Connect to ZKBio Zlink App

● Add Device

1. First, you must enter configuration mode on the device. Press * **[Admin Password]** # > **9** **[Admin Password]** #. The default admin password is **123456** and can be changed. For example: Press *123456#9123456#. The device beeps once.
2. Enable Bluetooth on your phone, then open the ZKBio Zlink App. Click **[Device]** > + icon > **[Bluetooth]** to connect the device via Bluetooth. The device will beep three times upon successful connection. (See diagram step 1, 2, 3)
3. In the list of detected devices, identify and add the device using its serial number. Click **[Connect]** to connect the device and configure Wi-Fi. (See diagram step 4,5)
4. Then from the list of searched Wi-Fi networks, select the one you want to connect to and click **[Confirm]**. After entering the password, click **[Connect to this network]**. (See diagram step 6,7,8)

5. Enter the device name and specify the device to a site. Click **[Complete]**. A “Added successfully” prompt will appear simultaneously. (See diagram step 9)
6. Once successfully added, the device is displayed in the list of the device interface. Click **[Detailed Settings]/[Set Later]** to enter the corresponding interface. (See diagram step 10,11)

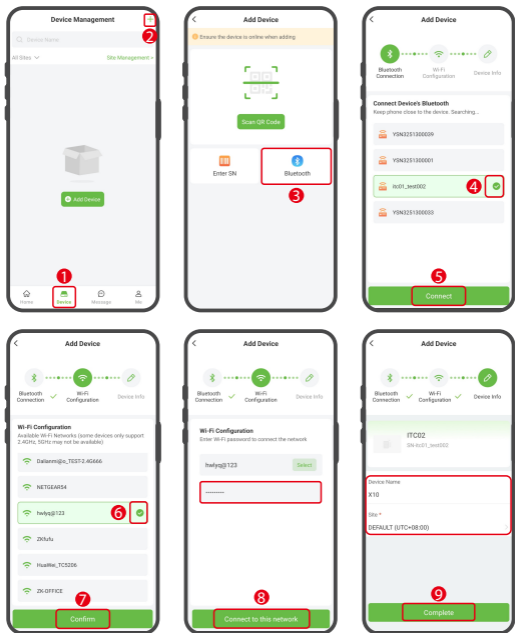

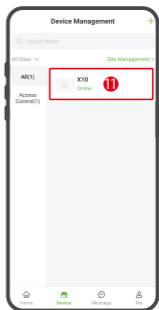
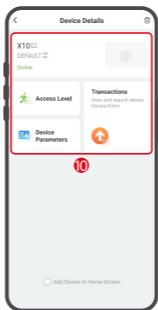
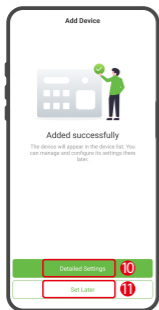

● Add Person & Department

In the bottom menu of the app, click [Me] > [Person & Department] > [Add Person]. You may choose to add either QR Code or Manually Add. Then, in the Add Person screen, enter the person's details. (See diagram step 1,2,3,4)

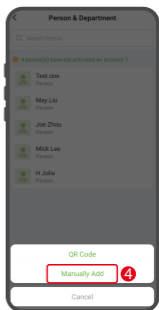
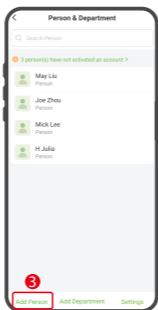
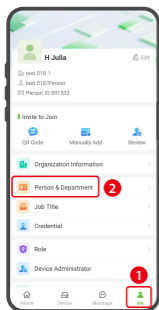

● Set Access Levels

1. Click [**Device**] to enter the Device Management interface. And select the device from the list. (See diagram step 1,2)
2. Then click [**Access Level**] to enter the Access Level interface. Click the + icon in the upper-right corner to add an access level. (See diagram step 3,4)
3. Set the name, select the device, time slot, persons, and click [**Save**] to synchronize the access level to the device. (See diagram step 5)

Note: There is a default timeslot named 24-hour access in the system.

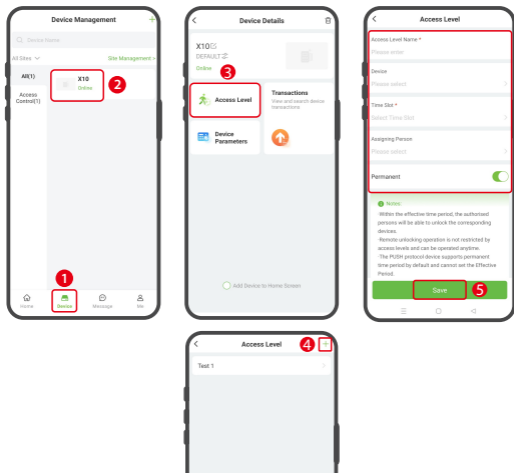

● Register Verification Mode

Once you have added persons to the device, you can register verification modes to them.

Register Fingerprint:

1. Click [**Me**] > [**Credential**] to enter the Credential screen, select the person who needs to register verification mode. (See diagram step 1,2,3)
2. On the details screen, click the  icon > [**Register Fingerprint**], then select the device and fingerprint you want to register. When you select the device to be registered, it will beep. After hearing the beep, tap the scanner three times. (See diagram step 4,5,6,7,8)
3. Once complete, tap [**Confirm**]. Registered fingerprints will appear in green on the screen. And you can repeat the above operation to register other fingers. (See diagram step 9)

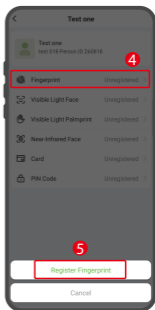
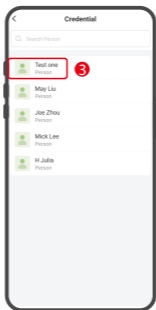
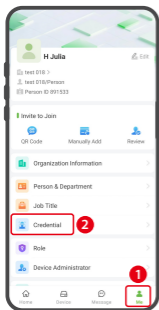

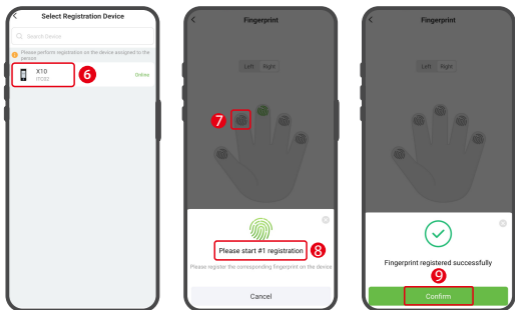

Register Card:

1. Click **[Me]** > **[Credential]** to enter the Credential screen, select the person who needs to register verification mode. (See diagram step 1,2,3)
2. On the details screen, click the  icon. You can select Register on Device or Manually Enter Card Number. If you want to register on device, then click **[Register on Device]**. (See diagram step 4,5,6,7,8)
3. When selecting a device for registration, the device will illuminate a green light and emit a beep. Place the card in the swipe area. The final beep indicates successful card registration.
4. Click **[Complete]** to return. (See diagram step 9)

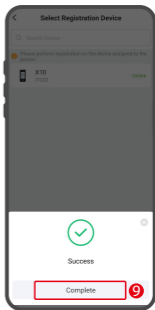
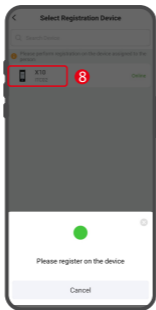
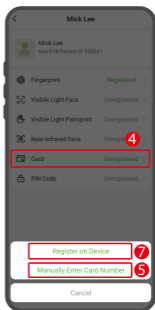
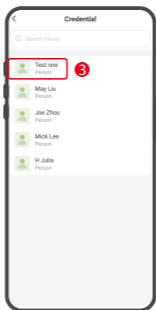
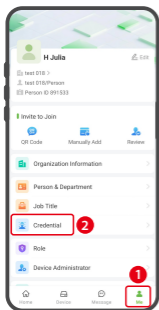

Register Password:

On the details screen, click the  icon > **[PIN Code]**, enter the password in the pop-up window, and then click **[Complete]**. The device will beep three times to indicate successful registration. For more detailed information, please refer to the relevant software user manual.

● View Records

Employee access records can be viewed in the **[Transactions]** section of the device details interface.

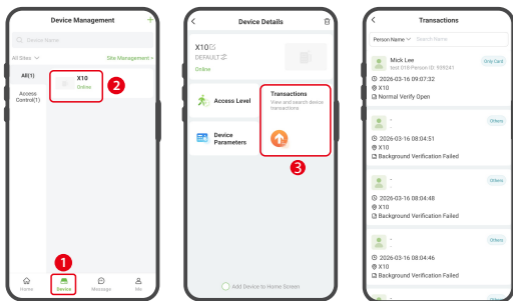

● Remote Opening

Click **[Home]** > **[Access Control]** > **[Remote Opening]**, then click the  icon to remotely unlock the door. After the door opens, a success message will appear on the screen.

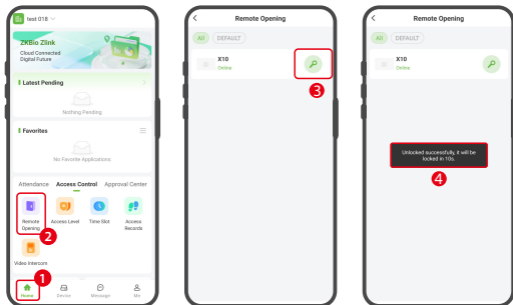

ZKTeco Industrial Park, No. 32, Industrial Road,
Tangxia Town, Dongguan, China.

Phone : +86 769 - 82109991

Fax : +86 755 - 89602394

www.zkteco.com

