



**We love that you are rocking JLab!  
We take pride in our products and fully stand behind them.**

JLAB  
OPEN SPORT  
EARBUDS



**YOUR WARRANTY**

All warranty claims are subject to JLab authorization and at our sole discretion. Retain your proof of purchase to ensure warranty coverage.



**CONTACT US**

Reach out to us at [support@jlab.com](mailto:support@jlab.com) or visit [jlab.com/contact](http://jlab.com/contact)

**REGISTER TODAY**

[jlab.com/register](http://jlab.com/register)

[Product updates](#) | [How-to tips](#)  
[FAQs & more](#)

**PAIR UP**

- 1 Take out of the case and remove stickers. Place them back in the case.

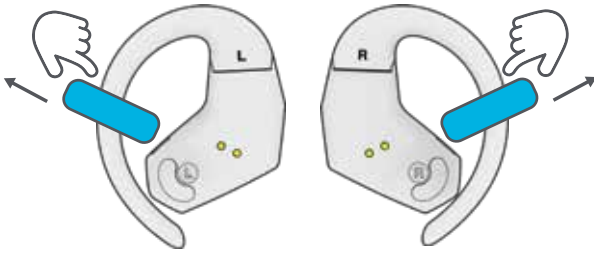

- 2 Blue lights on case indicates charging. Remove earbuds from case.

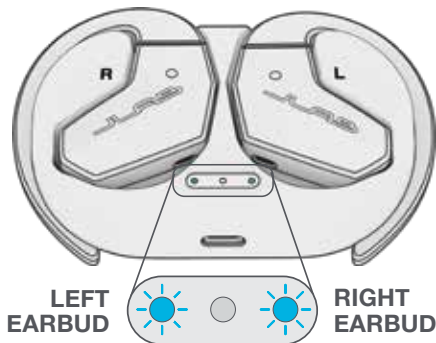

- 3 One will blink blue/white indicating ready to pair to your device. Select "JLab Open Sport" in your device's Bluetooth settings.

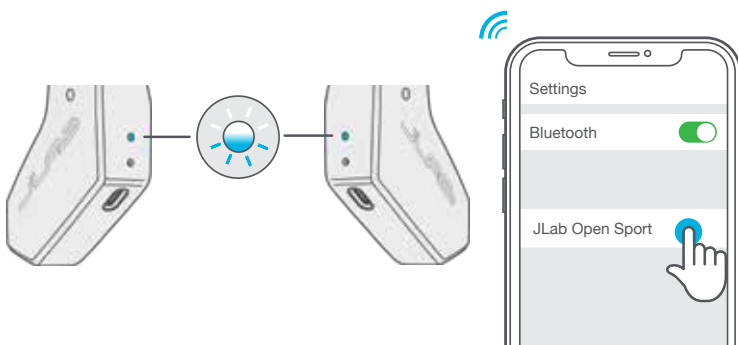

**ADDING NEW / ADDITIONAL BLUETOOTH DEVICES:**

**Turn OFF Bluetooth** from any previously connected device.  
**Turn ON Bluetooth** from new device.

Earbuds will automatically enter Bluetooth Pairing.

Select "JLab Open Sport" in new device settings to connect.

## GO AHEAD, PRESS THE BUTTON

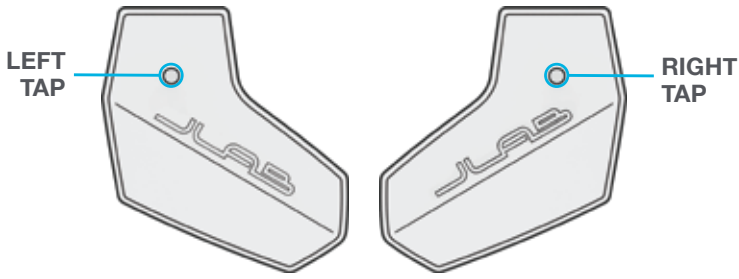

**VOLUME DOWN:** 1x Tap  
**SIRI (iOS) or "OK GOOGLE" (ANDROID):** 2x Tap

**TRACK BACK:**  
Press and hold 1+ sec

**SWITCH EQ:**  
3x Tap (Switch JLab Signature/Balanced)

**VOLUME UP:** 1x Tap

**ANSWER:** 2x Tap

**HANG UP:** 2x Tap

**REJECT INCOMING CALLS:**  
Press and hold 1+ sec

**PLAY / PAUSE:** 2x Tap

**TRACK FORWARD:**  
Press & hold 1+ sec

**SWITCH EQ:** 3x Tap  
(Switch JLab Signature/Balanced)

**TURN OFF WITHOUT CASE:** Turn off Bluetooth from device settings. JLab Open Sport will power off after 3 minutes.

## CUSTOM EQ SOUND MODES

Tap either the right or left earbud 3 times for different EQ settings (Open Sport will cycle 2 EQ settings).

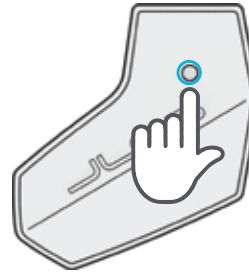

### JLab SIGNATURE

JLab C3™ signature sound with amplified bass and vocals



### BALANCED

Even sound with no additional enhancements

## FITTING WITH FRAMES

- 1 Slide ear hooks sideways to remove.



- 2 Remove the clips from the bottom of the charging case and slide on each Open Sport.

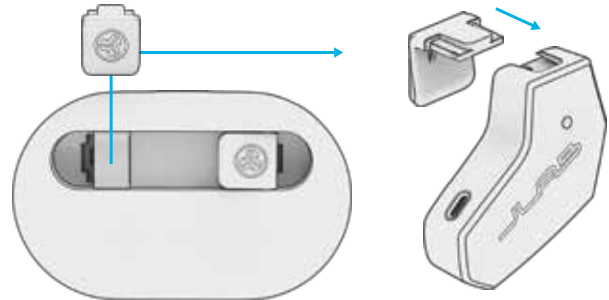

- 3 Slip over frames and adjust the clip tension by pinching in while on frames.

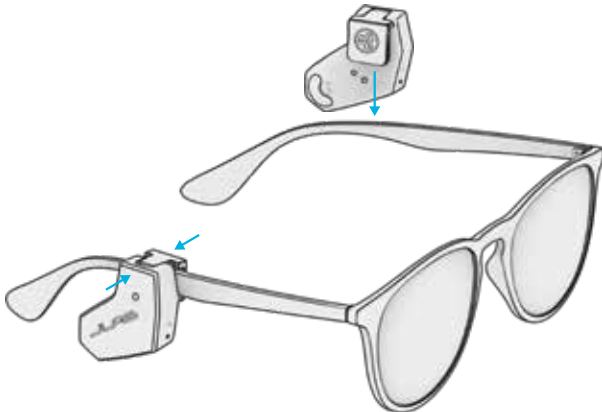

- 4 While wearing, move Open Sport closest to ear for best performance.

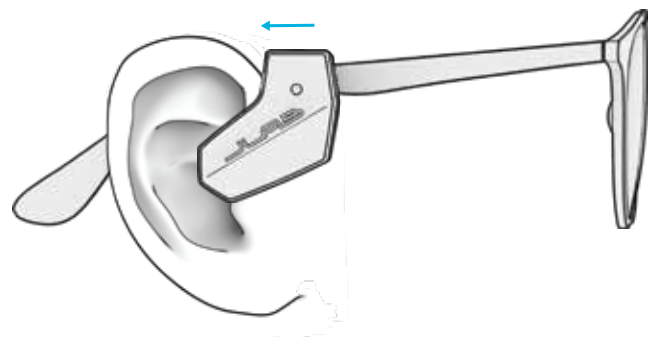

## FITTING WITH HOOKS

- 1 Bend and form the hook to desired preference.



- 2 Place hook behind ear and move back toward ear.

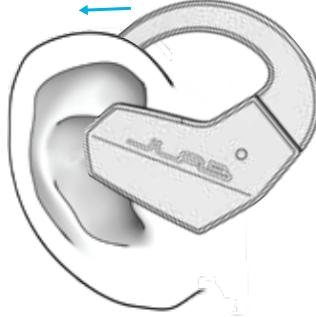

- 3 Rotate and adjust for best fit.



## GET CHARGED (EARBUDS)

Placing in the charging case will auto power OFF and start charging.

**Blue lights** will indicate earbuds are charging and will turn OFF when fully charged.

Removing the earbuds will auto power ON and connect to last device.

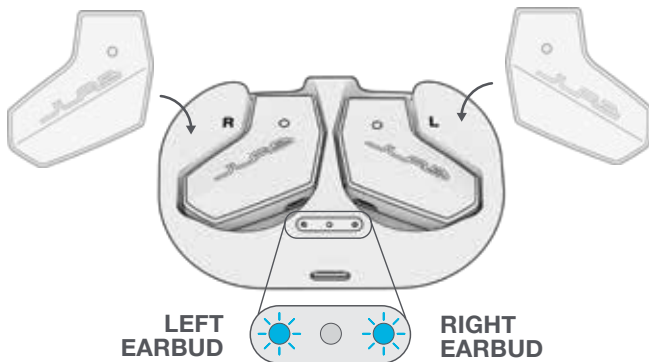

## GET CHARGED (CASE)

Connect included USB-C cable to charge.

LEDs **pulse white** when charging and **turn solid white** when fully charged.

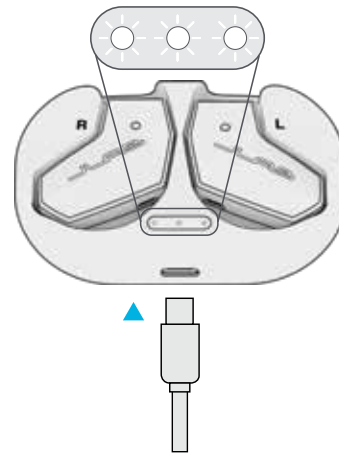

## MULTIPOINT (connect 2 devices simultaneously)

- 1 Once **FIRST** device is connected, turn off Bluetooth in device settings. JLab Open Sport will auto enter Bluetooth Pairing.

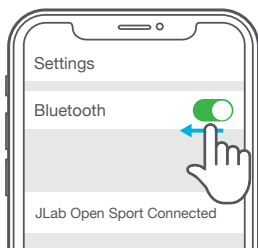
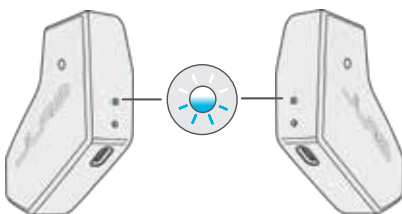

- 2 Enter your **SECOND** device Bluetooth settings and connect to JLab Open Sport.

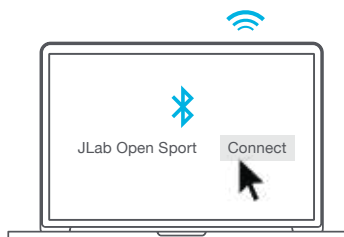
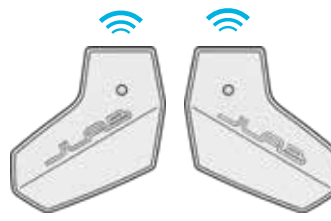

- 3 Enter your **FIRST** device Bluetooth settings. Turn on Bluetooth and connect to JLab Open Sport.

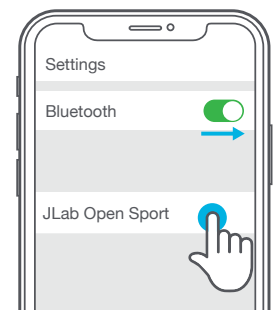

## TROUBLESHOOTING

### NO AUDIO IN ONE EARBUD OR EARBUDS DISCONNECTED (MANUAL RESET)

- 1 Keep earbuds in the charging case and forget "JLab Open Sport" in your Bluetooth device settings.

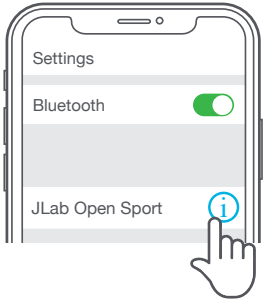

- 2 Quick tap 7x on one earbud in charging case.



- 3 Quick tap 7x on other earbud in charging case.

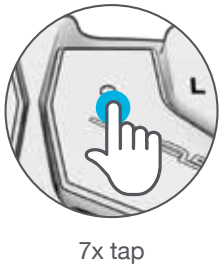

- 4 Take both earbuds out of the charging case. One earbud will blink blue/white indicating ready to pair to your device.

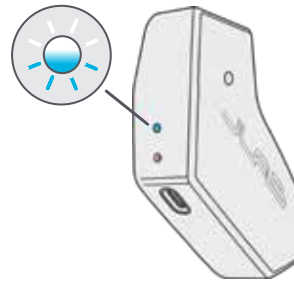

Instructional videos at: [JLAB.COM/MANUALS](https://www.jlab.com/manuals)

## CAUTIONS

- Avoid extreme heat, cold, and humidity.
- Avoid dropping or crushing the earbuds.
- Wax may build up in the earbud tips, lowering the sound quality. Carefully remove the wax with a cotton swab or other small tool to improve the sound quality.
- If you experience discomfort or pain, try lowering the volume or discontinuing use temporarily.
- If you experience regular discomfort while using this product, discontinue use and consult your physician.
- We recommend you treat your earbuds as you would a nice pair of sunglasses and keep them in safe location when not in use.



[Shop products](#) | [Product alerts](#) | [Burn-in your headphones](#)

JLab Store + Burn-in Tool

