

# TECKNET

## Smart Door Lock

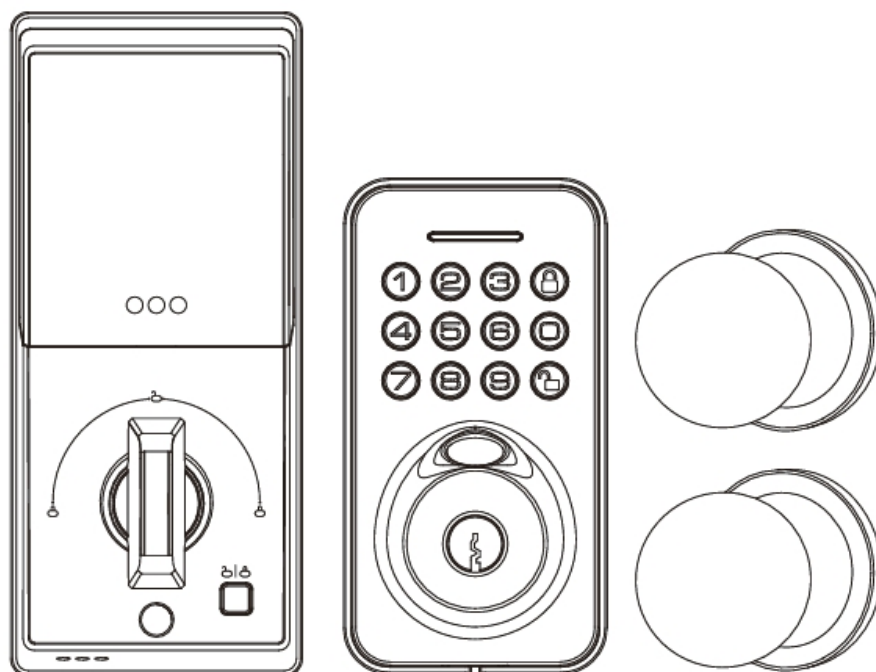

Model: E03-F

## User Manual

---

EN

---

# CONTENT

◆ Package Contents .....	01
◆ Product Overview .....	03
◆ Specifications .....	04
◆ Product Features .....	04
◆ Install Smart Lock .....	05
◆ Install Handle Set .....	10
◆ Operation Instructions .....	13
◆ App Instructions .....	14
◆ Troubleshooting .....	23
◆ FAQs .....	24

Thank you for purchasing TECKNET smart door lock. Please read this User Manual thoroughly before use of the product and retain it for future reference. If you have any problem using this product, please contact us by email at [support@ylinksworld.com](mailto:support@ylinksworld.com).

## Package Contents

### (1) Smart Lock Set

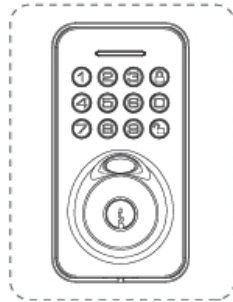

Front Panel

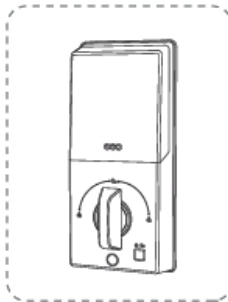

Back Panel

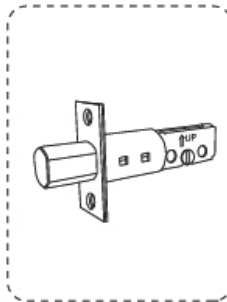

Deadbolt

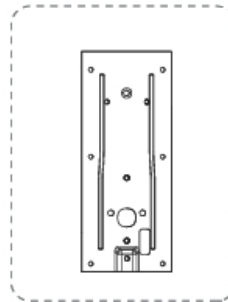

Mounting Plate

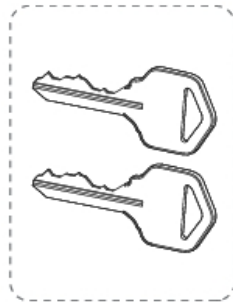

Keys

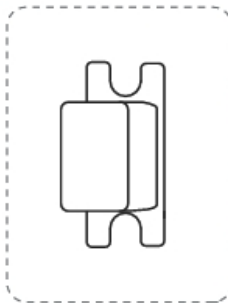

Long Strike Cover

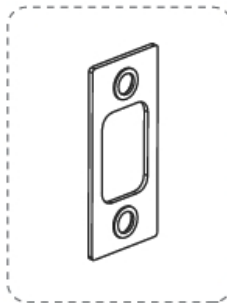

Strike Plate

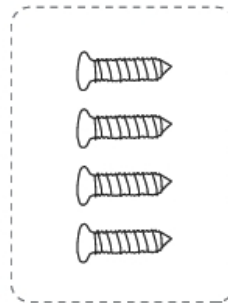

Bolt/Strike Screws

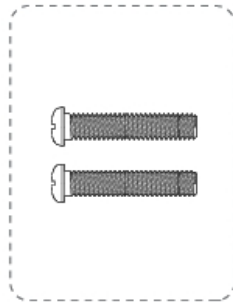

Mounting Plate Screws  
(Short, 35mm < door  
thickness < 45mm)

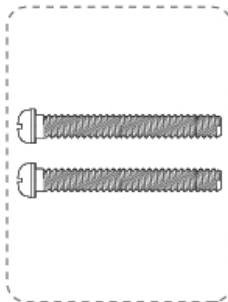

Mounting Plate Screws  
(Long, 45mm < door  
thickness < 55mm)

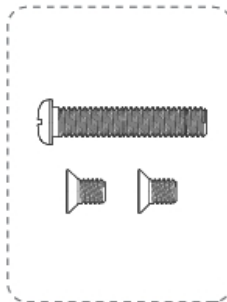

Back Panel  
Screws

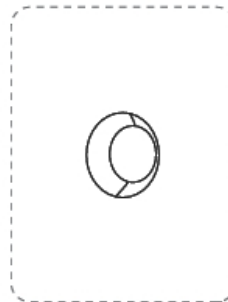

Back Panel  
Screw Cap

**(2) Handle Lock Set**

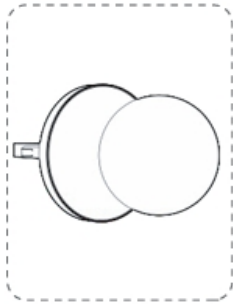

**Front Handle**

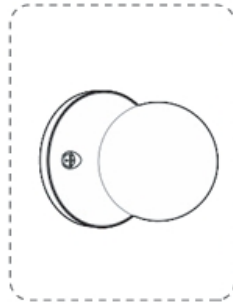

**Interior Handle**

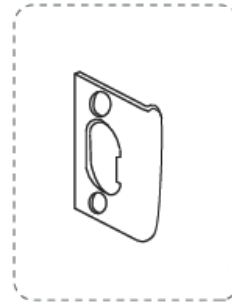

**D-shape Strike**

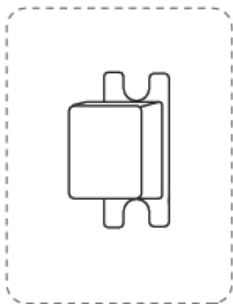

**Short Strike Cover**

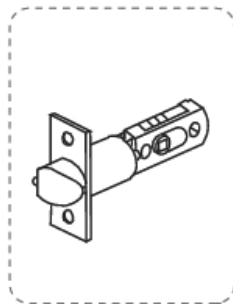

**Latch Bolt**

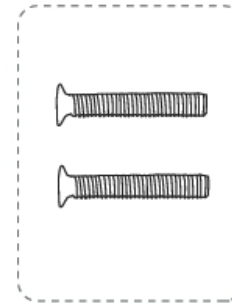

**Handle Screws**

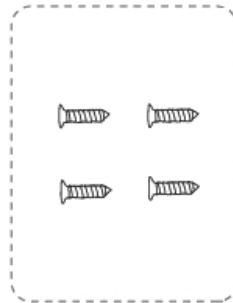

**Bolt/Strike Screws**



## Product Overview

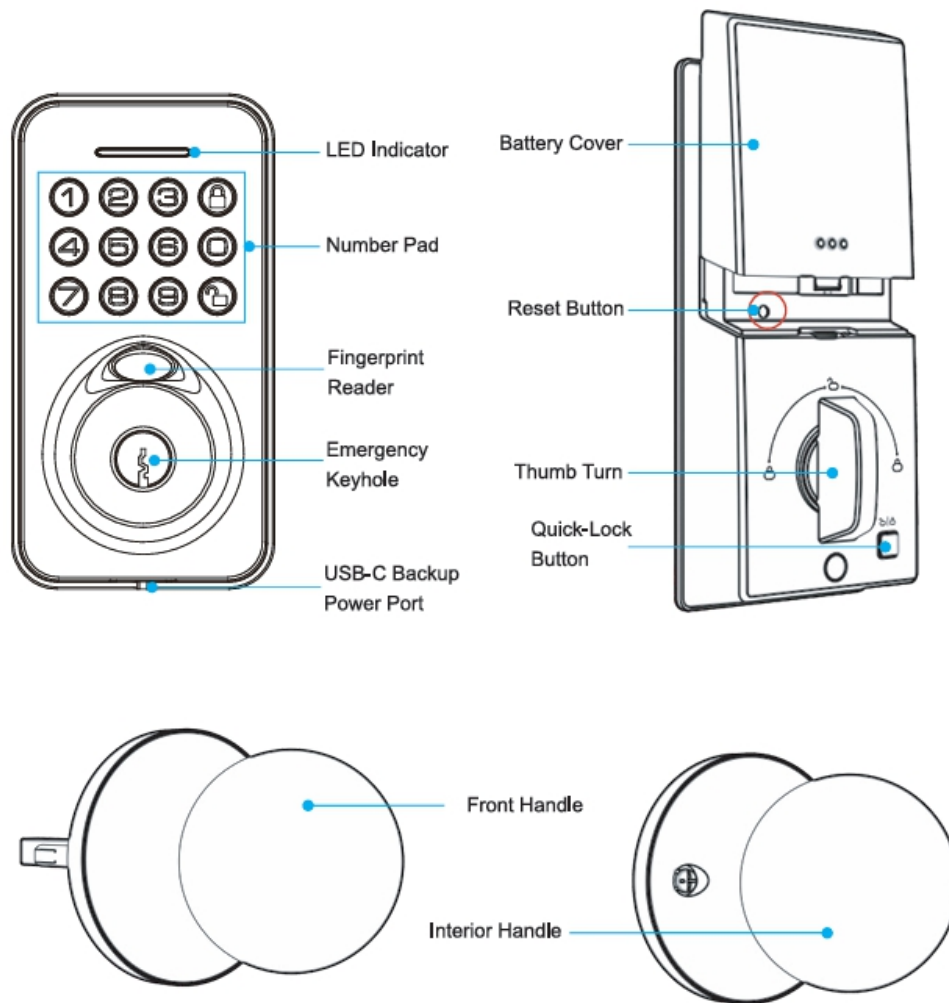

EN-03

## Specifications

Power Supply:	4 AA batteries (not included)
Operating Temperature:	-4°F~122°F
Operating Humidity:	0%~95%
Password Storage Capacity:	50
Fingerprint Storage Capacity:	50
APP Password Capacity:	No limits

## Product Features



Fingerprint

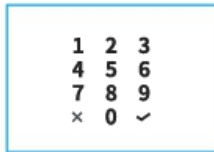

Password



APP



Key



Temporary Code



Auto-lock



Low Battery Alert

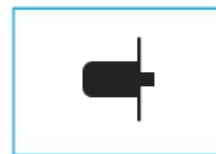

Standard Cylinder

# Install Smart Lock

## (1) Installation Overview



## (2) Check Door Measurement

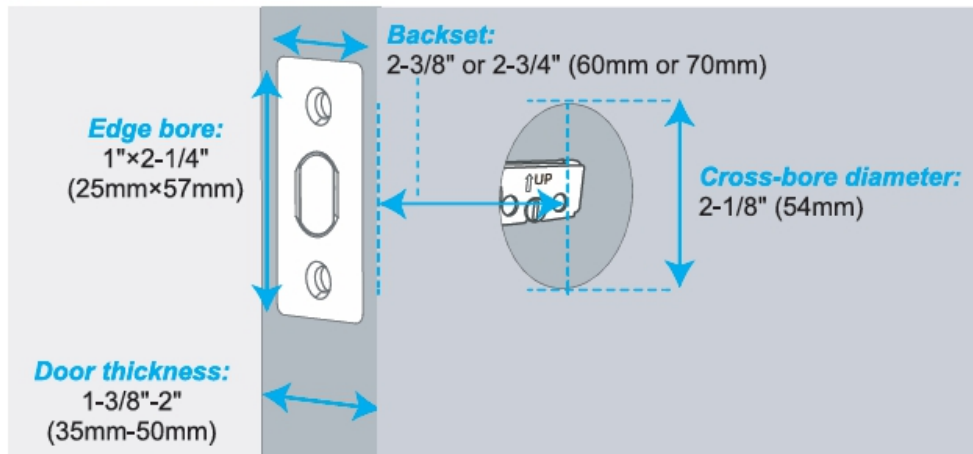

**Note:** Please refer to the template to drill holes if your door has no pre-drilled holes.

EN-05

### (3) Install Deadbolt and Strike Plate

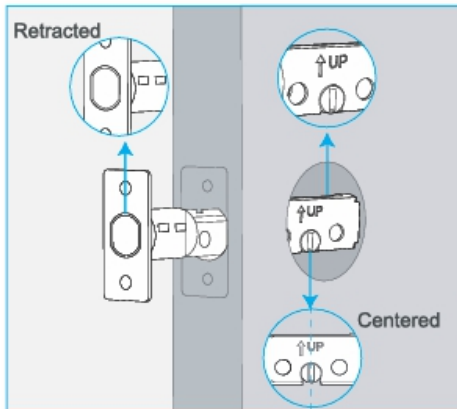

**A.** Insert the deadbolt. Ensure the spindle slot is centered at the cross bore. The bolt must be retracted (unlocked), and "UP" is oriented upward. Secure with the relevant screws.

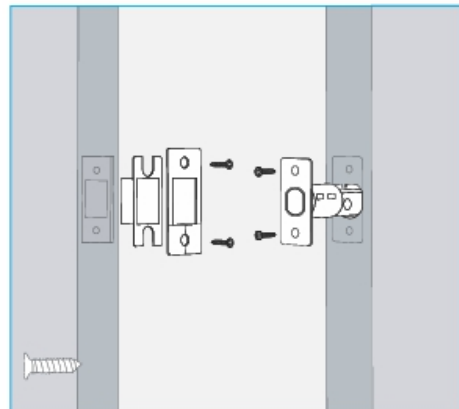

**B.** Install the Strike Plate and Long Strike Cover onto the door frame, then secure with the relevant screws.

#### Note:

The default deadbolt length is 2-3/8". If the spindle slot is not centered, twist the deadbolt to extend it to 2-3/4", then twist back into place.

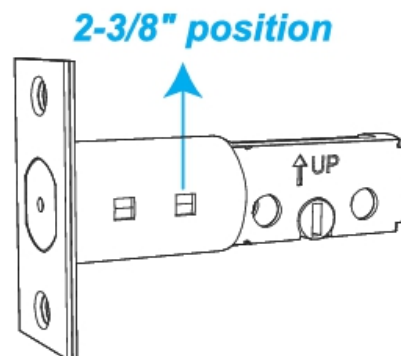
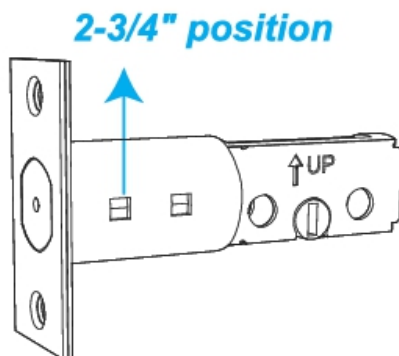

**(4) Install the Front Panel**

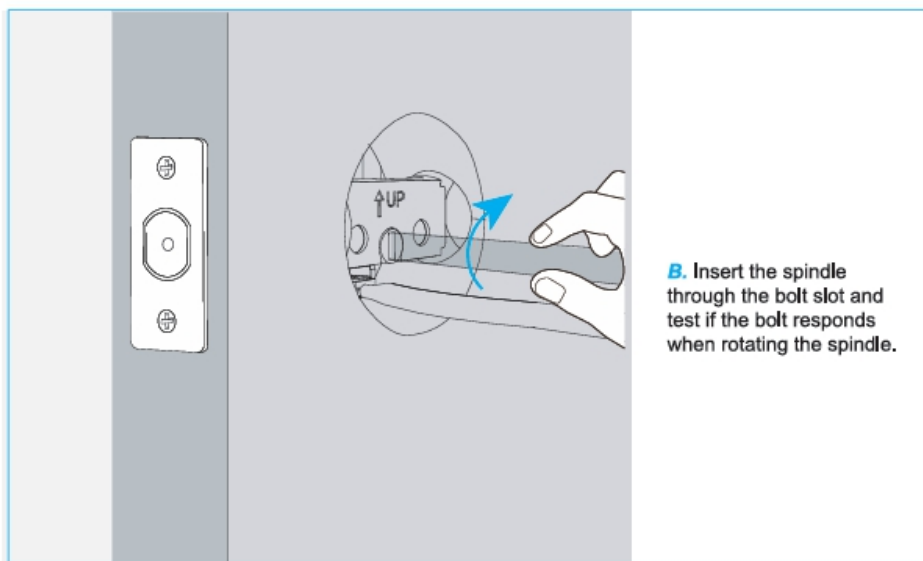
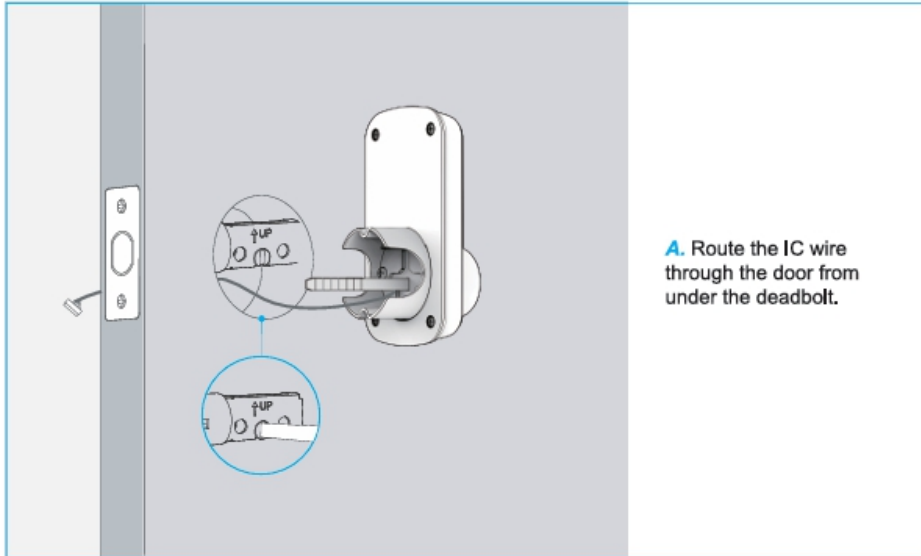

**Note:**  
During installation, ensure the deadbolt is retracted and do not insert the key.

**(5) Install the Back Panel**

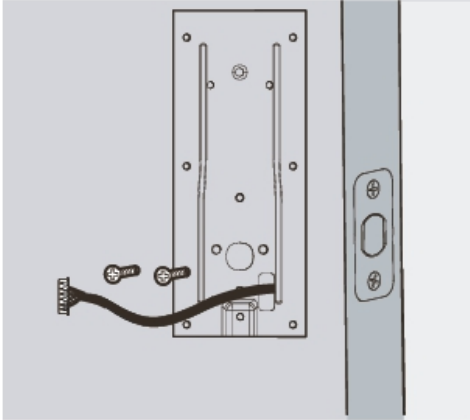

**A.** Route the IC wire through the hole at the bottom of the mounting plate. Secure the mounting plate with screws.

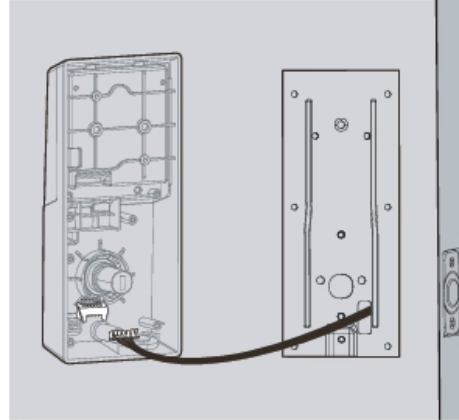

**B.** Connect the IC wire to the connector, then tuck the excess wire inside the door lock's mounting cavity (behind the mounting plate).

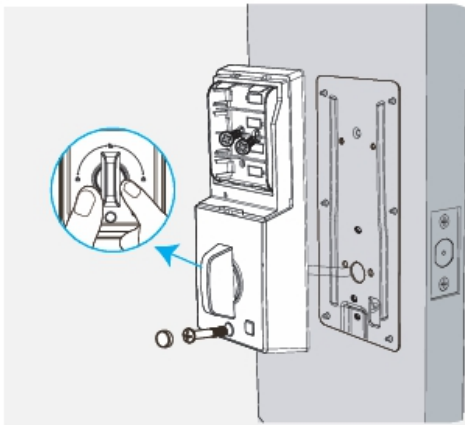

**C.** Install the back panel, ensuring the thumb turn is in the unlock position, and secure it with screws.

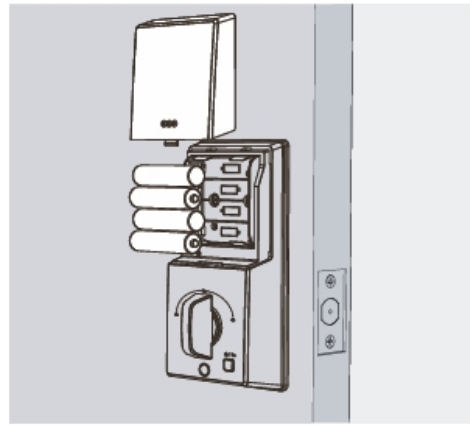

**D.** Install the batteries and cover.

**(6) Test Before Use**

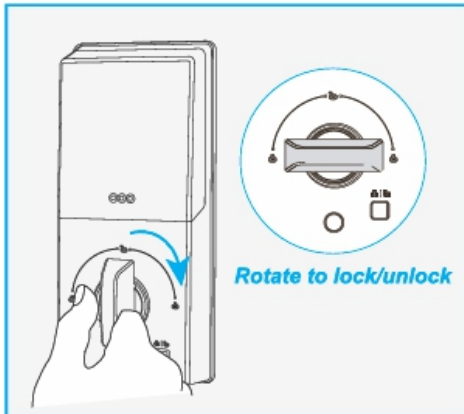

1. Turn the thumb turn to lock/unlock.

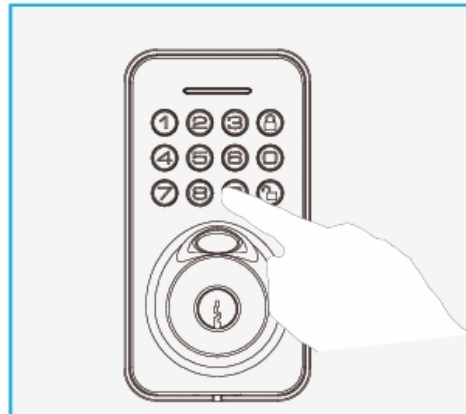

2. Enter the default user code 123456 and use the unlock key to check the password unlock function.



3. Use any fingerprint to test the fingerprint unlock function.

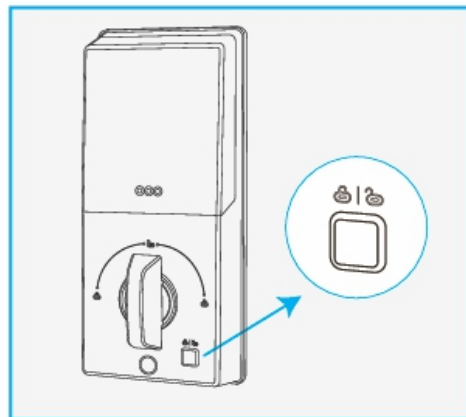

4. Press the Quick-lock button to lock/unlock.

## Install Handle Set

### (1) Installation Overview

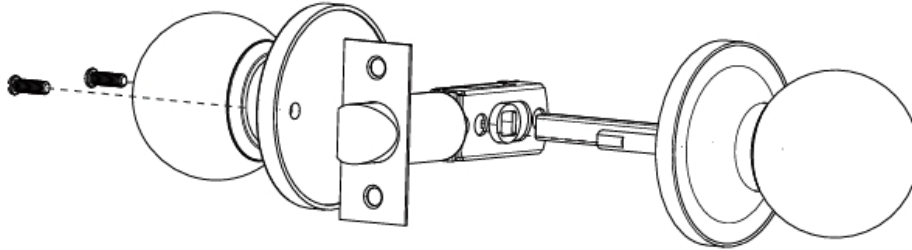

### (2) Check Door Dimension and Drill Holes

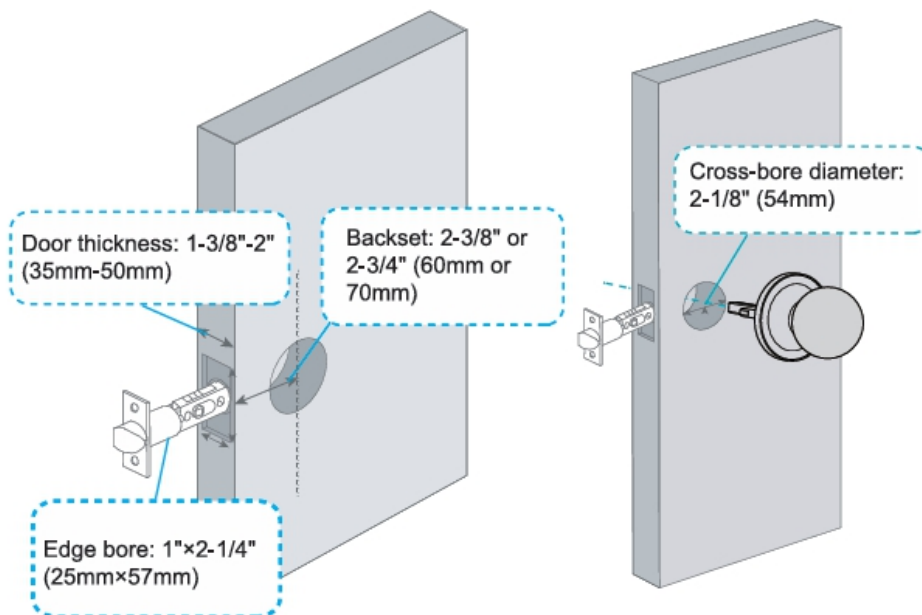

EN-10

**(3) Install Latch Bolt and Strike Plate**

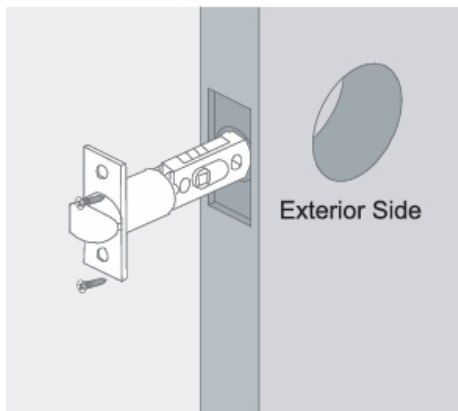

**A.** Insert the latch. Ensure the cam (spindle slot) is centered at the cross bore, then secure with the relevant screws.

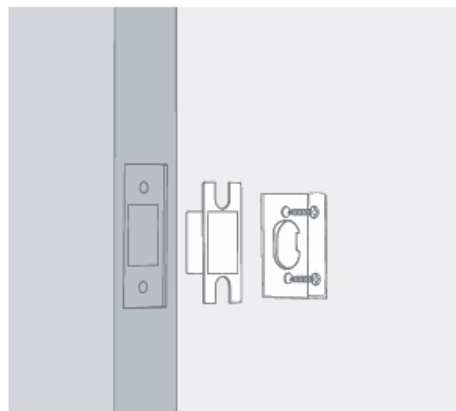

**B.** Install the D-shape strike and short strike cover onto the door frame, then secure with the relevant screws.

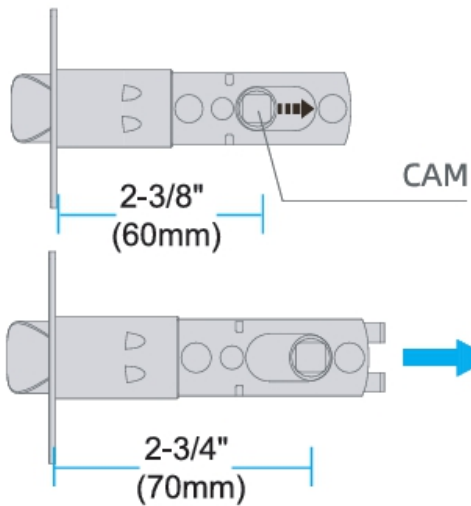

**CORRECT**

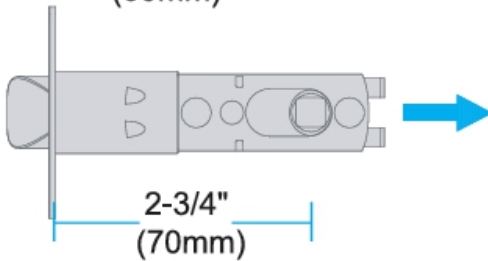

**INCORRECT**

**Note:**

The default latch bolt length is 2-3/8". If the cam is not centered in the cross bore, extend it to 2-3/4". Ensure the cam is horizontally positioned.

**(4) Install the Door Handle**

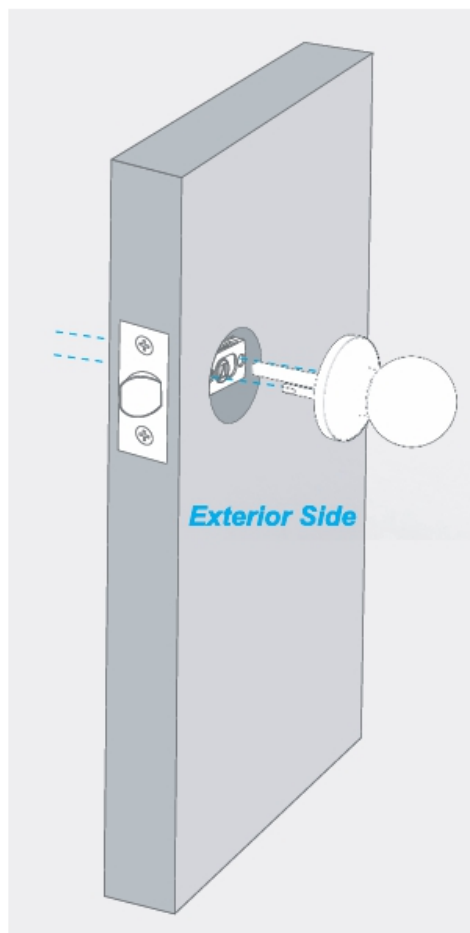

**A.** Install the front handle and interior handle, ensuring the spindle is correctly positioned through the cam.

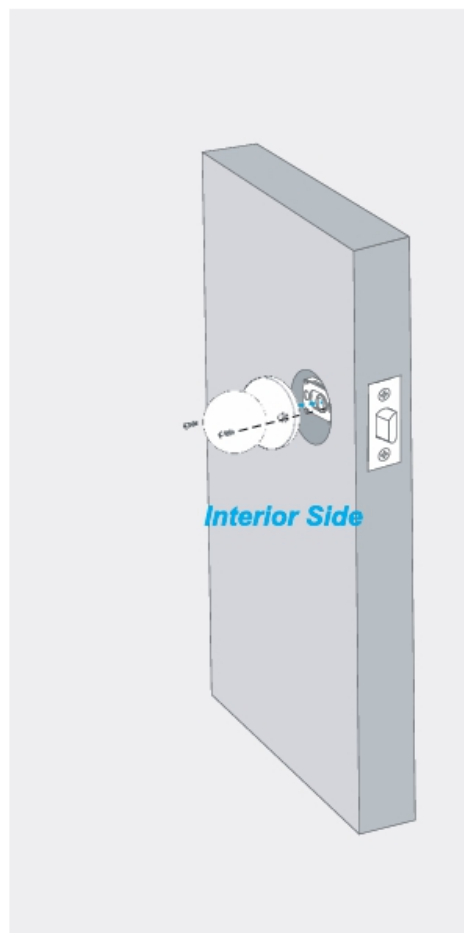

**B.** Manually rotate the screws to the appropriate position, then fix the handle with a screwdriver.

## Operation Instructions

### (1) Reset the Lock

Press and hold the reset button until you hear 6 beeps. The factory settings will be restored. All passwords and fingerprints will be removed, and BT pairing will be reset.

### (2) Add the First Administrator Password

**A.** Press the reset button. The lock will prompt: "Add administrator, please enter a new password."

**B.** Enter a 6–10-digit password, then press " " on the number pad to confirm. The lock will prompt: "Please enter the new password again."

**C.** Re-enter the password and press " " to confirm. If input correctly, the lock will prompt: "Added successfully, number 000" with a green light on, and the administrator will be added. If you hear 3 beeps with a red light on, the operation failed, and you need to repeat these steps.

#### Note:

You can add up to 3 administrator passwords or fingerprints. The first 3 added will be set as administrator access and used to verify admin status when adding new users.

### (3) Add a User

**A.** Press the reset button. The lock will prompt: "Add a user, authentication administrator."

**B.** Enter a previously added administrator password or fingerprint. The lock will prompt: "Add a user/administrator, please enter fingerprint or password."

**C.** Enter a new password or fingerprint. For a password, enter it and press " " to confirm twice. For a fingerprint, enter it 5 times. The lock will prompt: "Added successfully, number xxx."

#### Note:

You can add up to 50 passwords and 50 fingerprints to the lock.

### (4) Volume Setting

Press "333" and " " to set the voice broadcasting volume. You can select low, medium, or high levels.

### (5) Auto-lock Setting

Press "777" and " ", then verify your administrator password to activate or deactivate the auto-lock setting.

### (6) Passage Mode

Press "78" and " " to activate passage mode within 5 seconds after unlocking. In this mode, the lock will remain unlocked until the next motor-driven lock/unlock action. (Thumb turn lock/unlock will not exit passage mode.)

## App Instructions

### (1) Download the App

Download the Tuya Smart App from the App Store (iOS devices) or Google Play (Android devices).



### (2) Sign Up for an Account

Create your account and follow the setup instructions in the Tuya app.

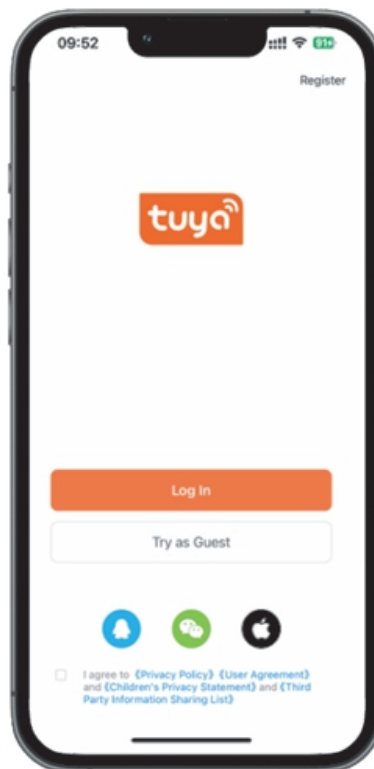

### (3) Add the Lock to Your APP

**A.** Before connecting the App, verify the current status of your lock:

1. If an admin password has already been set:

-Press "3" followed by "🔒".

-Enter the admin password when prompted.

-Once the "🔒" flashes green, the lock is in BT pairing mode.

2. If the lock is in Factory Reset state:

-Press and hold the Reset Button until you hear 6 beeps.

-The lock will automatically enter BT pairing mode.

**B.** Turn on BT on your phone and start pairing the door lock.

**C.** The app will automatically detect the lock device. Click "Add," and when the lock prompts "Operation succeeded," the connection is complete.

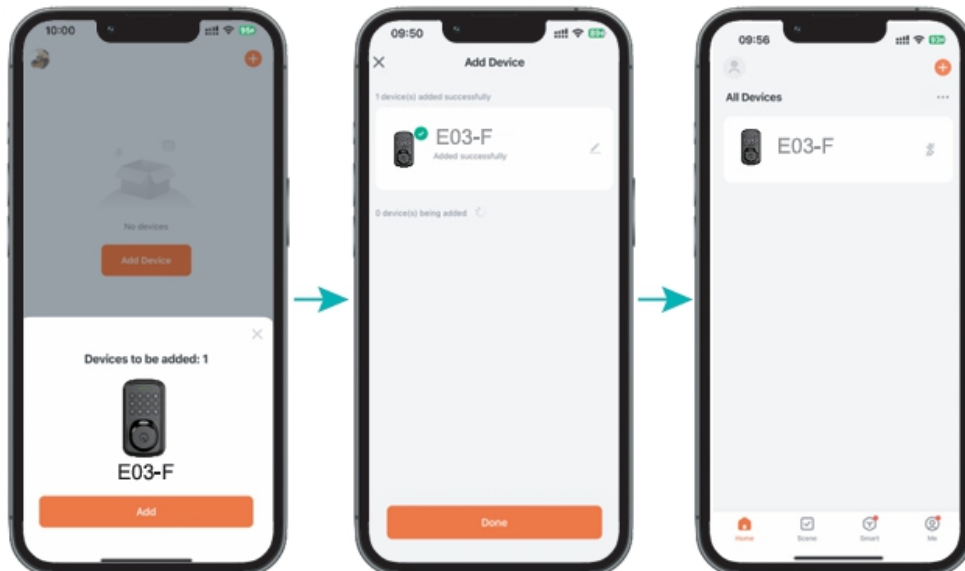

**Note:**

If the lock does not appear or is not detected, click "Add Device" and add the lock on the next page. You can also manually search for it in the directory.

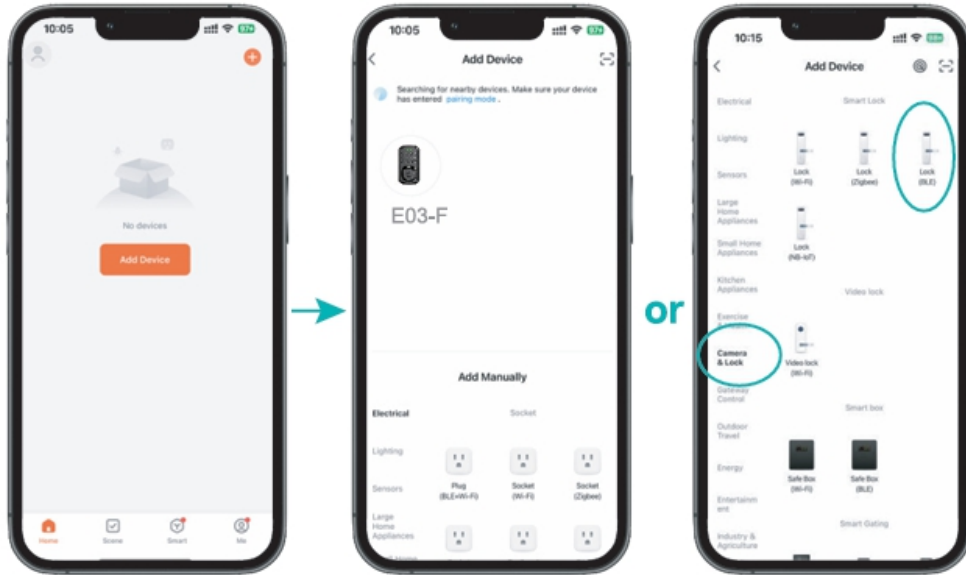

#### (4) APP Lock/Unlock

Press and hold the button to lock or unlock (requires BT connectivity).



### (5) Manage Password and Fingerprint on APP

Click "Family," select a family member, and add a password or fingerprint for that member. You can also sync lock-set passwords/fingerprints to the app, assign them to members, or delete them.

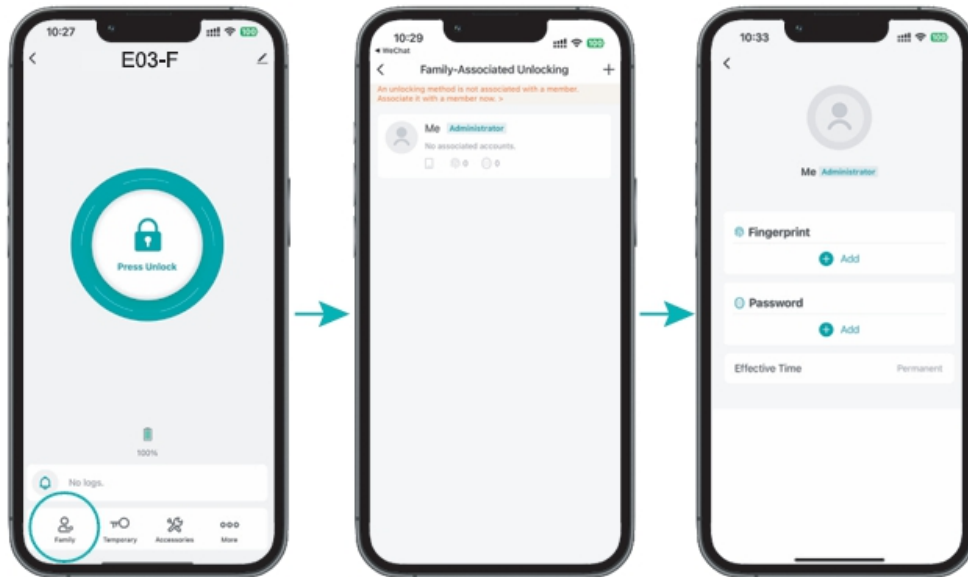

### (6) Add a Family Member

Click "+" to add a family member on the Family page. You may need to complete your home profile first. Follow the instructions to set up your home and create a profile, then manage family members' access.

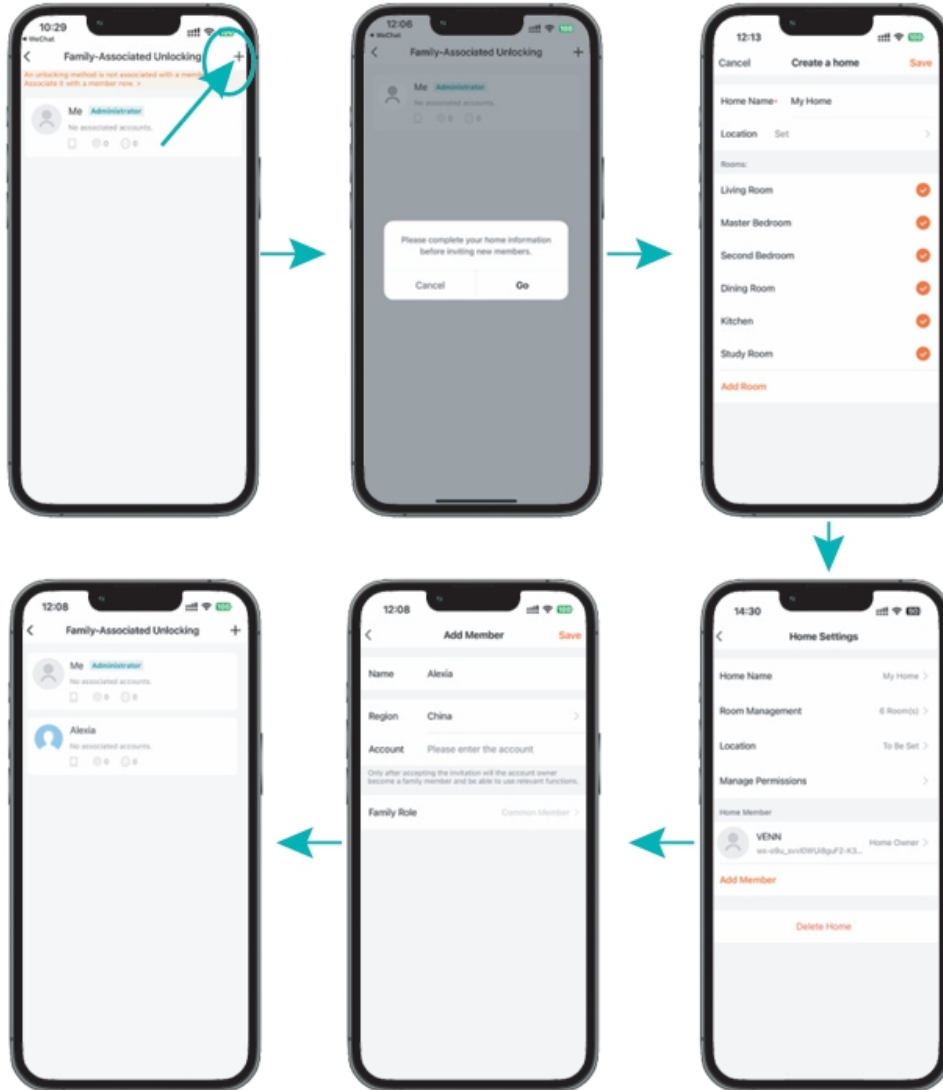

### (7) Manage Temporary Passwords

Click "Temporary," select the type of temporary password you want, and create it. You can set an expiration time for different temporary password types.

**Note:** Temporary passwords do not require a BT connection.

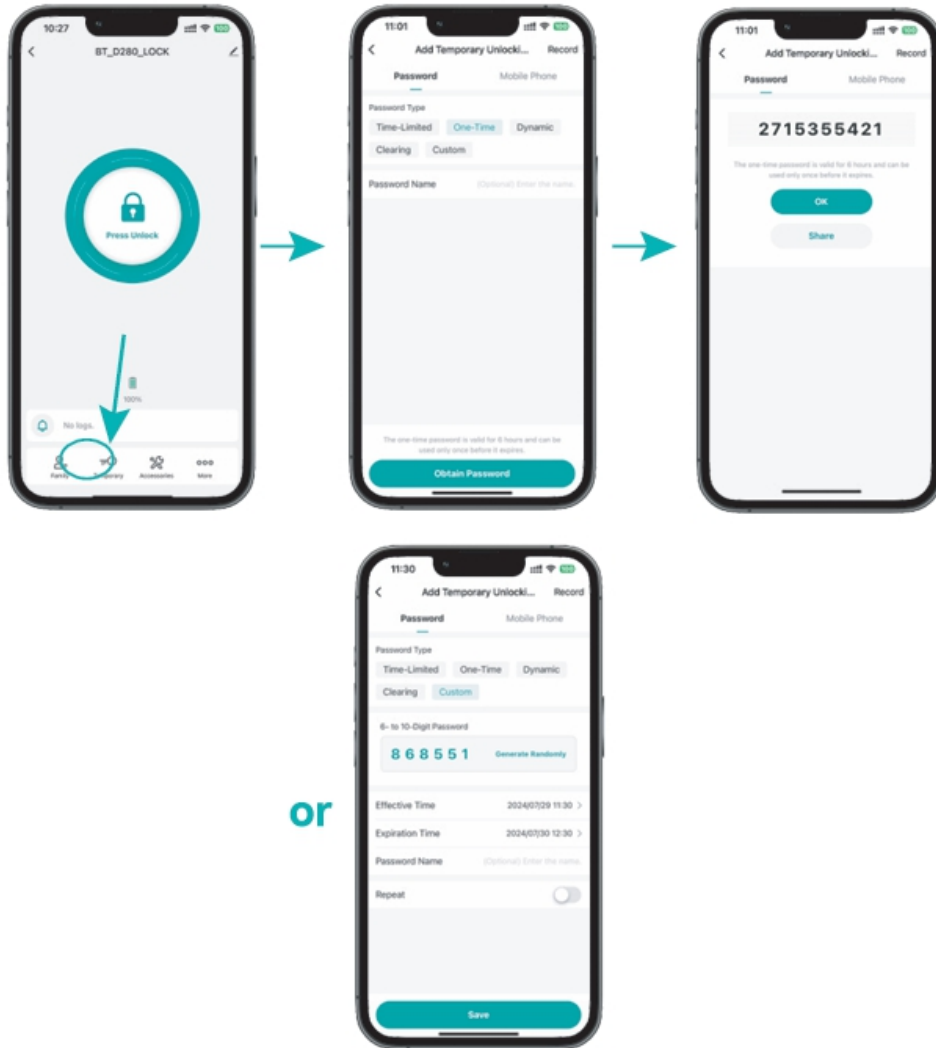

### (8) More Settings

Click "More" on the homepage to enable/disable auto-lock and set voice broadcast volume. You can set the auto-lock countdown from 1 second to 30 minutes and choose low, medium, or high volume levels.

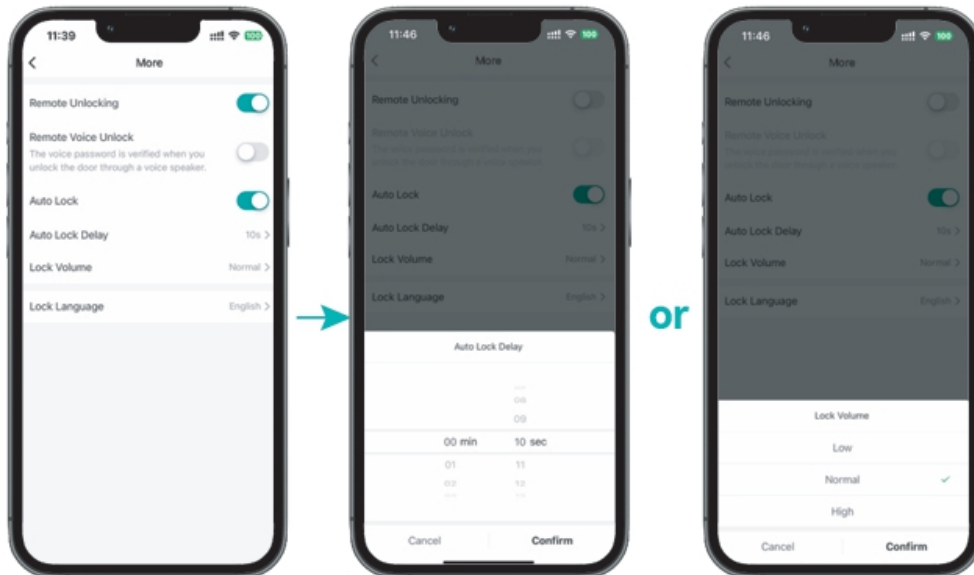

### (9) Check Unlocking Records

Click the log bar on the homepage to view alerts and unlocking events.

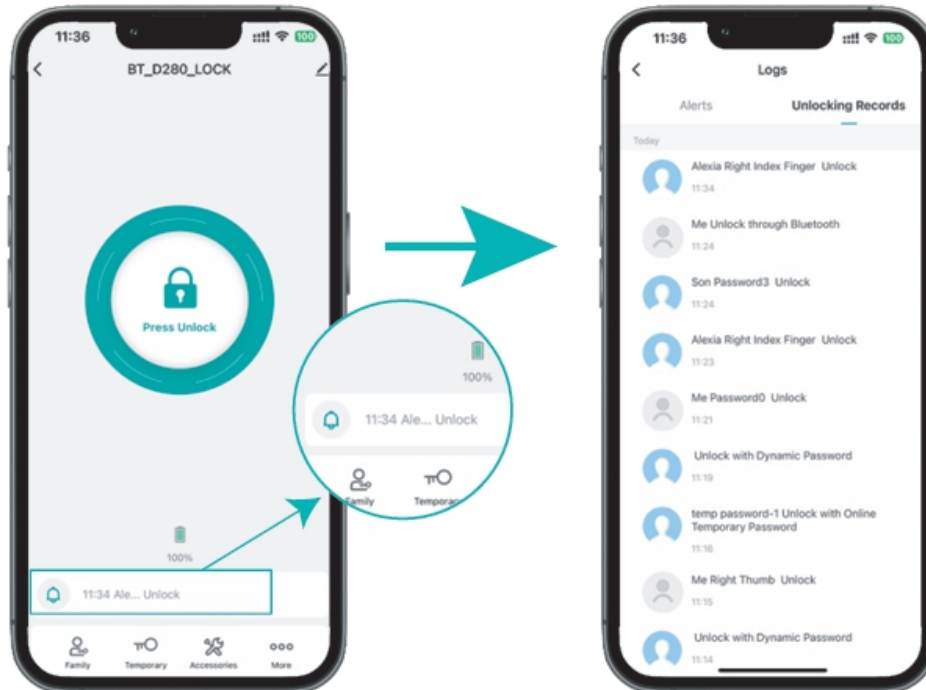

## Troubleshooting

<i>Issue</i>	<i>Solution</i>
Fingerprint is not sensitive and seldom works	A. Delete your fingerprint and add it again. B. Place your fingertip fully on the fingerprint reader to increase contact area for more complete data collection.
Cannot pair the lock with App	A. Ensure your phone is within BT range. B. The lock can only pair with one BT device. If already paired, delete it from the existing device or reset the lock and re-pair.
Cannot control the lock with my App	A. Ensure your phone is within BT range. B. Resetting the lock deletes all paired devices. Delete the lock from your app and re-pair.
Number Pad does not respond	A. Check if batteries are dead. B. Check if the IC wire is correctly connected.
Lock cannot work normally unless with a key	Reinstall the lock, ensuring no key was inserted during installation and the deadbolt is retracted and positioned upward.

## SIMPLIFIED EU DECLARATION OF CONFORMITY

Hereby, Shenzhen Unichain Technology Co., Ltd. declares that the product type E03-F is in compliance with Directive 2014/53/EU.

The full text of the EU declaration of conformity is available at the following internet address:

<https://teckneteu.com/>

## FAQs

**Q: Can I use the APP to remotely open the door for my neighbor?**

A: No, direct remote opening is not possible outside BT range. However, temporary passwords do not require BT or network, so you can send a one-time password to open the door.

**Q: Does this lock support Wi-Fi connection?**

A: No, this lock set does not support Wi-Fi connection.

**Q: How to delete a password?**

A: For family member passwords, delete them on the Family Member page in the Tuya App. For active temporary passwords, click the "Record" button in the upper-right corner of the Temporary Password page, select the password, and delete it. You can also set a Clearing Code for the password type on the Temporary Password page and enter it on the lock number pad (voice prompts will confirm deletion).

**Q: How to unlock if the batteries run out?**

A: The lock has a USB-C Backup Power Port at the bottom of the front panel. Use any USB-C power source to power the lock and activate the number pad.

**Q: How to set the auto-lock time?**

A: Set the auto-lock countdown on the "More Settings" page in the Tuya App (1 second to 30 minutes) or turn off the function.

**Q: How to let family members control the lock via App?**

A: They must download the Tuya app and sign in. The admin should go to: Tuya App > Me > Home Management > Select your home > Add Member > Share Invitation Code. Family members can enter the code to join and control the lock via the App.

## IMPORTANT SAFETY INSTRUCTIONS-CAREFULLY FOLLOW THESE INSTRUCTIONS.

1. RETAIN THESE INSTRUCTIONS - This sheet contains important safety and operating instructions.
2. Before using the product, read all instructions and caution markings on the product, accessories, and device.
3. This appliance is not intended for use by persons (including children) with reduced physical, sensory or mental capabilities, or lack of experience and knowledge, unless they have been given supervision or instruction concerning use of the appliance by a person responsible for their safety.
4. Children should be supervised to ensure that they do not play with the appliance.
5. Keep the product away from the fire to avoid an explosion.
6. For proper insertion, please observe polarity indicators (+/-).
7. Do not place the product in or near an inflammable, explosive, or hazardous object.
8. Do not operate the product with a damaged cord or plug.
9. Do not disassemble the product. Disassembly may result in a risk of safety hazards.
10. Do not throw or shake the product.
11. Do not place the product in or near water, rain, excess moisture, or extreme heat.

## Limited 12-Month Warranty



### *What this warranty covers.*

Shenzhen Unichain Technology Co., LTD. (Manufacturer: "Unichain") warrants to the original purchaser of this TeckNet product that the product shall be free of defects in design, assembly, material, or workmanship.

### *What the period of coverage is.*

Unichain warrants the TECKNET product for **12 Months**.

### *What will we do to correct problems?*

Unichain will repair or replace, at its option, any defective product free of charge (except for shipping charges for the product).

### *What is not covered by this warranty?*

All above warranties are null and void if the TeckNet product is not provided to Unichain for inspection upon Unichain's request at the sole expense of the purchaser, or if Unichain determines that the TeckNet product has been improperly installed, altered in any way, or tampered with. The TeckNet Product Warranty does not protect against acts of God such as flood, earthquake, lightning, war, vandalism, theft, normal-use wear and tear, erosion, depletion, obsolescence, abuse, damage due to low voltage disturbances (e.g. brownouts or sags), non-authorized program, or system equipment modification or alteration.

### *How to claim the warranty*

Please contact retailers or visit TECKNET website or email

**support@ylinksworld.com** for more information. To extend the warranty period, please visit TECKNET website and register your TECKNET products within **90 days** of purchase.

### *Disclaimer*

Every effort has been made to ensure that the information and procedures in this guide are accurate and complete, no liability can be accepted for any errors or omissions and we reserve the right to make any changes without further notice to any products mentioned herein.

## Correct Disposal of This Product



( Waste Electrical & Electronic Equipment )

This Marking shown on the product or its literature, indicate that it should not be disposed with other household wastes at the end of its working life.

To prevent possible harm to the environment or human health from uncontrolled waste disposal, please separate this from other types of wastes and recycle it responsibly to promote the sustainable reuse of material resources. Household user should contact either the retailer where they purchased this product, or their local government office, for details of where and how they can take this item for environmentally safe recycling.

Business users should contact their supplier and check the terms and conditions of the purchase contract. This product should not be mixed with other commercial wastes for disposal.

## FCC STATEMENT

This device complies with Part 15 of the FCC Rules. Operation is subject to the following two conditions:  
(1) This device may not cause harmful interference, and (2) this device must accept any interference received, including interference that may cause undesired operation.

NOTE 1: This equipment has been tested and found to comply with the limits for a Class B digital device, pursuant to part 15 of the FCC Rules. These limits are designed to provide reasonable protection against harmful interference in a residential installation. This equipment generates, uses and can radiate radio frequency energy and, if not installed and used in accordance with the instructions, may cause harmful interference to radio communications. However, there is no guarantee that interference will not occur in a particular installation. If this equipment does cause harmful interference to radio or television reception, which can be determined by turning the equipment off and on, the user is encouraged to try to correct the interference by one or more of the following measures:

- Reorient or relocate the receiving antenna.
- Increase the separation between the equipment and receiver.
- Connect the equipment into an outlet on a circuit different from that to which the receiver is connected.
- Consult the dealer or an experienced radio/TV technician for help.

NOTE 2: Any changes or modifications to this unit not expressly approved by the party responsible for compliance could void the user's authority to operate the equipment.

The device has been evaluated to meet general RF exposure requirement. The device can be used in portable exposure condition without restriction.

### IC Caution:

This device complies with Industry Canada's licence-exempt RSSs. Operation is subject to the following two conditions:

- (1) This device may not cause interference; and
- (2) This device must accept any interference, including interference that may cause undesired operation of the device.

The device has been evaluated to meet general RF exposure requirement. The device can be used in portable exposure condition without restriction.

Le présent appareil est conforme aux CNR d'Industrie Canada applicables aux appareils radio exempts de licence. L'exploitation est autorisée aux deux conditions suivantes:

- (1) l'appareil ne doit pas produire de brouillage, et
- (2) l'utilisateur de l'appareil doit accepter tout brouillage radioélectrique subi, même si le brouillage est susceptible d'en compromettre le fonctionnement.

L'appareil a été évalué pour répondre aux exigences générales d'exposition RF. L'appareil peut être utilisé dans des conditions d'exposition portables sans restriction.