

GUARD TOUR MANAGEMENT SYSTEM USER'S MANUAL

WM-5000X1



WM-5000X1 Guard Tour System User's Manual

1. What is guard tour system?

A guard tour system is a system used to help companies and organizations to organize, log and execute guard tours and patrols in their assets ensuring that the officers will accomplish their tasks within the predefined time intervals. There is a wide variety of guard tour systems, which can be divided in two major categories: Wand guard tour systems based on handheld devices and cloud guard tour systems based on modern mobile and cloud technology. Guard tour systems provide a means to check and record the time that a guard executes his guard tour by scanning specific checkpoints assigned on the area he patrols.



2. Applications

- warehouse systems
- improving rent a car systems
- monitoring proper service
- supervising personnel work time and place
- monitoring scheduled technical maintenance
- supervising guards
- supervising service producers
- supervising drivers
- monitoring rent systems
- airport protection and supervising workers
- hotel protection and supervising workers
- protection for other public institutions

3. Functional Diagram



4. Technical Information

Model	WM-5000X1
Physical	Metal body with silicon shell outside
Dimensions	163mm*50mm*36mm
Weight	314g
Tag Reading	RFID
Frequency	125KHz or Bluetooth card
Reading Distance	125KHz card: 3-5cm Bluetooth card: 10m
Operating Temperature	-40°C to +85°C
Storage Capacity	60,000 pieces records
Memory	32Mb Flash ROM
Fingerprint	200 groups
IP Rating	IP67
Flashlight	Press light button for 2 seconds
Charging Time	3 hours
Battery	3.7V Lithium Recharge Battery
Standby Time	Reading checkpoint 500 times a day , flashlight open 2 hours, can be used for 9 days.
Communication	USB magnetic cable
Humidity	10% to 90% non-condensing

RFID Tags

Model	Checkpoint	Frequency	Dimensions	Weight
WM-28B		125kHz	6.6mm*27.7mm	1.7g
WM-226		125kHz	36mm*28mm*6mm	3.8g
WM-30A		125kHz	30mm*4mm	2.8g
WM-70A		125kHz	76mm*56mm*10mm	19g
WM-70Y		125kHz	76mm*56mm*10mm	19g
WM-2.4GC-BLE		Bluetooth 4.0 low power consumption	72 mm*45mm*24mm	58g

5. System Components

- 1) WM-5000X1 reader
- 2) Magnetic cable
- 3) Software
- 4) Charger
- 5) RFID tags (optional purchase)
- 6) Guard ID cards (optional purchase)
- 7) Event wallet (optional purchase)

6. User Flow

- 1) Make a sketch of the checking places that the guard needs to check.
- 2) Install tags on each checking place.
 - *The round shape tag can be stuck or screwed on the wall.
 - *For the cylinder glass tag, make a hole in the wall, and then put it inside and cover it.
- 3) Install software and make settings in software
- 4) The guard uses the reader to verify his fingerprint first and starts to patrol(before scanning each checkpoint, guard needs verify his fingerprint); he need go to each checking place and use the reader to scan tags installed on the wall.
- 5) The guard will take the reader back to the control center and use USB cable to upload data to software.

Installation

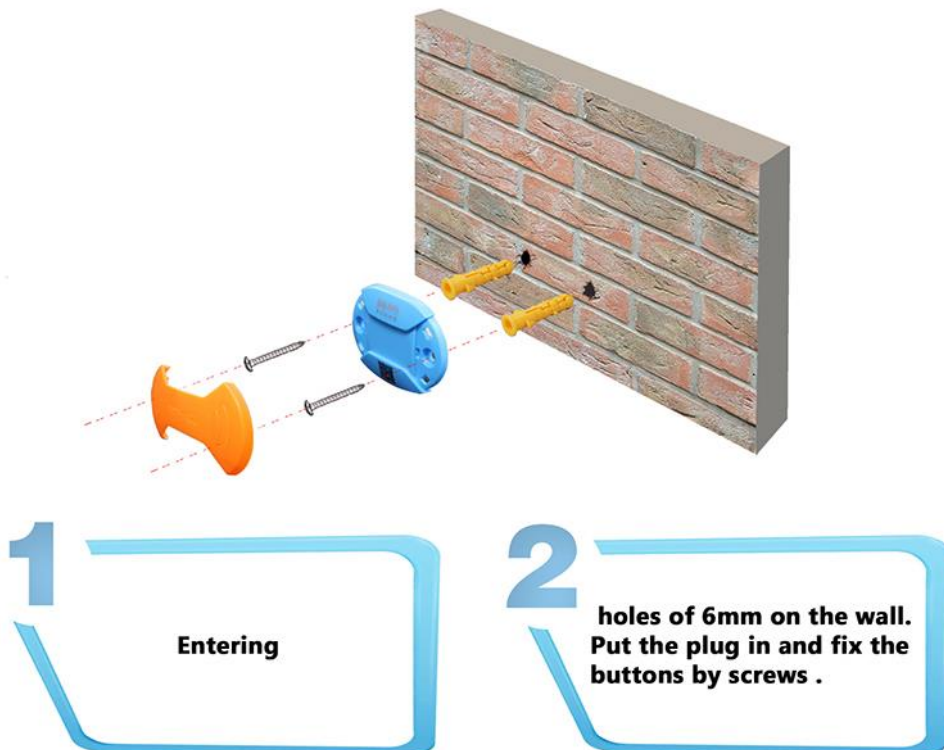

7. Warranty Policy

- (1) All products are strictly tested and qualified before sale.
- (2) Hardware devices sold by our company are covered by 1 year parts warranty.
- (3) During 1 year warranty period, we will replace or repair units without charge, subject to any problem coming from product itself under ordinary usage condition. The one year warranty period begins when the new products are received by customer. We warrant its remanufactured products and non-warranty repair to hardware from defects in material and workmanship for a period of 90 days. The 90 days warranty period begins the date when repair or remanufactured product is shipped from us.
- (4) This warranty does not apply on batteries and extra parts. This warranty is invalid if the product has been damaged by accident, abuse, misuse, product end of life, or misapplication or has been dismantled or repaired without the written permission of our company.
- (5) In any condition, freight will be paid by customer.

Thank you so much for choosing our guard tour system! If you have any question on our product, please feel free to contact us or local dealer and we still try our best to help you!



JWM Hi-Tech Development Co., Ltd

TEL: 0086 24 83782790

Email: sales@jwm-rfid.com

Web: <http://www.jwm-rfid.com>