

# Smart Doorbell

Human Detection, Two-way Audio

AL01-W

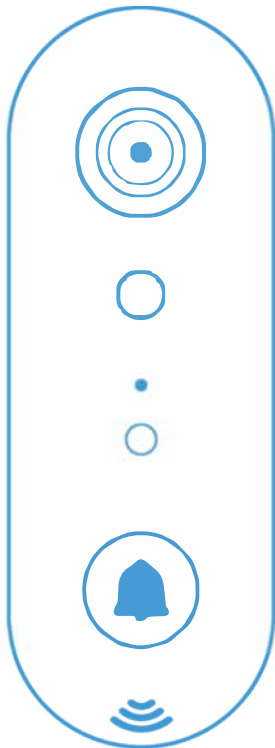

User Manual 5.0

Problems	Solution
What should I do if the device is unsuccessfully?	Check whether the Wi-Fi password is correct, and the network can be connected correctly, then Reset the camera, and add it again after completion.
What if the display device is offline?	First confirm whether the power supply and network are normal, and there is no problem before powering off the camera, and restarting it. If the connection is still, please reset the camera again.
What should I do if no charging with the device?	Before first using, please full charge with 10-12 hours, to activate the battery life. Don't use the USB charger than 10W (DC5V, 2A) to recharge, to avoid overload protection to cause it not charging.
How to Download the playback?	To click the "Record Screen" button through Playback and click the red button after recording, the video files will be saved to the phone album.
The TF card is full, what should I do?	No manual processing is required. When the remaining TF card capacity is less than or equal to 500M, the camera will automatically overwrite the oldest video file. Note: The TF card support with the capacity of 8~128GB.
The TF Card shows no memory card or abnormal?	<ol style="list-style-type: none"> <li>1. The camera does not support hot swapping. When inserting a TF card, it needs to be powered off. Please restart the camera.</li> <li>2. The TF card is still not recognized after restarting the camera, please replace with a new card and test it again.</li> <li>3. If the new card is still not recognized, the card slot maybe damaged or the cable is faulty. Contact the supplier to replace the device.</li> </ol>
What should I do if I can not receive the warning message?	Confirm whether the system has turned off the message push permission of video life. If it is turned off, please turn on the "Message notification" permission in the phone settings and check whether the message push is turned off in the device settings.

# Appearance Introduction

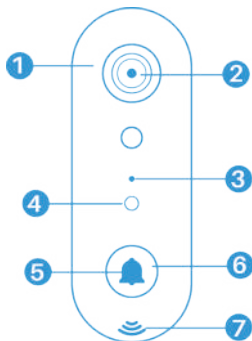

- 1. Hidden Infrared Lights
- 2. Wide-angle Lens
- 3. Microphone
- 4. Light Sensor
- 5. LED indicator
- 6. Doorbell Button
- 7. Speaker

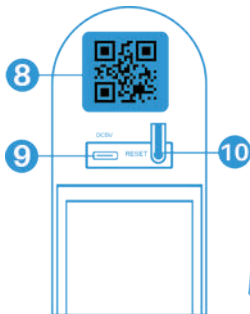

- 8. Device QR Code
- 9. Charging Port
- 10. Reset Button
- 11. Micro SD Card Slot

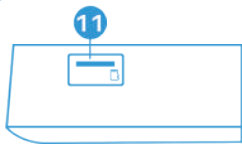

# Guide

1. The security doorbell only supports 2.4Ghz WiFi, please make sure the connected WiFi is 2.4Ghz WiFi before use.
2. The security doorbell supports up to 128GB TF card (Micro SD card). Please disconnect the camera before installing the TF card.



### **Blue Light Always On**

The device is in working mode.



### **Red Light Always On**

The device is charging.



### **Flashing RED**

Device is connecting to WiFi.

## **Device Charging**

Fully charge batteries by connecting your device to a 5V1A or 5V2A USB charger using a USB Type-c cable. It takes about 12 hours for batteries to fully charge.

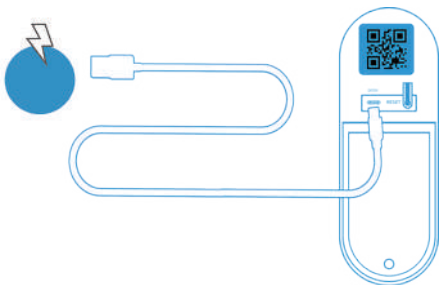

# Guide

## Connecting the power supply

Install the battery for the device, then wait for the device to start up and send voice prompts.

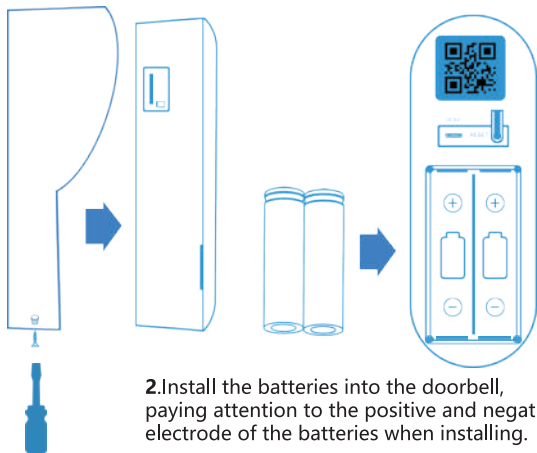

2. Install the batteries into the doorbell, paying attention to the positive and negative electrode of the batteries when installing.

1. After install the doorbell with the back cover bracket screw the security screw at the bottom of the doorbell tightly to fixed.

---

### **WARNING:** Lots of events

If your device is capturing an excessive number of events every day, you might need to recharge your battery sooner. Plus, the battery is also drained each time you use the live view to look or speak through your doorbell. To prevent excessive events, you can adjust your motion settings to a lower sensitivity.

---

# Set up your Video Doorbell

## 1.Download App

Download "videolife" App via App Store or Google Play.

(Note: If you need to use it on Windows, please by finish set up the security camera in the mobile app firstly)



1. Please login or register an account first.

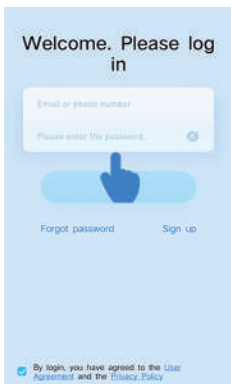

2. Click "+" to add devices.

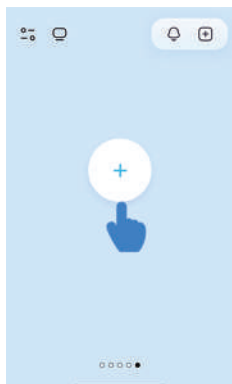

# Set up your Video Doorbell

3. Scan the QR code on your device. (Please open the back cover bracket of the doorbell to find the QR code)



4. Add the name and password of the Wi-Fi you need to connect.



5. Scan the QR code generated by the "videolife" App with your security doorbell. (Scan the QR code with the doorbell distance 10~30 cm)



6. Wait for the device to connect to the network.

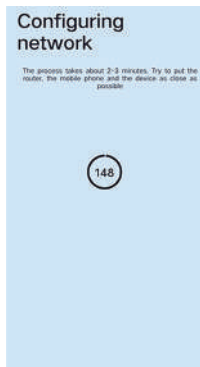

# Set up your Video Doorbell

7. Name your device.



8. Add successfully.

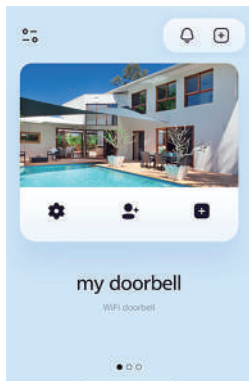

## Install your security doorbell

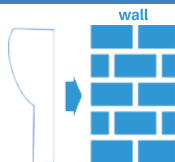

**Step 1**  
Mount the doorbell back cover bracket to the wall using the adhesive backing for the doorbell back cover bracket.

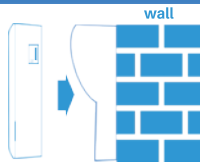

**Step 2**  
Attach the doorbell to the back cover bracket.

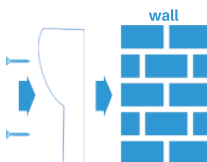

**Step 1**  
Use screws to secure the doorbell back cover to the wall.

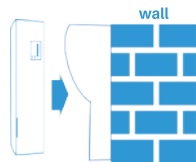

**Step 2**  
Attach the doorbell to the back cover bracket.

# Common Feature

## 1.Replacement of video doorbell networks

If you need to change the WiFi of the doorbell, please restore the doorbell to factory settings first. Remove the back cover of the doorbell, find the reset button of the doorbell, press and hold it for 8 seconds and wait for the voice prompt of the doorbell to restore the factory settings.

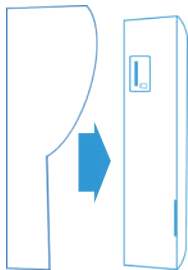

step 1

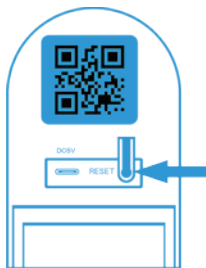

step 2

## 2.Video Doorbell Installation Micro SD card

**Note:** Disconnect the video doorbell from the power supply before installation.

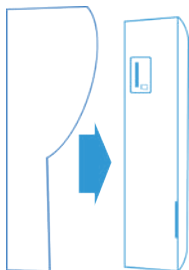

step 1

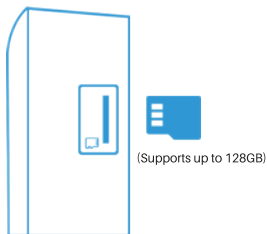

step 2

## 3. Multi-user Sharing

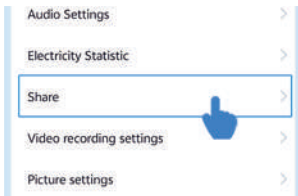

Step 1

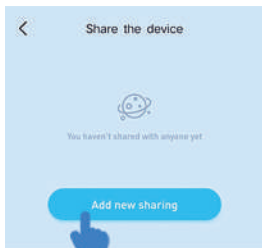

Step 2

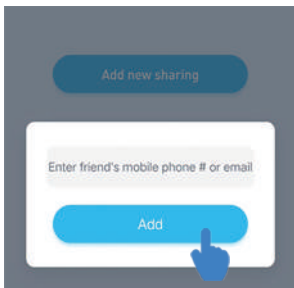

Step 3

**Note:** If you need to share your device with others, please ask them to download "videolife" firstly, then register an new account.

# Common Feature

## 5.View the video footage

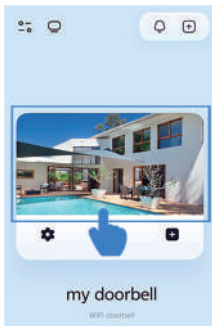

### Cloud Storage



### TF(Micro SD card) Storage



\* The doorbell support Cloud storage & Sd card local storage. Can check the footage playback on Cloud or SD card through App,to click the icon to view.

# Common Feature

## 6. Alarm message

step 1

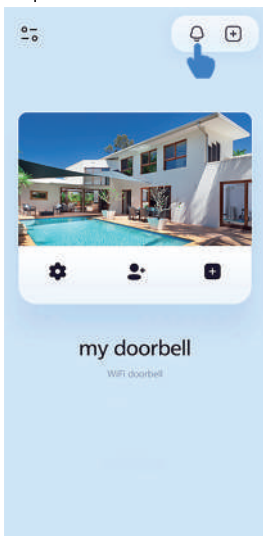

step 2

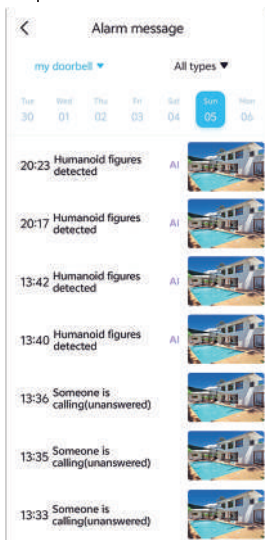

### 6.1. More settings

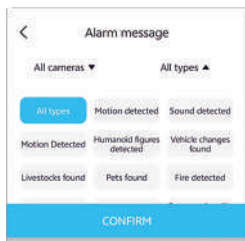
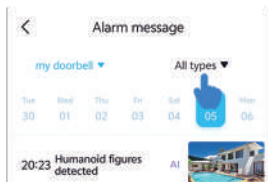

# Set up your Wireless Chime (Optional)

Connect the video doorbell to the doorbell chime, and get instant alert in your home when someone rings the doorbell. The chime plugs into any wall outlet, you can place it anywhere in the home.

## Step 1

Before the setup process, be sure your video doorbell has connected to your phone. Then plug your chime in USB port.

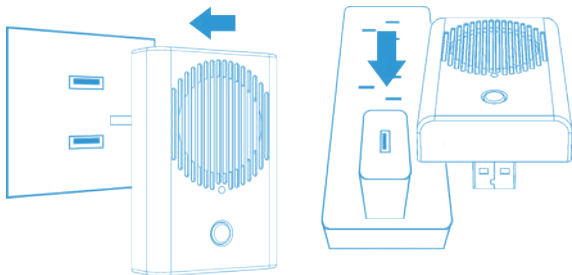

## Step 2

Press and hold the chime matching button for 6 seconds, when you hear a "Ding" sound from the chime to enter the pairing mode, then press the doorbell button of the video doorbell to match successfully.

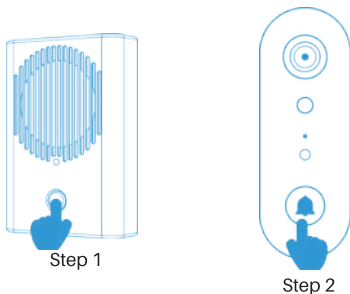

# Set up your Wireless Chime (Optional)

## Step 3

Press the Doorbell button again to verify the chime and video doorbell work properly.

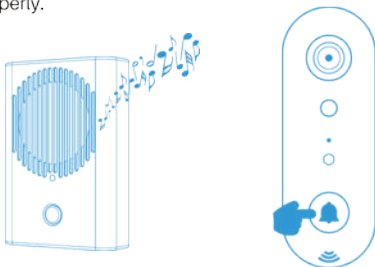

**If you encounter any problems, please click (  ) to contact our customer service**

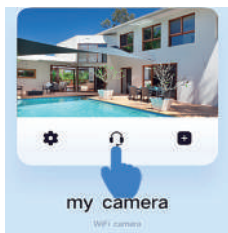

Option 1

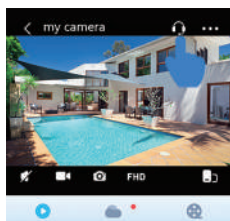

Option 2

# More Feature

Click (⚙️) to go to more setting

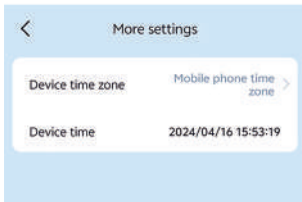
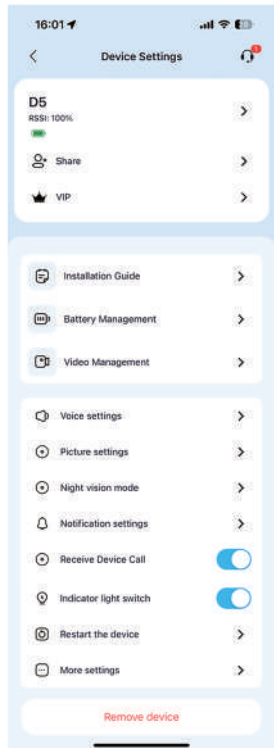
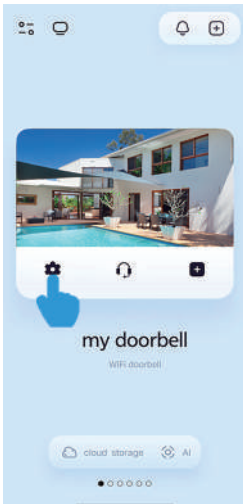

# More Feature

## 1.Voice settings

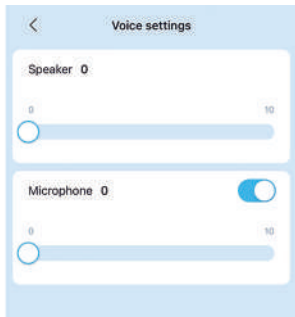
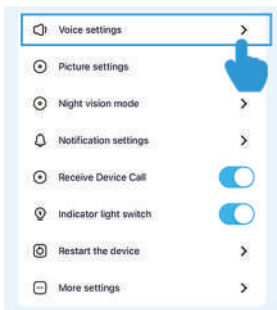

## 2.Video Management

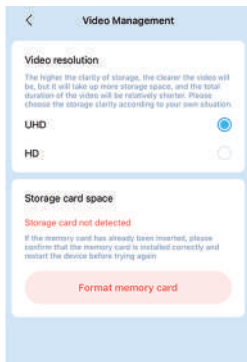
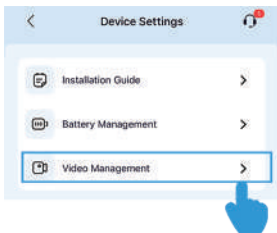

\* This setting requires a Micro SD card to be installed before it can be used.

## 3. Picture settings

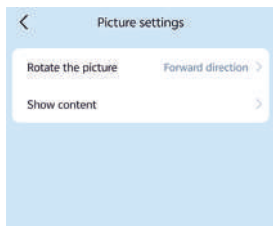
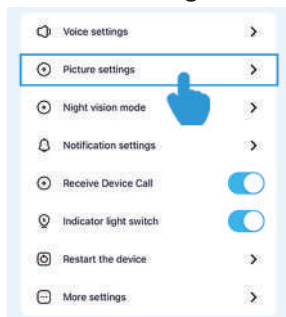

### 3.1 Rotate the picture

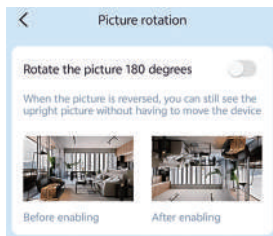
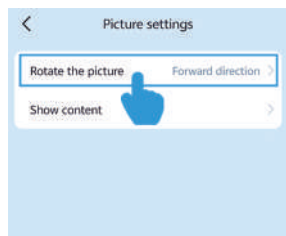

### 3.2 Show content

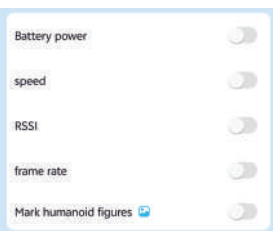
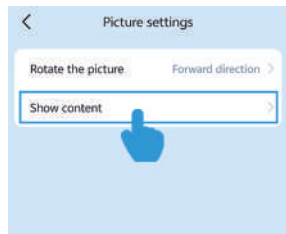

# More Feature

## 4.Night vision mode

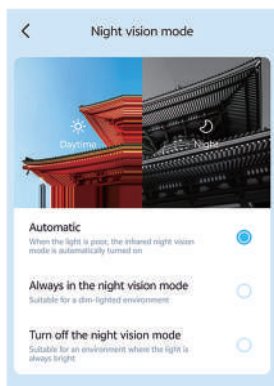
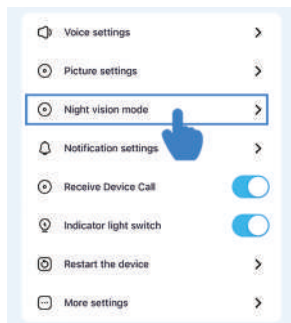

## 5.Notification settings

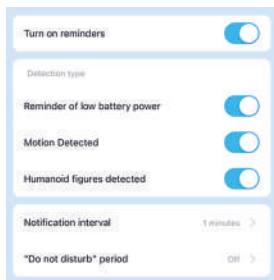
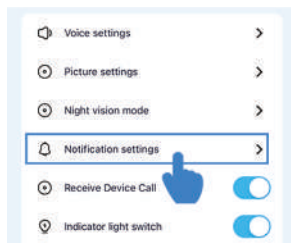

\* If you still don't receive message notification after enabling message notification, please check whether you have enabled the message notification privilege of "videolife" APP in your phone settings.

## 7.Call settings

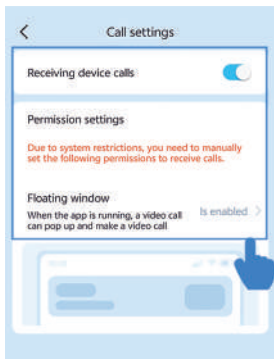
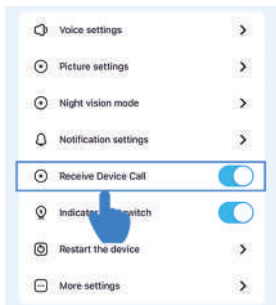

## 8.Battery Management

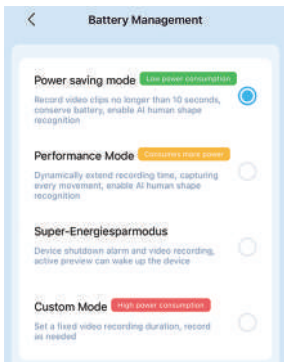
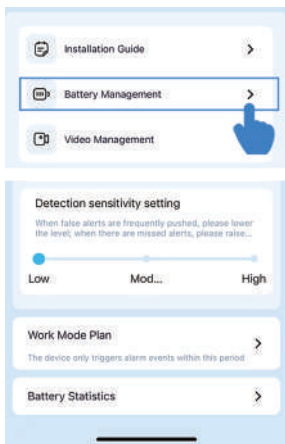

## 9.Other settings

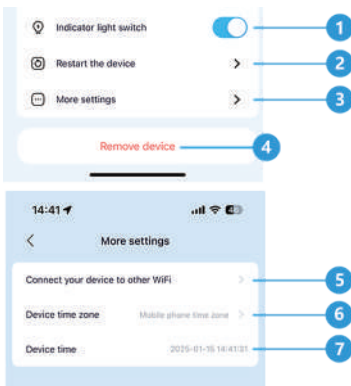

1. Turns the video doorbell status light on or off.
2. Reboot the video doorbell.
3. More Setting
4. Remove Device
5. Change with new WiFi
6. Set the time zone through videolife
7. Set Device time



[admin@videolife.co](mailto:admin@videolife.co)

Customer Support Email

This device complies with part 15 of the FCC Rules. Operation is subject to the following two conditions: (1) This device may not cause harmful interference, and (2) this device must accept any interference received, including interference that may cause undesired operation.

Any Changes or modifications not expressly approved by the party responsible for compliance could void the user's authority to operate the equipment.

**Note:** This equipment has been tested and found to comply with the limits for a Class B digital device, pursuant to part 15 of the FCC Rules. These limits are designed to provide reasonable protection against harmful interference in a residential installation. This equipment generates uses and can radiate radio frequency energy and, if not installed and used in accordance with the instructions, may cause harmful interference to radio communications. However, there is no guarantee that interference will not occur in a particular installation. If this equipment does cause harmful interference to radio or television reception, which can be determined by turning the equipment off and on, the user is encouraged to try to correct the interference by one or more of the following measures:

- Reorient or relocate the receiving antenna.
- Increase the separation between the equipment and receiver.
- Connect the equipment into an outlet on a circuit different from that to which the receiver is connected.
- Consult the dealer or an experienced radio/TV technician for help.
- This equipment complies with FCC radiation exposure limits set forth for an uncontrolled environment. This equipment should be installed and operated with minimum distance 20cm between the radiator & your body.