

Installation Guide

40GBase-SR QSFP+ MPO Transceiver

For technical support and other information, please visit <https://www.tp-link.com/support>, or simply scan the QR code.



* Images may differ from actual products.

Install the Transceiver

1. Wear an ESD-preventive wrist or ankle strap to prevent ESD damage to the transceiver.
2. Insert the transceiver into the slot and firmly press it into place.

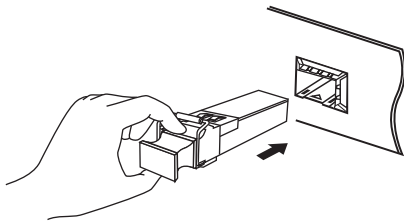

3. Remove the protective dust plug from the transceiver.

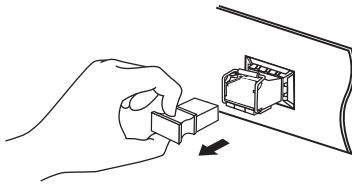

4. Plug fiber-optic cables into the transceiver. Note that the transceiver works without any additional configuration.

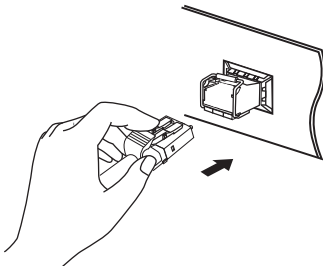

Remove the Transceiver

1. Wear an ESD-preventive wrist or ankle strap to prevent ESD damage to the transceiver.
2. Disconnect the network fiber-optic cables from the transceiver.

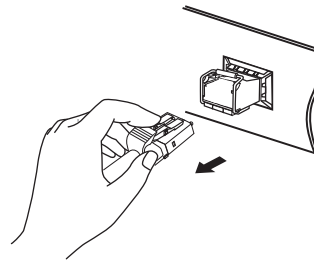

3. Pull the safety latch downwards to release the transceiver, and then pull it out from the slot.

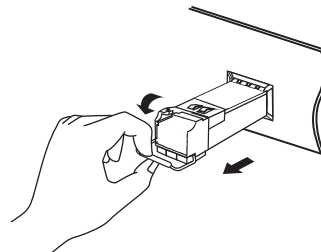

4. Reinstall the protective dust plug in the transceiver's optical bores and place it on antistatic mat or a static shielding bag.

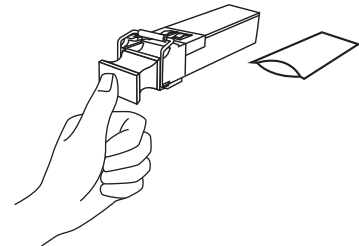

Note:

1. Do not touch the output pins on the transceiver with your hand.
2. Always keep the protective dust plug on the transceiver's optical bores until you are ready to make a connection.

Caution:

DO NOT point or stare directly into the beam or into the optical port of the transceiver when it is operating, as this can injure your eyesight.

Connection

Only use the same transceiver model between switches for fast and reliable connectivity.

For simplicity, we will take SM-7110-SR as an example.

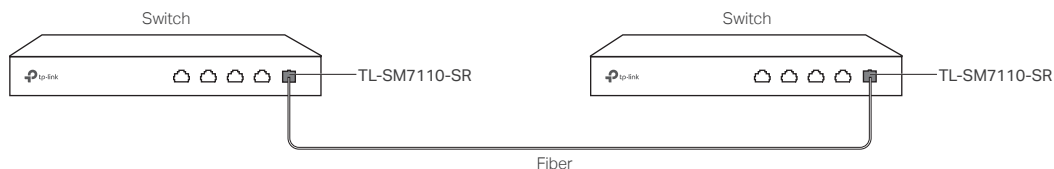

Specifications

General Specifications

Normal	TL-SM7110-SR
Wave Length	850 nm
Standards and Protocols	IEEE 802.3ae TCP/IP SFF-8472
Cable	50/125 or 62.5/125 μ m Multi-mode Fiber
Max. Cable Length	150 m (OM3)
Data Rate	40 Gbps
Port Type	MPO
Power Support	3.3 V
Safety & Emission	FCC, CE
DDM	Yes
SFP+ MSA	Yes
Hot Swappable	Yes

Safety Information

- Keep the device away from water, fire, humidity or hot environments.
- Keep the device away from fire or hot environments. DO NOT immerse in water or any other liquid.
- Do not attempt to disassemble, repair, or modify the device.
- Avoid using this product during an electrical storm. There may be a remote risk of electric shock from lightning.
- Do not point or stare directly into the beam or into the optical port of the transceiver when it is operating, as this can injure your eyesight.



EU Declaration of Conformity

TP-Link hereby declares that the device is in compliance with the essential requirements and other relevant provisions of directives 2014/30/EU, 2014/35/EU, 2011/65/EU and (EU)2015/863.

The original EU declaration of conformity may be found at <https://www.tp-link.com/en/support/ce/>

UKCA Declaration of Conformity

TP-Link hereby declares that the device is in compliance with the essential requirements and other relevant provisions of the Electromagnetic Compatibility Regulations 2016 and Electrical Equipment (Safety) Regulations 2016.

The original UK declaration of conformity may be found at <https://www.tp-link.com/support/ukca/>