

U-1176

PANTONE 3115C

MULTI GROOMING KIT HAIR TRIMMER

Ufree® 11 in 1 SUPER WASHABLE GROOMING KIT

PROFESSIONAL BLADE
LITHIUM BATTERY
FAST CHARGE: 1.5 HOURS
WORK TIME: 90 MINUTES
U-1176



INSTRUCTION MANUAL

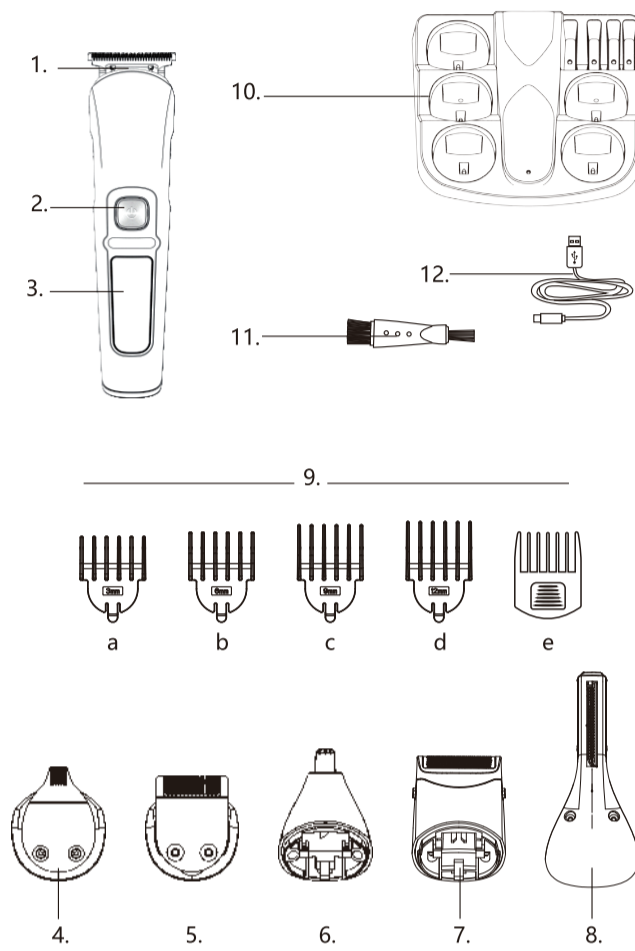

Our products are designed to meet the highest standard of quality, functionality and design. We hope you enjoy using your new appliance. Please read the instructions for use carefully and keep in a safe place for future reference.

CAUTION

Use this appliance only for its intended use as described in this manual.

DESCRIPTION

- | | |
|---------------------------------------|---|
| 1. full size trimmer | 7. micro shaver |
| 2. ON/OFF switch | 8. body trimmer |
| 3. Intelligent digital display screen | 9. full size combs a-d, precision comb e. |
| 4. design trimmer | 10. stand base |
| 5. precision trimmer | 11. cleaning brush |
| 6. Nose/ear trimmer | 12. USB cable(5A 1A charger applicable) |

specification

Products: intelligent body care kit
Model: U-1176
Battery type: Li-ion battery
Charging time: 1.5 hours
Use time: 90 minutes
Input: AC 110-240V ~ 50/60Hz
DC 5V 1A

Rated power: 5W
Production date:
please see the product body
Standard: GB4706.1-2005
GB4706.9-2008

HOW TO MATCH THE APPLIANCE

Ways of replacement and installation

Remove the heads

Push the blades in the direction of the arrow shown in the figure(fig. 1-2)

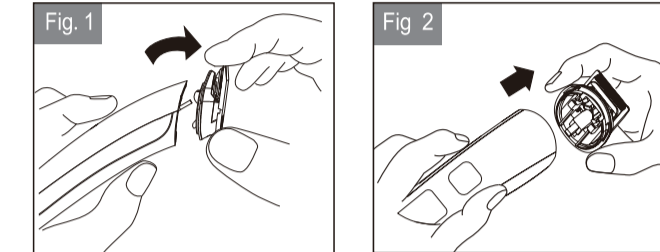

Install the heads

Align the protruding part(fig. 3 ②) of the blade with the body groove(fig. 3 ①), press the blade in the direction of the arrow(fig. 4)

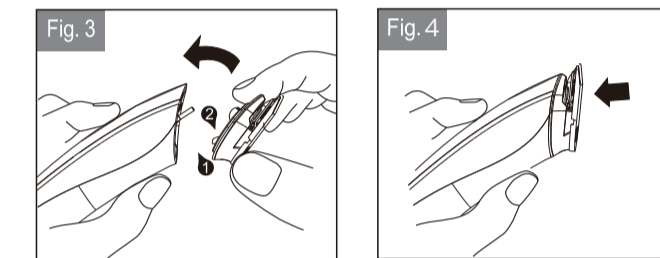

Remove full size trimmer combs

Lift from the bottom of the combs to remove as picture.(fig. 5-6)

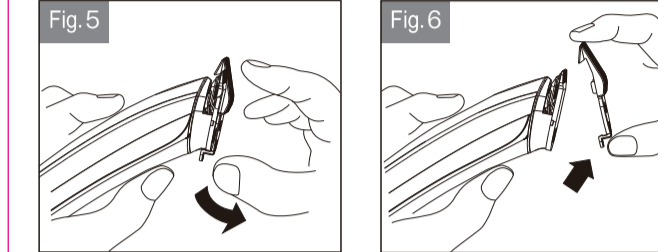

Install full size trimmer combs

Align the guide comb(3/6/9/12mm) with the head, press down on the bottom of the guide comb to install.(fig. 7-8)

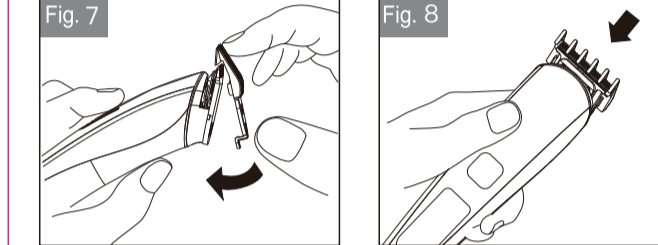

Install adjustable precision comb

Slide the comb from the top to the bottom of the head, adjustable in 4 levels from 1-4 mm.(fig. 9)

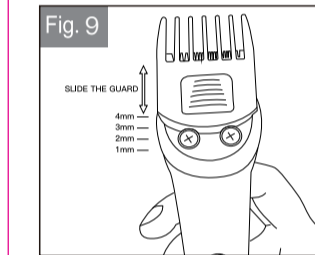

Adjust body trimmer lengths

The body trimmer head includes 3mm/6mm/9/12mm, slide the head up and down to adjust the lengths. (fig. 10)

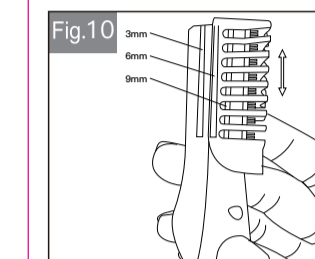

Remove foil head

Press the buttons on both sides and push forward to remove.(fig.11)

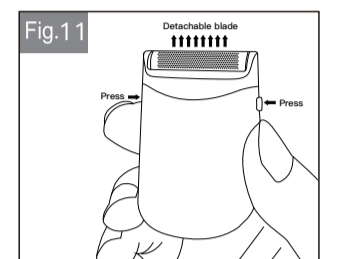

GETTING STARTED

- Charging your personal groomer
Before using your personal groomer for the first time, charge for 2 hours.
- Ensure the product is switched off.
- Connect the charging adaptor to the product and then to the usb port. The charging indicator will light up.
- Your personal groomer cannot be overcharged. However, if the product is not going to be used for an extended period time(2-3months), unplug it from the mains and store. Fully recharge your personal groomer when you would like to use it again.
- To preserve the life of your batteries, let them run out every 6 months then recharge for 14-16 hours.

4 length full size trimmer combs

No.	Level	Length(mm)
1	1	3
2	2	6
3	3	9
4	4	12

Adjustable precision trimmer comb

No.	Level	Length(mm)
1	1	1
2	2	2
3	3	3
4	4	4

Ways of cleaning the appliance

- When cleaning the appliance, just separate the appliance, as the pic shows. Then use the cleaning brush, clear the dust by cleaning the inside parts. (fig.13-14)

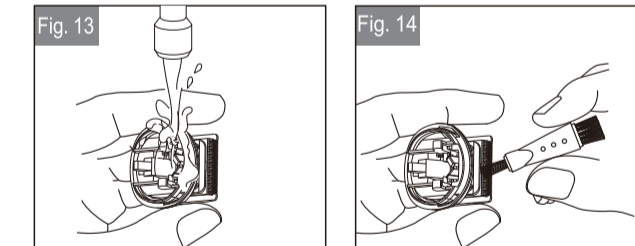

Ways of cleaning the appliance

- Usb cable charge and very convenient.(fig.15)
- Insert the appliance plug directly into the body.(fig.16)

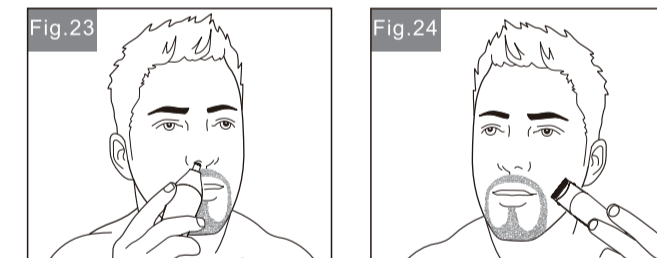
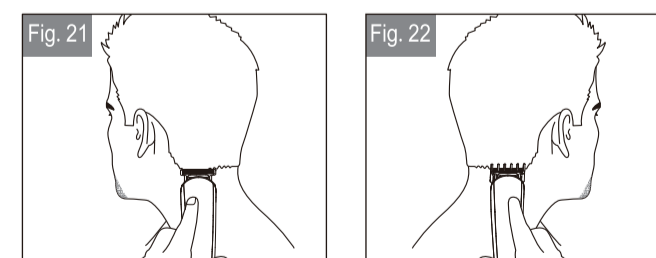
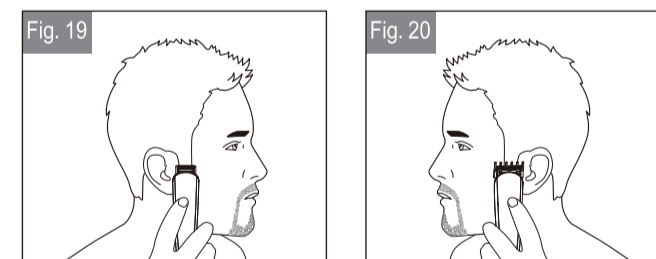
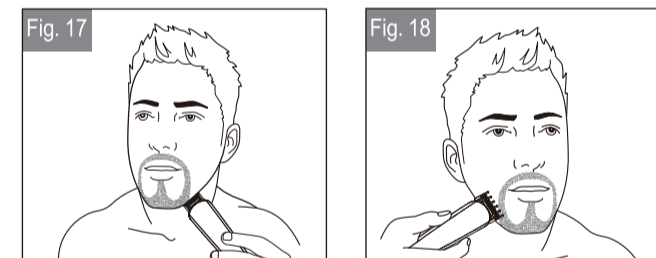
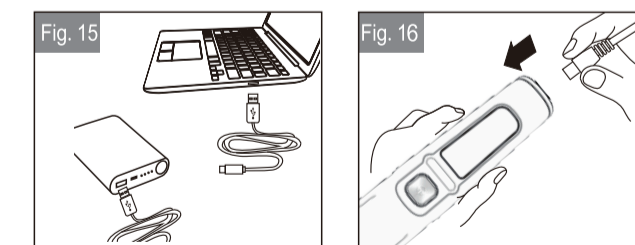

HOW TO USE

- To thin and taper the beard/moustache(fig.21-22)
 - Attach a guide comb to full size trimmer. If you are trimmer for the first time start with the maximum trimming length setting.
 - Turn the unit on.
 - Place the flat top of the trimmer comb against the skin.
 - Slowly slide the personal groomer through the hair. Repeat from different directions as necessary.
 - If hair builds up in the trimmer comb during the trimming process, switch the unit off, pull off the comb and brush/rinse off.
- To define the beard/moustache line(fig.17-18)
 - Hold the personal groomer with precision trimmer blade facing you.
 - Start with edge of beard/moustache line and gently lower the trimmer blade onto your skin. Use motions towards edge of beard/moustache line to trim to desired locations in facial area and away from beard in neck area
- Trimming edge of sideburns(fig.19-20)
 - Hold the personal groomer with precision trimmer blade facing you.
 - Start with edge of sideburn, and with the trimmer blades resting lightly against your skin, use motions towards edge of sideburn line to trim to desired locations in facial area.

Using the micro shaver trimmer(fig.24)

- Attach the micro shaver trimmer
 - Hold the groomer so the micro shaver gently touches your face in a 45 degree angle.
 - Use short, well-controlled movements to shave around your beard/moustache. Use your free hand to stretch your skin. This encourages the hair to stand upright, making it easier to shave.
- Note: the micro shaver was designed to shave the detail areas around your beard/moustache/sideburns. It was not designed to shave your entire face. For a close comfortable shave, guaranteed, use one of ante electric shaver.

To remove hair from nose and ear(fig.23)

- Attach nose trimmer attachment.
 - Insert the personal groomer gently into nostril or ear.
 - Gently move the groomer in and out of the nostril or ear and at the same time rotate.
 - Avoid inserting the cutting unit more than 6mm into your nostril or ear.
- Attaching and removing the trimmer comb attachment
Note: always ensure the personal groomer is switched off before changing any attachments.
- Tips for best results
- Beard, moustache and sideburn hairs should be dry.
 - Avoid using lotions before using your personal groomer. Comb your hair in the direction that it grows.
 - Remove trimmer comb attachment if you are: defining hairline edges such as sideburns, trimming the nape of your neck, trimming your beard line on front of neck.

CARE FOR YOUR PERSONAL GROOMER

Cleaning and maintaining your personal groomer

- After each use
 - Turn the personal groomer off.
 - Gently brush the remaining hairs away/rinse under warm water from the guide comb and trimmer blade.
- Cleaning cautions

- Only the guide comb attachment and trimmer blade may be removed from the product for cleaning.
- Cleaning should only be done with a soft brush, such as the brush supplied with the product.
- Only use the light-grade oil supplied or sewing machine oil on the blades.
- Do not use harsh or corrosive cleaners on the units or their blades.
- The product can be washed all over the body, but please clean the water droplets at the charging place before charging to avoid accidents

Storage

- Always store this appliance and cord in a moisture-free area. Do not store it in temperatures exceeding 140 f (60 C).
- Do not wrap the cord of the charging adaptor around the appliance.

IMPORTANT SAFETY INSTRUCTIONS

- Warning-to reduce the risk of burns, electrocution, fire, or injury to persons:
 - An appliance never be left unattended when plugged into a power outlet.
 - Keep the power plug and cord away from heated surfaces.
 - Make sure the power plug and cord do not get wet.
 - Do not plug or unplug the product with wet hands.
 - Do not use the product with a damaged cord.a replacement can be obtained via our international service centres.
 - Charge, use and store the product at a temperature between 15C and 35C.
 - Always unplug from the mains when cleaning.
 - Only use the parts supplied with the appliance.
- Keep this product out of reach of children. The use of this appliance by persons With reduced physical, sensory or mental capabilities or lack of experience and Knowledge can give cause to hazards. Persons responsible for their safety Should give explicit instructions or supervise the use of the appliance.

PROTECT THE ENVIRONMENT

- Do not dispose the remaining hairs in household waste at the end of it's useful life.

- Disposal can take place at our service centers or appropriate collection sites.
- Caution: do not put in fire or mutilate your battery packs they may burst or release toxic material.
- Do not throw away the appliance with the normal household waste at the end of it's life, but hand it in at an official collection point for recycling. By doing This, you help to preserve the environment(fig.25)

BATTERY REMOVAL

Lift the battery out of the housing by using a scissor cut down the connection between the body and the power line. Twist the connecting wires until they break(fig.26)

- The battery must be removed from the appliance before it is scrapped. The battery is to be disposed of safely.
- 1. Unplug groomer from outlet to avoid risk of electrical shock.
- 2. With wire cutters, clip the wires leading to the batteries.
- 3. Remove rear groomer cover by first prying the rubber panel from the product with a flat head screwdriver. Pry the on/off switch from the product by head screwdriver. Unscrew the upper housing by head screwdriver and pry the upper housing from the product with a flat head screwdriver. This will expose the batteries.
- 4. Remove the batteries from the product. Contact your local authorities for proper disposal.

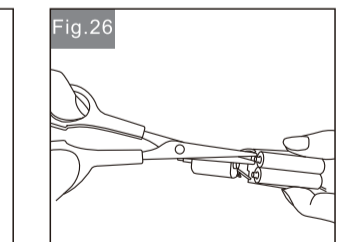
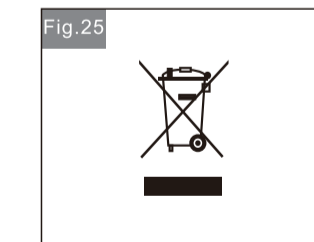

Thank you for shopping at Ufree. If you have any suggestions or questions about our product,please feel free to send us an email. Ufree attach great importance to the customer experience. We will help you solve it at the first time.

Email: service@ufree.net