



2.4 GHZ Wi-Fi Smart Door Controller for Access control ZEM-CWI

An FPC Security Company
786-442-1220
www.zemgosmart.com



Thanks for purchasing our products, please read the instructions before installing and programming the device. For more detailed functions and user setting please refer to the User manual: <https://www.zemgosmart.com/cwi-manual/>

SCAN THE QR CODES BELOW TO WATCH SALES & INSTALLATION VIDEOS



www.zemgosmart.com/vid1/



www.zemgosmart.com/vid2/

General Information

The Wi-Fi Smart controller **ZEM-CWI** is designed for electric locking devices (Automatic door Openers, Maglocks, Electric strikes, drop bolts, ETC) that can be installed in gates, main doors, side doors and another type of doors, plus other electrical equipment that will be controlled remotely via WIFI that you can see it from anywhere in the world as long as you have internet access on your computer, smartphone or tablet.

ZEM-CWI can be controlled via our **OpenSEE** app.

Features:

- Remotely Control doors or other electrical equipment via mobile app.
- No monthly fees, Self Monitoring, DIY - Plug and play, No Contracts and No-Hassle
- Web access: <https://m.openseewebapp.zemgosmart.com/> You may use this webaccess by any browser on your computer. You may use it on a Microsoft computer or Mac, smartphone and tablet.
- Be notified in real time by push notifications.
- 4 Universal Inputs and Outputs (Open collectors)
- 1 Relay Output for stand alone systems.
- 990 Users who have permission to control.
- You can add unlimited doors and unlimited CWI Devices.
- Real time status of your devices.
- Create Permission schedules for users and devices.
- Event log and notifications, Low power consumption.
- You may view this app on a smartphone, Smart Tablet and Normal PC.
- Apple and Google Play app: " Opensee"
- 3 years Warranty
- The range between the router and the CWI Smart Controllers is from 6.6 feet up to 164 feet.

How Does It Work?



Connect all types of Locks, receiver and exit buttons to the I/O 5 of the ZEM-CWI and four I/Os for connection with access control panels and Automatic Door Openers. The ZEM-CWI can be controlled with the OpenSEE app or web browser via WiFi.

System Overview

1. Light indicators.
2. Frontal case opening slot.
3. USB Mini-B port for controller programming. (Only used for emergency purposes)
4. Terminal block for external connections.
5. Pair button for activating the module's Wi-Fi configuration mode.

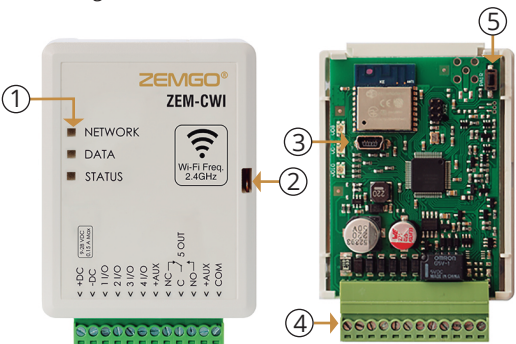

How to Download the OpenSee App

Step 1: Open up a third party QR scanner app and scan the QR codes on the back of the physical Device (Zem-CWI) Smart Controller.

Step 2: Search the word "Opensee" on the Play Store for Android phones or you may search "Opensee" on the App store for Apple phones.

Step 3: Below you will also find QR codes for Google and Apple. Please make sure you open up your third party QR code app.



Control the system
with our FREE
mobile app



Setting up the OpenSee App (For Android Devices)

Step 1: Go to your smartphone and open the (Opensee app) and Click on Register.



Step 2: Register.

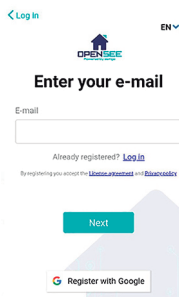

Or you can enter a valid email address and click next

You can register with your Google Account

Step 3: Check your email and enter the 3-digit code. (If you registered with Google please skip this part).

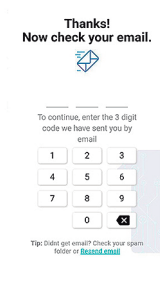

Step 4: If you registered by using your email enter the username and password then tap Finish (If you registered with Google please skip this part).

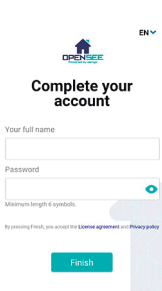

Step 5: If you press Next this will take you to the wiring diagrams. For all other types of connections that are not shown here, please contact our Technical Department via email (sales@zemgosmart.com) or you may call us at 1-888-504-3318. We will be more than happy to create customized Diagrams.

If you already wired your device press skip.

What's in the box

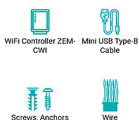

Pair the Device with the Wi-Fi Option

Note: During pairing mode please disable your mobile data on your phone's settings.

Step 1: Open the lid. Use a flat screwdriver to remove the ZEM-CWI lid.

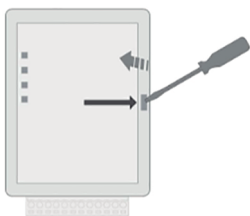

Step 2: Press PAIR button. Connect controller to power. Press and hold the PAIR button for 3 seconds. The NETWORK indicator will start fast flashing green and yellow. Release the button.

Connect to Device Scan Using Wi-Fi

Step 1: Select Scan Using Wi-Fi.



Step 2: Tap Skip.

Open the lid

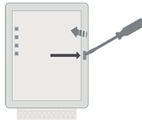

1. Use a flat screwdriver to remove the ZEM-CWI lid.



Step 3: Tap Allow.

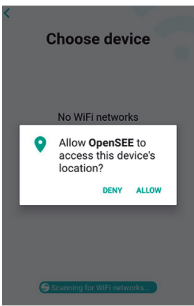

Step 4: Choose the ZEM-CWI_XXX device you want to pair.

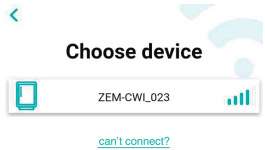

Step 5: Select your local Wi-Fi network. In this case we will select the Zemgo Smart Wi-Fi but in your case you must select your local wifi network.



Step 6: Enter your Wi-Fi password tap Connect and wait for device to connect. This process will take around 1 to 2 minutes to connect to the device.

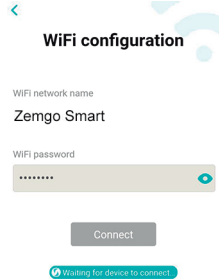

System Details

Step 1: Set system details: System Name, Address (Physical Address), Time zone.

Step 2: Select controller device: Controller mode or Wiegand mode.

System details

System name

Address

Time zone

Next

Add Connected Device

Controller type
 Controller mode Wiegand mode

Active controller

Controller name

Icon (click icon to change it)

Step 3: If you select Wiegand mode Set a Controller name and set the Icon for your device and Tap Done. For this feature you don't select any active controller.

Step 4: Tap yes if you want to add another device or tap no if you don't.

Add Connected Device

Controller type
 Controller mode Wiegand mode

Controller name

Icon (click icon to change it)

Add another device?

Yes **No**

Tip:
 You can always add more devices at the app settings.

Step 5: Tap yes if you want to add another user or tap no if you don't.

Note: You can also add the system by two additional methods, by scanning the QR code on the back of the device and by entering the Unique ID printed on the back of the device.

Do you want to add user?

Yes **No**

Tip: You may upload multiple users at once by using TrikidisConfig Windows application.

Add your system

Unique ID

Unique ID may be 12,15 or 16 symbols long.

Next

OR

Scan QR code Scan using WIFI

Skip

Home Screen Lock and Unlock

Step 1: You can access the home screen by tapping the Home Icon or by tapping on your system.

System 1 ONLINE

Settings

- Users
- Devices
- Permission schedules
- Notifications
- Transfer or delete system
- System information

System list **Home** Events

OPENSEE
 My Systems Edit

SYSTEM 1

Step 2: Whatever electrical device that you have installed, Tap on the desire one to unlock.

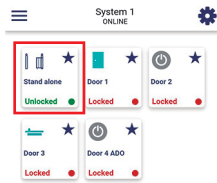

Step 4: Tap again to lock back.

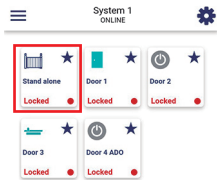

Step 3: Note: For the doors (I/Os) you have set with time delay they will automatically close after the time delay set.

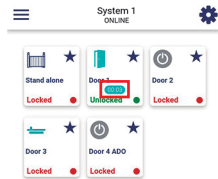

Step 5: Tap on the little star that's on the top right corner of each door to add them to the dashboard the ones marked blue are the ones added.

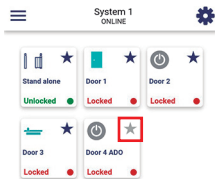

Home Screen Setting Functions

Step 1: After adding the devices you can access the settings by clicking on the Gear Icon.



Step 2: Settings.

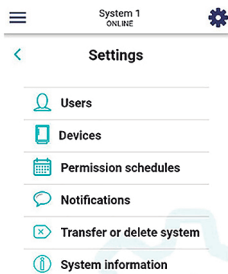

For more information on how to use all the settings please see from Section 14 until Section 18 of the User manual.

Events

Step 1: Tap on the events icon on the bottom right corner.



Step 2: See the latest event log and tap refresh if needed.

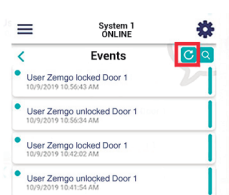

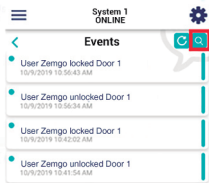

Step 3: Tap on the search to filter the event log.

System List: Shows all the CWI Systems (Physical Devices)

Step 1: Tap on the system list on the bottom left corner.

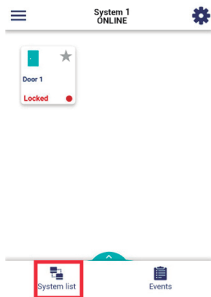

Step 2: See your system list, you can refresh the list (1), add new system (2), edit the system and/or remove the system (3), and device settings (4).



Web Browser (Web app)

The web browser is basically a way to access the OpenSee app via a web browser, you can use this web access by any browser (Google Chrome, Internet Explorer, Firefox, Safari, Opera) on your PC, laptop, tablet or smartphone. It is compatible with Windows and Mac OS.

For the web browser please go to your internet browser and type:

<https://m.openseewebapp.zemgosmart.com/>

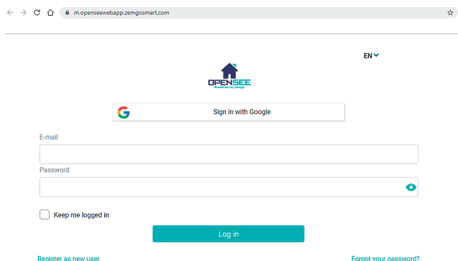

The features and settings are basically the same as the OpenSee app, please refer to section "4.0 Setting up the OpenSee app" of the user manual.