

USER MANUAL

CHARGE & GO MAX JMP3500

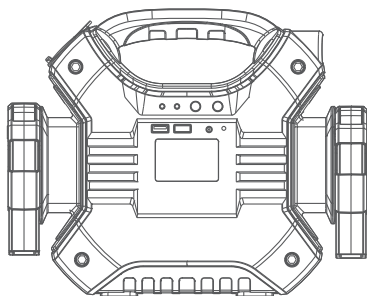

35000mAh

Please read the entire manual before use.

BATTERY LEVEL INDICATOR

Press the POWER button to check the battery level of the unit. Note: If the battery charge is below 20% the display will show "LOW BATTERY RECHARGE NOW"

LED FLASHLIGHT MODES

Press and hold the POWER button for 2 seconds to turn the LED light ON. The screen will show "LIGHT". Press the power button again to switch to flashing light mode. The screen will show "FLASH". Press the power button once more to switch to S.O.S mode. The screen will show "S.O.S." Pressing the power button again will turn off the light.

RECHARGING THE UNIT

To charge the jump starter, use the included AC wall charger. Only use the chargers provided with this unit. Insert the adapter's charging connector into the charging input socket on the control panel of the jump starter. A digital display will show "CHARGING BATTERY" and the battery's percentage of charge will show. The display will show "100%" once the internal battery is fully charged. In order to fully recharge the unit, please allow for 7 hours of charge time. To extend battery life, charge the unit every 3-6 months. Disconnect unit when fully charged.

Thank you for choosing the JMP3500 jump starter. Please read this manual carefully before use and keep for future reference.

SAFETY & MAINTENANCE

- This unit is designed to jump start 12V & 24V vehicle batteries. Do not use on 6V batteries. If the vehicle does not start immediately, wait for 1 minute to allow the unit to cool before trying again. To avoid damage to the starter motor, visit an Interstate All Battery Center for a battery test, if it does not start after five attempts.
- Do not open this unit. Opening the unit may break or damage components and will void the warranty.
- Do not place the unit in a high intensity magnetic field. This may damage components that may cause the unit to fail.
- The unit is not water proof. Do not use in wet conditions. Water may short-circuit the unit and may cause excessive heat, product deformation, damage or explosion.
- Not to be used by children.
- Recharge the unit every 3-6 months for best performance (even if the unit has not been used). This will extend the life of the battery.

SAFETY & MAINTENANCE

- Do not throw unit into fire.
- Use only the provided smart clamps and AC charger provided with the unit.
- Once product life is complete, please recycle as a rechargeable lithium battery in accordance with local regulations.
- This unit is to be used in emergency situations to jump start a vehicle. It is not to be used in place of the vehicle battery.
- When in use, do not allow the positive and negative clamps to touch. This may result in sparking, short circuit and may compromise safety.
- When a vehicle battery is less than 3 volts the unit's jump start capabilities will be disabled.
- The unit may get hot while charging. This is normal. Use caution when handling. Disconnect the unit when fully charged.
- Before using the product to jump start a vehicle, turn off all electric equipment on the vehicle (lights, air conditioning, navigation, etc.).

PRODUCT DESCRIPTION

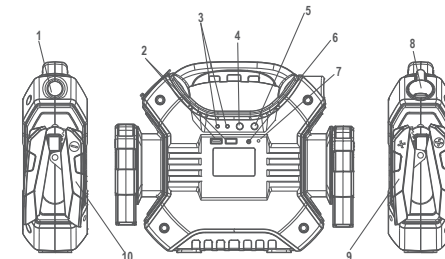

1. LED Work LIGHT
2. USB Output Ports
3. Voltage Select Buttons
4. Override Button
5. Main Power Button
6. 15V1A Input Port
7. Reversed Polarity Indicator Light
8. 12VDC Output Port
9. Battery Clamp Cable POS (+)
10. Battery Clamp Cable NEG (-)

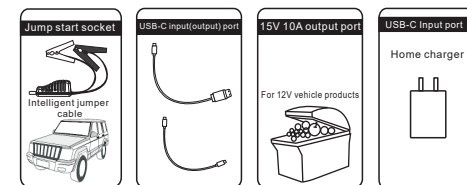

CHARGING ELECTRONIC DEVICES

To power and charge electronic devices, plug in the 3-in-1 USB cable into one of the 5V USB output ports. Connect the cable to your device and press the POWER button on the unit. The screen will show "USB 12V ON".

POWERING DC 12V DEVICES

The DC Output Port provides continuous 12V at a maximum of 10A and can be used to power 12V devices such as power tools, coolers, inflators etc. Before using this feature, ensure that the jump starter is fully charged. Plug the device into the port and power the device as usual. When finished, unplug the device from the jump starter and be sure to recharge the jump starter so it is prepared for future use.

JUMP STARTING A VEHICLE

Before attempting to jump start a vehicle, make sure the unit's battery level is not below 50%.

1. Connect the red battery clamp to the positive (+) battery terminal and the black battery clamp to the negative (-) battery terminal. When the connected to a 12V battery, the screen will display "12V JUMP START READY". When connected to a 24V battery, the screen will display "24V JUMP START READY".

JUMP STARTING A VEHICLE

2. Attempt to start vehicle.
3. Once the engine has started, disconnect the Clamps from the vehicle battery.

If starting is unsuccessful, wait one minute and repeat steps 1, 2 & 3.

NOTE: Remove the product from the vehicle within 30 seconds of jump starting. If not, it could lead to damage.

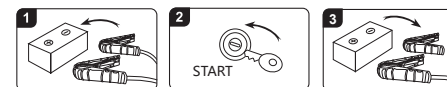

If the vehicle battery is below 5V, automatic 12V/24V detection will not be active and will need to be overridden. After determining the battery voltage, press the OVERRIDE button and the screen with flash 12V 24V at the same time. Within 6 seconds, press and hold for 2 seconds either the 12V or 24V button. The screen will then display either "12V JUMP START READY" or "24V JUMP START READY" and you may attempt to jump the vehicle.

After connecting clamps there is an alarm or beeping sound with the screen indicating "OUTPUTS LOCKED", "SHORT CIRCUIT", "CHECK ALL CONNECTIONS" or the Reverse Polarity Indicator Light is ON, immediately disconnect the clamps and connect correctly. Re-power the unit to resume operation.

TECHNICAL SPECIFICATIONS

Capacity	35,000mAh
Dimensions(L,W,H)	11.49 x 9.17 x 3.11in (292 x 233 x 79mm)
Weight	5.95lb (2700g)
Built-In Battery	High Rate Discharge LiFePo4 Battery
Input Recharging	15W/1A
Fully Charged Time	Approx. 7 hours
Jump Start Output	Supports 12V & 24V Battery System Vehicle
Output	5V/1A, 5V/2A, 12V/10A
Bulb Type	Ultra Bright LED Flashlight/SOS/Strobe
Starting / Peak Amps	12V 600A, 24V 300A / 12V 1200A, 24V 600A
Operation Temperature Range	-4°F to 140°F (-20°C to 60°C)
Lifecycle	>500 times
Safety Technology	MultiSafety Protection



All rights reserved. Reproduction in whole or in part without written permission is prohibited. All other trademarks are trademarks of their respective owners. Features and specifications are subject to change without notice.

866.842.5368

CustomerService@interstatebatteries.com

Distributed by Retail Acquisition and Development, Inc.
Urbandale, IA 50323

©2022 Interstate Batteries

MADE IN CHINA

