

HOOMESUN

MANUAL FOR INDOOR DRYER VENT

Indoor Dryer Vent Kit with Lint
Trap – Dryer Lint Catcher

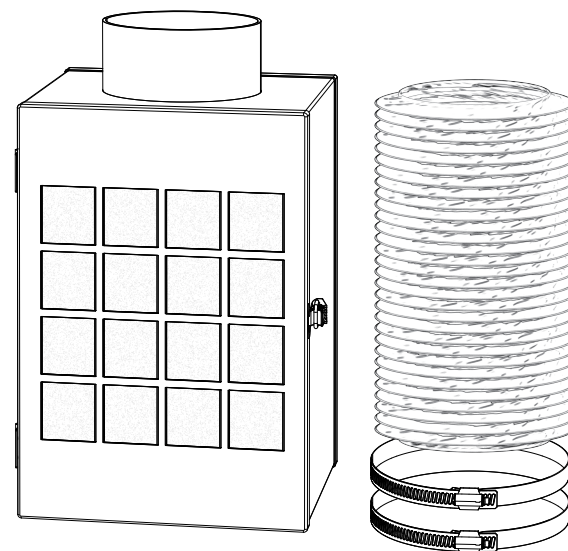

Product Content:

- 1PC x Indoor Dryer Vent
- 2PCS x Hose Clamps
- 1PC x 4-Inch Aluminum Foil Dryer Vent Hose
- 1PC x Metal Screen Filter
- 4PCS x Replacement Polyester Filters
- 4PCS x Screws
- 4PCS x Expansion Nylon Anchors

Product Details:

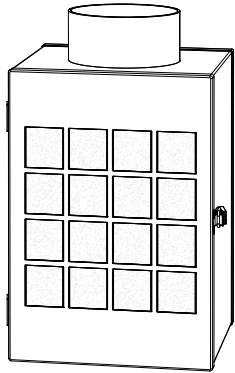

Indoor Dryer Vent:

Material: Metal, Durable construction for long-lasting use.
Features safety vent flap for reminding to clean the dryer vent.
Facilitates easy installation, maintenance and saves energy.

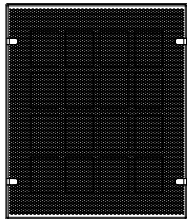

Metal Screen Filter:

Captures larger lint particles, preventing them from entering the vent hose.

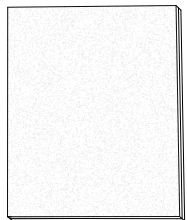

Polyester Filters:

Polyester filter traps the finest dust particles ensures a healthy indoor environment.
Our dryer vent comes with 4 polyester filters for replacement.

Product Details:

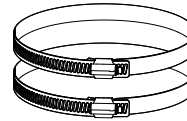

Hose Clamps:

Quantity: 2
Material: 201 stainless steel
Size: Suitable for securing the dryer vent hose to the indoor dryer vent

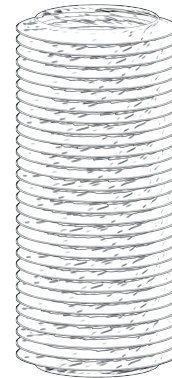

Dryer Vent Hose:

Length: 8 feet
Diameter: 4 inches
Material: Aluminum foil
Designed for efficient ventilation, ensuring proper airflow from the dryer to the indoor dryer vent.

Reminder Device:

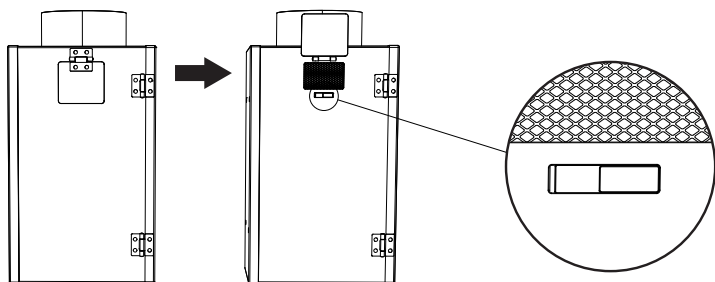

① When you forget to clean the screen or filter, the safety vent flap will automatically open to keep your dryer from overheating, this indicates that you need to clean the dryer vent.

② It comes with a rubber magnet, which can be cut to the right size magnet for your needs, can be used to replace or adjust the magnitude of the magnetic.

Polyester Filter Placement:

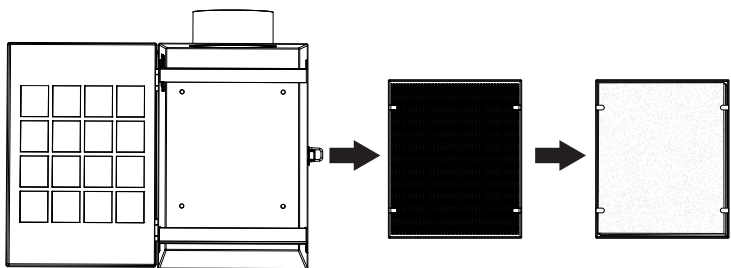

Open the lid of the dryer vent.
Remove the metal screen filter and place the polyester filter in it.

Installation Position Confirmation:

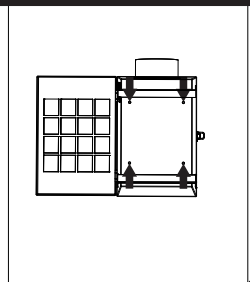

Confirm the desired installation position.
Trace points through the holes of the product onto the mounting surface.

Installation:

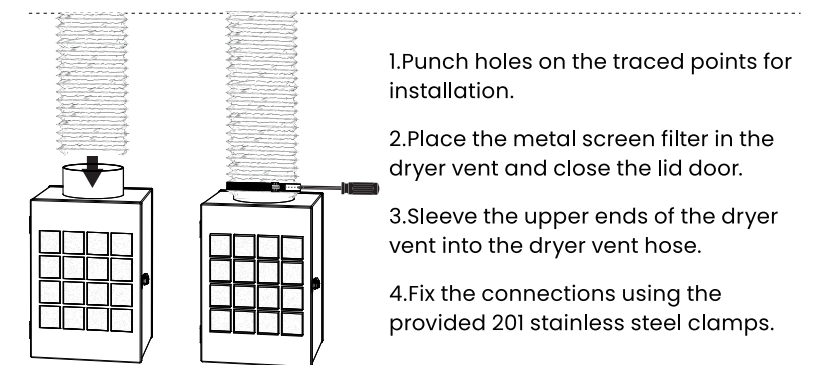
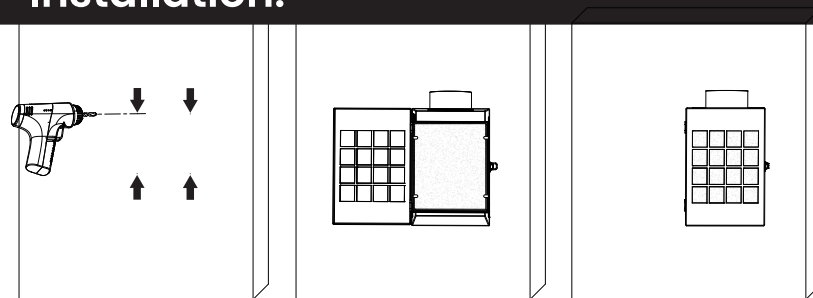

- 1.Punch holes on the traced points for installation.
- 2.Place the metal screen filter in the dryer vent and close the lid door.
- 3.Sleeve the upper ends of the dryer vent into the dryer vent hose.
- 4.Fix the connections using the provided 201 stainless steel clamps.

Note:

We guarantee that the product is properly installed, reasonably operated and maintained, and can be used well within the service life of the product. If you have any questions or suggestions about the product, please contact our service team: support@hoomesun.us

- 1.It is generally recommended to clean the dryer vent every 2-3 uses or as per individual frequency of use and laundry load.
- 2.Regular replaced polyester filters ensure optimal performance and prevents lint buildup.
- 3.Follow recommended cleaning intervals to maintain production efficiency.
- 4.Turn off the dryer before installing or cleaning the dryer vent .
- 5.Follow the recommended cleaning guidelines to avoid fire hazards.
- 6.Keep the dryer vent and vent hose clear of obstructions for efficient airflow.
- 7.For assistance or further inquiries, contact our customer support team at support@hoomesun.us.