

1. Package Contents

Baseus Security X1 Pro Outdoor Dual Camera 3K

X1 Pro Camera × 1 (Model No.: S00035)
Solar Panel (with 4m Charging Cable) × 1
Solar Panel Mounting Bracket × 1

Camera Mounting Bracket × 1
Camera Base × 1
Screw Pack × 1
Mounting Sticker × 2

2. Product Overview

- | | | | |
|---------------------------|---------------------------------|-----------------------------|---------------------------------|
| ① Solar Panel | ⑥ MIC | ⑪ Speaker | ⑮ Horizontal Adjustment Joint |
| ② Mounting Bracket | ⑦ Working Status Indicator | ⑫ USB Charging Port | ⑯ Adjustment Joint |
| ③ Base | ⑧ PIR Sensor (Motion Detection) | ⑬ Sync Button | ⑰ Camera Bracket Release Button |
| ④ Camera Mounting Bracket | ⑨ Spotlight | ⑭ microSD Card Slot | ⑱ Angle Lock Switch |
| ⑤ Charging Cable | ⑩ Lens | ⑮ Vertical Adjustment Joint | |

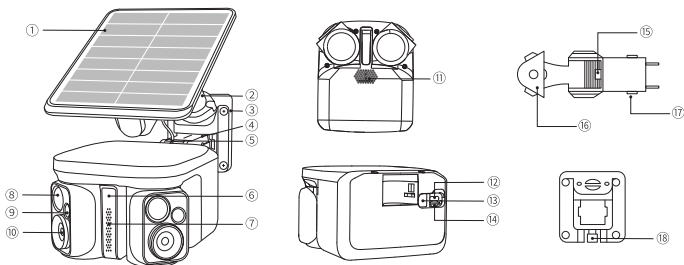

3. Setup Instructions

Download the App for Synchronization



baseus Security



Google Play and the Google Play logo are trademarks of Google Inc.



Apple and the Apple logo are trademarks of Apple Inc.

1. Download and install the baseus Security APP, and register an account.
2. Follow the instructions on the screen to add the camera to your device list.

4. Camera Charging



Please fully charge cameras before first use. It takes about 5.5 hours to charge each camera.

Charge Indicator Instructions

Indicator Light	Charging: Slowly flashing blue
	Fully Charged: Off
Charging Time	5.5 hours

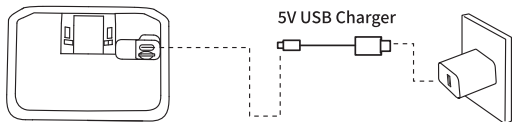

X1 Pro comes with a detachable solar panel, giving you the flexibility to position it for optimal sunlight exposure, independent of the camera's placement.

Equipped with Baseus Security's patented sun-tracking technology, the panel automatically rotates horizontally up to $\pm 60^\circ$ to maximize solar absorption. If the battery level drops, it's typically due to limited sunlight or increased power consumption. Manual charging isn't necessary unless a low battery alert appears.

For safe and reliable operation, always keep the area around the panel clear to prevent contact or collisions with nearby objects during movement.

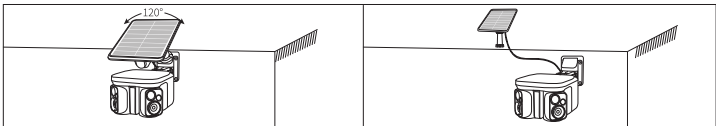

5. Camera Installation

1. Choose a location where you can get the ideal viewing angle.

We recommend to mount the camera 7-10 feet (2-3 meters) above the ground.

Recommended installation area:

1. Under the eaves or on the exterior wall near the front door
2. Corners of exterior walls
3. Any poles or fences with unobstructed sunlight

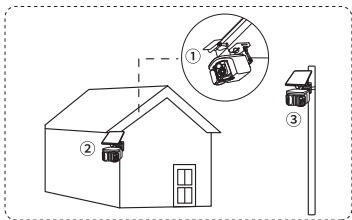
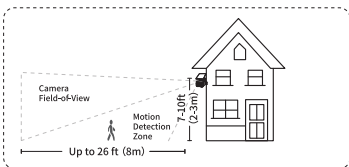

2. Camera Bracket Installation:

Align the bracket with the mounting slot on the camera, then push it until it clicks into place.

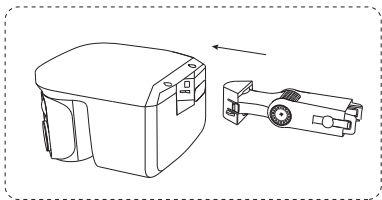

3. Base Installation:

Drill holes with a 15/64-inch (6mm) drill bit and insert expansion bolts into the holes.

Note: Expansion bolts are necessary for walls made of hard materials such as concrete, brick, or stucco.

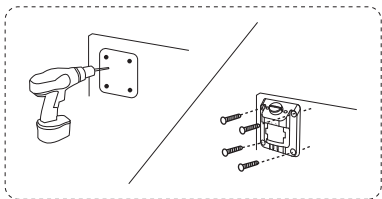

4. Solar Panel Installation:

Option 1: Attach the Solar Panel Mounting Bracket to the camera base using screws, then fasten the solar panel onto the bracket.

Option 2: Choose another location, drill holes using a 15/64-inch (6mm) drill bit, and secure the Solar Panel Mounting Bracket with expansion bolts. Then fasten the solar panel onto the bracket.

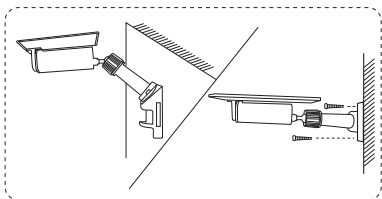

5. Camera Detachment & Reattachment:

Press both Camera Bracket Release Buttons and pull outward to remove the camera from the base.

Press both buttons and push inward to reattach the camera on the base.

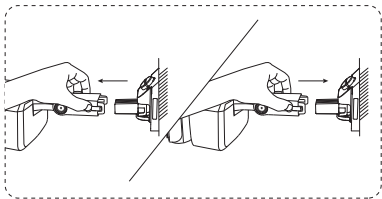

6. Angle Adjustment

- ① Press the Angle Lock Switch on the base to adjust the camera horizontally to 0°, -45°, or +45°. The angle will auto-lock once adjusted.
- ② Rotate the horizontal adjustment joint on the bracket to adjust the angle horizontally by $\pm 40^\circ$.
- ③ Rotate the vertical adjustment joint to adjust the angle vertically by $\pm 90^\circ$.
- ④ Use the baseus Security app to check the live view and make final adjustments for the optimal viewing angle.

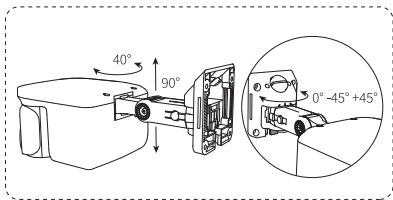

For troubleshooting, turn to the Service section in the baseus Security app for help. You can reach our customer support team via live chat, email, or phone.

6. Product Specifications

Baseus Security X1 Pro Outdoor Dual Camera 3K	Resolution	2560x1440 + 2560x1440
	Night Vision	Color Night Vision
	Input	5V=2A (Max.)
	Waterproof Rating	IP65

*The above data are provided by the Baseus Lab; actual use will vary depending on the specific circumstances.

7. Notice

The device is not a toy.

Choking Hazard: The product contains (or comes with) small parts, plastic elements, cables, and parts that may cause choking hazards. Keep your camera and its accessories out of the reach of small children. Consult a physician immediately if small parts are swallowed.

Strangulation Hazard: Children get strangled in cords. Keep cords out of the reach of children (more than 3ft/0.9m away).

The suitable temperature for S00035 and accessories is -20°C to 50°C (Charging temperature is 0°C to 40°C).

When charging, please place the device in an environment that has a normal room temperature and good ventilation.

Unless specifically indicated that it is safe to do so in the user guide or instruction manual, do not use this device in an environment that exceeds the recommended low or high temperature.

Unless specifically indicated that it is safe to do so in the user guide or instruction manual, avoid exposing your device to direct sunshine or excessively wet environments.

For pluggable equipment, the socket outlet shall be easily accessible.

Use only the adapter provided by the manufacturer. Using unauthorized adapters may cause danger and violate the authorized use of the device or the warranty article.

CAUTION: RISK OF EXPLOSION IF BATTERY IS REPLACED BY AN INCORRECT TYPE. DISPOSE OF USED BATTERIES ACCORDING TO THE INSTRUCTIONS.

IC NOTICE TO CANADIAN USERS

This device contains licence-exempt transmitter(s)/receiver(s) that comply with Innovation, Science and Economic Development Canada's licence-exempt RSS(s). Operation is subject to the following two conditions:

- (1) This device may not cause interference.
- (2) This device must accept any interference, including interference that may cause undesired operation of the device.

L'émetteur/récepteur exempt de licence contenu dans le présent appareil est conforme aux CNR d'Innovation, Sciences et Développement économique Canada applicables aux appareils radio exempts de licence. L'exploitation est autorisée aux deux conditions suivantes:

- (1) L'appareil ne doit pas produire de brouillage;
- (2) L'appareil doit accepter tout brouillage radioélectrique subi, même si le brouillage est susceptible d'en compromettre le fonctionnement.

CAN ICES-003(B)/NMB-003(B)

This Class B digital apparatus complies with Canadian ICES-003.

(Cet appareil numérique de la Classe B conforme à la norme NMB-003 du Canada).

Radiation Exposure Statement Déclaration d'exposition aux radiations

The product complies with the Canada portable RF exposure limit set forth for an uncontrolled environment and is safe for intended operation as described in this manual.

Le produit est conforme aux limites d'exposition pour les appareils portables RF pour les États-Unis et le Canada établies pour un environnement non contrôlé.

8. Safety



This symbol indicates that this product shall not be treated as household waste. Instead, it shall be handed over to the applicable collection point for the recycling of electrical and electronic equipment. Follow local rules and never dispose of the product with normal household waste.

FCC Statement

This device complies with Part 15 of the FCC Rules. Operation is subject to the following two conditions:

- (1) this device may not cause harmful interference, and
 - (2) this device must accept any interference received, including interference that may cause undesired operation.
- Any Changes or modifications not expressly approved by the party responsible for compliance could void the user's authority to operate the equipment.

This equipment has been tested and found to comply with the limits for a Class B digital device, pursuant to part 15 of the FCC Rules. These limits are designed to provide reasonable protection against harmful interference in a residential installation. This equipment generates, uses and can radiate radio frequency energy and, if not installed and used in accordance with the instructions, may cause harmful interference to radio communications. However, there is no guarantee that interference will not occur in a particular installation. If this equipment does cause harmful interference to radio or television reception, which can be determined by turning the equipment off and on, the user is encouraged to try to correct the interference by one or more of the following measures:

- Reorient or relocate the receiving antenna.
- Increase the separation between the equipment and receiver.
- Connect the equipment into an outlet on a circuit different from that to which the receiver is connected.
- Consult the dealer or an experienced radio/TV technician for help.

FCC Radio Frequency Exposure Statement

The device has been evaluated to meet general RF exposure requirement. The device can be used in fixed/mobile exposure condition. The min separation distance is 20cm.

The following importer is the responsible party (for FCC matters only)

Company Name: BASEUS TECHNOLOGY (US) INC

Address: 421 S BROOKHURST ST SUITE 1312

ANAHEIM, CA 92804

Telephone: +6-145412699



This product complies with the radio interference requirements of the European Community.

Declaration of Conformity

Shenzhen Baseus Technology Co., Ltd. Declares that the product is in compliance with Directive 2014/53/EU. The full text of the EU declaration of conformity is available at the following internet address:

<https://eu.baseus.com/pages/euro-compliance>.

RF exposure notice:

The Maximum Permissible Exposure (MPE) level has been calculated based on a distance of $d=20\text{cm}$ between the device and the human body. To maintain compliance with RF exposure requirement, use product that maintain a 20cm distance between the device and human body.

Frequency bands and power are as below:

Model	Function	Operation Frequency	Max. RF Power
S00035	Wi-Fi	2412-2472MHz	EIRP 16.43dBm
	Bluetooth	2402-2480MHz	EIRP 6.78dBm

The Bluetooth® word mark and logos are registered trademarks owned by the Bluetooth SIG, Inc. and any use of such marks by Shenzhen Baseus Technology Co., Ltd. is under license. Other trademarks and trade names are those of their respective owners.

9. Customer Service

For troubleshooting and tutorial videos,
please visit

<https://support.baseus.com>

or scan the QR code below:



Warranty	24-month limited warranty
	support@baseussecurity.com
	United States Tel: +1(800)2208056



Facebook
[@Baseus.fans](#)



Instagram
[@baseus_global](#)



X (Twitter)
[@Baseus_Global](#)



YouTube
[@Baseusofficial](#)



TikTok
[@baseus.us](#)