

BEAUTURAL

24-Hour Customer Service & 2-Year Warranty

Phone: +1 909-391-3888
(Mon-Fri 9:00am - 5:00pm PST)
US: ushelp@1byonebros.com
CA: cahelp@1byonebros.com
Website: www.1byonebros.com

If any accessory is missing from the package or there are any issues with the product, please get in touch with our official customer service. We will be pleased to serve you!

1byone Products Inc.
1230 E Belmont Street, Ontario, CA, USA 91761
Customer Service: +1 909-391-3888
www.1byonebros.com

Made in China

HANDHELD GARMENT STEAMER



Instruction Manual/ Manuel d'instructions/
Manual de instrucciones

Introduction

Thank you for purchasing BEAUTURAL Handheld Garment Steamer. This instruction manual contains important information about safety, usage, and disposal. Use the product as described and keep this manual for future reference. If you sell this steamer or pass it on, also give this manual to the new owner.

Safety Instructions

- This steamer can be used by children aged from 8 years and above and persons with reduced physical, sensory or mental capabilities or lack of experience and knowledge if they have been given supervision or instruction concerning use of the steamer in a safe way and understand the hazards involved. Children shall not play with the steamer. Cleaning and user maintenance shall not be made by children without supervision.
- The voltage of the power source must be compatible with the voltage displayed on the rating plate of this steamer.
- Never place heavy or sharp objects on the steamer's power cable.
- All cables should be positioned so they cannot be tripped over or become obstructions.
- It is recommended to not plug in any other appliances into the same circuit when the garment steamer is in use to avoid overload.
- If the supplied power cord is damaged, it should be replaced by a qualified technician.
- Do not expose the steamer to humidity or use it outdoors.
- Only fill the water tank with tap or distilled water. Other liquids may damage the steamer.
- Do not put any additives in the water tank. These can damage the steamer.
- Never leave the steamer unattended when it is hot, switched on, or connected to power.
- Do not use the steamer if it has fallen from a high place, or if there are visible signs of damage or leakage.
- The garment steamer provides a thermal safety fuse to protect it from over-heating. However, the steamer should not be left unattended while it is connected to power. Take care when there are children in the vicinity of the steamer.

- Never use the steamer on clothes that are being worn. Never direct the steamer towards people or animals.
- There may be leakage from the heating plate if the steamer's temperature is not high enough to vaporize water and generate steam. Therefore, make sure the steamer is always preheated for 2-3 minutes before use.
- Always unplug the steamer before attaching or detaching the attachment brush.
- Only use officially provided attachments and accessories.

Appliance Description

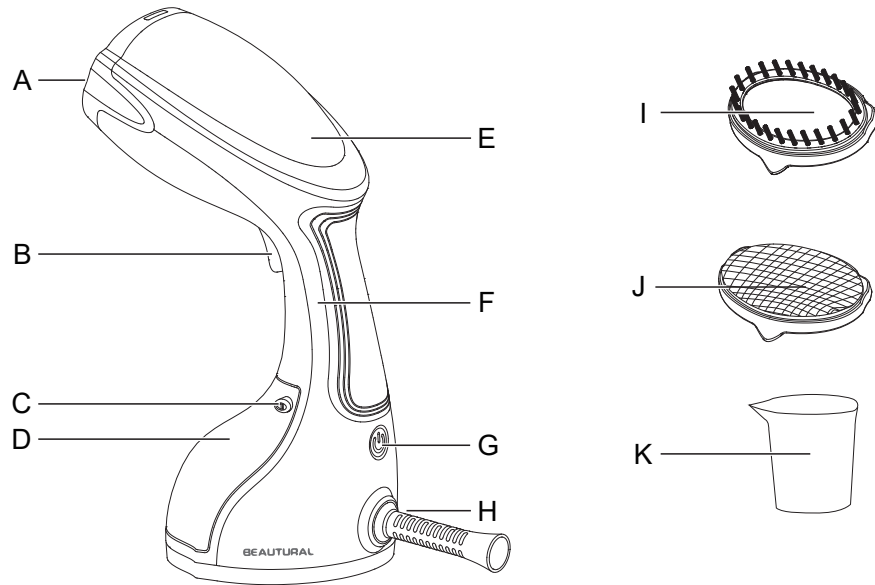

- | | |
|--|-----------------------------------|
| A. Heating Plate | F. Handle |
| B. Steam Trigger with Built-in Continuous Steam Switch | G. Power Button |
| C. Water Tank Release Button | H. Cord Guard |
| D. Water Tank (Removable) | I. Fabric Brush (Removable) |
| E. Power Indicator Light | J. Soft Cushion Brush (Removable) |
| | K. Measuring Cup |

Included Items

- | | |
|------------------------|------------------------|
| 1 x Garment Steamer | 1 x Measuring Cup |
| 1 x Fabric Brush | 1 x Instruction Manual |
| 1 x Soft Cushion Brush | |

Note: When unpacking the garment steamer, check if you have received all the items listed.

Before the First Use

When you first use the steamer, some residual water from the testing might be emitted from the heating plate. This is normal and will not affect the use of the steamer and will disappear quickly.

What Water to Use?

Using distilled, purified or filtered water is highly recommended and will reduce mineral buildup. Never use water containing additives (starch, perfume, aromatic substances, softeners, etc.), or condensation water (for example water from tumble dryers, water from refrigerators, water from air conditioning units, rainwater). This water contains organic waste materials or minerals that concentrate under the effect of heat and cause spitting, brown coloring or premature ageing of your steamer.

Before Use

Unlock and remove the water tank.

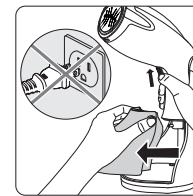

Fill the water tank with clean water. Do not overfill.

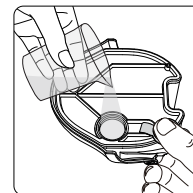

Pull off the water inlet cover.

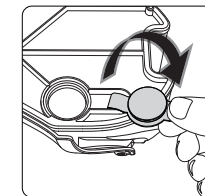

Firmly close the water inlet to prevent leakage.

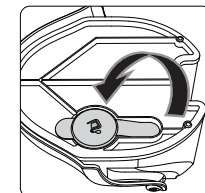

Push the water tank back into the steamer until it clicks into place.



Hang your garment on a clothes hanger.

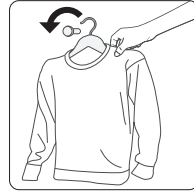

Accessories

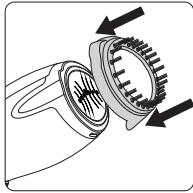

The fabric brush allows to remove lints, pet hair, dust, dirt and dander on overcoat and down jacket.

To attach: While the brush and steamer are cool, align the fabric brush to the heating plate and lock it into position (an audible "click" will be heard when correctly locked). Keep the pointed side facing downward.

To remove: Allow the steamer to cool prior to removing the brush. Put your finger under the pointed tip and lift it up.

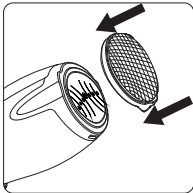
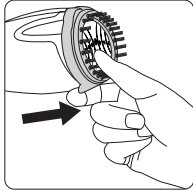

The soft cushion brush can protect delicate fabrics (such as nylon, silk and polyester) from damage caused by high-temperature panel or hot steam.

To attach: While the brush and steamer are cool, align the soft cushion brush to the heating plate and lock it into position (an audible "click" will be heard when correctly locked). Keep the pointed side facing downward.

To remove: Allow the steamer to cool prior to removing the brush. Put your finger under the pointed tip and lift it up.

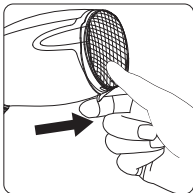

Use

Plug in the steamer.

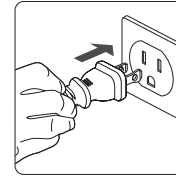

Allow the steamer to preheat, when the indicator light becomes solid the steamer is ready to use.

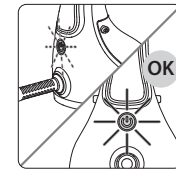

For continuous steam, lock the steam trigger by pushing the locker switch down. To release it, push it up.

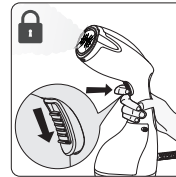

Use your free hand to keep the fabric taut and stretched. Steam the garment with slow, downward strokes, keeping the head of the steamer in contact with the fabric.

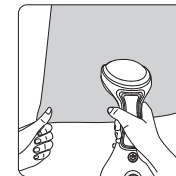

Switch on the steamer.

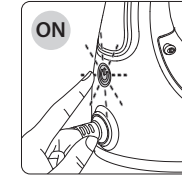

Press the steam button with the steam brush facing away from you holding it in a vertical position.

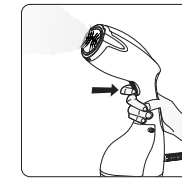

For optimal use, move the steam jets over your garment from top to bottom.

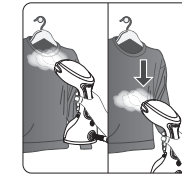

This steamer is anti-dripping, meaning it can be used horizontally to steam garments on an ironing board.

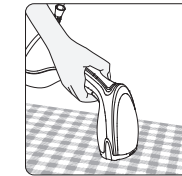

Tip: If you find the garment damp after steam ironing, stop the steam and use the heating plate to dry iron the garment for a while to make it dry.

Press the On/Off button to switch the steamer off.

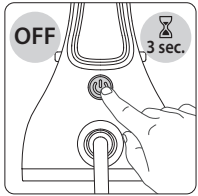

Stand the steamer on its base and allow it to completely cool off before storing.

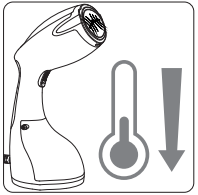

Warning: Never steam a garment while it is being worn.



Unplug the steamer.

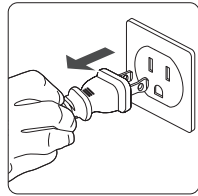

To avoid mineral buildup, empty the tank after each use.

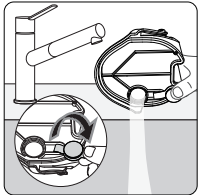

Warning: Never touch the soleplate of the steamer.

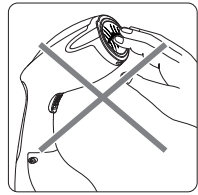

Note: When the water tank is empty, it is normal to feel or hear the water pump in the handle.

Standby Mode

- 1) For your safety, the steamer is fitted with a standby monitoring system, which is activated automatically after approximately 8 minutes without using the steam trigger.
- 2) The power indicator light flashes to indicate that the steamer is on standby mode.
- 3) To reactivate the steamer:
 - a. Press the power button and wait that the power indicator light stops flashing.
 - b. Press the steam trigger to start steaming again.

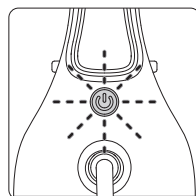
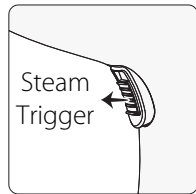

After Use

Unlock and remove the water tank.

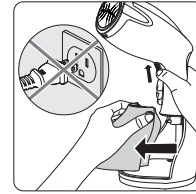

Return the water tank to its place on the steamer.

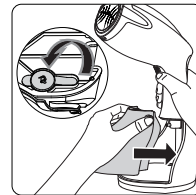

Cleaning

Wait an hour for complete cool down.

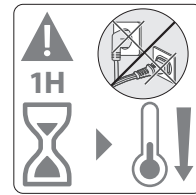

Never wash or rinse steamer directly over a sink.

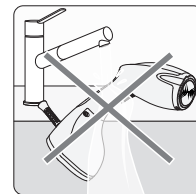

Empty the water tank completely.

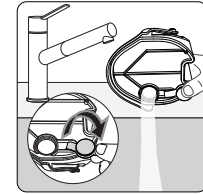

Wait for an hour for your steamer to cool before storing.



Only use a soft sponge with water to clean. Do not use any detergent product.

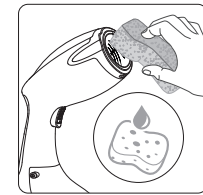

Troubleshooting

Symptom	Cause	Solution	Critical Notes
Indicator light OFF	Faulty evaporation plate	Contact after-sales service	Never disassemble evaporation plate
		Do NOT attempt repair	
Indicator light FLASHING continuously	Blown fuse (Non-120V region use)	Contact after-sales service immediately	Electrical hazard risk
		Requires component replacement	
Normal light (30s flash → steady) + NO STEAM		Follow step-by-step diagnosis:	
Water tank hose disconnected	Loose internal connection	Contact us for free tank replacement	Non-user-repairable
Water tank intact + Abnormal noise	Clogged water pump	Cleaning procedure:	Use distilled water to prevent clogs
		1. Hold steam button 30s → Remove tank if no steam	
		2. Locate water inlet hole (handle base)	
		3. Clear clog with:	
		- Compressed air (recommended)	
		- Pressurized water (syringe/tool)	
4. Reassemble & retest			

Specifications

Model: 722NA-0008, HJ-3000B

Rated voltage: AC 120V~60Hz

Rated power: 1200W

Water tank capacity: 8.8 fluid ounces (0.26 liters)

Steaming Tips

To Steam Garments

- Place the fabric in a dry and ventilated place and at least 20 cm (8 inches) away from any walls (otherwise moisture may cause mildew).
- Empty garment pockets and straighten turn-ups such as cuffs and hems.
- Hang the garment from a hanger and stretch the fabric slightly with one hand, making sure there is nothing behind the fabric that could be damaged by the steam.
- Put the heating plate against the garment, pressing and holding the Steam Activation Button while moving your arm in an up and down motion, targeting creases on the fabric.

NOTE: Do not steam over metal accessories. Use with caution when steaming around metal accessories.

WARNING: When using the garment steamer, do not touch the heating plate. This garment steamer will generate a large flow of high temperature air that can cause burns if not handled carefully.

To Steam Curtains

- Wash and dry the curtains.
- Steam when they are hanging.
- While steaming, stretch the curtains with one hand to help remove creases more easily.

To Steam Upholstery

1. The garment steamer can be used to kill bacteria, remove odors and freshen up furniture upholstery, slip covers, and cushions.
2. Move the garment steamer over the fabric, cushions should be removed for steaming. Allow cushions to dry thoroughly before placing back on furniture.



The appliance's packaging is made from environmentally friendly material and can be disposed of at your local recycling plant.

Customer Service/ Service Clients/Atención al cliente

UNITED STATES	Phone: +1 909-391-3888 (Mon-Fri 9:00am - 5:00pm PST) Email: ushelp@1byonebros.com
CANADA	Email: cahelp@1byonebros.com
UNITED KINGDOM	Email: ukhelp@1byonebros.com
GERMANY/FRANCE ITALY/SPAIN	Email: euhelp@1byonebros.com

BRAND OWNER

1byone Products Inc.
1230 E Belmont Street, Ontario, CA, USA 91761
Customer Service: +1 909-391-3888
www.1byonebros.com