

# Rear Axle Bearing Puller & Press Set

## User Manual

Read Carefully Before Use  
Keep for Future Reference



**OMT**  
Orion Motor Tech

UM-BJS-0049-V1

# Disclaimer

Read this disclaimer completely and carefully before proceeding with the rest of the manual content.

## 1. Product Modifications

Any modifications or alterations to Orion Motor Tech (OMT) products void any warranties and may result in damage or injury. OMT shall not be liable for any damages resulting from such modifications or alterations.

## 2. Compliance with Laws

Customers shall be liable for ensuring that the use of OMT products complies with all applicable laws and regulations in their respective jurisdictions. OMT shall not be responsible for any violations of laws or regulations resulting from the use of OMT products.

## 3. Correct Use

Always use OMT products only as directed in the accompanying manuals. Failure to follow instructions may result in injury or damage.

Always ensure the assembly, installation, operation, maintenance, or repair of OMT products is carried out by a competent person.

Regular maintenance should be performed throughout the lifecycle of OMT products. You are responsible for ensuring the products operate as intended.

Always wear appropriate protective gear.

## 4. Third-Party Products

OMT shall not be liable for any damages or losses resulting from the use of third-party products in conjunction with OMT products. Customers shall refer to the third-party's guidelines and/or warranties (if any) for any third-party products used.

## 5. Limitation of Liability

OMT shall not be liable for any direct, indirect, punitive, incidental, special, or consequential damages to property or life, whatsoever arising out of or connected with the use or misuse of OMT products. In no event shall OMT's liability exceed the value of the products sold.

## 6. Warranty

Refer to the sales page for warranty information.

This disclaimer states the entire obligation of OMT with respect to OMT products. If any part of this disclaimer is determined to be void, invalid, unenforceable, or illegal, including but not limited to the warranty disclaimers, liability disclaimers, and liability limitations set forth above, the invalid or unenforceable provision will be deemed superseded by a valid and enforceable provision that most closely matches the intent of the original provision and the remainder of the agreement shall remain in full force and effect.

# Contact Us

Thank you for choosing our products! If you have any questions or comments, contact us and we'll address your issues ASAP!

 [support@orionmotortech.com](mailto:support@orionmotortech.com)

 <https://orionmotortech.com/>

@OrionMotorTech



# Safety Information

## Danger

- **ALWAYS** perform all repairs in full compliance with your machinery's service manual. After any repairs, test your engine and machinery at low speed in your workshop before returning to normal use. Failing to do so may result in serious property damage or severe personal injury.
- **DO NOT** allow children, individuals with mental or physical impairments, or those unfamiliar with this product and compatible vehicle systems to use it. Unauthorized use may result in safety hazards.
- **DO NOT** use under the influence of alcohol, drugs, or medication that impairs judgment or reflexes. Keep children and bystanders at a safe distance during use.
- **NEVER** touch any heated surface with exposed skin. Contact with hot machinery parts may cause severe burns.

## Warning

- **ALWAYS** wear appropriate personal protective equipment (PPE) for your task. Use ANSI and OSHA-approved eye, respiratory, and hand protection. Microscopic particles produced during normal use are known to cause cancer, birth defects, and other reproductive harm in the state of California. Nonslip footwear is also highly recommended. Depending on your work environment, additional protection such as ear, head, and body gear may be required.
- Keep your work site clean and well-lit. Cluttered or dark work areas increase the risk of accidents and injuries.
- **ALWAYS** familiarize yourself with your machinery's safety warnings and instructions before use. Use the correct fluids, pressures, and adapters specific to your machine. **ALWAYS** secure and park the machinery properly before beginning any work.
- Before servicing your machinery, turn off the engine and secure it using chocks, jacks, or stands as outlined in the manufacturer's service manual. This will prevent accidental movement and potential injury.
- In case of emergencies, ensure a first aid kit and a communication device (e.g., phone) are readily available. Know the location of nearby emergency medical facilities.

## Caution

- For optimal performance, keep the kit clean and dry. Remove any fluid, oil, or grease before and after use. Regular maintenance is essential to ensure safe operation.
- Dress appropriately for automotive servicing. **DO NOT** wear loose clothing, jewelry, or accessories that could get caught in moving parts. Keep hair, clothing, gloves, hoses, and tools away from machinery in motion.
- Regularly inspect this product for misalignment, binding, wear, or damage before use. If any issues are found, repair or replace the damaged parts before further use. In a large shop, mark damaged tools with "**DO NOT USE**" signs until repaired. **ONLY** replace components with identical, authorized parts.
- Machinery repair can be inherently dangerous. This manual and the machinery service manual cannot cover every possible situation. **ALWAYS** use caution, exercise good judgment, and seek training if needed.

# Specifications

Rear Axle Bearing Puller Tool Set		
Case Dimensions	10.1 × 4.7 × 2.6 in.	25.6 × 11.8 × 6.7 cm
Net Weight	3.3 lb	1.5 kg
Bearing Race & Seal Driver Set		
Case Dimensions	10.24 × 5.91 × 3.58 in.	26 × 15 × 9.1 cm
Net Weight	3.5 lb	1.6 kg

## Parts List

### Pullers



1 3/8" to 2 7/8"



1 5/16" to 2 3/8"



1 1/4" to 1 7/8"

### Driver Discs



1.55 in.  
(39.5 mm)



1.75 in.  
(44.5 mm)



1.97 in.  
(50 mm)



2.32 in.  
(59 mm)



2.48 in.  
(63 mm)



2.56 in.  
(65 mm)



2.83 in.  
(72 mm)



3 in.  
(76 mm)



3.19 in.  
(81 mm)

### Driver



# Operation

## Warning

- Shut the engine before servicing. Ensure the vehicle is stationary and the engine has cooled to room temperature before performing maintenance or adjustments.
- Use the correct tools and personal protective equipment (PPE) before operating. Be **EXTREMELY** careful around possible pinching points, moving parts, or parts that may suddenly spring out.
- Make sure your surroundings are safe when using the tool. Avoid operating in crowded or unstable areas.
- Make sure the work area is clean and clear of any clutter or dirt that may affect operations.
- **ALWAYS** ensure that your vehicle has been jacked up and is adequately supported with axle stands.
- **DO NOT** force the tool. Excessive force may cause serious personal injuries and severe property damage.
- For added safety, we recommend training before using these tools. A lack of training could result in serious injury.

## Removing the Bearing

**Note:** Select the proper puller for your bearing's size referring to your vehicle's manual.

1



2



3

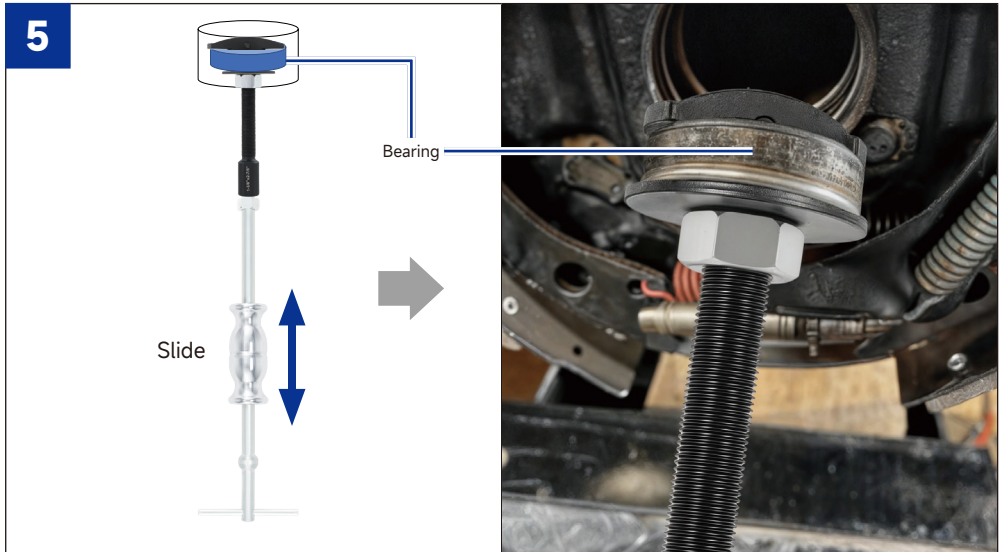
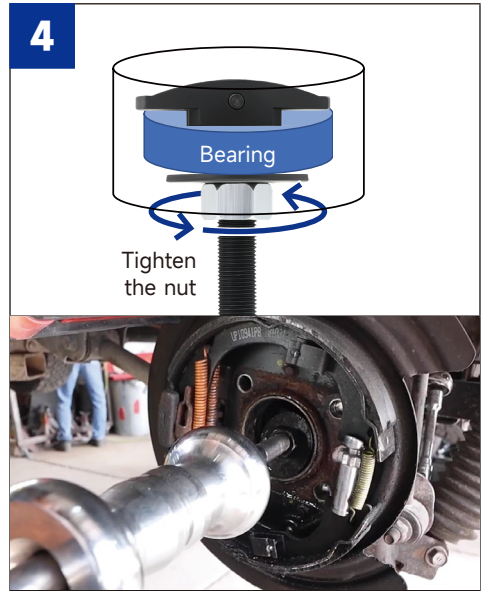
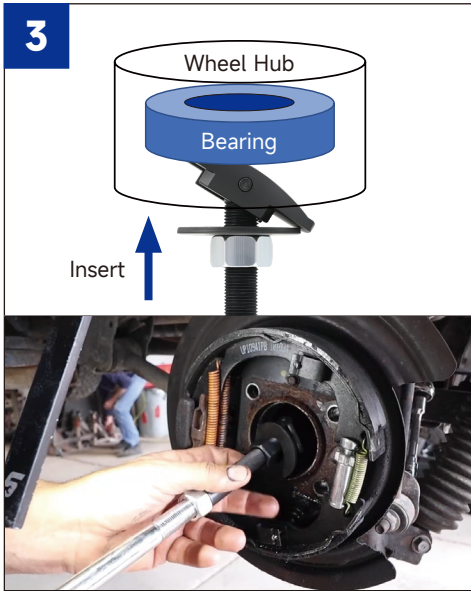

# Installing the Bearing Race or Seal

**Note:** Select the proper driver disc for your race or seal.

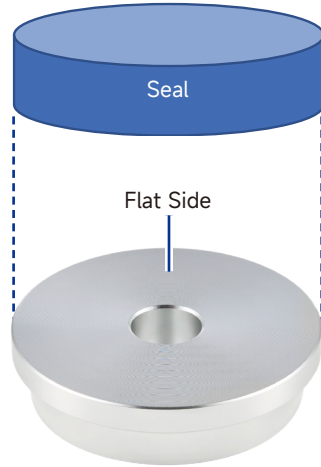

## 2

- Race Installation

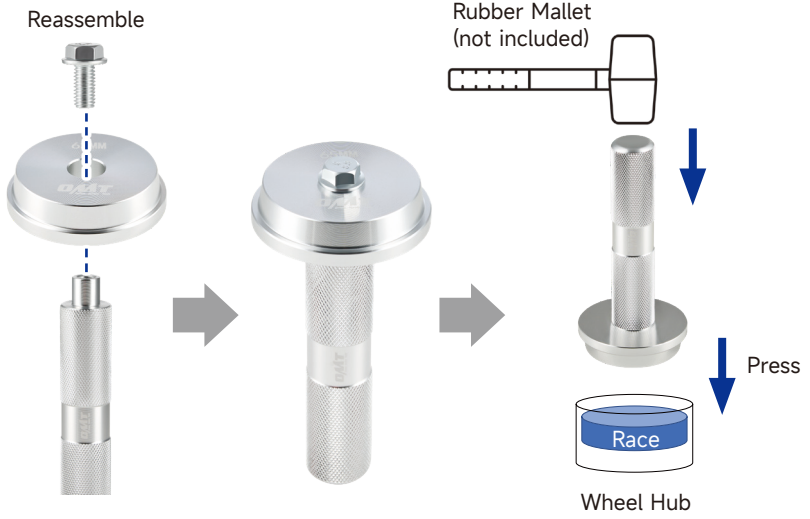

- Seal Installation

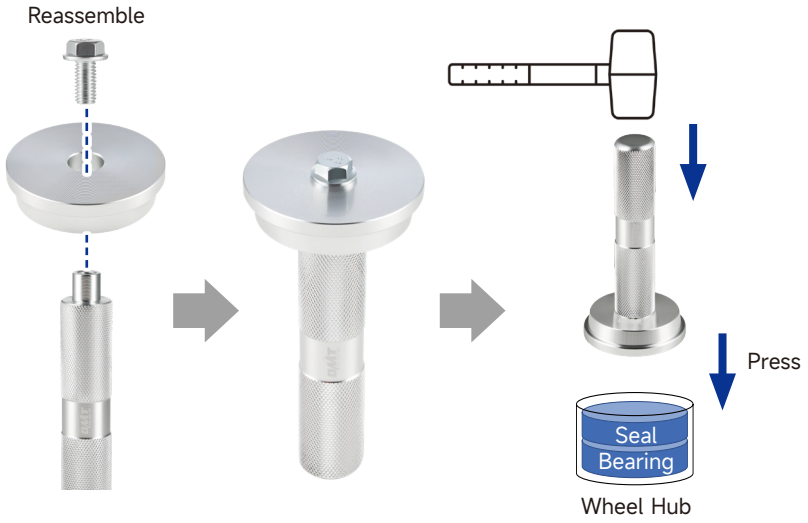

# Maintenance

- **BEFORE EACH USE**, inspect the general condition of the tool kit.
- Check for misalignment or binding of moving parts, cracked or broken parts, and any other condition that may affect its safe operation.
- If abnormal noise or vibration occur, address the issue before further use.
- **AFTER USE**, wipe clean with a damp cloth, using a mild detergent or mild solvent.
- Store these tools in their carrying case in a dry location.





**User Manual**

Rev. 10 Jun. 2025