

Replacement Parts List

- Seat Pad Set
- Cup Holder
- Backless Booster Belt-Positioning Clip
- Instructions

If requested color is not available, similar color will be substituted.

Applicable tax and shipping & handling will also be added.

For parts availability and questions:

Call: 1-800-544-1108

Text: 1-812-652-2525

Chat: www.maxicosi.com

Email: support@djgusa.com

RodiSport Booster Seat

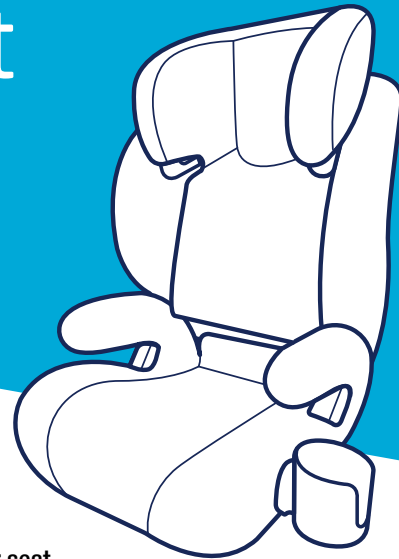

4358-8651

12.20.24



KEEP INSTRUCTIONS FOR FUTURE USE.
Read all instructions before using this booster seat.

⚠ WARNING: Failure to follow the warnings on the labels and in the instruction manual can result in serious injury or death to your child. Serious injury can include paralysis and/or permanent brain injury.



MAXI-COSI®

We Carry the Future



Overview

Welcome to the Maxi-Cosi family and thank you for choosing this booster seat, also known as a child restraint! To help you get started using your child's new booster seat, here are the 3 main tasks you'll need to complete.



Measure Your Child



Place Booster Seat into Your Vehicle



Buckle Up!

Your child's safety is worth the time it will take to read and follow these instructions.

Ready? Let's go!

Pages 1–2 will introduce you to the parts of the booster seat.

Page 35 has our contact information. If at any point you would like assistance, please feel free to reach out to us.

Quick Navigation

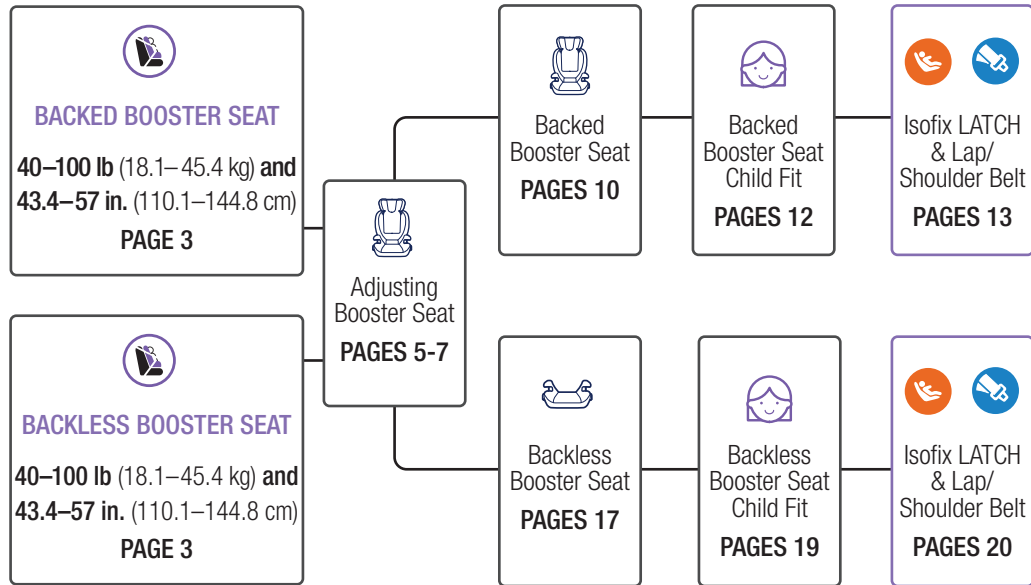

Contents

Getting Started

Parts of Booster Seat	1
Accessory Use	2
Booster Seat Requirements	3

Making Adjustments to Booster Seat

Installing Backrest	5
Removing Backrest	6
Adjusting Headrest Height & Reclining Backrest ..	7

Isofix LATCH & Vehicle Belts

Installation in Vehicle

Backed Booster Seat	10
Backed Booster Seat Child Fit	12
Backed Isofix LATCH & Lap/Shoulder Belt Use	13

Backless Booster Seat	17
Backless Booster Seat Child Fit	19
Backless Isofix LATCH & Lap/Shoulder Belt Use ...	20

Installing Backless Booster Belt-Positioning Clip ...	23
Using Belt-Positioning Clip	24
Adjusting Length & Removing Belt-Positioning Clip	25

Wash & Care of Car Seat Parts

Removing Seat Pad Set for Cleaning	26
Cleaning & Installing Seat Pad Set	27

Safety Information

Child Restraint Use	28
Vehicle Seating Position	29
Installation in Vehicle	30
Aircraft Information	30
Replacement & Expiration of Car Seat	31
Registration & Safety Notices	32

Additional Information

Dorel Juvenile Group Information	33
Warranty	34

Parts of Booster Seat

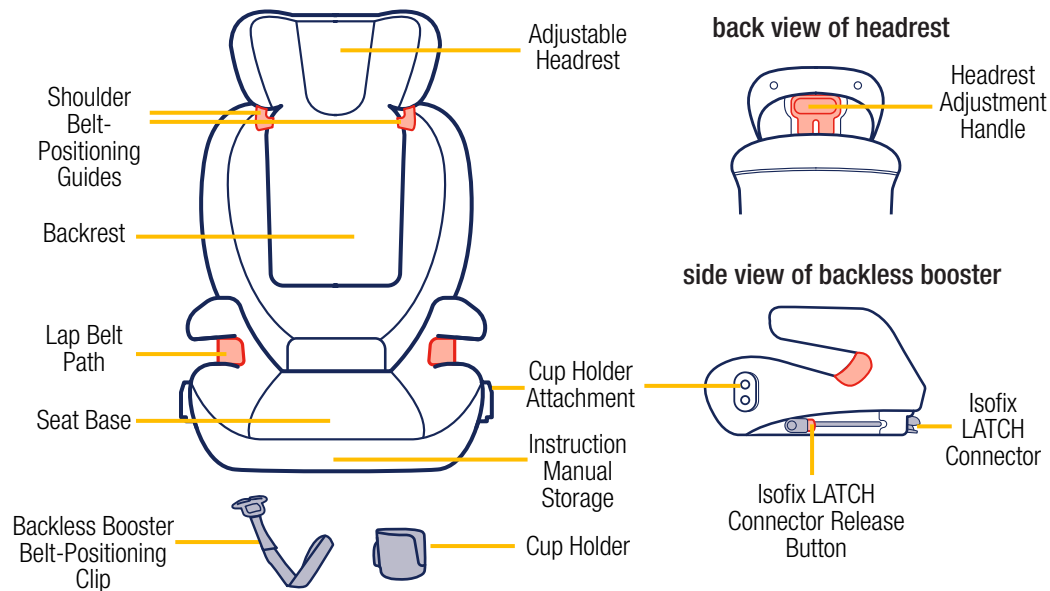

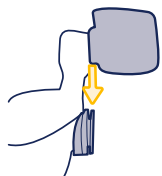

Cup Holder

To attach, align the slot in the cup holder with the attachment on the side of the seat. Slide the cup holder down onto the attachment.

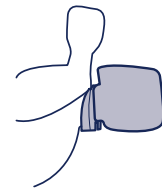

To remove, pull the cup holder up off the attachment.

The cup holder is top-rack dishwasher safe.

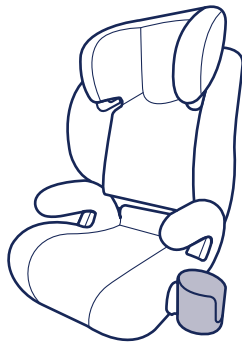

⚠️ WARNING

Failure to follow these instructions may result in serious injury or death to your child. Serious injury can include paralysis and/or permanent brain injury.

Be certain to measure your child's weight and height (do not guess) before choosing this car seat's mode.

Your child's height, weight, and age determine how the car seat should be placed in the vehicle.

Children vary widely in body size, shape, and temperament—**please consult your doctor before switching between any modes within the limits and fit requirements of the car seat.**

School-Aged Children

Children can only use a belt-positioning booster car seat once they outgrow forward-facing harness weight or height limits. Children must use the belt-positioning booster mode until the vehicle's lap and shoulder seat belt fit them properly without the belt-positioning booster.



BACKED BOOSTER SEAT



**40–100 lb (18.1–45.4 kg) and
43.4–57 in. (110.1–144.8 cm)**

In this car seat, your child can use the **Booster Seat** mode until they fit the vehicle's lap and shoulder seat belt properly without a **Booster Seat** OR outgrow any of the following:

- **Weight Limit:** 100 lb (45.4 kg); **OR**
- **Height Limit:** 57 in. (144.8 cm); **OR**
- **Booster Seat** child fit requirements. See page 12.



BACKLESS BOOSTER SEAT



**40–100 lb (18.1–45.4 kg) and
43.4–57 in. (110.1–144.8 cm)**

In this car seat, your child can use the **Booster Seat** mode until they fit the vehicle's lap and shoulder seat belt properly without a **Booster Seat** OR outgrow any of the following:

- **Weight Limit:** 100 lb (45.4 kg); **OR**
- **Height Limit:** 57 in. (144.8 cm); **OR**
- **Booster Seat** child fit requirements. See page 19.

Installing Backrest

Locate backrest connection slots in seat and slide backrest attachment hooks into slots.

You may need to push the seat pad flap back to reveal slots.

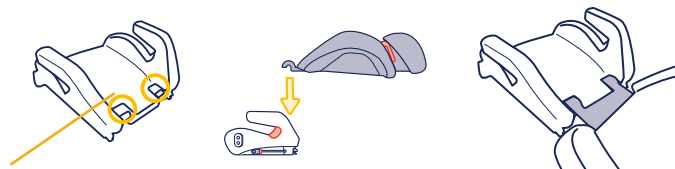

Rotate backrest all the way forward. It will click twice.



Rotate backrest all the way back. It will click twice. Then lift backrest out of seat.

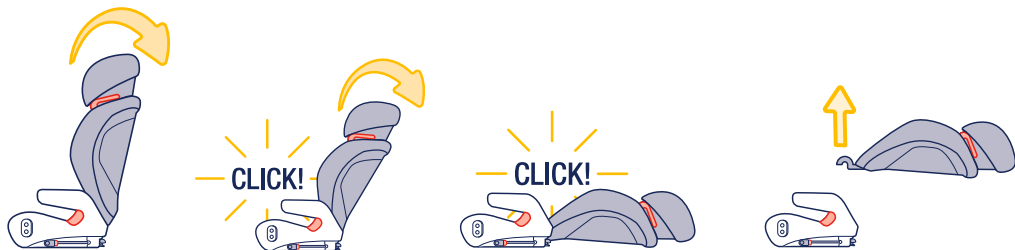

The headrest has multiple height positions.

back view of headrest

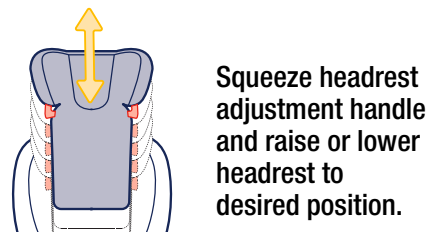
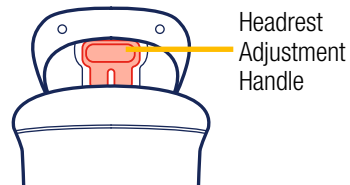

Squeeze headrest adjustment handle and raise or lower headrest to desired position.

The reclined position is only to be used to install the booster seat flush against the vehicle seat back. Vehicle seat back must be upright.

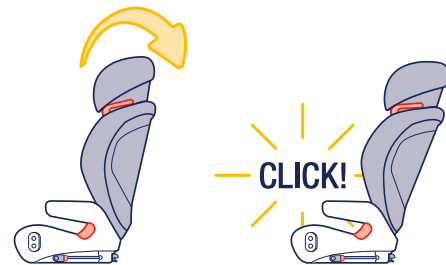

Rotate backrest backwards until it clicks once.



Isofix LATCH & Vehicle Belts

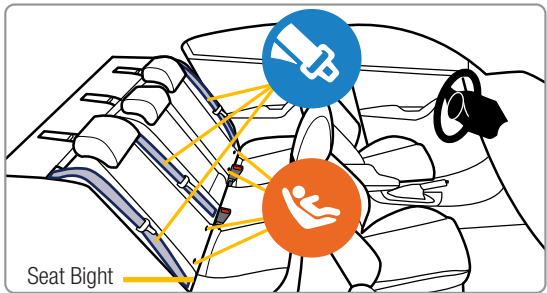

Your vehicle's features may be considerably different than those pictured here.

Not all vehicle belts and seating positions will work with child restraints.

The lower anchors of LATCH (Lower Anchors and Tethers for CHildren) is a universal system for installing child restraints. Most vehicles manufactured after September 2002 are equipped with LATCH. This Isofix LATCH system can only be used in vehicles that have the LATCH anchor bars installed and designated LATCH seating positions. This Isofix LATCH system cannot be used with raised LATCH anchors in the vehicle seat back.



You MUST review your vehicle owner's manual.

Check your vehicle owner's manual to determine the vehicle belt and seating positions available for installing a child restraint and which seating positions may be equipped with LATCH: lower anchor bars.

Must Use With This Booster Seat

Lap/Shoulder Belts



Never Use With This Booster Seat

Lap Only Belts



Inflatable Seat Belts



40–100 lb (18.1–45.4 kg) and 43.4–57 in. (110.1–144.8 cm)



Isofix LATCH +
Lap/Shoulder Belt



Keep booster seat secured to the vehicle with the Isofix LATCH or vehicle belt even when unoccupied.

⚠️ WARNING

Warning! Use **ONLY** the vehicle's lap and shoulder belt system when restraining the child in this booster seat.



DO NOT use only the lap belt when using this booster seat.



The shoulder belt **MUST ALWAYS** be adjusted snugly across the child's chest.



NEVER place shoulder belt under the child's arms or behind their back.

DO NOT use this booster seat if the top of your child's ears are above the top of the booster seat's headrest.

⚠️ WARNING

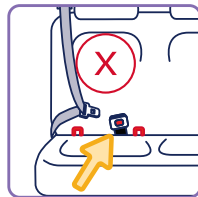

DO NOT use the LATCH system if the seat belt or seat belt buckle is not easily accessible with the booster seat secured to the anchors.

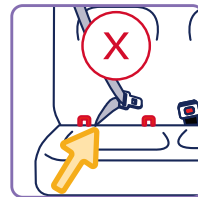

DO NOT use the LATCH system if the seat belt or seat belt buckle is between the LATCH anchors.

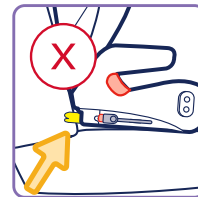

DO NOT use the LATCH system if the LATCH anchor bars are above the seat back.



Backed Booster Seat Child Fit

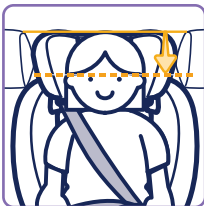

Head Position

The top of your child's ears should **NEVER be above** the top of the booster seat's headrest.

Adjust headrest if needed, see page 7.



Shoulder Belt Position

The shoulder belt should lay snugly across the center of your child's shoulder and across their chest; **not on their face or neck.**

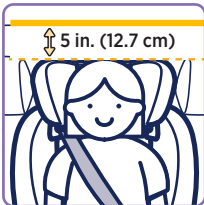

Car Position

DO NOT use the booster seat if your child's head is less than 5 in. (12.7 cm) below the roof of the car. Consult your vehicle manual for proper seatbelt usage.

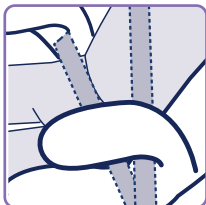

Lap Belt Position

The lap belt should lay snugly across your child's hips; **not on their stomach.**



Backed Isofix LATCH & Lap/Shoulder Belt Use



You **MUST** remove the backless belt-positioning clip strap to install the backrest. See page 25.

To install the backrest, see page 5. Isofix Steps 1, 3, and 4 are optional.

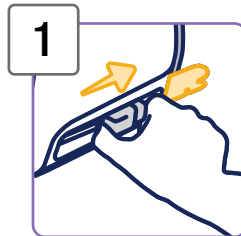

1

Extend Isofix LATCH Connectors (optional)

Press the button in and slide the Isofix LATCH connector out of the shell.

Repeat for the other side.

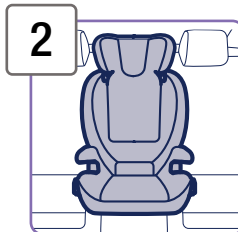

2

Place Booster Seat Forward Facing in Vehicle

The vehicle seat back **MUST** be upright.

The back of the booster seat should be flat against the vehicle seat back.

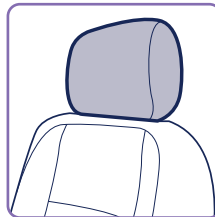

NOTE: If your vehicle seat has a headrest that interferes with achieving a flush car seat fit, check

your vehicle owner's manual to see if it can be removed, adjusted, or if there are other possible seating locations.

continued on next page

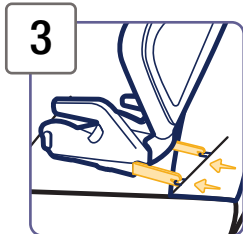

3 Align Isofix LATCH Connectors with Vehicle's Anchor Bars (optional)

Attach the connectors to the anchor bars. You may need to push down on the seat to align.

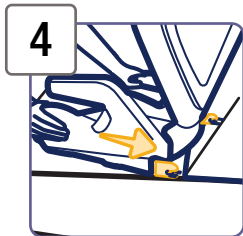

4 Push the Booster Seat Back Against Vehicle Seat (optional)

Make sure the seat is connected to the anchor bars.

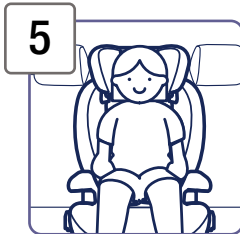

5 Have Child Sit in Booster Seat

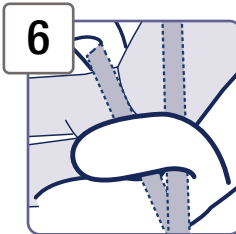

6 Position Lap Belt on Child

Route the lap portion of the lap/shoulder belt under both armrests.

The shoulder belt **MUST GO UNDER** the armrest

on the vehicle buckle side.

The lap belt should lay snugly across your child's hips; **not on their stomach.**

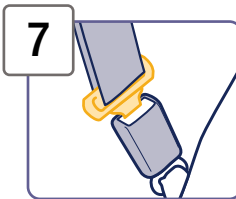

7 Buckle Vehicle Belt

Pull up on the lap belt to tighten.



8 Position Shoulder Belt on Child

Pull up on the shoulder belt to tighten.

The shoulder belt should lay snugly across the center of

your child's shoulder and across their chest; **not on their face or neck.**

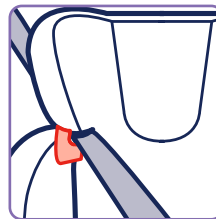

Only use the shoulder belt-positioning guide in the headrest **if necessary** to help position the shoulder belt correctly on your child.

continued on next page



Finished!

Check periodically to make sure your child has not moved out of position and loosened the shoulder belt.

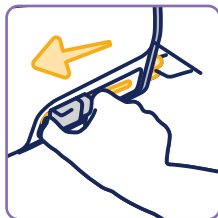

To Remove Isofix LATCH Connector From Vehicle Anchor

Press the button in and slide the Isofix LATCH connector back into the shell.

Backless Booster Seat

40–100 lb (18.1–45.4 kg) and 43.4–57 in. (110.1–144.8 cm)



Isofix LATCH + Lap/Shoulder Belt

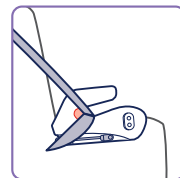

Keep booster seat secured to the vehicle with the Isofix LATCH or vehicle belt even when unoccupied.

⚠ WARNING

Warning! Use **ONLY** the vehicle's lap and shoulder belt system when restraining the child in this booster seat.



DO NOT use only the lap belt when using this booster seat.



The shoulder belt **MUST ALWAYS** be adjusted snugly across the child's chest.



NEVER place shoulder belt under the child's arms or behind their back.

DO NOT use this booster seat if the top of your child's ears are above the top of the vehicle seat back or headrest.

continued on next page

⚠️ WARNING

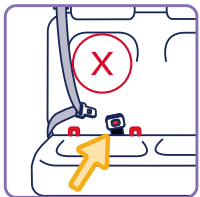

DO NOT use the LATCH system if the seat belt or seat belt buckle is not easily accessible with the booster seat secured to the anchors.

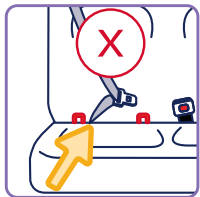

DO NOT use the LATCH system if the seat belt or seat belt buckle is between the LATCH anchors.

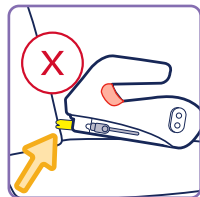

DO NOT use the LATCH system if the LATCH anchor bars are above the seat bight.

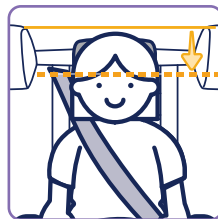

Head Position

The top of your child's ears should never be above the top of the vehicle seat's headrest.



Shoulder Belt Position

The shoulder belt should lay snugly across the center of your child's shoulder and across their chest; **not on their face or neck.**

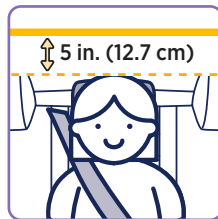

Car Position

DO NOT use the booster seat if your child's head is less than 5 in. (12.7 cm) below the roof of the car. Consult your vehicle manual for proper seatbelt usage.

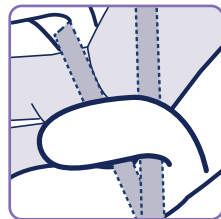

Lap Belt Position

The lap belt should lay snugly across your child's hips; **not on their stomach.**



To remove the backrest, see page 6.
Isofix Steps 1, 3, and 4 are optional.

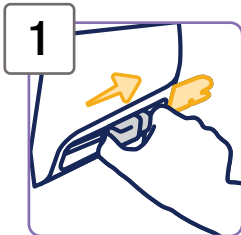

1 Extend Isofix LATCH Connectors (optional)

Press the button in and slide the Isofix LATCH connector out of the shell.

Repeat for the other side.

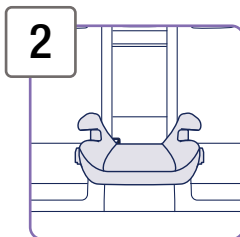

2 Place Booster Seat Forward Facing in Vehicle

The vehicle seat back **MUST** be upright.

The back of the booster seat should be flat against the vehicle seat back.

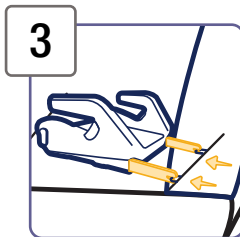

3 Align Isofix LATCH Connectors with Vehicle's Anchor Bars (optional)

Attach the connectors to the anchor bars. You may need to push down on the seat to align.

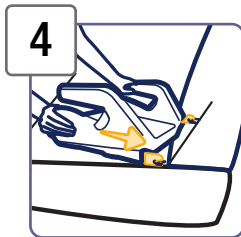

4 Push the Booster Seat Back Against Vehicle Seat (optional)

Make sure the seat is connected to the anchor bars.

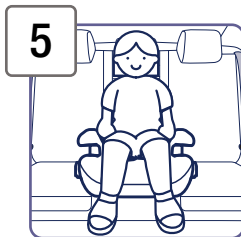

5 Have Child Sit in Booster Seat

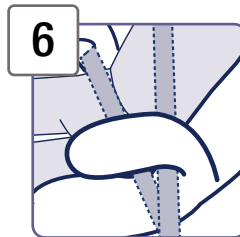

6 Position Lap Belt on Child

Route the lap portion of the lap/shoulder belt under both armrests. The shoulder belt **MUST GO UNDER** the armrest

on the vehicle buckle side.

The lap belt should lay snugly across your child's hips; **not on their stomach.**

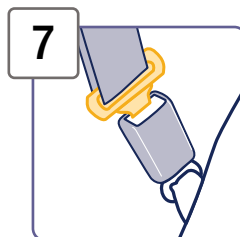

7 Buckle Vehicle Belt

Pull up on the lap belt to tighten.

continued on next page



8

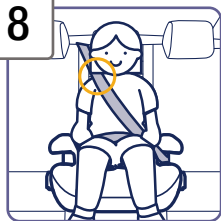

Position Shoulder Belt on Child

Pull up on the shoulder belt to tighten.

The shoulder belt should lay snugly across the center of your child's shoulder and across their chest; **not on their face or neck.**

Only use the belt-positioning clip **if necessary** to help position the shoulder belt correctly on your child.



To install the backless belt-positioning clip and for proper positioning, see pages 23–24.



Finished!

Check periodically to make sure your child has not moved out of position and loosened the shoulder belt.

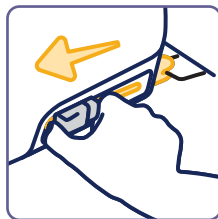

To Remove Isofix LATCH Connector From Vehicle Anchor

Press the button in and slide the Isofix LATCH connector back into the shell.

Installing Backless Booster Belt-Positioning Clip

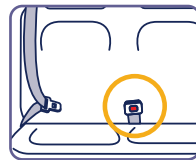

When using the belt-positioning clip, it **MUST BE** installed on the side of the booster seat that is closest to the vehicle seat buckle.

1

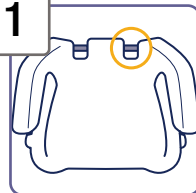

Locate Bar at Back of Booster Seat

2

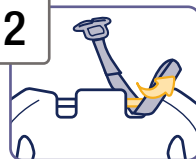

Route Belt-Positioning Clip Strap As Shown

3

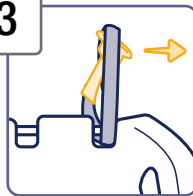

Pull Clip Through Loop at End of Strap

4

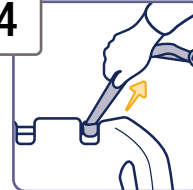

Pull to Tighten Strap on Bar

Using Belt-Positioning Clip

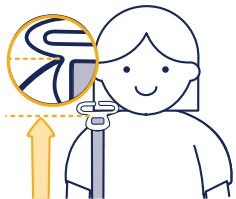

1. Have your child sit in the booster seat.
2. Pull the belt-positioning clip straight up to the top of your child's shoulder.
3. The top of your child's shoulder must be even with the bottom of the slot of the belt positioning clip as shown.

Check the length of the belt-positioning clip strap often as your child grows.

Adjust strap as needed. See next page.

The backless belt-positioning clip **MUST be removed** before installing the backrest for backed booster seat use. See next page.

Adjusting Length & Removing Belt-Positioning Clip

Adjusting Length of Belt-Positioning Clip Strap

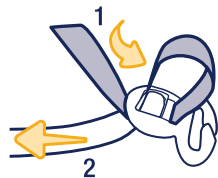

To Lengthen

Push the free end of the strap **(1)** into the clip.

Pull on the opposite end of the strap **(2)** to remove slack.

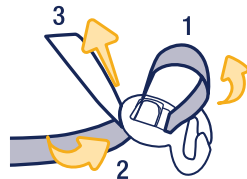

To Shorten

From the top of the clip, make a loop in the strap **(1)**.

Push the strap into the clip **(2)**.

Pull on the free end of the strap **(3)** to remove the loop.

Removing Belt-Positioning Clip Strap

1. Loosen strap at bar.
2. Pull clip through loop at end of strap.
3. Remove strap from seat.

Removing Seat Pad Set for Cleaning

1

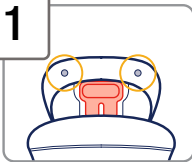

Locate Headrest Pad Fasteners on Back of Headrest & Undo Them

2

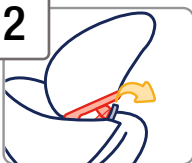

Locate Elastic Straps on Headrest Belt-Positioning Guide

Release them from each belt-positioning guide.

3



Gently Pull Headrest Pad off Headrest

4

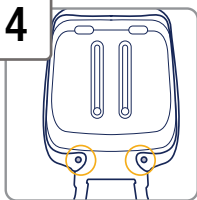

Locate Backrest Pad Fasteners on Back of Backrest & Undo Them

! WARNING

DO NOT use booster seat without the seat pad. Failure to do this can result in serious injury or death. Serious injury can include paralysis and/or permanent brain injury.

5

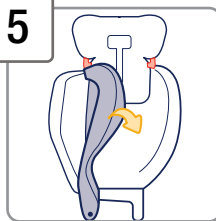

Gently Pull Backrest Pad Off Backrest

6

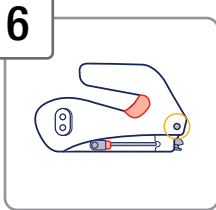

From Back of Seat, Undo Fasteners & Pull Seat Pad Off of Armrests & Seat

Cleaning & Installing Seat Pad Set

Machine wash separately with cold water on a gentle cycle. Do not use bleach. Tumble dry separately for 10–12 minutes on low heat. Remove immediately.

- From front of seat, pull seat pad onto seat and over armrests.
- Gently fit backrest pad onto backrest and attach backrest pad fasteners to back of backrest.
- Gently fit headrest pad onto headrest.
 - Fit the elastic straps onto the headrest belt-positioning guides.
 - Attach the headrest pad fasteners to the back of the headrest.

⚠️ WARNING

NEVER take your child out of the child restraint while the vehicle is moving.

NEVER leave child unattended.

Placing your child in a hot child restraint may result in burns.

DO NOT use a child restraint with damaged or missing parts.

DO NOT substitute parts or try to modify the child restraint in any way.

DO NOT use any child restraint accessory except those approved by Dorel Juvenile Group.

NEVER allow any child to play with this child restraint; it is not a toy.

DO NOT remove or cover up any of the warning labels or other labels on the child restraint.

This child restraint has been certified for use in passenger vehicles. **DO NOT** use in a boat, on a motorcycle, or in a cargo van or bus where there are no seat belts.

Read all instructions for additional warnings.

⚠️ WARNING

Check the vehicle owner's manual for more information about air bag/child restraint use.



Use the child restraint only on vehicle seats that face forward.



DO NOT use on seats that face the sides or rear of the vehicle.

For vehicles without a back seat, refer to your vehicle owner's manual.



According to accident statistics, children are safer when properly restrained in the rear seating positions than in the front seating positions.

Rear seating positions are statistically safer, whether you have air bags, advanced air bags, or no air bags at all.

If you are not sure where to place the car seat in your vehicle:

- Consult your vehicle owner's manual; **OR**
- Contact Dorel Juvenile Group Consumer Care Department; **OR**
- Visit your local Child Passenger Inspection Station. Go to <https://www.nhtsa.gov/vehicle-safety/car-seats-and-boosterseats> to find your closest station.

To avoid your child being seriously burned, take the following precautions:

- Park in the shade or where the sun does not directly hit the car seat.
- Cover the car seat with a sheet or blanket when not in use.
- Check for hot seat and buckles before placing child in car seat.

To help protect your vehicle seat's upholstery from damage: You may use an accessory approved by Dorel Juvenile Group or a single layer towel underneath and behind car seat.

WARNING

Check the vehicle belt before each use. Use only if the belt can be tightened properly and securely.

Even when unoccupied, this booster seat must be firmly secured to the vehicle by the Isofix LATCH or with the vehicle seat belt. In a crash or sudden stop, an unsecured booster seat could injure occupants.

Aircraft Information



This restraint is not certified for aircraft use because aircraft seats do not have shoulder belts.



DO NOT risk your child's safety.

To keep your child as safe as possible, Dorel Juvenile Group strongly recommends replacing the car seat even after a minor crash; even if it was not occupied at the time.

Replacement After a Minor Crash

The National Highway Traffic Safety Administration states that for a crash to be considered minor **ALL of the following must be true:**

- Vehicle able to drive away from the crash site; **AND**
- Vehicle door nearest the car seat was not damaged; **AND**
- No passengers were injured; **AND**
- Airbags did not deploy; **AND**
- There is no visible damage to the car seat.

If the crash your car seat was involved in meets **ALL** the criteria, you may not need to replace the car seat. If one or more of these criteria are not true or if you

are uncertain of any of your answers, replace the car seat immediately.

Replacement After a Moderate to Severe Crash

You **MUST** replace this car seat if it has been in a moderate to severe car crash.

This car seat is intended to protect a child in a single crash. During a crash, the car seat and all of its parts absorb crash energy, which can deform or weaken it. Damage is not always visible. A damaged car seat must be replaced immediately.

Expiration

On the bottom of the child restraint there is a date of manufacture label as shown.

DO NOT use this child restraint more than 10 years after the date of manufacture.

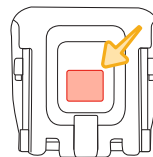

Please complete the postage-paid registration card that came with your child restraint, and send it to us. Child restraints could be recalled for safety reasons. You must register this restraint to be reached in a recall. Send your name, address, email address if available, the restraint's model number, and manufacturing date to:

Dorel Juvenile Group

P.O. Box 2609
Columbus, IN 47202

or call 1-800-544-1108 or register online at www.djgusa.com/registration/carseat/us.

For recall information, call the U.S. Government's Vehicle Safety Hotline at 1-888-327-4236 (TTY: 1-800-424-9153), or go to <http://www.NHTSA.gov>.

Your Street Address		
City		State
Zip Code		
Email Address (optional)		
Model Number	Model Name	Manufacture Date
AB123CDE	MAXI-COSI CARSEAT	2024/1/22
		
#11 B265035		

Example of model number, line code, and manufacture date.

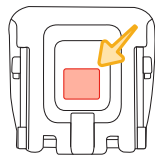

If you don't have the card or if your address changes, you will find the model number, manufacture date, and line code on the label located on the bottom of the child restraint.

Thank you for choosing this child restraint. The DJG family is committed to creating child restraints with the most comfort and convenience available today.

Remember, parents are a child's first teachers and examples. If you always buckle your seat belt, your child will think it is the natural thing to do. Make it a firm rule that the vehicle does not go until everyone is buckled up. Make no exceptions.

No one can predict if use of a child restraint will prevent injury or death in a particular crash. However, when combined with careful driving, proper use of a child restraint can lower a child's risk of injury or death in most crashes.

If you still have questions or have any concerns with this child restraint, please contact our Consumer Care Department:

Call: 1-800-544-1108

Text: 1-812-652-2525

Website: www.maxicosi.com

Email: support@djgusa.com

Hours of Operation:

M-TH from 8:00 AM to 6:00 PM EST

FRI from 8:00 AM to 4:30 PM EST

Dorel Juvenile Group, Inc. (DJG) warrants this product to the original retail purchaser as follows:

This product is warranted against defective materials or workmanship for one year from the date of original purchase. **An original receipt is required to validate your warranty.** DJG will, at its option, provide replacement parts or replace this product. DJG reserves the right to substitute if the part or model has been discontinued.

To make a claim under this warranty, please contact our Consumer Care Department by phone: 1-800-544-1108 or text: 1-812-652-2525. Our hours of operation are from 8:00 a.m. to 6:00 p.m. EST Monday through Thursday and from 8:00 a.m. to 4:30 p.m. on Friday.

Proof of purchase is required and shipping charges are the responsibility of the consumer.

Warranty Limitations: This warranty does not include damages which arise from misuse or abuse of this product.

Limitation of Damages: The warranty and remedies as set forth are exclusive and in lieu of all others, oral or written, expressed or implied. In no event will DJG or the dealer selling this product be liable to you for any damages, including incidental or consequential damages, arising out of the use or inability to use this product.

Limitation of warranties and other warranty terms and state law rights:

Any implied warranties, including implied warranties of the merchantability and fitness for a particular purpose, shall be limited to the duration and terms of the express written warranty. Some states do not allow limitations as to how long an implied warranty lasts or the exclusion or limitation of incidental or consequential damages, so the above limitations may not apply to you.

This warranty gives you specific legal rights, and you may have other rights, which vary from state to state. Neither DJG nor the dealer selling this product authorized any

person to create for it any other warranty, obligation, or liability in connection with this product.

Please note: Our product warranty only applies when purchased from an authorized Maxi-Cosi retailer. The origin of products not purchased through these authorized retailers is unknown and could be counterfeit. We cannot support products from an unknown origin as we cannot verify the handling or condition of such merchandise. We maintain a strong network of authorized retailers to ensure you are purchasing safe and complete products. Fulfillment

by a third party does not guarantee you are purchasing from one of these authorized retailers. Pricing which is inconsistent with the majority of retailers is a strong indication that the retailer is not authorized, as we have a consistent price offering across all authorized retailers. If you are unsure of the authorization status of a retailer you are considering purchasing from, or have purchased from, you can check www.maxicosi.com/us-en/shops.aspx; or call our Consumer Care Department at 1-800-544-1108; or text us at 1-812-652-2525.

©2024 Dorel Juvenile Group, Inc. (800) 951-4113 www.maxicosi.com. Styles, colors, and labeling may vary. Les styles, les couleurs et l'étiquetage peuvent varier. Made in CHINA. Fabriqué en CHINA. Distributed by (distribué par) Dorel Juvenile Group, Inc., 2525 State St., Columbus, IN 47201-7494. Dorel Juvenile Canada, 2233 Argentia Road, Suite 110, Mississauga, N L5N 2X7. Representante exclusivo en Chile: DOREL JUVENILE CHILE S.A. Av. del Parque 4161, oficina 602 A, Huechuraba, Santiago, Chile - Fono: 56 2 24971500 - www.infanti.cl - www.dorel.cl. Importado y distribuido en Perú por: COMEXA COMERCIALIZADORA EXTRANJERA S.A. SUCURSAL DEL PERÚ - Los Libertadores 455, San Isidro, Lima 27, Lima, Perú RUC 20431062870 – Fono: 4413029 – www.infanti.com.pe. En Centro América, Caribe y Ecuador por: Best Brands Group S.A. – Av. Balboa, Bay Mall Plaza, Planta Baja, local 9, Panamá. - Fono: (507) 300 2884. En Colombia por: Baby Universe S.A.S. - Vía 40 No. 77-29, Barranquilla, Colombia - Fono: (575) 353 1110 Importador: DJGM, S.A. DE C.V. Gabriel Mancera No. 1041 Col. Del Valle, Benito Juárez C.P. 03100 México, Ciudad de México R.F.C. DJG140305GN9 Tel. (55) 67199202