

Zip Micro



Instant Boiling and Chilled water.

Models:

Micro B (Boiling), Micro BC (Boiling/Chilled)



AFFIX PRODUCT LABEL HERE

Contents

WARNINGS AND PRECAUTIONS	04
Major components and accessories	06
Technical specification	07
Before Installation	08
Installation instructions.....	09
Step 1 – Tap installation	09
Step 2 – Ventilation	10
Step 3 – Command centre installation	11
Step 4 – Commissioning	14
Operation.....	16
Tap operation	16
Energy mode	17
Maintenance	18
Water filter	18
Air inlet filter (Boiling/Chilled model)	20
Troubleshooting.....	21
Cleaning	23
End of life disposal	23

WARNINGS AND PRECAUTIONS



WARNING: for continued safety of this appliance it must be installed, operated and maintained in accordance with the manufacturer's instructions.

This appliance may deliver water at high temperature. Refer to the Plumbing Code of Australia (PCA), local requirements and installation instructions to determine if additional delivery temperature control is required.

- Plumbing and electrical connections must be made in accordance with local regulations and relevant standards. In Australia: Plumbing standard AS/NZS 3500 series & Electrical Wiring Rules AS/NZS 3000.
- For residential chilled models, all refrigeration must comply with AS/NZS 60335.2.24.
- This appliance must be earthed.
- The power cord and general power outlet must be in a safe and accessible position after installation.
- Do not remove the cover of the appliance under any circumstances without first isolating the appliance from the power supply.
- This unit is designed for indoor use and must not be installed outdoors or exposed to the elements of nature.
- This appliance must not be cleaned by a water jet. This appliance must not be positioned in an area that may be cleaned by a water jet.
- This appliance is intended to be used in: staff kitchen areas in shops, offices and other working environments; farm houses and by clients in hotels, motels and other residential type environments; bed and breakfast type environments; catering and similar non-retail applications.
- Due to the process of continuous improvement, Zip reserves the right to change details in this manual, without notice. Visit zipwater.com to ensure you have the latest copy of this document.

Safety

This appliance is not intended for use by persons (including children) with reduced physical, sensory or mental capabilities, or lack of experience and knowledge, unless they have been given supervision or instruction concerning use of the appliance by a person responsible for their safety. For products sold in Europe, this appliance can be used by children aged from 8 years and above and persons with reduced physical, sensory or mental capabilities or lack of

WARNINGS AND PRECAUTIONS

experience and knowledge if they have been given supervision or instruction concerning use of the appliance in a safe way and understand the hazards involved. Children should be supervised to ensure that they do not play with the appliance. Cleaning and user maintenance shall not be made by children without supervision.

Refrigerant (BC model)

The HydroTap Micro (BC model) contains R134A refrigerant under pressure. Maintenance of the refrigeration unit must be carried out by an accredited service provider or qualified refrigeration technician.

Qualifications

If the power cable is damaged it must be replaced by a qualified technician. To avoid hazards, all installation procedures must be carried out by a suitably qualified tradesperson.

Venting

Occasionally steam and / or boiling water may discharge through a vent outlet on the tap. Ensure the tap body is located so the tap outlet safely dispenses into the drip tray or sink bowl area.

Lifting

Take care when lifting. The Micro command centre may exceed safe lifting limits. If you feel this is beyond your personal capabilities, please seek assistance with the lift. Do not lift the Micro command centre by the front cover or any of its connections. Refer to the Technical specification for the weight of the product.



Airflow

The ambient operating temperatures, when installed in a cupboard, must be between 5°C - 35°C. The system will operate satisfactorily only if the recommended air gaps of 50 mm on each side, and 200mm above the command centre are provided. If a vent kit is supplied, it is recommended to be fitted according to these instructions.

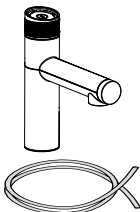
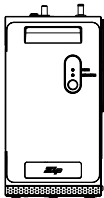
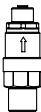
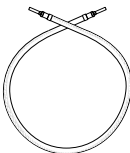
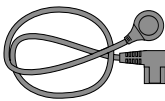
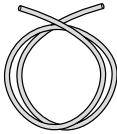

Frost Protection

If this appliance is located where the ambient air temperature could fall below 5°C when the heater is not in use, do not turn off the appliance electrically. This safeguard does not offer the same protection to the connecting pipework and fittings.

Major components and accessories

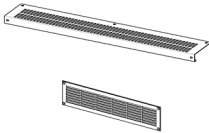
Parts supplied	Description
	Micro Tap and hoses part no: 94873 B hoses (x2) 94863 BC hoses (x3) 94063 tap fixing kit 95234 rubber grip
	Micro command centre, including water filter
	350 kPa pressure limiting valve (PLV) part no. 90833
	Braided hose for mains water (1m) part no. 95006
	IEC power cable (1.8m) part no. 94704
	1/4" filter flush hose (1m) part no. 91025
	Installation instructions (this book)

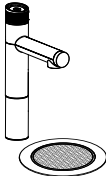
Parts supplied	Description
	For BC model: Vent Kit 1 x inlet, 1 x outlet 9 x screws part no. 93257
<ul style="list-style-type: none"> • Tube spanner • 4x adhesive door buffers • Tap operation label • Filter flush key (supplied fitted in front door) 	

Accessories	Description
	Replacement filter part no: 93701 (0.2 micron)
	Font and tap extension kit part no: 95162 (Chrome) 95163 (Matte Black)
	Water block part no. 95136

Technical specification

Model:	Micro B (Boiling)	Micro BC (Boiling Chilled)
Rated Voltage/Power	220-240V, 50Hz, 1.39 kW 220V, 60Hz, 1.23 kW	220-240V, 50Hz, 1.52 kW
Rated mains inlet water pressure	150 - 700 kPa	
Water connection	½" BSP (G ½")	
Ambient operating temperature	5 - 35 °C	
Boiling water temperature setpoint	98°C	
Chilled water temperature setpoint	–	6 - 8°C
Chilled water coolant	–	R134a
Dimensions (W x D x H) (mm)	180 x 270 x 340	180 x 502 x 340
Dry weight (command centre)	9 kg (+1.8kg when filled)	15.6 kg (+3.6kg when filled)

Note: 1 cup = 167 mL, 1 glass = 200mL.

An optional water block may be fitted in the water supply line to minimise the potential damage in the event of leakage. Contact your local service centre.

Before Installation

Before installation, ensure:

- All technical specifications and instructions have been reviewed.
- The underbench can support the product weight when full of water (see Technical specification).
- There is sufficient space in the cupboard to install the command centre and other components in accordance with these installation instructions.
- A user easily-accessible 220-240V AC, 10A power outlet is required. The appliance must be connected in accordance with current local electrical regulations. See Technical specification for power ratings. Check cable and plumbing against inlet /outlet positions before proceeding.
- Potable water supply with working pressure of 150 - 700 kPa (1.5 - 7.0 bar), with isolating valve within reach of the hose and positioned so that the valve will not be obstructed.
- A 350 kPa (3.5 bar) pressure limiting valve, which also functions to prevent backflow of water into the water mains (supplied) must be fitted.
- The appliance must be placed upright with its base in a horizontal position.



IMPORTANT! Do not proceed with the installation if these requirements are not met.

Installation instructions

Step 1 – Tap installation

- 1** Position the Micro Tap so that water from its spout will fall into a sink/drip tray fitted with a drain. Cut a 35mm hole into the sink or benchtop, using a sheet metal punch or hole saw (not supplied).

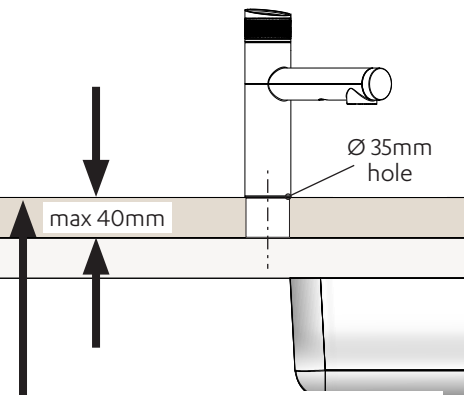

The tap must not be installed more than 900 mm above the base of the command centre. Failure to do this may result in poor water delivery.

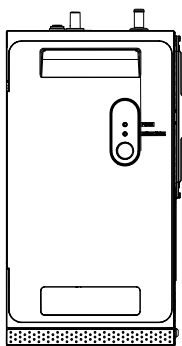

- 2** View from below the tap. Connect the silicone hoses to the tap tubes.

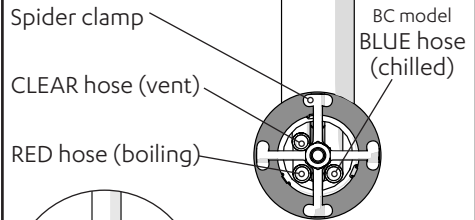

Push the hose 20mm over the tube. Fasten with a hose clamp.

3

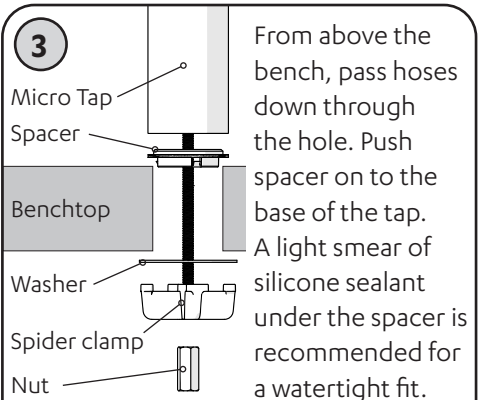

From above the bench, pass hoses down through the hole. Push spacer on to the base of the tap. A light smear of silicone sealant under the spacer is recommended for a watertight fit.

From below the bench, assemble washer, spider clamp and fastening nut. Check the tap is in the correct position before tightening the nut.

Installation instructions

Step 2 – Ventilation

1

IMPORTANT: Allow a minimum clearance envelope of 50mm either side, and 200mm above the command centre. Vents on the sides of the command centre must not be obstructed. Proper air circulation must be provided for the system to operate correctly.



2

Fit the silicone door buffers to the inside edge of the cupboard door to provide an air space. The top and front of the command centre must remain accessible for servicing.

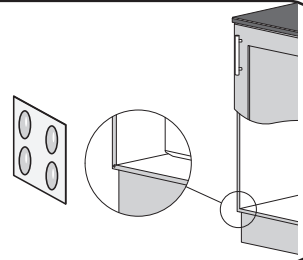

3

(Boiling/Chilled models) Install the cupboard floor inlet vent (supplied) in the cupboard where the command centre is located. Refer to the instructions supplied with the vent kit.

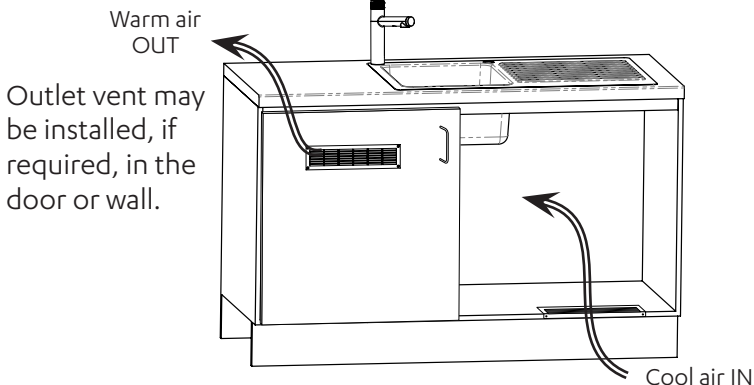

4

If cupboard temperature rises above 35°C

The outlet vent may be installed in the door or wall. If additional ventilation is required, please contact your local service centre for more details.

Step 3 – Command centre installation

Installation diagram

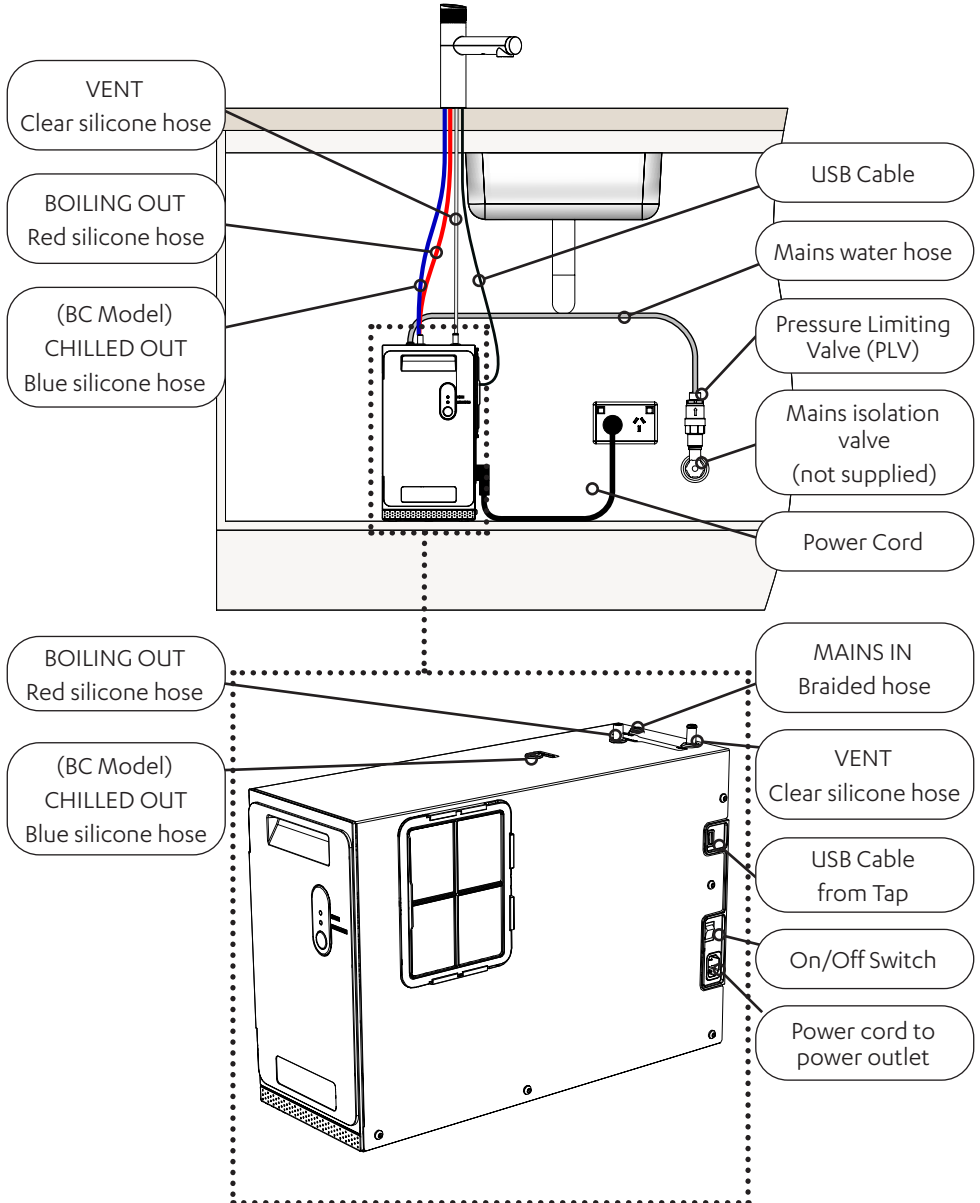

Installation instructions

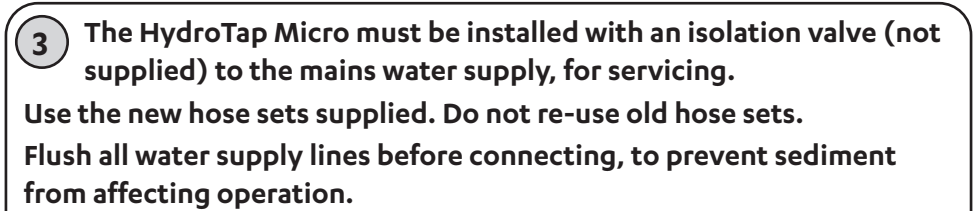
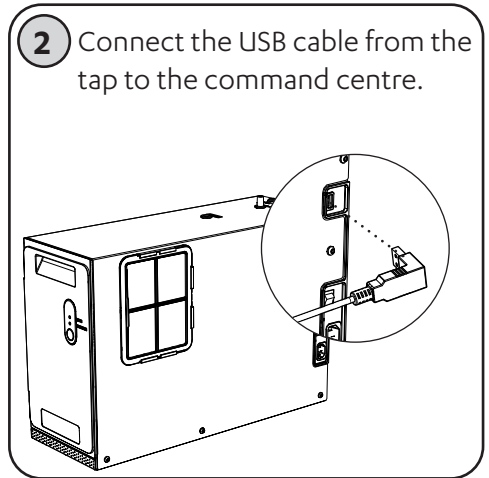
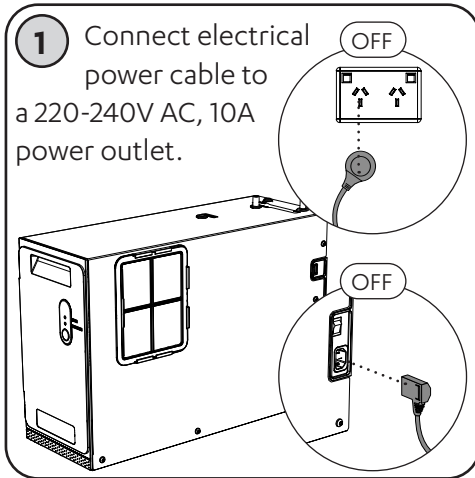

Connect the 350 kPa PLV to the mains water supply, applying sealant tape to the thread.

Mains water isolation valve remains OFF.

Connect the braided hose to the PLV.

At the top of the command centre, remove plug from MAINS IN. Connect the other end of the braided hose.

Quick-connect fitting: push the hose in as far as it will go

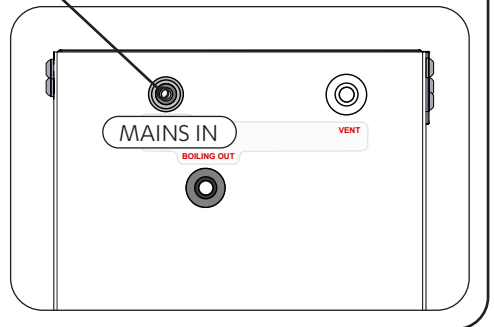
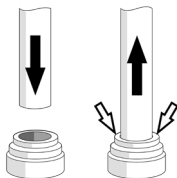

Installation instructions

- 4** Remove caps from the connectors at the top of the command centre.
Connect the silicone hoses from the tap to the command centre. Refer to the installation layout diagram overleaf.

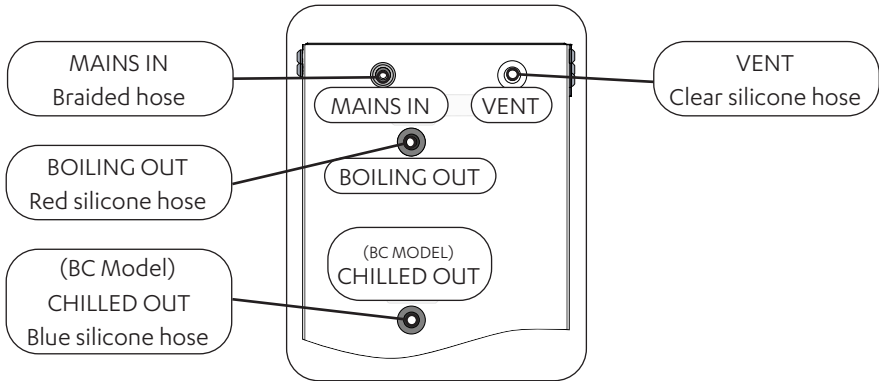

Tips for hose connection

- Push the silicone hose over the connector for a minimum of 15mm.
- Ensure there is a constant fall from the tap down to the command centre.
- Hoses must be trimmed to avoid loops and kinks. Take care when positioning before cutting and make a clean cut straight across the hose, using a sharp blade.
- The hoses must not be under tension when installed.
- Hoses must not be lengthened beyond the maximum supplied 1-metre length.

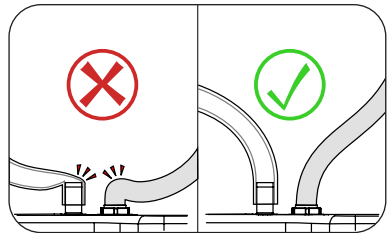
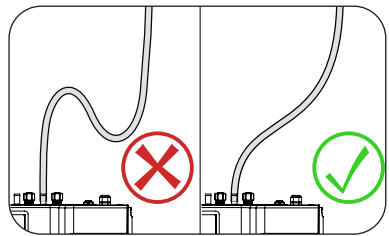

Commissioning

Step 4 – Commissioning

1 Turn water supply ON and check connections for leaks.

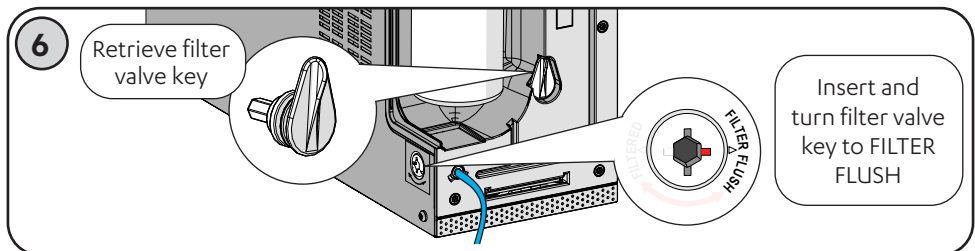
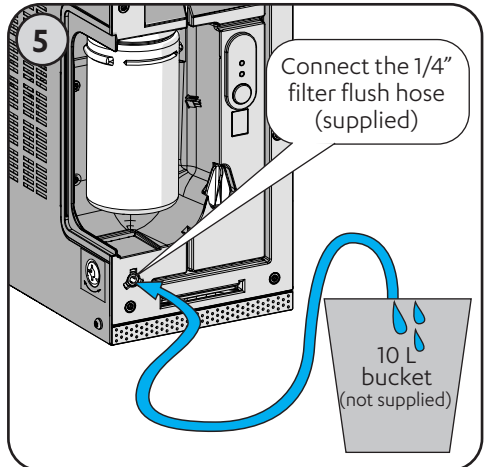
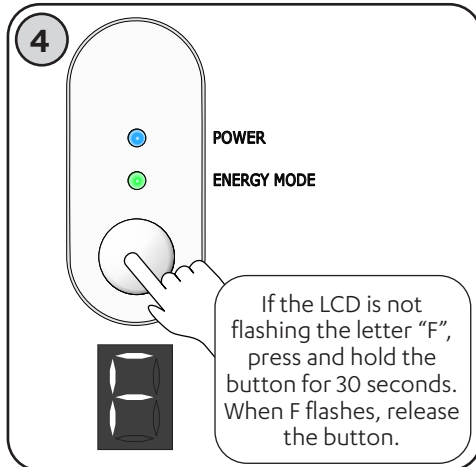
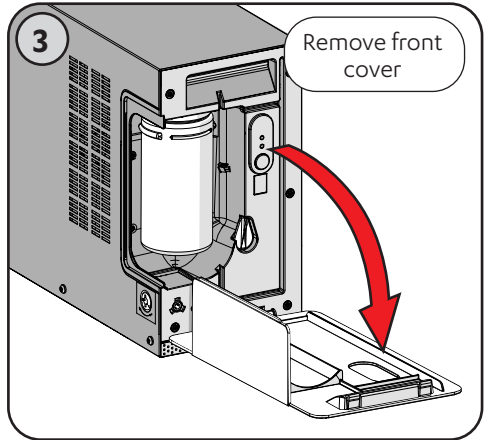
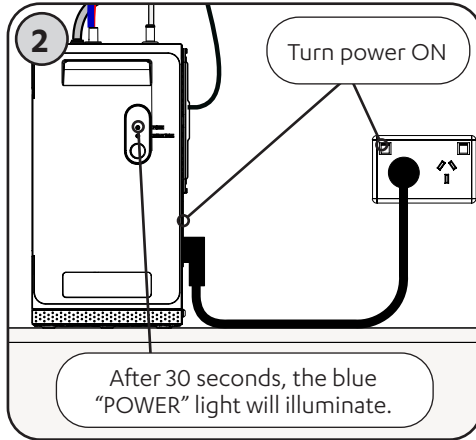

Commissioning

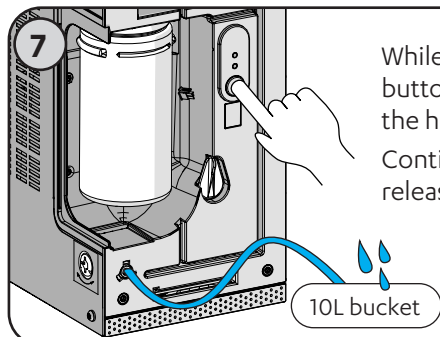

While the LCD flashes “F”, press and hold the button. Water will flow through the filter and out the hose. The “F” displayed will stay on.

Continue holding the button. The button may be released to temporarily stop water flow.

After 2 minutes (10 litres), water flow will stop. The LCD shows “P” and filter life will be reset to zero. Release the button.

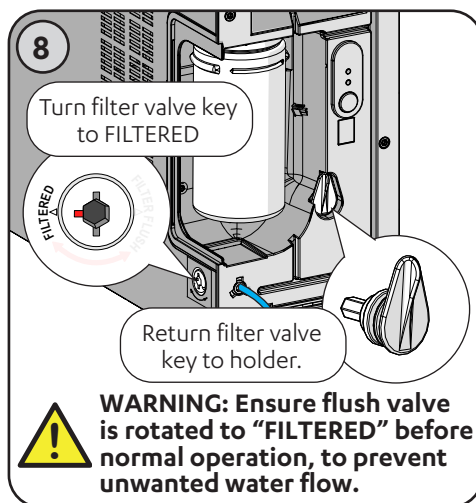

Turn filter valve key to FILTERED

Return filter valve key to holder.

WARNING: Ensure flush valve is rotated to “FILTERED” before normal operation, to prevent unwanted water flow.

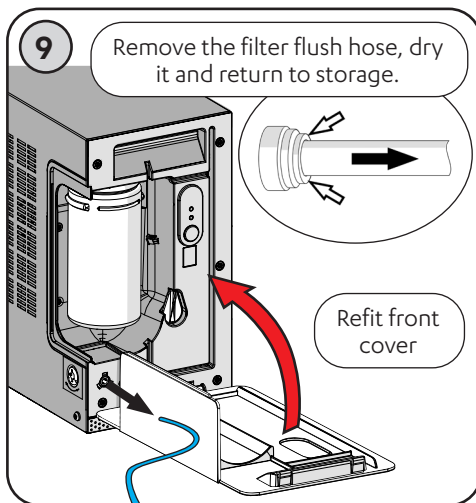

Remove the filter flush hose, dry it and return to storage.

Refit front cover

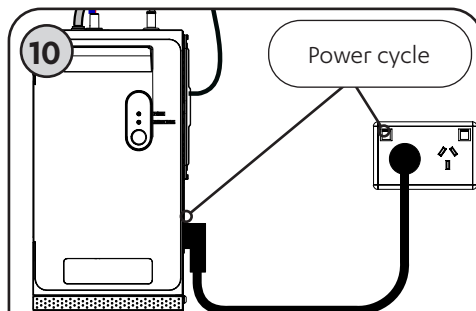

Power cycle

Turn power off to the command centre, wait 10 seconds, then power on again. Wait a further 30 seconds for the blue “POWER” light to illuminate.

11 Before first use:

Check for leaks. Allow 5 minutes for tanks to fill. Flush with fresh water to remove any residue from factory sanitisation.

- (All models) Dispense 1.8 litres of boiling water from the tap, equivalent to a complete tankful of water. Repeat 3 times.
- (BC model) Dispense 1.8 litres of chilled water from the tap, equivalent to a complete tankful of water. Repeat 3 times.

Tap operation

Boiling water

Tap the red lock icon at the centre of the tap head, twice. The lock light turns off.

Rotate and hold in the direction of the red arrow to dispense boiling water. The tap head springs back when released.

You may continue to dispense boiling water while the red arrow flashes (10 seconds).

If the lock icon flashes, it has not been properly disabled. Try again.

Boiling continuous flow

Tap the red lock icon twice. The lock light turns off.

Rotate to the second stop; it remains in position.

Boiling water flows for 10 seconds. Manually return the tap head to the neutral position.

Service Light

For details, see Troubleshooting.

Chilled water (Micro BC)

Rotate and hold in the direction of the blue arrow to dispense chilled water. The tap head springs back to the neutral position, when released.

Chilled continuous flow

Rotate tap head to the second stop; it remains in position.

Chilled water flows for 10 seconds. Manually return the tap head to the neutral position.

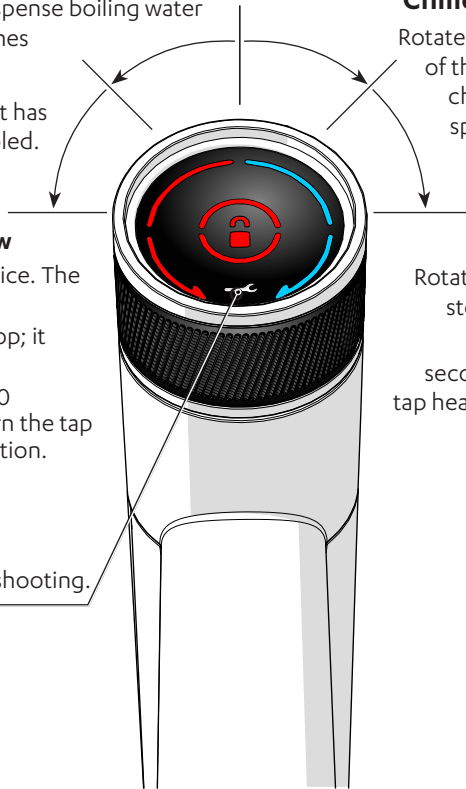

Energy mode

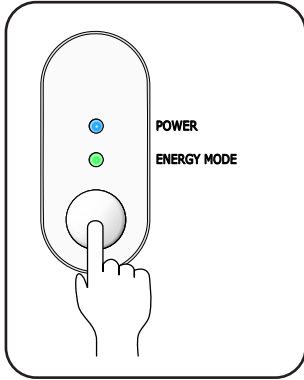

To enable/disable energy mode, press the button on the front of the command centre. The green light will illuminate when energy mode is enabled.

When energy mode is enabled, after 2 hours of inactivity, the boiling tank set point temperature is reduced to 68°C, to conserve energy.

If the tap is operated to dispense boiling water, the boiling set point temperature is restored to 98°C.

Allow time for the water to return to the set point temperature.

Water filter

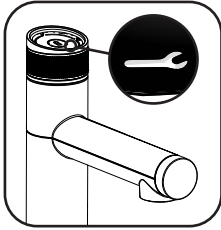

The Micro water filter has a 12 month usage capacity. The filter cartridge may require changing earlier depending on water quality, usage, or if you notice unpleasant odours or tastes. The Service icon on the tap will illuminate and “C F” will flash on the command centre LCD, to indicate a filter change is due. Failure to change the filter may adversely affect water quality or supply to the tanks.

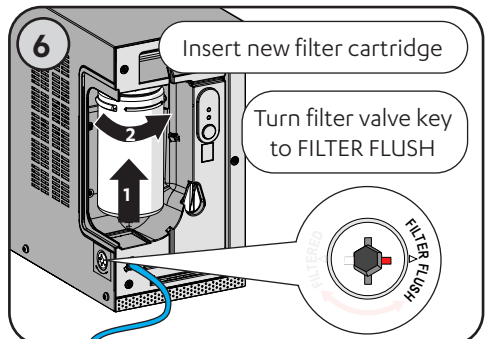
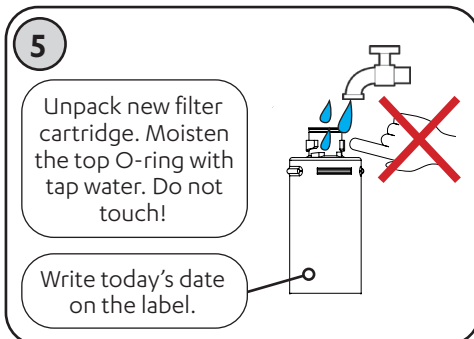
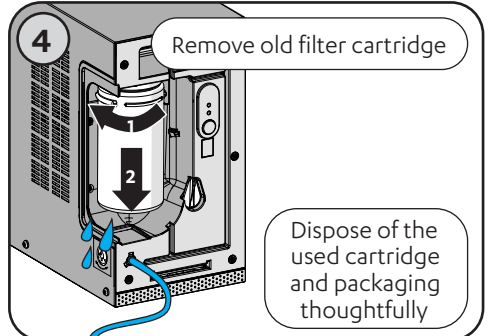
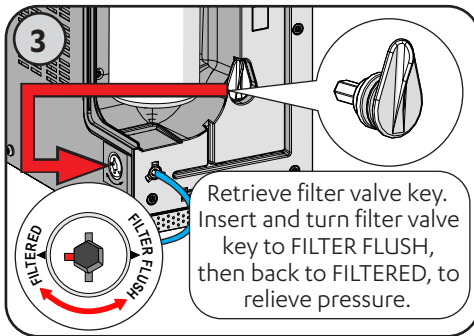
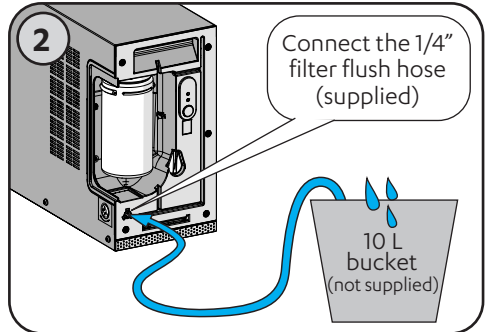
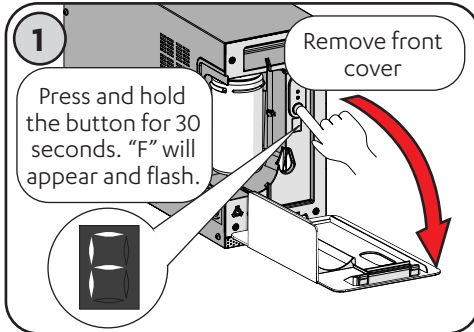

Maintenance

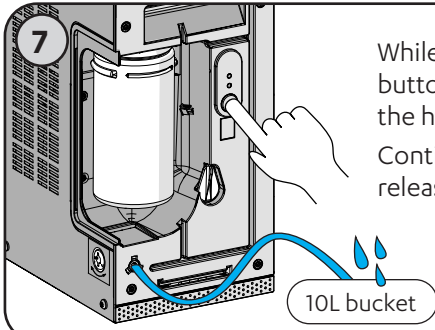

While the LCD flashes “F”, press and hold the button. Water will flow through the filter and out the hose. The “F” displayed will stay on.

Continue holding the button. The button may be released to temporarily stop water flow.

After 2 minutes (10 litres), water flow will stop. The LCD shows “P” and filter life will be reset to zero. Release the button.

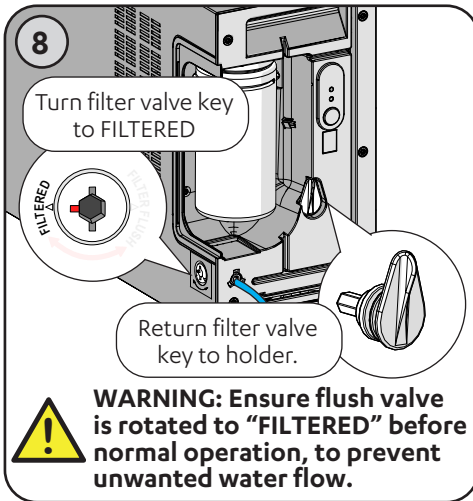

Turn filter valve key to FILTERED

Return filter valve key to holder.



WARNING: Ensure flush valve is rotated to “FILTERED” before normal operation, to prevent unwanted water flow.

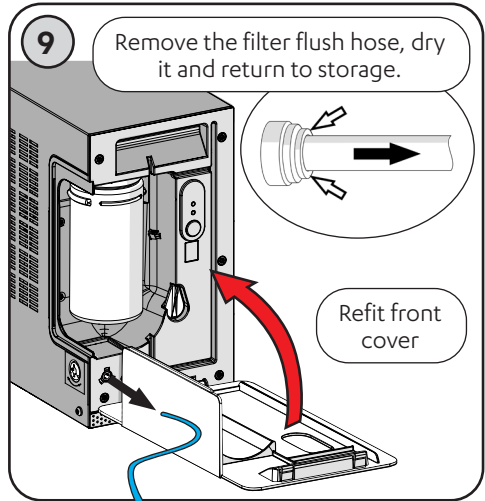

Remove the filter flush hose, dry it and return to storage.

Refit front cover

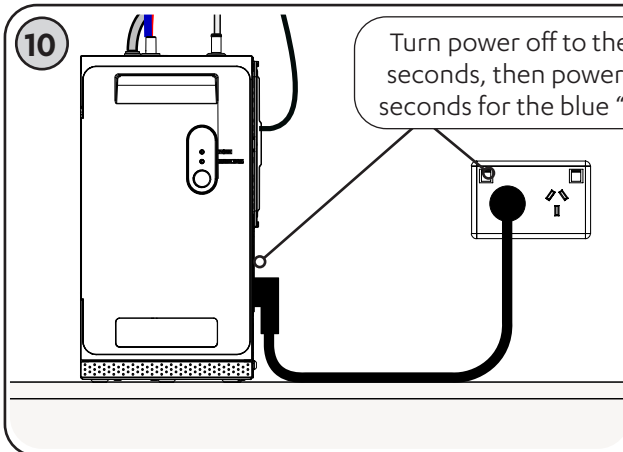

Turn power off to the command centre, wait 10 seconds, then power on again. Wait a further 30 seconds for the blue “POWER” light to illuminate.

Filter flush is complete.

Air inlet filter (Boiling/Chilled model)

The air inlet filter screen should be inspected at least every three months, cleaned and replaced if damaged.

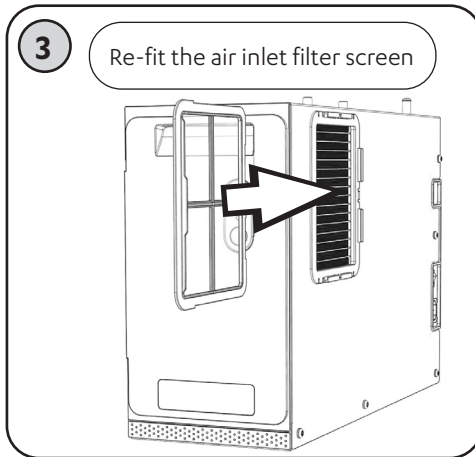
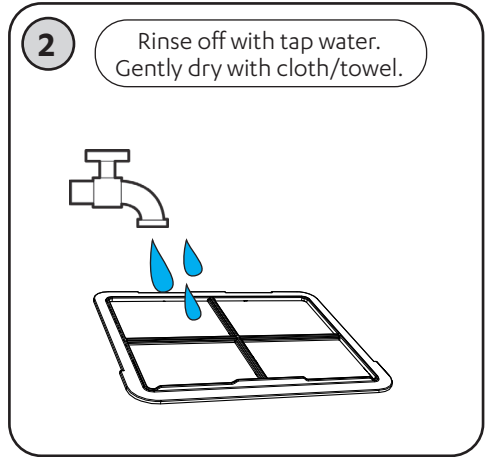
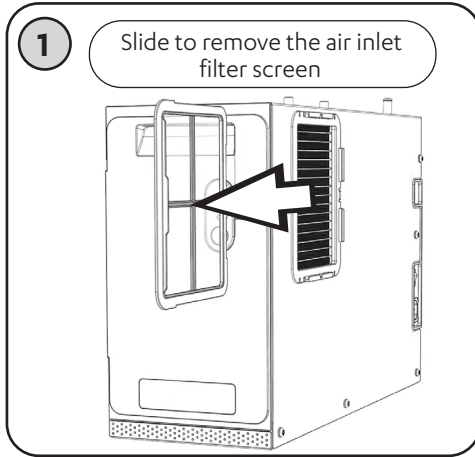

Note: For best performance the unit should only be operated with a clean air inlet filter screen, correctly fitted in place. Maintain at least a 50mm air gap in front of the screen at all times. Take care not to allow cloths or other soft materials to accidentally block the air inlet.



Warning: If the Micro is inactive for longer than 2-3 days, run the 15-second continuous flow at least four times before consumption.

Troubleshooting

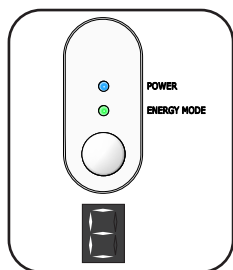
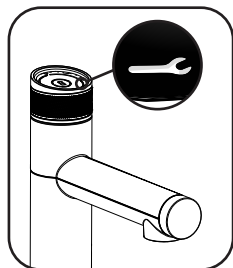

In the event of a fault, the service icon on the tap head illuminates.

Remove the front cover of the command centre and check if a code is shown on the display. Error codes consist of the letter E, followed by 2 digits separated by a hyphen (-), displaying in sequence repeatedly.

Call an electrician, a plumber, or Zip free call in Australia on 1800 947 827 for assistance, service, spare parts or enquiries.

Code		Possible cause	Solution
CF		Filter life has exceeded 12 months	Change water filter and perform filter flush.
F		Filter flush mode enabled.	Complete the filter flush. Refer to Page 18-19.
P		Power cycle required after completing filter flush.	Turn power off and on again.
C		Calibration. Internal process to set hot temperature point.	No action required.
E0-1, E0-2	Boiling sensor fault	Water is not heated.	Contact Zip service.
E0-3, E0-4	Chilled sensor fault	Water is not chilled.	Contact Zip service.

Troubleshooting

Code		Possible cause	Solution
E0-5, E0-6	Steam sensor fault	Water is not heated.	Contact Zip service.
E0-7, E0-8	Condenser fault	Water is not chilled.	Contact Zip service.
E0-9	Flood detected	Water detected in the unit due to tank overflow or internal/external leakage. All functions will turn off.	Disconnect power, check for external water leaks into the unit, resume power. If fault persists, contact Zip service.
E1-0	Boiling tank overflow	Water filled in the boiling tank beyond the allowed level.	Power cycle the unit. If fault persists, contact Zip service.
E1-1	Chilled tank overflow	Water filled in the chilled tank beyond the allowed level.	Power cycle the unit. If fault persists, contact Zip service.
E1-2	Condenser overheat	Temperature of condenser has exceeded 60°C. Water does not chill.	Check adequate ventilation as per the installation instructions. Check fan vent is clean and unobstructed.
E1-3	Communication loss	Command centre does not detect a tap connected. Water will not dispense from tap.	Ensure tap connector is correctly inserted into the side of the command centre. If issue persists, contact Zip service
E1-4, E1-5	Compressor overrun	Compressor running continuously for 30 minutes, and chilled tank is full. Compressor did not turn off and water temperature is 2°C or lower.	Check adequate ventilation. Check chilled water is not dispensed beyond rated use. If issue persists, contact Zip service
E1-6	Water supply fault	Hot or cold tanks not filling. Heating/cooling also stops.	Check if mains water supply is turned ON, with adequate flow of water. Check if filter is blocked and replace filter cartridge if necessary.

Cleaning



Do not use strong, corrosive or abrasive cleaning materials. Stainless steel surfaces will show scratches if an abrasive cleaning product is used.

Wipe clean the outer surfaces with a damp sponge or soft cloth.

End of life disposal

In order to help preserve our environment we ask that you dispose of this product correctly. Please contact your local city council for collection centre details.

Zip Water (Aust) Pty Ltd ABN 46 000 578 727
67-77 Allingham St, Condell Park NSW 2200
Postal: Locked Bag 80, Bankstown 1885 Australia
Call: 1800 ZIP TAP | 1800 947 827
Ph: +61 2 9796 3100
zipwater.com

The terms “Zip” and “HydroTap” are registered trade marks of Zip Water (Aust) Pty Ltd. Zip products described in this publication are manufactured under one or more patents and further patent applications are pending.

As Zip policy is one of continuous product improvement, changes to specifications may be made without prior notice. Images in this booklet have been modified and may not be true representations of the finished goods.

This product complies with AS3498. This user manual has been written according to firmware version 1.0 for the command centre and 1.0 for the tap.

© 2020 Zip Water (Aust) Pty. Ltd.

