

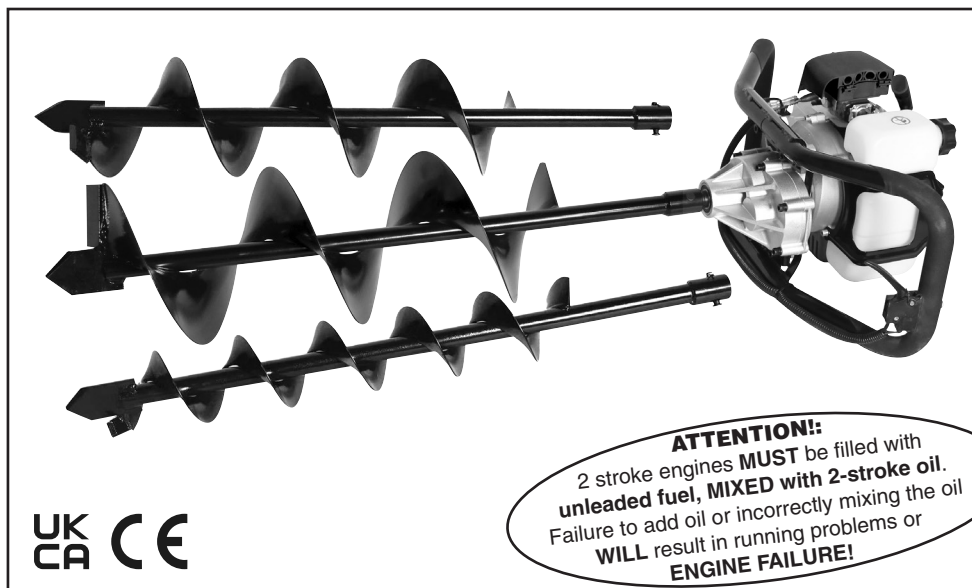

**DRAPER**<sup>®</sup>

# PETROL EARTH AUGER KIT

68294



These instructions accompanying the product are the original instructions. This document is part of the product, keep it for the life of the product passing it on to any subsequent holder of the product. Read all these instructions before assembling, operating or maintaining this product.

This manual has been compiled by Draper Tools describing the purpose for which the product has been designed, and contains all the necessary information to ensure its correct and safe use. By following all the general safety instructions contained in this manual, it will ensure both product and operator safety, together with longer life of the product itself.

All photographs and drawings in this manual are supplied by Draper Tools to help illustrate the operation of the product.

Whilst every effort has been made to ensure the accuracy of information contained in this manual, the Draper Tools policy of continuous improvement determines the right to make modifications without prior warning.

# 1. TITLE PAGE

---

## 1.1 INTRODUCTION:

**USER MANUAL FOR: PETROL EARTH AUGER KIT**

**Stock No: 68294.**

**Part No: GPAUG52-B.**

## 1.2 REVISIONS:

**Date first published January 2021.**

---

---

---

As our user manuals are continually updated, users should make sure that they use the very latest version.

**Downloads are available from:** <http://drapertools.com/manuals>

Draper Tools Limited  
Hursley Road  
Chandler's Ford  
Eastleigh  
Hampshire  
SO53 1YF  
UK

**Website:** [drapertools.com](http://drapertools.com)

**Product Help Line:** +44 (0) 23 8049 4344

**General Fax:** +44 (0) 23 8026 0784

## 1.3 UNDERSTANDING THIS MANUALS SAFETY CONTENT:

**Warning!** – Information that draws attention to the risk of injury or death.

**Important** – Information that draws attention to the risk of damage to the product or surroundings.

## 1.4 COPYRIGHT © NOTICE:

Copyright © Draper Tools Limited.

Permission is granted to reproduce this publication for personal and educational use only.

Commercial copying, redistribution, hiring or lending is prohibited.

No part of this publication may be stored in a retrieval system or transmitted in any other form or means without written permission from Draper Tools Limited.

In all cases this copyright notice must remain intact.

# 2. CONTENTS

---

## 2.1 TABLE OF CONTENTS

<b>1. TITLE PAGE</b>	
1.1 INTRODUCTION:.....	2
1.2 REVISIONS:.....	2
1.3 UNDERSTANDING THIS MANUALS SAFETY CONTENT:.....	2
1.4 COPYRIGHT © NOTICE:.....	2
<b>2. CONTENTS</b>	
2.1 TABLE OF CONTENTS .....	3
<b>3. WARRANTY</b>	
3.1 WARRANTY.....	4
<b>4. INTRODUCTION</b>	
4.1 SCOPE.....	5
4.2 SPECIFICATION.....	5
4.3 HANDLING AND STORAGE.....	5
<b>5. HEALTH AND SAFETY INFORMATION</b>	
5.1 GENERAL SAFETY INSTRUCTIONS FOR POWER TOOL USE .....	6
5.2 ADDITIONAL SAFETY INSTRUCTIONS FOR PETROL FENCE POST AUGER USE .....	7
5.3 HEALTH AND SAFETY INFORMATION CONCERNING THE USE OF FUELS .....	8
5.4 RESIDUAL RISK.....	8
<b>6. TECHNICAL DESCRIPTION</b>	
6.1 IDENTIFICATION.....	9
<b>7. UNPACKING AND CHECKING</b>	
7.1 PACKAGING .....	10
7.2 WHAT'S IN THE BOX .....	10
<b>8. PREPARING THE FENCE POST AUGER</b>	
8.1 ATTACHING THE AUGER BIT.....	11
8.2 FUELLING.....	11
<b>9. OPERATION INSTRUCTIONS</b>	
9.1 STARTING THE ENGINE .....	12
9.2 CORRECT STANCE .....	13
9.3 DRILLING OPERATIONS .....	13
<b>10. MAINTENANCE</b>	
10.1 CLEANING THE AIR FILTER.....	14
10.2 SPARK PLUG MAINTENANCE .....	14
10.3 ENGINE IDLE SPEED ADJUSTMENT .....	15
10.4 REPLACING THE FUEL FILTER.....	15
10.5 ENGINE LUBRICATION .....	15
<b>11. TROUBLESHOOTING</b>	
11.1 TROUBLESHOOTING.....	16
<b>12. EXPLANATION OF SYMBOLS</b>	
12.1 EXPLANATION OF SYMBOLS.....	19
<b>13. DISPOSAL</b>	
13.1 DISPOSAL.....	20

## 3. WARRANTY

---

### 3.1 WARRANTY

Draper tools have been carefully tested and inspected before shipment and are guaranteed to be free from defective materials and workmanship.

Should the tool develop a fault, please return the complete tool to your nearest distributor or contact:

**Draper Tools Limited, Chandler's Ford, Eastleigh, Hampshire, SO53 1YF. England.**

**Telephone Sales Desk: +44 (0) 8049 4333 or Product Help Line +44 (0) 23 8049 4344.**

A proof of purchase **must** be provided with the tool.

If upon inspection it is found that the fault occurring is due to defective materials or workmanship, repairs will be carried out free of charge. This warranty period covering labour is 12 months from the date of purchase except where tools are hired out when the warranty period is 90 days from the date of purchase. The warranty is extended to 24 months for parts only. This warranty does not apply to any consumable parts, any type of battery or normal wear and tear, nor does it cover any damage caused by misuse, careless or unsafe handling, alterations, accidents, or repairs attempted or made by any personnel other than the authorised Draper warranty repair agent.

**Note:** If the tool is found not to be within the terms of warranty, repairs and carriage charges will be quoted and made accordingly.

This warranty applies in lieu of any other warranty expressed or implied and variations of its terms are not authorised.

Your Draper warranty is not effective unless you can produce upon request a dated receipt or invoice to verify your proof of purchase within the warranty period.

Please note that this warranty is an additional benefit and does not affect your statutory rights.

**Draper Tools Limited.**

## 4. INTRODUCTION

---

### 4.1 SCOPE

This product is designed for boring holes of 100mm, 150mm and 200mm diameters in soil for the purposes of fencing, bore holes and planting hedging and saplings.

### 4.2 SPECIFICATION

Stock No. ....	68294
Part No. ....	GPAUG52-B
3 Auger bits .....	100mmØ, 150ØmmØ, 200mmØ
Auger bit length .....	800mm
Fuel/2-stroke oil mix .....	25:1
Engine type .....	2 stroke, single cylinder, air cooled
Fuel tank capacity .....	1.2L
Engine displacement .....	52cc
Maximum engine performance .....	1.45kW
Engine speed at idle .....	3000rpm
Maximum rpm adjustable: .....	up to 9000 or 8500 rpm (+/-300)
Sound pressure level (A-weighted LpAav) .....	91.3dB(A)
Sound power level (A-weighted LWAav) .....	108dB(A)
Single value noise level .....	103.4dB(A)
Vibration level .....	13.33M/s
Weight (power unit only, without fuel) .....	8.9kg

### 4.3 HANDLING AND STORAGE

Care must be taken when handling and lifting. This machine is not a toy and must be respected.

The environment will have a negative result on its operation if you are not careful. If the air is damp, components will rust. If the machine is unprotected from dust and debris; components will become clogged: And if not cleaned and maintained correctly or regularly the machine will not perform at its best.

**ALWAYS WEAR SUITABLE AND APPROVED PERSONAL PROTECTIVE EQUIPMENT**

## 5. HEALTH AND SAFETY INFORMATION

---

### 5.1 GENERAL SAFETY INSTRUCTIONS FOR POWER TOOL USE

When using any type of power tool there are steps that should be taken to make sure that you, as the user, remain safe.

Common sense and a respect for the tool will help reduce the risk of injury.

**Read the instruction manual fully.** Do not attempt any operation until you have read and understood this manual.

Most important you must know how to safely start and stop this machine, especially in an emergency.

**Keep the work area tidy and clean.** Attempting to clear clutter from around the machine during use will reduce your concentration. Mess on the floor creates a trip hazard. Any liquid spilt on the floor could result in you slipping.

**Find a suitable location.** If the machine is bench mounted, the location should provide good natural light or artificial lighting as a replacement. Avoid damp and dust locations as it will have a negative effect on the machine's performance. If the machine is portable do not expose the tool to rain. In all cases do not operate power tools near any flammable materials.

**Keep bystanders away.** Children, onlookers and passers by must be restricted from entering the work area for their own protection. The barrier must extend a suitable distance from the tool user.

Unplug and house all power tools that are not in use. A power tool should never be left unattended while connected to the power supply. They must be housed in a suitable location, away locked up and from children. This includes battery chargers.

**Do not overload or misuse the tool.** All tools are designed for a purpose and are limited to what they are capable of doing. Do not attempt to use a power tool (or adapt it in any way) for an application it is not designed for. Select a tool appropriate for the size of the job. Overloading a tool will result in tool failure and user injury. This covers the use of accessories.

**Dress properly.** Loose clothing, long hair and jewellery are all dangerous because they can become entangled in moving machinery. This can also result in parts of body being pulled into the machine. Clothing should be close fitted, with any long hair tied back and jewellery and neck ties removed. Footwear must be fully enclosed and have a non-slip sole.

**Wear personal protective equipment (PPE).** Dust, noise, vibration and swarf can all be dangerous if not suitably protected against. If the work involving the power tool creates dust or fumes wear a dust mask. Vibration to the hand, caused by operating some tools for longer periods must be protected against. Wear vibration reducing gloves and allow long breaks between uses. Protect against dust and swarf by wearing approved safety goggles or a face shield. These are some of the more common hazards and preventions, however, always find out what hazards are associated with the machine/work process and wear the most suitable protective equipment available.

**Do not breathe contaminated air.** If the work creates dust or fumes connect the machine (if possible) to an extraction system either locally or remotely. Working outdoors can also help if possible.

**Move the machine as instructed.** If the machine is hand held, do not carry it by the power supply cable. If the product is heavy, employ a second or third person to help move it safely or use a mechanical device. Always refer to the instructions for the correct method.

**Do not overreach.** Extending your body too far can result in a loss of balance and you falling. This could be from a height or onto a machine and will result in injury.

**Maintain your tools correctly.** A well maintained tool will do the job safely. Replace any damaged or missing parts immediately with original parts from the manufacturer. As applicable, keep blades sharp, moving parts clean, oiled or greased, handles clean, and emergency devices working.

**Wait for the machine to stop.** Unless the machine is fitted with a safety brake, some parts may continue to move due to momentum. Wait for all parts to stop, then unplug it from the power supply

## 5. HEALTH AND SAFETY INFORMATION

---

before making any adjustments, carrying out maintenance operations or just finishing using the tool.

**Remove and check setting tools.** Some machinery requires the use of additional tools or keys to set, load or adjust the power tool. Before starting the power tool always check to make certain they have been removed and are safely away from the machine.

**Prevent unintentional starting.** Before plugging any machine in to the power supply, make sure the switch is in the OFF position. If the machine is portable, do not hold the machine near the switch and take care when putting the machine down, that nothing can operate the switch.

**Carefully select an extension lead.** Some machines are not suitable for use with extension leads. If the tool is designed for use outdoors, use an extension lead also suitable for that environment. When using an extended lead, select one capable of handling the current (amps) drawn by the machine in use. Fully extend the lead regardless of the distance between the power supply and the tool. Excess current (amps) and a coiled extension lead will both cause the cable to heat up and can result in fire.

**Concentrate and stay alert.** Distractions are likely to cause an accident. Never operate a power tool if you are under the influence of drugs (prescription or otherwise), including alcohol or if you are feeling tired. Being disorientated will result in an accident.

**Have this tool repaired by a qualified person.** This tool is designed to conform to the relevant international and local standards and as such should be maintained and repaired by someone qualified, using only original parts supplied by the manufacturer. This will ensure the tool remains safe to use.

### 5.2 ADDITIONAL SAFETY INSTRUCTIONS FOR PETROL FENCE POST AUGER USE

**WARNING!** For your safety, please read and understand these instructions before assembling, operating or maintaining this machine.

**WARNING!** Read the instructions carefully.

Never attempt to modify or operate a modified machine. Fully assemble this machine, including all relevant guards, before operating.

Do not operate this machine without being completely familiar with the safety features and how to operate them.

Never operate this machine if the stop switch is faulty or not functioning.

Never operate this machine while tired, ill or under the influence of drugs.

**DANGER!** Keep out of the reach of children.

Refer to the instructions supplied with the attachment. Fully read and understand before attempting to assemble, operate or maintain the attachment.

Never allow people unfamiliar with these instructions to operate this machine. Local regulations may restrict the age of the operator.

Prior to each use, inspect the machine for signs of damage. Make sure the safety features are present and functioning and that all visible nuts, bolts and screws remain tight. Vibration from normal use can cause them to loosen over time.

Never operate this machine with defective or missing guards.

**WARNING!** Use of this product can pose a danger to wildlife. Before attempting to use this machine, check the area, particularly long grass and under bushes for signs of life: if necessary relocate.

**NOTE:** Not all animals will be deterred by the noise of the product alone.

Do not operate this machine near animals or bystanders.

Check the attachment is correctly fitted to the machine before attempting to start the engine.



## 5. HEALTH AND SAFETY INFORMATION

---

**CAUTION!** As the user you are responsible for any injury to people or damage to property. Never leave this machine running when not in use or leave it unattended during use.

**WARNING!** During use the engine gets very hot. Do not touch it, especially the exhaust.

Always be aware of your surroundings, staying alert for possible hazards that you may not hear over the noise of the engine.

Always wear appropriate PPE [Personal Protective Equipment].

- Safety goggles must be worn to protect your eyes from debris.
- Ear defenders must be worn to prevent damage to your hearing.
- Gloves to help reduce vibration fatigue.

### 5.3 HEALTH AND SAFETY INFORMATION CONCERNING THE USE OF FUELS

Fuels are inflammable and explosive. Reduce the risk of explosion and fire by:

- Turning off and cooling the motor down before filling the tank with fuel.
- Refraining from smoking and starting open fires when handling fuels.
- Storing and mixing fuels in approved and correspondingly labelled canisters.
- Storing fuels in closed containers. Keeping in mind that fuels may evaporate at room temperature and collect on the floor of closed rooms (risk of explosion).
- Start the device at least nine metres away from the machine.

Fuels are toxic, they contain substances that have an immediate toxic effect and may cause permanent damage to your health. Take all precautionary measures to prevent your body from absorbing any of these substances:

- Tank and siphon fuels only outdoors or in well-ventilated rooms.
- Do not inhale fuel fumes.
- Avoid contact with eyes and skin.
- Wear gloves when transferring fuel.
- When fuel has come into contact with your clothes, change them immediately. Clean your clothes before putting them back on.
- Store fuels out of the reach of children.

When handled inappropriately, fuels may cause damage to the environment:

- Transfer fuel carefully. Fuel must never trickle into the ground or the sewage system.
- Dispose of any remaining fuel in an appropriate manner. Never dispose of fuel with regular household waste.
- Fuels may be stored only for a limited time. Purchase only such quantities that can be used up within a few months.

### 5.4 RESIDUAL RISK

**Important:** Although the safety instructions and operating manuals for our tools contain extensive instructions of safe working with power tools, every power tool involves a certain residual risk which can not be completely excluded by safety mechanisms. Power tools must therefore always be operated with caution!

## 6. TECHNICAL DESCRIPTION

### 6.1 IDENTIFICATION

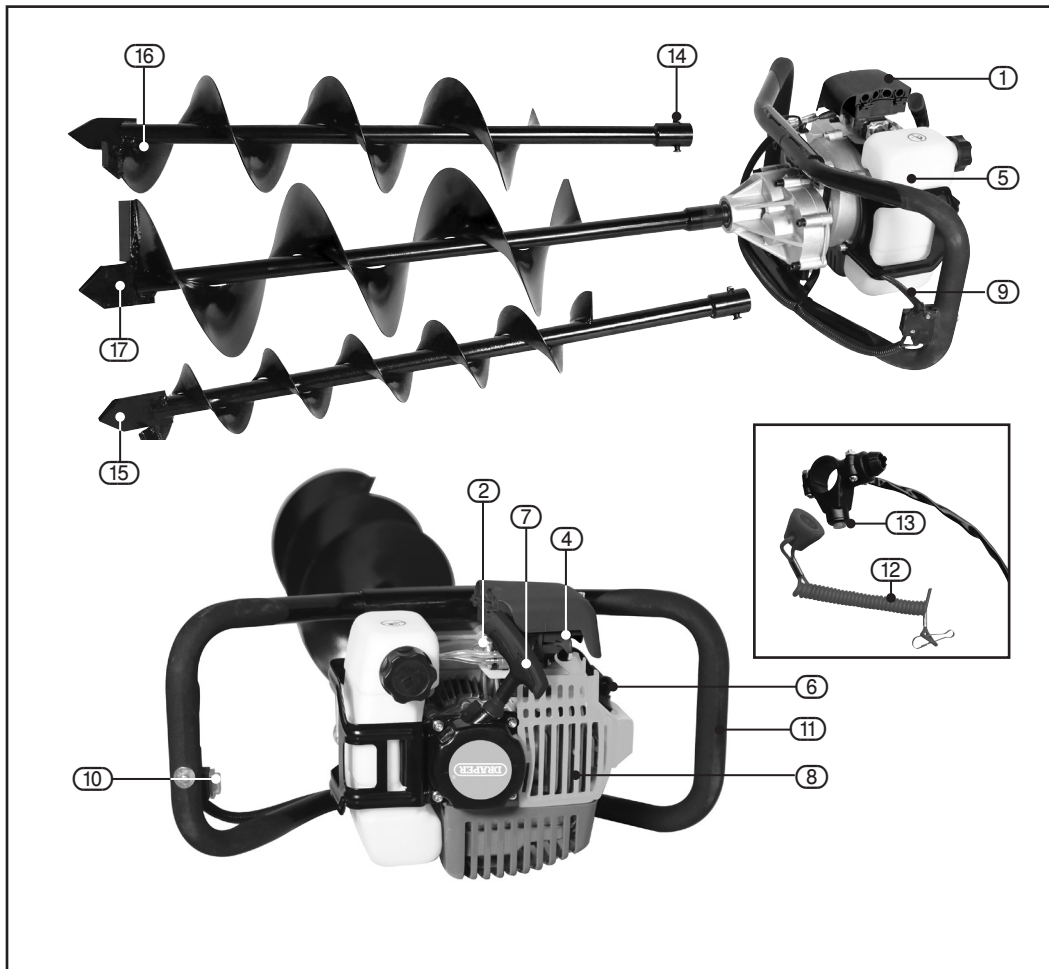

- |   |                              |   |                          |
|---|------------------------------|---|--------------------------|
| ① | Air filter housing.          | ⑨ | Throttle lever.          |
| ② | Fuel primer.                 | ⑩ | Engine on/off switch.    |
| ③ | Carburettor.                 | ⑪ | Handle bars.             |
| ④ | Choke lever.                 | ⑫ | Safety wrist lanyard.    |
| ⑤ | Fuel tank.                   | ⑬ | Lanyard cut-out fitting. |
| ⑥ | Spark plug cover (H.T lead). | ⑭ | Connection pin.          |
| ⑦ | Pull start assembly.         | ⑮ | Auger bit 100mmØ.        |
| ⑧ | Exhaust.                     | ⑯ | Auger bit 150mmØ.        |
|   |                              | ⑰ | Auger bit 200mmØ.        |

## 7. UNPACKING AND CHECKING

### 7.1 PACKAGING

Carefully remove the product from the packaging and examine it for any sign of damage that may have happened during shipping. If any part is damaged or missing, please contact the Draper Help Line (the telephone number appears on the Title page) and do not attempt to use the product.

The packaging material should be retained at least during the warranty period, in case the machine needs to be returned for repair.

#### Warning!

- Some of the packaging materials used may be harmful to children. Do not leave any of these materials in the reach of children.
- If any of the packaging is to be thrown away, make sure they are disposed of correctly, according to local regulations.

### 7.2 WHAT'S IN THE BOX

As well as the main product, there are several parts not fitted or attached to it.

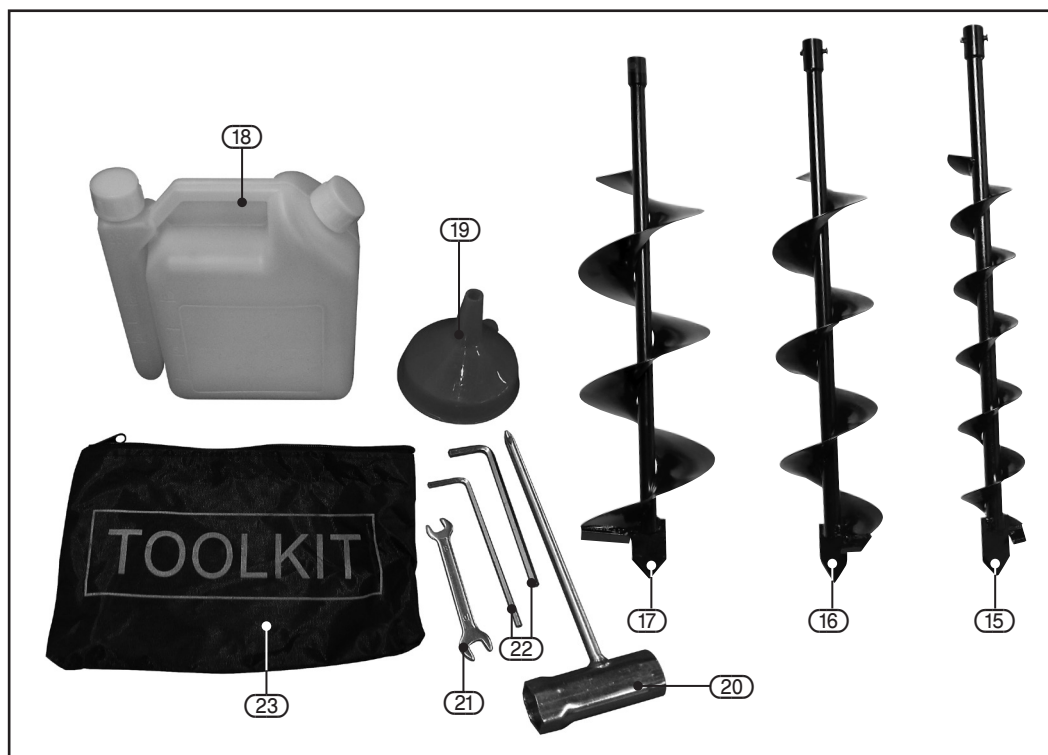

(15) Auger bit 100mmØ.

(16) Auger bit 150mmØ.

(17) Auger bit 200mmØ.

(18) 2-stroke mixing bottle.

(19) Funnel.

(20) Spark plug spanner/Screwdriver.

(21) Combination spanner.

(22) 2 × hex keys.

(23) Tool kit bag.

## 8. PREPARING THE FENCE POST AUGER

### 8.1 ATTACHING THE AUGER BIT – FIGS. 1 - 2

Warning! This machine must be operated with two hands at all times.

Note: Do not attempt to connect non-genuine accessories as it may result in injury or cause damage to this machine.

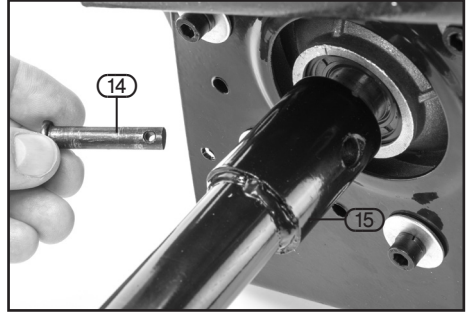

FIG.1

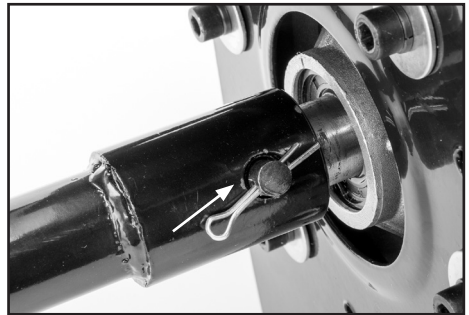

FIG.2

### 8.2 FUELLING – FIG. 3

This Draper petrol product is powered by an engine which **MUST** be filled with unleaded fuel **MIXED** with 2-stroke oil. Failure to add oil or incorrectly mixing the oil and fuel can result in running problems or engine failure. Any machine returned under warranty which is found to have failed due to a lack of lubrication will be considered a chargeable repair.

Only use fresh, clean, and good quality unleaded fuel mixed with synthetic 2-stroke oil in a ratio of 25:1.

The mixing container (18) is marked on the sides to allow the ratio of oil to be measured prior to mixing.

Fuel quality degrades rapidly: Avoid storing fuel by mixing only what you require.

Using fuel that has degraded will cause starting/running problems.

Use funnel (19) supplied to prevent fuel spillage. Never refuel the engine inside a building

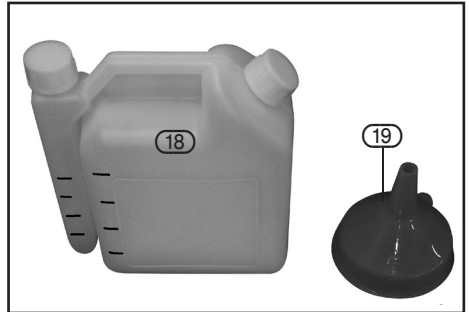

FIG.3

# 9. OPERATING INSTRUCTIONS

Do not attempt to start this machine until you have read and understood all the safety instructions.

## 9.1 STARTING THE ENGINE – FIGS. 4 - 6

**Note:** Ensure that the lanyard kill switch (12) is connected.

Switch the engine switch (10) to on.

**Cold starts** – close the choke to restrict the amount of air entering the engine. Slide the choke lever (4) to the OFF position.

**Warm starts** – open the choke to increase the amount of air entering the engine. Slide the choke lever (4) to the ON position.

- Prime the engine with fuel. Press the fuel primer (2) 3 or 4 times. The primer and fuel line from the tank should have fuel present.

**Attention!** Over priming will cause the engine to flood with too much fuel. This will engulf the spark plug and stop the engine from starting. There will be a stronger smell of fuel when this occurs.

- Grip the neck of the motor unit with your left hand holding the machine firmly on the ground. Crouch over the machine while maintaining firm footing.

**Attention!** Do not stand or apply any pressure on to the output shaft.

- With your right hand hold the pull start handle (7).
- Make 2 or 3 short, sharp pulls of the starter until the engine starts. If the engine does not start by the fifth crank, move the choke setting.

**Warning!** Do not pull the starter rope out fully as it may break. Do not release the starter rope and allow it to recoil unaided.

- When the engine starts, pull throttle lever (9) to release the 'start' position.
- When the engine has been running for a few minutes open the choke fully.

**Attention!** The majority of engines have an initial period in which the internal components bed themselves in. This engine is no different. During this the first 5 or 6 tank fills [bedding in period], running the engine in the very high rev. range must

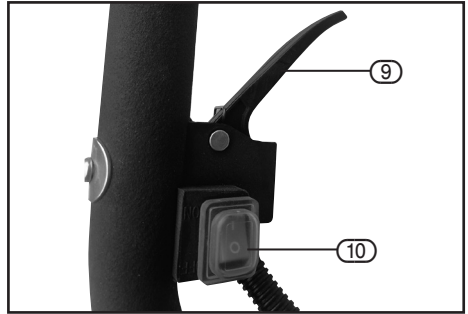

FIG.4

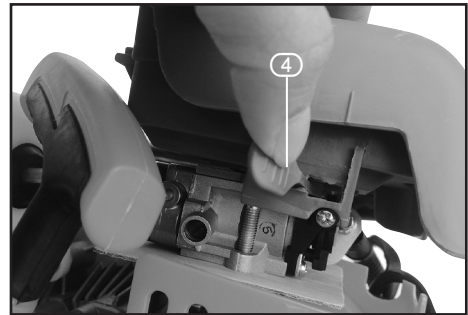

FIG.5



FIG.6

## 9. OPERATING INSTRUCTIONS

---

be avoided as the stresses involved can cause damage to the engine.

### 9.2 CORRECT STANCE – FIG. 7

This machine must be operated upright and held firmly, holding with both hands at all times.

### 9.3 DRILLING OPERATIONS

- Position the petrol auger at the chosen location for excavation.
- It is recommended to start drilling using half-throttle speed and to increase pressure on the throttle trigger gradually, especially when undertaking deeper boring tasks.

Warning: Beware of sudden machine recoil, as the machine may come into contact with hidden sub-surface rocks, debris and tree roots.



FIG.7

# 10. MAINTENANCE

## 10.1 CLEANING THE AIR FILTER – FIGS. 8 - 9

A dirty, clogged air filter will restrict the air flow in to the engine and will cause rough running. It will increase fuel consumption and may result in starting problems.

Attention! Stop the engine before removing the air filter assembly.

- Set the choke lever (4) to the OFF position to prevent any debris entering the carburettor inlet.
  - Using the supplied hex key (22), undo the retaining bolt on the air filter housing cover (1).
  - Remove and wash the foam air filter element (12) in warm soapy water to clean it. Do not use solvents to clean it.
  - Allow the filter to dry 100% before refitting it on to the engine.
- Replace the filter if it appears worn or damaged.

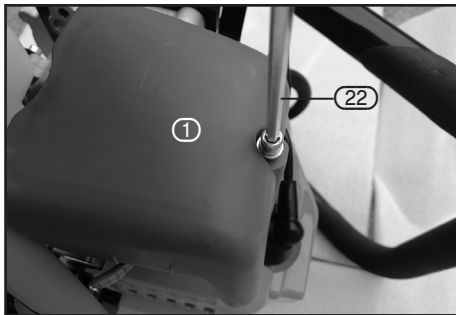

FIG.8



FIG.9

## 10.2 SPARK PLUG MAINTENANCE – FIG. 10

Over time the spark plug can become contaminated. This can be due to adverse running conditions such as, working with part throttle for a prolonged period or a fuel mix containing too much oil. This contamination can build up causing the engine to run roughly, reduce the fuel consumption or create starting problems.

- Without using any tools [so as to avoid damaging the H.T. lead] remove the lead (22) from the back of the spark plug.
- Using the spark plug spanner (20), turn the spark plug anticlockwise to remove it.
- Clean the spark plug and check the electrode gap. Maintain a gap of 0.6 to 0.7mm.

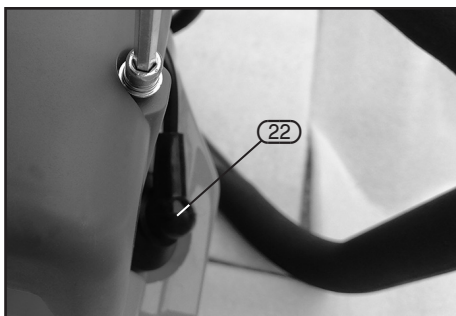

FIG.10

# 10. MAINTENANCE

## 10.3 ENGINE IDLE SPEED ADJUSTMENT – FIG.11

With the engine running at idle the attachment must not operate. For example, the auger bit must not spin while the engine idles. Adjust as necessary.

- Run the engine until it is warm.
- Turn screw (4.1) anticlockwise to decrease the engine idle speed.

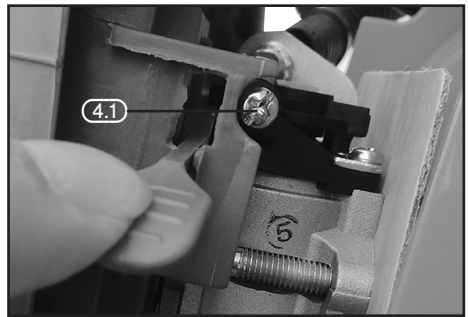

FIG.11

## 10.4 REPLACING THE FUEL FILTER – FIG.12

To make sure the supply of fuel remains clean there is a small fuel filter attached to the pick-up tube inside the fuel tank. This must be checked regularly and replaced when clogged.

- Drain fuel tank completely.
- Hook the pick-up tube through the tank opening.
- Gently pull the filter (5.1) clear of the tank mouth.
- While still holding the fuel line, pull the clogged filter off and insert the clean filter.

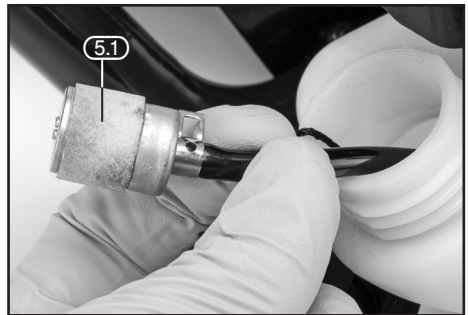

FIG.12

## 10.5 ENGINE LUBRICATION – FIG.13

- After the first 50 operating hours replace all of the engine lubricating oil.
- After the initial first oil change, the engine lubricating oil service interval is after every 100 hours of operating time; particularly if the engine casing is starting to get hot during operation.
- Always replace the oil with SAE80–90 grade lubricating oil.

Warning! When replacing the oil, always try to ensure that no oil is spilled over the exhaust port.

When checking the oil level, aim to keep the machine vertical and level to achieve an accurate assessment.

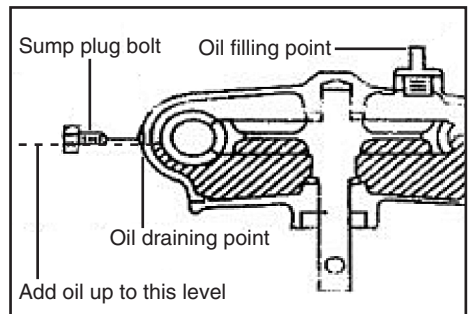

FIG.13

# 11. TROUBLESHOOTING

## 11.1 TROUBLESHOOTING

Problem	Probable cause	Suggested remedy
1. Engine will not start.	Engine stop switch activated.	Slide stop switch back to on position
	Little or no fuel.	Mix up a fresh batch of 25:1 [fuel with 2-stroke oil] and refill.
	Stagnant fuel (fuel has been stored too long).	Drain fuel tank. Mix up a fresh batch of 25:1 [fuel with 2-stroke oil] and refill.
	Spark plug electrode fouled or the gap is incorrectly set.	Remove and service/replace spark plug
	Spark plug H.T. lead not properly connected.	Push H.T. lead on firmly and make sure the engine housing is not preventing a good connection.
	Choke set incorrectly for the starting conditions.	Move the choke to the other setting and try again.
	Air filter clogged.	Clean/replace air filter.
	Engine flooded with fuel (the engine has been over primed)	Remove spark plug and dry the electrode of fuel. Pull the start handle 2 or 3 times without the spark plug fitted. Wait a moment before refitting the spark plug and trying again.
	Fuel filter clogged	Replace fuel filter [in fuel tank].
2. Engine will not restart after refuelling.	No fuel in the lines.	If the engine was run until starved of fuel, repriming may be necessary to purge any air from the fuel supply line.
3. Engine runs roughly.	Choke set incorrectly.	Adjust choke.
	Service due.	Clean/replace air filter and spark plug.
	Stagnant fuel (fuel has been stored too long).	Drain fuel tank. Mix up a fresh batch of 25:1 [fuel with 2-stroke oil] and refill.
4. Heavy blue smoke from exhaust.	The fuel, oil mix is incorrect.	Drain fuel tank. Mix up a fresh batch of 25:1 [fuel with 2-stroke oil] and refill.

# 11. TROUBLESHOOTING

<b>Problem</b>	<b>Probable cause</b>	<b>Suggested remedy</b>
5. Engine will not start.	Power switch off.	Switch to ON position.
	Spark plug wire disconnected.	Connect spark plug wire to spark plug.
	Out of fuel	Refuel.
	Spark plug wet, faulty or improperly gapped.	Clean, replace or correctly gap spark plug.
	Throttle control not held wide open.	Hold throttle control wide open when pulling recoil handle.
	Fuel line hose not positioned in bottom of fuel tank.	Push fuel line down into fuel in fuel tank.
6. Engine runs rough, floods during operation.	Dirty air filter.	Clean or replace air filter.
	Choke partially engaged.	Turn off choke.
	Carburettor out of adjustment.	Call service agent.
7. Engine is hard to start.	Start fuel.	Drain old fuel and replace with fresh. Use fuel stabilizer at end of season.
	Spark plug wire loose.	Make sure spark wire is securely attached to spark plug.
	Dirty carburettor.	Clean carburettor, use fuel stabilizer, new fuel can.
	Throttle control not held wide open.	Prime unit 3 more times, then hold throttle wide open when pulling recoil handle.
8. Engine misses or lacks power.	Clogged fuel tank.	Remove and clean.
	Clogged air filter.	Clean or replace.
	Carburettor out of adjustment or badly set.	Call service agent.
	Spark plug wet, faulty or improperly gapped.	Clean, replace or correctly gap spark plug.
9. Engine runs, then quits.	Plugged fuel filter.	Clean or replace.
	Carburettor cut off adjustment badly set.	Call service agent.

## 11. TROUBLESHOOTING

<b>Problem</b>	<b>Probable cause</b>	<b>Suggested remedy</b>
10. Engine revs too high.	Carburettor out of adjustment	Call service agent.
11. Auger turns at idle.	Idle speed too high.	Adjust idle speed lower.
	Broken clutch spring.	Replace spring.
12. Auger turns, but has no power.	Choke off.	Turn on choke after engine is running.
	Carburettor out of adjustment.	Call service agent.
	Broken transmission.	Call service agent.
	Worn clutch shoes.	Replace clutch shoes and spring.
	Worn engine lower seat.	Call service agent.
13. Auger jumps.	Blade damaged.	Replace with new blade.
14. Auger cuts slowly.	Dull blade.	Buy new blade, or have blade sharpened at service agent.
	Damaged pilot drill.	Replace pilot drill.

# 12. EXPLANATION OF SYMBOLS

## 12.1 EXPLANATION OF SYMBOLS



Read the instruction manual.



**Always** wear suitable eye/face protection.



**Warning!** Noise.  
Wear ear defenders.



**Always** wear gloves.



**Warning!**  
Keep away from source of ignition.



Not weatherproof.



Outdoor use only.



The exhaust gets very hot during operation.



Keep distance.



**Warning!**  
Beware of flying debris.



**Warning!**  
Protect feet from risk of injury.



Fuel/2-stroke oil mixture ratio.



**Warning!**  
Hot surface.



Continuous A-Weighted Sound Pressure Level.

# 13. DISPOSAL

---

## 13.1 DISPOSAL

- At the end of the machine's working life, or when it can no longer be repaired, ensure that it is disposed of according to national regulations.
- Contact your local authority for details of collection schemes in your area.

In all circumstances:

- Do not dispose of power tools with domestic waste.
- Do not incinerate.
- Do not abandon in the environment.
- When decommissioning (preparing the machine to be scrapped) drain any remaining fuel and oil for separate disposal.

## **CONTACTS**

Draper Tools Limited, Hursley Road,  
Chandler's Ford, Eastleigh, Hampshire. SO53 1YF. U.K.

Help Line: (023) 8049 4344

Sales Desk: (023) 8049 4333

Internet: [drapertools.com](http://drapertools.com)

E-mail: [sales@drapertools.com](mailto:sales@drapertools.com)

General Enquiries: (023) 8026 6355

**Service/Warranty Repair Agent:**

For aftersales servicing or warranty repairs, please contact the Draper Tools Help Line for details of an agent in your local area.

## **YOUR DRAPER STOCKIST**

TAMC0121

©Published by Draper Tools Limited.

No part of this publication may be reproduced, stored in a retrieval system or transmitted in any form or by any means, electronic, mechanical photocopying, recording or otherwise without prior permission in writing from Draper Tools Ltd.