

 vornadobaby

# Owner's Handbook

read & save these important instructions

manual del propietario

lea y guarde estas instrucciones importantes

mode d'emploi

lire et conserver ces instructions importantes



HELLO, I'M  
**Breesi**   
with soothing light + sound

## nursery air circulator

Hola, me llamo Breesi LS, circulador de aire para salas de cuna.

Bonjour, je suis le Breesi LS, ventilateur de chambre de bébé.

# Welcome to Vornadobaby

Thank you for choosing to put a Vornadobaby product in your nursery. Our goal is to provide healthy, comfortable air - through every season. Vornado has been doing this for quite a while now. We've brought all our experience in air health and comfort, and tailored it exclusively for your nursery.

---

A THIRD  
generation  
NAME

Vornado®



vornadobaby™

Vornado began in 1945, continues to revolutionize airflow today and is now tailored for the nursery.

# Contents

Important Instructions.....	4
Safety.....	6
Breesi LS Controls.....	7
Plug In & Placement.....	8
How To Use.....	10
Keeping Breesi LS Clean .....	12
Tips .....	14
Troubleshoot .....	15
Warranty.....	16



# IMPORTANT INSTRUCTIONS

## READ ALL INSTRUCTIONS BEFORE USING.

Please visually inspect all internal and external components before connecting to electric current. If any damage is found, **DO NOT USE THIS UNIT** and contact Vornado Air LLC at 1-800-234-0604.

This appliance has a polarized plug. (One blade is wider than the other.) To reduce the risk of electrical shock, this plug is intended to fit in a polarized outlet only one way. If the plug does not fit fully in the outlet, reverse the plug. If it still does not fit, contact a qualified electrician. Do not attempt to defeat this safety feature.

**WARNING** - To reduce the risk of fire or electrical shock, do not use this product with any solid state speed control device. To reduce the risk of fire or electric shock and injury to persons, do not use in a window.

This product employs overload protection (fuse). A blown fuse indicates an overload or short-circuit situation. If the fuse blows, unplug the product from the outlet. Replace the fuse as per the user servicing instructions (follow product marking for proper fuse rating) and check the product. If the replacement fuse blows, a short-circuit may be present and the product should be discarded or returned to an authorized service facility for examination and/or repair.

When using electrical appliances, basic precautions should always be followed to reduce the risk of fire, electric shock, and injury to persons, including the following:

- Read all instructions before using this circulator.
- **Do** use common sense when using this product and/or any electrical appliance.
- **Do** unplug your circulator before cleaning.
- **Do** clean your Vornado Air Circulator regularly. Refer to the CLEANING instructions provided. Never clean the air circulator in any manner other than as instructed in this manual.
- **Do Not** use gasoline, thinners, solvents, ammonias or other chemicals for cleaning.
- **Do Not** immerse this product in water or allow water to drip into the motor housing.
- **Do Not** use near furnaces, fireplaces, stoves or other high-temperature heat sources.
- Always unplug when not in use or when leaving the dwelling or premises for extended periods of time.
- **Do Not** carry this product by the cord, or use the cord as a handle.
- **Do Not** operate any circulator with a damaged cord or plug or after the circulator malfunctions, has been dropped or damaged in any manner. Discard circulator, or return to authorized service facility for examination and/or repair.
- **Do Not** attempt to repair or replace parts.
- **Do Not** use outdoors.
- **Do Not** use this product on wet surfaces.
- **Do Not** use this product in a bathtub or shower.
- **Do Not** run cord under carpeting. Do not cover cord with throw rugs, runners, or similar coverings. Do not route cord under furniture or appliances. Arrange cord away from traffic area and where it will not be tripped over.
- To disconnect circulator, turn controls to off, then remove plug from outlet.

- **Do Not** position this product too close to draperies because they may be drawn into the rear grill, cutting off airflow.
- Use this circulator only as described in this manual. Any other use not recommended by the manufacturer may cause fire, electric shock, or injury to persons.
- Operate this circulator only in its upright position.
- **Do Not** use this circulator on a circuit that has a variable speed device operating, such as a blender or a variable speed fan.

## User Servicing Instructions

Grasp plug and remove from the receptacle or other outlet device. Do not unplug by pulling on cord. Open fuse cover (A.) by sliding access cover on top of attachment plug towards blades. Remove fuse carefully (B.) by gently prying out the ends of the fuse from the receptacle. Risk of fire. Replace fuse only with 2.5 Amp, 125 Volt fuse. Contact Vornado customer service for replacement fuse. Phone: 1-800-234-0604, email: support@vornadobaby.com

Install replacement fuse (C.) by first placing the end of the fuse into the fuse receptacle which is opposite of the blades of the plug, then carefully push in the other end. Only push against the metal end of the fuse, not the glass center portion. Close the fuse access cover (D.) by sliding the cover back into the plug until it is completely closed, latches and is flush with the face of the plug. Risk of fire. Do not replace attachment plug. Contains a safety device (fuse, AFCI, LCDI) that should not be removed. Discard product if the attachment plug is damaged.

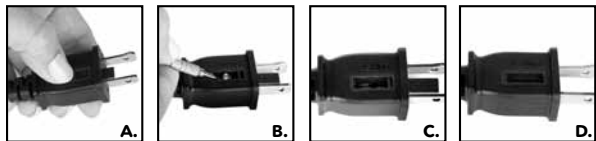

**Note:** This equipment has been tested and found to comply with the limits for Class B digital device, pursuant to part 15 of the FCC Rules. These limits are designed to provide reasonable protection against harmful interference in a residential installation. This equipment generates, uses and can radiate radio frequency energy and, if not installed and used in accordance with the instructions, may cause harmful interference to radio or television reception, which can be determined by turning the equipment off and on, the user is encouraged to try to correct the interference by one or more of the following measures:

- Reorient or relocate the receiving antenna.
- Increase the separation between the equipment and the receiver.
- Connect the equipment into an outlet on a circuit different from that to which the receiver is connected.
- Consult the dealer or an experienced radio/TV technician for help.

This device complies with part 15 of the FCC Rules. Operation is subject to the following two conditions: (1) This device may not cause harmful interference, and (2) this device must accept any interference received, including interference that may cause undesired operation.

Industry Canada ICES-003 Compliance: CAN ICES-3 (B)/NMB-3(B)

**Warning:** Changes or modifications to this unit not expressly approved by the party responsible for compliance could void the user's authority to operate the equipment.

## READ AND SAVE THESE INSTRUCTIONS

# Safety

**Plug It In Safely!** Your Breesi LS has a 6 ft. power cord is covered for additional safety. Vornado recommends placing product as close to an outlet as possible and securing the remaining cord.



## Locking Controls

Keep Breesi LS Off when not in use or lock in your desired settings.



## No Exposure to Mechanical Parts

360° of protection.



## Finger Friendly Design

Resists curious fingers.



## Covered Power Cord Storage

Safely store power cord inside base of Breesi LS.



## No Pinch Points or Sharp Edges

To help protect a tumbling toddler.

# Breesi LS Controls



- ① Power (⏻)
- ② Fan (🌀 - ● Low, ● Medium, ● High)
- ③ Soothing Dimmable Light (💡)
- ④ Sound Soother (🎵)
- ⑤ Control Lock (🔒)

# Plug In & Placement

## Power Cord Storage

For your convenience and safety the Power Cord Storage keeps the power cord neat and out of harms way.

1. Lift the Power Cord Storage flap to locate plug, then unwind the power cord stored inside.

**Safety Tip:** Power cords increase strangulation risks. Secure as much excess cord as possible inside the Power Cord Storage.

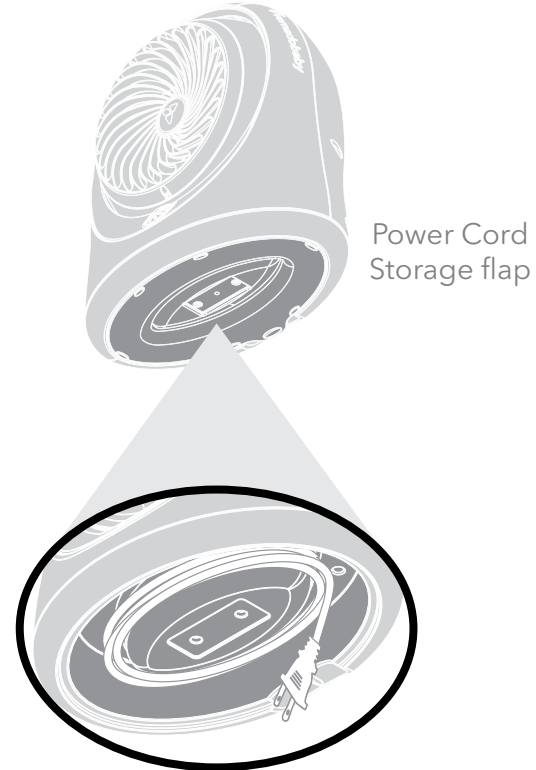

## Set Up

1. Position your Breesi LS so the vortex beam of air is directed across the room, unobstructed.
2. Plug power cord into standard wall outlet.

**Safety Tip:** It is best to position the Breesi LS close to the power outlet and store excess power cord inside the Power Cord Storage.

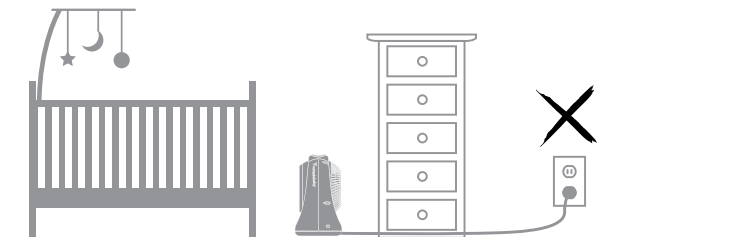

# How To Use

## Fan

1. Press Power button On (⏻). The control panel will illuminate when On and dim after approximately 20 seconds.



2. Select desired Fan (🌀) setting. High speed (⋮), Medium speed (⋅) or Low speed (●).



3. Adjust the airflow direction by pivoting the Breesi LS head.

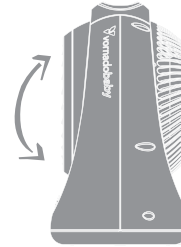

## Using Soothing Dimmable Light

1. Press the Soothing Dimmable Light button (💡) for a soft night time glow. Press the (+/-) button to adjust between 5 levels of the brightness.



Soothing  
Dimmable Light  
Area

## Using Sound Soother

1. Press the Sound Soother button (🎵) to cycle through 4 sound options: White Noise, Brookside, Froggy Night and Womb. Press the (+/-) button to control the volume between 10 levels. To power sounds Off, continue to press the Sound Soother button until it cycles Off.

**Note:** Previous control settings are kept for the next time Breesi LS is powered On, unless Breesi LS is unplugged.



## Breesi LS features a child-resistant switch, keeping the fan in parents' desired setting.

### Lockable Controls

1. To engage this feature press and hold the Control Lock button (🔒) for 3 seconds. The Control Lock icon will blink 3 times rapidly to show it is locked.



**Note:** The Control Lock icon will blink 3 times slowly if any button is pressed while the Control Lock is engaged. While this feature is engaged you will not be able to change the settings or Power Breesi LS On or Off. If Breesi LS is powered Off, you may still engage the Control Lock.

2. To turn this feature Off press and hold the Control Lock button (🔒) for 3 seconds.

# Keeping Breesi LS Clean

## Cleaning the Grill

1. Power Breesi LS Off and unplug.
2. Using a Phillips Head screwdriver, remove the screw located at the 6 o'clock position in the front of the grill.

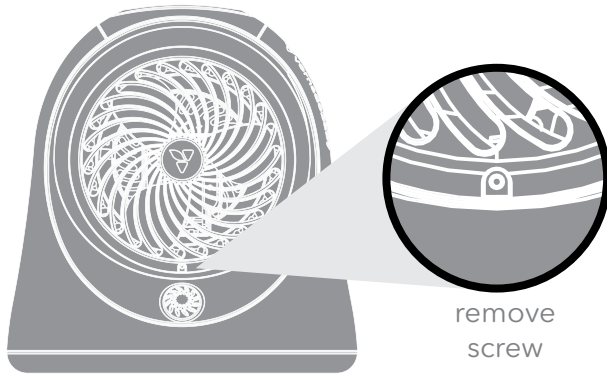

3. Twist Grill counterclockwise to unlock and pull out.

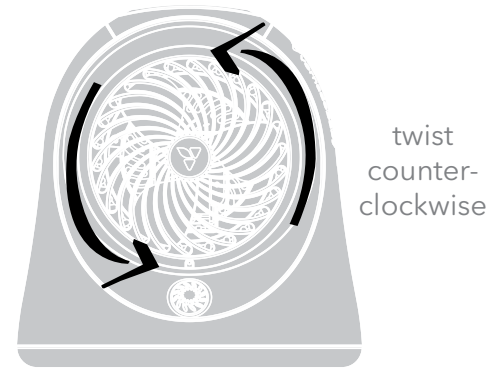

4. Dust or vacuum the Grill and Blade.

**Note:** Do not use gasoline, thinners, solvents or other chemicals for cleaning.

**Always unplug Breesi LS before starting any part of the cleaning process.**

5. Reinstall Grill. Replace Grill onto Bresi LS and twist clockwise until the Grill aligns with the screw hole. Replace screw.

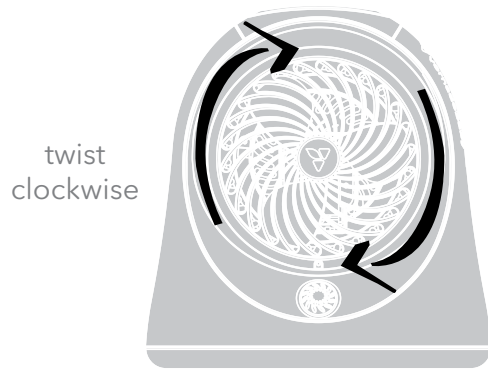

### Cleaning the Blade

It is possible to remove the blade should something accidentally get wrapped around the motor shaft.

1. First, remove the nut from the shaft. Turn the nut clockwise to loosen. Pull the Blade straight out from the shaft.

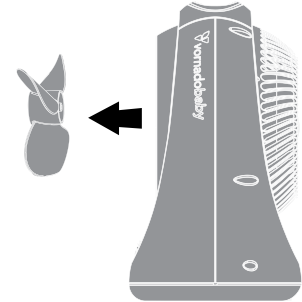

2. When replacing, be certain the flat side of the shaft aligns directly with the corresponding flat side on the Blade's socket. Push the Blade all the way on the shaft. Do not use a hammer as this could result in bearing damage. Reinstall nut counter-clockwise until secure.

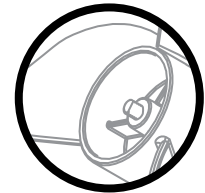

**Always unplug Bresi LS before starting any part of the cleaning process.**

# Tips

- During the off-season or after extended periods of non-use, you may choose to store your Breesi LS. To ensure long life of the product, it is recommended to store your Breesi LS by following these instructions:
  - Unplug power cord and wrap cord neatly inside the Power Cord Storage.
  - Thoroughly clean your Breesi LS. Use the brush attachment on your household vacuum cleaner to vacuum any accumulated dust on Breesi LS or wipe down the entire surface with a soft cloth. You may also use a can of compressed air for debris.
  - Always set Power to Off and unplug Breesi LS before cleaning.
  - Cover, or place Breesi LS back into retail carton if available. This will prevent Breesi LS from accumulating dust over time.
  - Store Breesi LS in a cool and dry location.
- The motor is permanently lubricated and requires no oiling. Do not use gasoline, thinners, solvents or other chemicals for cleaning.
- Your Breesi LS has no user serviceable parts. Do not disassemble Breesi LS. This will void your warranty. If service is required, return your Breesi LS to Vornado (see WARRANTY for instructions).
- Your night light uses an electroluminescent element to create a soft, soothing glow. The element may dim slightly over time depending on frequency of use.

# Troubleshoot

<b>Unit fails to power on.</b>	Unit is not plugged in. Plug Power Cord into electrical outlet.
	Ensure unit fan speed setting is selected.
	Plug fuse has blown. Replace fuse (See USER SERVICING INSTRUCTIONS on page 5).
	Unit is damaged or in need of repair. Cease usage and unplug. Contact Consumer Service for assistance.
	The outlet is worn or damaged. Try another outlet or contact a qualified electrician.
<b>Airflow is weak or slow.</b>	Unit set to a low speed setting. Adjust to a higher speed setting.
	Airflow is blocked. Remove obstruction.
	Adjust direction of airflow towards the user.



# Happy Parent Guarantee

Call Toll Free

800.234.0604

[www.vornadobaby.com](http://www.vornadobaby.com)

[support@vornadobaby.com](mailto:support@vornadobaby.com)

If you're not satisfied with this product, let us know. We'll go the extra mile to ensure you're a happy Vornadobaby parent!

Vornado Air LLC ("Vornado") warrants to the original consumer or purchaser this Vornadobaby® Breesi LS Nursery Air Circulator ("Product") is free from defects in material or workmanship for a period of five (5) years from the date of purchase. If any such defect is discovered within the warranty period, Vornado, at its discretion, will repair or replace the Product at no cost.

## For warranty or repair service:

Call 1-800-234-0604 or email [support@vornadobaby.com](mailto:support@vornadobaby.com) to obtain a Return Authorization ("RA") form. Please have or include your Product's model number and serial number, as well as your name, address, city, state, zip code and phone number when contacting Vornado for warranty service.

## After receiving the RA form, ship your Product to:

Vornado Air LLC Attn: Warranty & Repair 415 East 13th Street Andover, KS 67002  
For your convenience, please have your model number and serial number when contacting Vornado with service inquiries. To assure proper handling, packages must be clearly marked with the RA number. Packages not clearly marked with the RA number may be refused at the receiving dock. Please allow 1-2 weeks for repair and return of your Product after the Product is received.

Product registration available online at [www.vornadobaby.com](http://www.vornadobaby.com)

Repairs not covered by the warranty or outside the warranty period will

require a fee to cover the cost of materials, labor, handling and shipping.

This warranty does not apply to defects resulting from abuse of the Product, modification, alteration, repair or service of the Product by anyone other than Vornado, mishandling, improper maintenance, commercial use of the Product, damages which occur in shipment or are attributed to acts of God. REPAIR OR REPLACEMENT AS PROVIDED UNDER THIS WARRANTY IS THE EXCLUSIVE REMEDY OF THE CONSUMER. VORNADO SHALL NOT BE LIABLE FOR ANY INCIDENTAL OR CONSEQUENTIAL DAMAGES FOR BREACH OF ANY EXPRESS OR IMPLIED WARRANTY ON THIS PRODUCT. EXCEPT TO THE EXTENT PROHIBITED BY APPLICABLE LAW, ANY IMPLIED WARRANTY OF MERCHANTABILITY OR FITNESS FOR A PARTICULAR PURPOSE ON THIS PRODUCT IS LIMITED IN DURATION TO THE DURATION OF THIS WARRANTY. Some states do not allow the exclusion or limitation of incidental or consequential damages, or allow limitations on how long an implied warranty lasts, so the above limitations or exclusions may not apply to you. This warranty gives you specific legal rights, and you may have other rights that vary from state to state.



Designed, engineered and supported in Andover, KS

© 2015 Vornado Air LLC Andover, KS 67002 U.S. Patent Pending. Specifications subject to change without notice. Vornado® and Vornadobaby® are trademarks owned by Vornado Air LLC.



Speak your mind [www.vornadobaby.com/reviews](http://www.vornadobaby.com/reviews)  
Hable con franqueza [www.vornadobaby.com/reviews](http://www.vornadobaby.com/reviews)  
Évaluer ce produit en ligne [www.vornadobaby.com/reviews](http://www.vornadobaby.com/reviews)

Vornado Air, LLC  
415 East 13th Street, Andover, Kansas 67002  
800.234.0604  
[www.vornadobaby.com](http://www.vornadobaby.com)  
[support@vornadobaby.com](mailto:support@vornadobaby.com)