

Fanttik

REX K2 APEX

Cordless Impact Driver



Please read this instruction manual carefully before use and save it for future reference.

Contents

1. Safety Instructions	02
2. Package Contents	03
3. Product Overview	04
4. Operation and Functions	05
5. Specifications	11
6. Troubleshooting	13
7. Warranty	14

1. Safety Instructions

- Avoid exposure to moisture, dust, and dropping.
- Do not store or operate the product in extreme temperature environment.
- Stay alert, watch what you are doing and use common sense when operating. Do not operate while you are tired or under the influence of drugs, alcohol or medication.
- Use personal protective equipment. Always wear eye protection.
- This product is not a toy and should not be used by children.
- This product contains a built-in battery. Do not throw it into fire. Dispose of the battery according to local laws and regulations.
- Do not dismantle the machine by yourself. Have your power tool serviced by a qualified repair person or contact us for advice.

2. Package Contents



Impact driver x 1

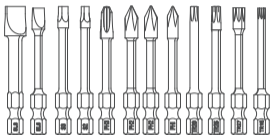

Impact bits x 12

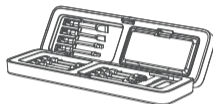

Accessory storage case x 1

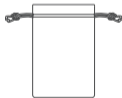

Storage bag x 1



USB charging cable x 1

QUICK GUIDE

Quick start guide x 1

User Manual

User Manual x 1

3. Product Overview

1. 1/4" Hex Drive Chuck
2. LED Work Light
3. Variable Speed Trigger
4. Side Button
5. Side Screen
6. Torque Setting Knob
7. Main Screen
8. Mode Switch Button
9. Type-C Charging Port

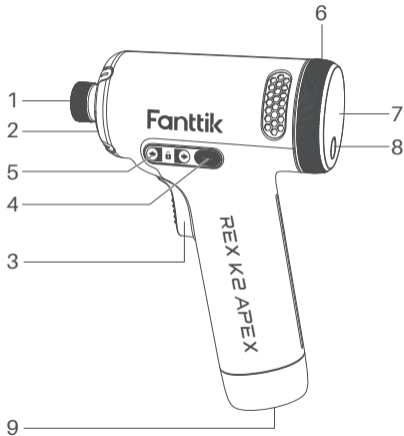

4. Operation and Functions

Turn On and Unlock the Tool

The safety lock is engaged by default, please unlock it before first use.

- For the first time use, pull the Variable Speed Trigger to turn on the tool, then press the Side Button for 2 seconds to unlock the tool for further operation.

Side Button (Direction select & Children/Transportation safety lock button)

- Press and hold the Side Button for 2 seconds to unlock the tool; after use, please press and hold the button for 2 seconds to lock the tool to prevent accidental use by children or during transport. In locked mode, a lock symbol appears on the Side Screen; in unlock mode, the lock symbol disappears.



Locked



Unlocked

- In unlocked mode, quick press the Side Button to switch rotation directions. A corresponding forward or reverse arrow symbol appears on the Side Screen.
- Please lock the tool for safe transportation or to prevent accidental access by children.



Variable Speed Trigger

- To start the tool, grasp the handle firmly and pull the trigger. The Main Screen and Side Screen will be activated simultaneously.
- To vary the speed, increase or decrease the pressure on the trigger. The further the trigger is pulled, the greater the rotational speed.
- To stop the tool, release the trigger. Ensure the tool has come to a complete stop before laying the tool down.

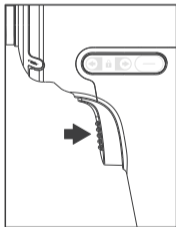

Installing and Removing Bits

This driver is intended for use with drill or driver bits with a 1/4" shank and ball detent recess. Please be cautious, do not start the tool when installing or removing bits.

- To install a bit, pull out the chuck collar (1) and press the bit shank into the chuck (2).
- To remove a bit, pull out the chuck collar (1) and remove the bit (2), then release the collar.

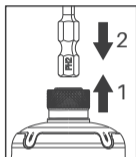

Attach

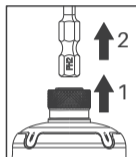

Remove

Working Modes and Mode Switch Button

- The tool has two working modes: Regular working mode and AutoAssist mode. Shortly press the Mode Switch Button to toggle between two modes.
- Regular working mode: Enables manually select torque level by rotating the Torque Setting Knob, the Main Screen also displays the torque selected.



Regular Mode

- AutoAssist mode: Torque selection is disabled, the Main Screen displays 'AU' and "Ⓐ" symbols. In this mode, the tool automatically halts when fastening a screw fully into material, this helps prevent over-tightening (*Performance may vary depending on material and self-tapping screw size. The motor may occasionally stop before the screw is fully seated.)



AutoAssist Mode

Torque Setting Knob

- In regular working mode, rotate the Torque Setting Knob to select torque output: 20, 40, 60, 80, 100 N·m (177, 354, 531, 708, 885 in-lbs). The higher torque setting also results in higher rotational speed. The maximum unloaded speed is 3000 RPM when setting to 100 N·m.



Turn On/Off the LED Work Light

- The LED Work Light turns on automatically when the Variable Speed Trigger is pulled. The light remains on for 10 seconds after the trigger is released.

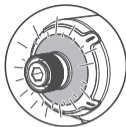

Turn Off the Tool

- The tool powers on when the Variable Speed Trigger is pulled and automatically powers off 10 seconds after the trigger is released.

Power indicator

- A battery symbol is always displayed on the Main Screen indicating current battery level. When the symbol is empty, please charge the tool.
- While charging, the green arc LED indicator and the battery symbol will flash.
- When the battery is fully charged, both the arc LED indicator and battery symbol will remain solid.



Battery charging

- The tool has USB type-C charging port. A USB-C to USB-C charging cable is included, charger is NOT included. The tool supports a maximum 10W (5V/2A) charging input.
- Note: For safety, the tool is programmed to be inoperable while charging.

5. Specifications

Product Name	Cordless Impact Driver
Product Model	REX K2 APEX
Impact Driver Dimensions	5.3 x 2.1 x 7.1 inches (135 x 54 x 180 mm)
Impact Driver Net Weight	1.88 lb. (855g)
Torque Settings	20, 40, 60, 80, 100 N·m (177, 354, 531, 708, 885 in-lbs)
Max. Speed (unloaded)	3000 RPM
Battery Capacity	3000mAh/21.6Wh
Rated Voltage	7.2V
Charging Input	5V/2A
Charging Time	150-180min
Storage Temperature	-4°F-140°F(-20°C-60°C)
Working Temperature	32°F-113°F(0°C-45°C)VVT

Bit specifications

Bit Shank: 1/4-inch (6.35mm) hex shank

Bit Material: Coated S2 Steel

Bit Type: Impact Driver Bit

Bit List:

 Phillips PH1, PH2*2, PH3

 Tamper-Resistant Torx TR15, TR20, TR25, TR27

 Slot SL6, SL8

 Square S2, S3

6. Troubleshooting

Error Code	Error Cause	Recovery Action
E0	Battery overheated	Waiting for cool down
E1	Overvoltage fault	Press trigger again, if error persists, wait for up to 48h
E2	Startup error	Release the trigger
E3	MOSFET overheating	Waiting for cool down
E4	Overcurrent fault	Release the trigger
E5	Short-circuit protection	Release the trigger
E6	Motor stalling fault	Release the trigger
E7	Electrical fault	Release the trigger
E8	MOSFET driver fault	Release the trigger
E9	Battery pack fault	Release the trigger, if error persists, wait for up to 48h
EB	Static bias current anomaly	Hardware fault, contact support

*If you cannot find a solution to the issue encountered, please contact us at support@fanttik.com, we provide timely and effective online after-sales service.

7. Warranty

This product is covered by a **12-month** limited warranty for manufacturing defects.



Lienco SAS
8 RUE MARCEL CERDAN, BUSSY
SAINT GEORGES, 77600, France
Email: contact@lienco.eu
Phone/Fax: +33766929910



CET Product Service Ltd.
Beacon House Stokenchurch Business
Park, Ibstone Rd, Stokenchurch High
Wycombe HP14 3FE UK
Email: info@cetproduct.com
Phone/Fax: +44 7419325266



points de collecte sur www.quefairedemesdechets.fr
privilégiez la réparation ou le don de votre appareil !

[Service hotline available in the U.S. and Canada only]

929-693-6066 MON-FRI 9AM-5PM[ET]

www.fanttik.com

support@fanttik.com

Manufacturer/Hersteller: METASEE LLC

Address/Adresse: 12 GREENWAY PLZ STE 1161A

HOUSTON, TX 77046-1203

Made in China CAN ICES(B)/NMB(B)

