

beurer

LA 30



EN Aroma diffuser
Instructions for use

CE



Read these instructions for use carefully and keep them for later use, be sure to make them accessible to other users and observe the information they contain.



WARNING

- This device may be used by children over the age of eight and by people with reduced physical, sensory or mental skills or a lack of experience or knowledge, provided that they are supervised or have been instructed on how to use the device safely, and are fully aware of the consequent risks of use.
- Children must not play with the device.
- Cleaning and user maintenance must not be performed by children unless supervised.
- Disconnect the device from the mains supply during filling or cleaning.
- Do not use any solvent-based cleaning products.
- If the mains connection cable of this device is damaged, it must be disposed of. If it cannot be removed, the device must be disposed of.
- Be aware that high humidity levels may encourage the growth of biological organisms in the environment.

- Do not permit the area around the device to become damp or wet. If dampness occurs, turn the output of the device down. If the output volume cannot be turned down, use the device intermittently. Do not allow absorbent materials, such as carpeting, curtains, drapes, or tablecloths, to become damp.
- Never leave water in the reservoir when the appliance is not in use.
- Empty and clean the device before storage. Clean the device before next use.
- Micro-organisms that may be present in the water or in the environment where the appliance is used or stored, can grow in the water reservoir and be blown in the air causing very serious health risks when the water is not renewed and the tank is not cleaned properly every three days.

Table of contents

1. Included in delivery	4	8. Cleaning and maintenance	10
2. Signs and symbols	4	9. Accessories and replacement parts	10
3. Warnings and safety notes	5	10. What if there are problems?	10
4. Intended use	6	11. Disposal	10
5. Device description	7	12. Technical specifications	11
6. Initial use	7	13. Warranty / Service	11
7. Usage	9		

1. INCLUDED IN DELIVERY

Check that the delivery has not been tampered with and make sure that all components are present. Before use, ensure that there is no visible damage to the device or accessories and that all packaging material has been removed. If you have any doubts, do not use the device and contact your retailer or the specified Customer Services address.

1x aroma diffuser













1x mains adapter



1x measuring jug

1x set of instructions for use

2. SIGNS AND SYMBOLS

The following symbols appear in these instructions for use and on the device:

	Warning Warning instruction indicating a risk of injury or damage to health
	IMPORTANT Safety note indicating possible damage to the device/accessory.
	Product information Note on important information
	Read the instructions
	The electronic device must not be disposed of with household waste
	CE labelling This product satisfies the requirements of the applicable European and national directives.
	Manufacturer
	Separate the packaging elements and dispose of them in accordance with local regulations.
	Marking to identify the packaging material. A = Material code, B = Material number: 1-7 = Plastics, 20-22 = Paper and cardboard
	Separate the product and packaging elements and dispose of them in accordance with local regulations.
	The products demonstrably meet the requirements of the Technical Regulations of the EAEU.
	Energy efficiency level 6

	United Kingdom Conformity Assessed Mark
	water tank, periodical cleaning
	Importer

3. WARNINGS AND SAFETY NOTES

Non-observance of the following information may result in personal injury or material damage.

Safety notes

WARNING

- Keep packaging material away from children! Choking hazard!
- If you suffer from a severe respiratory or lung disease, consult your doctor before using the device.
- If you start to feel unwell while the device is in use, stop using it immediately, switch the device off and ventilate the room.
- The appliance is only to be used with the recommended vaporizing medium. The use of other substances may give rise to a toxic or fire risk.

Electric shock

WARNING

As with every electrical device, use this device carefully and cautiously, in order to avoid hazards due to electric shock.

- Therefore, observe the following instructions for use:
 - Only use this device with the voltage specified on the device
 - Never use the device if it shows visible signs of damage
 - Do not use the device during a thunderstorm
- In the case of defects or operational faults, switch the device off immediately and disconnect the device from the mains socket. Do not pull on the mains cable or on the device to disconnect the mains adapter from the socket. Never hold or carry the device by the mains cable.
- Only use the device in dry rooms (e.g. never in the bath, sauna).
- Never reach for a device that has been submerged in water. Disconnect the mains adapter immediately.
- Do not drop the device or subject it to any impacts.
- Do not clamp or pinch the mains cable.
- Ensure that the mains cable and mains adapter do not come into contact with water, steam or other liquids.

Repairs

WARNING

Only specialist personnel may perform repairs on electrical devices. Improper repairs may subject users to considerable danger. For repairs, please contact Customer Services or an authorised retailer.

Risk of fire

WARNING

There is a risk of fire if the device is used improperly or these instructions for use are ignored. Therefore, observe the following instructions for use:

- Never use underneath a cover, such as a blanket, pillow, etc.
- Never use near petrol or other highly flammable substances.

Handling

IMPORTANT

- The device must be switched off and disconnected from the mains every time after use and before cleaning.
- Ensure that the mains cable does not pose a trip hazard.
- Do not insert any objects into openings on the device.
- Do not place any objects on the device.
- Do not expose the device to high temperatures.
- Avoid water damage by handling the device carefully (e.g. water damage from splashing in the vicinity of wooden floors).
- If the device should accidentally tip over, water may escape, even if the device is switched off and unplugged.
- The immediate vicinity of the device can become damp.
- Calcareous water can leave white deposits.
- Do not place the device on the floor, but in a raised position (e.g. on a table or chest of drawers).
- Position the device so that the mist outlet is not directed towards objects.
- Empty any remaining water when the device is not in use.
- The water tank and the cover are made of oil-resistant materials. Keep aroma oils away from other components of the device as these could become damaged by certain ingredients within the oils.

4. INTENDED USE

The aroma diffuser is only to be used for improving the ambient scent in a room. The device is intended for private use.

Use the device for the intended purpose only and in the manner specified in these instructions for use. Any form of improper use can be dangerous. The manufacturer is not liable for damage resulting from improper or careless use.

5. DEVICE DESCRIPTION

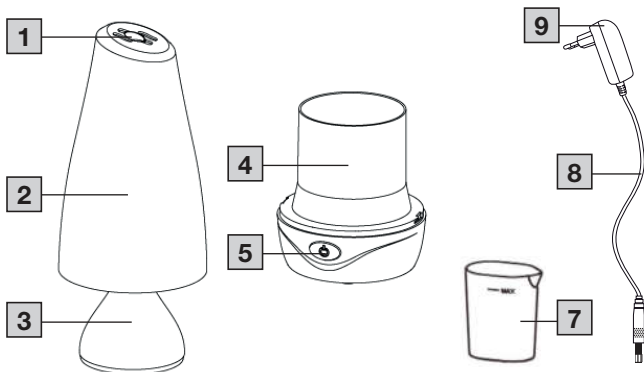

1 Outlet	6 Connection socket
2 Outer cover	7 Measuring jug
3 Inner cover	8 Mains cable
4 Water tank	9 Mains adapter
5 ON/OFF button	

6. INITIAL USE

WARNING

- Only fill the device when the network adapter is unplugged.
- Never fill the device when the cover is still on.
- Only use for water-based aroma oils.
- Open the cardboard packaging, remove all the packaging film and check the device for damage.

1. Pull the outer cover upwards to remove it.

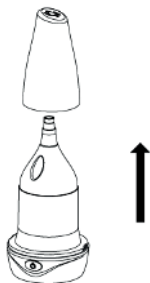

2. Pull the inner cover upwards to remove it.

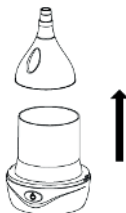

3. Fill the measuring jug with water up to the "MAX" marking.

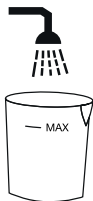

4. Carefully pour the water from the measuring jug into the water tank. Observe the "MAX" marking in the device.

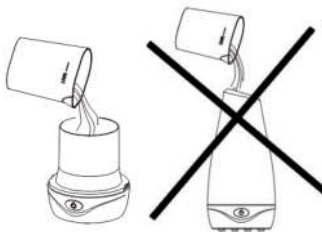

5. Add three to five drops of the (water-based) aroma oil that you want to use.



6. Replace inner cover.

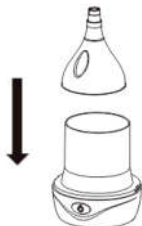

7. Replace outer cover.

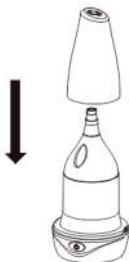

8. Insert the mains cable of the network adapter into the connection socket.

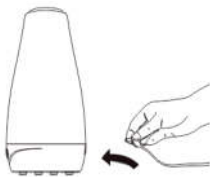

7. USAGE

Press the ON/OFF button to switch on the device (⏻).



i NOTE

The device has three different modes:

	Aroma diffuser	Mood light with change of colour
Press the ON/OFF button (⏻) 1x	ON	OFF
Press the ON/OFF button (⏻) 2x	ON	ON
Press the ON/OFF button (⏻) 3x	OFF	OFF

The device has an automatic switch-off function. If the tank is empty, the device switches itself off after 2-3 seconds.

After use

1. Disconnect the device from the socket.
2. Remove the inner and outer covers from the device in an upward direction.
3. Pour any remaining water down the drain.

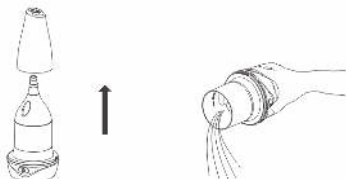

4. Clean the device as described under “8. Cleaning and maintenance”.

8. CLEANING AND MAINTENANCE

NOTE

Before cleaning the device, ensure that the device is disconnected from the power supply and that there is no water left in the water tank. Regular cleaning is a prerequisite for hygienic and fault-free operation. The aroma diffuser can be dismantled for cleaning easily and without tools.

- Clean the device after every use using a soft, slightly damp cloth, paying particular attention to the cover and the inside of the water tank. Never use abrasive, corrosive or solvent-based cleaning products.

9. ACCESSORIES AND REPLACEMENT PARTS

For replacement parts and additional items visit www.beurer.com or contact the corresponding service address in your country (according to the service address list). Replacement parts and additional items are also available from retailers.

Item	Item number
Beurer by Taoasis “Vitality” aroma oil (10 ml)	681.30

10. WHAT IF THERE ARE PROBLEMS?

Problem	Cause	Solution
No mist is being emitted from the device	Mains adapter is not plugged in.	Insert the mains adapter into a suitable socket.
	There is not enough water in the water tank.	Fill the water tank up to the “MAX” marking.
	There is too much water in the water tank.	Pour away excess water from the water tank until it only reaches the “MAX” marking.
	The outlet in the cover is blocked.	Check that the outlet in the cover is not blocked.

If you cannot find a solution to your problem here, contact our Customer Services.

11. DISPOSAL

For environmental reasons, do not dispose of the device in the household waste at the end of its useful life. Dispose of the unit at a suitable local collection or recycling point. Dispose of the device in accordance with EC Directive – WEEE (Waste Electrical and Electronic Equipment). If you have any questions, please contact the local authorities responsible for waste disposal.



12. TECHNICAL SPECIFICATIONS

Product name	LA 30
Supply	Input: 100–240 V~, 50/60 Hz, 0.5 A Output: 24.0 V ——— 0.5 A, 12.0 W
Water tank capacity	100 ml
Room size	up to approx. 15 m ²
How it works	Ultrasonic atomiser
Run time	approx. 4-8 hours
Protection class	IP50, protection against harmful quantities of dust, no protection against water.
Weight	LA 30: approx. 320 g adapter: approx. 113 g
Dimensions	Ø 100 mm x 215 mm
Average active efficiency	≥ 85.15 %
Efficiency at low load (10 %)	≥ 73.49 %
No-load power consumption	≤ 0.093 W
Mains part	Manufacturer: Xiamen Innov Electronics Tech Co. Ltd. Model no.: EU: [606.31]: IVP 2400-0500 WG UK: [606.30]: IVP 2400-0500 B

13. WARRANTY / SERVICE

Further information on the warranty and warranty conditions can be found in the warranty leaflet supplied.



UK Importer: Beurer UK Ltd., Suite 16, Stonecross Place, Stonecross Lane
North, WA3 2SH Lowton, United Kingdom



Beurer GmbH • Söflinger Str. 218 • 89077 Ulm, Germany
www.beurer.com • www.beurer-healthguide.com
www.beurer-gesundheitsratgeber.com

