

# Fanttik

## **NB10 Fold**

Foldable Pressure Washer

## User Manual

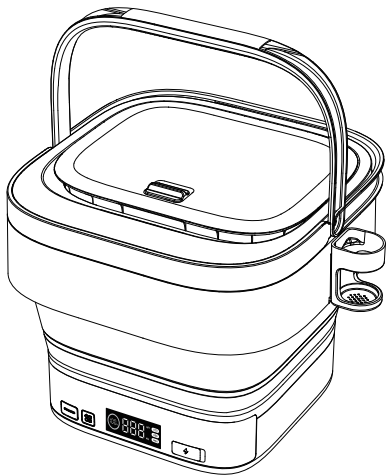

Please read this instruction manual carefully before use and keep it for future reference.

# Contents

1. Safety Warnings .....	02
2. Product Overview .....	05
3. Operation and Functions .....	06
4. Specifications .....	09
5. Troubleshooting .....	10
6. Warranty Info .....	11

# 1. Safety Warnings

**WARNING: Read all safety warnings and instructions. Failure to follow the warnings and instructions may result in electric shock, fire and/or serious injury.**

Please read and comply with all original instructions before the initial operation of your appliance and store the guidance for future reference or subsequent owners. Apart from the notes included, the general safety provisions and rules for the prevention of accidents of the legislator must be observed.

Warnings and notes that are attached on the appliance provide important notes for the safe operation.

## **DANGER**

All circuits in the working area must be protected from jet water.

The user must be the operator as intended. The person must consider the local conditions and must pay attention to other persons in the surroundings when operating the washer.

Before each operation, check important components such as high-pressure hoses, hand spray guns and safety devices for damage. Do not operate washer with damaged components.

High pressure nozzles can be dangerous if misused. The spray must not be directed

at persons, live electrical equipment, or the machine itself.

## **ATTENTION**

Do not operate the washer at temperatures below 0°C

## **DANGER**

Pressure washer must not be operated in explosive atmospheres.

Explosion risk - Do not spray flammable liquids.

Never use acidic solvents containing solvents or undiluted! This includes gasoline, paint thinner, and heating oil. Spray can be highly flammable, explosive, and toxic. Do not use acetone, undiluted acidic solvents as they will corrode the materials used on the equipment. Never use the washer with flammable or toxic liquids, or liquids incompatible with normal operation.

Keep packaging films away from children, otherwise there is a risk of suffocation!

## **WARNING**

In accordance with applicable regulations, cleaning machines must never be used on drinking water networks without a system separator. Ensure that the connection to the building water installation in which the cleaning machine is operated is equipped with a compliant system separator!

Water flowing through an anti-backflow valve is considered undrinkable.

To ensure applicable safety, only use original spare parts from the manufacturer or manufacturer approved.

High-pressure hoses, fittings and couplings are important to machine safety. Use only hoses, fittings and couplings recommended by the manufacturer.

Improper use of the cleaning machine may result in serious injury or oxidation.

Store the washer away from children.

Bleed any residual pressure before disconnecting the hose from the product.

Before each use, regularly check whether all metal fasteners are tight and whether the gasket components are intact; check whether parts are broken or worn.

Store indoors - Never store the washer outdoors or where it may freeze.

## 2. Product Overview

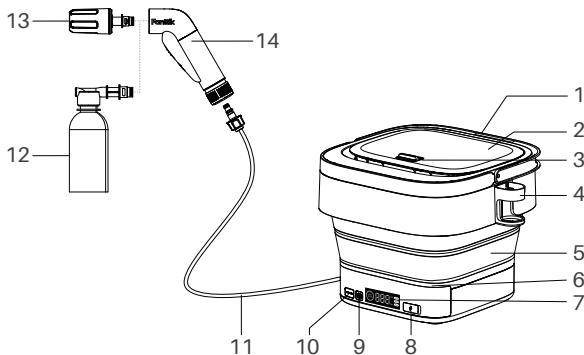

1. Handle

2. Lid

3. Lid latch

4. Water gun holder

5. Washing machine main unit

6. Camping light

7. Display panel

8. Type-C charging port

9. Shift button

10. On/off switch

11. Water outlet

12. Soap dispenser

13. 5-in-1 spray nozzle

14. Water gun

### 3. Operation and Functions

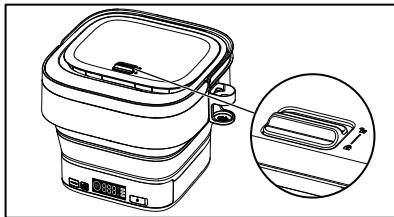

1. Remove the lid from the water tank

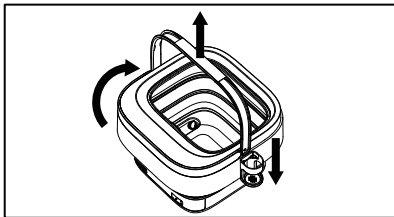

2. Lift the bucket

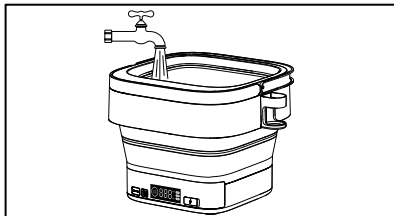

3. Fill the bucket with clean water

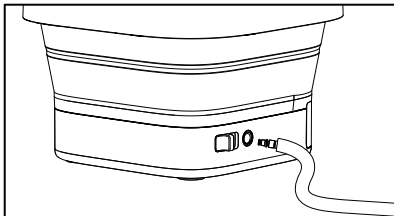

4. Connect the water outlet to the outlet pipe

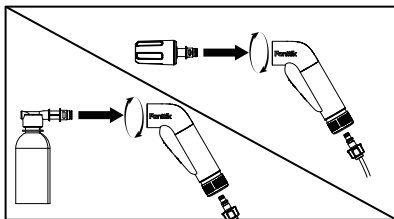

5. Connect the water gun to the nozzle, and connect the water gun to the soap pot

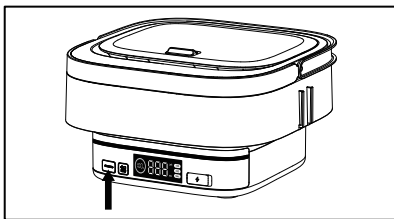

6. Short press the power button to turn the camping light on or off

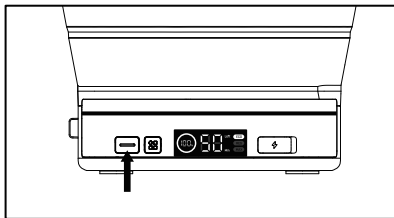

7. Press and hold the power button to turn on the device, and the motor and screen will light up

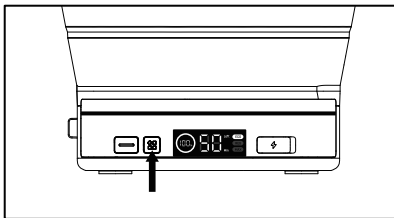

8. Short press the shift button to switch gears, ECO REG MAX

## Attention

1. Only inject clean water into the water tank and ensure that only clean water is inhaled.
2. Impurities in the water will damage the pressure pump and its accessories.
3. Do not fill the water tank with any detergents, pesticides or other additives.
4. Do not immerse the device in water.
5. The pump is damaged due to poor operation of the equipment. If the device does not build pressure within 1 minute, switch off the device and follow the instructions in the "Troubleshooting" chapter.
6. This low-pressure cleaning machine is designed for cleaning products, including vehicles, tools, exterior walls, garden equipment, and pets.

## 4. Specifications

Rated voltage	10.8V
Rated pressure	220Psi
Rated flow rate	0.6-0.8GPM
Rated power	190W
Water tank capacity	12L
Length	325mm
Width	325mm
Height (folded)	155mm
Net weight	3.3kg

## 5. Troubleshooting

Fault	Cause	Solution
The device does not run	The charging state of the battery is too low.	Charge the battery, see Chapter Battery charging.
	Trigger of the gun is released	Press the trigger of the gun
Device does not reach required pressure	Not enough water in the water reservoir.	Make sure that there is enough clean, clear water in the water reservoir.
	The fine filter is dirty.	Clean the fine filter, see chapter Cleaning the fine filter
	The charging state of the battery is too low.	Charge the battery, see Chapter Battery charging.
Strong pressure fluctuations or constant switching off/on of the device	The nozzle is clogged.	Clean the nozzle: Remove contamination and debris from the nozzle hole, using a needle and rinse with clean, clear water from the front.
	Insufficient water supply	Make sure that there is enough clean clear water in the water reservoir.

Fault	Cause	Solution
Machine has stopped operating and the screen displays E04	Over-Temperature Protection	Shut down and allow the machine to cool before use
Machine has stopped operating and the screen displays E06	Overload protection	Shut down and restart the machine
Machine has stopped operating and the screen displays E08	Machine malfunction	Shut down the machine, resolve the short-circuit fault, then restart for use

## 6. Warranty Info

This product is covered by a **12-month** warranty for manufacturing defects.



Lienco SAS  
8 RUE MARCEL CERDAN, BUSSY  
SAINT GEORGES, 77600, France  
Email: [contact@lienco.eu](mailto:contact@lienco.eu)  
Phone/Fax: +33766929910



CET Product Service Ltd.  
Beacon House Stokenchurch Business  
Park, Ibstone Rd, Stokenchurch High  
Wycombe HP14 3FE UK  
Email: [info@cetproduct.com](mailto:info@cetproduct.com)  
Phone/Fax: +44 7419325266



points de collecte sur [www.quefairedemesdechets.fr](http://www.quefairedemesdechets.fr)  
privilégiez la réparation ou le don de votre appareil !

[Service hotline available in the U.S. and Canada only]  
929-693-6066 MON-FRI 9AM-5PM[ET]  
[www.fanttik.com](http://www.fanttik.com)  
[support@fanttik.com](mailto:support@fanttik.com)

Manufacturer/Hersteller: METASEE LLC  
Address/Adresse: 12 GREENWAY PLZ STE 1161A  
HOUSTON, TX 77046-1203

Made in China

CAN ICES(B)/NMB(B)

RoHS

