

# USER MANUAL

## DIGITAL DEHUMIDIFIER REMOTE CONTROLLER

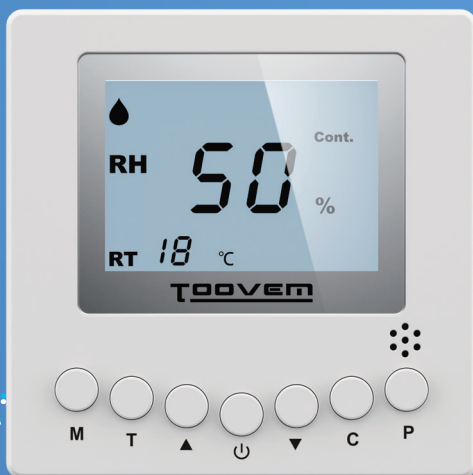

This user manual contains important information about the installation and operation of the Digital Dehumidifier Remote Controller. Prior to using the product, we strongly recommend you thoroughly review this manual and store it in a readily accessible location for future reference.

# Installation Guidelines

## STEP 1

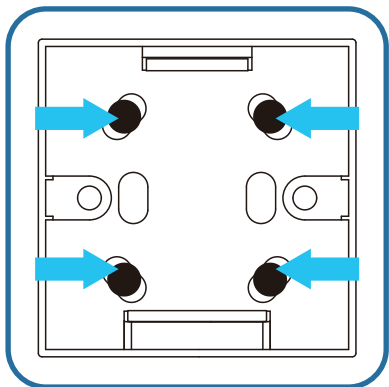

Position the switch box in the desired location and use the four screws provided to secure in place.

## STEP 2

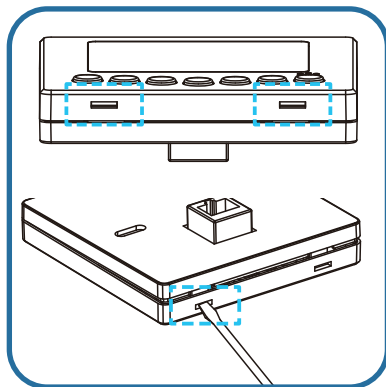

Gently insert a flathead screwdriver or a similar tool into the two slots provided. Carefully pry the unit open by applying gentle pressure.

## STEP 3

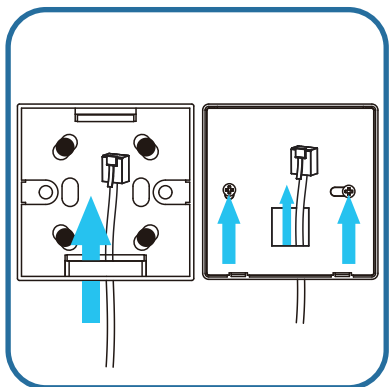

Thread the wire through the designated opening in the cover shell. Next, align and secure the switch box using two screws.

## STEP 4

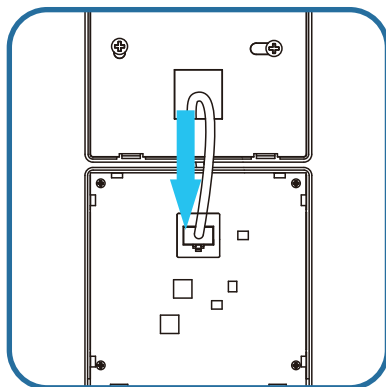

Insert the CAT-5 cable into the corresponding port on the control board. Listen for a distinctive clicking sound, which indicates a successful connection.

## STEP 5

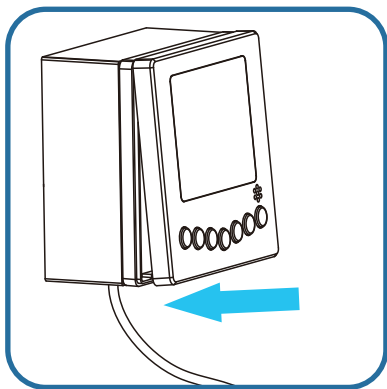

Attach the control board to the switch box as shown above.

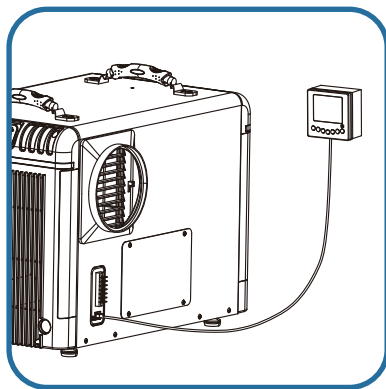

## STEP 6



Connect the remote controller to the unit.

## Instructions

### 1. Power Button



Press the Power button once to turn the unit on/off. When one of the following icons is displayed, it indicates that the dehumidifier is powered on. (    )

### 2. Increase / Decrease

Press the Up and Down arrow keys to adjust the humidity level.

### 3. Mode

Press the Mode button to toggle the application mode.

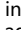
- The icons (   ) indicate that the dehumidifier is adjusting its operation based on the relative humidity level in the location of the remote controller.
- The icon (   ) indicates that the dehumidifier is adjusting its operation based on the relative humidity level in the location of the dehumidifier.

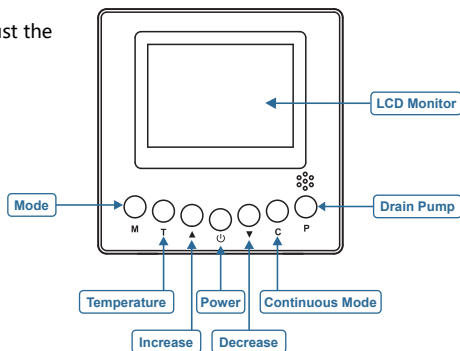

### 4. Temperature

Press the Temperature button to display the current temperature on the screen. Press the button again to turn off the display.

### 5. Continuous Mode

Press this button to switch the unit into continuous mode. Upon activation, it will appear on the screen.

### 6. Drain Pump

Press the Drain Pump button if the unit will not be in use for an extended period of time to ensure safe storage.

# Remote Controller Instructions

Compatible dehumidifiers offer the convenience of remote control through an optional accessory, the TOOVEM Remote Controller. This controller connects to your dehumidifier using a 25' CAT-5 cable.

The remote controller is equipped with an integrated sensor, providing multiple options to remotely manage the dehumidifier while also being able to monitor the environmental conditions around it.

One practical use of the remote controller is to install the dehumidifier in one room and duct the conditioned air into another room equipped with the remote controller. For example, you can install the dehumidifier in a laundry room and duct the conditioned air into the living room. Mount the remote controller in the living room, allowing its sensor to regulate humidity and provide user-friendly controls.

Another potential application for the remote controller is to place the dehumidifier in an area that is not easily accessible. For example, install the dehumidifier in a crawl space and mount the remote controller in the living room or garage for easy access. This setup provides a convenient way to monitor the dehumidifier's operation without the need for frequent physical access.