

# PRE INSTALLATION GUIDE

FÖRINSTALLATIONSGUIDE  
ANLEITUNG VOR DER INSTALLATION  
預安裝指南

FOR

# TopBrewer

PRO



Scanomat  
Download Center



Scanomat  
Connection Diagram



Scanomat  
Architect Pack  
(2D/3D Files)

For TopBrewer Pro  
Version: 4.1  
22-07-2021

# CONTENTS

» Introduction	3
» Product Matrix: Choose your setup	4
» Products Overview	5
» Space requirements: Basic Installation	6
» Space requirements: Extended Installation	7

## CARPENTER & VENTILATION 8

» <b>Basic Installations</b>	
» Example 1 - Pro Fridge A2	9
» Example 2 - Pro Fridge A3	10
» Example 3 - Duct rediverted	11
» <b>Extended / Special Installations</b>	
» Example 1 - with cold water	12
» Example 2 - with two Pro	13
» Example 3 - behind a wall	14
» Faucet and Drip tray	15
» Topmounted iPad holder	16
» Boxit Alu iPad Holder	17
» Drip trays	18

## ELECTRICAL 19

» Electrical Requirements	20
---------------------------	----

## PLUMBING 21

» Plumbing - adjacent cabinet	22
» Plumbing - same cabinet	23

# Introduction

## The operation of a TopBrewer Pro coffee system.

The TopBrewer Pro consists of a main unit, the coffee machine, the "swan neck" or tap that is installed through the tabletop and is height adjustable through the mounting bracket, a drained drip tray and a ventilation kit for the toe kick base. Additionally we offer optional accessories that are installed along side of the TopBrewer. These accessories include our extensive lineup of fridges, coolers and racks (overview on next page) that expands the machines capabilities to include milk, chocolate and ice water.

The TopBrewer is connected to the cold water supply and water is heated in professional flashheaters, meaning on demand. This works by water flowing through two 2,3kW aluminum coils when a drinks is ordered and a separate steam-coil producing steam for milk. The total heating capacity of the TopBrewer is thus 6,9 kW and it should be preferably connected to 400V, 3 phase, 16 amp (3-phase version) or 208-240V, single phase, 30 amp (single phase version) for the machine to perform to it's full potential. If only 208-240V, single phase, 10 amps is available, the machine can be re-programmed to run on a priority heating diverting power to the heating source needing it the most.

When ordering a milk drink, milk is pumped from the fridge (the pump is placed inside the fridge for sanitary reasons), and once a delivery is done the machine finishes with pushing the remaining milk out with cold water and thus cleaning the entire tubing. The water does not enter the cup but is afterwards ejected into the drain via the double-valve inside the fridge.

All water shall be purified using TopBrewer certified filtration. We require that the main inlet is filtered through a filter with a bypass so that the water reaches 4 dH°. A second filter with 0% bypass is used to completely remove lime/scale from the dedicated steamer inlet.

## Installation, maintenance and warranty

The TopBrewer system can be installed in almost any location provided there is sufficient space for the machine as well as power, water supply and waste.

The TopBrewer must be placed with sufficient clearance so that it may slide out on its hinges. The fridge must be fitted so that the length of the tubes does not exceed 1,5 mm . It can be installed in an adjacent cabinet provided it maintains such maximum length. Accessories such as the Scanomat Cooler 45 and the Chocolate rack must also stay within the same maximum distances to ensure proper dispense quality.

All equipment must be fitted so that they receive proper ventilation, with temperatures not exceeding 35°C, as this would harm components and void warranty.



# Product Matrix

Choose your setup



## Cabinet Layout

Configuration Choices

	LESS THAN 590 MM DEPTH	ALLOWS FOR MORE THAN 590 MM DEPTH	HIDDEN OR BEHIND THE WALL
WITH WATER	PAGE 14	PAGE 14	PAGE 16
WITHOUT WATER	PAGE 12	PAGE 11	PAGE 16
WITH HOT CHOCOLATE	N/A	PAGE 11	PAGE 16
WITH WATER AND HOT CHOCOLATE	PAGE 12	PAGE 14	PAGE 16



# Products Overview

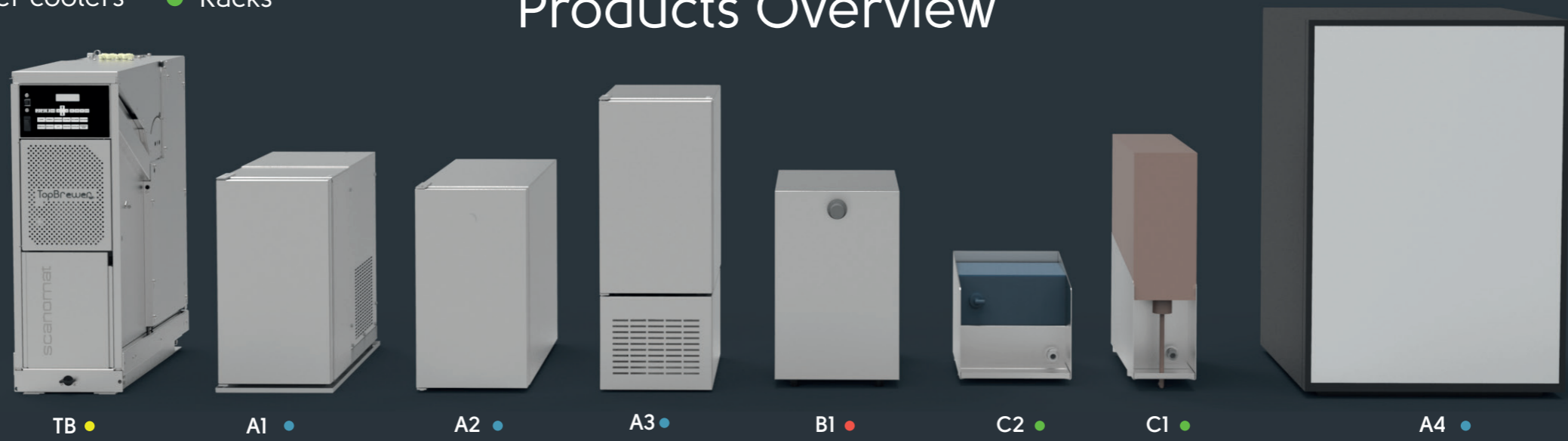

\* OPTIONALLY WITH CO<sub>2</sub>

UNIT DETAILS	TopBrewer Pro	ICE-Bank (A1)*	Pro-fridge (A2)	Pro-fridge Tall (A3)	Cooler 45 (B1)*	Pro-Fridge BiB (A4)	Slimrack (C1)	Chocolate rack (C2)
Installation Dimensions (WxDxH)	224 x 560 x 667 mm	236 x 569 x 428.5 mm	231 x 600 x 430 mm	231 x 438 x 600 mm	255 x 464 x 404 mm	520 x 560 x 760 mm	129 x 428 x 476,5 mm	230 x 323 x 237 mm
Packing Dimensions (WxDxH)	320 x 660 x 790 mm	246 x 579 x 488.5 mm	300 x 615 x 490 mm	241 x 443 x 660 mm	265 x 483 x 464 mm	530 x 575 x 820 mm	139 x 443 x 536,5 mm	240 x 338 x 297 mm
Weight, gross.	60 kg	25 kg	20 kg	20 kg	22 kg	31 kg	9 kg	8 kg
Weight, net.	56 kg	22 kg	17 kg	17 kg	19 kg	28 kg	6 kg	5 kg
Bean/Carton Capacity	2 x 1.4 kg	Up to 4 l.	Up to 9 l.	Up to 9 l.	-	3x 10 l. Bag-in-box (up to)	10 l. Bag-in-box	3 l. Bag-in-box
Throughput/hour	180 cups	Up to 4 L	-	-	Up to 45 L	-	-	-
Approvals	CE, ETL/UL, CB, NSF		CE	CE, ETL/UL	CE, ETL/UL	CE, ETL/UL, NSF	CE, ETL/UL	CE
Power	EU, 6900 Watt	220-240V, 30 amp, single phase OR 400V, 16 amp, 3-phase	220-240V, 10 Amp. 3-pin plug point for each unit.v			31V DC from TopBrewer		
	EU, 2300 Watt	(Priority Heating) 220-240V, 10 amp, single phase						
	Canada & USA	L6-30 twist lock plug (supply male/female connections)	115V, 60 Hz, 10 Amp Plug point for each unit.					
	United Kingdom	32 Amp - Commando fitting (supply male/female connections)  1 x 10 Amp single phase (Priority heating)	115V, 60 Hz, 10 Amp Plug point for each unit.					
Water	Direct Water Connection, 3/4" type shutoff valve Water pressure: 200kPa (2 Bar) - 600 kPa (6 Bar)		-	-	Direct Water Connection, 3/4" type shutoff valve Water pressure: 200kPa (2 Bar) - 600 kPa (6 Bar)		-	-
Filtration	TopBrewer water filters fitted in a location adjacent to the TopBrewer. See plumbing section. Dedicated steam filter required (Pure 50, 0% bypass)		TopBrewer ActiveCoal 10.000, optional, purifies the water with active coal		TopBrewer ActiveCoal 10.000, optional, purifies the water with active coal technology.		-	-
Drainage	Waste U-pipe, ø40mm. Manifold/drain plug (included, see Plumbing section) is inserted and components are connected here.							
Ventilation	Duct Fan Ventilation required. Cooler produces a lot of heat, which needs to be able to exit as per installation instructions in Carpenter section							



Space requirements

# Basic Installation 1

Compact ventilation

CLEARANCE HEIGHT NEEDED FOR INSTALLATION OF SWAN NECK MIN 500 MM

A 600 MM CABINET RECOMMENDED  
MIN. TOTAL WIDTH 580 MM

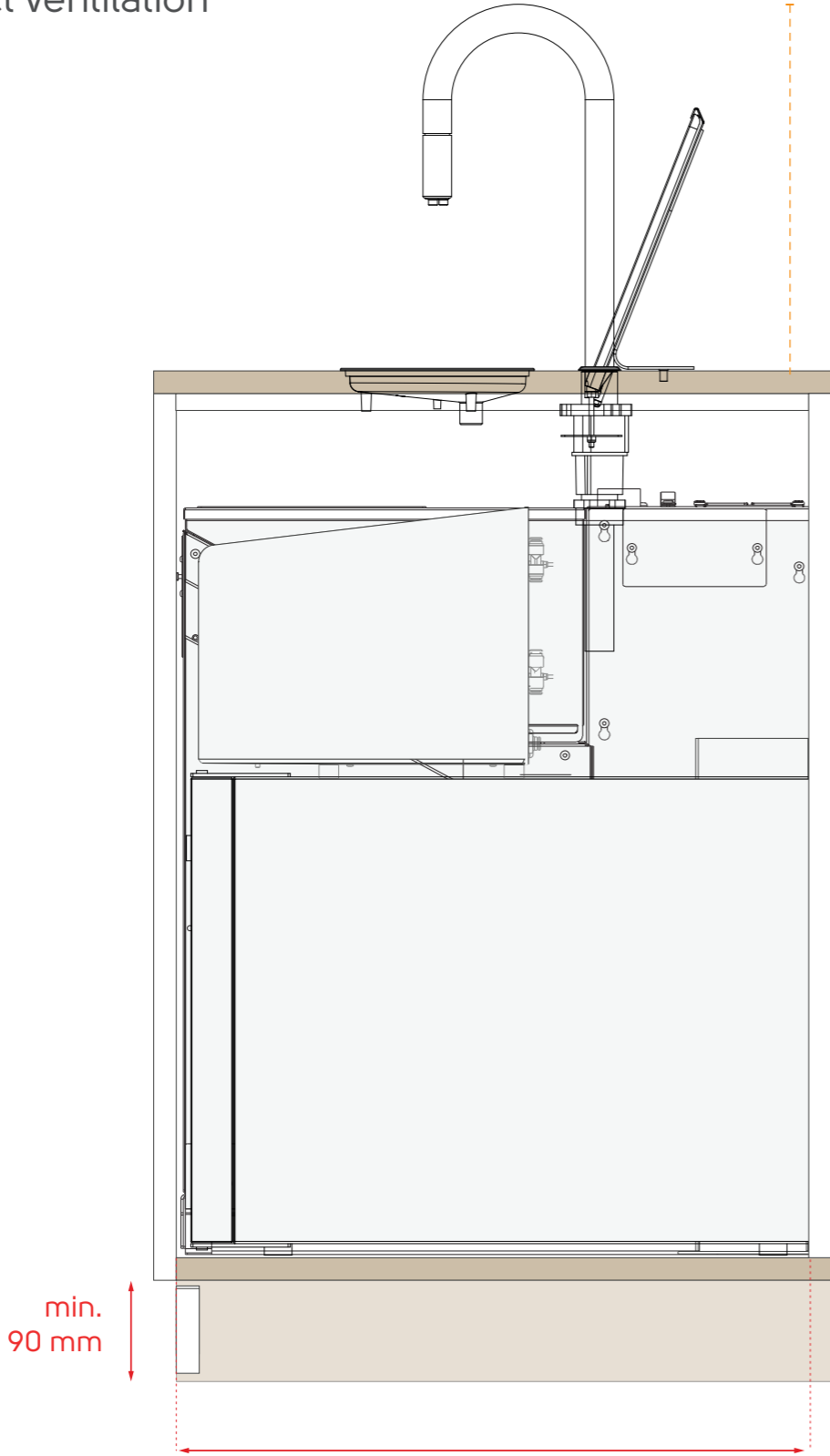

Recommended depth 610 mm  
Minimum 600 mm

750 MM RECOMMENDED  
680 MM MINIMUM

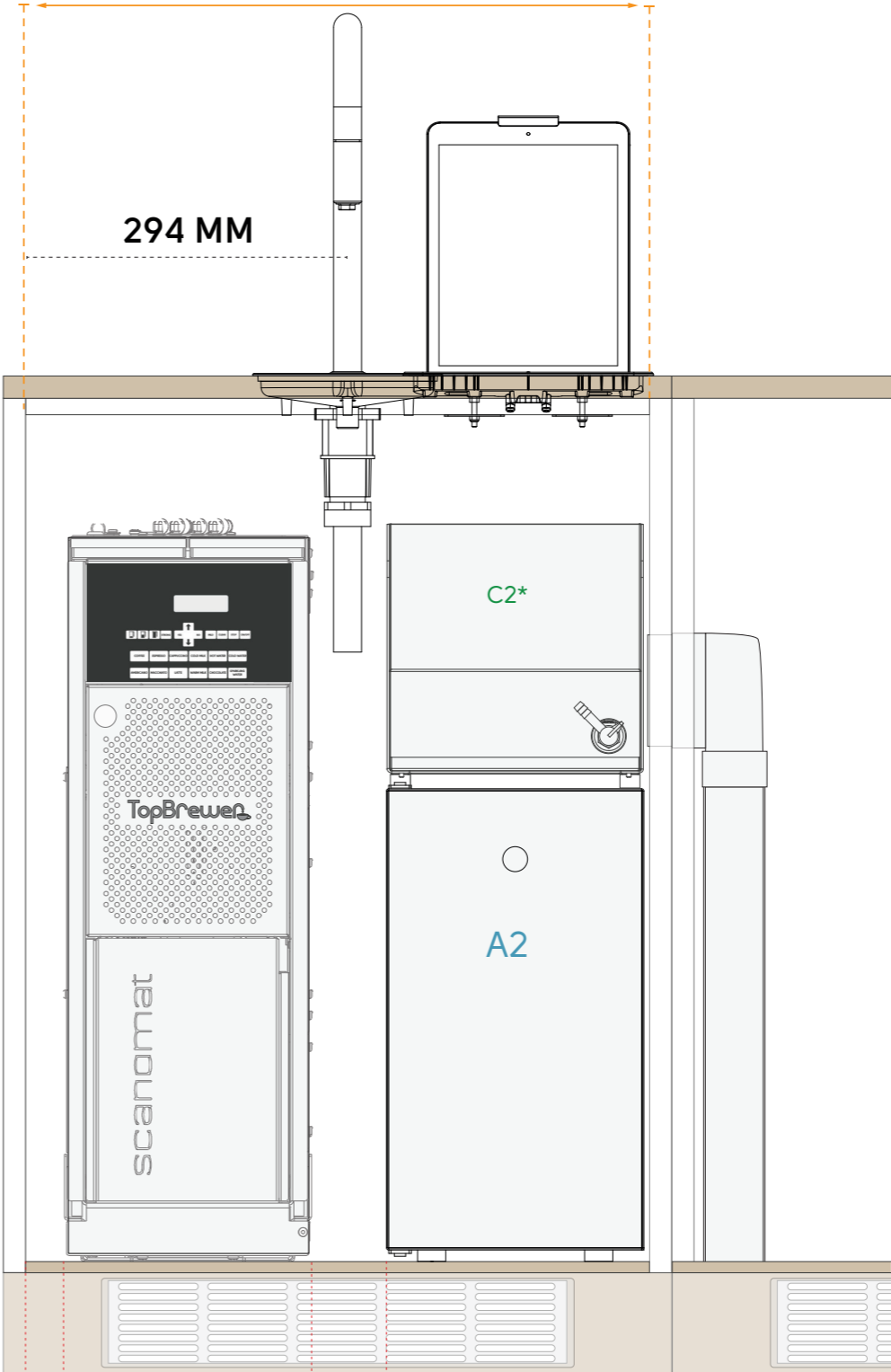

Always allow min. 40 mm clearance

Always allow min. 60 mm clearance

Space requirements

# Basic Installation 2

Center ventilation

CLEARANCE HEIGHT NEEDED  
FOR INSTALLATION OF SWAN NECK  
MIN 500 MM

A 700 MM CABINET RECOMMENDED  
MIN. TOTAL WIDTH 595 MM

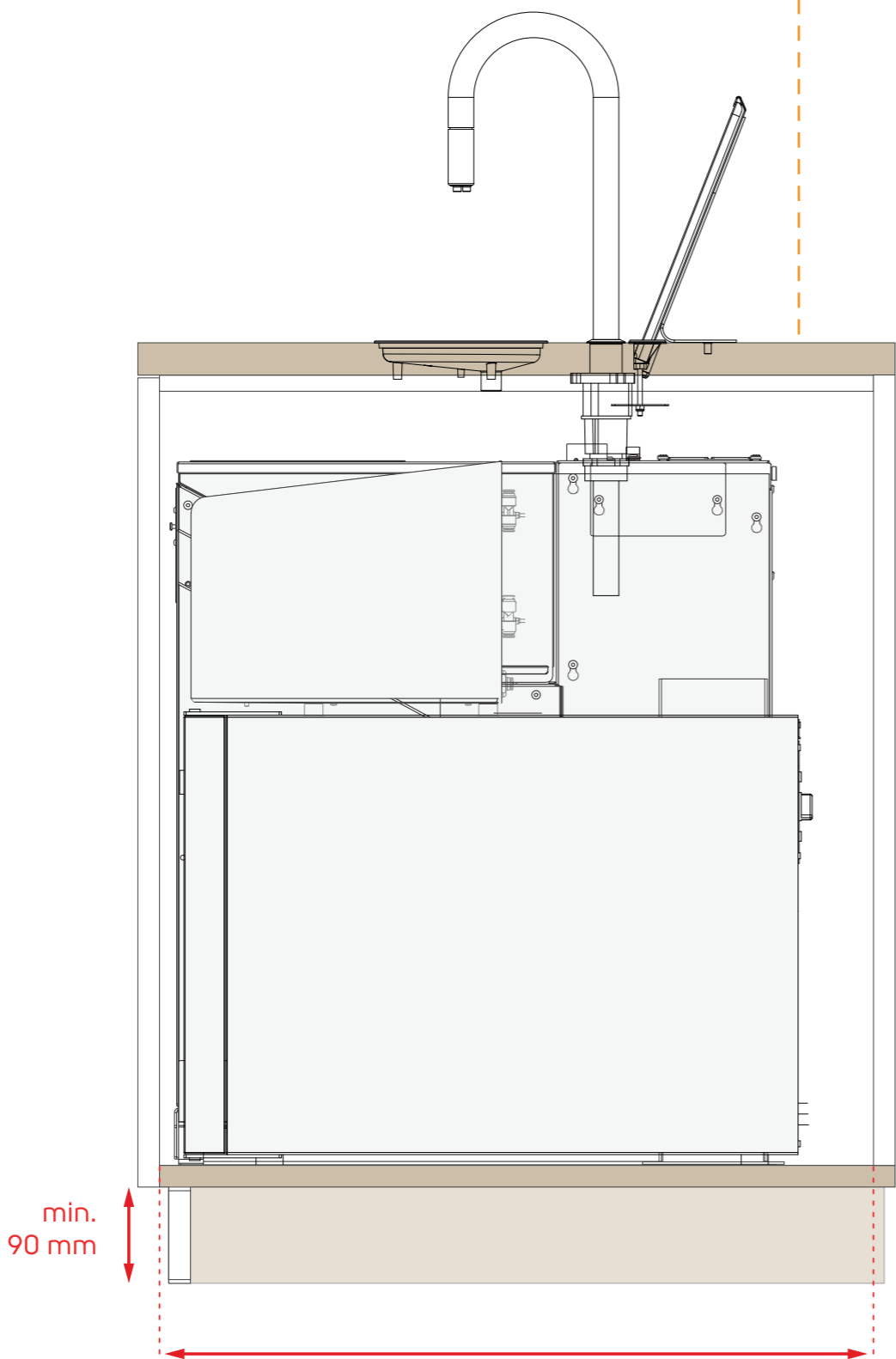

Recommended depth 650 mm  
Minimum 600 mm

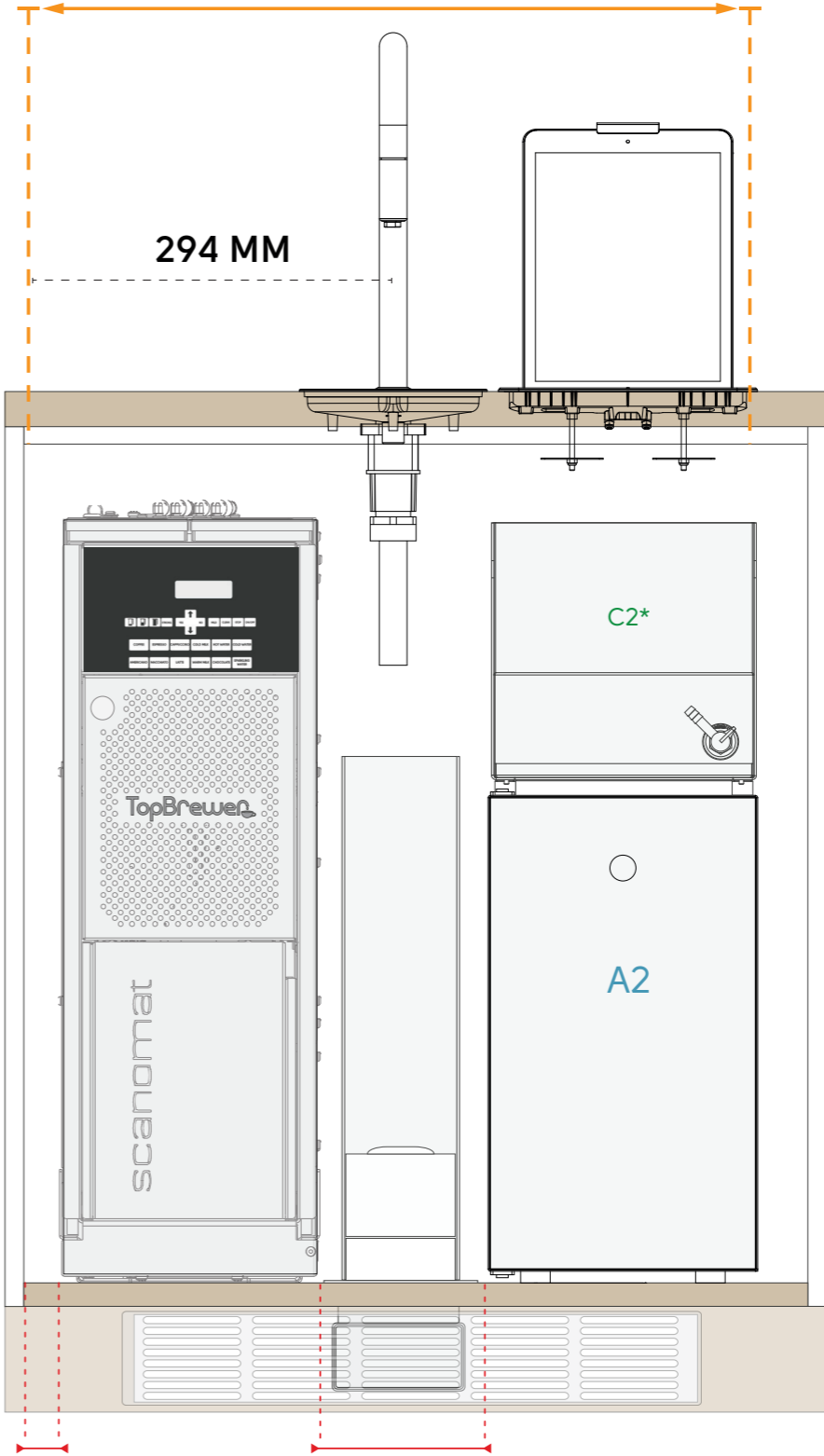

750 MM RECOMMENDED  
680 MM MINIMUM

294 MM

Always allow  
min. 40 mm  
clearance

Always allow  
min. 60 mm  
clearance

Space requirements

# Extended Installation 1

Compact ventilation

CLEARANCE HEIGHT NEEDED FOR INSTALLATION OF SWAN NECK MIN 500 MM

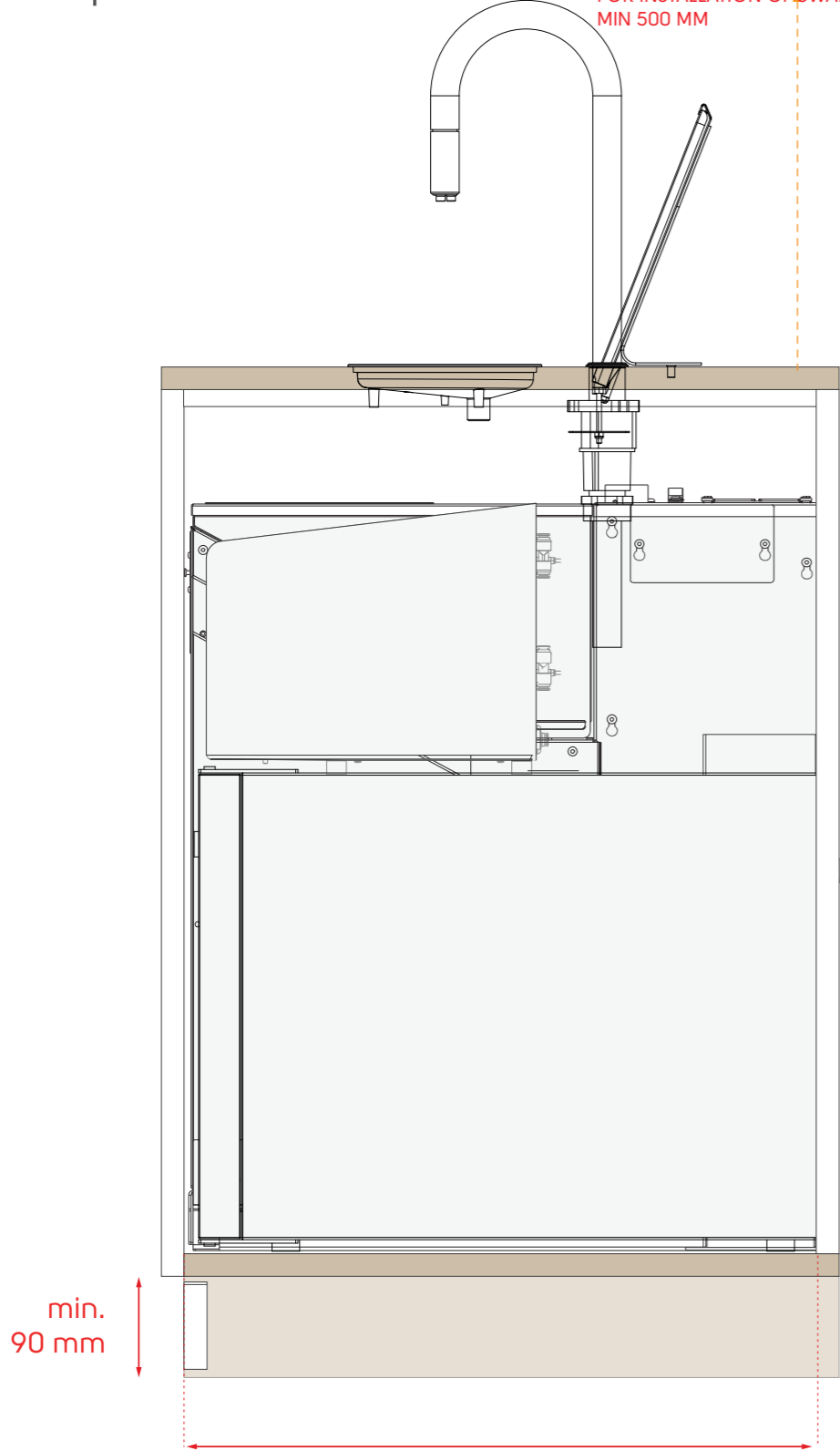

- A1 : 569 mm
- A2: 600 mm
- A3: 534 mm
- A4: 560 mm

A 700 MM CABINET RECOMMENDED  
MIN. TOTAL WIDTH 580 MM

470 MM RECOMMENDED  
MIN. TOTAL WIDTH 400 MM

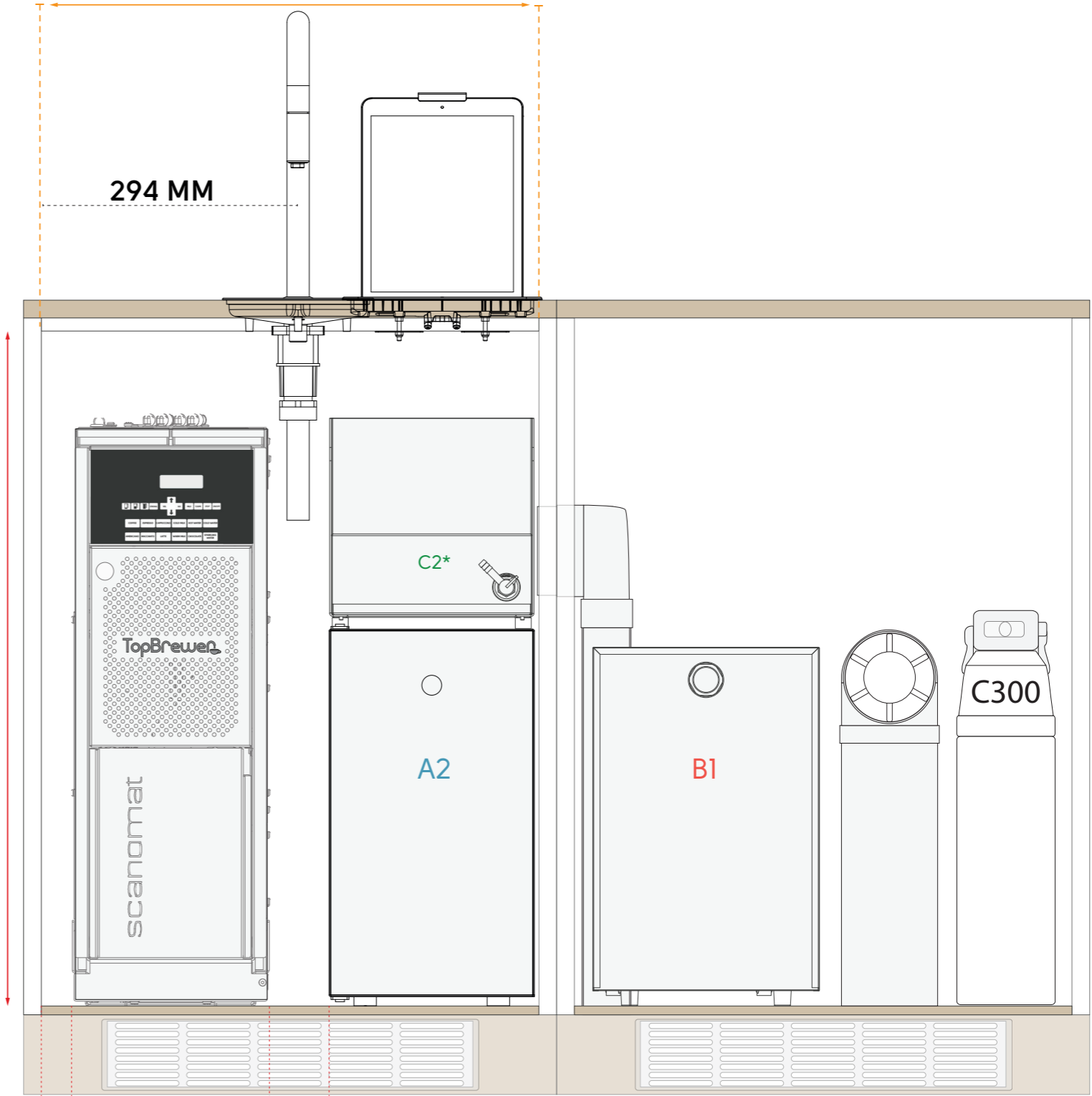

750 MM RECOMMENDED  
680 MM MINIMUM

Always allow min. 40 mm clearance

Always allow min. 60 mm clearance

# Space requirements

## Extended Installation 2

Center ventilation

CLEARANCE HEIGHT NEEDED  
FOR INSTALLATION OF SWAN NECK  
MIN 500 MM

A 700 MM CABINET RECOMMENDED  
MIN. TOTAL WIDTH 580 MM

470 MM RECOMMENDED  
MIN. TOTAL WIDTH 400 MM

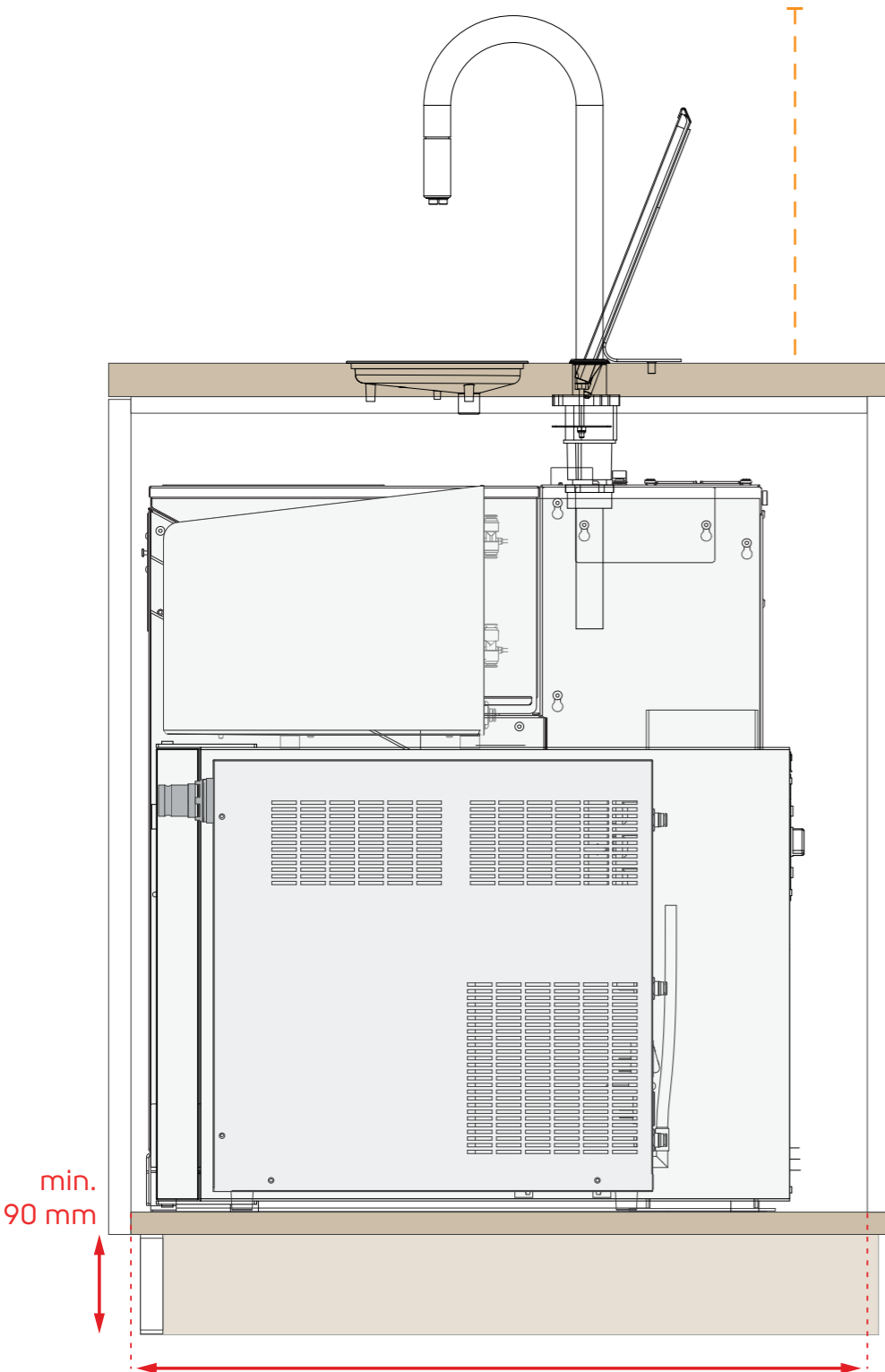

A1 : 569 mm  
A2: 600 mm  
A3: 534 mm  
A4: 560 mm

750 MM RECOMMENDED  
680 MM MINIMUM

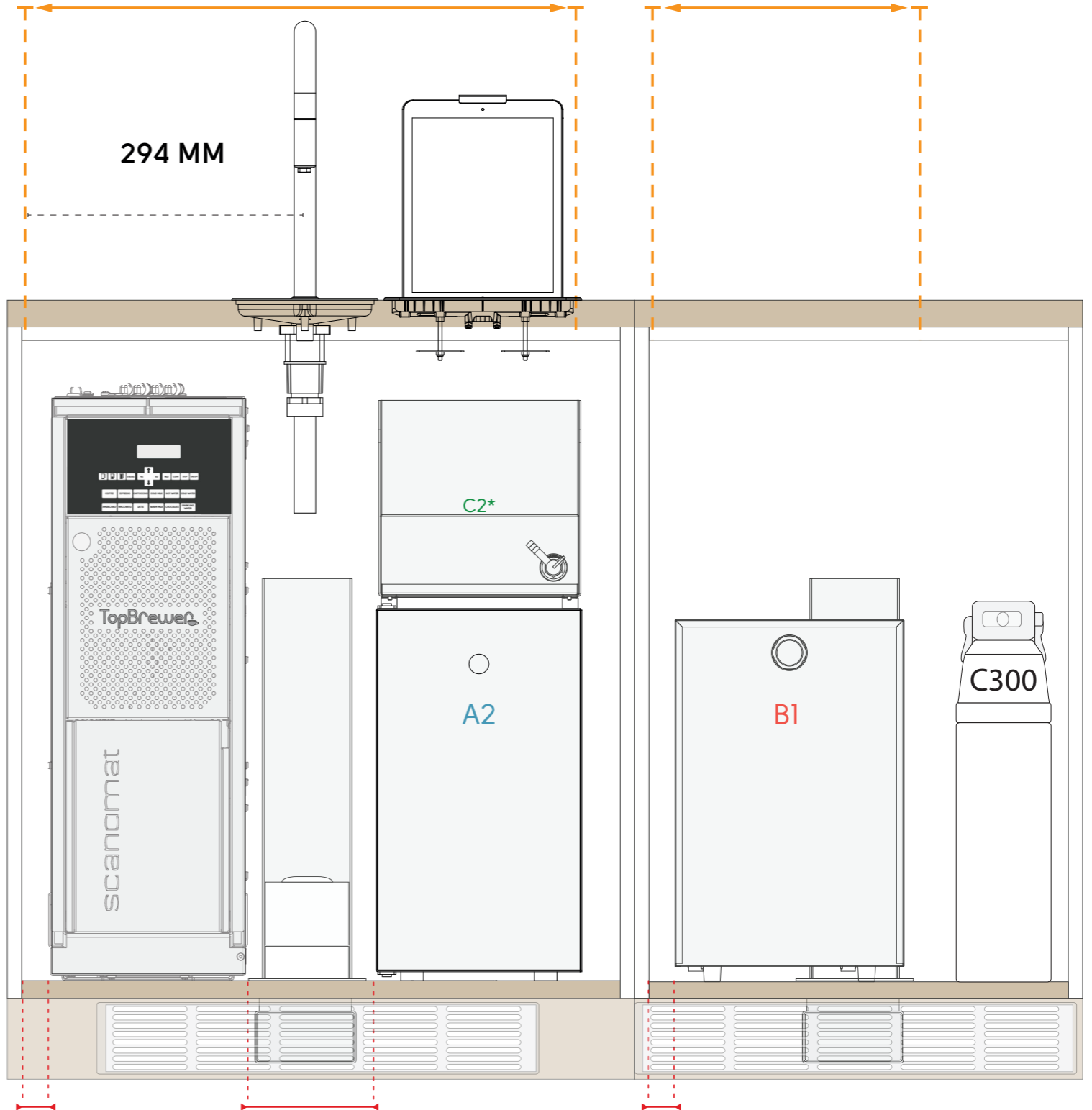

Always allow  
min. 40 mm  
clearance

Always allow  
min. 60 mm  
clearance

Always allow  
min. 40 mm  
clearance

**CARPENTER**

**SNICKARE**

**ZIMMERMANN**

**木匠**





















ELECTRIC

ELEKTRISK

ELEKTRISCH

電的



# PLUMBING

## VVS

## KLEMPNERARBEITEN

## 水暖





# scanomat

coffee solutions for more than 50 years

For more information & questions to your installation,  
contact us on the below channels

## Tecnical / Architect Support

E-mail: [support@scanomat.dk](mailto:support@scanomat.dk)

Chat: [www.scanomat.com](http://www.scanomat.com)

International: +454918180

Denmark: +4549181212

Sweden: +46 (0)774 41 0000

Norway: +47 22662210

UK: [architect@scanomat.co.uk](mailto:architect@scanomat.co.uk)

Locate Dealer: [scanomat.com/services/partners](http://scanomat.com/services/partners)



For TopBrewer Pro  
Version: 4.1  
22-07-2021