

**HOOMESUN**

# MANUAL FOR DRYER DUCT LINT TRAP

Indoor Dryer Vent Kit with Lint  
Trap – Dryer Lint Catcher

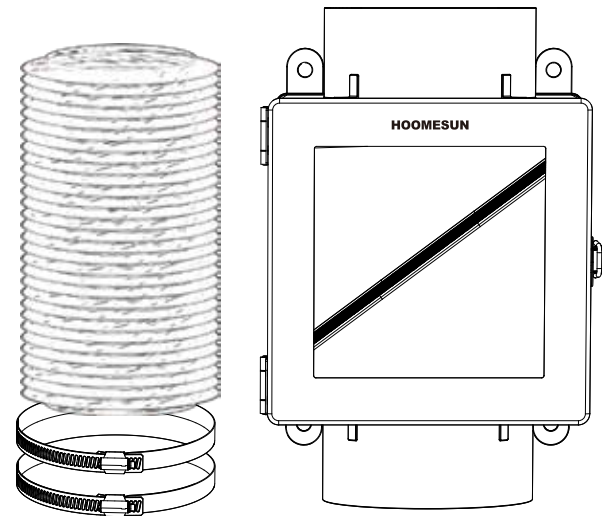

## Product Content:

- 1PC X Dryer Duct Lint Trap
- 1PC X Large Metal Lint Screen
- 1PC X Small Metal Lint Screen
- 1PC X 4-Inch 8FT Aluminum Foil Dryer Vent Hose
- 2PCS X Hose Clamps

## Product Details:

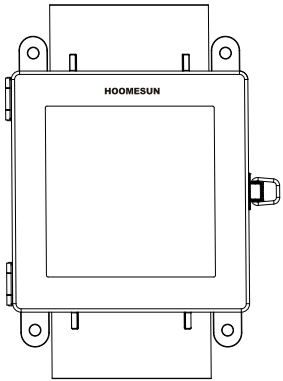

### Dryer Duct Lint Trap:

Material: Metal, Durable construction for long-lasting use.  
Features a slot for inserting both the large and small metal lint screens.  
Facilitates easy installation and maintenance.

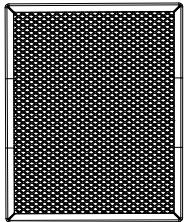

### Large Metal Lint Screen:

Placement: Diagonally inserted through the slot in the Dryer Duct Lint Trap.  
Captures larger lint particles, preventing them from entering the vent hose.

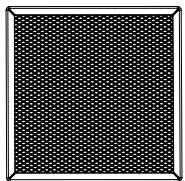

### Small Metal Lint Screen:

Placement: Inserted from the top of the slot in the Dryer Duct Lint Trap.  
Designed to capture smaller lint particles, enhancing overall lint trapping efficiency.

## Product Details:

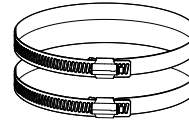

### Hose Clamps:

Quantity: 2  
Material: 201 stainless steel  
Size: Suitable for securing the dryer vent hose to the Dryer Duct Lint Trap

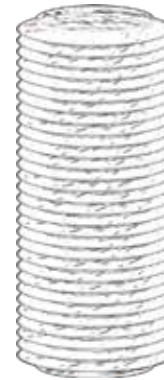

### Dryer Vent Hose:

Length: 8 feet  
Diameter: 4 inches  
Material: Aluminum foil  
Designed for efficient ventilation, ensuring proper airflow from the dryer to the lint trap.

## Installation Steps:

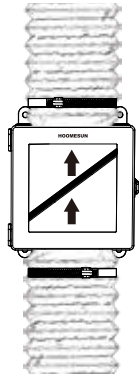

### Orientation:

Ensure the wind direction is blowing from the bottom up. Place the Dryer Duct Lint Trap with the logo facing upwards for the front side.

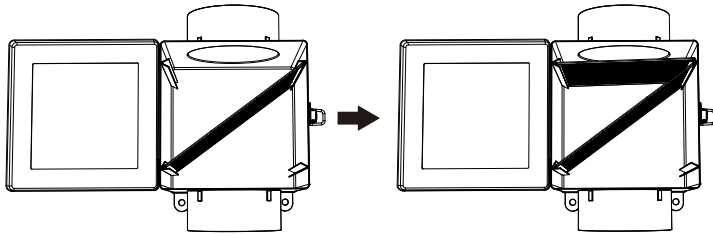

### Lint Screen Placement:

Open the Dryer Duct Lint Trap box. Insert the large metal lint screen diagonally through the slot. Place the small metal lint screen from the top of the slot. Put on the cover after installing both lint screens.

## Installation Position Confirmation:

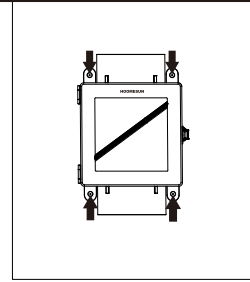

Confirm the desired installation position. Trace points through the holes of the product onto the mounting surface.

## Installation:

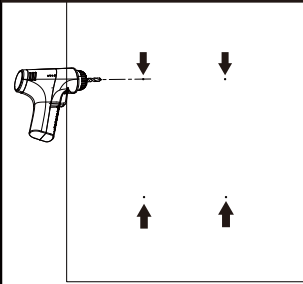

1. Punch holes on the traced points for installation.

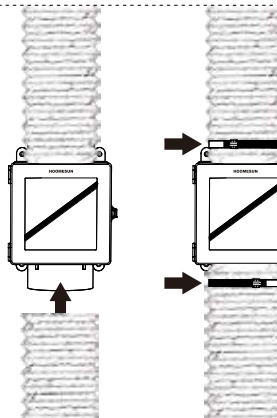

2. Sleeve the upper and lower ends of the Dryer Duct Lint Trap into the dryer vent hose.

3. Fix the connections using the provided 201 stainless steel clamps.

## Note:

We guarantee that the product is properly installed, reasonably operated and maintained, and can be used well within the service life of the product. If you have any questions or suggestions about the product, please contact our service team: [support@hoomesun.us](mailto:support@hoomesun.us)

---

1. It is generally recommended to clean the lint trap mesh every 4-6 uses or as per individual frequency of use and laundry load.
2. Regular cleaning ensures optimal performance and prevents lint buildup.
3. Ensure proper orientation and placement of lint screens for effective lint trapping.
4. Follow recommended cleaning intervals to maintain product efficiency.
5. Turn off the dryer before installing or cleaning the lint trap.
6. Follow the recommended cleaning guidelines to avoid fire hazards.
7. Keep the lint trap and vent hose clear of obstructions for efficient airflow.
8. For assistance or further inquiries, contact our customer support team at [support@hoomesun.us](mailto:support@hoomesun.us).