

USER MANUAL

MODEL: ZQA-8000A



Air Purifier

YUNIUP



Contents

- 1 - What's in the box?
- 1 - Specifications
- 3 - Getting to Know Your Air Purifier
- 4 - Getting Started
- 5 - Using Your Air Purifier
- 8 - Safety Information
- 9 - Power Cord & Plug
- 9 - Care & Maintenance
- 10 - Troubleshooting
- 11 - Warranty Information
- 12 - Customer Support
- 13 - Q&A

Specifications

Power Supply	DC 24V-1A
Rated Power	24W
Speed setting	5 speeds
Operating Conditions	Temperature: 14°-104°F/-10°-40°C
	Humidity: ≤85% RH
Nosie Level	19dB
Air Purifier Weight	6.7lb/3.05kg
Air Purifier Dimensions	12 x 6.2 x 15.8 in/30.6 x 16 x 40.2cm
Power Adapter	Input: 100-240V~50/60Hz
	Output: 24V-1A
EPA Est. No.	103308-CHN-1

What's in the box?

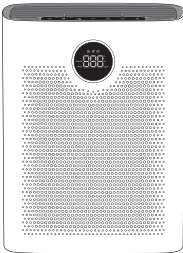

1 * Air Purifier

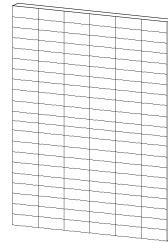

1 * High efficiency H14 true hepa filter



1 * User Manual

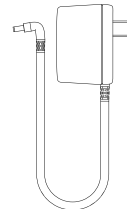







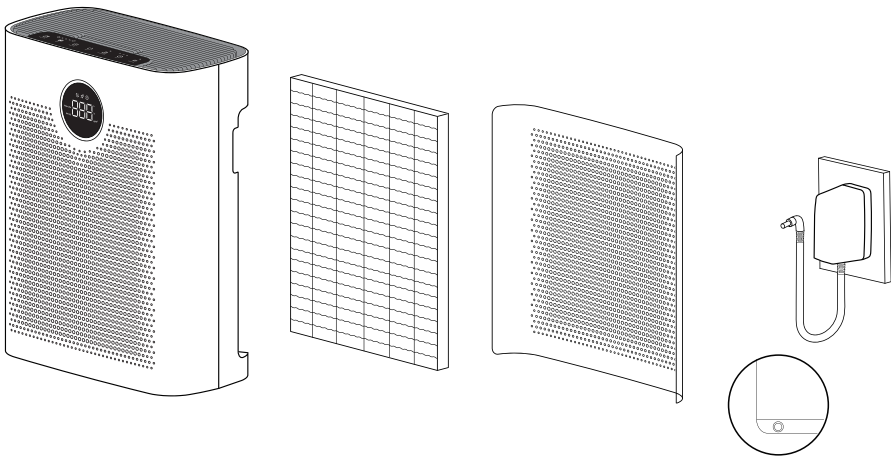
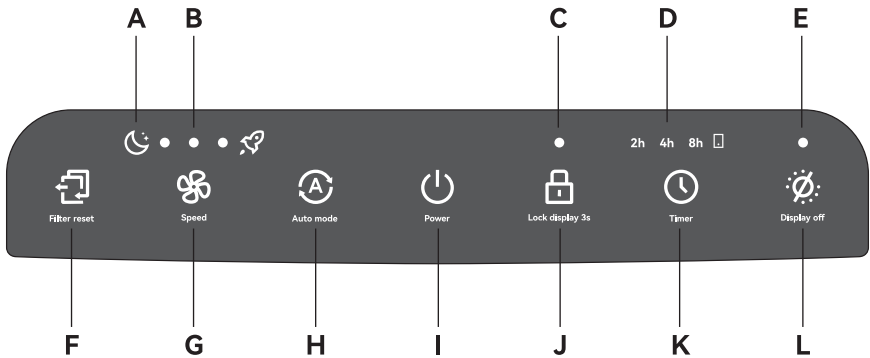

1 * AC Power Adapter

- A. Sleep Mode Indicator
- B. Fan Speed Indicator
- C. Child Lock Mode Indicator
- D. Timer Indicator
- E. Display Off Indicator
- F. Filter Reset Button

- G. Fan Speed Button
- H. Auto Mode Button
- I. Power Button
- J. Child Lock Mode Button
- K. Timer Button
- L. Display Off Button



GETTING TO KNOW YOUR AIR PURIFIER CONTROLS & DISPLAY

	Power Button	Turns the air purifier on/off.
	Fan Speed Adjustment	Cycles through 5 fan speeds: Sleep Mode, Low(1 indicator), Medium(2 indicators), High(3 indicators), Max(4 turbo mode indicators).
	Auto Mode	The air purifier will automatically adjust the fan speed(Sleep Mode – Turbo Mode) based on the PM2.5 levels detected by the sensor.
	Ambient Light	Tap the light control button to turn off the ambient light. Tap it again to turn off the ambient light. Based on the sensor's monitoring of PM2.5 levels in the air, the ambient light uses different colors to alert users to the real-time air quality.
	Timer Button	3 Timer Settings: 2H, 4H, 8H Note: The timer indicator light will light up when the corresponding timer is selected.
	Child Lock	Lock the air purifier to prevent children and pets accidentally change the settings. Press and hold for 3 seconds till hear a beep to turn on/off.
	Display Off	Turn display screen of air purifier on/off.
	Filter reset	Remind user when the filter is needed to be replaced. When the filter use time reaches 1140H, the filter reset button will always light up to remind. After replacement,long press the filter replacement indicator, the light will off and start the timer again. Press briefly to display the remaining service life of the filter element

Getting Started

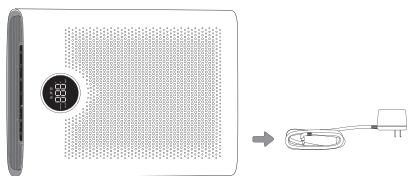

[Figure 1.1]

1. Take out the power cord from the bottom of the air purifier. [Figure 1.1]

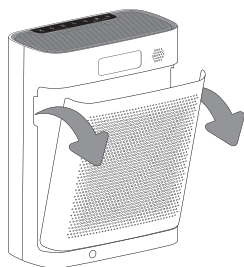

[Figure 1.2]

2. Pull on the sides of the back cover to detach it. [Figure 1.2]

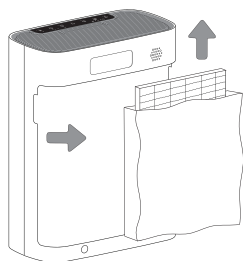

[Figure 1.3]

3. Extract the filter cartridge and take off the protective plastic bag. [Figure 1.3]

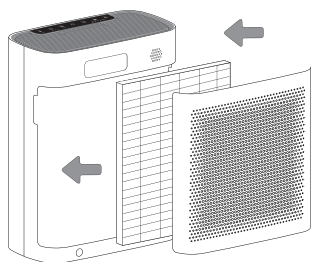

[Figure 1.4]

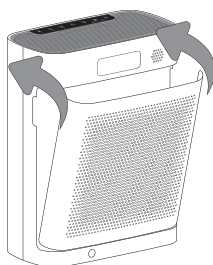

[Figure 1.5]

4. Put the filter cartridge back into the air purifier and close the back cover. [Figure 1.4][Figure 1.5]

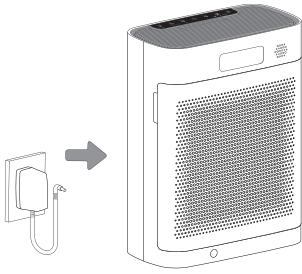

[Figure 1.6]

5. Plug the power adapter into the circular port on the bottom back of the air purifier. [Figure 1.6]

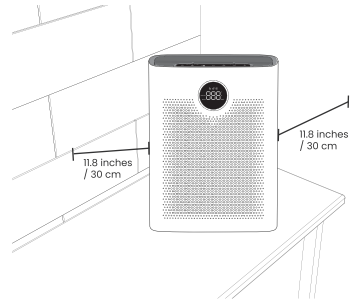

[Figure 1.7]

6. When using the air purifier, allow at least 11.8 inches / 30cm of clearance from the front of the air purifier. [Figure 1.7]

Using Your Air Purifier

1. When the machine is powered on for the first time, the power indicator flashes for three seconds, and the power button brightness remains at 30%.
2. **Power-On:** Press the power button lightly, and the indicator will light up as the air purifier starts operating. By default, it runs in Auto Mode (A Mode), and the Auto Mode indicator will also illuminate.
3. **Power-Off:** Press the power button to turn off all functions. The power indicator dims to 30% brightness.

Fan Speed Adjustment

Lightly press the fan speed adjustment button to cycle through the following speed modes in sequence: Sleep Mode → I → II → III → Turbo Mode.

Note:

Level I: One indicator light turns on.

Level II: Two indicator lights turn on.

Level III: Three indicator lights turn on.

Turbo Mode: In Turbo mode, the previous three level indicators deactivate while the Turbo indicator light turns on.

Sleep Mode

Lightly press the fan speed adjustment button to switch to Sleep Mode. The Sleep Mode indicator will illuminate, and the fan speed will immediately adjust to the lowest setting.

After 3 seconds: All display lights and ambient lighting will turn off, while the Sleep Mode indicator dims.

Note: While in Sleep Mode, lightly press the fan speed adjustment button again to exit Sleep Mode. The indicator will brighten, and the speed will automatically switch to Level 1.

Auto Mode

Lightly press the Auto Mode button, the air purifier will automatically adjust its speed setting based on real-time PM2.5 levels detected by the sensor.

Automatic Speed Adjustment Rules:

PM 2.5 0–35 $\mu\text{g}/\text{m}^3$: Automatically switches to Sleep Mode

PM 2.5 36–75 $\mu\text{g}/\text{m}^3$: Automatically adjusts to Speed Level I

PM 2.5 76–115 $\mu\text{g}/\text{m}^3$: Automatically adjusts to Speed Level II

PM 2.5 >116 $\mu\text{g}/\text{m}^3$: Automatically adjusts to Speed Level III

Timer Function

1. Repeatedly press the timer button to select the desired operation duration from 2, 4, or 8 hours.
2. When the timer is active, the timer indicator light will illuminate.
3. Upon completion of the set duration, the air purifier will automatically power off.
4. To cancel the timer function, press the timer button repeatedly until all timer indicator lights turn off.

Notes:

1. During timer operation, all other button functions remain available for normal use.
2. If the timer duration is changed during operation, the timer will restart with the newly set duration.
3. When pressing the timer button during operation:

First press: Displays remaining time from previous setting

Subsequent presses: Adjusts timing starting from current remaining time

Child Lock Mode

To Activate: Press and hold the Child Lock button for 3 seconds. The machine will enable Child Lock mode, locking the display and all buttons (no operations can be performed).

To Deactivate: Press and hold the Child Lock button again for 3 seconds to exit Child Lock mode.

Screen Lighting Control

Press the screen lighting button to turn off the display screen light.

Press again to turn the screen light back on.

Filter Replacement

1. After 1,140 hours of operation, the red indicator light will illuminate, reminding the user to replace the filter.
2. When the red light is on: Replace the filter, then press and hold the filter indicator button for 3 seconds → the red light will turn off.
3. To manually reset the filter timer: Press and hold the filter indicator button for 3 seconds → the red light turns on. Replace the filter, then press and hold the button again for 3 seconds → the red light turns off (reset successful).
4. Short press the filter reset button: The button backlight turns white, and the display shows the remaining filter life. After 5 seconds, it switches back to PM2.5 display, and the white light turns off. If pressed again within 5 seconds: The display immediately switches to PM2.5, and the white light turns off.

Ambient Light

The ambient light changes color based on real-time PM2.5 levels detected by the sensor to indicate air quality:

PM 2.5 0–35 $\mu\text{g}/\text{m}^3$: Blue light

PM 2.5 36–75 $\mu\text{g}/\text{m}^3$: Green light

PM 2.5 76–115 $\mu\text{g}/\text{m}^3$: Yellow light

PM 2.5 >116 $\mu\text{g}/\text{m}^3$: Red light

Aromatherapy

Open the essential oil compartment lid on top of the air purifier. Add a few drops of essential oil (oil not included) (The lid of The essential oil needs to be pressed down to open).

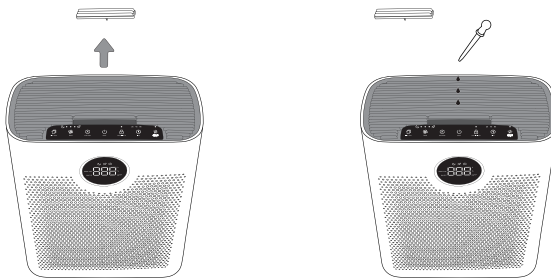

Kindly Notice: Do not add essential oils directly into the filter or fan. The filter will be damaged by essential oils and may emit unpleasant odors.

About the Filter

The air purifier uses a 3-stage H14 True HEPA filtration system to purify air.

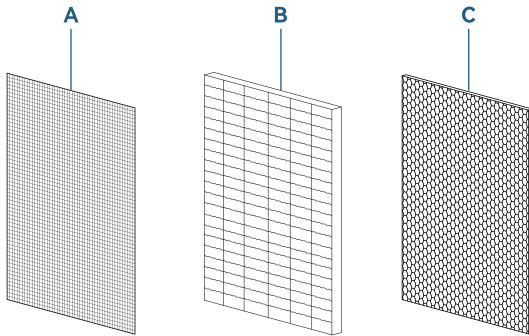

A. Pre-Filter

Captures large particles such as dust, lint, fibers, hair, and pet fur.

B. H14 True HEPA Filter

Traps at least 99.995% of airborne particles 0.1–0.3 microns in size. Traps airborne particles such as fine dust, smoke particles, and allergens such as pollen and pet dander.

C. Activated Carbon Filter

Physically adsorbs smoke, odors, and fumes.

Safety Information

Only use the air purifier as described in this manual.

Do not use the air purifier without removing the plastic wrap from the filter.

If not removed, the air purifier **will not** filter air, and may overheat, causing a fire hazard.

Do not use the air purifier outdoors.

Keep the air purifier **away from** water or wet, damp areas.

Never submerge it in water or liquid.

Do not use the air purifier in excessively humid areas.

Keep the air purifier away from heat sources such as stovetops, ovens, or radiators.

Do not use the air purifier in places where combustible gases, vapors, metallic dust, aerosol(spray) products, or fumes from industrial oil are present.

Keep the air purifier 5ft (1.5m) away from where oxygen is being administered.

Supervise children when they are near the air purifier.

Do not place anything into the openings of the air purifier.

Do not place heavy objects on the air purifier.

Keep the inside of the air purifier dry. To prevent moisture build up, **avoid** placing it in rooms with major temperature changes or underneath air conditioners.

Always unplug the air purifier before servicing (such as changing the filter).

Do not use the air purifier if it is damaged or not functioning well, or if the power cord or plug is damaged.

Do not risk repairing the air purifier by yourself. Contact customer support for assistance.

Not for commercial use. Household use only.

Power Cord & Plug

Place the air purifier near the electrical outlet it is plugged into.

Never place the power cord near any heat sources.

Do not cover the power cord with a rug, carpet, or other covering.

Do not place the cord under furniture or appliances.

Keep the power cord out of areas where people frequently move around.

Place the cord in places where it **will not** be tripped over.

The air purifier has a polarized plug (one prong is wider than the other), which fits into a polarized outlet in only one orientation. This is a safety feature to reduce the risk of electric shock. If the plug

does not fit, reverse the plug to the correct orientation. If it still **does not** fit, **do not** bypass this safety feature and do not try forcing the plug into the outlet. Instead, do not use it with the outlet.

This air purifier uses standard US 120V, 60Hz outlets.

If using it **outside** the US, **check** the compatibility.

Care & Maintenance

Cleaning the Air Purifier

1. Unplug and turn off the air purifier.
2. Open the back cover of the air purifier's filter compartment.
3. Vacuum the inside of the air purifier using a vacuum hose with a crevice attachment.

Cleaning the Air Filter

The filter should be cleaned every 2–4 weeks to increase efficiency and extend the life of your filter. Clean the pre-filter using a soft brush or vacuum hose to remove hair, dust, and large particles. Do not clean the filter with water or other liquids.

Vacuum the filter using directly.

When Should I Replace the Filter?

The filter should be replaced ever 3–6 months. Replace the filter earlier or later, depending on how often you use your air purifier. When the filter use time reaches 1140h, the filter replacement button will always light up to remind. After replacement, long press the filter replacement indicator, the light will off and start the timer again.

You may need to replace your filter if you notice:

- Increased noise when the air purifier is on
- Decreased airflow
- Unusual odors
- A visibly clogged filter

Troubleshooting

Problem	Possible Solution
<p>Air purifier will not turn on or respond to button controls.</p>	<ul style="list-style-type: none"> - Make sure if the power cord is damaged. - Plug the air purifier into a different outlet. - The air purifier may be malfunctioning. <p>Stop using the air purifier and contact Customer Support. Do not try to repair the air purifier.</p>
<p>Airflow is significantly reduced.</p>	<ul style="list-style-type: none"> - Ensure there are at least 11.8 inches / 30 cm of clearance on all sides of the air purifier. - The filter may be clogged by large particles such as hair or lint, blocking the air flow. Clean the filter. Replace with a new filter.
<p>Air purifier makes an unusual noise while the fan is on.</p>	<ul style="list-style-type: none"> - Make sure the filter is properly in place with plastic packaging removed. - Make sure the air purifier is operating on a hard, flat, level surface. - Replace the filter. - The air purifier may be damaged, or a foreign object may be inside. Stop using the air purifier and contact Customer Support. Do not try to repair the air purifier.
<p>Strange smell coming from the air purifier.</p>	<ul style="list-style-type: none"> - Clean the filter, or replace if necessary. - Make sure not to use your air purifier in an area with high humidity or while diffusing essential oils.
<p>Filter Indicator is still flash after replacing the filter.</p>	<ul style="list-style-type: none"> - Reset the Check filter Indicator.
<p>Poor air purification quality.</p>	<ul style="list-style-type: none"> - Tap Fan Speed Button increase the fan speed.. - Make sure no objects are blocking the front, sides, or top of the air purifier. - Close windows and doors while using the air purifier. - Replace the filter.
<p>Note: If your problem is not listed, please contact Customer Support.</p>	

FEDERAL COMMUNICATIONS COMMISSION INTERFERENCE STATEMENT – PART 15

This device complies with Part 15 of the FCC Rules. Operation is subject to the following two conditions:

- (1) This device may not cause harmful interference, and
- (2) This device must accept any interference received, including interference that may cause undesired operation.

WARNING: FCC Regulations state that any unauthorized changes or modifications to this equipment not expressly approved by the manufacturer could void the user's authority to operate this equipment.

This equipment has been tested and found to comply with the limits for a Class B digital device, pursuant to Part 15 of the FCC Rules.

These limits are designed to provide reasonable protection against harmful interference in a residential installation. This equipment generates, uses, and can radiate radio frequency energy and, if not installed and used in accordance with the instructions, may cause harmful interference to radio communications. However, there is no guarantee that interference will not occur in a particular installation. If this equipment does cause harmful interference to radio or television reception, which can be determined by turning the equipment off and on, the user is encouraged to try to correct the interference by one or more of the following measures:

- Reorient or relocate the receiving antenna.
- Increase the separation between the equipment and receiver.
- Connect the equipment into an outlet on a circuit different from that to which the receiver is connected.
- Consult the dealer or an experienced radio/TV technician for help.

Note: A shielded interface cable is required to ensure compliance with FCC regulations for Class B certification.

Warranty Information

Product Name	Air purifier
Model	ZQA-8000A
Date of Purchase	
Order ID	

12-month warranty

There is no other express warranty. This warranty doesn't apply:

If the product has been modified as is;
Failure to use the product in accordance with the instructions and directions in the user manual;
Damage or defects caused by accident, abuse, misuse or improper or inadequate maintenance;
Damage or defects caused by service or repair of the product by anyone other than an unauthorized service provider or official store;
Damage or defects occurring in the course of commercial use, rental use or any use other than that for which the product was originally intended;
Damage or defects that exceed the cost of the product.

This warranty applies only to the original consumer purchaser of the product and is not transferable to any subsequent owner of the product, whether or not the product is transferred within the specified warranty period.

This warranty gives you specific legal rights, and you may also have other rights that vary from state to state. Some states do not allow the exclusion or limitation of incidental or consequential damages, so the above limitations or exclusions may not apply to you.

For guidance on product use, please contact our customer service team via Amazon email

Customer Support

If you have any questions or concerns about your new product, please contact our helpful Customer Support Team.

Support Hours Mon-Fri, 9:00 am-5:00 pm PST/PDT

Customer Service Email: Airpurifiers2024@outlook.com

Store link: <https://www.amazon.com/sp?ie=UTF8&seller=A1TWH5YBTJWLE1>



CONFORMS TO UL STD.507
CERTIFIED TO CSA STD.C22.2 NO.113

Intertek
5031719

CAUTION

- Warning: Keep out of reach of children.
- Do not use near heat sources or flammable materials.
- Unplug the device when not in use for extended periods.
- Ensure the air purifier is placed on a flat, stable surface.
- Do not block the air inlet or outlet during operation.
- Caution: Electric shock hazard.
- Use only the recommended filters for replacement.
- Do not attempt to repair the unit yourself. Contact a certified service provider.
- Keep away from water and moisture.
- Please read the instruction carefully before use,so as to use correctly!

Where is the power cord of the air purifier?

Turn the bottom switch with the power cord in the middle of the filter element

Air purifier filtration efficiency?

The H14 HEPA certified filtration efficiency is 99.995% for the most easily penetrating particle size of 0.1–0.3um

What contaminants can the H14 filter efficiently capture?

Small particles: PM2.5, smoke, dust

Microorganisms: bacteria, viruses, mold spores

Allergens: pollen, dust mite excrement, pet dander

How to find air purifier replacement filter element?

Search the ZQA-8000A air purifier filter on the platform or store

Filter replacement principle?

The detection system will automatically calculate the life of the air quality and the cycle time of the machine (limit is 1140 hours), and it will remind the arrival time

Can I replace the filter element in advance?

Under normal circumstances, wait for the reminder to replace, if you must replace in advance, long press the filter replacement reminder button for 3 seconds to display the red light, and then press and hold it for 3 seconds to reset

How is the remaining life of the filter element displayed?

Press the filter element reset button briefly

What should I do if the product has accessories or use problems?

Please consult VNIUP brand customer service directly on the platform, we will work with you to solve the problem