

# SwitchBot Weather Station User Manual

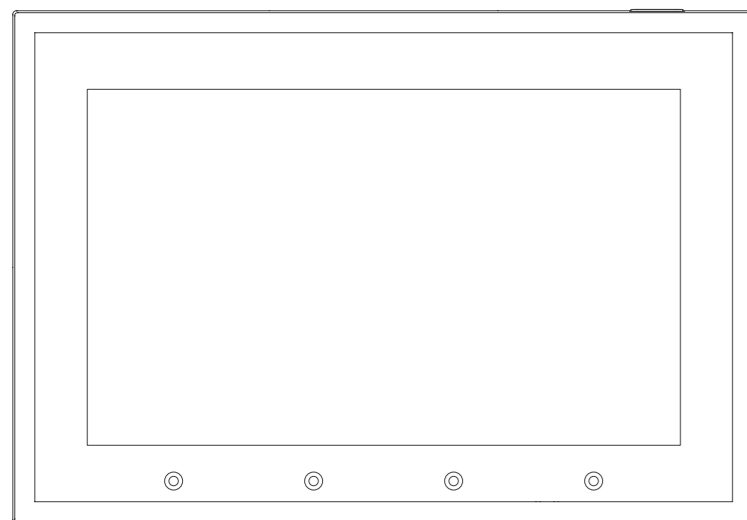

Scannen Sie den QR-Code, um die deutsche Version unseres Benutzerhandbuchs zu erhalten.  
Scannez le code QR pour obtenir notre manuel d'utilisation en version française.  
Escanee el código QR para obtener la versión en español de nuestro manual de usuario.  
Scan de QR code voor de Nederlandse versie van onze gebruikershandleiding.  
Scansionate il codice QR per ottenere la versione italiana del nostro manuale d'uso.  
Zeskanuj kod QR, aby pobrać instrukcję obsługi w języku polskim.

<https://www.switch-bot.com/pages/switchbot-user-manual>



User Manual

## Package Contents

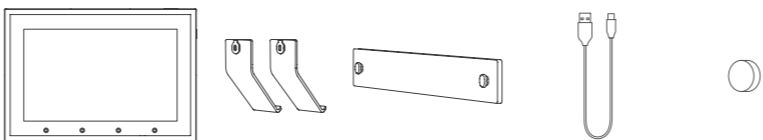

Weather Station    Stand × 2    Mounting Bracket    Charging Cable    Adhesive Pad

## List of Components

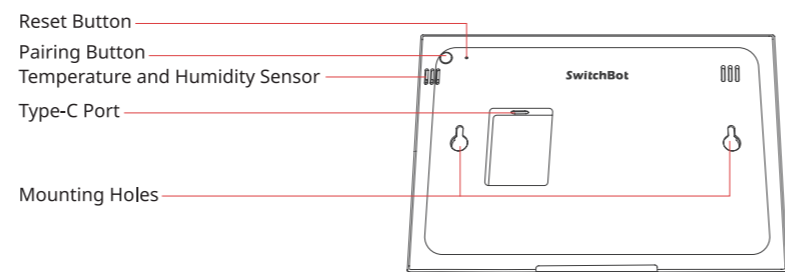
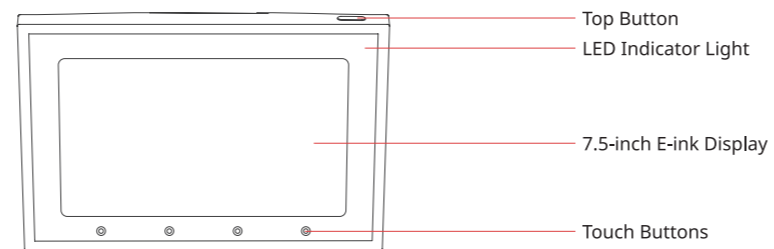

## Preparation

You will need:

- A smartphone or tablet using Bluetooth 4.2 or later.
- The latest version of our app, downloadable via the Apple App Store or Google Play Store.
- A SwitchBot account, you can register via our app or sign in to your account directly if you already have one.

**Please note:** if you intend to use the third-party services or voice control, you will need a SwitchBot Hub (sold separately).



iOS and Android system requirements:

<https://support.switch-bot.com/hc/en-us/articles/12567397397271>



## Installation

**Add the device to our app.**

Open our app and sign in to your account. Tap "+" at the top right-hand corner of the home page, find the Weather Station icon, and select. Then follow the instructions to add your device.

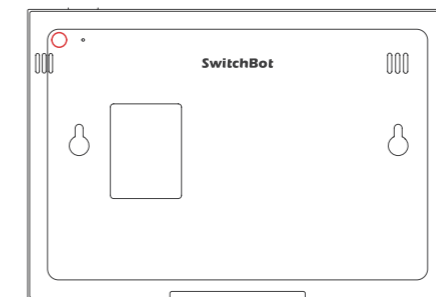

Press the pairing button for 2s until the indicator light flashes, indicating that the device has entered the pairing mode.

### Desktop Mounting

Clamp the two stands onto the mounting holes at the back.

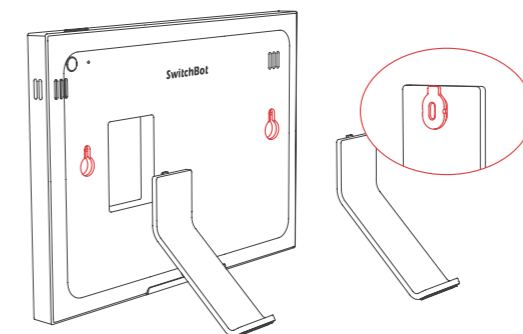

Please read this user manual carefully before using your device.

## Wall Mounting

1. Clean the installation position with dry cloth or tissue.
2. Stick the round adhesive pad on the indicated area at the back of your Weather Station.

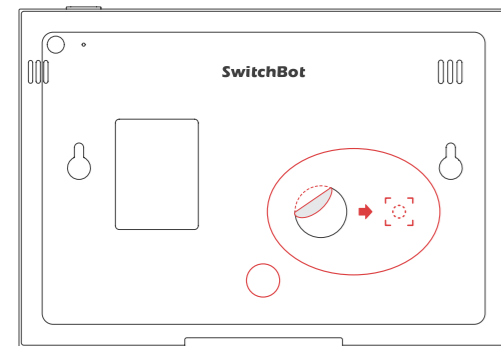

3. Peel off the tape liner on the bracket and attach it on the surface. Press for at least 30s for better adhesion.
4. Firmly clamp the device onto the bracket.

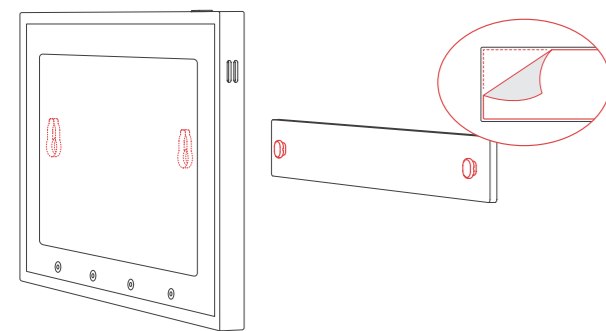

Material is suitable for smooth surfaces and walls such as glass, ceramic tiles, and stainless steel.

## Precautions

- Use a 5V=1A adapter and Type-C cable to charge the device for safe, stable power and optimal performance.
- Clean the screen and unit with a soft, dry cloth. Avoid abrasive cleaners or solvents to prevent surface damage.
- Do not apply pressure to the screen or let sharp/hard objects like keys or coins contact it directly.
- Keep the sensor's air vent unobstructed to ensure airflow and avoid interference with sensor readings.
- Long-term exposure to non-recommended conditions (5 °C to 50 °C, 20–80% RH) may accelerate aging.
- Avoid placing the product in constantly humid or moist environments.
- Keep the product away from prolonged direct sunlight or heat sources.

## Display Overview

### Top Bar

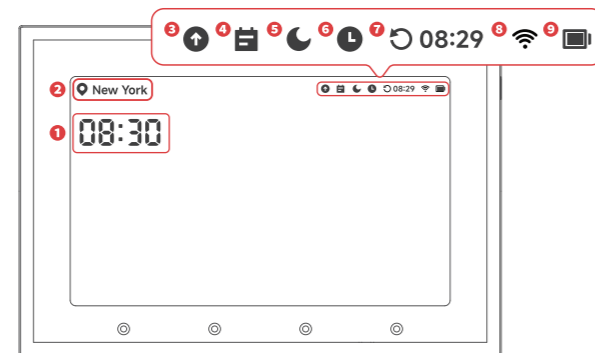

08:30	1 Time
New York	2 Location
↑	3 Firmware upgrade reminder
📅	4 Schedule reminder
🌙	5 Do not disturb mode

🕒	6 Alarm
🕒 08:29	7 Data last updated time
📶	8 Wi-Fi connection status
🔋	9 Battery level

## Usage Tips

### Screen Light

Tap the top button to activate the screen front light.

### Data Refresh

Press the top button for 2s to make the device connect to the network and update the latest weather and calendar data.

### Unit Switching

Press the pairing button to switch the display units of temperature.

### Scene Triggering

1. Create two custom Scenes for quick activation using the two lower-right shortcuts.
2. Use your Weather Station's temperature and humidity data as Automation triggers. When readings meet your set conditions, the corresponding Automations will run automatically.



**Note:** A SwitchBot Hub (sold separately) is required.

### AI Analysis

Our AI leverages current and forecasted weather data to generate detailed travel and health suggestions. For a more personalized experience, sync your third-party calendars with your Weather Station.

## LED Indicator Light

LED Indicator Light	Description
Fast/slow blinking	Connecting to the network or in pairing mode
Slow blinking/off	Firmware upgrade in progress
Slow blink once	Power-cycle restart
Fast blink once	Button pressed

## Restoring to Factory Settings

Hold the pairing button on the back for 15s. The device screen will refresh and complete the reset process.

## Firmware Upgrades

In order to improve user experience, we will regularly release firmware updates to introduce new functions and solve any software defects that may occur during usage. When a new firmware version is available, we will send an upgrade notification to your account via our app. When upgrading, please make sure your product has sufficient battery or stay powered on and make sure your smartphone is within range to prevent interference.

## Frequently Asked Questions

**Q: My temperature and humidity readings are inaccurate. How can I fix this?**

**A:** Recalibrate your Weather Station through our app. If the issue persists, please contact customer support.

**Q: How do I restart the device?**

**A:** Use a reset pin or other thin, sturdy object to long-press the reset button for 3s until the indicator light turns on, then release. The device will restart after the screen refreshes.

Please visit our website or scan the QR code below for more information.



## Specifications

Material: ABS+PC  
Size: 212 × 146 × 15 mm (8.3 × 5.7 × 0.6 in.)  
Weight: 310 g (10.9 oz.)  
Power: 5V=1A, 5000 mAh lithium-ion battery  
Battery Life: 1 year  
Operating Temperature: 0–50°C (32–122°F)  
Operating Humidity: 0–90% RH  
Temperature Precision: 0–50°C (32–122°F) [±0.4°C/0.7°F]  
Humidity Precision:  
0 to 10% RH (±3% RH)  
10 to 90% RH (±2% RH)  
Connectivity: 2.4GHz Wi-Fi, Bluetooth Low Energy 4.2 or above

## Warranty

We warrant to the original owner of the product that the product will be free from defects in materials and workmanship. Please note that this limited warranty does not cover:

1. Products submitted beyond the original limited warranty period.
2. Products on which repairs or modifying have been attempted.
3. Products subjected to falls, extreme temperatures, water, or other operating conditions outside the product specifications.
4. Damage due to natural disaster (including but not limited to lightning, flood, tornado, earthquake, or hurricane, etc.).
5. Damage due to misuse, abuse, negligence or casualty (e.g. fire).
6. Other damage that is not attributable to defects in the manufacture of product materials.
7. Products purchased from unauthorized resellers.
8. Consumable parts (including but not limited to batteries).
9. Natural wear of the product.

## Contact & Support

Feedback: If you have any concerns or problems when using our products, please send feedback via our app through the Profile > Support page.

Setup and Troubleshooting: [support.switch-bot.com](https://support.switch-bot.com)

Support Email: [support@switch-bot.com](mailto:support@switch-bot.com)

