

# WP100AOG EZ-Pitcher + Reverse Osmosis Water Filtration System

## Installation and Operation Guide

 **WARNING**

Please read this manual carefully before using your product, and keep it for future reference. As the appliance is kept upgrading, it may differ between the actual appliance and the one in the manual. Please refer to the actual product.



## **WARNING**

- Please use municipal tap water as the water source. Do not use water that is microbiologically unsafe or of unknown quality without adequate disinfection before or after the system.
- Be sure to handle the system gently and carefully. Do not attempt to modify or repair the system yourself, otherwise, the warranty becomes invalid.
- This device is intended for domestic use only.
- The inlet water temperature of the system should be within 5-38°C. When the inlet water temperature exceeds 38°C, the filter could be damaged and become invalid. If the inlet water temperature is lower than 5°C, it may cause freezing and the parts of the system to rupture, resulting in water leakage.
- Do not reverse the installation order of the filter cartridges to avoid affecting the filter performance of the system.
- If the system is abnormal or faulty, stop using it immediately. Close the inlet water valve, and turn on the faucet to empty the system. Events of faults include:
  - Leakage
  - The product is cracked or damaged
  - There is an abnormal sound or burnt smell
  - The machine does not work
  - Please contact consumer care for inspection immediately.
- If not using the system for an extended period, turn off the water supply to avoid damage to the system.

---

# CONTENTS

1 Product Introduction	04
2 Product Specification	04
3 Product Overview and Installation Illustration	05
4 Tools and Materials Required	06
5 Installation	06
5.1 Installing the Angle Stop Adapter	06
5.2 Selecting the Pitcher Base Location	07
5.3 Sleeving the Pipe and Signal Cable of the Pitcher Base	08
5.4 Install RO Drain Connector	09
5.5 Place the Alkaline Filter	10
5.6 Connecting the Pipe to the System	11
5.7 Connecting the Signal Cable Connecting	12
5.8 Pitcher Base Operation	13
5.9 System Start-up	13
6 Maintenance	15
7 Trouble Shooting	17
Warranty Policy	18

---

## 1 PRODUCT INTRODUCTION

The WP100 Reverse Osmosis (RO) System uses a semipermeable membrane to reduce dissolved salts and minerals, improving the taste and odor of your water. The RO membrane is made of layers of micron-thin film wound around a hollow center core. Water molecules can pass through the membrane, but dissolved salts and minerals are rejected.

The WP100 Reverse Osmosis System features 4-stage filter action. Your water supply is pre-filtered to reduce dirt and chlorine that may foul the membrane. The RO membrane separates this pre-filtered water into PURIFIED WATER and WASTE water. Incoming water pressure forces the pure water through the membrane and into the pitcher storage. Dissolved solids and other contaminants cannot pass through the membrane and are sent to the drain as waste(reject)water. When you put that pitcher back to base, pure water is drawn from the system through an automatic filling and stopped when it is filled, it's ready and providing you with cleaner, great-tasting water. For each gallon of water produced, several gallons are discharged as reject water. The pitcher can hold up to 0.47 gallons (1.8 L) of water at a time, for drinking and cooking needs.

**IMPORTANT:** Before installing this reverse osmosis system, make certain your water supply complies with the following operating specifications. Failure to do so may reduce the effectiveness of the system and will void the warranty.

## 2 PRODUCT SPECIFICATION

Model	WP100
Part No.	WP100AOG
Filtered water flow rate	100GPD
Operating Temperatures	40-100 °F (5-38 °C)
Operating Pressure	14.5-100 psi (0.1-0.7 MPa)
Rated voltage	DC 24V
Rated power	35W
pH Parameters	2-11
TDS (Total Dissolved Solids)	< 1800 ppm
Iron	< 0.2 ppm
Turbidity	< 5 NTU
Hardness	< 10 gpg (170 mg/L)

**Hardness:** Recommended hardness not to exceed 10 grains per gallon, or 170 parts per million.

**Note:** System will operate with hardness over 10 grains but the membrane life may be shortened. The addition of a water softener may lengthen the membrane life.

**Water Pressure:** The operating water pressure in your home should be tested over a 24 hour period to attain the maximum pressure. If the incoming water pressure is above 80 psi then a water pressure regulator is required.

### 3 PRODUCT OVERVIEW AND INSTALLATION ILLUSTRATION

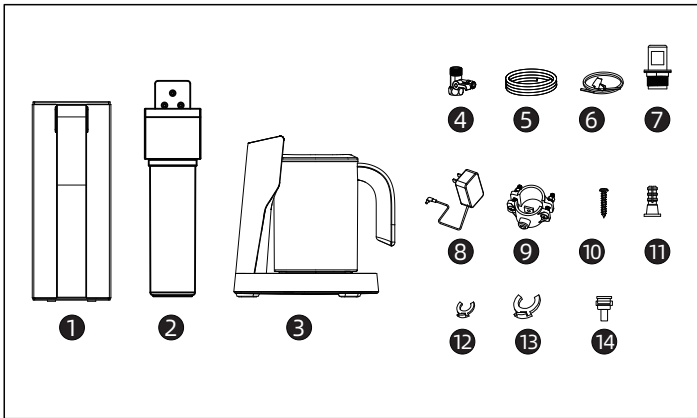

- ① RO system
- ② Alkaline filter
- ③ Pitcher base
- ④ Angle stop valve
- ⑤ 1/4" PE pipe
- ⑥ Sleeve pipe bag
- ⑦ Cover
- ⑧ Power adapter with plug
- ⑨ Drain connector
- ⑩ Screws
- ⑪ Expansion screw
- ⑫ 1/4" clips
- ⑬ 3/8" clips
- ⑭ Quick connector

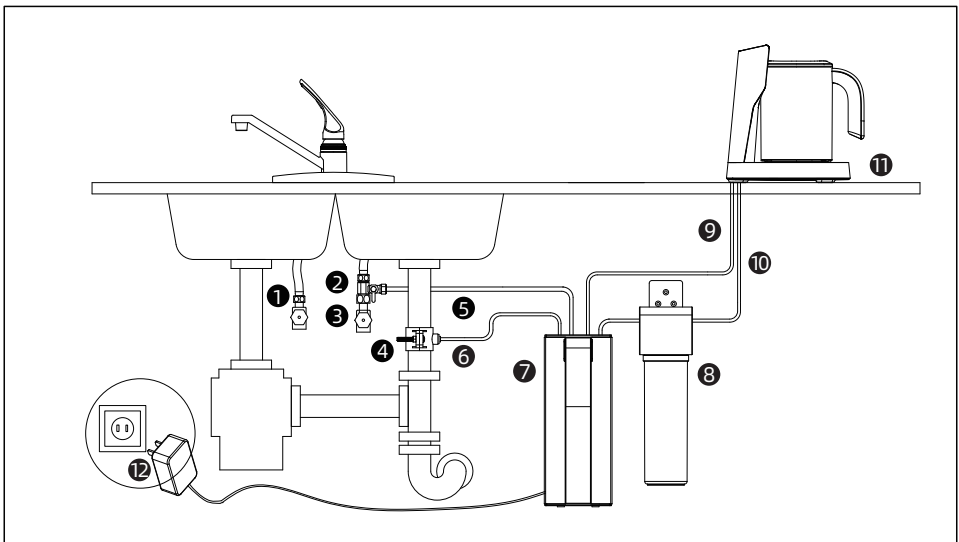

- ① Hot line
- ⑦ Reverse osmosis system
- ② Cold line
- ⑧ Alkaline filter
- ③ Angle stop valve
- ⑨ Signal cable
- ④ Drain connector
- ⑩ Filtered water outlet pipe
- ⑤ Water inlet pipe
- ⑪ Pitcher Base
- ⑥ Drain outlet pipe
- ⑫ Power adapter

## 4 TOOLS AND MATERIALS REQUIRED

- Hand or electric drill (cordless preferred)
- (2) Adjustable wrenches
- Slotted and Phillips screwdrivers
- File
- Safety glasses
- Drill bits: 1/8", 3/16", 1/4", 3/8"
- If sink does not have hole for separate faucet:
- Center punch
- Cone-shaped grinding wheel
- 1-1/4" hole saw or drill bit
- Safety mask



### NOTE

All tools may not be necessary for installation. Read installation procedures before starting to determine what tools are necessary.

## 5 INSTALLATION

Read all installation and operating instructions before installing and using your RO system.

### 5.1 Installing the Angle Stop Adapter

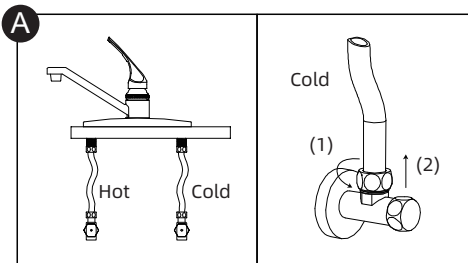

- A. Turn off the cold water supply. Turn on the kitchen cold water faucet to release the pressure and allow water to drain from the line. Disconnect the cold water hose from the cold water valve.

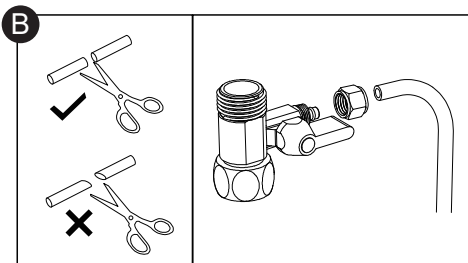

- B. Measure the length of the 1/4" pipe and cut it accordingly with a pipe cutter.

Slide the nut of the angle stop adapter onto the 1/4" PE pipe pipe and insert the pipe into the opening of the angle stop adapter. Tighten the nut with a wrench.

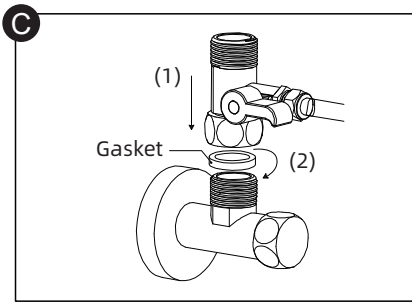

C. Install the angle stop adapter on the cold water valve. Please don't miss the gasket inside the angle stop adapter during installation.

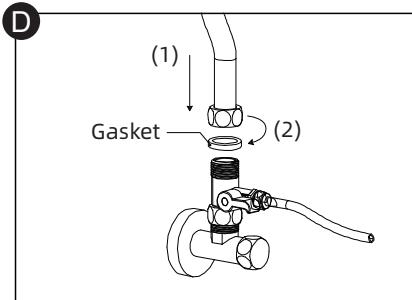

D. Connect the cold water hose with the angle stop adapter and screw it tightly with a wrench. Please don't miss the gasket in the cold water hose during installation.

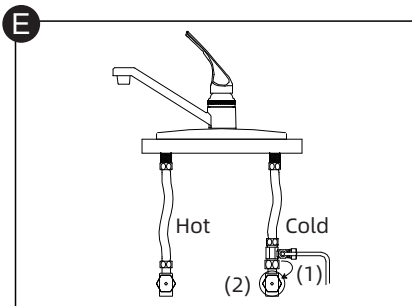

E. Switch off the angle stop adapter. Turn on the cold water supply. Wipe the connections with a tissue to see if there is leakage. If the tissue stays dry, it means the angle stop adapter is installed properly.

## 5.2 Selecting the Pitcher Base Location

The drinking water pitcher should be positioned with function, convenience and appearance in mind. An adequate flat area is required to allow pitcher base to rest securely. The pipe and signal-cable through a 1-1/4-inch hole. Most sinks have pre-drilled a 1/2-inch or a 3/8-inch diameter holes designed for spray hoses. The drinking water pitcher connection may be through using one of these holes, despite their larger size. If these pre-drilled holes cannot be used or are in an inconvenient location, it will be necessary to drill a 1-1/4-inch hole in the sink or through countertop next to the sink for the piping and cable.



## CAUTION

- This procedure may generate dusts which can cause severe irritation if inhaled or come in contact with the eyes. The use of safety glasses and safety mask for this procedure is recommended.
- Do not attempt to drill through an all-porcelain or porcelain-coated sink. For applications on these types of sinks, we recommend using the sprayer hole or drilling the hole through the countertop.
- When drilling through a countertop, make sure the area below the drilled area is free of wiring and piping. Make certain that you have ample room to make the proper connections to the bottom of the countertop.
- Do not drill through a countertop that is more than 1 inch thick.
- Do not attempt to drill through a tiled, marble, granite or similar countertop. Consult a plumber or the countertop manufacturer for advice or assistance.

The following instructions apply to stainless steel sinks ONLY.

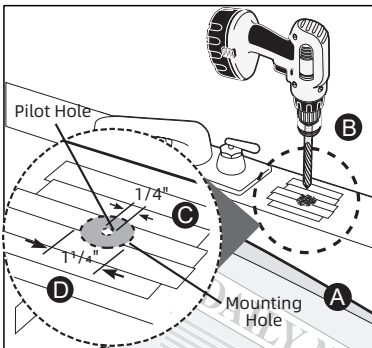

- (A) Line bottom of sink with newspaper to prevent shavings, parts or tools from falling down the drain.
- (B) Place masking tape over the area to be drilled to help prevent scratches if drill bit slips.
- (C) Mark point with center punch. Use a 1/4-inch drill bit to drill a pilot hole through sink.
- (D) Use a 1-1/4-inch hole saw to enlarge hole. Smooth rough edges with a file.

## 5.3 Sleeving the Pipe and Signal Cable of the Pitcher Base

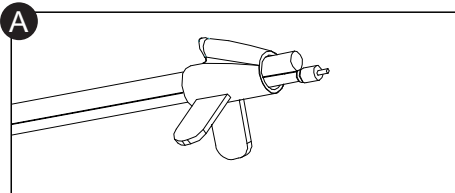

- (A) Use the clamp to sleeve the the pipe and signal cable.

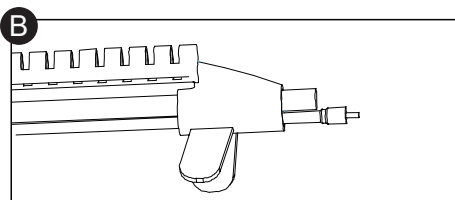

- (B) Use the clamp to expand drivepipe. Push the clamp down make the pipe and code through the drivepipe.

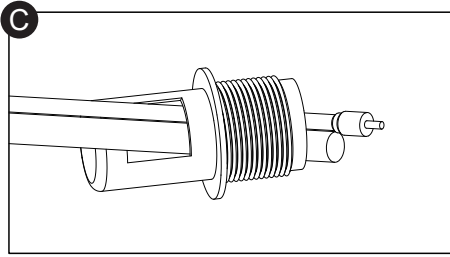

(C) Put the pipe and signal cable through the hole of the cover.

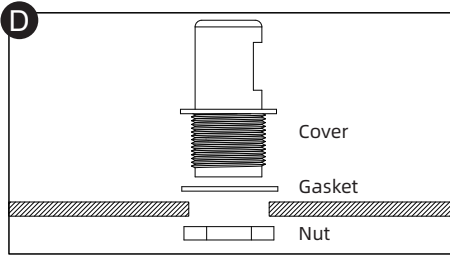

(D) Install the cover according to the diagram. Screw the cover stem nut all the way up the cover stem, and tighten it to secure the cover.

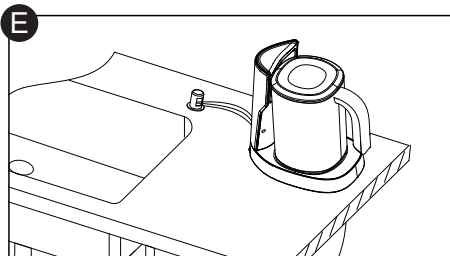

(E) Located the base of the countertop.

## 5.4 Install RO Drain Connector

1. Identify drain outlet location.
2. Knock out center hole on foam seal (4).
3. Use hole in foam seal (4) as a template to locate your drilling position above drain tap, mark location with pencil. Note: If you have a double sink and/or cross/horizontal drain pipe, it is safe to mark drill location on the top of the horizontal drain pipe.
4. At marked location, drill 1/4" hole through wall of drain pipe. Be sure not to penetrate opposite side of pipe.
5. Remove protective cover from back of foam seal (4) and attach to front plate of drain connector (1) in alignment with holes.
6. Begin to position the drain connector (1) on sink drain pipe with Screws (2) and Nuts (3), using your pencil (or a thin pen) in the drain connector (1) tube hole, to guide your location over your drilled hole as you securely tighten Nuts (3) and Screws (2).

**NOTE**

Remove pencil once location is established.

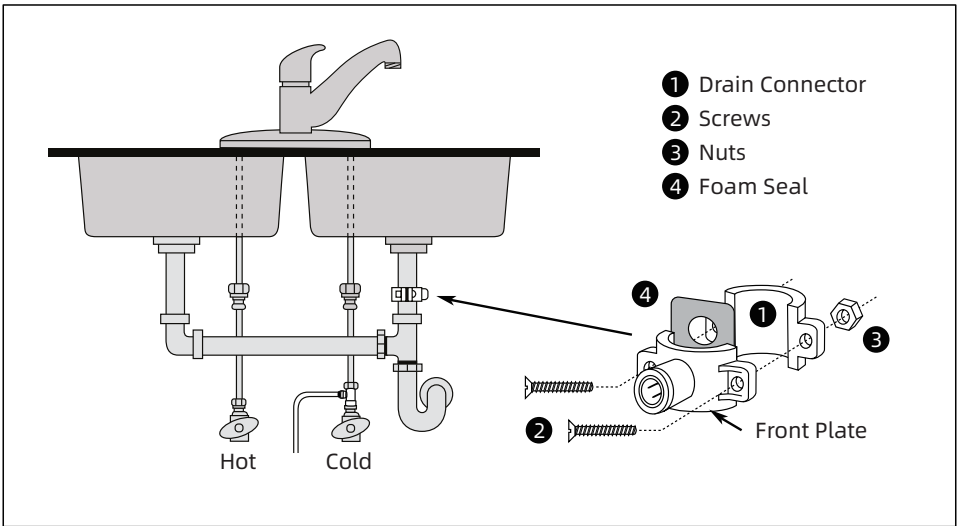

### 5.5 Place the Alkaline Filter

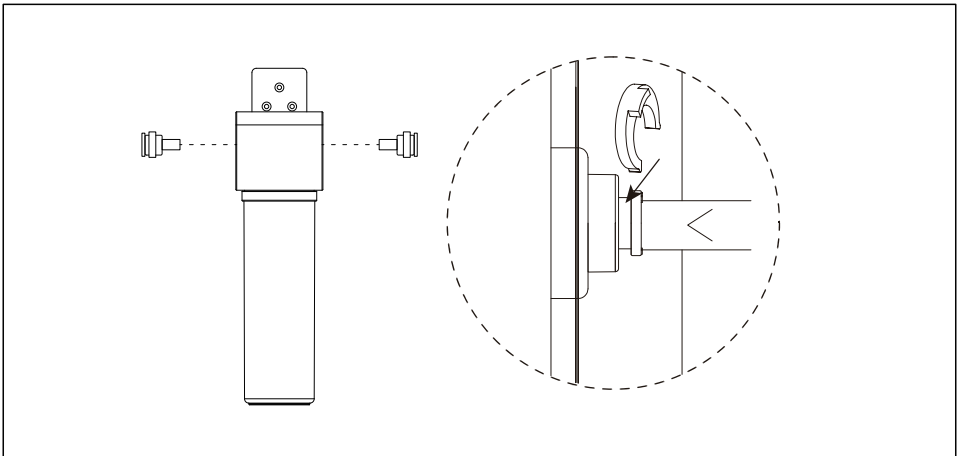

Install the quick-connector of two side. Use a clip to secure the quick-connector at the hole.

### Wall mounting for Alkaline filter (optional step)

- Select an easily accessible area under the sink to mount the Alkaline filter.
- Mark wall placement for mounting screws using the built-in bracket on the back of the manifold. Ensure holes are as level as possible. (Note: At least 5cm from bottom of cartridge to the floor to allow ample space for cartridge changes)
- Drill 3 pilot holes for mounting brackets using 1/4" drill bit for the system manifold.

Note: Do not drill into anything beyond the cabinet wall.

- Insert anchors and mount the manifold on wall and screw in place. Avoid over-tightening.

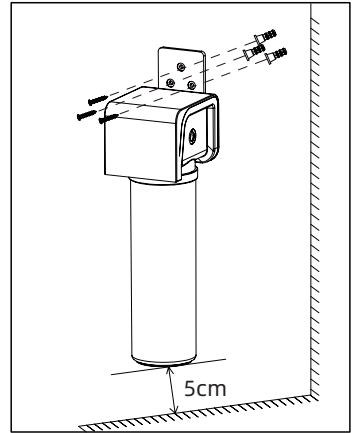

## 5.6 Connecting the Pipe to the System

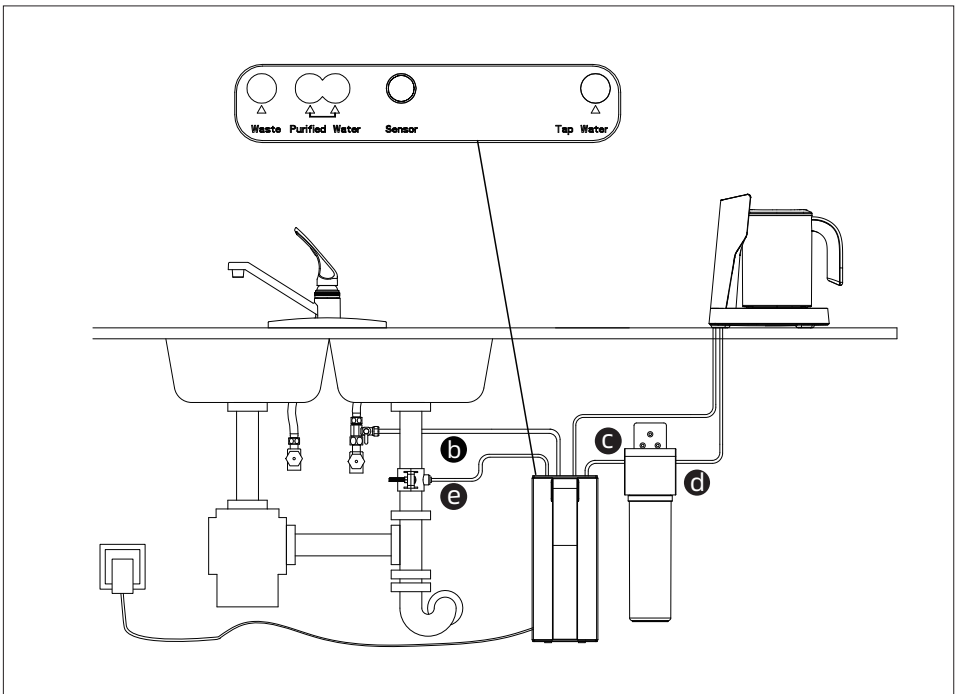



## NOTE

Please check if there is sufficient space for installing the system itself, its accessories, connections, and for servicing and repair. Under no circumstances should the system be installed outdoors. The environment where the system is installed should adhere to any appropriate hygiene and sanitation conditions. Avoid any external dripping liquids from pipes or drains etc onto the system.

This system should be placed on a stable and at the surface. Keep the system away from heat. It shall not be placed in a place that may have in-flammable gas leakage.

(a) Press down the collects and pull out the plugs of the water inlet and outlet holes in the top of the system.

(b) Connect the Tap water and the angle stop adapter.

Insert the other end of the 1/4" pipe which has been connected with the angle stop adapter into the Tap water hole in the top of the system. Use a clip to secure the pipe at the hole.

(c) Connect the Purified water and the alkaline filter

Cut a section of 1/4" pipe. Insert one end of the pipe into the Purified water hole. Insert the other end of the pipe into the left hole of the alkaline filter. Use a clip to secure the pipe at the hole. (the filters have two holes of the Purified water hole, choose one of the holes and another one still plugged)

(d) Connect the alkaline filter and the pitcher base

The pitcher base had assembled a 1/4" pipe. Insert one end of the 1/4" pipe into the right hole of the alkaline filter until it stops. Use a clip to secure the pipe at the hole.

(e) Connect the waste and the drain connector

Cut a section of 1/4" pipe. Insert one end of the pipe into the waste hole until it stops. Use a clip to secure the pipe at the hole. Insert the other end of the pipe into the drain connector.

## 5.7 Connecting the Signal Cable Connecting

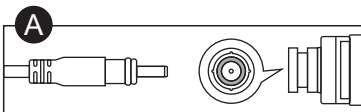

A. Align and plug the D3.5 jack pin into the jack socket on the top of unit.

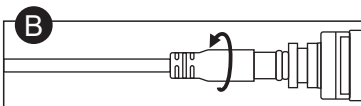

B. Plugged in and twist it 90° until it's locked.

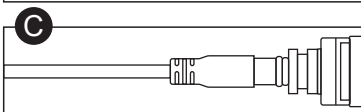

C. Completed the connection of pitcher signal cable and ready to be used.

## 5.8 Pitcher Base Operation

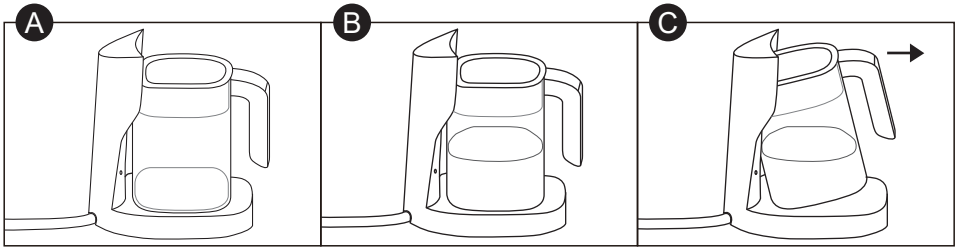

- (A) Place the pitcher back to the base, water will be auto-fills after the "beep".
- (B) In case of water use demand during water filling, just lift the pitcher from base and hovered it for 2 seconds (as shown in Figure 3), after filling stopped, then take out the pitcher completely.
- (C) The filling will automatically be stopped when pitcher is filled with water. it's ready for you enjoy it.

## 5.9 System Start-up

### 5.9.1 Before the first-time use

- (A) Put the pitcher on the base correctly.
- (B) Turn on the cold water supply, and ensure the supply adapter valve is open.
- (C) Connect the system with power. You will hear a beep, and all indicators will light up for 3s . The system flush will be automatically on 18s. Wipe all the joints and connections with tissue to check if there is leakage. If the tissue stays dry, it means the system is installed properly. If there is no further operation after the auto-flash, the system will turn into standby mode, and the indicators will be off.
- (D) Allow 11 minutes for the pitcher to fill. Continue to periodically check the installation for leaks. After the pitcher is filled, lift-up and remove the pitcher. Empty the pitcher for flush. Check the pitcher and base for leaks.
- (E) Repeat step D four times. Then system is ready for operation. You can now enjoy quality water from your Reverse Osmosis System.



### NOTE

Initially, the water may appear cloudy. This is a result of air trapped in the RO filter. It is not harmful and will disappear in a matter of minutes. It may take up to a week after installing a new RO filter for the trapped air to dissipate.

## 5.9.2 User interface

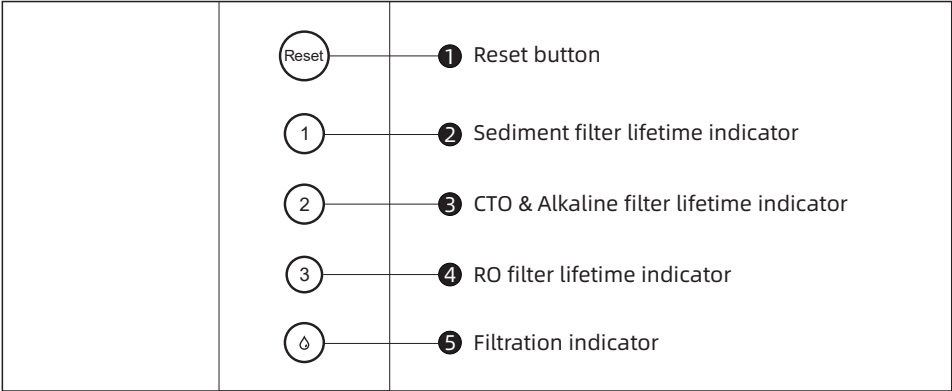

When the system on filtration or flush mode, all the indicators will light up. Not operation within 10s will on standby mode, and all indicator will be off.

### A. Filter lifetime indicator

The filter lifetime not reach the end, the indicator is constant white light. When the filter has reached the end of life, the indicator will flash, there will be beeps whenever reminding you to replace the filter.

### B. Filtration indicator

When on filtration mode, the filtration indicator is flashing.

When on flush mode, the filtration indicator is constant white light.

### C. Reset button

To reset the filter lifetime, long press the reset button for 2 seconds. You will hear a beep, and indicator of 1-Sediment lifetime flash. Short press the reset button again to select the filter to be reset.

When the indicator of the selected filter flashes, long-press the reset button for 5 seconds. You will hear a long beep, and the indicator will show constant light. This means the filter lifetime has been reset successful.

# 6 MAINTENANCE

## Routine maintenance

- Organic solvent such as gasoline etc. shall not be used for wiping the housing of the device. If cleaning is required, please gently wipe the surface of the product with a wet cloth.
- If the system is not used for more than 2 days, Empty the pitcher for more than twice to flush the system.
- If the system will not be used for an extended period, turn off the angle stop adapter, take out the filter cartridges, seal them with plastic wraps, and store them in the refrigerator (not in the freezer). Empty the pitcher. Before using it again, repeat step D and step E in chapter 9.



### NOTE

Don't store the filter cartridges in the freezer of the refrigerator. It may cause leaks or damage the filtration media.

## Filter Cartridge Replacement



### NOTE

The life of the filter cartridges depends on water volume used and the quality of the feed water. For the best performance, please change your filter cartridge according to the filter lifetime indicator, or the filter replacement cycle suggested below. When there is a noticeable change in taste, odor, or flow of filtered water, we recommended changing the filters as well.

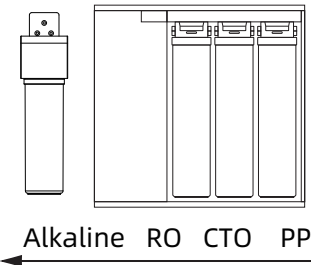

Ensure the correct cartridge is purchased for the system.

Model: WP100

Cartridge	Part No.	Filtration capacity
Sediment filter	RP001A0N	6~12 months
CTO filter	RP003A0N	6~12 months
RO filter	RP004A0N	24~36 months
Alkaline filter	RP005A0N	6~12 months

## Cartridge Replacement

(A) Shut off power and release pressure by turning off the water supply to the system with the pitcher until water fill stops. Place a tray under the system to catch any water that may drip.

(B) Pull the right cover of the side to remove it (Figure A).

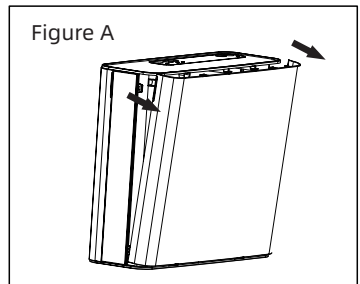

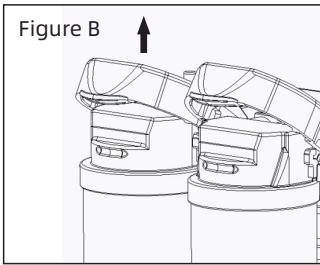

(C) Lift the locking bar upward until the filter cartridge disengages from the filter head assembly (Figure B).

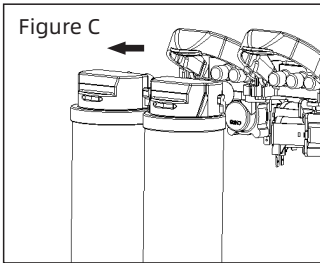

(D) Pull the cartridge away from the filter head assembly and ensure the locking bar remains in the fully up position (Figure C).

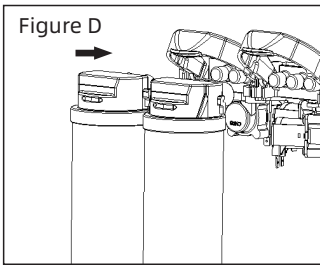

(E) Align the posts on the filter cartridge with the ports in the filter head assembly. Slide the cartridge filter into the filter head assembly (engaging with the locking bar causing it to drop forward and down). (Figure D).

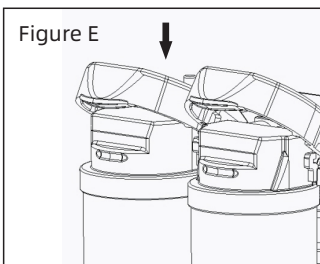

(F) Pull down the locking bar until it snaps into place.

(G) Put the right cover back and turn on the water supply and re-connect with power. Reset the filter lifetime. After filter is replaced, allow water to flow for flush the new filters. Empty the pitcher for flush when the pitcher is full. Repeat the flush four times. After that, the system is ready and you can start to consume the filtered water.

## 7 TROUBLE SHOOTING

Problem	Possible cause	Solution
No water fill in the pitcher	Cold water valve or the angle stop adapter is turned off.	Turn on the valves.
	The system is not connected with power	Check if the power adapter is connected to the system and the power socket properly.
The flow rate gets slower. (Water fill fully in the pitcher more than 30minutes)	Filter is blocked.	Replace the filter.
	The pipes are bend.	Make sure the pipes are straightened.
	Inlet water pressure is low.	Wait until the inlet water pressure gets stable, or install a pressure boost before the system if the inlet water pressure is constantly lower than 15psi.
Poor outlet water quality.	Filter has reached the end of life.	Replace the filter.
	The system hasn't been used for some time.	Check routine maintenance in chapter 10.
	The inlet water quality is poor.	Always use municipal tap water as the water source. Do not use water that is microbiologically unsafe or of unknown quality without adequate disinfection before or after the system.
All indicators flash, and there are beeps	The system has been filtering water continuously for 1 hour.	Unplug the system, wait for 1 minute, and plug in again to shoot the trouble.
	The PCB board is damaged.	Contact customer services.
No water runs to the drain.	The drain pipe is bend.	Make sure the pipe is straightened, or replace with a new pipe.
	System malfunctions.	Contact customer services.
There is leakage.	The pipes are not connected properly.	Reconnect the pipes.
	System malfunctions.	Contact customer services.

---

## **WARRANTY POLICY**

If you need information or if you have any problems, please visit [www.tecasakitchen.com](http://www.tecasakitchen.com) or contact the customer services center in your country. Within one year from the date of purchase, you will receive free warranty service for any damage caused by the manufacturing process, or components under normal operation confirmed by our maintenance service. The warranty service does not include frequently replaced consumable components, auxiliary devices, transportation fees, and door-to-door service. Please show the proof of purchase to the service personnel during maintenance.



**TECASA**  
*Stylish Kitchen Life*

TEL: 877-216-1818