



## EN ■ Robotic Vacuum Cleaner

# Robotic Vacuum Cleaner

## Important safety instructions

### READ CAREFULLY AND STORE FOR FUTURE USE.

- This robotic vacuum cleaner may be used by children 8 years of age and older and by persons with physical or mental impairments or by inexperienced persons, if they are properly supervised or have been informed about how to use this robotic vacuum cleaner in a safe manner and understand the potential dangers. Children must not play with the robotic vacuum cleaner. Cleaning and maintenance performed by the user must not be performed by unsupervised children.
- This robotic vacuum cleaner is intended for domestic use. Do not use it in rooms with high humidity, for example laundries, in industrial environments or outdoors.
- The robotic vacuum cleaner can be used for cleaning various types of hard floors and carpets with a low pile. Do not use it for vacuuming carpets with a high pile.
- When cleaning carpets, do not use the mop or the side rotary brushes.
- Do not expose the robotic vacuum cleaner to direct sunlight or use it near an open fire or appliances that are potential sources of heat.
- Only use the robotic vacuum cleaner with the original accessories that came with it.



#### **Attention:**

The battery of the robotic vacuum cleaner may only be charged using the supplied power adapter type T-ZC11.1 and charging station type T-ZC11.2.

- Only the original power adapter supplied with the robotic vacuum cleaner may be used for connecting the charging station to a power socket.
- Before connecting the power adapter to a power socket, check that the technical details on its rating label match the electrical voltage in the power socket.

- Ideally, locate the charging station against a wall so that there are no stairs or obstacles within a radius of 1.5 m, which would prevent the robotic vacuum cleaner from returning to the charging station.
- Do not tamper with the charging station when you have wet hands.
- Ensure that the robotic vacuum cleaner has the inflow filter correctly installed in the dust container before putting it into operation.
- When the robotic vacuum cleaner is in operation, the doors leading outside, on to the balcony, terrace, etc. must be closed. Clothing, paper, toys, fragile items, power cords and other cables and all other items that could be impacted or caught by the vacuum cleaner must be removed from the floor surfaces. Lift curtains and drapes that reach to the floor so that they do not get caught in the vacuum cleaner. The robotic vacuum cleaner may be used in rooms with installed in-floor power sockets only when the in-floor socket caps are closed.
- When the robotic vacuum cleaner is running, watch out for children and household pets.
- When the robotic vacuum cleaner is running, ensure that the air outlet openings are not covered and that the suction opening is not blocked.
- Do not use the robotic vacuum cleaner to vacuum the following items:
  - smouldering cigarettes, burning or flammable items, matches or ash;
  - oils, water and other liquids;
  - sharp items, e.g. splinters, needles, pins, etc.;
  - flour, wall plaster and other building materials;
  - animal excrements;
  - larger pieces of paper or plastic bags, which can easily block the suction opening.
- Before every cleaning, disconnect the charging station from the power socket and set the switch located on the underside of the robotic vacuum cleaner to position 0 (off). Do not submerge the robotic vacuum cleaner, power adapter or the charging station in water or any other liquid, do not wash it under running water and do not spray it with water.
- Do not place any items on to the robotic vacuum cleaner and do not step or sit on it. Otherwise, this could lead to its damage.
- Make sure the power adapter power cord is not touching a hot surface.
- If the power adapter power cord is damaged, it must be replaced by an authorised service technician or by a similarly qualified person, this will prevent the creation of a dangerous situation.

- If you will not be using the robotic vacuum cleaner for an extended period of time, take out the battery. Prior to removing the battery, it is necessary to check that the switch on the underside of the vacuum cleaner is set to position 0 (off).
- Never disassemble the battery pack or battery, short circuit it, or throw them into a fire.
- Do not use the robotic vacuum cleaner when it is not working correctly, if it has been damaged or has been submerged in water. To avoid a hazardous situation arising, do not repair the device yourself or modify it in any way. Have all repairs performed at an authorised service centre. Tampering with the vacuum cleaner during the warranty period may void the warranty.

**A**

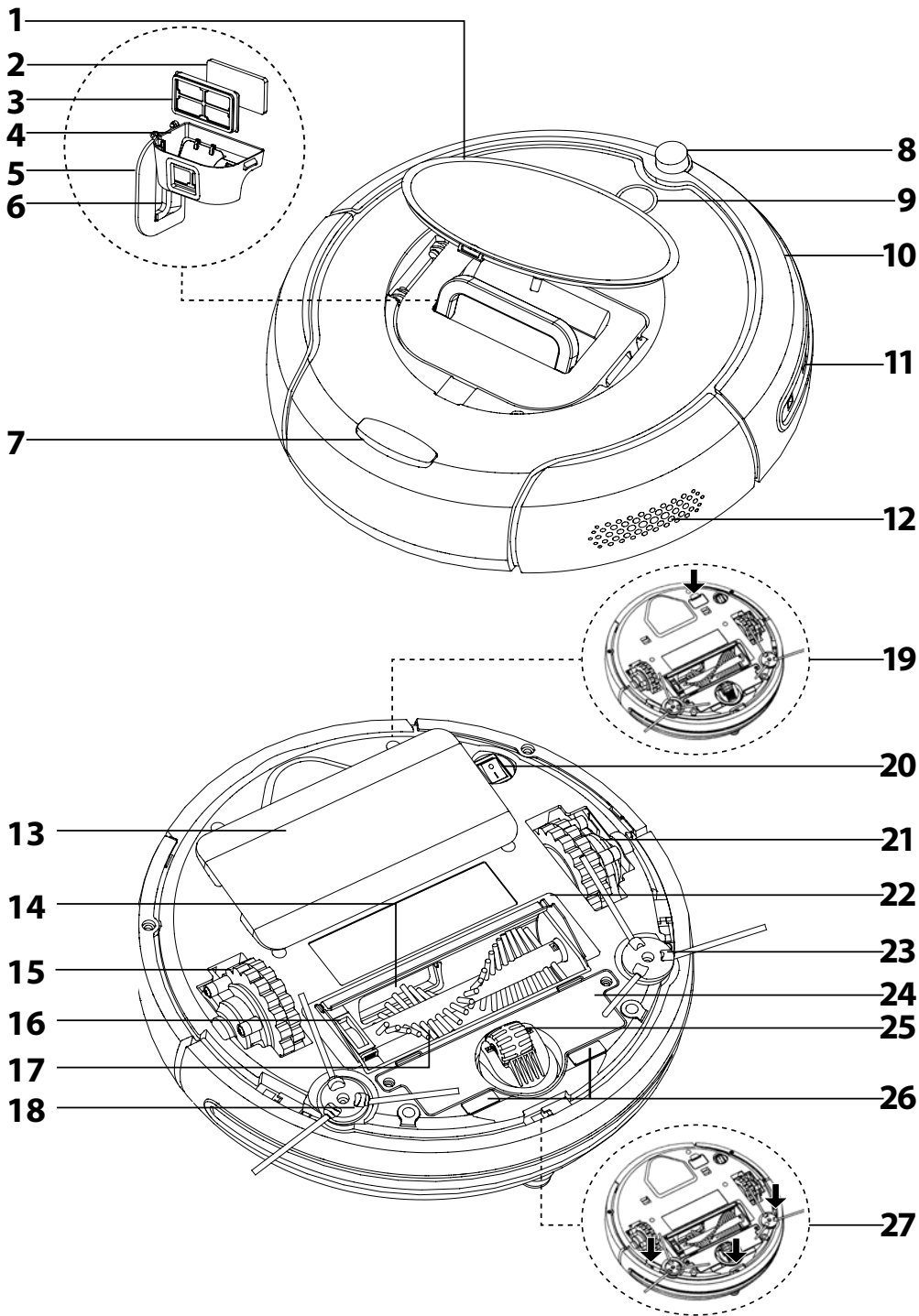

**B**



**1**

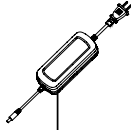

**2**

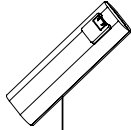

**3**



**4**

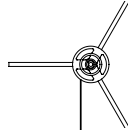

**5**



**6**

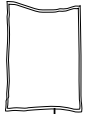

**7**



**8**



**9**



**10**

**C**

**1**

**2**

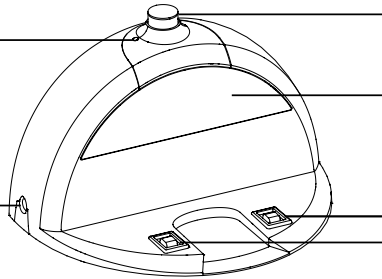

**3**

**4**

**5**

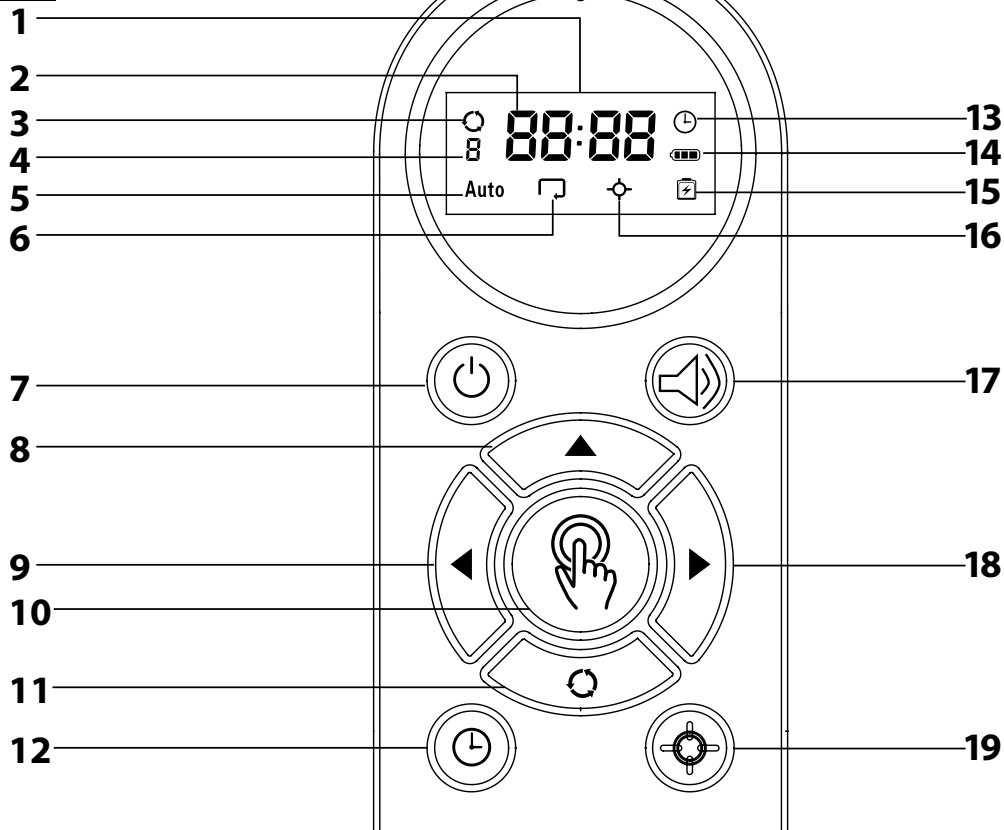
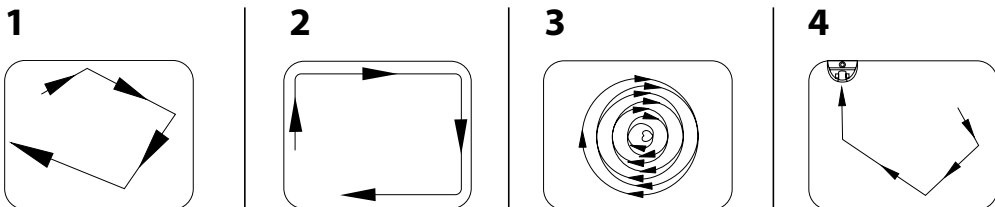
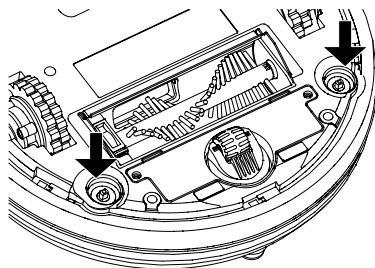
**D****E****F**

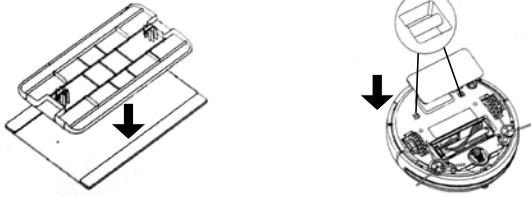
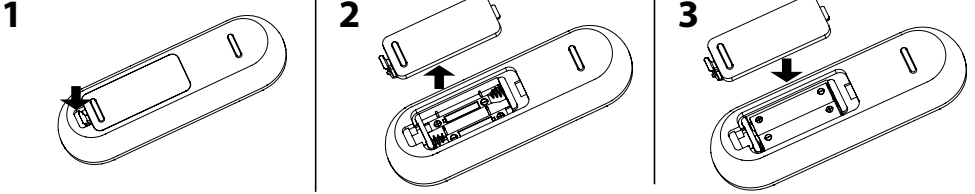
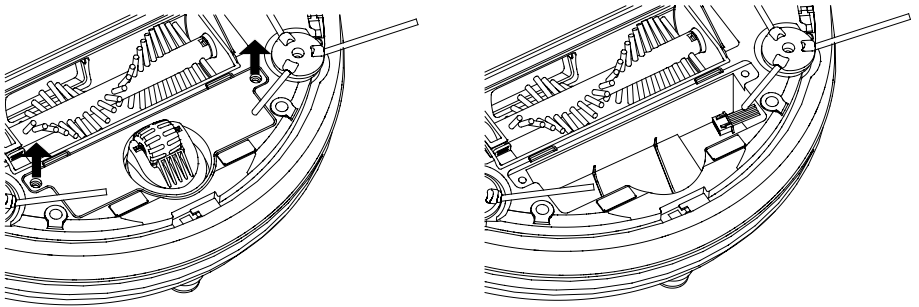
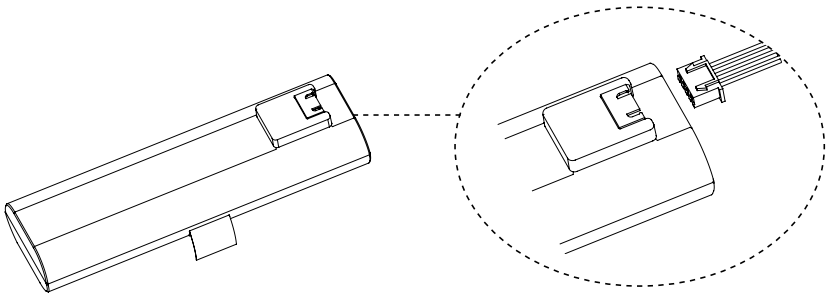
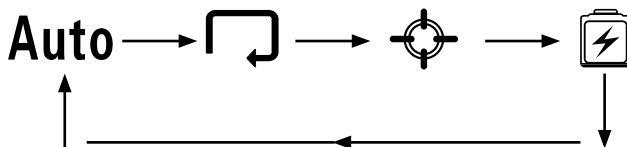
**G****H****I****J****K**

- Prior to using this appliance, please read the user's manual thoroughly, even in cases, when one has already familiarised themselves with previous use of similar types of appliances. Only use the appliance in the manner described in this user's manual. Keep this user's manual in a safe place where it can be easily retrieved for future use.
- We recommend saving the original cardboard box, packaging material, purchase receipt and responsibility statement of the vendor or warranty card for at least the duration of the legal liability for unsatisfactory performance or quality. In the event of transportation, we recommend that you pack the appliance in the original box from the manufacturer.

### DESCRIPTION OF THE ROBOTIC VACUUM CLEANER

- |   |   |
|---|---|
| <b>A1</b> Dust container compartment lid                        | <b>A16</b> Clamp for securing and releasing the central rotary brush                              |
| <b>A2</b> First inflow micro-filter                             | <b>A17</b> Removable central rotary brush   |
| <b>A3</b> Second inflow micro-filter                            | <b>A18</b> Removable side rotary brush  |
| <b>A4</b> Dust container  | <b>A19</b> Connector with cover it is intended only for service purposes.                         |
| <b>A5</b> Dust container lid                                    | <b>A20</b> 0/1 switch (off/on) serves to turn the power to the robotic vacuum cleaner on and off. |
| <b>A6</b> Dust container folding handle                         | <b>A21</b> Motorised right wheel  |
| <b>A7</b> Button for opening the dust container compartment lid | <b>A22</b> Rubber squeegee  |
| <b>A8</b> Infrared signal receiver                              | <b>A23</b> Removable side rotary brush  |
| <b>A9</b> Control button with a LED indicator                   | <b>A24</b> Battery compartment cover  |
| <b>A10</b> Bumper   | <b>A25</b> Front swivel wheel   |
| <b>A11</b> Front sensors  | <b>A26</b> Charging contacts  |
| <b>A12</b> Vents  | <b>A27</b> Bottom sensors   |
| <b>A13</b> Removable mop head                                   |   |
| <b>A14</b> Suction opening                                      |   |
| <b>A15</b> Motorised left wheel                                 |   |





### OVERVIEW OF ACCESSORIES

- |                                       |   |
|---------------------------------------|---|
| <b>B1</b> Charging station            | <b>B7</b> Textile mop sleeve                            |
| <b>B2</b> Power adapter               | <b>B8</b> Side rotary brush attachment screws (2 pcs)   |
| <b>B3</b> Rechargeable battery        | <b>B9</b> Battery type LR03/AAA (2 pcs)                 |
| <b>B4</b> Remote control              | <b>B10</b> Hex key combined with cross-head screwdriver |
| <b>B5</b> Side rotary brushes (4 pcs) |   |
| <b>B6</b> Mop head                    |   |

### DESCRIPTION OF THE CHARGING STATION

- |   |  |
|---|--|
| <b>C1</b> Indicator light signals that the charging station is connected to a power socket. | <b>C3</b> Infrared navigation signal transmitter     |
| <b>C2</b> Power adapter power cord connector socket   | <b>C4</b> Infrared anti-collision signal transmitter |
|   | <b>C5</b> Charging contacts                          |

### DESCRIPTION OF THE REMOTE CONTROL

- |  |   |
|--|---|
| <b>D1</b> LCD display  | <b>D11</b> Automatic cleaning repeat activate or deactivate setting button  |
| <b>D2</b> Time display   | <b>D12</b> Current time setting button  |
| <b>D3</b> Automatic cleaning mode repeat function setting indicator  | <b>D13</b> Planned cleaning function setting indicator  |
| <b>D4</b> Number of automatic cleaning cycles  | <b>D14</b> Battery power level indicator  |
| <b>D5</b> Automatic cleaning mode setting indicator  | <b>D15</b> Return to charging station mode and charging mode indicator  |
| <b>D6</b> Along-the-wall cleaning mode setting indicator   | <b>D16</b> Spiral cleaning mode setting indicator   |
| <b>D7</b> Button                    | <b>D17</b> Button                  |
| <b>D8</b> Forward direction button  | <b>D18</b> Right direction button  |
| <b>D9</b> Left direction button     | <b>D19</b> Planned cleaning activate or deactivate setting button   |
| <b>D10</b> Mode selection button   |   |

### FEATURES OF THE ROBOTIC VACUUM CLEANER

- The robotic vacuum cleaner can be used for cleaning various types of hard floors such as wooden or laminate floating floors, tiles, vinyl, etc. and carpets with a low pile. In the automatic cleaning mode, the vacuum cleaner effectively combines various routes to optimally clean the entire floor area.
- The suction opening **A14** is equipped with a rotary brush **A17**, which effectively removes hair, animal fur, etc. The two side rotary brushes **A18** and **A23** brush dirt out of hard-to-reach places along walls and furniture and out of corners.

- The motorised rubber wheels **A15** and **A21** protect sensitive floors against scratching and can travel over threshold strips up to a height of 1.5 cm. The infrared sensors **A11** in the front bumper **A10** prevent the robotic vacuum cleaner from colliding with obstacles. Safe operation in rooms with stairs is made possible by the bottom anti-stair-fall sensors **A27**.
- In the event that the voltage on the battery **B3** falls below a certain level, the robotic vacuum cleaner will automatically search out the charging station **B1** and dock into it to recharge before further use.
- The remote control **B4** enables comfortable control by allowing the setting of the operating mode, number of automatic cleaning cycles, cleaning time planning or for locating the vacuum cleaner via an acoustic signal.

### OVERVIEW OF THE OPERATING MODES

#### AUTOMATIC CLEANING MODE

- The robotic vacuum cleaner effectively combines various routes, see figure E1, to optimally clean the entire floor area.

#### ALONG-THE-WALLS CLEANING MODE

- The robotic vacuum cleaner travels along the perimeter of the room, see figure E2, and the motorised rotary brushes **A18** and **A23** effectively brush out dirt from the area along the walls, furniture and in corners to ensure perfect cleaning results.

#### SPIRAL CLEANING MODE

- The robotic vacuum cleaner moves in a spiral to clean a location with a higher concentration of dirt, see figure E3.

#### RETURN TO CHARGING STATION AND CHARGING MODE

- The robotic vacuum cleaner will automatically switch to the return to charging station **B1** mode whenever it detects low voltage in the battery **B3** during operation.
- In this mode the robotic vacuum cleaner automatically seeks out the route to the charging station **B1**, see figure E4, and docks itself to enable the battery **B3** to recharge. If it is unsuccessful, it will keep trying until it docks itself successfully. As soon as it docks itself successfully, the charging cycle will commence.
- Make sure that the charging station **B1** is located in accordance with the instructions provided in chapter Installation location and using the charging station. Otherwise, the vacuum cleaner may not dock successfully.

#### INSTALLING AND USING THE SIDE ROTARY BRUSHES

- Turn the vacuum cleaner upside down. Prepare the side rotary brushes **B5** (2 pcs), screws **B8** (2 pcs) and the hex key **B10**. Using the screws **B8** and the hex key **B10**, attach the rotary brushes **B5** in the locations shown in figure F. Turn the robotic vacuum cleaner back over to the operating position.
- The side rotary brushes **A18** and **A23** are intended for smooth floor surfaces and ensure effective cleaning in corners, along walls and furniture.
- When using the robotic vacuum cleaner to clean rooms with carpets, remove the side rotary brushes **A18** and **A23**. To remove them proceed in the reverse sequence.

#### ATTACHING THE MOP AND ITS USE

- Turn the vacuum cleaner upside down. Attach the textile sleeve **B7** to the mop head **B6** using the Velcro zip and attach the assembled mop to the robotic vacuum cleaner as shown in figure G. Turn the vacuum cleaner back over to the normal operating position.
- Only use the mop intended for this type of robotic vacuum cleaner. Do not use the mop head **B6** without the textile sleeve **B7**.
- The mop is only an auxiliary function to the robotic vacuum cleaner and is intended for cleaning smooth hard floor areas. The dry mop can be used for wiping dust off the floor. A dampened mop may be used for wiping floors.
- The mop is not intended for cleaning carpets. The mop is removed in the reverse sequence.

#### INSERTING AND REPLACING BATTERIES IN THE REMOTE CONTROL

- Release the tab in the bottom part of the removable battery compartment cover and remove the cover, see figure H1 and H2.
- Insert two type LR03/AAA (2x 1.5 V) batteries **B9** into the remote control **B4**. When inserting the batteries ensure the correct polarity as shown inside the battery compartment. Close the cover, see figure H3.
- In the event that the batteries are flat, replace them with new ones. Do not combine various types of batteries or new and old batteries.
- The signal range of the remote control **B4** is approximately 6 m.

## INSERTING AND REMOVING RECHARGEABLE BATTERY

- Before first use, it is necessary to install the included Li-Ion battery **B3** (14,4 V=, 2850 mAh) into the robotic vacuum cleaner. Use only the original battery type.
- Turn the vacuum cleaner upside down. Check that switch **A20** is set to position 0 (off). Screw out the screws from the cover **A24** and remove the cover **A24**, see figure I.
- Connect the connector located in the battery compartment to the battery **B3**, see figure J. The battery **B3** can be connected in only one direction. Put the battery **B3** into the battery compartment and close the battery compartment with the cover **A24**. In the front part of the cover **A24** there are tabs that must first slide into the grooves in the battery compartment, and only then is it possible to close the cover **A24** and attach it by screwing in the screws. After attaching the cover **A24**, turn the robotic vacuum cleaner back over to the operating position.
- Remove the battery **B3** in reverse sequence. Before removing the battery **B3**, check that switch **A20** is set to position 0 (off).
- When the robotic vacuum cleaner will not be used for an extended period of time, take out the battery **B3** and store it in a dry, clean and cool place out of children's reach.

## LOCATION AND USE OF THE CHARGING STATION

- Locate the charging station **B1** against a wall on a hard, even and dry surface within reach of a power socket. Make sure that there are no stairs or obstacles within a range of 1.5 m, that would prevent the robotic vacuum cleaner from finding the charging station **B1** and docking successfully.
- Insert the power adapter cable connector into socket **C2** of the charging station **B1**, and insert the power cord plug into a power socket.
- After connecting to a power socket, the indicator light **C1** will be lit indicating the connection of the charging station **B1** to a power source.
- When the robotic vacuum cleaner detects low voltage of the battery **B3** during operation, it will automatically start to search out the charging station **B1**. In order for the robotic vacuum cleaner to find the charging station **B1** and to dock into it, it needs to locate the infrared signal transmitted by the charging station **B1**. For this reason, we recommend leaving the charging station **B1** permanently connected to a power source. When the robotic vacuum cleaner docks inside the charging station **B1**, the charging cycle will commence and the charging station **B1** will stop transmitting the infrared signal.
- In the event that the robotic vacuum cleaner is not used for an extended period of time, disconnect the charging station **B1** from the power socket and store it in a dry, clean and cool place.

## CHARGING RECHARGEABLE BATTERY

- To charge the battery **B3**, it is necessary to dock the robotic vacuum cleaner into the charging station **B1**. You may do this manually or allow the robotic vacuum cleaner to dock automatically.
- Make sure that the charging station **B1** is connected to a power socket. This is signalled by indicator light **C1** being lit. Set the switch **A20** on the underside of the robotic vacuum cleaner to position I (on).
- For manual docking, put the robotic vacuum cleaner into the charging station **B1** so that the charging contacts **A26** on the underside of the robotic vacuum cleaner connect with the charging contacts **C5** on the charging station **B1**. When the contacts are connected, the charging process will start. The control button LED indicator light **A9** will slowly flash red.
- For automatic docking into the charging station **B1**, set the return to charging station mode using button **D10** on the remote control **B4**. When the signal from the remote control **B4** is received, the robotic vacuum cleaner will emit an acoustic signal and commence to automatically seek out the charging station **B1**.
- Likewise, the robotic vacuum cleaner will start seeking out the charging station **B1** when the voltage on the battery **B3** falls below a certain level.
- When the vacuum cleaner returns to the charging station **B1**, the control button LED indicator **A9** will be lit red. The navigation and anti-collision infrared signals transmitted by the charging station **B1** are used for the navigation and successful docking of the robotic vacuum cleaner.
- When the robotic vacuum cleaner finds the charging station **B1** and manages to dock, the charging process will commence. The transmitter of the navigation and anti-collision infrared signal **C3** and **C4** will stop transmitting the signal. The control button LED indicator light **A9** will slowly flash red.
- When the battery **B3** is fully charged, the charging process will stop automatically. The control button LED indicator light **A9** will slowly flash green.
- A complete charge takes approximately 3 to 5 hours. The actual charging time depends on the power level of the battery **B3**. A fully charged battery **B3** will provide up to 80 minutes of operation. Allow the battery **B3** to fully charge before first use.
- In the event that the charging contacts are disconnected during the charging cycle, the robotic vacuum cleaner will move away from the charging station **B1** and then redock itself to resume the charging process, unless it is prevented from doing so by an obstacle.
- In the event of a power outage, the charging cycle will be interrupted and will continue after the power supply is renewed.

- In the event that the maximum charging current is exceeded, the charging station **B1** will automatically interrupt the charging cycle.
- A fault on the charging station **B1** is signalled by a quickly flashing indicator light **C1**.

## RECHARGEABLE BATTERY CARE

- We recommend that you do not interrupt the charging cycle and to maintain the battery **B3** in a charged state.
- Do not leave the robotic vacuum cleaner standing fully charged or completely flat for an unnecessarily long period of time.
- A battery that is allowed to remain flat for a long time may self-discharge below a permissible level and thereby cause irreparable damage to itself.

## TURNING THE ROBOTIC VACUUM CLEANER ON AND OFF

- Turn on the power supply to the robotic vacuum cleaner by setting switch **A10** to position I (on). In the event that the vacuum cleaner is located away from the charging station **B1**, when switch **A20** is set to position I (on), it will switch to the stand-by mode. In the event that the vacuum cleaner is docked in the charging station **B1**, when switch **A20** is set to position I (on), the charging process will start automatically.
- Turn off the power supply to the robotic vacuum cleaner by setting switch **A20** to position 0 (off). The control button LED indicator light **A9** will turn off. When the vacuum cleaner is turned off, it is not possible to control it using the control button **A9** or the remote control **B4**.

## STAND-BY MODE AND SLEEP MODE

- In the stand-by mode, the control button LED indicator **A9** is lit green. After one minute of inactivity, an acoustic signal is emitted and the robotic vacuum cleaner automatically switches to sleep mode.
- In the sleep mode, the control button LED indicator **A9** quickly flashes green in 5-second intervals. To wake the robotic vacuum cleaner from the sleep mode into the stand-by mode, press control button **A9** once. A sound is made and the control button LED indicator **A9** will be lit green.

## USING THE CONTROL BUTTON

- The control button **A9** serves to wake up the robotic vacuum cleaner from sleep mode, to put the robotic vacuum cleaner into the automatic cleaning mode and to stop its operation.
- To wake the robotic vacuum cleaner from the sleep mode into the stand-by mode, press control button **A9** once. Waking up from the sleep mode is confirmed by an acoustic signal.
- To put the robotic vacuum cleaner into operation from the stand-by mode or from the charging mode, press the control button **A9** once. The robotic vacuum cleaner will start automatic cleaning.
- To stop operation, press the control button **A9** once. An acoustic signal will be emitted and the robotic vacuum cleaner will switch to the stand-by mode. After one minute of inactivity, an acoustic signal is emitted again and the robotic vacuum cleaner automatically switches to sleep mode.

## USING THE REMOTE CONTROL

- The signal range of the remote control **B4** is 6 m. If the vacuum cleaner is located outside the signal range, it will not be transmitted.

## BUTTON

- Button **D7** serves to put the robotic vacuum cleaner into the automatic cleaning mode and to stop its operation.
- To put the robotic vacuum cleaner into operation, press button **D7** once. The robotic vacuum cleaner will switch to the automatic cleaning mode.
- To stop operation, press button **D7** once. An acoustic signal will be emitted and the robotic vacuum cleaner will switch to the stand-by mode. After one minute of inactivity, an acoustic signal is emitted again and the robotic vacuum cleaner automatically switches to sleep mode.

## BUTTON

- When button **D17** is pressed, the robotic vacuum cleaner will emit an acoustic signal. This function can be utilised when, for example, you need to find out in which room the vacuum cleaner is currently located. When button **D17** is released, the robotic vacuum cleaner will stop emitting the acoustic signal.

## MODE SELECTION BUTTON

- Button **D10** serves to set the automatic cleaning mode, along-the-wall cleaning mode, spiral cleaning mode or return back to the charging station and charge mode.
- When the robotic vacuum cleaner is in the stand-by mode, sleep mode or charging, press button **D10** to automatically start the automatic cleaning mode. Repeatedly press button **D10** to switch between the individual operating modes in the order shown in figure K. The mode setting is indicated by the respective indicator on display **D1** on the remote control **B4**.

- In the automatic cleaning mode, along-the-wall cleaning mode and spiral charging mode, the control button LED indicator **A9** is lit green. In the return to charging station mode, the control button LED indicator **A9** will be lit red.

#### DIRECTION BUTTONS ▲ ◀ ▶

- The direction buttons **D8**, **D9** and **D18** can be used to manually control the movement of the robotic vacuum cleaner on the floor. When the vacuum cleaner is moved on the floor, the operation of the motorised side rotary brushes **A18** and **A23** is synchronised with the movement of the motorised wheels **A15** and **A21**. The vacuuming function is disabled.
- When the direction button **D8** is pressed, the robotic vacuum cleaner will move forward. For continuous movement forward, hold down button **D8**. When button **D8** is released, the vacuum cleaner will stop moving.
- When direction button **D9** is pressed, the vacuum cleaner will turn anticlockwise. To continuously turn the vacuum cleaner, hold down button **D9**. When button **D9** is released, the vacuum cleaner will stop moving.
- When direction button **D18** is pressed, the vacuum cleaner will turn clockwise. To continuously turn the vacuum cleaner, hold down button **D18**. When button **D18** is released, the vacuum cleaner will stop moving.
- If the robotic vacuum cleaner is docked in the charging station **B1**, when any direction button is pressed the robotic vacuum cleaner will move approximately 80 cm from the charging station **B1**, turn around by 180° and switch to the stand-by mode. Press a direction button again to control the direction of movement.
- If the robotic vacuum cleaner is in a cleaning mode or returning to the charging station, when any direction button is pressed the vacuum cleaner will stop and switch to the stand-by mode. Press a direction button again to control the direction of movement.
- In the manual movement control mode, the robotic vacuum cleaner moves according to the direction buttons and sensors **A11** and **A27** prevent collisions with obstacles and falling from stairs.

#### SETTING AND CANCELLING REPETITION OF THE AUTOMATIC CLEANING MODE

- This function enables the setting of repetition for the automatic cleaning mode or to cancel it. The robotic vacuum cleaner will automatically perform the set number of cleaning cycles. At the end of each cleaning cycle, it will automatically return to the charging station to recharge the battery **B3** and the next cleaning cycle will always commence when the charging cycle has finished. When a cleaning cycle starts, the number of repetitions will always be lowered by one cycle.
- Hold down button **B11** to switch to the mode for setting the number of automatic cleaning cycles. Indicator **D3** will start flashing and the number of cleaning cycles will be shown on display **D1**. The default setting is 0 cleaning cycles. A maximum of 3 repetitions may be set. In the event that the automatic cleaning mode repetition mode function is already set, then the number of remaining cycles will be shown on display **D1**. Select the number of repetitions using buttons **D9** (+) and **D18** (-). Hold down button **D11** to save the setting. The saving of your setting is confirmed by an acoustic signal.



#### Note:

The mode for setting the number of cleaning cycles will automatically be cancelled and display **D1** will switch to the time display mode if no changes are made within 10 seconds. The previously saved setting will remain in memory.

- If the robotic vacuum cleaner is parked in the charging station **B1** and the charging cycle is finished, the robotic vacuum cleaner will immediately commence the automatic cleaning cycle and the number of repetitions will be reduced by one cycle. If the robotic vacuum cleaner is in the charging mode, the charging cycle will first finish and only then will the vacuum cleaner start the automatic cleaning cycle.
- If the robotic vacuum cleaner is not docked in the charging station **B1** and is switched to the stand-by mode or sleep mode, it is necessary to start the first cleaning cycle manually. This automatically lowers the number of repetitions by one cycle. In the event that the operation of the robotic vacuum cleaner is interrupted and then started again, the number of cycles will, likewise, be lowered by one cycle.
- When the robotic vacuum cleaner is in the automatic cleaning mode, it will complete it first and return to the charging station **B1**. When the charging cycle is complete, the robotic vacuum cleaner will start the automatic cleaning cycle and the number of repetitions will be reduced by one cycle.
- The repetition of automatic cleaning mode function is cancelled by pressing button **D8** once in the repetition setting mode. Indicator **D3** and the number of repetitions will turn off. The robotic vacuum cleaner will emit a confirmation acoustic signal. The function can also be cancelled by setting the number of repetitions to 0 cycles or by turning the vacuum cleaner off and on using switch **A20**.

#### SETTING THE CURRENT TIME

- Hold down button **D12** to switch to the time setting mode. The minutes will start flashing on display **D1**. Use the direction buttons **D9** (+) and **D18** (-) to set the minutes. Hold down the button to speed up the setting process.
- Press button **D12** to switch to the hour setting mode. The hours will start flashing on display **D1**. Use the direction buttons **D9** (+) and **D18** (-) to set the hours. Hold down the button to speed up the setting process.
- Hold down button **D12** to save the current setting. The robotic vacuum cleaner will confirm the setting by an acoustic signal.
- The current time setting mode will automatically be cancelled and display **D1** will switch to the time display mode if no changes are made within 10 seconds. The setting will not be stored in memory.

#### SETTING AND CANCELLING THE PLANNED CLEANING FUNCTION

- This function is used to set a time in advance, when the robotic vacuum cleaner is to start automatic cleaning.
- Hold down button **D19** to switch to the time setting mode for planned cleaning. Indicator **D13** will be lit and the minutes will be shown on display **D1**. Use the direction buttons **D9** (+) and **D18** (-) to set the minutes. Hold down the button to speed up the setting process.
- Press button **D19** to switch to the hour setting mode. The hours will start flashing on display **D1**. Use the direction buttons **D9** (+) and **D18** (-) to set the hours. Hold down the button to speed up the setting process.
- Hold down button **D19** to save the setting. The robotic vacuum cleaner will confirm the setting by an acoustic signal. Display **D1** will switch to the current time display mode. After another 30 seconds the remote control **B4** will switch to sleep mode.
- Press button **D19** to wake up the remote control **B4** from the sleep mode. Press button **D19** again to show the time of the planned cleaning. After 5 seconds the display **D1** will switch back to the current time display mode. If the planned cleaning function is not set, then in the display planned cleaning mode, display **D1** will show “-:-:-”.



#### Note:

The planned cleaning time mode will automatically be cancelled and display **D1** will switch to the time display mode if no changes are made within 10 seconds. The initial setting will remain saved in memory.

- This function enables the setting of only a single planned cleaning time. When the automatic cleaning at a planned time is started, the function is reset and for another planned cleaning it is necessary to set this function again.
- In the event that at the time of the planned cleaning, the robotic vacuum cleaner is in the cleaning mode or returning to the charging station **B1**, the planned cleaning will only take place next time at the planned cleaning time when the robotic vacuum cleaner is not in operation.
- The planned cleaning function and repetition of automatic cleaning can be set simultaneously. When the robotic vacuum cleaner starts automatic cleaning at a planned time, the number of repetitions will be reduced by one cycle.
- The planned cleaning function is cancelled by pressing button **D8** once in the planned cleaning time setting mode. This is confirmed by an acoustic signal. The previous time setting will remain stored in memory. Likewise, turning the power supply to the vacuum cleaner on and off using switch **A20** will cancel the function. In the event that batteries are removed from the remote control **B4** or they go flat, the planned cleaning function and time setting will be reset.

#### SLEEP MODE AND WAKING FROM SLEEP MODE

- The remote control **B4** will automatically switch to sleep mode after 30 seconds of inactivity. In this mode, only the time is shown on the display **D1**.
- Press any button to wake up the remote control **B4** from the sleep mode. The display **D1** will show other information such as the operating mode indicator, battery level, planned cleaning function indicator **D13** and the repeated automatic cleaning function **D3**, if set. For the display **D1** to show the correct information, the robotic vacuum cleaner must be within signal range of the remote control.

#### TROUBLESHOOTING

- The robotic vacuum cleaner is itself able to identify problems and report them via a warning acoustic signal. If this happens, the vacuum cleaner will stop and when one of the control buttons on the display **D1** of the remote control **B4** is pressed, it will show the error message code. In the case of control buttons **D11**, **D12** and **D19**, the error message code is shown only when the button is used to confirm a setting.
- The table below will help you identify the cause and to remedy the problem. Once the problem is resolved, you may put the vacuum cleaner back into operation.

ERROR MESSAGE CODE	CAUSE	SOLUTION
C01	Wheels are not in contact with the floor.	Place the vacuum cleaner on the floor so that both wheels are in contact with the floor.
C03	The bottom front sensor is soiled (dust, dirt, etc.)	Set switch <b>A20</b> to position 0 (off) and clean the sensor using a clean and dry wiping cloth.
C04	The bottom left sensor is soiled (dust, dirt, etc.)	Set switch <b>A20</b> to position 0 (off) and clean the sensor using a clean and dry wiping cloth.
C05	The bottom right sensor is soiled (dust, dirt, etc.)	Set switch <b>A20</b> to position 0 (off) and clean the sensor using a clean and dry wiping cloth.
C06	The motor of the vacuum cleaner is not working.	Set switch <b>A20</b> to position 0 (off). To resolve the malfunction, please contact an authorised service centre.
C07	Foreign items (cables, parts of clothing, etc.) have wound themselves on to the front left brush <b>A18</b> .	Set switch <b>A20</b> to position 0 (off) and remove the items that are blocking brush <b>A18</b> .
C08	Foreign items (cables, parts of clothing, etc.) have wound themselves on to the front right brush <b>A23</b> .	Set switch <b>A20</b> to position 0 (off) and remove the items that are blocking brush <b>A23</b> .
C09	Foreign items (cables, parts of clothing, etc.) have wound themselves on to the left wheel <b>A15</b> .	Set switch <b>A20</b> to position 0 (off) and remove the items that are blocking the wheel <b>A15</b> .
C10	Foreign items (cables, parts of clothing, etc.) have wound themselves on to the right wheel <b>A21</b> .	Set switch <b>A20</b> to position 0 (off) and remove the items that are blocking the wheel <b>A21</b> .
C12	The temperature of the battery <b>B3</b> is too high.	Set switch <b>A20</b> to position 0 (off) and before using the robotic vacuum cleaner again, allow the battery <b>B3</b> to cool down.
C13	The voltage of the battery <b>B3</b> is too low.	The battery <b>B3</b> needs to be charged. Place the robotic vacuum cleaner manually into the charging station <b>B1</b> . Make sure that there is a connection between the charging contacts.
C16 and C17	Error on the right or left part of the bumper <b>A10</b> .	Set switch <b>A20</b> to position 0 (off). Release the jammed part of the bumper <b>A10</b> .
C18	The robotic vacuum cleaner is tangled.	Move it to open space.
C19	Error of battery <b>B3</b> .	Replace the old battery <b>B3</b> with a new one.
C21, C22 and C23	Error of anti-collision sensor located in the front bumper <b>A10</b> (on the left, in the middle or on the right)	Set switch <b>A20</b> to position 0 (off) and using a clean and dry wiping cloth, clean the entire window of the front bumper <b>A10</b> .

- In the event that the robotic vacuum cleaner stops and you are unable to put it back into operation, try turning switch **A20** off and then on again. If the problem persists, please contact an authorised service centre.

## CLEANING AND MAINTENANCE

- Prior to cleaning, turn off the robotic vacuum cleaner by setting switch **A20** to position 0 (off) and disconnect the charging station **B1** from the power socket.
- Empty the dust container **A4** after each use. Press button **A7** to open the lid **A1** and remove the dust container **A4**. Release the clip on the dust container **A4** and open the lid **A5**. Remove the dirt from the dust container **A4**. For hygiene reasons, we recommend doing this away from living areas. Properly close the lid **A5**. A click indicates that the lid **A5** is closed. Put the dust container **A4** back in its place and close the lid **A1**.
- Remove and clean the mop after every use. Wash the textile sleeve **B7** by hand in lukewarm water with the addition of a small amount of gentle washing powder and allow it to dry naturally. Wipe the mop head **B6** using lightly dampened cloth and then wipe it thoroughly dry.
- Clean the inflow filters **A2** and **A3** once per week. After emptying out the dust container **A4**, remove the frame with the filters **A2** and **A3**. Take filter **A2** out of the frame and then tap out both filters **A2** and **A3** away from living areas. In the event of greater soiling, you may wash the filters **A2** and **A3** under running lukewarm water. After washing them, allow the filters **A2** and **A3** to dry naturally. Put the cleaned filters **A2** and **A3** back in their place. Before putting the filters **A2** and **A3** back in their place, make sure that they are completely dry. For hygiene reasons, we recommend that filters **A2** and **A3** are replaced every three months.



### Attention:

To prevent damaging the vacuum cleaner, make sure that both inflow filters **A2** and **A3** are properly installed in their place.

- At least once per week or more frequently, clean the front swivel wheel **A25**, motorised wheels **A15** and **A21**, central rotary brush **A17**, suction opening **A14**, rubber squeegee **A22**, side rotary brushes **A18** and **A23**, charging contacts **A26**, sensors **A11** and **A27** and charging station **B1**. First remove any coarser dirt from the swivel wheel **A25** and the motorised wheels **A15** and **A21**. Then clean them around their entire perimeter using a lightly dampened cloth and wipe them dry. Do not forget to also clean the area around the wheels. Release and remove the clamp of the central rotary brush **A16** and take out the rotary brush **A17**. Use a dry wiping cloth to clean out the suction opening **A14**, rubber squeegee **A22** and the area in which the rotary brush **A17** is housed. Remove any dirt and material (wound on hair, animal fur, etc.) from the rotary brush **A17**. Insert it back in its place and secure it using the clamp **A16**. Remove the side rotary brushes **A18** and **A23**. Remove any dirt and material from the rotary brushes **A18** and **A23** and from the area where they were attached. After cleaning them, reattach them. If they are worn out, replace them with a new ones. Wipe the sensors **A11** located on the bumper **A10**, sensors **A27** on the underside of the vacuum cleaner, the surface of the charging station **B1** including the charging contacts **C5** using a soft dry wiping cloth.
- Regularly wipe the remaining surfaces of the robotic vacuum cleaner using a soft dry wiping cloth.
- For cleaning, never use abrasive cleaning products, solvents, etc.
- Neglecting cleaning and maintenance may negatively affect the functioning of the vacuum cleaner and lead to its reduced performance.

## TECHNICAL SPECIFICATIONS

### POWER ADAPTER

Type..... T-ZC11.1  
 Input .....100–240 V~, 50/60 Hz, 0.3 A  
 Output ..... 18 V  $\Rightarrow$ , 0.8 A  
 Protection class..... II

### CHARGING STATION

Type..... T-ZC11.2  
 Input ..... 18 V  $\Rightarrow$ , 0.8 A  
 Output ..... 18 V  $\Rightarrow$ , 0.8 A

### ROBOTIC VACUUM CLEANER

Power input .....40 W  
 Battery .....Li-Ion / 14.4 V  $\Rightarrow$ / 2,850 mAh  
 Charging time.....3–5 h  
 Maximum operating time with fully charged battery .....80 minutes  
 Dust container capacity.....230 ml  
 Noise level.....74 dB(A)

The declared noise emission level is 74 dB(A), which represents a level A of sound power with respect to a reference sound power of 1 pW.

### Explanation of technical terminology

Safety class for electrical shock protection:

Class II – Electrical shock protection is provided by double or heavy-duty insulation.

We reserve the right to change text and technical specifications.

## DISPOSAL OF USED BATTERIES

Batteries contain environmentally damaging substances and therefore do not belong in standard household waste. Hand it over for proper disposal at respective collection locations.



## INSTRUCTIONS AND INFORMATION REGARDING THE DISPOSAL OF USED PACKAGING MATERIALS

Dispose of used packaging material at a site designated for waste in your municipality.

## DISPOSAL OF USED ELECTRICAL AND ELECTRONIC EQUIPMENT

This symbol on products or original documents means that used electric or electronic products must not be added to ordinary municipal waste. For proper disposal, renewal and recycling hand over these appliances to determined collection points. Alternatively, in some European Union states or other European countries you may return your appliances to the local retailer when buying an equivalent new appliance.



Correct disposal of this product helps save valuable natural resources and prevents potential negative effects on the environment and human health, which could result from improper waste disposal. Ask your local authorities or collection facility for more details.

In accordance with national regulations penalties may be imposed for the incorrect disposal of this type of waste.

### For business entities in European Union states

If you want to dispose of electric or electronic appliances, ask your retailer or supplier for the necessary information.

### Disposal in other countries outside the European Union.

This symbol is valid in the European Union. If you wish to dispose of this product, request the necessary information about the correct disposal method from the local council or from your retailer.



This product meets all the basic requirements of EU directives related to it.