

## Operating Instructions

Welcome! Digital Calendar Frame –Your Family Schedule Assistant!  
Just 4 steps to connect your phone to your digital calendar frame. Let's get started.

### STEP1: Plug in the Frame

Unbox the frame. Have the frame connected to an AC outlet. The calendar frame will power on.

### STEP2: Select Language, Connect to WiFi, Choose City

1. Select the language after power on.
2. Connect to Wi-Fi in the Wi-Fi settings.
3. Select the time zone and adjust the time zone if necessary.

### STEP3: Download the 'Whale Framely' App

1. Get Your Activation Code  
Download the 'Whale Framely' app by scanning the QR code or search for "Whale Framely" in the App Store (iOS) or Google Play (Android) to download.



2. Create an App Account and fill in all the required information.

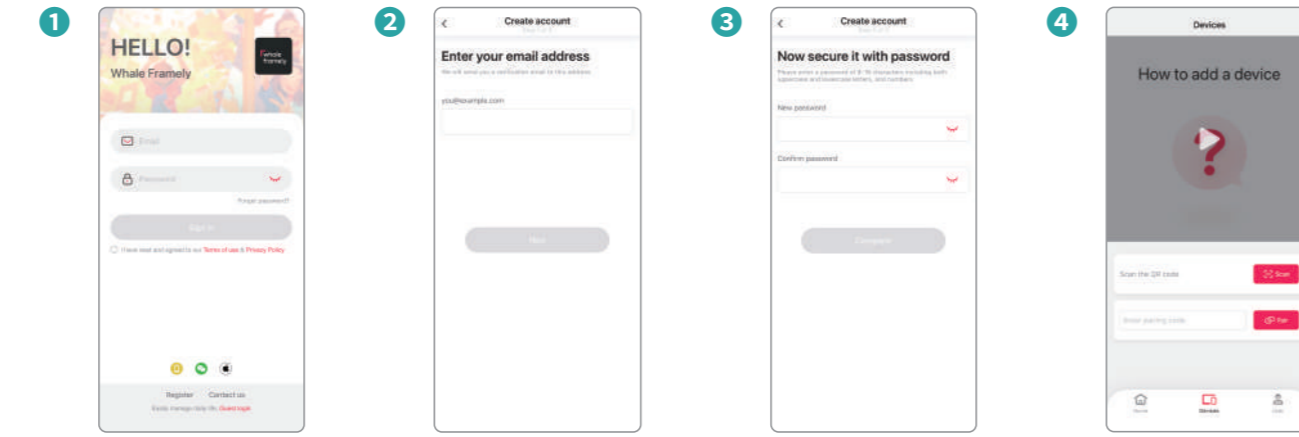

STEP4: Scan the QR Code on the Calendar Frame to Start

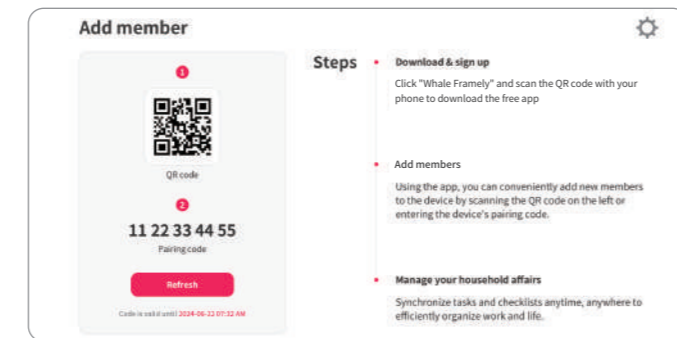

## Version update

- For first-time use, please make sure your calendar version is the latest by following the path below:
- Settings → More → Upgrade → click "Check for new version".
- If "No new version" is displayed, your device is already the latest version.

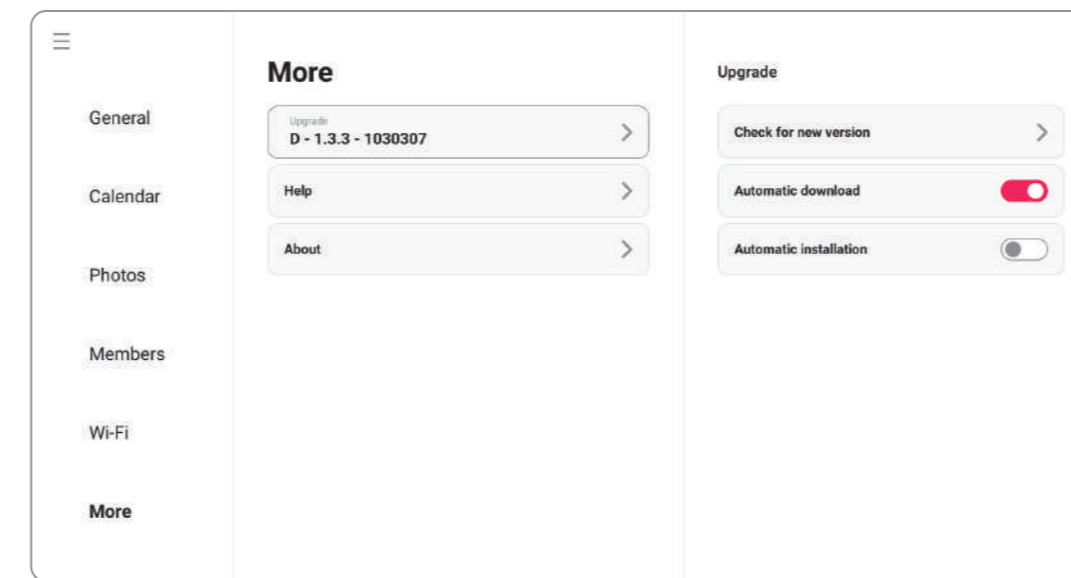

## Members

You can create accounts for your family members to manage daily schedules together.

**Add member:** For people without their own devices.  
**Invite new members:** For people with their own devices.

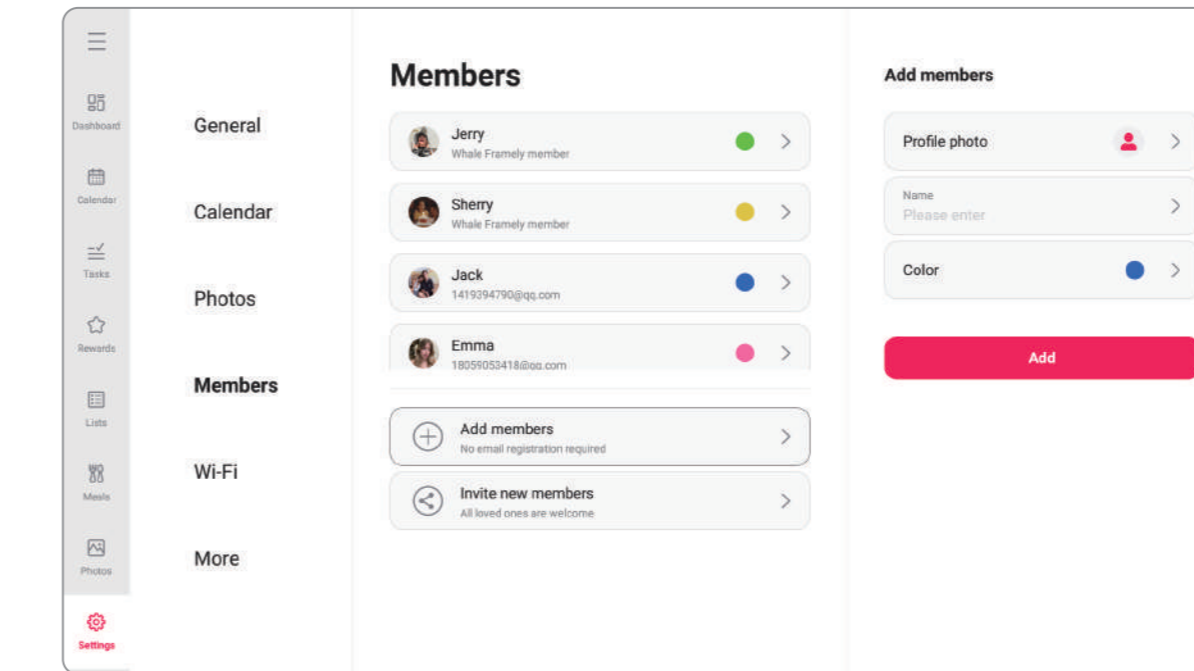

If you have any problem about the digital calendar, please feel free to contact us:  
US: afterserviceUS@airzeen.com UK: afterserviceUK@airzeen.com



Please scan the QR code to access the detailed user manual

Ver.1.4

## Create Rewards

Rewards is a feature that helps motivate kids by making their progress toward goals visible and trackable.

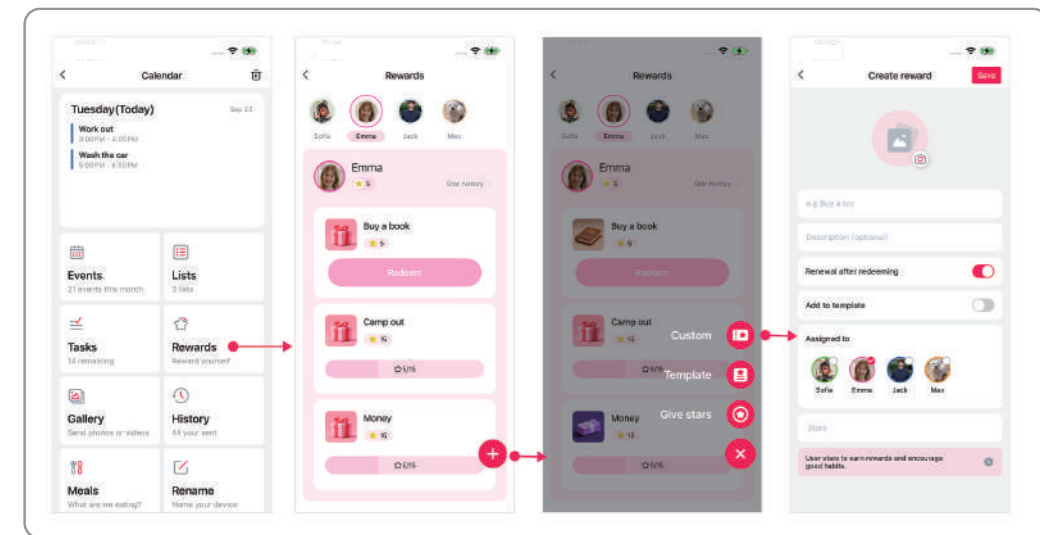

- 1) Members will earn points after completing tasks in the task section. These points will be auto matically synced to the member's rewards section.
- 2) When you have collected enough stars, you can redeem our pre-agreed rewards with them! Rewards can be items or special experience.

**Note:** Rewards are created by parents on the mobile app, and children can view their rewards and progress on the device.

## How to Sync an External Calendar with Your Account

Before syncing the external calendar, ensure your calendar device is paired with the Whale Framely app. Sync operations can only be completed through the app. See the following picture:

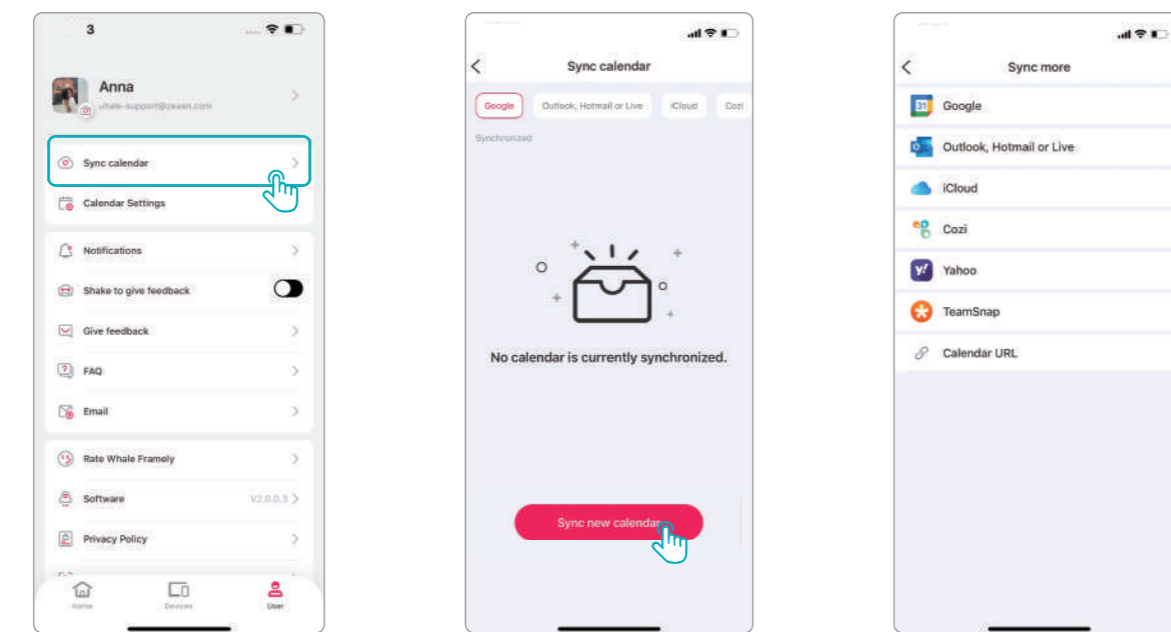

**Note:** When you sync your external calendar (such as Google, iCloud, etc.) with Whale Framely, any changes made to the source calendar will be automatically updated in the Whale Framely calendar.

## Important Notes for Calendar Sync

1. Google Calendar and Outlook Calendar support two-way sync (changes update in both directions). For other calendars (e.g., iCloud, Cozi, etc.), the sync is one-way (from the calendar to the app).
2. iCloud Sync: If you can't find the "Share Link" option as prompted by the app, make sure calendar permissions are enabled in your iCloud settings. Follow these steps:
  - (1) Settings > Your Name > iCloud.
  - (2) Tap "See All" (or "Show All"), then select iCloud Calendar.
  - (3) Turn use on this iPhone on.

**Note:** Screenshots provided are for reference only. The exact layout and options may vary slightly depending on your operating system version, so some features might be located in different places.

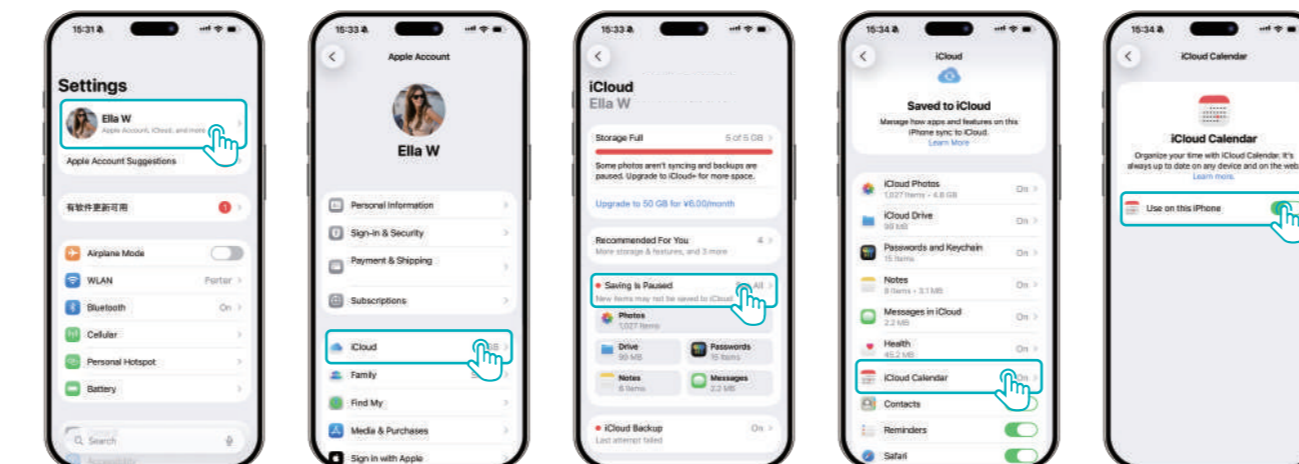

## Settings

**Sleep Mode** < Settings - General - Sleep Mode >

Offers a sleep mode, in which the screen turns off to reduce power consumption. The default setting turns off the screen at 20:00 and turns it back on at 08:00. To change this, simply set the start/end time for sleep mode.

**Time Zone** < Settings - General - Time Zone >

Set the time zone used on the calendar.

**Account Protection** < Settings - Calendar - Account Protection >

The Account Protection feature safeguards family accounts, preventing accidental deletion by children.

## Troubleshooting Guide

### 1. Unable to sync calendar or photos

- **Check network connection:** Make sure the device is networked and maintains a stable network connection.
- **Check the login account:** Ensure that the device login account is the same as the synchronization account.
- **Update the app:** Make sure you are using the latest version of the app.
- **Check the login account:** Ensure that the device login account is the same as the synchronization account.
- **Regrant synchronization permissions:** Check and regrant synchronization permissions in Settings.

### 2. How can I ensure that Google Calendar events sync to Airzeen Calendar?

- **Android Devices:** After creating a new event in the Google Calendar app, you need to manually tap the "Refresh" button in the sidebar to sync the event to the Airzeen Calendar.
- **iPhone:** Events created on an iPhone are automatically synced to the Airzeen Calendar without additional actions.

### 3. Does it support syncing events from third-party calendars to Airzeen Calendar?

Google Calendar and Outlook Calendar support bidirectional syncing with Airzeen Calendar, allowing events from Airzeen Calendar to be synced to Google Calendar and Outlook Calendar, and vice versa. Other calendars only support one-way syncing, meaning they only support syncing events from third-party calendars to Airzeen Calendar.

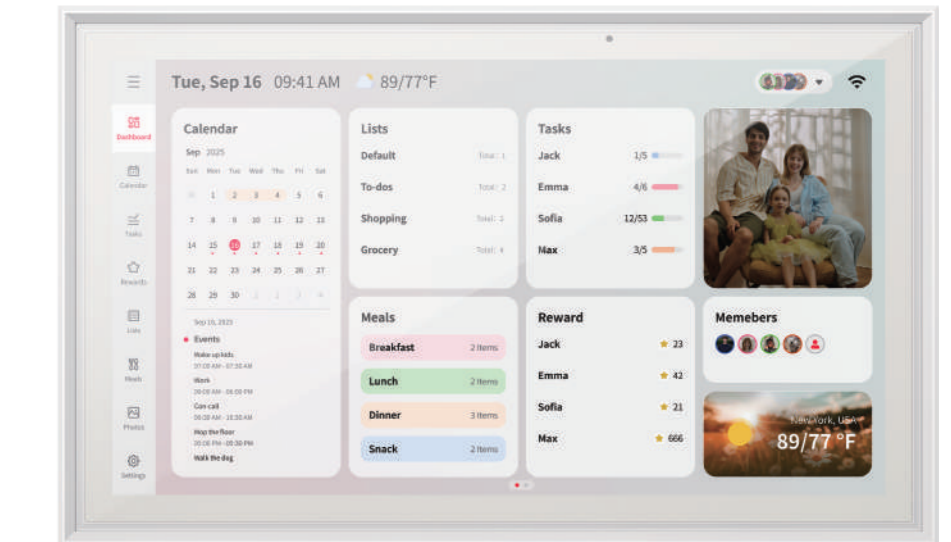

# QUICK START GUIDE

Smart Digital Calendar for Family Schedules

