

**Garage Door Controller**

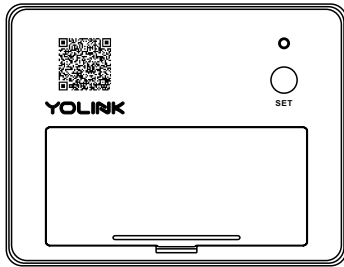

**Garage Door Sensor 2**

**YOLINK**

## **Garage Door Kit 3**

YS4906-UC\_YS7706-UC  
Installation & User Guide

Rev 1.0

# Contents

In the Box .....	1
Important Notice .....	2
Introduction .....	3
Set Up .....	5
Installation .....	8
Using the YoLink App .....	19
About YoLink Control .....	29
Maintenance .....	35
Specifications .....	40
Garage Door Controller Troubleshooting .....	41
Garage Door Sensor 2 Troubleshooting .....	42
Warning .....	43
Customer Service & Warranty .....	45

# In the Box

- A. Garage Door Controller
- B. Garage Door Sensor 2
- C. Power Adapter
- D. USB Cable
- E. Signal Wire
- F. Quick Start Guide

A.

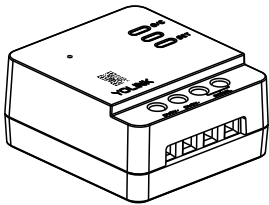

B.

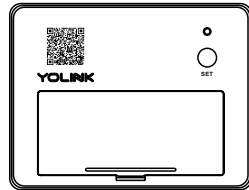

C.

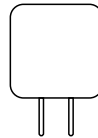

D.

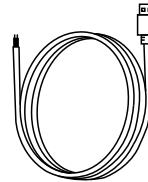

E.



F.



## Important Notice

- Improper use of your garage door operator/opener can cause property damage and/or serious injury or death. Install and use your Garage Door Kit 3 only as instructed in this manual
- If you are uncomfortable working with wiring or electricity, please consult or hire a qualified electrician
- Allow the garage door operator/opener to complete opening or closing before opening/closing with the controller or app
- Do NOT allow children to use the door operator/opener or control it via the app without adult supervision
- Due to the different control circuit design of garage door opener, Garage Door Controller cannot be compatible for all the garage door openers, visit [yolink.net](https://yolink.net) to check compatibility for your garage door opener from the garage door opener list
- Garage Door Sensor 2 is not compatible for roller doors and slide or slide hinged doors, but only compatible for sectional doors or canopy garage doors

# Introduction

YoLink Smart Garage Door Kit 3 includes two products - YS4906-UC Garage Door Controller, and YS7706-UC Garage Door Sensor 2

- Garage Door Controller: Used for garage door operator or button control, allows you to control your garage door from the YoLink app, as well as via popular voice assistants like Alexa and Google Assistants
- Garage Door Sensor 2: Supervises the position of your garage door, detecting when it is opened or closed, and can send alerts or trigger an automation based on the door opening, closing or being left open too long

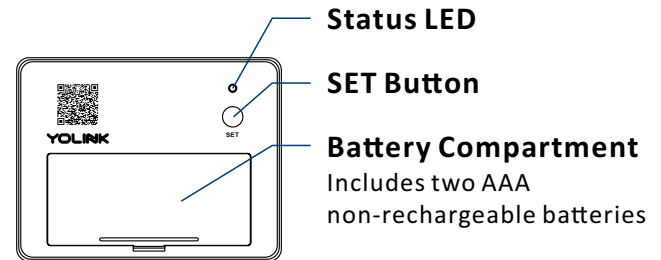
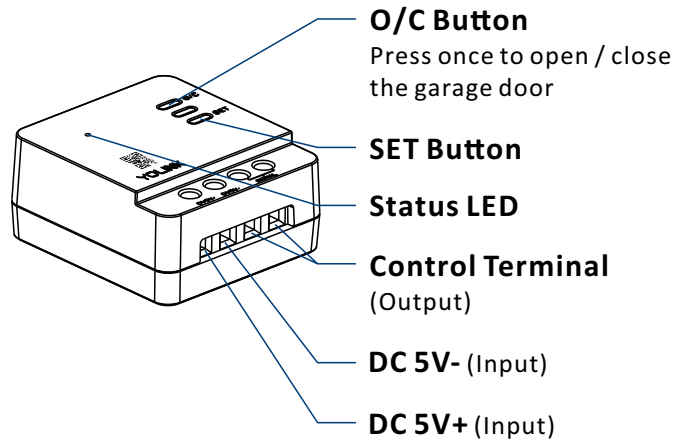

The LED light indicates the current status of the controller and sensor:

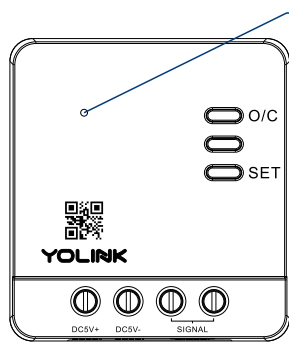

- **Green Once**  
Opening / Closing the door
- **Blinking Green**  
Connecting to Cloud
- **Fast Blinking Green**  
Establishing Connection with YoLink System
- **Slow Blinking Green**  
Updating
- **Fast Blinking Red**  
Removing Connection to YoLink System
- **Blinking Red And Green Alternately**  
Restoring to Factory Defaults

- **Red Once**  
Alert Mode (Door is Opened or Closed)
- **Blinking Green**  
Connecting to Cloud
- **Fast Blinking Green**  
Establishing Connection with YoLink System
- **Slow Blinking Green**  
Updating
- **Fast Blinking Red**  
Removing Connection to YoLink System
- **Blinking Red And Green Alternately**  
Restoring to Factory Defaults

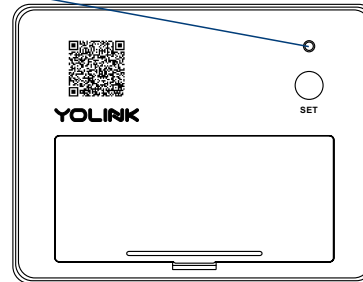

# Set Up

Follow the steps below to set up your Garage Door Kit via the YoLink app

## Set Up - First-Time YoLink Users *(Existing users proceed to **Add Device**, next page)*

**\* Get ready:** To set up and use your Garage Door Kit, you will need an Apple iPhone or tablet that is iOS 9.0 or higher, or an Android phone or tablet that is Android 4.4 or higher

- Download YoLink app through Apple App Store or Google Play Store
- Log in or create a new account if required
- YoLink Hub is required to set up your Garage Door Kit. Please set up your YoLink Hub first (refer to YoLink Hub manual)



Download, and log in to YoLink app

1

*\* Make sure your hub is connected to the internet (green LED indicator is blinking, blue LED indicator is always on)*

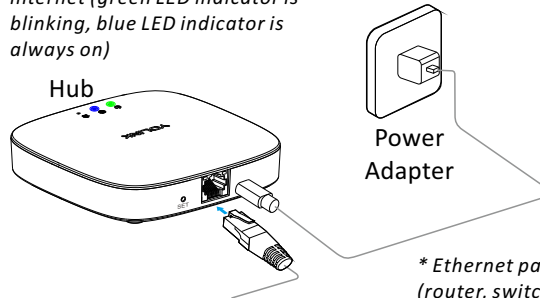

Set up YoLink Hub

2

*\* Ethernet patch cable (included) to your network (router, switch, etc.), recommended, but optional. Otherwise connect your Hub to your home Wi-Fi network. Refer to the Hub set up manual for more information:*



YS1603-UC\_User Guide

## Add Device

- Tap “” button, then scan QR Code on the Garage Door Controller and Garage Door Sensor 2 in turn

*\* For the best user experience, we suggest you pair your Garage Door Sensor 2 with a Garage Door Controller. After pairing you will get real-time battery status of your Garage Door Sensor 2, signal level between Garage Door Controller or Garage Door Sensor 2 and the YoLink Hub, and real-time opened or closed status of your garage door*

*\* If you skip the pairing when adding the device, you can pair them later in the **Details** page of Garage Door Controller*

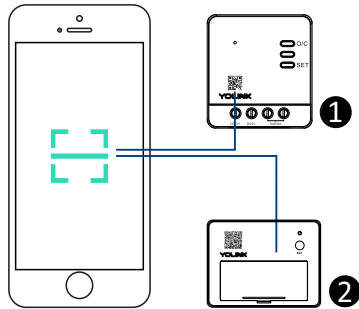

Tap “” button  
to add devices

1

- Turn on power of controller after installation (refer to Installation section on next page), the Status LED will blink several times (red, then green). The green LED indicates the device is online and ready to use
- Press the SET button (on front of sensor) once, the Status LED will blink several times (red, then green). The green LED indicates the device is online and ready to use

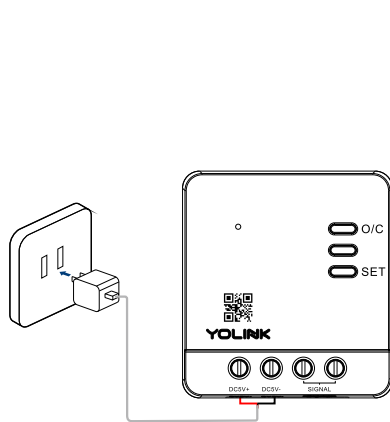

Turn on power after installation

2

*\* If the controller is powering on, press the SET button once, the Status LED will blink green, your device is ready to use*

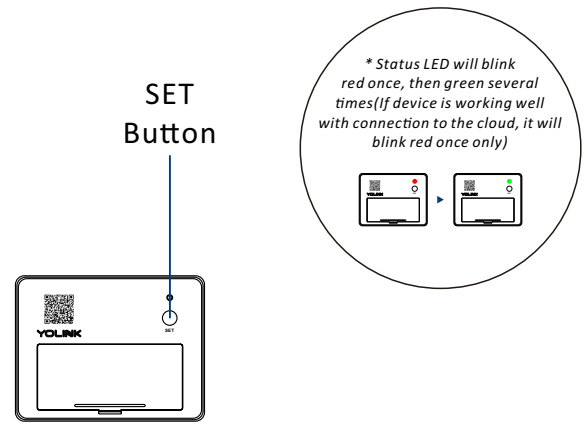
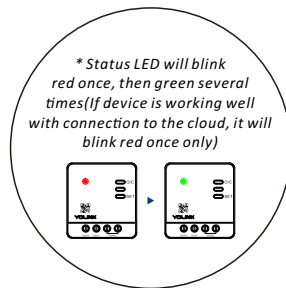

Press the SET button (on front of sensor) once

3

# Installation

## Test the Controller and Sensor Location Before Installation

- The controller and sensor are very difficult to relocate after being affixed to the mounting surface. Test your controller and sensor location before affixing the two devices to the surface. Use masking or painters tape to secure the controller and sensor to the surface. Once you have the controller and sensor temporarily mounted, test it out. With the app in hand, open or close the door using app and observing the status of the sensor as shown on the app (Opened or Closed). Optionally, you may set up your automation (e.g. turn on a light when the door is opened) to functionally test the status change of the door - proceed to the following steps for information on creating automations, then return to this step
- Garage Door Controller and Sensor 2 are designed and intended for indoor use only!
- Garage Door Sensor 2 should be mounted on the top panel of garage door and keep the SET button at the top and the longer side parallel to the floor, otherwise the status of sensor shown on the app (Opened or Closed) may be inaccurate
- Avoid allowing the controller and sensor to be exposed to strong impacts or vibration
- Please add the Garage Door Controller and Sensor 2 to the YoLink app before installation

# Garage Door Controller

## Get Ready to Install the Garage Door Controller

- Before starting, choose the appropriate method for your installation, connecting to your garage door operator (typically on the ceiling of your garage) or the button (typically on the wall). For connections to the operator (Method A) you may install the Garage Door Controller on the garage door operator itself, near it on the ceiling, or on the wall, but please note the wiring requirements: the Garage Door Controller requires the included power adapter, which requires a 120V receptacle, which may or may not be available at your desired location. Also, power wiring will be required between the Controller and the power adapter and signal wiring will be required between the Controller and the operator
- Slotted screwdriver - Number 3 mm may be required

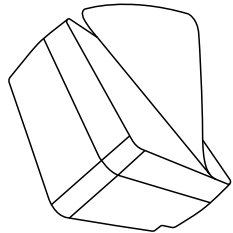

Remove the protective layer

1

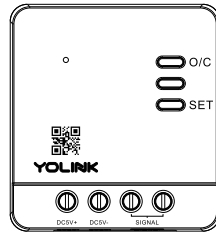

Place the controller at the desired location and press firmly for at least 5 seconds

2

## Begin Installation:

- Loosen the screw terminal using a 3 mm slotted screwdriver, connect the first wire to the associated screw terminal on the Garage Door Controller; do the same for the remaining three wires
  - Before connecting the wire to the terminal, ensure there is about 2/5 inch of bare wire visible (strip off insulation as needed)
  - Insert the wire into the terminal, then tighten the screw terminal
  - Gently tug on the wire to ensure a tight connection

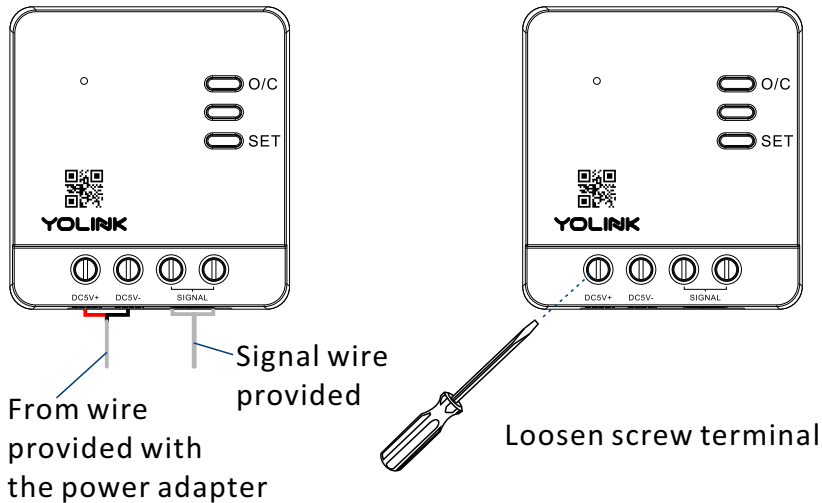

3

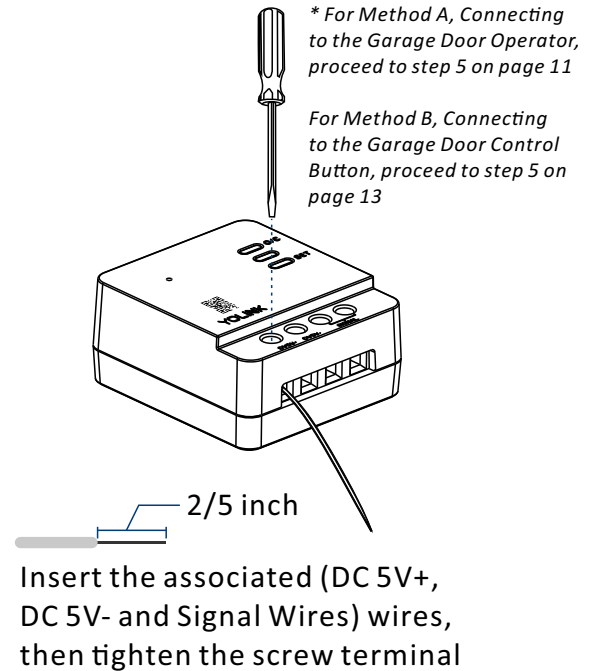

4

- Method A: Connecting to the Garage Door Operator

- Remove the existing wires from the door operator, after making a note (or taking a picture) of their locations. Twist\* together one existing wire to one (new) signal wire, install under the existing wire's original terminal. Repeat for the other existing wire and new control wire

*\* If the wires are not twisted together, it is important to ensure both the old and new wires are both secured in place under the terminal, making a good electrical connection*

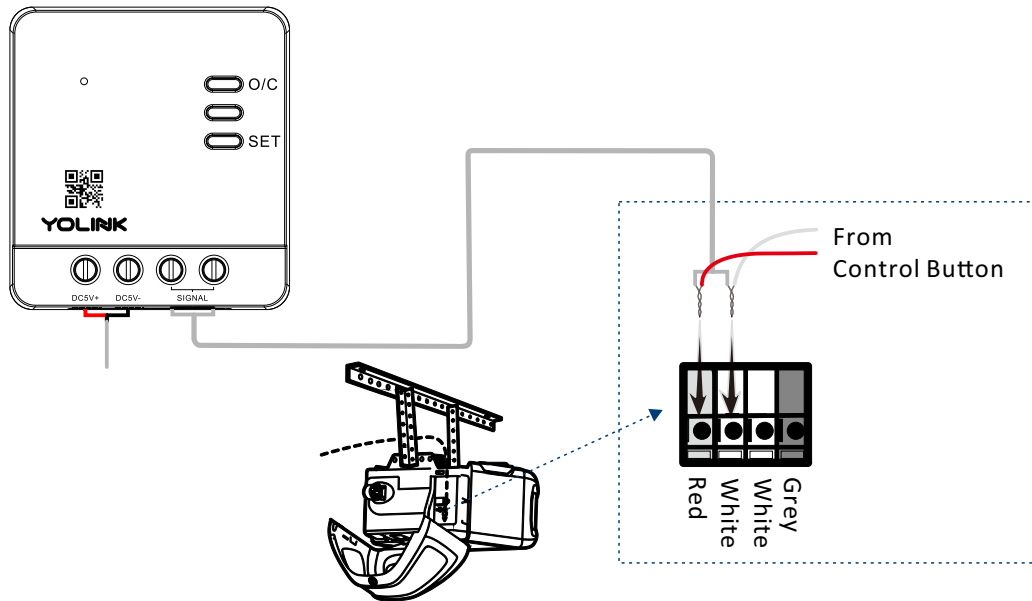

Locate the two control terminals on your garage door operator

- Power on the controller

- Test your garage door operator as you would normally use it. If it is not working properly, double-check or re-do steps 3 through 6 as needed. Do not proceed to the next step until your garage door operator works as before

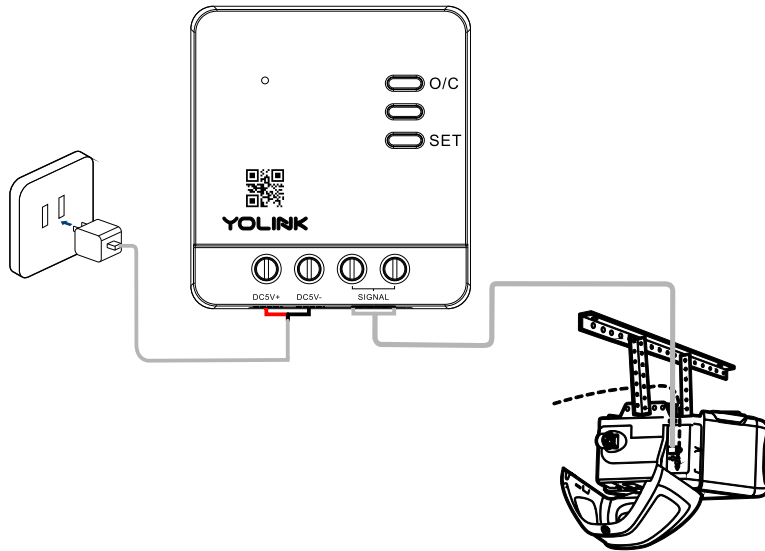

Power on the controller

6

- **Method B: Connecting to the Garage Door Control Button**

- Remove the existing garage door control button. Remove the existing wires, after making a note (or taking a picture) of their locations. Twist\* together one existing wire to one (new) signal wire, install under the existing wire's original terminal. Repeat for the other existing wire and new control wire

*\* If the wires are not twisted together, it is important to ensure both the old and new wires are both secured in place under the terminal, making a good electrical connection*

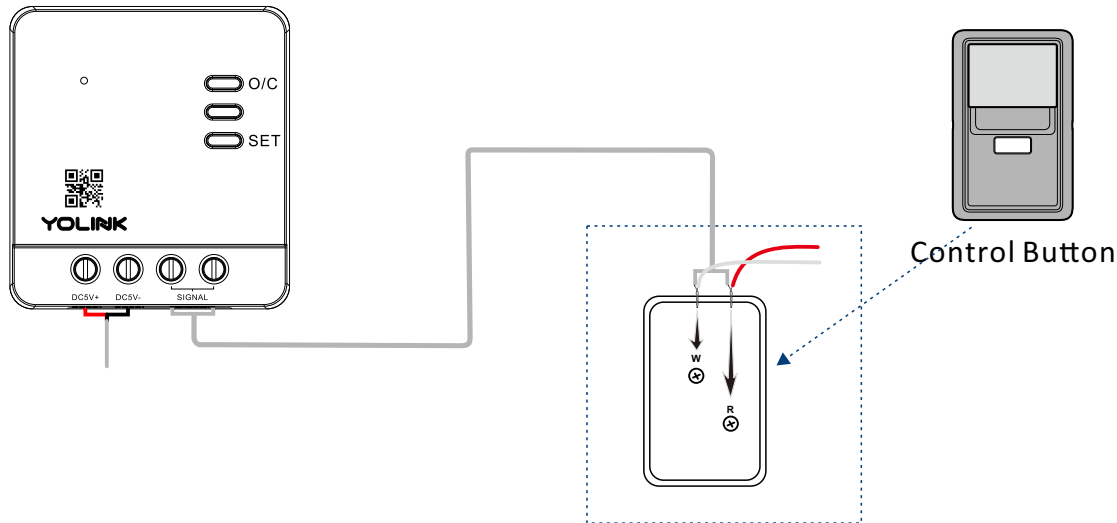

Locate the two control terminals on your garage door control button



- Power on the controller

- Verify your existing garage door controller button functions normally. Otherwise, double-check or re-do step 5

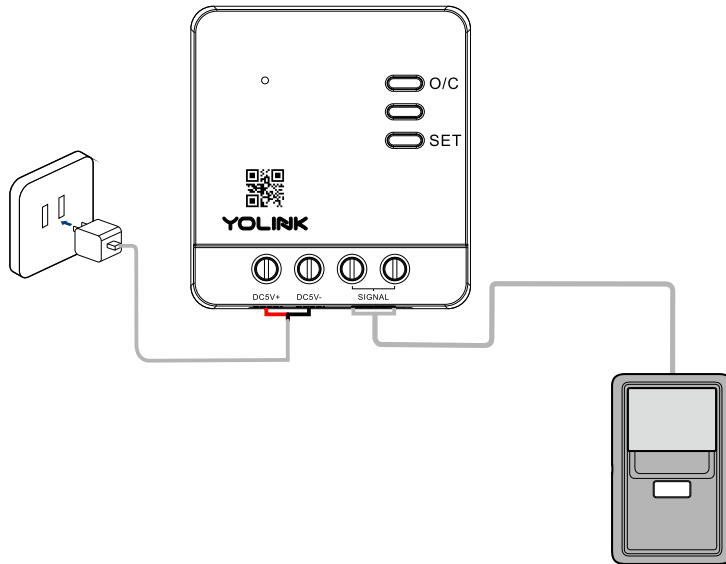

Power on the controller

6

## Garage Door Sensor 2

- Method A: Install the Garage Door Sensor 2 with double-sided tape on the back of the device
  - Find a suitable area on the top panel (left or right side suggested). Ensure the sensor will not come in contact with moving parts of the garage door operator/mechanism. Clean the selected installation area
  - Remove the protective layer of the double-sided tape

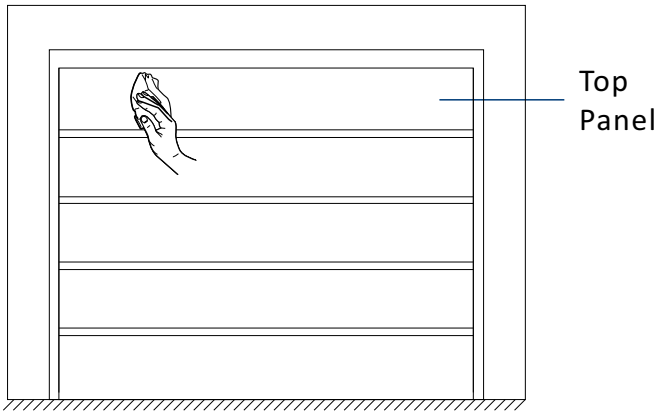

Clean the installation area

1

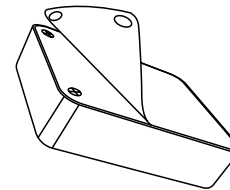

Remove the protective layer

2

- Keep the SET button of the Garage Door Sensor 2 at the top and the longer side parallel to the floor, press the sensor firmly to the door for at least 5 seconds

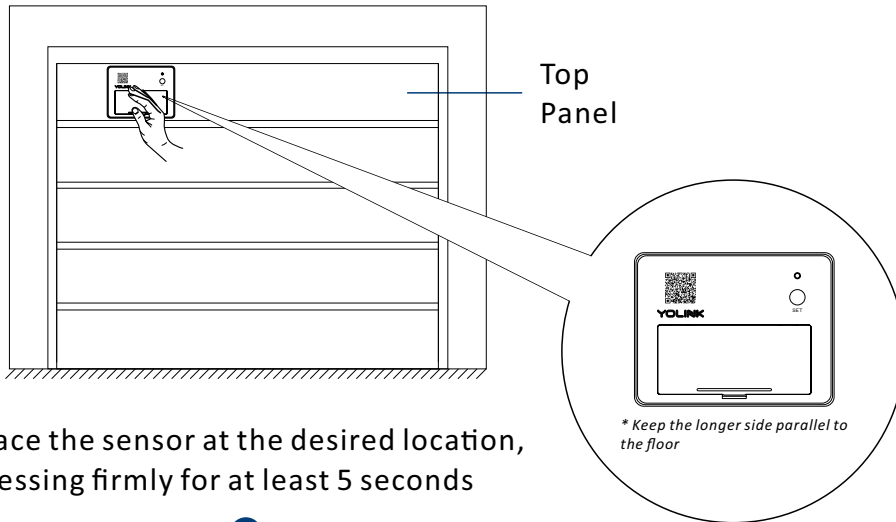

Place the sensor at the desired location, pressing firmly for at least 5 seconds

3

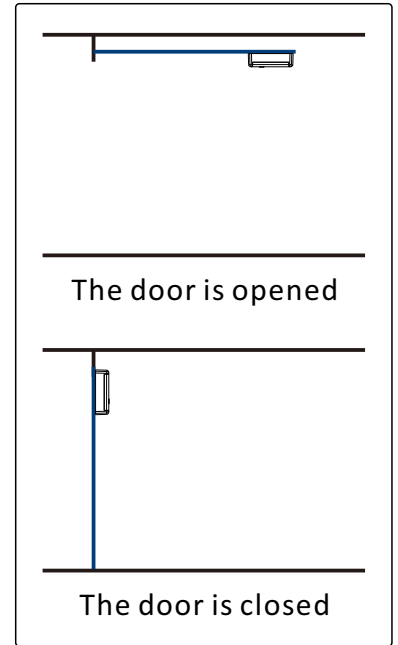

- **Method B: Mount the Garage Door Sensor 2 to the wall with screws (not included)**

- For wall-mounting, open the battery cover and remove the screws to gain access to the mounting holes on the back of the Sensor

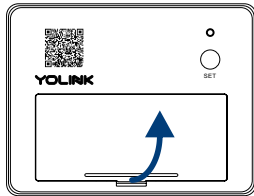

Open the battery cover and remove the batteries

2

- Keep the longer side of the Garage Door Sensor 2 parallel to the floor, mount the sensor to the top panel (left or right side suggested) of the garage door using screws

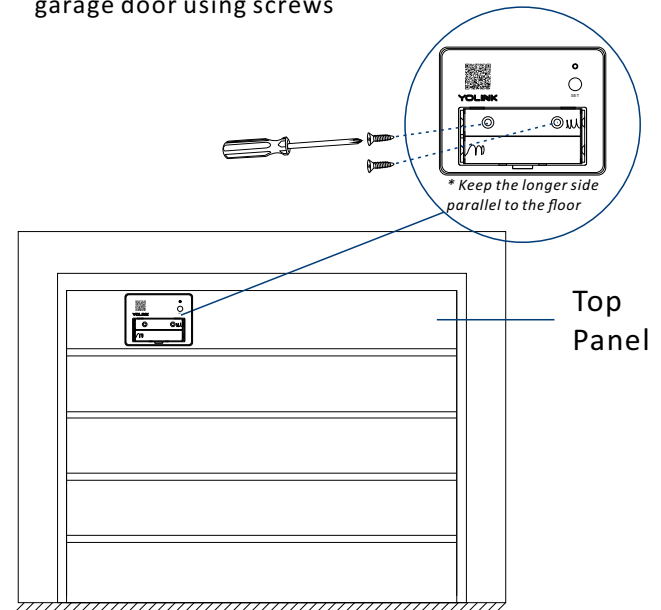

Mount the Garage Door Sensor 2

3

- Reinstall the batteries and close the battery cover

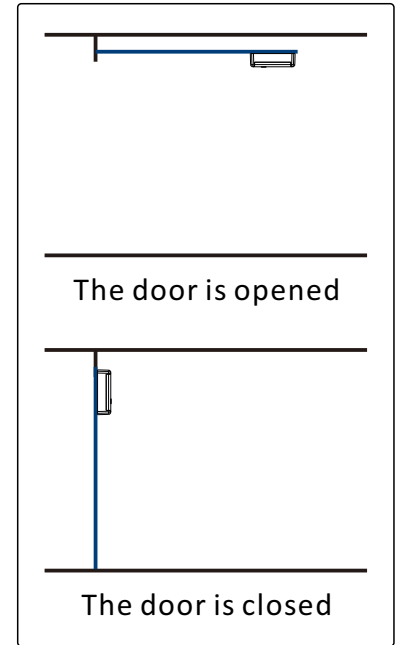
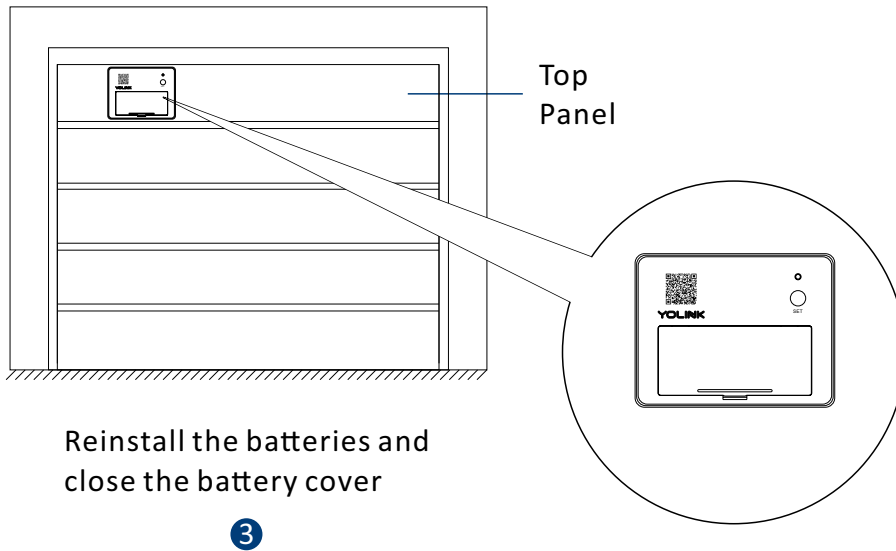

# Using the YoLink App

## Device page (Paired with a Sensor)

### Device name

\* Edit name on Details page

\* Tap to open/close the garage door

### Device history

Door opened and closed, logged with date & time

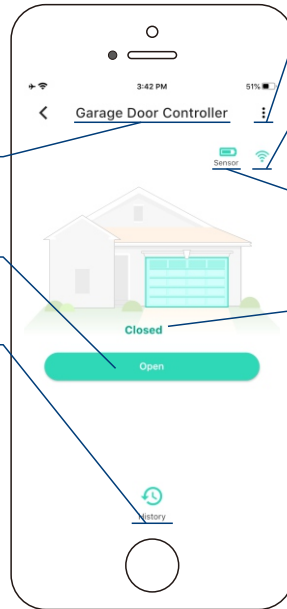

### Details

\* Tap to go to Details page (refer to page 20)

### Connection status

of controller/sensor and Hub (the worse one)

### Battery level

current battery level of sensor

\* Shown red if replacement is required

### Real-time status:

Opened or closed or inaccurate status

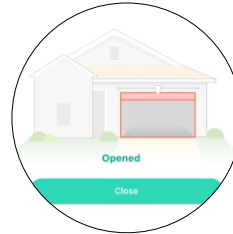

\* Garage door is closed

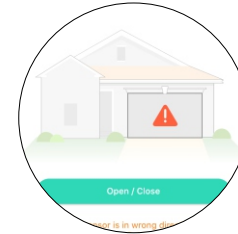

\* Inaccurate status of garage door, double-check the Installation of garage door sensor 2

# Device page (Controller Only)

## Device name

*\* Edit name on Details page*

*\* Tap to open/close the garage door*

## Device history

Door controlled (no status of door), logged with date & time

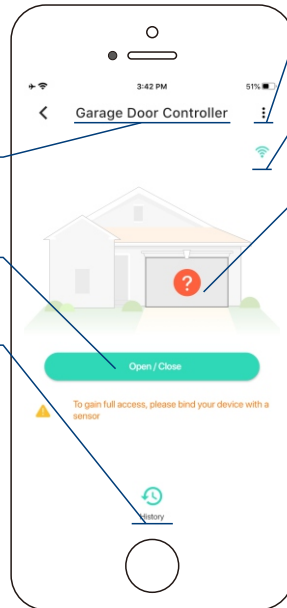

## Details

*\* Tap to go to Details page (refer to page 22)*

## Connection status

of controller and Hub

## Unknown status of door

*\* Pair with a sensor to obtain the status of door*



# Device page (Sensor Only)

## Device name

*\* Edit name on Details page*

## Device history

Door opened and closed, logged with date & time

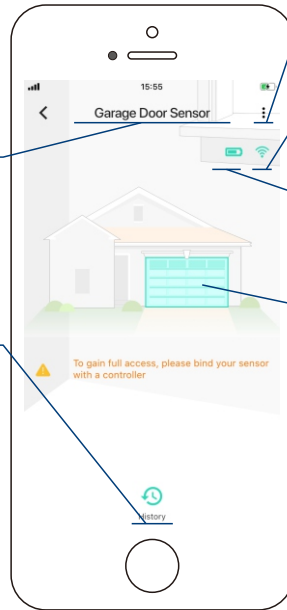

## Details

*\* Tap to go to Details page (refer to page 23)*

## Connection status

of sensor and Hub

## Battery level

current battery level

*\* Shown red if replacement is required*

## Real-time status:

Opened or closed or inaccurate status



*\* Garage door is closed*

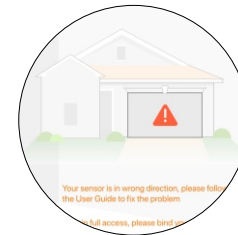

*\* Inaccurate status of garage door, double-check the Installation of garage door sensor 3*

# Details page (Paired with a Sensor)

## Device type

## Rename the device

## Choose a room for device

## Alert settings

*\* Enable or disable alerts. Default is set to Alert When Door is Opened or Closed*

## Send notification

to you when the door is left open for a set time

*\* Default is set to 30 minutes. After the first notification, there will be continuously notification at a default interval of 30 minutes*

## Add / remove from favorites

## Device history

Door opened and closed, logged with date & time

## Device status

Opened or closed or inaccurate status

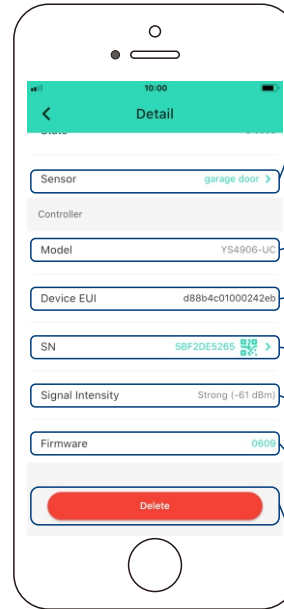
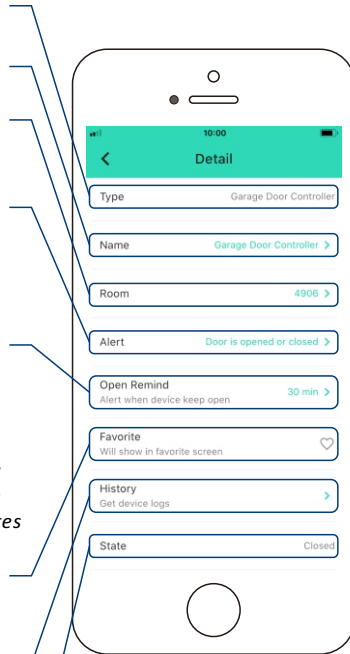

## Tap to pair/unpair with a sensor

*\* Sensor's device name indicates the controller is paired with a sensor. Tap to go to Details page of sensor (refer to next page)*

## Device model

## Device EUI (unique)

## Device SN (unique)

## Connection status of controller and Hub

## Firmware version

*\* "#### ready now" indicates a new update is available (refer to page 33)*

*\* Tap to delete the device from your YoLink account*



## Details page of Sensor

**Device type**

**Rename the device**

**Device model**

**Device EUI (unique)**

**Connection status  
of sensor and Hub**

**Firmware version**

*\* "#### ready now" indicates a  
new update is available (refer  
to page 33)*

*\* Tap to unpair the sensor  
with the controller*

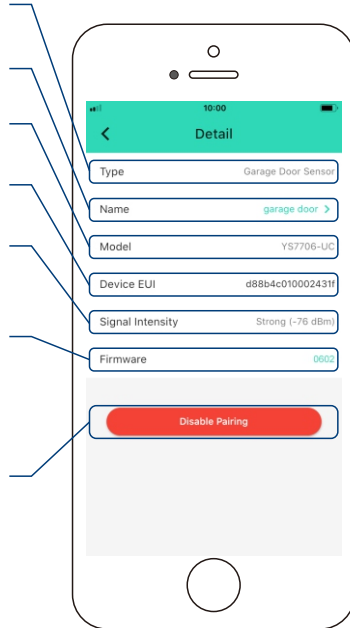

# Details page (Controller Only)

**Device type**

**Rename the device**

**Choose a room**  
for device

**Add / remove**  
from favorites

**Device history**  
Door controlled (no  
status of door), logged  
with date & time

**Unknown status of door**  
*\* Pair with a sensor to obtain  
the status of door*

**Tap to pair/unpair  
with a sensor**  
*\* Sensor's device name  
indicates the controller is  
paired with a sensor*

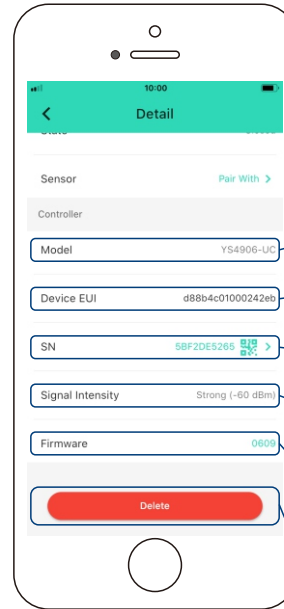
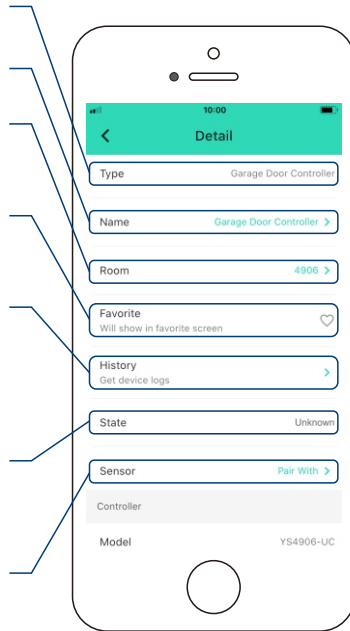

**Device model**

**Device EUI (unique)**

**Device SN (unique)**

**Connection status**  
of controller and Hub

**Firmware version**

*\* "#### ready now" indicates a  
new update is available (refer  
to page 34)*

*\* Tap to delete the device from  
your YoLink account*



# Details page (Sensor Only)

## Device type

## Rename the device

## Choose a room for device

## Add / remove from favorites

## Device history

Door opened and closed, logged with date & time

## Alert settings

*\* Enable or disable alerts. Default is set to Alert When Door is Opened or Closed*

## Send notification

to you when the door is left open for a set time  
*\* Default is set to 30 minutes. After the first notification, there will be continuously notification at a default interval of 30 minutes*

## Device status

Opened or closed or inaccurate status

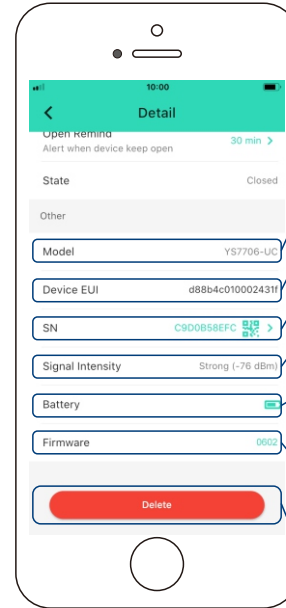
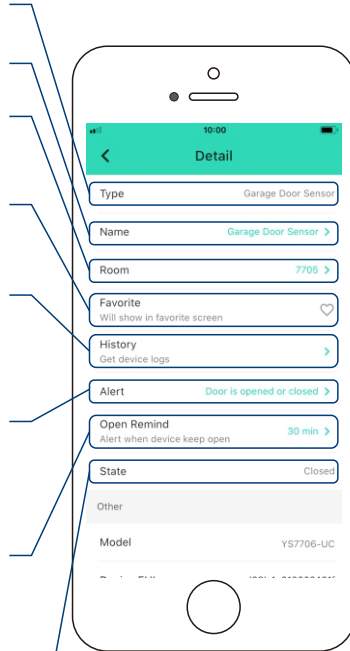

## Device model

## Device EUI (unique)

## Device SN (unique)

## Connection status of sensor and Hub

## Battery level

current battery level  
*\* Shown red if replacement is required*

## Firmware version

*\* "#### ready now" indicates a new update is available (refer to page 35)*

*\* Tap to delete the device from your YoLink account*

## Device Alerts

- Upon the opening or closing or left open for a set time of the garage door, an alert will be sent to your YoLink account

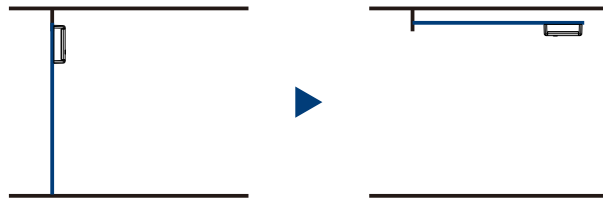

Door is opened

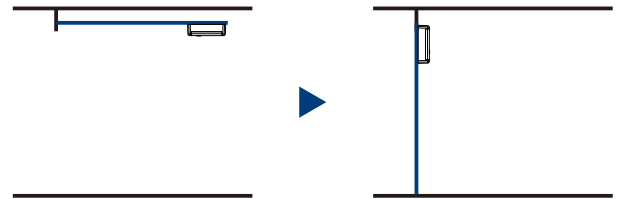

Door is closed

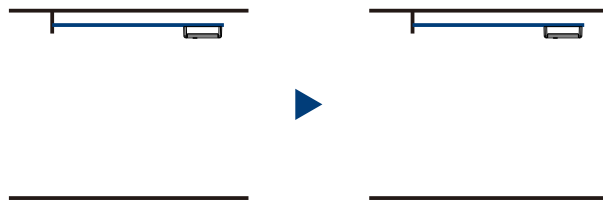

Door is still open for a set time

## Automation

Easily set up rules for “if this then do that” functions

- Go to “Smart”, tap “Automation” followed by the “ + ” icon to add an automation
- Fill in details followed by the “ ✓ ” icon

*\* Garage Door Sensor 2 can be set as a trigger only, Garage Door Controller cannot be set as either a trigger or an action device*

**Tap to add an automation**

**Tap “  ” button**  
to enable or disable the automation

*\* Click to edit the automation.  
Swipe left to view the history logs and to edit or delete the automation*

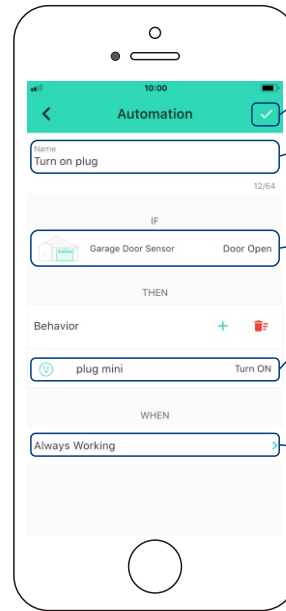
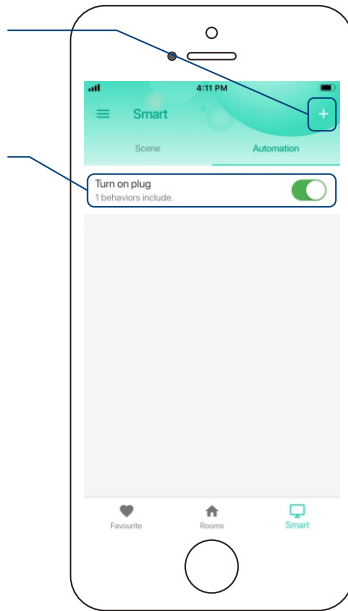
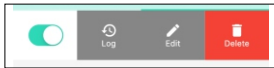

**Tap to save the settings**

**Edit name**  
for the automation

**Edit trigger**

**Edit behavior**

*\* You must have at least one action device, or you cannot set a behavior*

**Edit when**

*\* Set a time range for the automation (always or during specific days / times)*

## Voice Assistants

Connect YoLink with third-party voice assistants service to monitor the status of your devices through voice commands

- Tap “☰” in the upper left corner to go to My Profile
- Go to **Settings > Voice Assistants** for the applicable voice assistant integration guide

*\* Garage Door Kit 3 is integrated with Alexa and Google Assistant only when the Garage Door Controller is paired with the Garage Door Sensor 2, and is also integrated with **IFTTT.com***

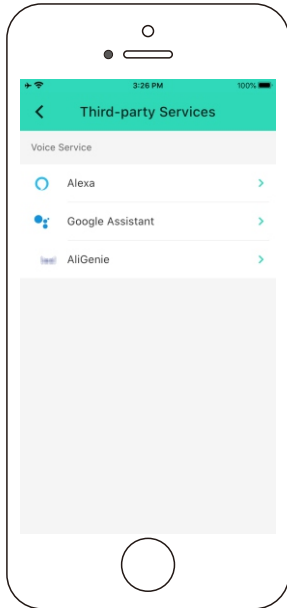

# About YoLink Control

YoLink Control is our unique device-to-device control technology. Using YoLink Control, YoLink devices can be controlled without the Hub or an internet connection. (Use of YoLink Control is optional; you can use the Automation feature in the app OR use YoLink Control, but YoLink Control offers the benefit of operation without the Hub or internet connection.)

One device controls another, directly. A device that sends out commands is called the controller. A device that receives the commands is called the responder. Examples of a controller are a Door Sensor or Water Leak Sensor, while examples of a responder are a Siren or a YoLink Plug Mini

The Garage Door Sensor 2 can only work as the controller of YoLink Control, while the Garage Door Controller does NOT support YoLink Control

## Pairing

- To configure your Garage Door Sensor 2 as a controller, turn the sensor into opened status (verify the door is opened). Press and hold the SET button for 5-10 seconds until the LED quickly blinks green
- To configure a YoLink Plug Mini as the responder. Turn on the plug using POWER button or via YoLink app (verify the Status LED of YoLink Plug Mini displays blue). Press and hold the POWER button for 5-10 seconds until the LED quickly blinks blue
- Upon pairing, the LED will stop blinking (this may happen after only blinking two or three times)

## Note

- If you want to turn off the YoLink Plug Mini when the door is opened, turn off the YoLink Plug Mini first, and let it enter pairing mode
- For the same Garage Door Sensor 2 and YoLink Plug Mini, you can only choose to either turn on or turn off the YoLink Plug Mini when the door is opened
- If you want to turn on or off the YoLink Plug Mini when the door is closed, turn the sensor into closed status (verify the door is closed), and let the closed door sensor enter pairing mode
- Also for the same Garage Door Sensor 2 and YoLink Plug Mini, you can only choose to either turn on or turn off the YoLink Plug Mini when the door is closed

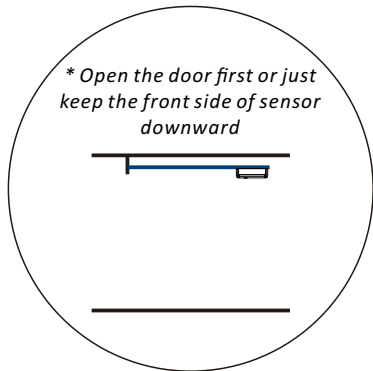

## Turn on the plug

\* verify the Status LED of YoLink Plug Mini displays blue. Refer to the YoLink Plug Mini manual for more information:



YS6604-UC\_YoLink Plug Mini

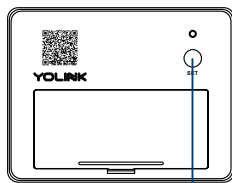

SET Button

Hold the SET button for 5-10 seconds, until the green light blinks quickly

1

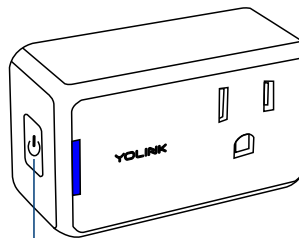

POWER Button

Hold the POWER button on the YoLink Plug Mini (**Turned on**) for 5-10 seconds, until the blue light blinks quickly

2

## Operation

- When the door is opened, the YoLink Plug Mini will be immediately turned on. The plug will remain turned on until turned off using the POWER button or via the app
- More advanced sequences, controlling multiple outputs (e.g. turn off plug and activate siren) are available via the YoLink app

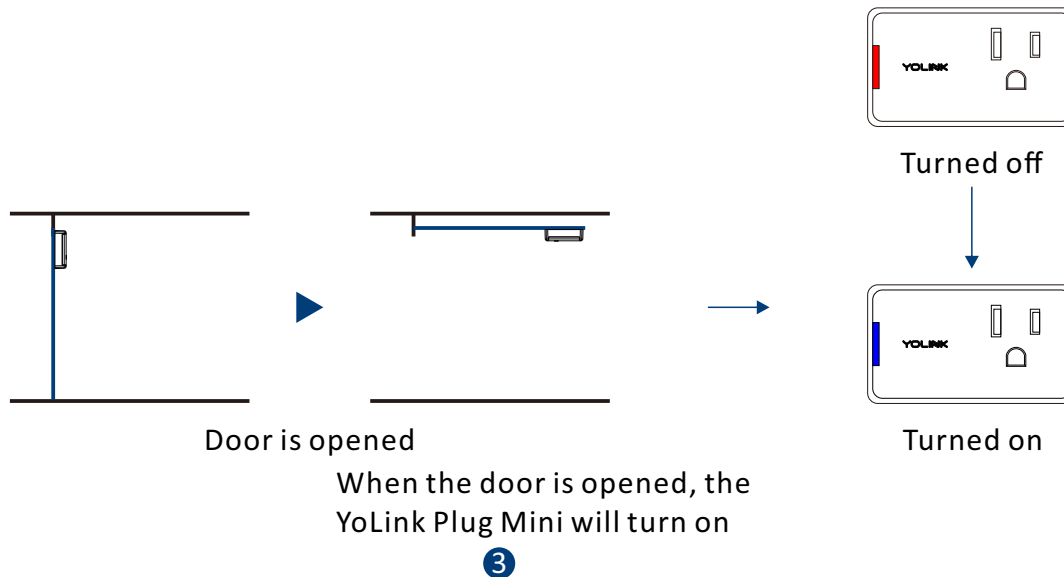

## Unpairing

- At the Garage Door Sensor 2 (controller), turn the sensor into opened status (verify the door is opened), press and hold the SET button for 10-15 seconds until the LED quickly blinks green, then red
- At the YoLink Plug Mini (responder), press and hold the POWER button for 10-15 seconds, until the LED quickly blinks blue, then red
- Upon un-pairing, the Garage Door Sensor 2 LED will stop blinking and turn off, and the YoLink Plug Mini LED will stop blinking and return to the previous color (blue for turned on, red for turned off)
- The YoLink Plug Mini will no longer respond when the door is opened

### Note

- If you want to unpair the Garage Door Sensor 2 (closed status) with the YoLink Plug Mini, turn the sensor into closed status (verify the door is closed), and let it enter unpairing mode

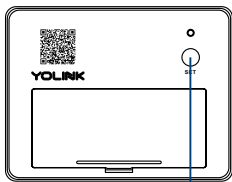
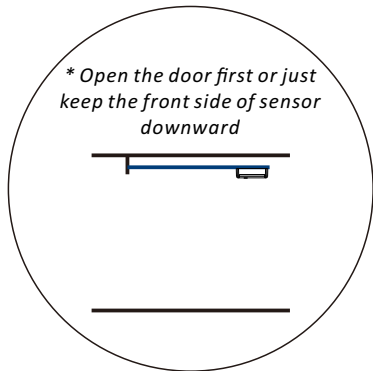

SET Button

Hold the SET button for 10-15 seconds, until the red light blinks quickly

1

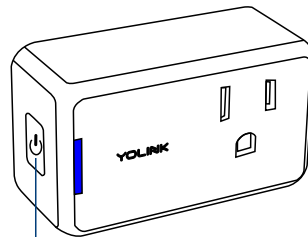

POWER Button

Hold the POWER button on the YoLink Plug Mini for 10-15 seconds, until the red light blinks quickly

2

*\* Plug is either turned on or turned off*

# Maintenance

## Firmware Update (Pair with a Sensor)

To ensure our customers have the best user experience, we highly recommend you update to the newest version firmware when an update is available

- In “Firmware” , if a new version is listed as available (#### ready now), click it to start the firmware update process
- You may use your device during the update as it is performed in the background. The LED light will slowly blink green during the update and the process will be complete within 2 minutes after the light stops blinking
- You may update the firmware of the sensor following the same procedure. For the sensor, the device's firmware will be updated automatically within 4 hours (maximum). To force an immediate update, press the SET button on the device once to make the device enter update mode

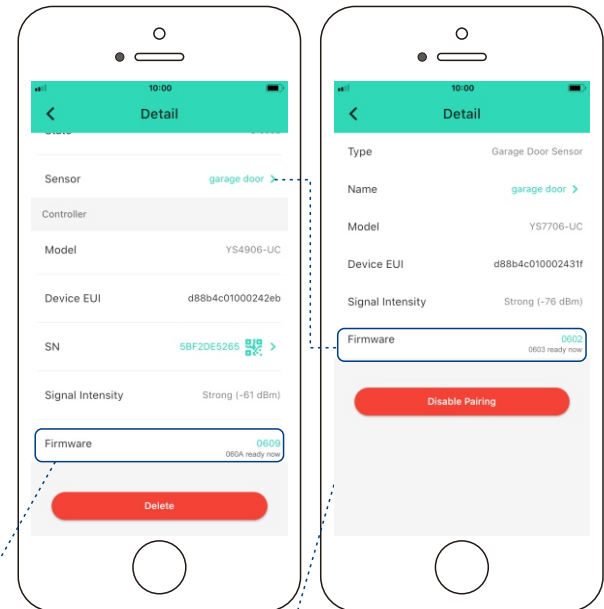

Firmware

0609  
060A ready now

Firmware

0602  
0603 ready now

## Firmware Update (Controller Only)

To ensure our customers have the best user experience, we highly recommend you update to the newest version firmware when an update is available

- In “Firmware”, if a new version is listed as available (#### ready now), click it to start the firmware update process
- You may use your device during the update as it is performed in the background. The LED light will slowly blink green during the update and the process will be complete within 2 minutes after the light stops blinking

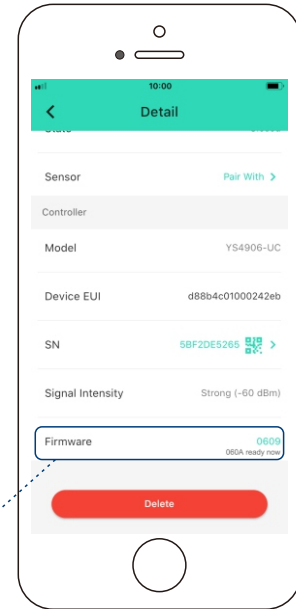

Firmware 0609  
060A ready now

## Firmware Update (Sensor Only)

To ensure our customers have the best user experience, we highly recommend you update to the newest version firmware when an update is available

- In “Firmware”, if a new version is listed as available (#### ready now), click it to start the firmware update process
- The device's firmware will be updated automatically within 4 hours (maximum). To force an immediate update, press the SET button on the device once to make the device enter update mode
- You may use your device during the update as it is performed in the background. The LED light will slowly blink green during the update and the process will be complete within 2 minutes after the light stops blinking

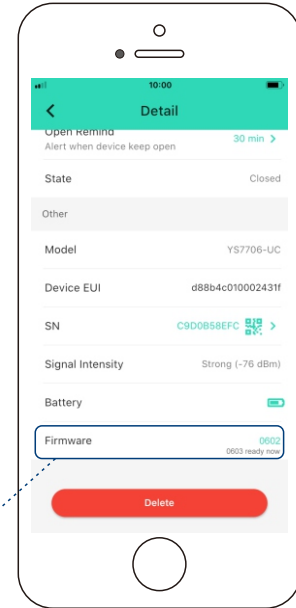

## Factory Reset

Factory reset will erase all of your settings and restore it to factory defaults. After the factory reset, your device will remain in your Yoolink account

- Hold the SET button for 20-25 seconds until the status light blinks red and green alternately, then, release the button (*Hold the SET button longer than 25 seconds will ABORT the factory reset operation*)
- Factory reset will be complete when the status light stops blinking
- You may factory reset the sensor following the same procedure

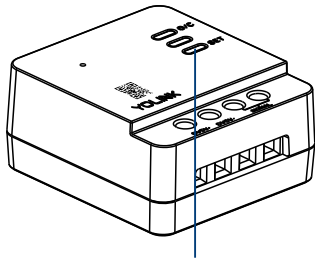

SET Button

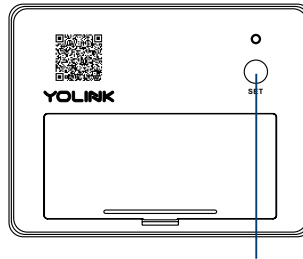

SET Button

## Replacing the Batteries (Garage Door Sensor 2)

- Remove the battery cover by gently prying with your fingertip or tool at the edge as shown
- Remove the old batteries
- Install two new alkaline non-rechargeable AAA batteries, and then close the battery cover
- Using the app, check the online status of the sensor and verify there is no low-battery indicator
- Note: do not mix old and new batteries

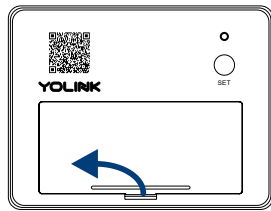

Remove the battery cover

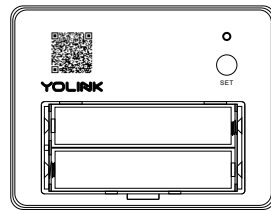

Remove the old batteries

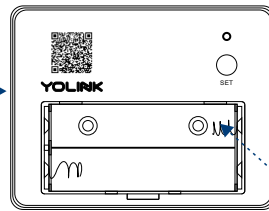

Install two new AAA batteries

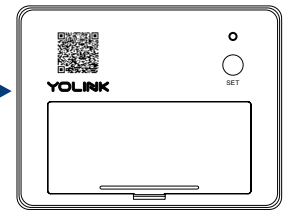
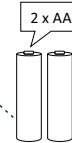

Close the battery cover

# Specifications

## Garage Door Controller

---

**Voltage:** 5V DC

---

**Current:** 1A

---

**Dimensions:** 2.09 x 1.93 x 0.98 inch (L x W x D)

---

**Environment:** Working Temperature: 32°F - 104°F (0°C - 40°C)  
Working Humidity: 10% - 90% non-condensing

---

## Garage Door Sensor 2

---

**Voltage:** 3V DC (2 - AAA battery)

---

**Dimensions:** 2.56 x 1.97 x 0.69 inch (L x W x D)

---

**Environment:** Working Temperature: 32°F - 104°F (0°C - 40°C)  
Working Humidity: 10% - 90% non-condensing

---

# Garage Door Controller Troubleshooting

## Hardware:

- 1. Wiring:** Garage Door Controller cannot compatible for all the garage door openers, visit [yolink.net](http://yolink.net) to check compatibility of your garage door opener first
- 2. Input voltage:** Be sure device is powered by 5V AC

## Symptom:

### 1. Device is offline

- If controller is not connected to the cloud, press the SET button on controller once
- If Hub is offline, reconnect the Hub to the Internet and press the SET button on controller once
- If Hub is not on, power on the Hub again and press the SET button on controller once
- If controller is out of range with Hub, relocating the Hub may be required
- If controller is not turned on. Turn on the device

- 2. Other issues,** contact customer service, **1-949-825-5958 (M-F 9am - 5pm PST)**

# Garage Door Sensor 2 Troubleshooting

## Hardware:

**Batteries:** Batteries should be brand new, name brand “AAA” alkaline type. Refer to “Warnings” Section on page 41

## Symptom:

### 1. Device is offline or no alert received from door opened/closed events

- If sensor is not connected to the cloud, press the SET button on sensor once
- If Hub is offline, reconnect the Hub to the Internet and press the SET button on sensor once
- If Hub is not on, power on the Hub again and press the SET button on sensor once
- If sensor is out of range with Hub, relocating the sensor or Hub may be required
- For a device with low-battery indicators or alerts or if the condition of the batteries is in question, replace the batteries with 2 premium “AAA” alkaline batteries

### 2. Other issues, contact customer service, **1-949-825-5958 (M-F 9am - 5pm PST)**

## Warning

- Please install, operate and maintain the Garage Door Controller and Sensor 2 only as directed herein. Failure to follow the information in this manual can void the warranty and result in malfunctions and/or equipment failure
- Garage Door Controller and Sensor 2 are not waterproof and are designed and intended only for indoor use. Subjecting these two devices to outdoor environment conditions such as direct sunlight, extreme hot or cold temperatures, rain, water and/or condensation can damage the device and will void the warranty. Refer to Specifications (page 38) for the device environmental limitations
- If your Garage Door Controller or Sensor 2 gets dirty, please clean it by wiping it down with a clean, dry cloth. Do not use strong chemicals or detergents, which may discolor or damage the exterior and/or damage the electronics, voiding the warranty
- Do not install or use this device where it will be subjected to physical impacts and/or strong vibration. Physical damage is not covered by the warranty
- Power the controller with the included power adapter and USB cord, only. Powering the controller with other power supplies and voltages can result in severe damage to the controller, which is not covered by the warranty
- Power the sensor only with two AAA batteries (see below, regarding batteries)
- Use only new, name brand, alkaline non-rechargeable AAA batteries
- Do not use rechargeable batteries
- Do not use zinc blend batteries

- Do not mix new and old batteries
- Do not puncture or damage batteries. Leakage can cause harm on skin contact, and is toxic if ingested
- Do not dispose of batteries in fire as they may explode! Please follow local battery disposal procedures
- To avoid damaging the device, if storing the device for an extended period, remove the batteries
- Please contact Customer Service before attempting to repair, disassemble or modify the device, any of which can void the warranty and permanently damage the device

**If you have any difficulties installing or using your Garage Door Kit 3, please contact our Customer Service department during business hours:**

US Live Tech Support: **1-949-825-5958** M-F 9am - 5pm PST

Email: **service@yosmart.com**

YoSmart Inc. 17165 Von Karman Avenue, Suite 105, Irvine, CA 92614

## **Warranty** 2 Year Limited Electrical Warranty

YoSmart warrants to the original residential user of this product that it will be free from defects in materials and workmanship, under normal use, for 2 years from the date of purchase. User must provide a copy of original purchase receipt. This warranty **does not cover** abuse or misused products or products used in commercial applications. This warranty does not apply to Garage Door Kit 3 that have been improperly installed, modified, put to a use other than designed, or subjected to acts of God (such as floods, lightning, earthquakes, etc.). This warranty is limited to repair or replacement of the Garage Door Kit 3 only at YoSmart's sole discretion. YoSmart will NOT be liable for the cost of installing, removing, nor reinstalling this product, nor direct, indirect, or consequential damages to persons or property resulting from the use of this product. This warranty only covers the cost of replacement parts or replacement units, it does not cover shipping & handling fees

To implement this warranty please give us a call during business hours at 1-949-825-5958, or visit [www.yosmart.com](http://www.yosmart.com)

Copyright 2020. YoSmart, Inc. All rights reserved

## FCC Statement

This equipment has been tested and found to comply with the limits for a Class B digital device, pursuant to part 15 of the FCC Rules. These limits are designed to provide reasonable protection against harmful interference in a residential installation. This equipment generates, uses and can radiate radio frequency energy and, if not installed and used in accordance with the instructions, may cause harmful interference to radio communications. However, there is no guarantee that interference will not occur in a particular installation. If this equipment does cause harmful interference to radio or television reception, which can be determined by turning the equipment off and on, the user is encouraged to try to correct the interference by one or more of the following measures:

- Reorient or relocate the receiving antenna
- Increase the separation between the equipment and receiver
- Connect the equipment into an outlet on a circuit different from that to which the receiver is connected
- Consult the dealer or an experienced radio / TV technician for help

This device complies with part 15 of the FCC Rules. Operation is subject to the following two conditions:

- 1) This device may not cause harmful interference
- 2) This device must accept any interference received, including interference that may cause undesired operation. Any changes or modifications not expressly approved by the party responsible for compliance could void the user's authority to operate the equipment

Note: The manufacturer is not responsible for any radio or TV interference caused by unauthorized modifications to this equipment. Such modifications could void the user's authority to operate the equipment.

## **FCC RF Radiation Exposure Statement**

This equipment complies with FCC RF radiation exposure limits set forth for an uncontrolled environment. This device and its antenna must not be co-located or operating in conjunction with any other antenna or transmitter.

“To comply with FCC RF exposure compliance requirements, this grant is applicable to only Mobile Configurations. The antennas used for this transmitter must be installed to provide a separation distance of at least 20 cm from all persons and must not be co-located or operating in conjunction with any other antenna or transmitter.”