

Slow Juicer

User's manual

EN



SENCOR®

SSJ 5050SS
SSJ 5051RD

Prior to using this appliance, please read the user's manual thoroughly, even in cases where you have previously familiarised yourself with the operation of similar types of appliances. Only use the appliance in the manner described in this user's manual. Keep this user's manual in a safe place where it can be easily retrieved for future reference.

We recommend saving the original cardboard box, packaging material, purchase receipt and responsibility statement of the vendor or warranty card for at least the duration of the legal liability for unsatisfactory performance or quality. In the event of transportation, we recommend that you pack the appliance in the original box from the manufacturer.

EN-1

TABLE OF CONTENTS

IMPORTANT SAFETY INSTRUCTIONS	3
DESCRIPTION OF THE JUICER	5
THE PRINCIPLE AND ADVANTAGES OF A SLOW JUICER	6
BEFORE FIRST USE	6
ASSEMBLING THE JUICER	6
USING THE JUICER	7
USEFUL ADVICE AND TIPS	7
DISASSEMBLING THE JUICER	8
CLEANING AND MAINTENANCE	8
STORAGE	9
TECHNICAL SPECIFICATIONS	9
INSTRUCTIONS AND INFORMATION REGARDING THE DISPOSAL OF USED PACKAGING MATERIALS ..	9
DISPOSAL OF USED ELECTRICAL AND ELECTRONIC EQUIPMENT	9

IMPORTANT SAFETY INSTRUCTIONS

READ CAREFULLY AND STORE FOR FUTURE USE.

- This appliance may be used by persons with physical or mental impairments or by inexperienced persons, if they are properly supervised or have been informed about how to use the appliance in a safe manner and understand the potential dangers.
- Children must not use this appliance or play with it. Keep the appliance and its power cord out of their reach.
- The appliance is intended for processing a standard amount of fruit and vegetables in the household. Do not use it for any other purposes than those intended.
- Only place the appliance on a stable, even, dry surface. Do not place it on window sills, sink drainboards, unstable surfaces, on equipment that is a source of heat, or in its vicinity.
- Do not use the appliance in an industrial environment or outdoors.
- Do not use accessories, which have not been supplied with this appliance or which have not been explicitly recommended by the manufacturer for this appliance.
- Before connecting the appliance to a power socket, make sure the voltage stated on its rating label corresponds to the voltage in your power socket.
- Make sure that the appliance is correctly assembled before putting it into operation.
- Prior to juicing, remove hard stones that are contained in, for example, apricots, peaches, mangoes, etc. and inedible peels, e.g. from oranges, pineapples, melons, mandarins, etc.
- Do not use the juicer for processing frozen or excessively hard ingredients, e.g. sugar cane.
- Always use the supplied pusher to push the fruit and vegetables through the feed tube. Never use your hands or other items.

 **Warning:**
Improper use can lead to injury.

- Always turn off the appliance and disconnect it from the power socket when not be using it and when leaving it without supervision, before assembly, disassembly or cleaning.
- Prior to removing accessories or parts that move during use, check that the appliance is turned off and disconnected from the power socket and wait until the moving parts come to a stop.
- Do not wash the base unit of the appliance under running water or submerge it in water or another liquid.
- Ensure that the power plug contacts do not come into contact with water or moisture.
- Do not place heavy items on the power cord. Make sure the power cord does not hang over the edge of a table or that it is not touching a hot surface.
- Do not disconnect the appliance from the power socket by pulling on the power cord. This could damage the power cord or the socket. Disconnect the power cord from the power socket by pulling on the plug.
- It is forbidden to use the appliance if it has a damaged power cord or plug. If the power cord is damaged, have it replaced at a professional service centre.
- Do not use the appliance if any part of it is damaged. To prevent causing a dangerous situation, do not repair the appliance yourself. Have all repairs or adjustments performed at an authorised service centre. By tampering with the appliance, you risk voiding your legal rights arising from unsatisfactory performance or quality warranty.

Slow Juicer

SSJ 5050SS / SSJ 5051RD

EN

DESCRIPTION OF THE JUICER

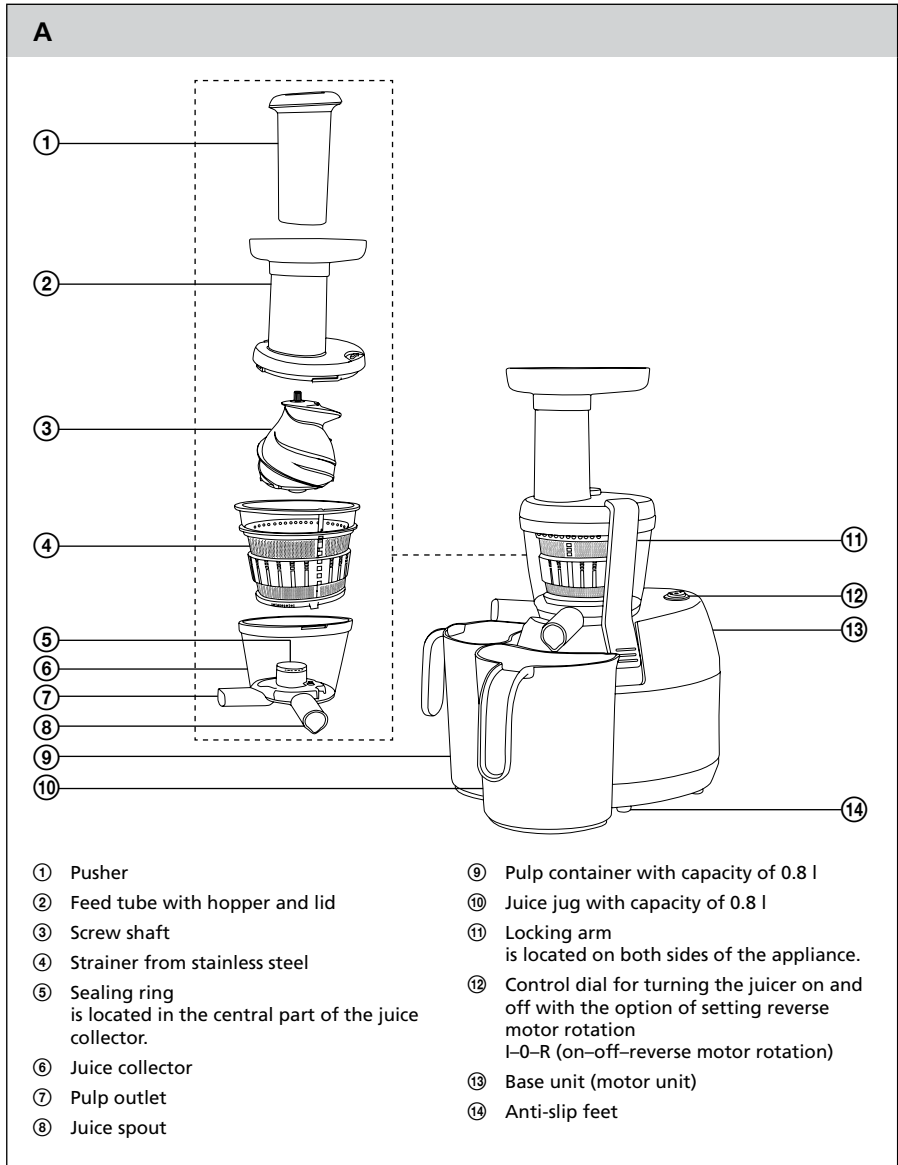

EN-5

Slow Juicer

SSJ 5050SS / SSJ 5051RD

THE PRINCIPLE AND ADVANTAGES OF A SLOW JUICER

- This juicer utilises a slow juicing system. In the first phase, the screw shaft coarsely masticates the inserted ingredients. In the next phase, juice is pressed out and pulp is separated. Juice extracted using the slow juicing process contains only a minor amount of fibre, oxidises slower and retains valuable vitamins and enzymes.
- This juicer is suitable for juicing both soft and hard fruits and vegetables such as citrus fruits, currants, gooseberries and other berries, apples, pears, carrots, beetroot, cucumbers, pineapple, melon, etc. It can even handle leafy vegetables. However, in this case we recommend to juice together with other fruits and vegetables.
- The slow juicer is not particularly suitable for juicing purely leafy vegetables, overripe fruits or floury apples.

BEFORE FIRST USE

1. Remove all packaging materials from the appliance and its accessories.
2. Thoroughly wash all removable parts (pusher A①, feed tube with hopper and lid A②, screw shaft A③, stainless steel strainer A④, juice collector A⑥ and the juice and pulp collector A⑨ and A⑩) that come into contact with food in warm water using kitchen detergent. Then rinse all these parts under clean running water and thoroughly wipe dry with a fine wiping cloth. All removable parts can also be safely washed in a dishwasher.



Attention:

Never submerge the motor unit A⑬ in water or rinse it under running water.

ASSEMBLING THE JUICER

- During assembly, the appliance must be turned off and disconnected from the power socket.
1. Place the base unit A⑬ on an even, dry and stable surface. Ensure that the sealing ring A⑤ is properly attached to the juice collector A⑥. Place the juice collector A⑥ on to the motor unit A⑬ so that both outlets A⑦ and A⑧ fit into the groove in the motor unit A⑬ and that the motor shaft fits into the central hole in the juice collector A⑥.
 2. Insert the strainer A④ into the juice collector A⑥ so that the symbol "•" marked on the top edge of the strainer A④ is aligned with the same symbol on the top edge of the juice collector A⑥. This will align the pulp outlet hole in the bottom part of the strainer A④ with the pulp outlet hole in the juice collector A⑥. Push the strainer A④ downwards.
 3. Insert the shaft A③ into the strainer A④ and push it downwards so that it is properly seated over the hexagonal drive shaft on the motor unit A⑬.
 4. Place the feed tube with hopper and lid A② on to the juice collector A⑥ so that symbol "▼" on the lid A② is aligned with symbol "•" on the juice collector A⑥. Turn the feed tube A② clockwise all the way. This will secure the lid with the feed tube A② on the juice collector A⑥.
 5. Properly secure the lid A② using both locking arms A⑪.
 6. Insert the pusher A① into the feed tube A②. Place the pulp container A⑨ under the pulp outlet A⑦ and place the juice jug A⑩ under the juice spout A⑧. The juicer is now assembled and ready for use.
 7. The juicer is equipped with a safety mechanism that prevents it from being started unless it is correctly assembled.

USING THE JUICER

1. Make sure that the juicer is correctly assembled and that the control dial A⑫ is set to the 0 position (turned off). Then plug the juicer into a power socket.
2. Prepare the fruit or vegetables. Thoroughly wash the ingredients and cut them up into pieces 2 × 4.5 cm that will pass through the feed tube A②. Remove hard stones that are contained in, for example, apricots, peaches, mangoes, etc. inedible peels, e.g. from oranges, pineapples, melons, mandarins, etc. and hard peels, e.g. from potatoes, beetroot, etc.
3. Prior to starting the juicer, make sure that the lid A② is properly secured using the locking arms A⑩. Start the juicer by setting the control dial A⑫ to position I (turned on). Take the pusher A① out of the feed tube A②. Gradually add the prepared ingredients into the feed tube A② and push them down using the pusher A①. You will achieve optimal results if you fill the feed tube A② gradually and push the ingredients down gently.



Attention:

Do not use fingers or other utensils to push ingredients through the feed tube A②. Always use the pusher A① designed for this purpose.

The maximum time of non-stop operation of this appliance is 10 minutes. Then allow it to cool down for 10 minutes.

4. If the juice jug A⑩ or pulp container A⑨ fill up during the juicing process, turn the juicer off by setting the control dial A⑫ to position 0 (off), empty out the respective container and then put it back in its place. Then you can put the juicer back into operation and continue juicing.
5. If the juice collector A⑥ becomes clogged, set the control dial A⑫ to position "R" (reverse motor rotation). Hold it in this position for 3 to 5 seconds and then release it. The control dial A⑫ will return to position 0 (off). Repeat the entire process two to three times. In the same way, we recommend that you remove pulp remains from the juice collector A⑥ when you have finished juicing.



Note:

In the event that the described procedure does not help, it is necessary to turn off the juicer, disconnect it from the power socket, disassemble it and clean the individual parts.

6. After finishing juicing, turn the juicer off by setting the control dial A⑫ to the 0 position (off) and disconnect it from the power socket. We recommend that you only remove the juice jug A⑩ after juice stops dripping from the spout A⑧.
7. After every use, disassemble the juicer, see chapter Disassembling the juicer and clean it out according to the instructions contained in chapter Cleaning and maintenance.

USEFUL ADVICE AND TIPS

- Before you start juicing, thoroughly wash all the ingredients and cut them up into smaller pieces measuring 2 × 4.5 cm that will pass through the feed tube A②. Remove hard stones that are contained in, for example, apricots, peaches, mangoes, etc. inedible peels, e.g. from oranges, pineapples, melons, mandarins, etc. and hard peels, e.g. from potatoes, beetroot, etc.
- To achieve optimal results, always process only fresh ripened fruits and vegetables. Override or unripe fruits and vegetables will negatively affect the resulting taste of the juice.
- If you juice fruits and vegetables of varying consistency, we recommend that you start with the softer fruits and vegetables, e.g. citruses, berries, etc. and then proceed on with harder fruits, e.g. apples.
- We do not recommend juicing bananas because they have a very low juice content.
- Juice leafy vegetables together with other fruits and vegetables, e.g. apples, carrot, beetroot, citruses, etc. pushing them into the feed tube A② at the same time.

Slow Juicer

SSJ 5050SS / SSJ 5051RD

- Do not use the juicer for processing frozen or excessively hard ingredients, e.g. sugar cane.
- Place the ingredients into the feed tube A② gradually and push through gently with mild pressure. Do not overfill the feed tube A② and do not push the ingredients in too quickly and with excessive pressure. The process of separating the juice from the pulp occurs gradually and will not be sped up by pushing ingredients in quickly.
- To prevent freshly pressed apple juice from turning brown, you can add a little lemon juice.
- To prevent losing valuable minerals, we recommended consuming the juice immediately after it is pressed.

DISASSEMBLING THE JUICER

1. Before disassembling the juicer, make sure that it is turned off and disconnected from the power socket. Make sure that all parts that move during operation have stopped moving.
2. Remove the juice jug A⑩ and the pulp container A⑨. Take the pusher A① out of the feed tube A②.
3. Release both the locking arms A⑪ by lifting them upwards and tilting them out towards the juice collector A⑥.
4. Rotate the feed tube A② anticlockwise and take it off the juice collector A⑥.
5. Take the juice collector A⑥ with the strainer A④ and the screw shaft A③ located inside off the base unit A⑬ by lifting it upwards.



Note:

It will be easier to take the juice collector A⑥ off the base unit A⑬ when you clean out the pulp remains after juicing, as described in point 5 in chapter Using the juicer.

6. Over a sink, take the screw shaft A③ and strainer A④ out of the juice collector A⑥.

CLEANING AND MAINTENANCE

- Clean out the juicer after every use. Before cleaning it, make sure that the juicer is turned off, disconnected from the power socket and properly disassembled.
- Remove juice and pulp residues from the juice jug A⑩ and the pulp container A⑨. Thoroughly wash both containers A⑩ and A⑨, the pusher A①, the feed tube with hopper and lid A② and the screw shaft A③ using warm water with kitchen detergent. Then rinse them under clean running water and thoroughly wipe dry with a fine wiping cloth.
- Thoroughly wash the strainer A④ and the juice collector A⑥ under warm running water using kitchen detergent and a fine nylon brush. If you are unsuccessful in cleaning out the small holes in the strainer A④, soak it first in warm water containing lemon juice. Then to finish off, rinse the strainer A④ and the juice collector A⑥ under clean running water and thoroughly wipe dry with a fine wiping cloth.



Note:

We recommend that all accessories are washed immediately after use. Dried on juice and pulp residues are far more difficult to remove and may clog the holes in the strainer A④ and thereby reduce juicing efficiency.

All removable parts can also be safely washed in a dishwasher.

- For cleaning the base unit A⑬, use a cloth lightly dipped in a weak solution of water and neutral kitchen detergent. Then wipe the surface of the base unit A⑬ with a clean dampened cloth and dry thoroughly. Never submerge the base unit A⑬ in water or rinse it under running water.
- Do not use abrasive cleaning products, solvents, thinners, etc. Otherwise the surface may be damaged.

STORAGE

- When not using the appliance, store it in a dry place out of children's reach. You can store the appliance assembled.

TECHNICAL SPECIFICATIONS

Rated voltage range	220–240 V
Rated frequency	50/60 Hz
Rated power input.....	200 W
Noise level	80 dB(A)

The declared noise emission level of the appliance is 80 dB(A), which represents a level A of acoustic power with respect to a reference acoustic power of 1 pW.

Changes to text and technical parameters are reserved.

INSTRUCTIONS AND INFORMATION REGARDING THE DISPOSAL OF USED PACKAGING MATERIALS

Dispose of used packaging material at a site designated for waste in your municipality.

DISPOSAL OF USED ELECTRICAL AND ELECTRONIC EQUIPMENT



This symbol on products or original documents means that used electric or electronic products must not be added to ordinary municipal waste. For proper disposal, renewal and recycling hand over these appliances to determined collection points. Alternatively, in some European Union states or other European countries you may return your appliances to the local retailer when buying an equivalent new appliance.

Correct disposal of this product helps save valuable natural resources and prevents potential negative effects on the environment and human health, which could result from improper waste disposal. Ask your local authorities or collection facility for more details.

In accordance with national regulations penalties may be imposed for the incorrect disposal of this type of waste.

For business entities in European Union states

If you want to dispose of electric or electronic appliances, ask your retailer or supplier for the necessary information.

Disposal in other countries outside the European Union.

This symbol is valid in the European Union. If you wish to dispose of this product, request the necessary information about the correct disposal method from the local council or from your retailer.



This appliance meets all the basic requirements of EU directives related to it.

Slow Juicer

SSJ 5050SS / SSJ 5051RD