



Instruction

Except for the accessories listed as part of the product configuration, the contents of this manual do not represent a commitment by our company.

Our company reserves the right to make changes to this manual without prior notice. We shall not be liable for any direct, indirect, intentional, or unintentional damage or hazards resulting from improper installation or use.

Before ordering the product, please consult your dealer to ensure that the product's performance meets your requirements. All trademarks mentioned in this manual are the property of their respective manufacturers.

The content of this manual is protected by copyright. All rights reserved. No part of this manual may be reproduced in any form or by any means, mechanical, electronic, or otherwise, without prior written permission.



Catalogue

Product Introduction	2
Appearance	3
Operating Instructions	4
Notes	4
Systems manual	8
Level A description	8
Device Installation Steps	9
Warranty Card	11



Introduction

Respected users:

First of all, thanks for purchasing our products, so that we have the opportunity to provide you our best service. In order to make our service more satisfying, please read this instruction and keep it carefully. Thanks.

Product Introduction

The touch screen Industrial all in one PC which we research and design has professional modular structure, powerful function scalability and user-friendly design. Embedded, wall mounting, desk top and other installation is available. Aspect Ratio 4:3 square screen and 16:9 widescreen is optional. Customized function like keyboard, scanners and card reader can be added additional to meet the increasingly diverse needs of various industries.

Main characteristic:

1. The product is an all-in-one machine ,integrated the mainboard, LCD display and touch screen which has good stability.
2. Popular touch function is applied which will simplify the work and make it more convenient and faster, more humanized.
3. The size is small ,the installation and maintain is easy.
4. Low power consumption mainboard is applied which has low power consumption , low noise and stable performance.
5. Appearance is beautiful and application is widely.

Features

1. All-in-one design integrating industrial host, display, and touchscreen, offering stable performance and convenient operation.
2. Supports Windows or Android systems, with a wide range of applications to choose from.
3. Supports multiple touch gestures, combined with optimised algorithms for rapid response, and offers capacitive and resistive touch options.
4. Features a self-developed low-power, high-performance industrial motherboard, ensuring stable and reliable quality.



5. Rich interfaces and customizable expansion options to fully meet the diverse needs of industrial control applications.
6. Widely applied in smart factories, smart healthcare, Industry 4.0, digital factories, and IoT fields.

Accessories

Manual*1, power adapter*1, power cord*1, mounting bracket*1, warranty card and certificate of conformity.

Appearance

1. Appearance style (for reference only)



2. Interface diagram (subject to contract or actual product)

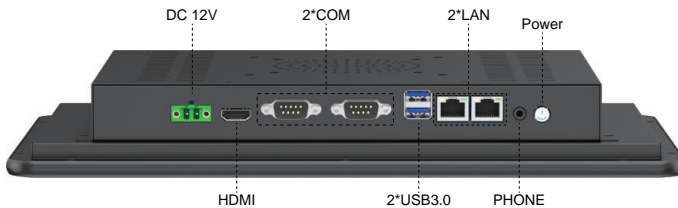



Operating Instructions

Power On

1. Take out the power cord from the bag.
2. Connect the power cord jack to the adapter power connector and the other plug to the power socket.
3. If you need to use the network, you can connect the RJ45net work terminal to the RJ45 network interface of the device. Or use WiFi to connect to the network (only products with WIFI function).
4. Press the host trigger button to start the host

External device access

Other USB devices (such as keyboard, mouse and USB flash drive) can be connected to the USB interface of the device to operate the machine or install software.

Touch screen use

Left-click: Clicking on the screen with your finger is equivalent to the left-click of the mouse;

Double-clicking: Touching the screen twice with the finger is equivalent to double-clicking the mouse;

Right-click: Long-pressing the surface of the touch screen with your finger is equivalent to the right button of the mouse.

Power Off

1. Turn off the host: Click on the bottom left corner to start - shut down.
2. Turn off the power: Turn off the main power switch after the main unit is completely turned off.

Notes

USE Point

1. The touch screen is made of glass, which is easily damaged. Be careful when moving.
2. The main power must be turned off after the shut down.



3. Do not plug or unplug any live parts of the equipment (including external equipment) while the power is on.
4. The device should be covered with a dust cover when it is not in use; and disconnected from the power supply.
5. Please be careful not to pull the connecting wires inside the machine arbitrarily, otherwise it will cause short circuit or open circuit of the power supply or signal; do not disassemble the machine at will, so as not to damage the parts
6. When a fault occurs, immediately turn off the main power supply, unplug the power cord, stop using it, and contact the sellers in time.
7. Do not disassemble or repair it.

Maintenance Point

1. Wipe the surface of the display (touch screen) with a dry cloth before turning it on every day.
2. If the touch point is not positioned correctly, pls calibrate the touch screen according to the calibration instructions.
3. When cleaning the cabinet, wipe the unit with a soft, dry cloth. Do not use wet or chemical (such as gasoline) rags.
4. If you have any questions, please contact us.

Fault Resolution

Situation 1:

When pressing the power button, the PC can not start up :

1. Check whether the power adapter is working properly. If the adapter's indicator light is not on, it means that it is not working. Check whether the power cord and power strip are supplying power normally.
2. The start-up cable is loose or the start-up switch is faulty. Open the back cover under technical guidance and test whether the start-up pins can be started by short-circuiting them.
3. If you hear an alarm sound when starting up, it means that the memory stick is loose or not inserted properly, or that the memory stick is damaged.

Situation 2:

The touch screen does not work, and there is no response when touching any part. (When all the touch cables are plugged into the computer, there



will be a tip reminding to install the driver or discover new hardware in the lower right corner of the computer. Re-plug the USB cable to see if there is any reminder).

1. Infrared touch: first check whether the data cable of the touch screen is loose with the USB interface of the computer motherboard, and then check if there is dust on the border around the touch screen, If so, use a soft cloth to remove it. Observe if the indicator light on the control box is working properly. The indicator light is green and blinks when it is normal. The power cord is loose, resulting in failure to supply power properly; re plugging; The start wire is loose or the start switch is broken. If the start line is re-plugged and it still cannot be solved, the start switch and start wire need to be replaced.
2. Resistive touch: First check if the USB cable of the touch control card connected with the computer motherboard is loose or dropped, and then re tighten it. Next, on normal work, the control card indicator is green, the touch is normal with flashing.
3. Capacitive touch: First check if the USB cable of the touch control card connected with the computer motherboard is loose or dropped, and then re-tighten it. Next, check if the touch control card and the touch screen cable are tight, if it is loose, re-chuck it.

Situation 3:

When I click on the screen, the mouse can only move in the upper left corner of the screen?

1. The machine does not have the driver installed. Install the driver.
2. Check if the machine is frozen. Restart the machine.

Situation 4:

How do I clean the touch screen?

Spray computer screen cleaner on a towel and wipe the glass surface with the towel. In general, you can wipe the dust off the glass surface directly with a dry towel.

Situation 5:

How to solve the problem of the mouse pointer jumping around?

Poor grounding of the machine's power supply causes static electricity on the controller to interfere with the system. Please connect the ground wire



on the controller to the ground through other conductive media (such as an all-in-one machine cabinet with good grounding performance).

Situation 6:

The machine has no sound?

1. Check the volume playback key to see if the sound is set to minimum.
2. Check whether the power cord of the amplifier is properly connected to the power outlet.
3. Check whether the audio plug is properly connected to the computer motherboard.

Situation 7:

Blue screen on startup?

1. 7B is usually caused by an incorrect hard drive mode. Press the Delete key during startup, go to BIOS Advanced Settings, and set the SATA settings to IDE or AHCI for the hard drive mode. The second possibility is a system issue—reinstall the system.
2. 50 indicates a memory module issue—the memory module may be loose or faulty.
3. 24 typically indicates a hard drive failure—check the hard drive sectors.
4. B4 typically indicates a graphics card issue or driver problem.
5. 7E or 8E indicates a virus.
6. D1 indicates a graphics card failure.

Situation 8:

System issues

1. The system automatically enters the repair interface and prompts for restoration. In such cases, an external USB keyboard is required. During the boot process, when the system displays the loading screen (countdown interface), use the arrow keys on the keyboard to select “Normal Boot” to start the Windows system (the issue is caused by an illegal power shutdown, causing the system to automatically jump to the repair interface).
2. When reinstalling the system, the quick access key is F11. Contact after-sales technical support for remote guidance.



Systems manual

System: Unless otherwise specified, the system is compatible with Windows 10 or later versions. The system provided with our products is for testing purposes only. Customers may install their preferred system version. We recommend using genuine software. For touchscreen drivers, please contact our after-sales service team.

Note: Resistive touchscreens only support single-point touch and require driver installation on any system. Capacitive touchscreens support 10-point touch. On Windows 10 or later versions, capacitive touchscreens are driver-free; however, Windows 10 systems require driver installation.

Level A description

This is grade A product, it may be make radio interference in living environment. In this situation, users may be required to adopt somepractical measures to solve it.



To prevent sudden danger, please use a three-phase plug for the power cord plug. For normal use, this product must be in reliable contact.



High voltage danger, please pay attention to safety

Device Installation Steps

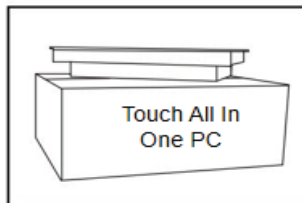

1. Remove all accessories from the packaging box.

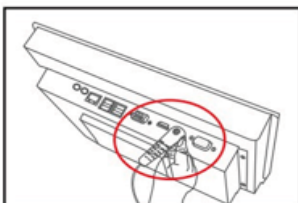

2. Connect the power cord and press power switch to start

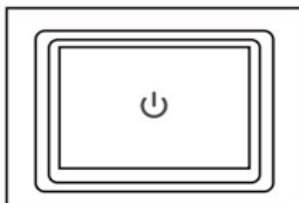

3. It may take a little longer to start up first time. Please wait.

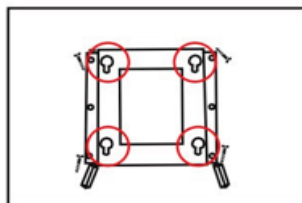

4-1. Secure the wall panels to the wall horizontally using self-tapping screws.

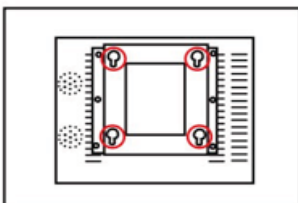

4-2. Use four screws to align the fixing slot of the wall bracket and insert it. Gently move it to the under and insert to the fixing slot.

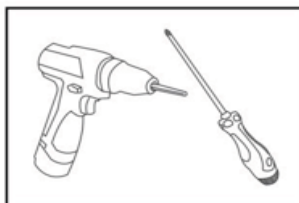

4-3. Use the electric drill or screwdriver to install.

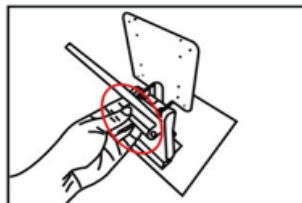

5-1. Folding bracket: First take apart the decorative plastic panel at the back of the folding stand, then align the folding bracket to 100*100 VESA hole.

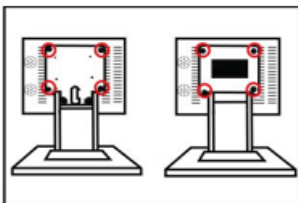

5-2. Fix the folding bracket to the machine with M4 screws, cover the decorative plastic cover, then twist it with the M3 screw.

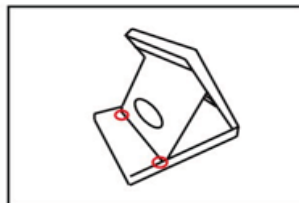

6-1. Triangle base: First, secure the rectangular adapter plate to the machine using M4 screws.

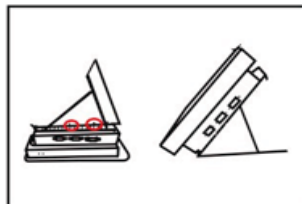

6-2. Place the triangle base in the aligned position, then fix it with M3 screws from both sides. Final, power on the machine.

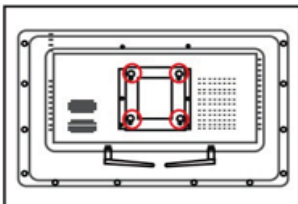

7-1. K-typed stand: First, fix the fixing screws to the back of the machine to reserve space for the card to the bottom, then take out the base from the package and lay it flat.

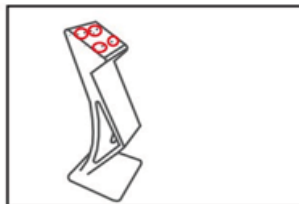

7-2. Align the machine with the cardslot on the base and gently move it down to the slot.

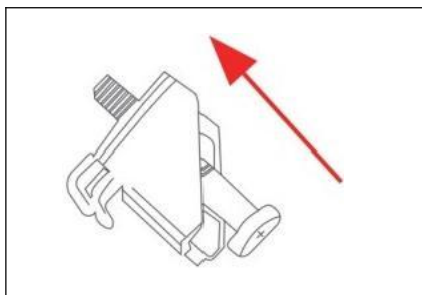

8-1.Snap-on installation: First, remove the snap-on screw, and use a long screw to twist the screw into the snap-on part in a certain direction as shown in the figure.

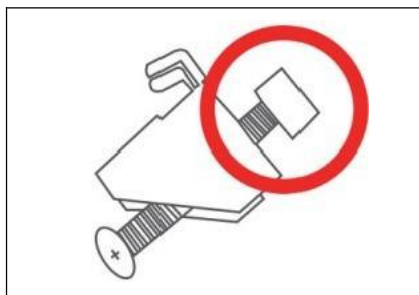

8-2.Lock the snap nut onto the long screw, just enough to lock it flat, without protruding.

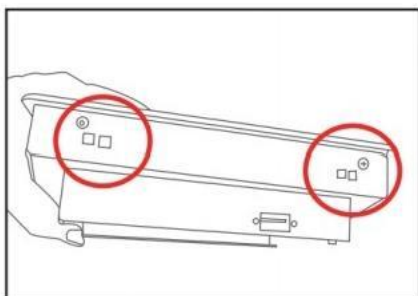

8-3.Insert the machine into the reserved installation hole, then insert the clip into the clip slot reserved for the machine from the back.

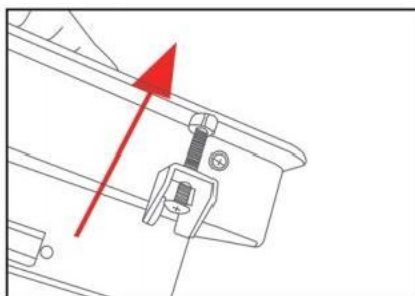

8-4.Then, turn the long screws clockwise to secure the machine to the clip plate. Generally, there are two clip screws on each side.

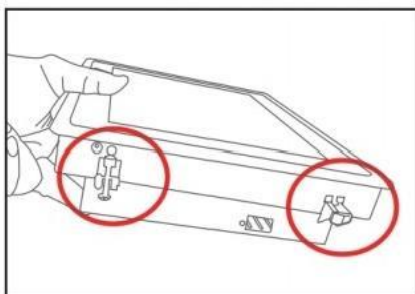

8-5.Tighten all four screws at the same time to secure the machine in place. You can then use the machine normally by connecting it to the power supply.

Warranty Card

Warranty Terms and Conditions

Dear Customer:

Thank you for choosing our company's products. This not only reflects your high trust in the quality of our product series but also demonstrates your great trust and support for our after-sales service system. To help you use our products more conveniently, please read the following warranty terms carefully:

1. Our products are covered by the national “return, exchange, and warranty” three-guarantee service.
2. The entire machine is warranted for three years, with specific warranty matters handled in accordance with national regulations.
3. For products purchased beyond the warranty period, paid after-sales service will be provided.
4. If you encounter any issues while using our products, you may contact our service hotline or dealer phone number, and we will promptly provide you with satisfactory service.
5. Exclusions from free warranty: The free warranty is valid only under normal usage conditions. In the following situations, our company will charge relevant repair fees:
 - 1) Machine failures caused by natural disasters or force majeure (non-product quality factors), such as fire, flood, electric shock, earthquake, etc.;
 - 2) Equipment failures or damage caused by improper use, maintenance, or storage by the user;
 - 3) Damage caused by unauthorized disassembly or modification of hardware or software without authorization from Senke or the dealer;
 - 4) The product serial number is unclear, altered, or removed;
 - 5) Products obtained through promotional offers or gifts are not covered by the above warranty commitment; Removing the anti-counterfeiting label constitutes a voluntary waiver of the warranty;If any of the above terms conflict with the national “Three Guarantees” regulations, the national regulations shall prevail.

Warranty Card

Warranty Card			
Username		User Address	
Contact		Contact Number	
Product Name		Specifications	
Purchase date		Factory number	
Maintenance Records	Date	Cause of failure	Handling Situation

IC Statement

This device complies with Industry Canada licence-exempt RSS standard(s). Operation is subject to the following two conditions:

- (1) this device may not cause interference;
- (2) this device must accept any interference, including interference that may cause undesired operation of the device.

Operation of this device is restricted to indoor use only. (5150-5250MHz) This equipment complies with IC radiation exposure limits set forth for an uncontrolled environment. This equipment should be installed and operated with minimum distance of 20 cm between the radiator and your body. This transmitter must not be co-located or operating in conjunction with any other antenna or transmitter.

Devices shall not be used for control of or communications with unmanned aircraft systems.

Devices shall not be used on oil platforms.

Devices shall not be used on aircraft, except for the low-power indoor access points, indoor subordinate devices, low-power client devices, and very low-power devices operating in the 5925-6425 MHz band, that may be used on large aircraft as defined in the Canadian Aviation Regulations, while flying above 3,048 metres (10,000 feet). Devices shall not be used on automobiles. Devices shall not be used on trains.

Devices shall not be used on maritime vessels.

Le présent appareil est conforme aux CNR d'Industrie Canada applicables aux appareils radio exempts de licence. L'exploitation est autorisée aux deux conditions suivantes:

- (1) l'appareil ne doit pas produire de brouillage;
- (2) l'utilisateur de l'appareil doit accepter tout brouillage radioélectrique subi, même si le brouillage est susceptible d'en compromettre le fonctionnement.

Le fonctionnement de cet appareil est limité à une utilisation en intérieur uniquement.

(5150-5250MHz)

Cet équipement est conforme aux limites d'exposition aux rayonnements de la IC établies pour un environnement non contrôlé. Cet équipement doit être installé et fonctionner à au moins 20cm de distance d'un radiateur ou de votre corps. Cet émetteur ne doit pas être co-localisé ni fonctionner en conjonction avec une autre antenne ou un autre émetteur.

L'équipement ne doit pas être utilisé pour contrôler ou communiquer avec les systèmes d'aéronefs sans pilote. L'équipement ne doit pas être utilisé sur une plate-forme pétrolière.

L'équipement ne doit pas être utilisé à bord d'un aéronef, à l'exception des points d'accès intérieurs de faible puissance, de l'équipement esclave intérieur, de l'équipement client de faible puissance et de l'équipement de très faible puissance fonctionnant dans la bande 5925 - 6425 MHz qui peuvent être utilisés sur de gros aéronefs tels que définis dans le règlement de l'aviation canadien et volant à des altitudes supérieures à 3048 m (10 000 FT). L'équipement ne doit pas être utilisé dans la voiture.

L'équipement ne doit pas être utilisé à bord du train.

L'équipement ne doit pas être utilisé à bord des navires en mer.

The radio transmitter IC: 35032-SKBST236 has been approved by The Ministry of Innovation, Science and Economic Development of Canada to use the following antenna types with the specified maximum allowed gain. Antenna types not included in this list, whose gain is higher than the maximum gain of any type listed, are strictly prohibited from use with this device.

Cet émetteur radio IC : 35032-SKBST236 a été approuvé par Innovation, Sciences et Développement économique Canada pour fonctionner avec les types d'antenne énumérés ci-dessous, avec le gain maximal admissible indiqué. Les types d'antenne non inclus dans cette liste qui ont un gain supérieur au gain maximum indiqué pour tout type répertorié sont strictement interdits pour une utilisation avec cet appareil.

Type of antenna:Ⓢ	External antennaⓈ
Antenna Gain:Ⓢ	2.4G :2400-2500(0.7dBi)Ⓢ 5G :5150-5850MHz(0.9dBi)Ⓢ 6G:5925-7125MHz(0.8dBi)Ⓢ
Impedance:Ⓢ	50hmⓈ
Manufacture:Ⓢ	Shenzhen <u>Zhenyixing</u> Technology Co., Ltd.Ⓢ
Model:Ⓢ	WIFI6EⓈ

FCC STATEMENT

This device complies with Part 15 of the FCC Rules. Operation is subject to the following two conditions:

- (1) This device may not cause harmful interference, and
- (2) This device must accept any interference received, including interference that may cause undesired operation.

This equipment has been tested and found to comply with the limits for a Class B digital device, pursuant to part 15 of the FCC Rules. These limits are designed to provide reason-able protection against harmful interference in a residential installation. This equipment generates, uses and can radiate radio frequency energy and, if not installed and used in accordance with the instructions, may cause harmful interference to radio communica-tions. However, there is no guarantee that interference will not occur in a particular installation. If this equipment does cause harmful interference to radio or television reception, which can be determined by turning the equipment off and on, the user is encouraged to try to correct the interference by one or more of the following measures:—Reorient or relocate the receiving antenna.

—Increase the separation between the equipment and receiver.

—Connect the equipment into an outlet on a circuit different from that to which the receiver is connected.

—Consult the dealer or an experienced radio/ TV technician for help.

This device complies with part 15 of the FCC rules. Operation is subject to the following two conditions(1)this device may not cause harmful interference, and (2) this device must accept any interference received, including interference that may cause undesired operation.

This equipment complies with FCC radiation exposure limits set forth for an uncontrolled environment.

This equipment should be installed and operated with minimum distance 20cm between the radiator & your body.

Transmitters in the 5.925-7.125 GHz band are prohibited from operating to control or communicate with unmanned aircraft systems.

FCC regulations restrict the operation of this device to indoor use only. It is prohibited on oil platforms, cars, trains, boats, and aircraft, except it is permitted in large aircraft while flying above 10,000 feet.

This product is only suitable for indoor used onl