

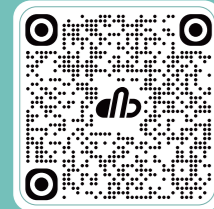

DB-Basscast F37



Scan for Amazon Support



Scan to View Full User Guide

After-sales Contact: 1-833-833-2013 E-mail: ussupport@dbsono.com

WHAT'S IN THE BOX?

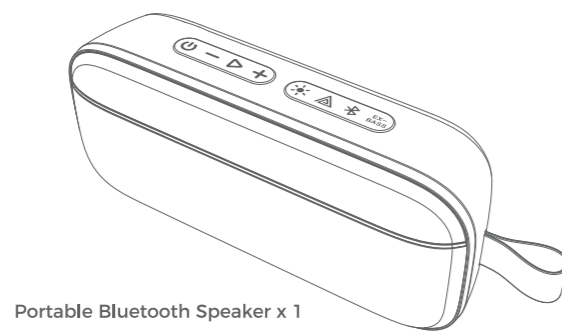

Portable Bluetooth Speaker x 1

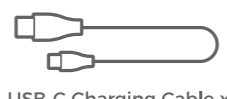

USB-C Charging Cable x 1



User Manual x 1

Note: Do not use if the product is partially damaged. Please contact us by email at: ussupport@dbsono.com or call the DBSONO Customer Service Center at: 1-833-833-2013

Product Overview

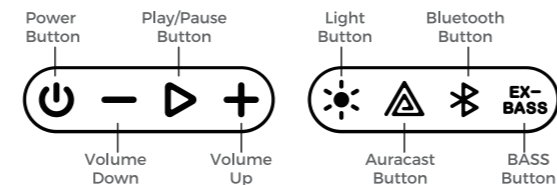

Function Guide

Button	Short Press	Long Press	Double Press
Power	Power On / Off	Power On / Off	—
Volume Down (–)	Decrease Volume	Previous track (Bluetooth mode)	Decrease volume
Play/Pause	Play / Pause	—	—
Volume Up (+)	Increase Volume	Next track (Bluetooth mode)	Increase volume
Light	Switch lighting mode (6 modes total)	Turn lighting & button indicators On / Off	Switch lighting mode
Auracast	Enable / Disable Auracast broadcast mode (the speaker connected to Bluetooth acts as host, the one not connected acts as guest)	—	—
Bluetooth	Mode switch (switch between Bluetooth mode and Type-C playback) / Exit Auracast	Disconnect Bluetooth / Reconnect Bluetooth	Enable / Exit TWS (Both the host and guest speakers must double-press)
BASS	Turn Bass Boost On / Off	—	—

Press and hold the Volume Up and Volume Down keys together for 5 seconds. The speaker will announce the software version. All lights will turn white for 5 seconds. Bluetooth connections will be cleared, volume will be reset to 8 levels, and the speaker will power off. After long-pressing the Light key to turn off the button indicators, pressing any key will activate the button indicators again.

LED Indicator Status

Indicator	Status	Light Behavior
Power	Power On (Normal Battery)	Solid White
	Power On (Low Battery)	Flashing White Slowly
	Charging	Flashing White Slowly
	Fully charged	Light Off
Charging (Liquid Detected in Port)	Charging (Liquid Detected in Port)	Flashing White and Yellow Lights Alternately
	Not Connected/Pairing	Flashing White Slowly
Bluetooth	Connected	Solid White
	Waiting for TWS Pairing	Flashing White Quickly
TWS	Connected but Not Playing	Flashing White Slowly
	Playing	Solid White
Light	Not Connected	Solid White
	Lights On	Solid White
Light Off	Lights Off	Light Off
	Entering Link Mode	Flashing White Slowly
Exiting Link Mode	Off	Off
Primary (Host) Speaker	Primary (Host) Speaker	Flashing White Slowly
	Secondary (Client) Speaker	Solid White
EX-BASS	BASS On	Solid White
	BASS Off	Light Off

STRAP CONFIGURATIONS

You can use the strap as a finger loop for easy portability of the speaker. It can also be attached to a carabiner or rope.

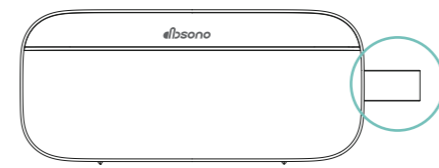

Water and Dust Resistance

This speaker is waterproof, splash-proof and dustproof with an IP56 rating. It withstands daily splashes and rain, giving you peace of mind for outdoor use.

Precautions: Do not immerse the speaker in any type of liquid. After contact with water, wipe off any residue from the surface.

Ensure the charging port is completely dry before charging.

Never attempt to charge the speaker while it is wet, as this may cause damage to the unit.



Bluetooth Pairing

First-time Pairing

1. Long press the Power button to turn on the speaker. Short press the Bluetooth button. The speaker enters Bluetooth pairing mode, and the Bluetooth button indicator flashes white slowly.

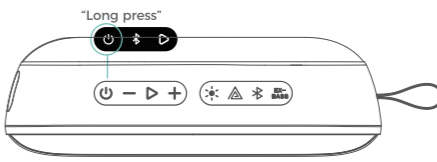

2. On your smartphone, tablet, or other device, turn on Bluetooth and search for DB BassCast in the list of available devices.

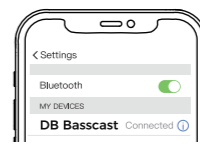

3. Select DB BassCast to connect. You will hear a confirmation tone, and the Bluetooth button indicator turns solid white.

Disconnecting and Reconnecting

To disconnect from the current device and pair with a new one, long press the Bluetooth button on both speakers. The speaker re-enters pairing mode (flashing white slowly). To reconnect to a Bluetooth device, long press the Bluetooth button again.

Auto-reconnect

When powered on, the speaker automatically attempts to reconnect to the last paired device.

TWS Pairing

1. Power On: Turn on both speakers.

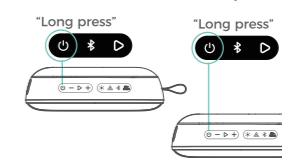

2. Enter Pairing Mode: Double-press the Bluetooth button on both speakers. The Bluetooth indicator will flash white quickly.

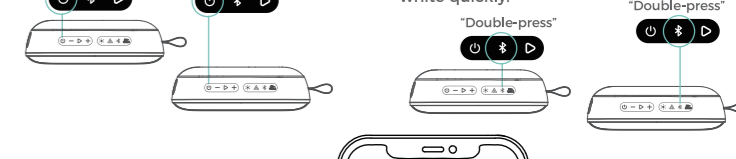

3. Connect: Go to your device's Bluetooth settings and select "DB Basscast".

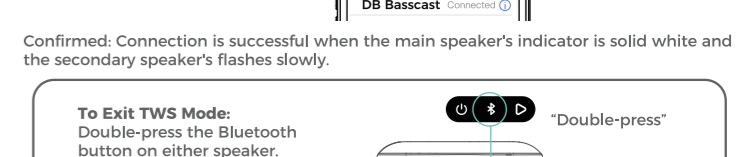

Confirmed: Connection is successful when the main speaker's indicator is solid white and the secondary speaker's flashes slowly.

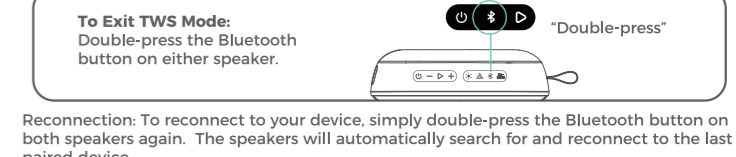

Reconnection: To reconnect to your device, simply double-press the Bluetooth button on both speakers again. The speakers will automatically search for and reconnect to the last paired device.



Auracast Mode

Connect one speaker to your phone via Bluetooth, then short press the Auracast button on multiple Auracast-compatible speakers (up to 100 units) at the same time to sync audio playback. The speaker connected to Bluetooth serves as the host, while the other speakers act as guests.

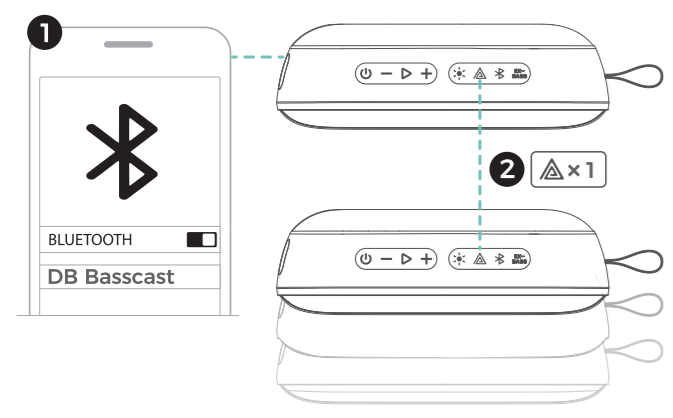

Mode	LED indicator Status
Entering Link Mode	Flashes white slowly
Exiting Link Mode	Off
Host speaker	Flashes white slowly
Guest speaker	Solid white

Specifications

Model	F37
Bluetooth Version	V6.0
Bluetooth Range	> 30 meters (96 ft)
Lighting mode	6 types
Connection method	Bluetooth wireless connection
Charging Input	5V = 2A
Charging Time	2.5 hours
Playback Time	> 8 hours (varies with volume & content)
Dimensions	20.2*6.4*9.09 cm (7.97*2.52*3.58 inches)
Waterproof Rating	IPX5
Auto Power-Off	Turns off after 15 minutes when idle (no Bluetooth connection or no playback).

How to Reset (to factory defaults)

With the speaker powered on: Press and hold the + and - buttons together for 5 seconds. You will hear a voice announcement of the software version. All indicator lights will shine solid white for 5 seconds, indicating the reset is in progress. The speaker will clear the Bluetooth pairing list and automatically power off.

Troubleshooting

- Q 1. Unable to Power On?**
A The battery may be completely depleted. Please charge the speaker for at least 30 minutes before trying again.
- Q 2. Speaker Fails to Connect to Mobile Device?**
A Make sure the speaker is in pairing mode (Bluetooth indicator flashes white slowly). Ensure Bluetooth is turned on your device and it is within the 30-meter effective range. Try forgetting or unpairing "DB-Basscast" from your device's Bluetooth list, then search again. Clear the speaker's pairing list and reconnect.
- Q 3. Sound is Choppy or Poor Quality?**
A Move the speaker closer to your Bluetooth device (within 30 meters / 96 ft), and keep it away from obstacles and wireless interference sources such as Wi-Fi routers or microwave ovens.
- Q 4. No sound?**
A Make sure the voice prompts are enabled. Press the Bluetooth button to check the connected device and confirm you are using the correct one. Try a different music source. Connect to a different mobile device. If two devices are connected, pause the audio on the first device and play audio from the second one. If two devices are connected, move both devices within the speaker's range (96 ft).
- Q 5. Speaker Fails to Charge?**
A Make sure the connector on the charging cable is properly aligned with the port on the speaker. Try a different power source. Secure both ends of the USB-C cable. If the speaker has been exposed to extreme high or low temperatures, allow it to return to room temperature before charging.
- Q 6. How to Switch Between TWS and Auracast Mode?**
A TWS → Auracast: Briefly press the Auracast button on both speakers. Auracast → TWS: Double-press the Bluetooth button on both speakers.

Important Safety Instructions

- Read and keep these instructions, read all warnings and follow all instructions.
- Warning: (If applicable) Please refer to any important information (e.g., electrical safety, etc.) printed on the exterior bottom enclosure or rear panel before installing or operating the product.
- Important Safety Information: (If applicable) Do not use this apparatus near water. The apparatus shall not be exposed to dripping or splashing and shall not be used near liquids, such as vessels, that will be placed on the apparatus. Electrical equipment should NEVER be kept or stored in damp environments.
- Water and Moisture: (If applicable) Do not use this apparatus near water. The apparatus shall not be exposed to dripping or splashing and shall not be used near liquids, such as vessels, that will be placed on the apparatus. Electrical equipment should NEVER be kept or stored in damp environments.
- Do not block any ventilation openings. Install in accordance with the manufacturer's instructions. Do not install this equipment in a confined or "boxed-in" space such as a bookcase or similar unit, and maintain good ventilation conditions. The ventilation should not be impeded by covering the ventilation openings with items such as newspaper, tablecloths, curtains, etc.
- Do not install near any heat sources such as radiators, heat registers, stoves, or other apparatus (including amplifiers) that produce heat. Do not place exposed flame sources such as lit candles on the apparatus.
- Do not use this product if the power supply unit of the type described in these operating instructions, or as marked on the unit.
- Be careful not to damage the power cord. When moving or not using the appliance, secure the power cord (e.g., wrap it with a cord tie), before using it again, make sure the power cord has not been damaged. If the power cord has been damaged at all, bring the unit and cord to a qualified service technician for repair or replacement as specified by the manufacturer.
- Unplug this apparatus during lightning storms or when unused for long periods of time.
- Do not casually use interior accessories that do not meet the electrical requirements of the device.
- Use only the cord, stand, tripod, bracket, or table specified by the manufacturer, or sold with the apparatus. When a cord is used, use caution when moving the cord/appliance combination to avoid injury from tripping.
- Internal voltage selectors (if applicable), internal or external voltage selector switches, if any, should only be reset and re-equipped with a proper plug for alternative voltage by a qualified service technician. Do not attempt to do this yourself.
- Additional Battery Warning: (If applicable) Replacement of a battery with an incorrect type may defeat a safeguard; disposal of a battery into fire or a hot oven, or mechanically crushing or cutting of a battery, may result in an explosion; leaving a battery in an extremely high temperature surrounding environment, such as a sunbather, fire, or a hot surface, may result in an explosion or leakage of flammable liquid or gas. A battery subjected to extremely low air pressure may result in an explosion or the leakage of flammable liquid or gas. Risk of fire or explosion if the battery is replaced by an incorrect type!
- Internal voltage selectors (if applicable), internal or external voltage selector switches, if any, should only be reset and re-equipped with a proper plug for alternative voltage by a qualified service technician. Do not attempt to do this yourself.
- Protective earthing terminal (if applicable): The apparatus should be connected to a mains socket outlet with a protective earthing terminal.
- For Class II apparatus only: This symbol means the equipment is a Class II double-insulated electrical appliance. It has been designed in such a way that it does not require a safety connection to electrical earth. When servicing, use only identical replacement parts installed by or instructed person or with the aid of ready-made leads or cords.
- Warning: (If applicable) Provide an earthing connection before the mains plug is connected to the mains. When disconnecting the earthing connection, be sure to disconnect it after pulling the mains plug out from the mains.
- Warning: (If applicable) Where the mains plug on an appliance couples up used on the disconnect device, the disconnect device shall remain readily operable.
- Warning: (If applicable) To prevent possible hearing damage, do not listen at high volume levels for long periods.
- This apparatus is for professional use only. It is not intended for general consumer use.

Important Tips

- Environment and temperature:** Operating temperature should be between 0°C to 40°C / 32°F to 104°F. Operating temperature should be between 0°C to 40°C / 32°F to 104°F. Keep away from extreme temperature environments (such as high temperature fire, direct sunlight or extremely cold environment) to avoid battery damage.
- To avoid potential radio interference to other users, the antenna type and its gain should be chosen that the equivalent isotropically radiated power (e.i.r.p.) is not more than that necessary for successful communication. This radio transmitter (identify the device by certification number, or model number if Category II) has been approved by ISED to operate with the antenna types listed below with the maximum permissible gain and required antenna impedance for each antenna type indicated. Antenna types not included in this list, having a gain greater than the maximum gain indicated for that type, are strictly prohibited for use with this device. This unit does not exceed the Class II limits for radio noise emission from digital apparatus set out in the radio interference regulations of the Canadian Department of Communications. This device operates on a non-protected, non-interference basis. Should the user seek to obtain protection from other radio services operating in the same TV bands, radio licence is required. For further details, consult Innovation, Science and Economic Development Canada's document Client Procedures Circular CPC-2428, Voluntary Licensing of License-Exempt Low-Power Radio Apparatus in the TV Bands.
- For wireless products supporting the 5.15-5.35 GHz frequency band:** (If applicable) Usage of the 5.15-5.35 GHz band are restricted to indoor operation only. This applies to the following countries: AT, BE, BG, CZ, DK, EE, FR, DE, ES, IL, IT, EL, CY, LV, LT, LU, HU, MT, NL, NO, PL, PT, RO, SE, SK, TR, UK, UK, UK, UK.
- For 240-volt use in U.K., use NEMA-415k 240-volt plug. For other countries use proper plug for local outlet.
- ESD/RFI Warning:** This unit may contain a microcomputer for signal processing and control functions. In very rare situations, severe interference, noise from an external source, or static electricity may cause it to lock up. In the unlikely event that this should happen, turn off the unit, wait at least five seconds, and then turn it back on again. The pins of connectors identified with this ESD warning symbol should not be touched.
- ⚠ The product or remote control contains a button cell or coin battery (CR1202, CR2025, or CR2032, 3.0 VDC).**
- WARNING:**
 - INGESTION HAZARD: This product contains a button cell or coin battery.
 - DEATH or serious injury can occur if ingested.
 - A swallowed button cell or coin battery can cause Internal Chemical Burns in as little as 2 hours.
 - KEEP new and used batteries OUT OF REACH OF CHILDREN.
 - Seek immediate medical attention if a battery is suspected to be swallowed or inserted into any part of the body. Call a local poison control center for treatment information.
- Button cell or coin batteries located inside the product are non-rechargeable. Do not force discharge, recharge, (non-rechargeable batteries are not to be recharged), disassemble, heat above manufacturer's specified temperature rating, or incinerate. Doing so may result in injury due to venting, leakage, or explosion resulting in chemical burns.
- Disposal of batteries:** (If applicable) Remove and immediately recycle or dispose of used batteries according to local regulations and keep away from children. Even used batteries may cause severe injury or death. Do NOT dispose of batteries in household trash or incinerate. Overheated batteries can rupture or explode. If you are unsure of how or where to dispose of a battery, refer to your local ordinances for the proper location, method, etc.
- Disposal of batteries:** (If applicable) Remove and immediately recycle or dispose of used batteries according to local regulations and keep away from children. Even used batteries may cause severe injury or death. Do NOT dispose of batteries in household trash or incinerate. Overheated batteries can rupture or explode. If you are unsure of how or where to dispose of a battery, refer to your local ordinances for the proper location, method, etc.
- ⚠ DANGER: LASER RADIATION:** The laser beam from this device is not intended for use as a laser. Do not stare into the beam. Do not use the device in a way that could cause eye injury. Do not use the device in a way that could cause fire or explosion. Do not use the device in a way that could cause damage to property. Do not use the device in a way that could cause damage to health. Do not use the device in a way that could cause damage to the environment. Do not use the device in a way that could cause damage to the device.
- ⚠ DANGER: LASER RADIATION:** The laser beam from this device is not intended for use as a laser. Do not stare into the beam. Do not use the device in a way that could cause eye injury. Do not use the device in a way that could cause fire or explosion. Do not use the device in a way that could cause damage to property. Do not use the device in a way that could cause damage to health. Do not use the device in a way that could cause damage to the environment. Do not use the device in a way that could cause damage to the device.
- ⚠ DANGER: LASER RADIATION:** The laser beam from this device is not intended for use as a laser. Do not stare into the beam. Do not use the device in a way that could cause eye injury. Do not use the device in a way that could cause fire or explosion. Do not use the device in a way that could cause damage to property. Do not use the device in a way that could cause damage to health. Do not use the device in a way that could cause damage to the environment. Do not use the device in a way that could cause damage to the device.

770*105MM
105克铜版纸正反面彩色印刷, 折页

