



Please keep this instruction sheet for future reference,  
as it contains important information.

Requires four AA (LR6) and two AAA (LR03) **alkaline** batteries (batteries not included).

Adult assembly is required.

Tool required: Phillips screwdriver (not included).

Use as a mobile from birth until 5 months.

A mobile is intended for visual stimulation and not to be grasped by a child.

Wipe this toy with a clean, damp cloth. Do not immerse this toy.

## Assembled Parts



Base



Soother  
(2 pieces)



Mobile



Mobile Arm

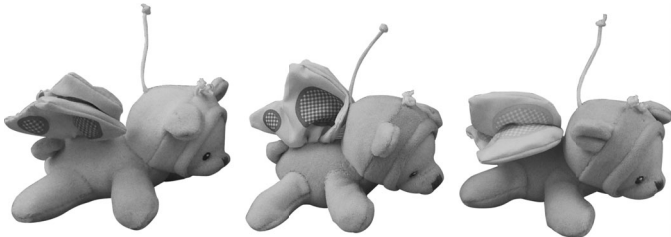

3 Toys

**Note:** All of the screws used to assemble this toy are attached to the product. Follow these instructions carefully to fully secure the screws. Tighten and loosen all screws with a Phillips screwdriver. Do not over-tighten the screws.

# Mobile Assembly

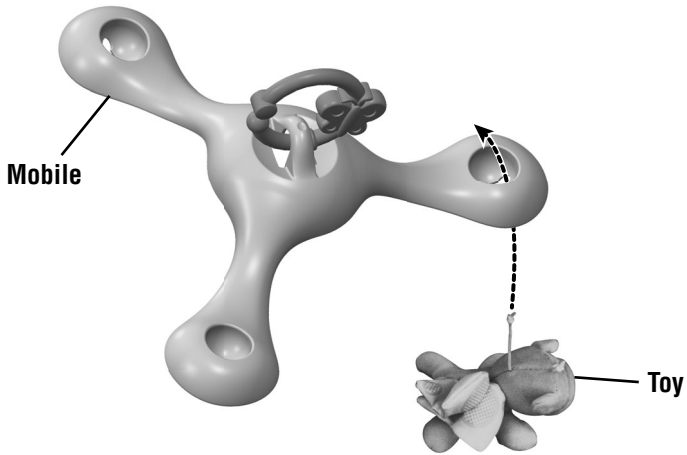

1

- Slide the string on each toy into each slot in the mobile.
- Pull the strings down to secure in place.

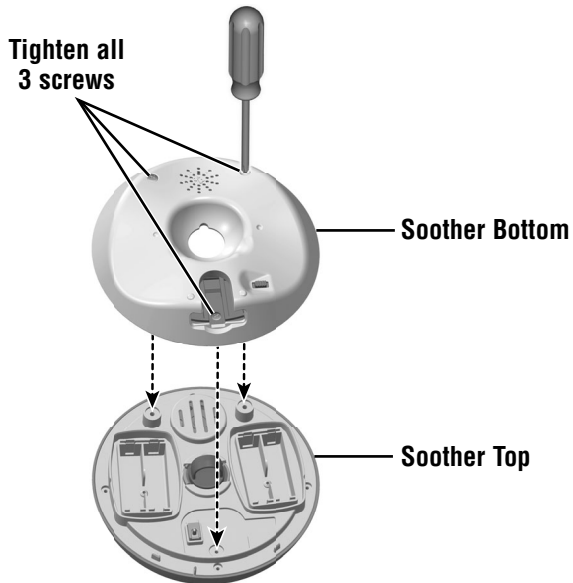

2

**Hint:** You may want to install the batteries in this product before assembling soother. See the **Battery Installation** section.

- Fit the top and bottom of the soother together. Tighten the three screws in the soother.

# Mobile Assembly

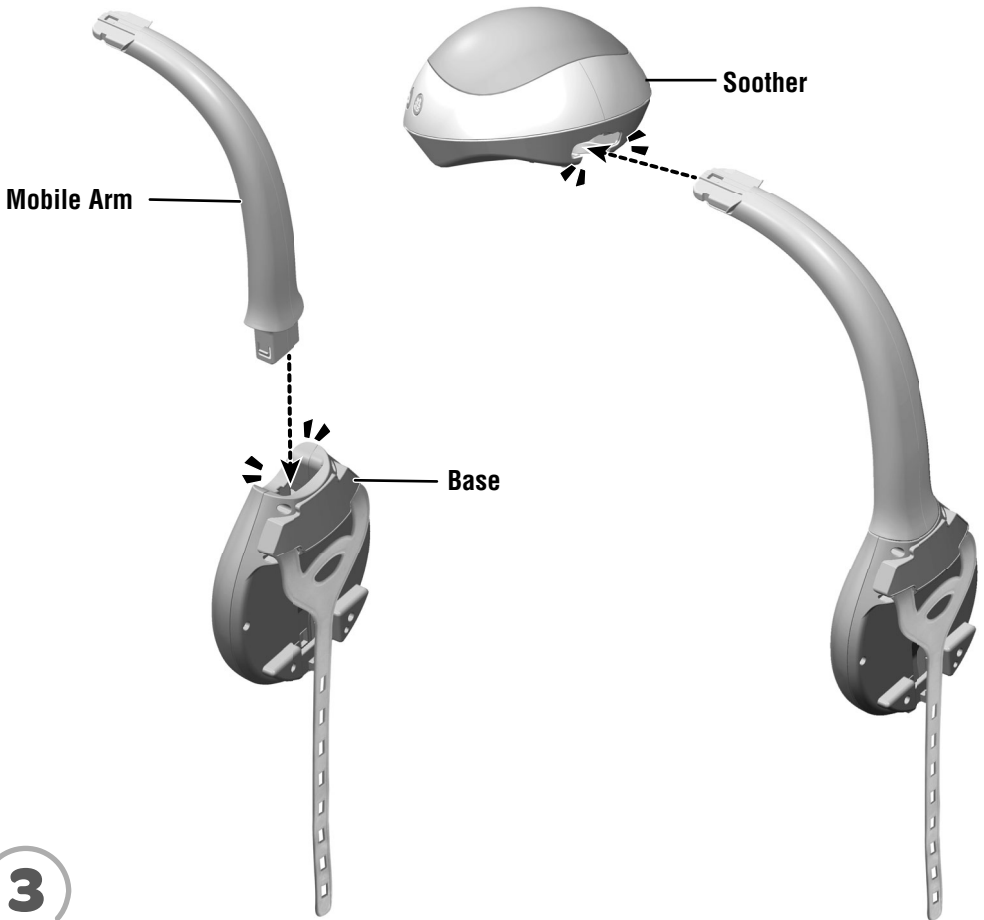

3

- Fit the mobile arm into the socket in the top of the base. Push to **“snap”** in place. This is a permanent assembly.
- **“Snap”** the mobile arm into the socket in the soother.

# Mobile Assembly

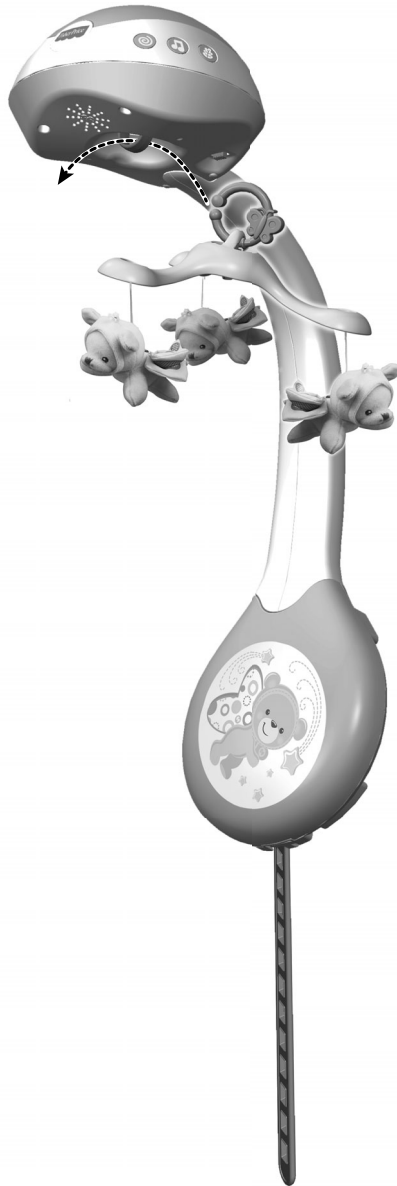

4

- Fit the open end of the link toy onto the soother.

# Consumer Information



## CONSUMER ASSISTANCE

1-800-432-5437 (US & Canada)  
1300 135 312 (Australia)

**service.fisher-price.com**

Fisher-Price, Inc., 636 Girard Avenue, East Aurora, NY 14052.  
Hearing-impaired consumers: 1-800-382-7470.

**Outside the United States:**

Canada: Mattel Canada Inc., 6155 Fremont Blvd.,  
Mississauga, Ontario L5R 3W2; [www.service.mattel.com](http://www.service.mattel.com).

Great Britain: Mattel UK Ltd, Vanwall Business Park,  
Maidenhead SL6 4UB. Helpline: 01628 500303.  
[www.service.mattel.com/uk](http://www.service.mattel.com/uk)

Mattel Europa B.V., Gondel 1, 1186 MJ Amstelveen, Nederland.

Australia: Mattel Australia Pty. Ltd., 658 Church Street,  
Locked Bag #870, Richmond, Victoria 3121 Australia.

New Zealand: 16-18 William Pickering Drive,  
Albany 1331, Auckland.

- In the unlikely event that use of the remote interferes with normal use of other remote controlled equipment, such as televisions or stereos, or use of other electronic or battery powered appliances interfere with operation of the mobile, do not use both at the same time.

### CAN ICES-3 (B)/NMB-3 (B)

Operation is subject to the following two conditions: (1) this device may not cause interference, and (2) this device must accept any interference, including interference that may cause undesired operation of the device.

L'utilisation de ce dispositif est autorisée seulement aux conditions suivantes : (1) il ne doit pas produire de brouillage et (2) il doit pouvoir tolérer tout brouillage radioélectrique reçu, même si ce brouillage est susceptible de compromettre son fonctionnement.

### FCC STATEMENT (UNITED STATES ONLY)

This equipment has been tested and found to comply with the limits for a Class B digital device, pursuant to Part 15 of the FCC rules. These limits are designed to provide reasonable protection against harmful interference in a residential installation. This equipment generates uses and can radiate radio frequency energy and, if not installed and used in accordance with the instructions, may cause harmful interference to radio communications. However, there is no guarantee that interference will not occur in a particular installation. If this equipment does cause harmful interference to radio or television reception, which can be determined by turning the equipment off and on, the user is encouraged to try to correct the interference by one or more of the following measures:

- Reorient or relocate the receiving antenna.
- Increase the separation between the equipment and receiver.
- Consult the dealer or an experienced radio/TV technician for help.

**NOTE:** Changes or modifications not expressly approved by the manufacturer responsible for compliance could void the user's authority to operate the equipment.

This device complies with Part 15 of the FCC Rules. Operation is subject to the following two conditions: (1) This device may not cause harmful interference, and (2) this device must accept any interference received, including interference that may cause undesired operation.

# Battery Installation



For longer life, use **alkaline** batteries.



**Soother**



**Remote**

## Soother

- Loosen the screws in the bottom of the soother. Remove the bottom of the soother.
- Insert four AA (LR6) **alkaline** batteries.
- Replace the bottom of the soother and tighten the screws.

**IMPORTANT!** Under normal use conditions, the batteries in the soother will require replacement more often than the batteries in the remote. When sounds or lights become faint or stop, it's time for an adult to change the batteries.

## Remote

- Loosen the screw in the battery compartment door with a Phillips screwdriver and remove the door.
- Insert two AAA (LR03) **alkaline** batteries.
- Replace the battery compartment door and tighten the screw.
- If this product begins to operate erratically, you may need to reset the electronics. Slide the power/volume switch on the soother off and then back on. Remove the batteries from the remote and reinstall them.



- Protect the environment by not disposing of this product with household waste (2002/96/EC). Check your local authority for recycling advice and facilities.

## Battery Safety Information

In exceptional circumstances, batteries may leak fluids that can cause a chemical burn injury or ruin your product. To avoid battery leakage:

- Do not mix old and new batteries or batteries of different types: alkaline, standard (carbon-zinc) or rechargeable (nickel-cadmium).
- Insert batteries as indicated inside the battery compartment.
- Remove batteries during long periods of non-use. Always remove exhausted batteries from the product. Dispose of batteries safely. Do not dispose of this product in a fire. The batteries inside may explode or leak.
- Never short-circuit the battery terminals.
- Use only batteries of the same or equivalent type, as recommended.
- Do not charge non-rechargeable batteries.
- Remove rechargeable batteries from the product before charging.
- If removable, rechargeable batteries are used, they are only to be charged under adult supervision.

# Crib Attachment



## WARNING

### Prevent Entanglement Injury

#### Crib Mobile Use

- Keep out of baby's reach.
- Remove mobile from crib or playpen when baby begins to push up on hands and knees.
- This product may not attach to all crib designs. Do not add additional strings or straps to attach to a crib or playpen.

#### Stroller Toy Use

- Do not attach link directly to crib or playpen.

**IMPORTANT!** Always attach all provided fasteners (strings, straps, clamps, etc.) tightly to a crib or playpen according to the instructions. Do not add additional strings or straps to attach to a crib. Check frequently.

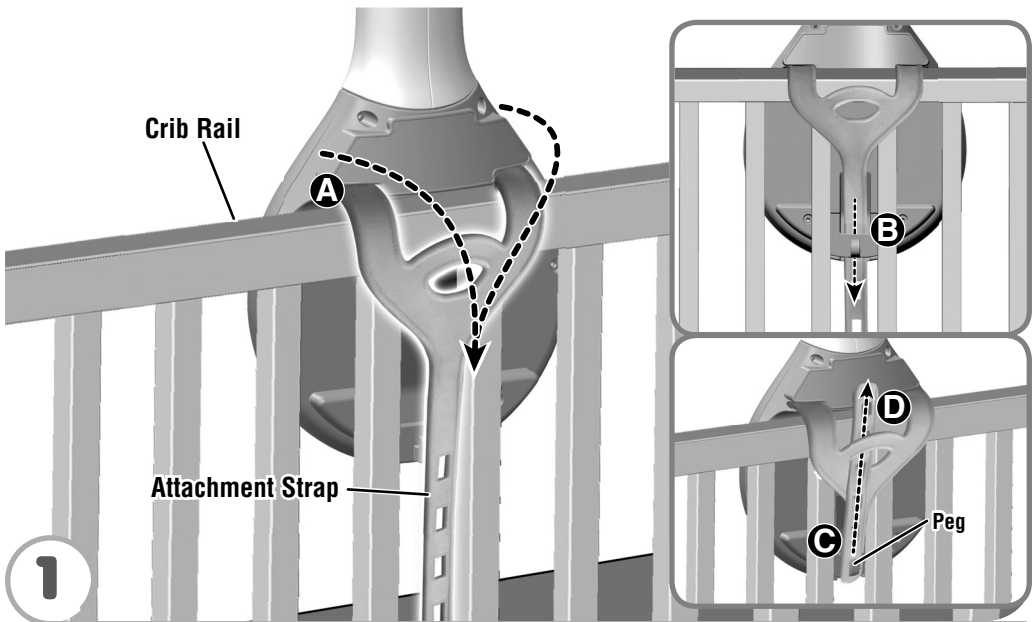

- Position the toy inside the crib. Make sure the attachment strap is on the outside of the crib **A**.
- Slide the end of the attachment strap down through the slot on the back of the toy **B**.
- Pull the end of the attachment strap up and fasten to the peg on the back of the toy **C**.

**Note:** This toy should be snug against the crib rail and spindles. Use the strap slot that provides the tightest fit.

- If you have excess strap, slide the free end of the attachment strap up through the opening near the top of the attachment strap **D**.

## Crib Attachment

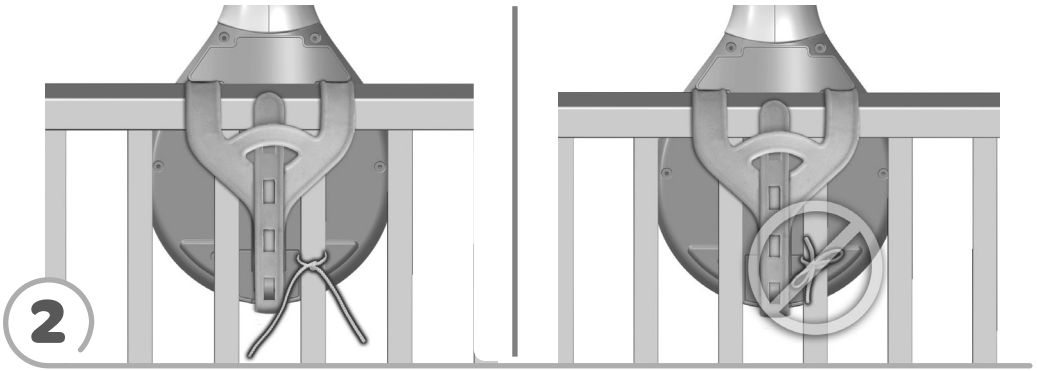

- Tie the toy's strings to a crib spindle.

**Note:** It is better to tie the strings in a knot than a bow, since a bow may be easily untied.

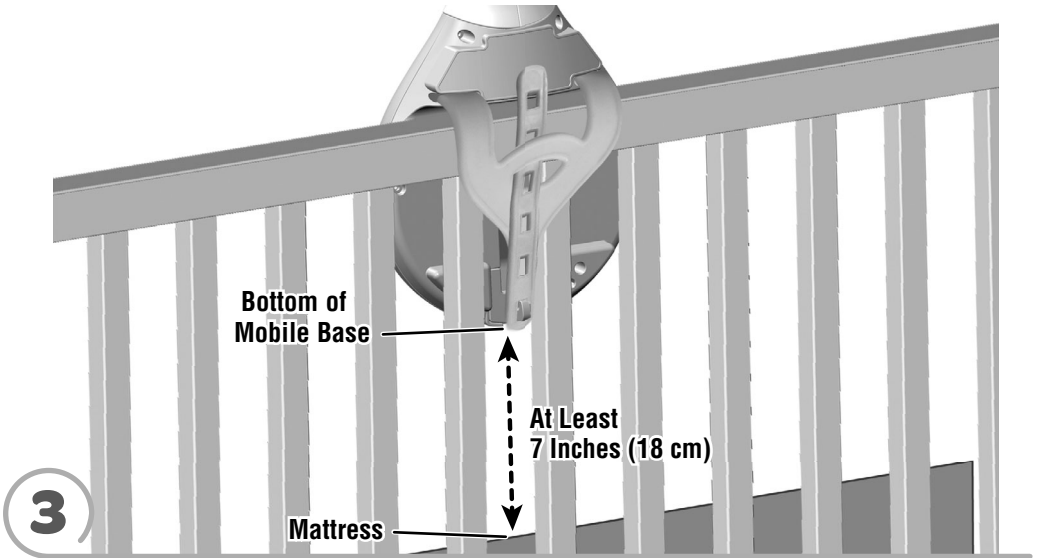

- Make sure the distance between the bottom of the mobile base and the crib mattress is **at least 7 inches (18 cm)**.
- If the distance is less than 7 inches (18 cm): readjust the attachment strap to lift the toy; or lower the crib mattress.

# Projection Mobile with Soothing Sounds



- Slide the power/volume switch to ON with low volume ◀), ON with high volume ◀)) or OFF ○.
- Press a sound selection button to turn on:
  - 🌀 White noise and mobile motion
  - 🎵 Music and mobile motion
  - 🌿 Nature sounds and mobile motion
- Press the music button again to change the musical selection.
- Press and hold a sound selection button to turn off the music/sounds and mobile motion.
- *Hint: Music/sounds play for approximately 30 minutes. The mobile turns off after approximately 12 minutes. Press a sound selection button again to restart.*
- Press the light button ☽ to turn on projector lights. Press the button again to turn the lights off.
- *Hint: The lights time out after approximately 30 minutes. Press the light button again to restart.*
- Press the button on the remote to start music/sounds.

## Remote Use



- The soother is designed to go into sleep mode after several hours. If the soother does not respond to the remote:
  - slide the power/volume switch on the soother off and back on, or
  - press a sound selection button on the soother, or
  - replace the batteries in the soother, or
  - replace the batteries in the remote to reactivate the remote.
- You may notice a loss of range between the remote and the mobile when using in bright light. For best performance, avoid using the remote in areas of bright light. Move the mobile, or reduce the amount of light to improve performance.
- Position the mobile so that the back of the soother points towards the area that the remote will be used. Make sure there is a clear path between the remote and the soother. Point the end of the remote toward the back of the soother and press the button.

## Stroller Toy

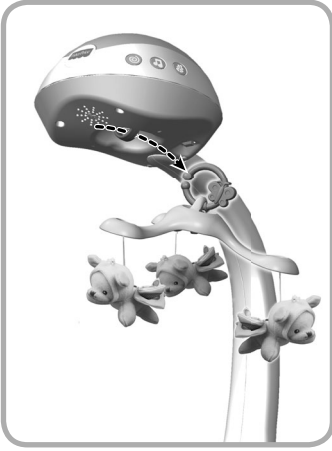

- Pull the mobile link off the soother.
- Fit the open end of the mobile link onto a stroller canopy.

## Tabletop Soother

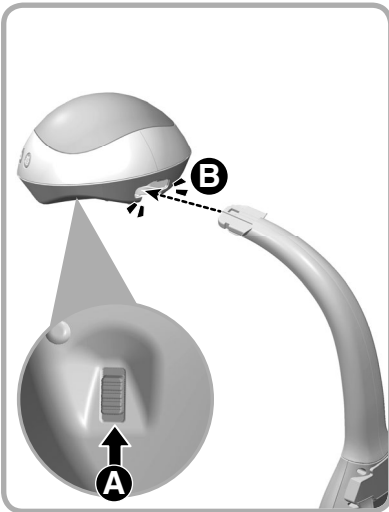

- Pull the mobile link off the soother.
- Slide the switch on the bottom of the soother **A** and pull to remove from the mobile arm **B**.