



Scan the QR code to see the manual.



# OWNER'S MANUAL

# WASHTOWER

---



Before beginning installation, read these instructions carefully. This will simplify installation and ensure that the product is installed correctly and safely. Leave these instructions near the product after installation for future reference.

## ENGLISH

WWT-1910BX / WWT-1910BLX / WWT-1910FGX / WWT-1910GRX



MFL05831201  
Rev.00\_091225

[www.lg.com](http://www.lg.com)

Copyright © 2025 LG Electronics. All Rights Reserved

# TABLE OF CONTENTS

This manual may contain images or content that may be different from the model you purchased.  
This manual is subject to revision by the manufacturer.

## SAFETY INSTRUCTIONS

READ ALL INSTRUCTIONS BEFORE USE..... 4  
WARNING ..... 4  
CARING FOR THE ENVIRONMENT ..... 10

## INSTALLATION

Parts and Specifications ..... 11  
Installation Place Requirements ..... 15  
Unpacking the Appliance ..... 17  
Connecting the Water Supply Hose ..... 18  
Installing the Drain Hose ..... 19  
Levelling the Appliance ..... 21  
Disassembly ..... 23

## OPERATION-WASHER

Operation Overview..... 25  
Preparing the Wash Load ..... 26  
Adding Detergents and Softeners ..... 27  
Control Panel and Programme Table ..... 31  
Extra Options and Functions ..... 37

## OPERATION-DRYER

Operation Overview..... 40  
Preparing the Laundry ..... 41  
Control Panel and Programme Table ..... 43  
Extra Options and Functions ..... 49

## SMART FUNCTIONS

Using LG ThinQ Application ..... 52  
Smart Diagnosis ..... 54

## MAINTENANCE

Washer ..... 56

Dryer .....60

## **TROUBLESHOOTING**

Washer .....64

Dryer .....71

Common.....75

## SAFETY INSTRUCTIONS

### READ ALL INSTRUCTIONS BEFORE USE

The following safety guidelines are intended to prevent unforeseen risks or damage from unsafe or incorrect operation of the appliance.

The guidelines are separated into 'WARNING' and 'CAUTION' as described below.

### Safety Messages



This symbol is displayed to indicate matters and operations that can cause risk. Read the part with this symbol carefully and follow the instructions in order to avoid risk.



#### **WARNING**

This indicates that the failure to follow the instructions can cause serious injury or death.



#### **CAUTION**

This indicates that the failure to follow the instructions can cause the minor injury or damage to the product.

### WARNING

---

#### **WARNING**

- To reduce the risk of explosion, fire, death, electric shock, injury or scalding to persons when using this product, follow basic precautions, including the following:

---

### Technical Safety

- This appliance is not intended for use by persons (including children) with reduced physical, sensory or mental capabilities, or lack of experience and knowledge, unless they have been given supervision or instruction concerning use of the appliance by a person responsible for their safety.

- Children should be supervised to ensure that they do not play with the appliance.
- If the power cord is damaged, it must be replaced by the manufacturer, its service agent or similarly qualified persons in order to avoid a hazard.
- The inlet water pressure must be between 100 kPa and 800 kPa.
- Use a new hose or hose-set supplied with the appliance. Reusing old hoses can cause a water leak and subsequent property damage.
- Ventilation openings must not be obstructed by a carpet.
- Do not dry unwashed items in the appliance.
- Fabric softeners, or similar products, should be used as specified by the fabric softener instructions.
- Remove all objects from pockets such as lighters and matches.
- Never stop the appliance before the end of the drying cycle unless all items are quickly removed and spread out so that the heat is dissipated.
- The appliance is not to be used if industrial chemicals have been used for cleaning.
- Items that have been soiled with substances such as cooking oil, vegetable oil, acetone, alcohol, petroleum, kerosene, spot removers, turpentine, waxes and wax removers should be washed in hot water with an extra amount of detergent before being dried in the appliance.
- Items such as foam rubber (latex foam), shower caps, waterproof textiles, rubber backed articles and clothes or pillows fitted with foam rubber pads should not be dried in the appliance.
- Do not drink the condensed water. Failure to do so may result in food-borne illnesses.
- If the supply cord is damaged, it must be replaced by the manufacturer or its service agents or similarly qualified person in order to avoid a hazard.
- The lint filter must be cleaned frequently.
- Lint must not to be allowed to accumulate around the appliance.

- Do not spray dry cleaning detergent directly onto the appliance or use the appliance to dry clothes left with dry cleaning detergent.
- Do not dry clothes stained with oil substances. Oil substances (including edible oils) stained on clothes cannot be completely removed even after washing with water.
- The appliance must not be supplied through an external switching device, such as a timer, or connected to a circuit that is regularly switched on and off by a utility.
- Remove clothes from the product immediately when drying is complete or the power is turned off during the drying process. Leaving clothes that has been dried in the appliance unattended could result in fire. Clothes not removed from the appliance after drying could result in fire. Remove clothes immediately after drying, and then hang or lay the clothes flat to cool.
- Oil-affected items can ignite spontaneously, especially when exposed to heat sources such as in a tumble dryer. The items become warm, causing an oxidation reaction in the oil. Oxidation create heat. If the heat cannot escape, the items can become hot enough to catch fire. Piling, stacking or storing oil-affected items can prevent heat from escaping and so create a fire hazard.
- If it is unavoidable that fabrics that contain vegetable or cooking oil or have been contaminated by hair care products be placed in a tumble dryer they should first be washed in hot water with extra detergent – this will reduce, but not eliminate, the hazard.
- This appliance is intended to be used in household only.
- Potentially there could be hydrogen built-up in hot water system that has not been used for two weeks or more. In this instance, hot water faucets should be allowed to run for several minutes prior to use of the appliance.

### **Maximum Capacity**

The maximum capacity in some cycles for dry clothes to be used is **Wash (19 kg)/Dry (10 kg)**.

## WARNING - To avoid a fire



Do not wash or dry clothes or items that have any contaminants of flammable solvents or substances. Do not clean the product with, or expose it to, flammable substances.

## Installation

- Make sure the appliance is properly installed, grounded, and adjusted by qualified service personnel according to the installation instructions.
- Never attempt to operate the appliance if it is damaged, malfunctioning, partially disassembled, or has missing or broken parts, including a damaged cord or plug.
- This appliance should only be transported by two or more people holding the appliance securely.
- Do not install the appliance in a damp and dusty place. Do not install or store the appliance in any outdoor area, or any area that is subject to weathering conditions such as direct sunlight, wind, rain, or temperatures below freezing.
- Make sure the power plug is completely pushed into the power outlet.
- If the power cord is damaged or the hole of the outlet socket is loose, do not use the power cord and contact an authorized service centre.
- Do not use multiple outlet sockets, an extension power cable or double adapter with this appliance.
- Do not modify the power plug provided with the appliance. If it does not fit the power outlet, have a proper outlet installed by a qualified electrician.
- This appliance is equipped with a power cord having an equipment-earthing / grounding conductor (earthing pin) and a grounding power plug. The power plug must be plugged into an appropriate outlet socket that is installed and earthed / grounded in accordance with all local codes and ordinances.

- Improper connection of the equipment-grounding conductor can result in risk of electric shock. Check with a qualified electrician or service personnel if you are in doubt as to whether the appliance is properly grounded.
- This appliance must not be installed behind a lockable door, a sliding door or a door with a hinge on the opposite side to that of the appliance, in such a way that a full opening of the appliance door is restricted.
- This appliance must not be stored or used in any outdoor location.
- Tighten the drain hose to avoid separation.

### **Operation**

- To avoid breaking the door glass, do not push too hard on the door when closing.
- Do not apply any sharp objects to the control panel in order to operate the appliance.
- Do not attempt to separate any panels or disassemble the appliance.
- Do not repair or replace any part of the appliance. All repairs and servicing must be performed by qualified service personnel unless specifically recommended in this Owner's Manual. Use only authorized factory parts.
- Do not push down the door excessively, when the appliance door is open.
- Do not put animals, such as pets into the appliance.
- Do not wash rugs, mats, shoes or pet blankets, stuffed toys, or any other items other than clothes or sheets, in this machine.
- Keep the area underneath and around the appliance free of combustible materials such as lint, paper, rags, chemicals, etc.
- Do not leave the appliance door open. Children may hang on the door or crawl inside the appliance, causing damage or injury.
- Do not put in, wash or dry articles that have been cleaned in, washed in, soaked in, or spotted with combustible or explosive substances (such as waxes, wax removers, oil, paint, gasoline, degreasers, drycleaning solvents, kerosene, petrol, spot removers, turpentine,

vegetable oil, cooking oil, acetone, alcohol, etc.). Improper use can cause fire or explosion.

- Items such as foam rubber (latex foam), shower caps, waterproof textiles, rubber backed articles and clothes or pillows fitted with foam rubber pads should not be dried in the appliance.
- Do not use or store flammable or combustible substances (ether, benzene, alcohol, chemical, LPG, combustible spray, gasoline, thinner, petroleum, insecticide, air freshener, cosmetics, etc.) near the appliance.
- Never reach into the appliance while it is operating. Wait until the drum has completely stopped.
- Do not touch the door during a high temperature programme.
- In case of a water leak from the appliance or flood, disconnect the power plug and contact the LG Electronics customer information centre.
- Turn off water taps to relieve pressure on hoses and valves and to minimize leakage if a break or rupture should occur. Check the condition of the fill hoses; they should be replaced after 5 years.
- If there is a gas leakage (isobutane, propane, natural gas, etc.) within the home, do not touch the appliance or power plug and ventilate the area immediately.
- If the drain hose or inlet hose is frozen during winter, use it only after thawing.
- Keep all washing detergents, softener and bleach away from children.
- Do not touch the power plug or the appliance controls with wet hands.
- Do not bend the power cable excessively or place a heavy object on it.
- Avoid touching any water that is drained from the appliance during the wash.
- Make sure that drainage is working properly. If water is not drained properly, your floor may get flooded.
- When the air temperature is high and the water temperature is low, condensation may occur and thus wet the floor.

- Wipe off dirt or dust on the contacts of the power plug.

### **Maintenance**

- Disconnect the appliance from the power supply before cleaning the appliance. Setting the controls to the OFF or stand by position does not disconnect this appliance from the power supply.
- Securely plug the power plug in the outlet socket after completely removing any moisture and dust.
- Do not spray water inside or outside the appliance to clean it.
- Never unplug the appliance by pulling on the power cable. Always grip the power plug firmly and pull straight out from the outlet socket.
- Only qualified service personnel from LG Electronics service centre should disassemble, repair, or modify the appliance. Contact an LG Electronics customer information centre if you move and install the appliance in a different location.

### **Disposal**

- Before discarding an old appliance, unplug it. Cut off the cable directly behind the appliance to prevent misuse.
- Dispose of all packaging materials (such as plastic bags and styrofoam) away from children. The packaging materials can cause suffocation.
- Remove the door before disposing of or discarding this appliance to avoid the danger of children or small animals getting trapped inside.

## **CARING FOR THE ENVIRONMENT**

### **This dryer contains fluorinated greenhouse gases**

R134a (GWP: 1430): 0.572t CO<sub>2</sub>-eq / 0.400 kg \*1000. Hermetically sealed.

# INSTALLATION

## Parts and Specifications

### NOTE

- Appearance and specifications may change without notice to improve the quality of the appliance.

### Front View

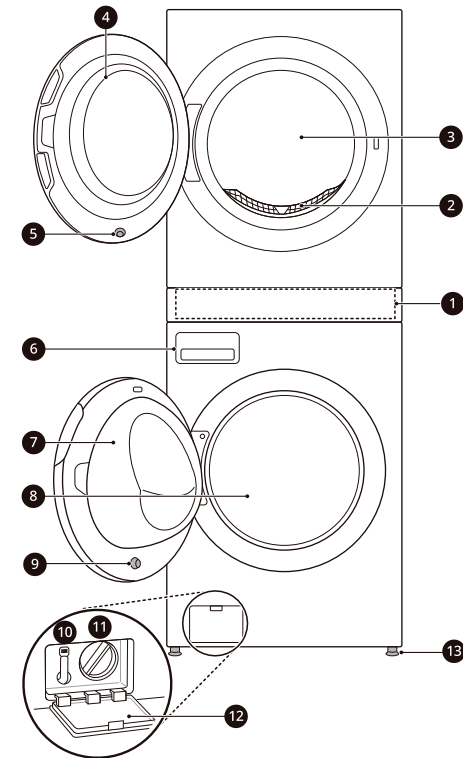

- 1 Control Panel
- 2 Lint Filter
- 3 Dryer Drum
- 4 Dryer Door
- 5 Dryer Door Magnet
- 6 Detergent Dispenser Drawer
- 7 Washer Door

- 8 Washer Drum
- 9 Washer Door Magnet
- 10 Drain Hose
- 11 Drain Pump Filter
- 12 Drain Pump Filter Cover
- 13 Leveling Feet

### Rear View

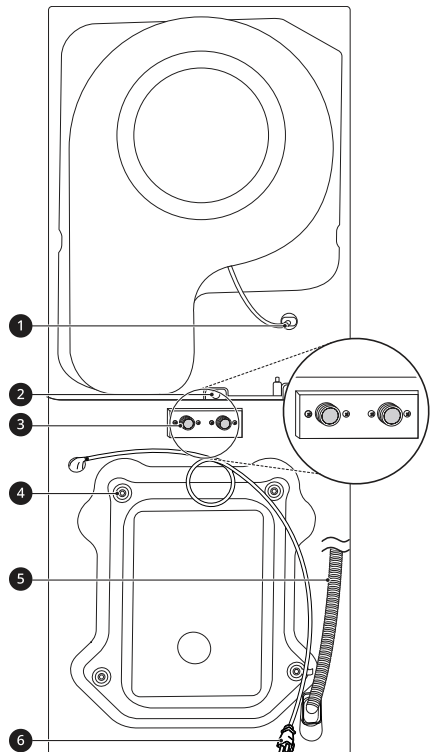

- 1 Back Panel
- 2 Detergent Dispenser Drawer
- 3 Lint Filter
- 4 Drain Pump Filter Cover
- 5 Drain Pump Filter
- 6 Leveling Feet

## 12 INSTALLATION

---

- 1 Power Cord (for Dryer)
- 2 Drain Hole (for Dryer)
- 3 Hot and Cold Water Inlets
- 4 Shipping Bolts
- 5 Drain Hose (for Washer)
- 6 Power Cord (for Washer)

Accessories

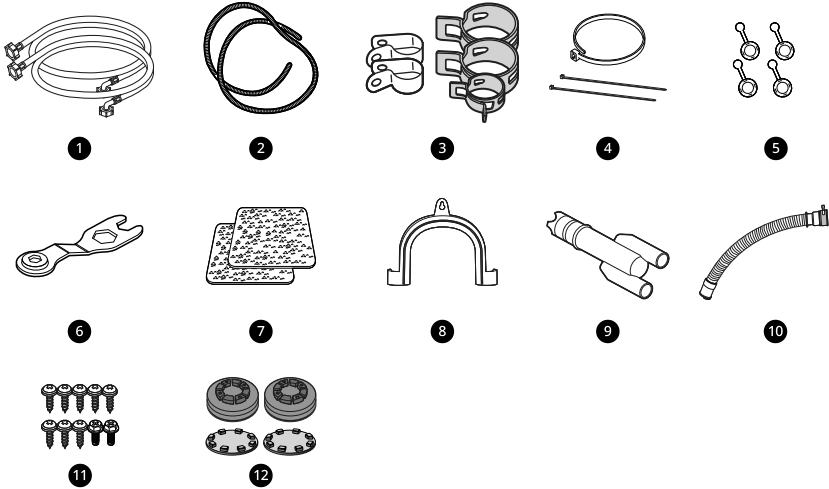

1	Cold and Hot Water Inlet Hoses (for Washer) (2 EA)	2	Water Drain Hose (for Dryer) (1 EA)	3	Band Clamps (5 EA)
4	Cable Ties (3 EA)	5	Caps for Covering Transit Bolt Holes (4 EA)	6	Spanner (1 EA)
7	Anti-slip Sheets (2 EA)	8	Elbow Bracket for Securing Drain Hose (1 EA)	9	Drain Hose Connector (1 EA)
10	Short Drain Hose (1 EA)	11	Screws (10 EA)	12	Leg Stoppers (2 Pairs)

**NOTE**

- The images in this manual may be different from the actual components and accessories that are subject to change by the manufacturer without prior notice for product improvement purposes.

### Specifications

<b>Model</b>	<b>WWT-1910BX / WWT-1910BLX / WWT-1910FGX / WWT-1910GRX</b>
Power supply	220 - 240 V~, 50 Hz
Dimension (Width X Depth X Height)	700 mm X 830 mm X 1890 mm
Product weight	160 kg
Permissible Inlet Water pressure	100 KPa ~ 800 KPa (1.0~8.0 kgf/cm <sup>2</sup> )
Allowable temperature	5 - 35 °C

## Installation Place Requirements

Before installing the appliance, check the following information to make sure that the appliance should be installed in a correct place.

### Installation Location

- This appliance must be installed on firm flooring to minimize vibration during the spin cycle. Concrete flooring is best, being far less prone to vibration during the spin cycle than wooden floorboards or a carpeted surface.
- If it is impossible to avoid positioning the appliance next to a gas cooker or coal burning stove, an insulation (850 X 600 mm) covered with aluminum foil on the side facing the cooker or stove must be inserted between the two appliances.
- Ensure that when the appliance is installed, it is easily accessible for an engineer in the event of a breakdown.
- When installing the appliance, adjust all four feet using the transit bolt spanner provided to ensure the appliance is stable.

### Floor Installation

\*1 minimum space for installation

To ensure sufficient clearance for water inlet hoses, drain hose and airflow, allow minimum clearances on the sides and behind the appliance. Be sure to allow for wall, door, or floor moldings that may increase the required clearances.

**The faucet is to the REAR when the appliance is placed.**

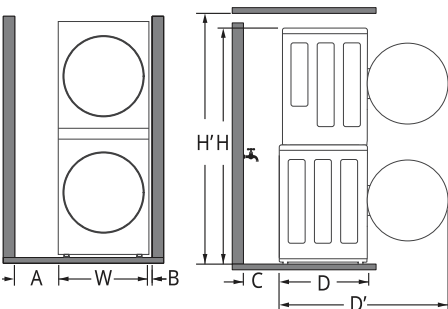

A	30 cm <sup>*1</sup>
W	70 cm
B	5 cm
C	20 cm
D	83 cm
D'	146 cm <sup>*1</sup>
H	189 cm
H'	200 cm

**The faucet is to the SIDE when the appliance is placed.**

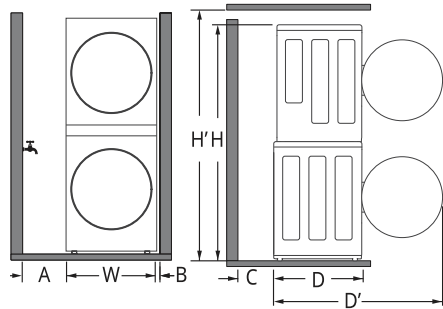

A	15 cm <sup>*1</sup>
W	70 cm
B	5 cm
C	10 cm
D	83 cm
D'	146 cm <sup>*1</sup>
H	189 cm
H'	200 cm

### **⚠ WARNING**

- This appliance must only be used for domestic household purposes and should not be used in mobile applications.

### **NOTE**

- Never try to level any uneven floor by putting pieces of wood, cardboard or similar materials under the appliance.

## **Ventilation**

### **Alcove or under counter**

Make sure that air circulation around the appliance should not be impeded by carpets, rugs, etc.

### **Cupboard**

Cupboard door must have 2 (louvered) openings, each having a minimum area of 387 cm<sup>2</sup>, located 8 cm from the bottom and top of the door.

## **Ambient Temperature**

- Do not install the appliance in rooms where freezing temperatures may occur. Frozen hoses may burst under pressure. The reliability of the electronic control unit may be impaired at temperatures below freezing point.

### **NOTE**

- If the appliance is delivered in winter and temperatures are below freezing, place the appliance at room temperature for a few hours before putting it into operation.
- The appliance performs best at a room temperature of 23 °C.

## **Wooden Floors (Suspended Floors)**

When installing the appliance on wooden floors, use rubber cups to reduce excessive vibration and unbalance. Timber or suspended type flooring may

contribute to excessive vibration and unbalance, errors and malfunction.

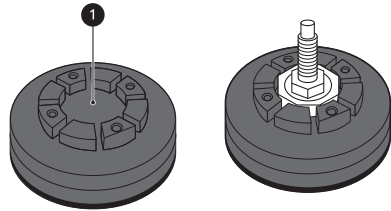

- To reduce vibration, we recommend placing at least 20 mm thickness of rubber caps ① under each adjusting foot of the appliance, secured to at least two floor beams with screws.
- If possible, install the appliance in one of the corners of the room, where the floor is more stable.
- Fit the rubber cups to reduce vibration.

### **⚠ CAUTION**

- If the appliance is installed on the unstable floor (e.g. wooden floor), the warranty does not cover any damages and cost occurred due to the installation on the unstable floor.

### **NOTE**

- You can purchase rubber cups (part No. **MJB65174401, MJB65174501**) from the LG service centre.

## **Electrical Connection**

- Do not use an extension cord or double adapter.
- Always unplug the appliance and turn off the water supply after use.
- Connect the appliance to an earthed socket in accordance with current wiring regulations.
- The appliance must be positioned so that the plug is easily accessible.
- Power outlet must be within 1 meter of either side of the appliance.

## ⚠ WARNING

- Repairs to the appliance must only be carried out by qualified personnel. Repairs carried out by inexperienced persons may cause injury or serious malfunctioning. Contact your local authorised LG repairer.
- The power plug must be plugged into an appropriate outlet socket that is installed and grounded/earthed in accordance with all local codes and ordinances.

After removing the carton and shipping material, lift the appliance off the foam base.

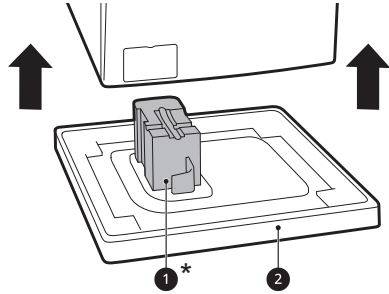

- Make sure the tub support **1\*** comes off with the base and is not stuck to the bottom of the appliance.
- If you must lay the appliance down to remove the carton base **2**, always protect the side of the appliance and lay it carefully on its side. Do not lay the appliance on its front or back.

## Unpacking the Appliance

### ⚠ WARNING

- When installing this appliance, take adequate measures to protect yourself, e.g. by wearing protective gloves.
- Moving or installation of the appliance requires two or more people. Failure to follow these instructions may result in injury.
- When moving the product, tilt it toward the back of the product. Do not transport the product in a horizontal position.

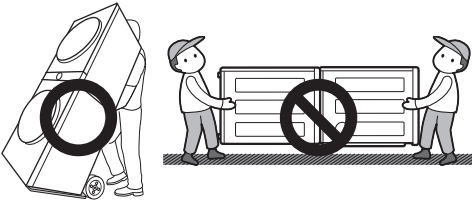

## Removing the Transit Bolt Assemblies

To prevent the appliance from severe vibration and breakage, remove transit bolts and retainers.

- 1 Starting with the bottom two transit bolts **1**, use the spanner (included) to fully loosen all transit bolts by turning them counterclockwise.

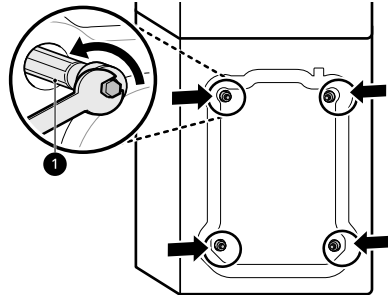

- 2 Remove the bolt assemblies by wiggling them slightly while pulling them out.

- 3 Install the hole caps.

## Lifting the Appliance Off the Foam Base

\* This feature may vary depending on the model purchased.

## 18 INSTALLATION

- Locate the hole caps ② included in the accessory pack or attached on the back.

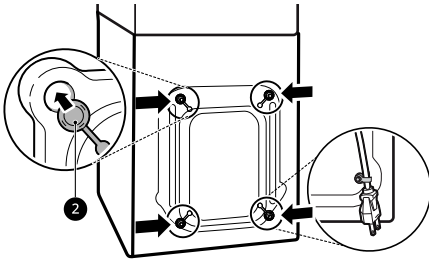

### NOTE

- Save the transit bolts and retainers for future use.
- To prevent damage to the appliance during transport:
  - Reinstall the transit bolts.
  - Secure the power cord to the back of the appliance.

## Connecting the Water Supply Hose

### Note for Connection

- Water pressure must be between **100 kPa** and **800 kPa** (1.0 – 8.0 kgf/cm<sup>2</sup>). If the water pressure is more than **800 kPa**, a decompression device should be installed.
- Please refer to the applicable connection method appropriate for your country.
- Periodically check the condition of the water supply hose and replace the water supply hose if necessary.

### NOTE

- If the water pressure is near or over 800 kPa, a water pressure reduction device should be installed to both taps.
- Exceeding 65 °C can damage some clothes.

- Temperatures below 4 °C can cause hoses to freeze and burst and unfavourable wash results due to undissolved detergent.
- Cold inlet Water Temperatures over 25 °C can cause damage to clothes such as delicate Woollens.
- Do not overtighten the water supply hose or use mechanical devices to tighten onto the inlet valves.
- No further backflow protection required for connection to the water inlet.
- Ensure the inlet hoses are not bent, kinked or tangled as this could cause insufficient water flow and result in a malfunction.

## Checking the Rubber Seal

Two rubber seals ① are supplied with the water supply hose. They are used for preventing water leaks. Connection to taps is sufficiently tight.

- Do not use mechanical devices such as multi grips to tighten the water supply hose. Ensure that the curved end of the water supply hose is connected to the appliance.

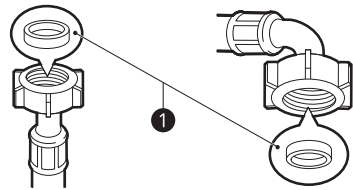

## Connecting the Hose to the Water Tap

### Connecting Screw-Type Hose to Tap with Thread

Screw the supply hose connector onto the water supply tap. Hand tighten only with the aid of a soft

cloth. Do not overtighten the supply hose with any mechanical device.

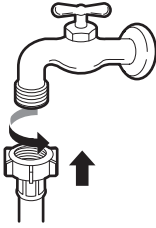

## NOTE

- After connecting the water inlet hose to the water tap, turn on the water tap to flush out foreign substances (dirt, sand, sawdust, and etc.) in the water lines. Let the water drain into a bucket, and check the water temperature.

## Connecting the Hose to the Appliance

- 1 Screw the supply hose to the water inlet valve on the back of the appliance.
  - Do not connect cold and hot water supply hoses in reverse.

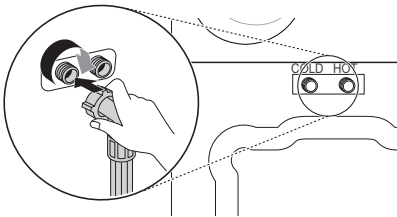

## NOTE

- After completing connection, if water leaks from the hose, repeat the same steps. Use the most conventional type of tap for the water supply. In case that the tap is square or too big, remove the guide plate before inserting the tap into the adaptor.
- Make sure that the hose should not be kinked or trapped.

## Installing the Drain Hose

### Connecting the Drain Hose to the Dryer

- 1 Insert the hose clamp ① onto the drain hose of the dryer.

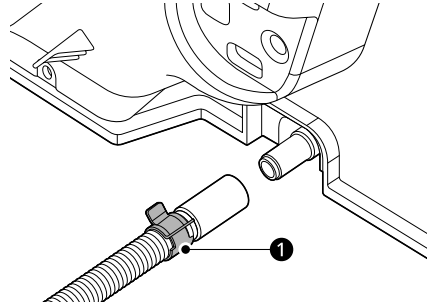

- 2 Connect the drain hose of the dryer and secure the hose clamp.

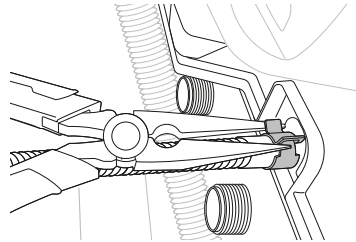

- 3** Use the provided drain hose connector **2** to secure the 2 drain hoses in place.

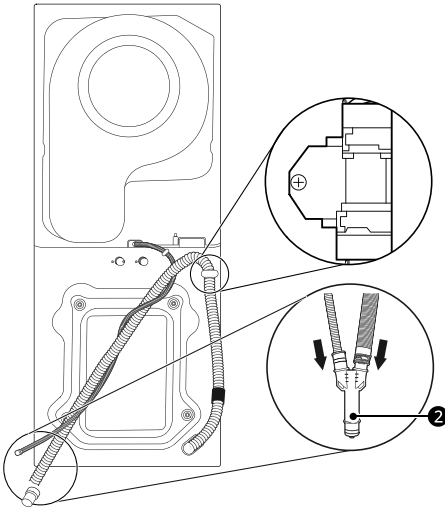

band clamp **1** to keep the washer hose in place.

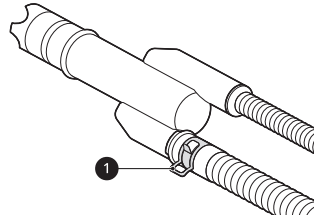

- 3** Use the band clamp **2** on the short drain hose (included) to attach it to the bottom opening of the drain hose connector.

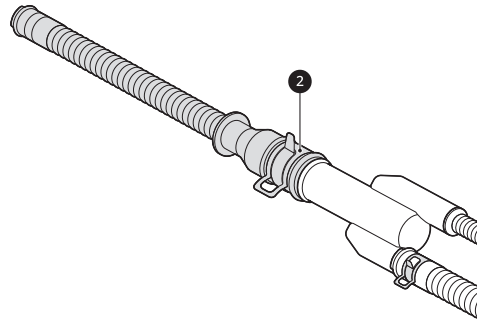

### NOTE

- The drain hose should not be placed higher than **100 cm** above the floor. Water in the appliance may not drain or may drain slowly.
- Securing the drain hose correctly will protect the floor from damage due to water leakage.
- If the drain hose is too long, do not force it back into the appliance. This will cause abnormal noise.

- 4** Connect securely the short drain hose to a floor gully or a standpipe. When connecting to a waste spigot, use the band clamp **3** to the end of the short drain hose.

### Connecting Hoses to the Drain Hose Connector

- 1** Slide the included band clamp onto the end of the drain hose of the washer.
- 2** Connect the drain hoses from the washer and dryer to the drain hose connector. Tighten the

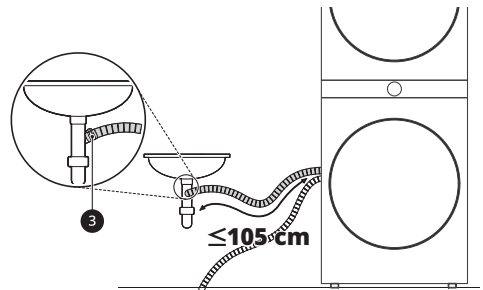

### ⚠ CAUTION

- Adjust the wire hose clamp to prevent the hose from coming loose or leaking. Failure to do so could result in flooding. Use of the drain hose

connector helps avoid siphoning, odours, or improper draining.

- Make sure the drain hoses are not kinked or pinched. This is a potential cause of drainage problems or noise.

- If the appliance rocks when pushing the top plate diagonally, adjust the feet again.
- Check whether the appliance is perfectly level after installation.

## NOTE

- Depending on the installation environment, you may have to purchase a separate drain hose connector. The connector supplied will suit a standard laundry tub side drain hole.
- Use the elbow bracket (included) if necessary. When installing the drain hose to a sink, secure it tightly with string.

## NOTE

- Timber or suspended type flooring may contribute to excessive vibration and unbalance. Reinforcement or bracing of the timber floor may need to be considered to stop or reduce excessive noise and vibration.

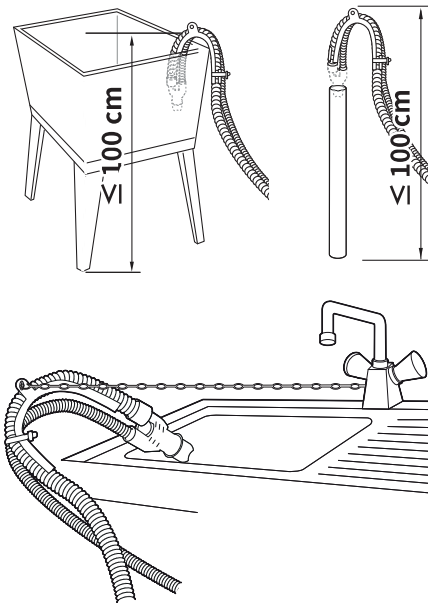

## Adjusting and Levelling the Feet

When installing the appliance, the appliance should be aligned and perfectly level. If the appliance is not aligned and level properly, the appliance may be damaged or may not operate properly.

- 1 Turn the levelling feet as required if the floor is uneven.
  - Do not insert pieces of wood etc. under the feet.
  - Make sure that all four feet are stable and resting on the floor.

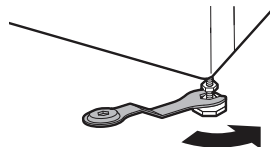
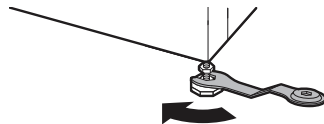

## Levelling the Appliance

### Checking the Level

When pushing down the edges of the top plate diagonally, the appliance should not move up and down at all (check both directions).

### NOTE

- Do not install the washing machine on a plinth, stand or elevated surface unless it is manufactured by LG Electronics for use with this model.

- 2 Check if the appliance is perfectly level using a spirit level ❶.

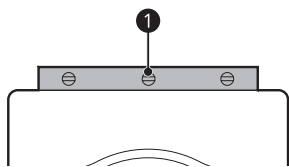

- 3 Secure the levelling feet with the lock nuts ❷ by turning anti-clockwise against the bottom of the appliance.

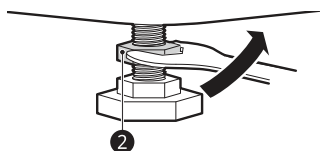

- 4 Check if all lock nuts at the bottom of the appliance are secured properly.

### NOTE

- Proper placement and levelling of the appliance will ensure long, regular, and reliable operation.
- The appliance must be 100% horizontal and stand firmly in position on a hard flat floor.
- It must not 'Seesaw' across corners under the load.
- Do not let the feet of the appliance get wet. Failure to do so may cause vibration or noise.

## Using Anti-Slip Sheets

This feature may vary depending on the model purchased.

If you install the appliance on a slippery surface, it may move because of excessive vibration. Incorrect levelling may cause malfunction through noise and vibration. If this occurs, install the anti-slip sheets under the levelling feet and adjust the level.

- 1 Clean the floor to attach the anti-slip sheets.
  - Use a dry rag to remove and clean foreign objects and moisture. If moisture remains, the anti-slip sheets may slip.
- 2 Adjust the level after placing the appliance in the installation area.
- 3 Place the adhesive side ❶ of the anti-slip sheets on the floor.
  - The most effective way is to install the anti-slip sheets under the front feet. If it is difficult to place the sheets under the front feet of the appliance, attach them under the rear feet.

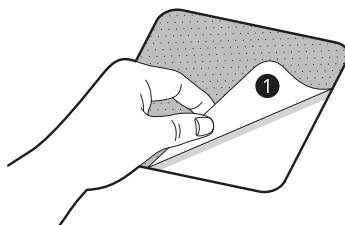

- 4 Put the appliance on the anti-slip sheets.
  - Do not attach the adhesive side ❶ of anti-slip sheets to the feet of the appliance.

### NOTE

- Additional anti-slip sheets are available at LG Electronics service centre.

# Disassembly

## Disassembling the Washer and Dryer

The washer and dryer cannot be disassembled and installed for use side by side. If it is necessary to disassemble the appliance in order to move or reinstall it, follow these instructions.

### ⚠ WARNING

- Protect your hands and arms from sharp edges. To reduce the risk of injury to persons, adhere to all industry recommended safety procedures including the use of long-sleeved gloves and safety glasses.

### NOTE

- Any damage resulting from improper disassembly/assembly or installation of the product is not covered by the product warranty.

**1** Be sure to unplug the appliance.

**2** Loosen screws assembled on the stack bracket on the back of the appliance.

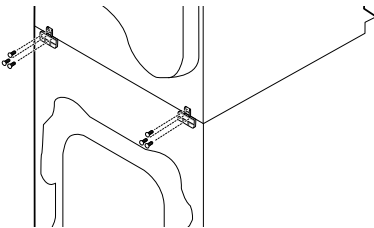

**3** Push open the caps at the left and right sides of the control panel on the front of the appliance. Loosen the screws under the caps.

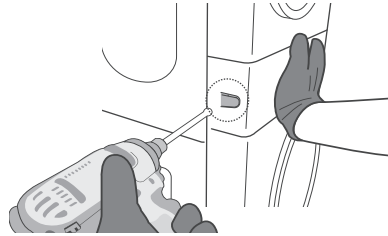

**4** Pull the control panel forward to remove it.

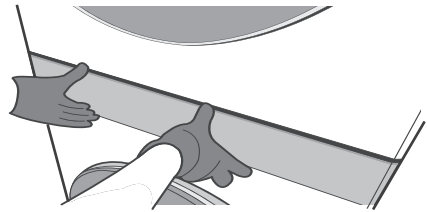

**5** Disconnect the wire harnesses from the washer **1** and dryer **2** to the control panel.

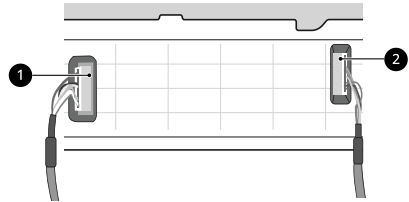

### ⚠ CAUTION

- Always ground yourself before touching the PCB or wiring. Discharge of static electricity may cause product malfunction.

### NOTE

- Tuck the wire harnesses to the side to avoid pinching them.

## 24 INSTALLATION

---

- 6** Unscrew the second screw from the top of the four screws on the left and right.

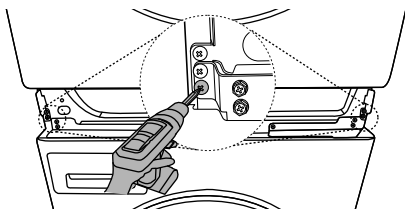

- 7** Lift the dryer and separate it from the washer.

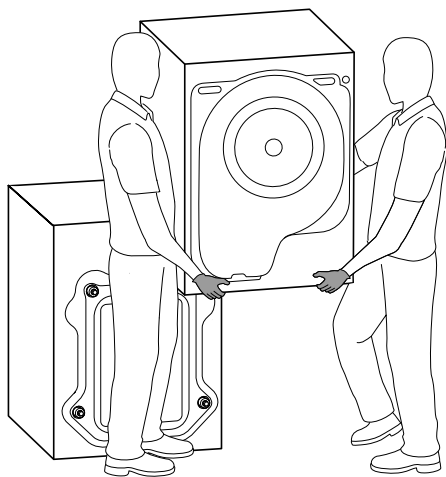

---

### **⚠ WARNING**

- Protect your hands and arms from sharp edges of the panel frame exposed on the top of the washer.
- To avoid strain injuries, use 2 or more people to lift the dryer.

---

### **NOTE**

- When assembling the appliance, proceed in reverse order.
-

# OPERATION-WASHER

## Operation Overview

### Using the Washer

Before the first wash, select the **Normal Wash** programme and add a half amount of the detergent. Start the appliance without clothes. This will remove possible residues and water from the drum that may have been left during manufacturing.

- Sort clothes by fabric type, soil level, colour and load size as needed.
- Open the door and load items into the appliance.

### CAUTION

- Before closing the door, ensure that all clothes and items are inside the tub and not overhanging on the rubber door seal where they will become caught when the door is closed. Failing to do so will cause damage to the door seal and the clothes.

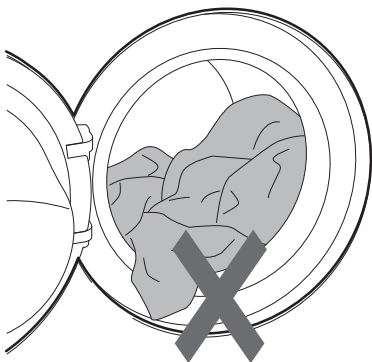

- Close the door.

### CAUTION

- Remove items from the flexible door seal gasket to prevent clothing and door seal damage.

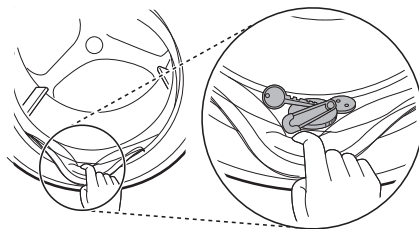

- Add cleaning products or detergent and softener.
  - Add the proper amount of detergent to the detergent dispenser. If desired, add bleach or fabric softener to the appropriate areas of the dispenser.
- Press the **Power** button to turn on the appliance.
- Either swipe over the programme name to scroll through and select a programme, or touch down the area to open the list of programmes.



- 7 Use these buttons to select the desired options for the selected programme. Not all options are available in each programme.

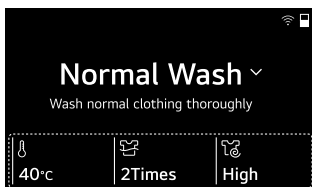

- 8 Begin cycle.

- Press the **Start/Pause** button, and then touch the **OK** button within 60 seconds to begin the cycle. The appliance will agitate briefly without water to measure the weight of the load.
  - The appliance is equipped with a 2-button start safety feature; if the **OK** button is not touched within 60 seconds, the feature will reset. In this case, repeat the steps and make sure to press both buttons within 60 seconds of each other.
  - If the **Start/Pause** button is not pressed for a prolonged period, the appliance will shut off, and all settings will be lost.

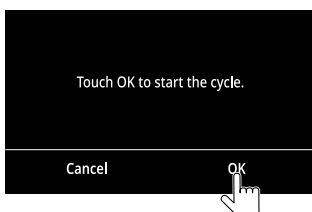

- 9 End of cycle.

- When the cycle is finished, a melody will sound. Immediately remove your clothing from the appliance to reduce wrinkling.

## Preparing the Wash Load

### Sorting the Clothes

- For best washing results, sort your clothes according to the care label stating fabric type and washing temperature. Adjust the spin speed or spin intensity in accordance to the fabric type.
- Soil level (Heavy, Normal, Light): Separate clothes according to soil level. If possible, do not wash heavily soiled items with lightly soiled ones.
- Colour (White, Lights, Darks): Wash dark or dyed clothes separately from whites or light colours. Mixing dyed clothes with light clothes can result in dye transfer or discolouration of lighter clothes.
- Lint (Lint producers, Collectors): Wash separately lint producing fabrics from lint collecting fabrics. Lint producers can result in pilling and linting on the lint collectors.

### Checking the Clothes Care Label

The symbols tell you about the fabric content of your garment and how it should be washed.

#### Symbols on the Care Labels

Symbol	Wash / Fabric type
	<ul style="list-style-type: none"> <li>• Normal Wash</li> <li>• Cotton, Mixed Fabrics</li> </ul>
	<ul style="list-style-type: none"> <li>• Easy Care</li> <li>• Synthetic, Mixed Fabrics</li> </ul>
	<ul style="list-style-type: none"> <li>• Special Delicate Wash</li> <li>• Delicates</li> </ul>
	<ul style="list-style-type: none"> <li>• Hand Wash Only</li> <li>• Wool, Silk</li> </ul>
	<ul style="list-style-type: none"> <li>• Do not wash</li> </ul>

**NOTE**

- The dashes under the symbol give you information about the type of fabric and the maximum allowance of mechanical stress.

**Checking the Clothes before Loading**

- Combine large and small items in a load. Load large items first.
- Large items should not be more than half of the total wash load. Do not wash single items. This may cause an unbalanced load. Add one or two similar items.
- Check all pockets to make sure that they are empty. Items such as nails, hair clips, matches, pens, coins and keys can damage both your appliance and clothes.

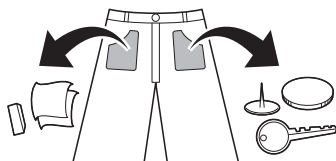

- Wash delicates (stockings, underwired bras) in a wash net.
- Close zippers, hooks and strings to make sure that these items do not snag on other clothes.
- Pre-treat dirt and stains by brushing a small amount of detergent dissolved water onto stains to help lift dirt.

**Adding Detergents and Softeners****Detergent Dosage**

- Detergent should be used according to the instruction of the detergent manufacturer and selected according to type, colour, soiling of the fabric and the washing temperature. Use only

detergents that are suitable for Drum (front load) type washers.

- If too many suds occur, reduce the detergent amount.
- If too much detergent is used, too many suds can occur and this will result in poor washing results or cause heavy load to the motor.
- If you wish to use liquid detergent, follow the guidelines provided by the detergent manufacturer.
- You can pour liquid detergent directly into the main detergent drawer if you are starting the wash cycle immediately.
- Do not use liquid detergent if you have selected **Pre Wash** option, as the liquid will dispense immediately and may harden in the drawer or the tub.
- Detergent usage may need to be adjusted for water temperature, water hardness, size and soil level of the load. For best results, avoid overdosing the detergent. Failing to do so will cause oversudsing.
- Refer to the label of the clothes, before adding the detergent and choosing the water temperature.
- Use only suitable detergents for the respective type of clothing:
  - Liquid detergent is often designed for special applications, e.g. for coloured fabric, wool, delicate or dark clothes.
  - Powdered detergent is suitable for all types of fabric.
  - For better washing results of white and pale garments, use powdered detergent with bleach.
  - Detergent is flushed from the dispenser at the beginning of the wash cycle.

**NOTE**

- Do not let the detergent harden. Doing so may lead to blockages, poor rinse performance or odour.
- Full load: According to manufacturer's recommendation.
- Part load: 1/2 of the normal amount.

**NOTE**

- Minimum load: 1/3 of full load.

**Using the ezDispense Function**

When the **ezDispense** function is turned on, the liquid detergent and softener are dispensed in the set amounts, at the appropriate time during the cycle.

- A full detergent compartment will last for about 18 standard cycles, with the drum loaded halfway up with clothes.
- The default settings are configured to dispense **45 ml** of detergent and **30 ml** of softener for **4-6 kg** of normally soiled laundry. This can be changed using the **Detergent Dispense** or **Softener Dispense** setting. Please refer to **Washer Settings** chapter for further details.

- 1 Slowly slide the detergent dispenser drawer out as far as it will go.

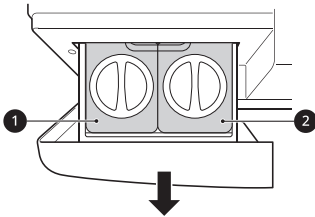

- 1 Liquid fabric softener or Liquid detergent compartment
- 2 Liquid detergent compartment

- 2 Turn the lids on the **ezDispense** compartments counterclockwise to open them.

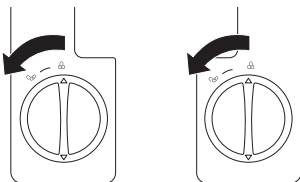

- 3 Pour the detergent and softener into their respective reservoirs, up to the **MAX** line.
  - The **ezDispense** drawer has two compartments. Put the liquid detergent into the right hand side compartment and the liquid fabric softener or liquid detergent into the left hand side compartment. If detergent is added to the ❶ compartment, the fabric softener cannot be used.
  - Do not put powdered or liquid bleach, gel, tablet detergent, natural oil based liquids or sheet type detergents, or acidic solutions such as vinegar into the **ezDispense** compartments. Doing so will cause damage to the internal tubing and other dispensing parts and affect the operation.
  - Remove any residual detergent on the outside of the **ezDispense** drawer before inserting it.
  - Do not try to fill the compartments too quickly. Add detergent and softener slowly to avoid overflows.

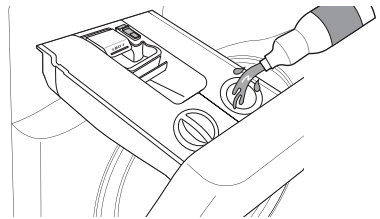

- 4 After filling the compartments, insert the lids and turn them clockwise until they are tightly closed.
  - Securely close the lids to the **ezDispense** compartments to minimize airflow which can harden cleaning products and prevent them from dispensing properly. Be careful not to lose the lids.

- 5 Close the dispenser drawer slowly before starting the cycle.
  - Slamming the drawer closed may result in the detergent overflowing into another compartment or dispensing into the drum earlier than programmed.

- Be careful not to get a hand caught in the drawer while closing.
- It is normal for a small amount of water to remain in the manual dispenser compartments at the end of the cycle.

## ⚠ CAUTION

- Close lid and cover of the compartment securely before use. If not, the detergent and softener will harden or overflow.
- Slide the detergent dispenser drawer out or in slowly and use both hands for safety. Failure to do so can damage the washer or cause the detergent or softener to leak out of the ventilation holes.
- Detergent or fabric softener left in the **ezDispense** compartments for an extended period may harden and fail to dispense properly.
- Do not remove the dispenser drawer while the product is in operation.
- Remove detergent/softener in the **ezDispense** compartments before moving or relocating the the appliance.

## Using the Manual Dispense Function

Add detergent and bleach to the manual dispenser.

- 1 To turn off the automatic dispensers, press the **SETTINGS**  button.
- 2 Select **ezDispense**.
- 3 Select **Detergent Dispense** or **Softener Dispense**.
- 4 Slide the bar all the way to the left until **Off** appears.

- 5 Open the detergent dispenser drawer.

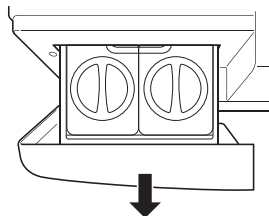

- 6 Load the laundry products into the appropriate manual dispenser compartments.
  - Use the main wash detergent compartment at the front of the manual dispenser for powdered or liquid detergent or oxygen-based bleach. Do not use it for liquid chlorine bleach.
  - Do not place detergent sheets in the manual dispenser.
  - Place liquid chlorine bleach **ONLY** in the compartment at the rear of the manual dispenser.
  - If using single-use detergent packs, place the pack in the drum before loading the laundry. Do not place liquid or powdered detergent packs in the dispenser.

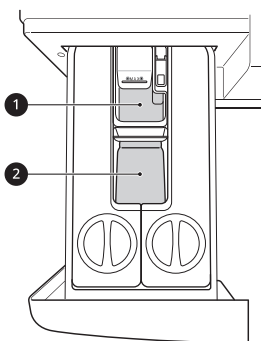

- 1 Liquid chlorine bleach compartment
- 2 Manual main wash detergent compartment

- 7 Close the detergent dispenser drawer slowly before starting the cycle.
  - Slamming the detergent dispenser drawer may result in the detergent overflowing into

another compartment or pouring into the tub earlier than programmed.

### CAUTION

- Do not place or store laundry products, such as detergent, bleach, or liquid fabric softener, on top of your washer. These products can damage the washer's finish and controls.

### NOTE

- The manual dispenser cannot be used for pre-wash detergent dispensing.
- When adding detergent tablets and water softener, be sure to turn off the **ezDispense** function.

## Manual Main Wash Detergent Compartment

This compartment holds laundry detergent for the main wash cycle. Either powdered or liquid detergent may be used in this compartment.

- The detergent is added to the load at the beginning of the cycle.
- Liquid or powdered color-safe bleach may be added to the manual main wash compartment with detergent of the same type. Do not mix liquids and powders.
- If you use a detergent that does not dissolve easily or a detergent with high viscosity, it will leave a residue and clog the dispenser.

## Liquid Bleach Compartment

This compartment holds liquid bleach, which is dispensed automatically at the proper time during the wash cycle. The dispenser is activated twice to ensure complete dispensing of the bleach. Any liquid remaining in the dispenser at the end of the cycle is water, not bleach.

### WARNING

- Do not mix chlorine bleach with ammonia or acids such as vinegar or rust/scale remover. Mixing chemicals like these can produce a lethal gas, resulting in severe injury or death.

### NOTE

- Do not add powdered bleach to this compartment. The bleach compartment is designed to dispense liquid chlorine bleach only. Powdered or liquid color-safe bleach will not dispense properly.
- Follow the manufacturer's recommendations when adding bleach. Never add more than one cup, and do not exceed the maximum fill line or the bleach may be dispensed immediately and damage fabrics. Using too much bleach can also damage fabrics.
- Never pour undiluted liquid chlorine bleach directly onto the load or into the drum. Fabric damage can occur.
- Do not use color-safe bleach or oxygen bleach in the same cycle with liquid chlorine bleach.

## Adding Detergent Tablets

Detergent tablets can also be used when washing.

- 1 Open the door and put detergent tablets into the drum before loading the clothes.
- 2 Load the clothes into the drum and close the door.

### NOTE

- Do not put tablets into the dispenser.

# Control Panel and Programme Table

## Control Panel Features

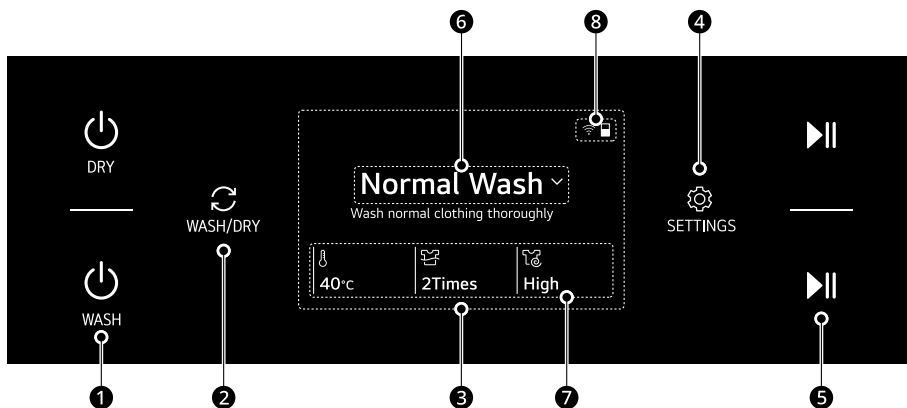

### 1 Power On/Off Button

- Press the button to turn the appliance on. Hold again to turn the appliance off.
- Pressing the **Power** button during a programme will cancel that programme and any load settings will be lost.

### 2 WASH/DRY Button

- Press this button to switch the center display between the washer and the dryer.

### 3 Status Display

- The current course and settings are shown in the display.
- Estimated time remaining and status messages are shown after the course is started.

### 4 SETTINGS Button

- This button allows you to select additional settings.

### 5 Start/Pause Button

- This **Start/Pause** button is used to start or pause a wash programme.
- When in pause, the power is turned off automatically after a certain time for safety reasons.

### 6 Programme Buttons





- Either swipe over the programme name to scroll through and select a programme, or touch down the area to open the list of programmes.

### 7 Washing programme setting Buttons

- Use these buttons to select the desired options for the selected programme. Not all options are available in each programme.
- The current settings are shown in the display.
- Press the button for that option to select other settings.

### 8 Indicators

## 32 OPERATION-WASHER

- : Displayed when the washing machine or dryer is activated. The icon is blue for washer settings and red for dryer settings.
- : lights up when the appliance is connected to **Wi-Fi** network at home.
- : lights up when the remote control feature is activated.
- : lights up when the programme starts and the door is locked.
- : lights up when the **Control Lock** function is set.

## Washing Programme

### Default washing programmes

Normal Wash		40 °C (Cold to 60 °C)	Max. Load: Rating
Description	Washes normally soiled clothes by combining various drum motions. <ul style="list-style-type: none"><li>• Pressing the <b>Start/Pause</b> button without selecting a programme will cause the <b>Normal Wash</b> programme to begin immediately, using the default settings.</li></ul>		
Note for test institutes	<ul style="list-style-type: none"><li>• Set program at “<b>Normal Wash</b>, Intensive, 3 Rinses, Extra High, 40 °C, <b>Turbo Clean On</b>” option for a normally soiled cotton load and test in accordance or in conformity with AS/NZS 2040.1.</li><li>• The test results depend on water pressure, water hardness, water inlet temperature, room temperature, type and amount of load, degree of soiling utilized detergent, fluctuations in the main electricity supply and chosen additional options.</li></ul>		

AI Wash		40 °C (Cold to 60 °C)	Max Load: 6 kg
Description	Set optimal conditions automatically according to the characteristics and contamination level of the clothing.		

Duvet		Cold (Cold to 40 °C)	Max Load: 4 kg (1 down duvet )
Description	Washes large items such as bed covers, pillows, sofa covers, etc.		

Quick Wash		40 °C (Cold to 40 °C)	Max Load: 3 kg
Description	Washes small loads of lightly soiled clothes in a short time.		

Hand / Wool		Cold (Cold to 40 °C)	Max. Load: 4 kg
Description	Washes hand-washable and machine-washable delicate clothes such as washable wool, lingerie, dresses etc.		

<b>Hygiene</b>	<b>95 °C</b>	<b>Max. Load: 3 kg</b>
Description	Washes clothes at a high temperature.	

<b>Towels</b>	<b>40 °C (Cold to 60 °C)</b>	<b>Max. Load: 5 kg</b>
Description	Washes hard wearing fabrics such as towels, shirts and tablecloths.	

<b>One Shirt</b>	<b>40 °C (Cold to 40 °C)</b>	<b>Max. Load: 1 shirt</b>
Description	Washes quickly for a single shirt.	

<b>Baby Care</b>	-	<b>Max. Load: 3 kg</b>
Description	Washes baby clothes with gentle motion and better performance.	

<b>Rinse+Spin</b>	-	<b>Max. Load: 5 kg</b>
Description	Rinses and spins clothes. Use fabric softener if needed.	

<b>Spin Only</b>	-	<b>Max. Load: Rating</b>
Description	This programme drains and spins the clothes without washing or rinsing it.	

<b>Tub Clean</b>	-	-
Description	This function helps clean the inside of your appliance's tub.	

<b>Heavy Duty</b>	<b>60 °C (40 °C to 60 °C)</b>	<b>Max. Load: 8.5 kg</b>
Description	Washes heavily soiled clothes by combining special drum motions.	

<b>Sportswear</b>	<b>30 °C (Cold to 30 °C)</b>	<b>Max. Load: 3 kg</b>
Description	Washes special garments like sports and outdoor wear. <ul style="list-style-type: none"> <li>• Use for water-repellent fabric laminate used on clothing.</li> </ul>	

<b>Colour Care</b>	<b>30 °C (Cold to 40 °C)</b>	<b>Max. Load: 2 kg</b>
Description	Helps prevent the clothes from discolouring. <ul style="list-style-type: none"> <li>• Use for cotton, mixed fabrics etc.</li> </ul>	

<b>One Piece Wash</b>	<b>40 °C (Cold to 40 °C)</b>	<b>Max. Load: 1 kg</b>
Description	Quickly wash one item of lightly contaminated clothing.	

## 34 OPERATION-WASHER

<b>Shirt</b>	<b>60 °C (40 °C to 60 °C)</b>	<b>Max. Load: 1 kg</b>
Description	Remove stubborn dirt from shirts.	

<b>Lightly Soiled</b>	<b>Cold</b>	<b>Max. Load: 3 kg</b>
Description	Wash lightly contaminated clothing with cold water.	

<b>Sweat Stains</b>	<b>40 °C (40 °C to 60 °C)</b>	<b>Max. Load: 5 kg</b>
Description	Remove sweat and stains from clothing.	

<b>Silent Wash</b>	<b>40 °C (Cold to 60 °C)</b>	<b>Max. Load: 3 kg</b>
Description	Washes clothes with less noise and vibration than other washing programmes. • Use for lightly soiled white cotton (underwear).	

<b>Rainy Season Wash</b>	<b>40 °C (Cold to 60 °C)</b>	<b>Max. Load: 3 kg</b>
Description	Use powerful spin to ensure easy drying.	

<b>Wash Only</b>	<b>40 °C (Cold to 60 °C)</b>	<b>Max. Load: 5 kg</b>
Description	Washes once with no rinse or spin.	

<b>Rinse Only</b>	<b>-</b>	<b>Max. Load: 5 kg</b>
Description	Rinses once with no wash and spin.	

### Download programmes

<b>School Uniform</b>	<b>40 °C (Cold to 60 °C)</b>	<b>Max. Load: 3 kg</b>
Description	Use this programme to wash school uniform.	

<b>Thorough Rinse</b>	<b>40 °C (Cold to 60 °C)</b>	<b>Max. Load: 5 kg</b>
Description	Add a rinse for a cleaner wash.	

### NOTE

- Select the appropriate water temperature for chosen wash programme. Always follow garment manufacturer's care label or instructions when washing to avoid damage to clothes.
- Select the proper wash temperature and spin speed for the desired programmes.
- Actual water temperature may differ from the declared cycle temperature.

- Neutral detergent is recommended.

## Extra Options

\*1 This option is automatically included in the programme.

Programme	Steam	Drying Preparation	Fresh Care	Turbo Clean
Normal Wash	●	●	●	●*1
AI Wash		●	●	●*1
Duvet		●	●	●
Quick Wash		●	●	●*1
Hand / Wool		●	●	
Hygiene	●	●	●	●
Towels	●	●	●	●*1
One Shirt		●	●	●*1
Baby Care	●*1	●	●	●
Rinse+Spin			●	
Spin Only			●	
Tub Clean				
Heavy Duty	●	●	●	●
Sportswear			●	●
Colour Care		●	●	●
One Piece Wash		●	●	●*1
Shirt	●		●	●
Lightly Soiled		●	●	●
Sweat Stains	●	●	●	●
Silent Wash		●	●	

## 36 OPERATION-WASHER

---

Programme	Steam	Drying Preparation	Fresh Care	Turbo Clean
Rainy Season Wash	●	●	●	●*1
Wash Only	●		●	
Rinse Only			●	

## Extra Options and Functions

### Customizing a Washing Programme

Each programme has default settings that are selected automatically. You may also customize these settings using these buttons.



#### Temp.

Use this option to manually select the wash temperature for the selected programme.

- Select the water temperature suitable for the type of load you are washing. Follow the garment fabric care labels for best results.

#### Rinse

The number of rinses can be selected by using this function that is recommended for people with detergent allergies.

#### Spin

It allows you to select a spin intensity level for the washing programme.

## Washer Settings

- 1 Press the **SETTINGS** button.

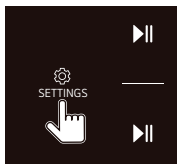

- 2 Select the desired settings and adjust them as needed.

## NOTE

- If no action is taken for several minutes after pressing the **SETTINGS** button, the display reverts to the previous screen.

#### Wash

Adjusting the wash level setting will modify the cycle times and/or wash actions.

#### Steam

Adding this option to a wash cycle helps provide superior cleaning performance. Using steam gives fabrics the cleaning benefits of a very hot wash.

- Swipe the bar to turn the option on or off.

#### Drying Preparation

Setting this function allows the the dryer to operate automatically after the washing programme.

## Follow the next steps to use a special option.

- 1 Press the **Power** button of the washer.
- 2 Select a washing programme.
- 3 Change the washing programme (**Temp.**, **Rinse** or **Spin**) if necessary.
- 4 Press the **SETTINGS** button and swipe the bar to turn this option on.
- 5 Press the **Start/Pause** button, and then touch the **OK** button within 60 seconds to begin the cycle.
  - The appliance is equipped with a 2-button start safety feature; if the **OK** button is not touched within 60 seconds, the feature will reset. In this case, repeat the steps and make

sure to press both buttons within 60 seconds of each other.

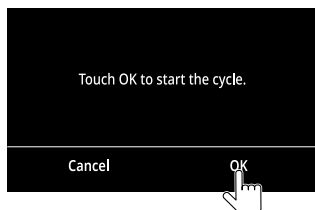

- When the dryer is turned, the paired drying programme and option will be displayed.
- After the load weight is sensed, the dryer display shows the estimated remaining dry time for about 1 minute.

**6** After the washing programme is finished, load items into the dryer and close the door.

**7** Press the **Start/Pause** button.

### ezDispense™

Select this option to open the controls for the ezDispense auto-dispense function. The available options vary based on dispenser usage settings.

- **Dispenser Usage:** Select how to use the 2 dispenser tanks—detergent and softener, 2 different detergents, or the same detergent in both tanks.
- **Detergent Dispense:** Set the amount of detergent dispensed for each load.
- **Softener Dispense:** Set the amount of softener dispensed for each load.
- **Detergent in Use:** When using the tanks for 2 different detergents, select whether to use the detergent in tank 1 or tank 2.
- **Detergent 1 Dispense:** Set the amount of detergent in tank 1 to dispense for each load.
- **Detergent 2 Dispense:** Set the amount of detergent in tank 2 to dispense for each load.
- From the dispense screen, press the default amounts button to change the default dispense settings for all loads.

### Remote Start

With the **LG ThinQ** app, you can use a smartphone to control your appliance remotely. In order to use

the **Remote Start** function, refer to **SMART FUNCTIONS**.

### Delay End

Once you have selected the programme and other settings, press the **SETTINGS - Delay End** button to delay the start of the programme.

- Once the desired delay time is set, press the **Start/Pause** button to start the delay time.
- If you want to cancel your reservation, press the **Delay End - Turn off** button or press **Delay End - Change - Not reserved**.

### NOTE

- If the **Start/Pause** button is not pressed to begin the delay time, the washer automatically turns off after a certain time and all cycle settings are lost.

### Fresh Care

Use this option when you will not be able to unload your clothes immediately after the washing programme ends.

- Swipe the bar to turn the option on or off.
- The drum will tumble periodically for up to 19 hours to prevent wrinkles.

### Turbo Clean

Adding this option reduces the programme time but the similar washing results will be provided.

- Swipe the bar to turn the option on or off.

### Drum Light

The drum is equipped with a white LED light that illuminates when the appliance is turned on. This light automatically turns off when the door is closed and the programme starts.

- Swipe the bar to turn the option on or off.

## Washer Additional Settings

**1** Press the **SETTINGS** button.

**2** Scroll down and select the **Washer Additional Settings**.

- 3 Select the desired settings and adjust them as needed.

## NOTE

- If no action is taken for several minutes after pressing the **SETTINGS** button, the display reverts to the previous screen.

### Cycle List Edit

Edit the list of wash programmes that are displayed. Some wash programmes cannot be deleted from the default list.

### Cycle Optimisation

When activated, this feature organizes the programme list and options automatically based on your usage patterns.

- On is the default setting.
- Turning off retains the current list order.

### ezDispense™ Nozzle Clean

Use this option to periodically clean the ezDispense compartments or before changing the softener compartments to a detergent compartment.

- This function cleans residual detergent or softener in the hose connected to the **ezDispense** (when changing the type of detergent or softener).

## ⚠ CAUTION

- Before using the function, remove the ezDispense compartment, clean it, fill it with water and reassemble it in the dispenser drawer.

### Signal

The volume of the notification sounds and button sounds can be set from **Off** to **Very High**.

- Default volume is **Very High** and can be adjusted.
  - Volume : **Off, Low, Medium, High, Very High**

### Smart Diagnosis

Use this to help troubleshoot errors or malfunctions.

- See the **Smart Diagnosis** section for more details.

## Washer And Dryer Common Settings

- 1 Press the **SETTINGS** button.
- 2 Press the **Washer & Dryer Common Settings**.
- 3 Select the settings and adjust them as needed.

## NOTE

- If no action is taken for several minutes after pressing the **SETTINGS** button, the display reverts to the previous screen.

### Wi-Fi

Use this function when you want to turn on or off your Wi-Fi connection.

### Direct Pairing

It automatically sets the drying cycle suitable for the washing cycle.

### Control Lock

Use this option to disable the controls. This function can prevent children from changing cycles or operating the appliance.

## NOTE

- The function does not lock the door.
- Once this function is set, all buttons are locked except the **Power** and **SETTINGS** buttons.
- Turning off the power will not reset this function. You must deactivate this function before you can access any other options and functions.

### Brightness

Use this function to adjust the brightness of the display.

### Factory Reset

Select this to delete all the stored data and initialize settings.

# OPERATION-DRYER

## Operation Overview

### Using the Dryer

Before the first cycle, set the appliance to dry for 5 minutes to warm up the drum. Open the door between loads the first few times you use the appliance to allow any odours from the interior of the appliance to disperse.

Children must be supervised so that they do not climb inside the drum.

- 1 Ensure the lint filter is clean.

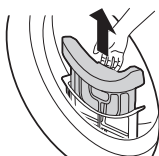

- Open the door and ensure the lint filter is clean. When the filter is full with lint, drying times will be longer than usual.

- 2 Place the clothes into the drum after sorting and close the door.

- Push the clothes deep into the drum so that the clothes keeps away from the door seal. When the clothes get stuck between the door and seal, they may get damaged while drying.
- The clothes should be sorted by fabric types and dryness level.
- All strings and attached belts of clothes should be well tied and fixed before being put into the drum.

- 3 Press the **Power** button to turn the appliance on.

- Depending on the models, the **Power** button may light up to indicate that the appliance is ready for dry.

- 4 Either swipe over the programme name to scroll through and select a programme, or touch down the area to open the list of programmes.



- 5 Use these buttons to select the desired options for the selected programme. Not all options are available in each programme.

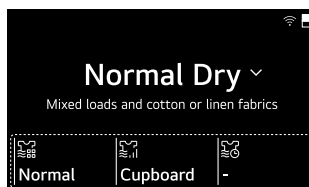

### NOTE

- If you change the drying programme, the setting you set will be deleted, so please set it again.

- 6 Press the **SETTINGS** button to select the desired option.

- 7 Press the **Start/Pause** button to start the drying programme.

### NOTE

- The appliance washes lint, which builds up onto the surface of the condenser, automatically using water that is condensed from the clothes during operation.

- The frequency of cleaning condenser may vary depending on the size and the initial moisture amount of the clothes.

- 8** After the drying programme has finished, open the door and unload the clothes.

### **⚠ CAUTION**

- Be careful! The drum inside may still be hot.

- 9** Press the **Power** button to turn the appliance off.

- 10** Clean the lint filter.

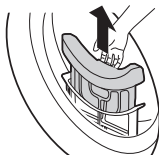

- 11** To help reduce odours from forming, the dryer's door can be left open or slightly ajar for a short period of time if possible to help ventilate the drum after use.

### **⚠ WARNING**

- For safety reasons, do not allow children or animals to enter the appliance. It may cause damage or injury.

### **NOTE**

- The final part of a tumble dry cycle occurs without heat (cool down cycle) to ensure that the clothes are left at a temperature that ensures the clothes will not be damaged.
- A high atmospheric temperature and a small room may both increase drying time as well as energy consumption.

## Preparing the Laundry

### **NOTE**

- Do not overload the appliance for the best drying performance and most efficient energy usage.

## Checking the clothes before loading

### **⚠ CAUTION**

- Check that the clothes are not stuck between appliance and door, otherwise the clothes may get damaged while drying.
- Observe the maximum load capacity on the programme table for the relevant drying programme to get optimum drying results. Overloading gives a poor drying result and causes unnecessary creasing.
- Do not load soaking wet clothes into the appliance. It will cause an increasing of drying time and energy consumption. Make sure that the clothes are spun thoroughly before loading.
- A mixed fabric load can cause the drying time to be extended and the time remaining in the display to pause during active drying. The remaining time will then continue when it is the actual time that remains.
- Make sure to empty all pockets. Items such as nails, hair clips, matches, pens, coins and keys can damage both your appliance and clothes.
- Remove loose belts and close zippers, hooks and strings to make sure that these items do not snag other clothes.

## Sorting the Clothes

Clothes have their own fabric care labels, so drying according to the fabric care label is recommended. Sort the clothes into size and type of fabric and then prepare the clothes according to the symbols on the fabric care labels.

### Woollens

- Be sure to follow fabric care label symbols first. Wool may not be completely dried from the cycle, so do not repeat drying. Pull woollens to their original shape and dry them flat.

### Woven and Loopknit Materials

- Some woven and loopknit materials may shrink, depending on quality.

### Non-Iron and Synthetics

- Do not overload the appliance. Take out non-Iron items as soon as the appliance stops to reduce creases.

### Baby Clothes and Night Gowns





- Always check fabric care labels.

### Rubber and Plastics

- Do not dry any items made from or containing rubber or plastics such as:
  - Aprons, Bibs and Chair Covers
  - Curtains and Table Cloths
  - Bathmats



### Fiberglass

- Do not dry fiberglass items in the appliance. Glass particles left in the appliance may be subsequently picked up by your clothes in later cycles.

Symbol	Description
	Gentle / Delicate
	Do not Tumble Dry
	Do not Dry
	High Heating
	Medium Heating
	Low Heating
	No Heating / Air
	Line Dry / Hang to dry
	Drip Dry
	Dry Flat
	In the Shade

## Checking the Fabric Care Label

The symbols on the fabric care label tell you about the fabric content of your clothes and how it should be dried.

Symbol	Description
	Dry
	Tumble Dry
	Permanent Press / Crease Resistant

# Control Panel and Programme Table

## Control Panel Features

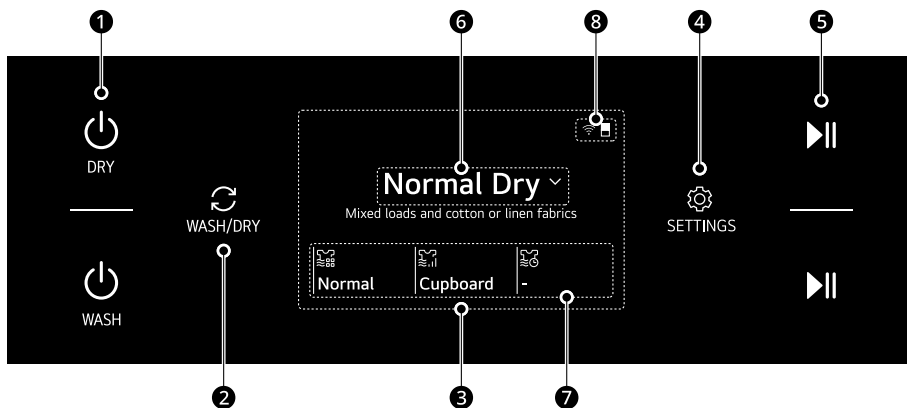

### 1 Power On/Off Button

- Press the button to turn the appliance on. Hold again to turn the appliance off.
- Pressing the **Power** button during a programme will cancel that programme and any load settings will be lost.

### 2 WASH/DRY Button

- Press this button to switch the center display between the washer and the dryer.

### 3 Status Display

- The current course and settings are shown in the display.
- Estimated time remaining and status messages are shown after the course is started.

### 4 SETTINGS Button

- This button allows you to select additional settings.

### 5 Start/Pause Button

- This **Start/Pause** button is used to start or pause a dry programme.
- When in pause, the power is turned off automatically after a certain time for safety reasons.





### 6 Programme Buttons

- Either swipe over the programme name to scroll through and select a programme, or touch down the area to open the list of programmes.

### 7 Drying programme setting Buttons

- Use these buttons to select the desired options for the selected programme. Not all options are available in each programme.
- The current settings are shown in the display.
- Press the button for that option to select other settings.

### 8 Indicators

- : Displayed when the washing machine or dryer is activated. The icon is blue for washer settings and red for dryer settings.
- : lights up when the appliance is connected to **Wi-Fi** network at home.
- : lights up when the remote control feature is activated.
- : lights up when the programme starts and the door is locked.
- : lights up when the **Control Lock** function is set.

## Drying Programme

### Default drying programmes

Programme	[Normal Dry]	Max. Load Capacity	Rating
<b>Dry Level</b> • Detail	<b>Extra</b> • For thick and quilted fabrics		
	<b>Very</b> • For fabrics that need to dry more strongly than <b>Cupboard</b>		
	<b>Cupboard</b> • For fabrics that do not need to be ironed		
	<b>Light</b> • For fabrics that need to reduce shrinkage and static electricity generation		
	<b>Iron</b> • For fabrics that need to be ironed		
<b>Note for test institutes</b>	• Set program <b>Normal Dry + Normal + Cupboard</b> option for test in accordance or in conformity with AS/NZS 2442.1. • The test results depend on room temperature, type and amount of load, water hardness.		

Programme	[AI Dry]	Max. Load Capacity	5 kg
<b>Detail</b>	A course that dries according to the characteristics of the clothing in the optimal conditions		

Programme	[Duvet]	Max. Load Capacity	4 kg (1 down duvet )
<b>Clothing Type</b>	Beddings, bed sheets		
<b>Detail</b>	For bulky items		

<b>Programme</b>	<b>[Quick Dry]</b>	<b>Max. Load Capacity</b>	<b>1.5 kg</b>
<b>Clothing Type</b>	Light and small laundry less than 3 items		
<b>Detail</b>	For small amount of polyamide, acrylic and polyester items		

<b>Programme</b>	<b>[Delicates]</b>	<b>Max. Load Capacity</b>	<b>1 kg</b>
<b>Clothing Type</b>	Wool		
<b>Detail</b>	For wool fabrics that are suitable for tumble drying		

<b>Programme</b>	<b>[Bedding Refresh]</b>	<b>Max. Load Capacity</b>	<b>3 kg</b>
<b>Clothing Type</b>	Blankets, comforters		
<b>Detail</b>	Remove dust from the beddings with airflow.		

<b>Programme</b>	<b>[Towels]</b>	<b>Max. Load Capacity</b>	<b>5 kg</b>
<b>Clothing Type</b>	Towels		
<b>Detail</b>	A towel drying course		

<b>Programme</b>	<b>[Down Jacket Refresh]</b>	<b>Max. Load Capacity</b>	<b>2 kg</b>
<b>Clothing Type</b>	Padding, Seasonal clothing		
<b>Detail</b>	A course that enhances the volume of seasonal clothing such as padding, not drying course		

<b>Programme</b>	<b>[Time Dry]</b>	<b>Max. Load Capacity</b>	<b>-</b>
<b>Detail</b>	A course that can be dried by setting a time		

<b>Programme</b>	<b>[Allergy Care]</b>	<b>Max. Load Capacity</b>	<b>4.5 kg</b>
<b>Clothing Type</b>	Cotton clothes, underwear		
<b>Detail</b>	A course for hygienic drying of cotton clothing, underwear		

<b>Programme</b>	<b>[Drum Clean]</b>	<b>Max. Load Capacity</b>	-
<b>Detail</b>	A course to prevent odour by sterilizing the inside of the dryer		

<b>Programme</b>	<b>[Outerwear Refresh]</b>	<b>Max. Load Capacity</b>	-
<b>Clothing Type</b>	Outdoor clothes. It is effective if you put in a proper set of clothes.		
<b>Detail</b>	A course to restore the degraded water repellency performance of outdoor clothing, not drying course		

You can use a variety of drying courses by using **Cycle List Edit** in **SETTINGS**.

<b>Programme</b>	<b>[Shrinkage Relief]</b>	<b>Max. Load Capacity</b>	<b>3 kg</b>
<b>Clothing Type</b>	Cotton clothes		
<b>Detail</b>	A course optimized for temperature, proper drying degree, and optimal motion to ease the shrinkage of the fabric		

<b>Programme</b>	<b>[Cool Air]</b>	<b>Max. Load Capacity</b>	<b>Rating</b>
<b>Detail</b>	A course that breezes without heat		

<b>Programme</b>	<b>[Baby Care]</b>	<b>Max. Load Capacity</b>	<b>1.5 kg</b>
<b>Clothing Type</b>	Baby clothes		
<b>Detail</b>	A course for drying small amounts of light clothing, such as baby clothes		

<b>Programme</b>	<b>[Heavy Duty]</b>	<b>Max. Load Capacity</b>	<b>Rating</b>
<b>Clothing Type</b>	Cotton clothes, thick clothes		
<b>Detail</b>	A course that strongly dries thick or cotton clothing		

<b>Programme</b>	<b>[Sportswear]</b>	<b>Max. Load Capacity</b>	<b>2 kg</b>
<b>Clothing Type</b>	Sportswear		
<b>Detail</b>	A course for drying sportswear		

<b>Programme</b>	<b>[Shirt]</b>	<b>Max. Load Capacity</b>	<b>3.5 kg</b>
<b>Clothing Type</b>	Shirt		
<b>Detail</b>	A course to dry a shirt that is prone to deformation or damage		

<b>Programme</b>	<b>[Easy Ironing]</b>	<b>Max. Load Capacity</b>	<b>Rating</b>
<b>Detail</b>	A course that dries in a moist state so that it is suitable for ironing		

<b>Programme</b>	<b>[Silent Dry]</b>	<b>Max. Load Capacity</b>	<b>3 kg</b>
<b>Detail</b>	A course that dries quietly when the sound of the product needs to be reduced		

<b>Programme</b>	<b>[Rainy Days]</b>	<b>Max. Load Capacity</b>	<b>Rating</b>
<b>Detail</b>	A course used when you want to dry your rain-soaked clothes		

## Download programmes

<b>Programme</b>	<b>[Wrinkle Prevention]</b>	<b>Max. Load Capacity</b>	<b>-</b>
<b>Detail</b>	Tumbles clothes after cycle to prevent wrinkles		

<b>Programme</b>	<b>[Rack Dry]</b>	<b>Max. Load Capacity</b>	<b>-</b>
<b>Detail</b>	Manually select the drying time		

## Extra Options

<b>Programme</b>	<b>Dry Mode</b>
<b>[Normal Dry]</b>	<b>Eco</b>
	<b>Normal<sup>*1</sup></b>
	<b>Turbo</b>
<b>[AI Dry]</b>	<b>Normal<sup>*1</sup></b>
<b>[Duvet]</b>	<b>Normal<sup>*1</sup></b>

Programme	Dry Mode
[Quick Dry]	Turbo <sup>*1</sup>
[Delicates]	Normal <sup>*1</sup>
[Bedding Refresh]	Normal <sup>*1</sup>
[Towels]	Normal <sup>*1</sup>
[Down Jacket Refresh]	Turbo <sup>*1</sup>
[Time Dry]	Normal <sup>*1</sup>
[Allergy Care]	Turbo <sup>*1</sup>
[Drum Clean]	Turbo <sup>*1</sup>
[Outerwear Refresh]	Turbo <sup>*1</sup>
[Shrinkage Relief]	Normal <sup>*1</sup>
[Cool Air]	-
[Baby Care]	Normal <sup>*1</sup>
[Heavy Duty]	Normal <sup>*1</sup>
[Sportswear]	Eco <sup>*1</sup>
[Shirt]	Normal <sup>*1</sup>
[Easy Ironing]	Turbo <sup>*1</sup>
[Silent Dry]	Normal <sup>*1</sup>
[Rainy Days]	Turbo <sup>*1</sup>

\*1 This option is automatically included in the programme.

## NOTE

- Only **[Normal Dry]** programme is available to select dryness level.
- The estimated time remaining will change if you select extra options for the programme.

## Extra Options and Functions

### Customizing a Drying Programme

Each programme has default settings that are selected automatically. You may also customize these settings using these buttons.

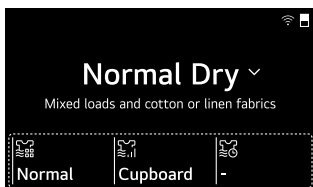

#### Dry Mode

Use this button to select the **Dry Mode** for the programme.

- **Eco:** Energy saving option
- **Normal:** Default drying option
- **Turbo:** Time saving option

#### NOTE

- Selectable options will differ depending on the selected programme.

#### Dry Level

It allows you to select a dryness level for the drying programme.

#### Dry Time

Use this option to manually select the drying time, from 20 to 240 minutes, in 10-30 minute increments. Use this for small loads or to reduce wrinkles.

#### NOTE

- Clothes might be still damp depending on the fabric type of the clothes after drying. In this case, use this option to dry the clothes more thoroughly.

## Rack Dry

This programme is designed for use with clothes that must be dried flat, without tumbling, including sweaters and delicate fabrics.

To use the programme, you need a dryer rack that is placed inside the appliance. Before drying, discard packing materials of the dryer rack.

#### NOTE

- Some models are not sold with all of the available accessories, you may need to purchase the dryer rack first if it was not provided with your model. Please contact LG Electronics Customer Information Centre or visit the LG Website at <http://www.lg.com> for purchase.

- 1 Open the door.
- 2 Insert the hook of dryer rack to the drum centre.

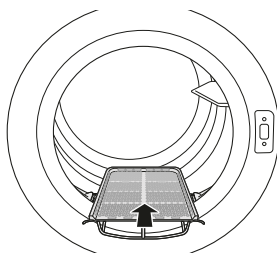

- 3 Place the dryer rack on the structure above the lint filter and press it to complete assembly.

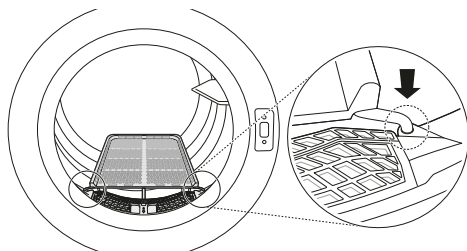

- 4 Place wet items on top of the rack. Allow space around items for air to circulate.

- The dryer rack does not move, but the drum will rotate.

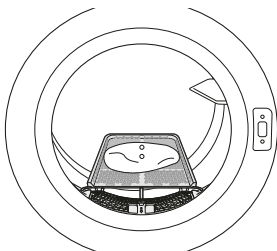

- 5 Close the door.
- 6 Turn power on and press the **Dry Time** button to finely adjust the drying time.
- 7 Hold the **Start/Pause** button.

### NOTE

- Check the lint filter and remove any lint accumulated from items dried on the rack.

## Dryer Settings

- 1 Press the **SETTINGS** button.

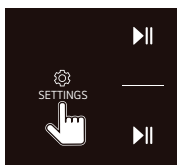

- 2 Select the desired settings and adjust them as needed.

### NOTE

- If no action is taken for several minutes after pressing the **SETTINGS** button, the display reverts to the previous screen.

### Wrinkle Care

Selecting this option will tumble the load periodically for up to 3 hours after the selected programme, or until the door is opened. This is helpful in preventing wrinkles when you are unable to remove items from the dryer immediately. Select this option before you start a drying programme.

- Swipe the bar to turn the option on or off.
- When the option is set, only the **Power** button works after the drying programme ends.
- When a drying programme is running, pause the programme first to set the option.
- Always turn off the appliance before unloading the clothes.

### Damp Dry Signal

When this option is selected, the appliance signals when the load is approximately 80% dry. This allows you to remove faster-drying lightweight items or items that you would like to iron or hang while they are still slightly damp.

- Swipe the bar to turn the option on or off.

### Remote Start

With the **LG ThinQ** app, you can use a smartphone to control your appliance remotely. In order to use the **Remote Start** function, refer to **SMART FUNCTIONS**.

### Delay End

Once you have selected the programme and other settings, press the **Delay End** button to delay the start of the programme.

- If you want to cancel your reservation, press the **Delay End - Turn off** button or press **Delay End - Change - Not reserved**.

### Drum Light

The drum is equipped with a white LED light that illuminates when the appliance is turned on. This light automatically turns off when the door is closed and the programme starts.

- Swipe the bar to turn the option on or off.

## Dryer Additional Settings

- 1 Press the **SETTINGS** button.

**2** Scroll down and select the **Dryer Additional Settings**.

**3** Select the desired settings and adjust them as needed.

### NOTE

- If no action is taken for several minutes after pressing the **SETTINGS** button, the display reverts to the previous screen.

### Cycle List Edit

Edit the list of dry programmes that are displayed. Some dry programmes cannot be deleted from the default list.

### Cycle Optimisation

When activated, this feature organizes the programme list and options automatically based on your usage patterns.

- On is the default setting.
- Turning off retains the current list order.

### Condenser Care

For more information, see **Using Condenser Clean Feature** in **MAINTENANCE**.

### Signal

The volume of the notification sounds and button sounds can be set from **Off** to **Very High**.

- Default volume is **Very High** and can be adjusted.
  - Volume : **Off, Low, Medium, High, Very High**

### Smart Diagnosis

Use this to help troubleshoot errors or malfunctions.

- See the **Smart Diagnosis** section for more details.

## Washer And Dryer Common Settings

**1** Press the **SETTINGS** button.

**2** Press the **Washer & Dryer Common Settings**.

**3** Select the settings and adjust them as needed.

### NOTE

- If no action is taken for several minutes after pressing the **SETTINGS** button, the display reverts to the previous screen.

### Wi-Fi

Use this function when you want to turn on or off your Wi-Fi connection.

### Direct Pairing

It automatically sets the drying cycle suitable for the washing cycle.

### Control Lock

Use this option to disable the controls. This function can prevent children from changing cycles or operating the appliance.

### NOTE

- The function does not lock the door.
- Once this function is set, all buttons are locked except the **Power** and **SETTINGS** buttons.
- Turning off the power will not reset this function. You must deactivate this function before you can access any other options and functions.

### Brightness

Use this function to adjust the brightness of the display.

### Factory Reset

Select this to delete all the stored data and initialize settings.

# SMART FUNCTIONS

## Using LG ThinQ Application

The **LG ThinQ** application allows you to communicate with the appliance using a smartphone.

### LG ThinQ Application Features

Communicate with the appliance from a smartphone using the convenient smart features.

#### Remote Start

It allows you to control the appliance remotely from the **LG ThinQ** application.

#### Download Cycle

You can download new and special cycles that are not included in the basic cycles on the appliance.

A variety of specialty cycles specific to the appliance can be downloaded to the successfully registered appliances.

#### Tub Clean Coach (Washer)

This function shows how many cycles remain before it is time to run the **Tub Clean** function.

#### Energy Monitoring

This function checks the energy consumption of the recently used cycles and monthly average.

#### Smart Diagnosis

This function provides useful information for diagnosing and solving issues with the appliance based on the pattern of use.

#### Settings

Allows you to set various options on the appliance and in the application.

#### Push Alert

When the cycle is complete or the appliance has problems, you have the option of receiving push notifications on a smartphone. The notifications are triggered even if the **LG ThinQ** application is off.

### NOTE

- In the following cases, you must update the network information for each appliance in the

**LG ThinQ** application under **Device Cards > Settings > Change Network**.

- wireless router is changed
- wireless router password is changed
- Internet service provider is changed
- The application is subject to change for appliance improvement purposes without notice to users.
- Functions may vary by model.

## Installing LG ThinQ App and Connecting an LG Appliance

### Models with QR Code

Scan the QR code attached to the product using the camera or a QR code reader app on your smartphone.

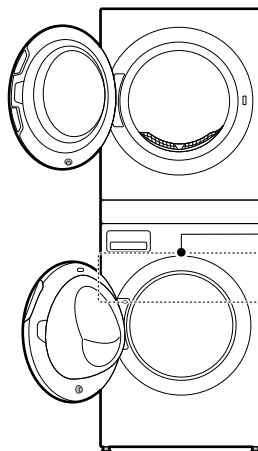

## Models without QR Code

- 1 Search for and install the **LG ThinQ** app from the Google Play Store or Apple App Store on a smartphone.
- 2 Run the **LG ThinQ** app and sign in with your existing account or create an LG account to sign in.
- 3 Touch the add (+) button on the **LG ThinQ** app to connect your LG appliance. Follow the instructions in the app to complete the process.

### NOTE

- You may be asked to provide a password to connect to the LG network (not your home network) during the Wi-Fi setup. The password is the last 4 characters of the network name, repeated twice, with no spaces. For example, if the network name appears as LG\_XXXX\_8b92, then you would enter 8b928b92 as your password. The password is case sensitive and the last 4 characters are unique to your appliance.
- To verify the Wi-Fi connection, check that the  icon on the control panel is lit.
- The appliance supports 2.4 GHz Wi-Fi networks only. To check your network frequency, contact your Internet service provider or refer to your wireless router manual.
- **LG ThinQ** is not responsible for any network connection problems or any faults, malfunctions, or errors caused by network connection.
- If the appliance is having trouble connecting to the Wi-Fi network, it may be too far from the router. Purchase a Wi-Fi repeater (range extender) to improve the Wi-Fi signal strength.
- The Wi-Fi connection may not connect or may be interrupted because of the home network environment.
- The network connection may not work properly depending on the Internet service provider.

- The surrounding wireless environment can make the wireless network service run slowly.
- If the appliance cannot be registered due to problems with the wireless signal transmission, unplug the appliance and wait about a minute before trying again.
- If the firewall on your wireless router is enabled, disable the firewall or add an exception to it.
- The wireless network name (SSID) should be a combination of English letters and numbers. (Do not use special characters.)
- Smartphone user interface (UI) may vary depending on the mobile operating system (OS) and the manufacturer.
- If the security protocol of the router is set to **WEP**, network setup may fail. Change the security protocol (**WPA2** is recommended) and connect the product again.

## Using the Appliance Remotely

### Remote Start

Use a smartphone to control your appliance remotely. You can also monitor your cycle operation so you know how much time is left in the cycle.

### Using this function

- 1 Put the clothes into the drum.
- 2 Press the **Power** button.
- 3 Set the **Remote Start** function of the Washer and Dryer.
  - Washer: Press the **SETTINGS** and swipe the bar to turn on or off the **Remote Start**.
  - Dryer: Press the **SETTINGS** and swipe the bar to turn on or off the **Remote Start**.
- 4 Start a cycle from the **LG ThinQ** application on your smartphone.

### NOTE

- All buttons are available when **Remote Start** is activated. The **WASH/DRY** button is activated when both the washer and dryer are on. Use the **LG ThinQ** app to select and start the course.
  - You can use the **Remote Start** function by pressing the **Power** button on the product and then pressing the **Start/Pause** button. However, depending on the model you purchased, the function to operate the product with remote start is different, so check it out on the **LG ThinQ** app.
  - If the door has been opened, you can not start a cycle remotely.
- 

### Disable this function manually

To turn off **Remote Start** function, press the **Power** button or **Start/Pause** button or enter **SETTINGS - Remote Start**.

### Delay End

Setting this function allows the appliance to start automatically and finish after a specified time.

### Using this function

- 1 Put the clothes into the drum.
- 2 Press the **Power** button.
- 3 Run **LG ThinQ** application and select the product.
  - For washing, select the washer.
  - For drying, select the dryer.
- 4 Select a washing or drying programme.
- 5 Touch the **Delay End** and set the delay time.
- 6 Start a cycle from the **LG ThinQ** application on your smartphone.

### NOTE

- The delay time is the time to the end of the programme, not the start. The actual running time may vary due to water temperature, clothes and other factors.
  - Avoid using liquid detergent for this function.
- 

## RF Radiation Exposure Statement

This equipment shall be installed and used at a minimum distance of 20 cm from the human body.

## Open Source Software Notice Information

To obtain the source code that is contained in this product, under GPL, LGPL, MPL, and other open source licenses that have the obligation to disclose source code, and to access all referred license terms, copyright notices and other relevant documents, please visit <https://opensource.lge.com>.

LG Electronics will also provide open source code to you on CD-ROM for a charge covering the cost of performing such distribution (such as the cost of media, shipping, and handling) upon email request to [opensource@lge.com](mailto:opensource@lge.com).

This offer is valid to anyone in receipt of this information for a period of three years after our last shipment of this product.

## Smart Diagnosis

Use this feature to help you diagnose and solve problems with your appliance.

### NOTE

- For reasons not attributable to LGE's negligence, the service may not operate due to external factors such as, but not limited to, Wi-Fi unavailability, Wi-Fi disconnection, local app store policy, or app unavailability.

- The feature may be subject to change without prior notice and may have a different form depending on where you are located.

## Using LG ThinQ to Diagnose Issues

If you experience a problem with your Wi-Fi equipped appliance, it can transmit troubleshooting data to a smartphone using the **LG ThinQ** application.

- Launch the **LG ThinQ** application and select the **Smart Diagnosis** feature in the menu. Follow the instructions provided in the **LG ThinQ** application.

## Using Audible Diagnosis to Diagnose Issues

Follow the instructions below to use the audible diagnosis method.

- Launch the **LG ThinQ** application and select the **Smart Diagnosis** feature in the menu. Follow the instructions for audible diagnosis provided in the **LG ThinQ** application.

- 1 Press the **Power** button to turn on the appliance.
  - Do not press any other buttons.
- 2 Hold the mouthpiece of your phone in front of the appliance.
  - Washer: Hold the phone to the right of the **Start/Pause** button.
  - Dryer: Hold the phone to the left of the **Power** button.
- 3 Press the **SETTINGS - Washer Additional Settings** or **Dryer Additional Settings - Smart Diagnosis** and the **Start/Pause** button.
  - If you have operated a different button or dial before pressing the **Smart Diagnosis** button, turn it off and start all over again.

- Keep the smartphone in place until the data transfer has finished. Time remaining for data transfer is displayed.

- 4 After the data transfer is complete, the diagnosis will be displayed in the application.

### NOTE

- For best results, do not move the smartphone while the tones are being transmitted.

# MAINTENANCE

## ⚠ WARNING

- Unplug the appliance before cleaning to avoid the risk of electric shock. Failure to follow this warning may result in serious injury, fire, electric shock, or death.
- Never use harsh chemicals, abrasive cleaners, or solvents to clean the appliance. They may damage the finish.

## Washer

### What to Clean

Always remove items from the washing machine as soon as the cycle is complete. Leaving damp items in the washing machine can cause wrinkling, colour transfer, and odour.

- After the wash cycle is finished, wipe the door and door seal to remove any moisture.
- Leave the door slightly open to dry the drum.
- Wipe the appliance with a dry cloth to remove any moisture.

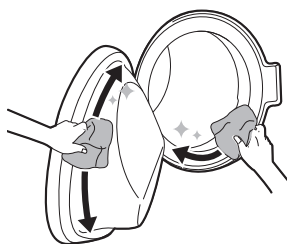

## ⚠ WARNING

- Leave the door open to dry inside of the appliance only if the children are supervised at home.

## Cleaning the Exterior

Proper care of your appliance can extend the service life.

### Exterior

- Immediately wipe off any spills.
- Wipe with a damp cloth and then again with a dry cloth ensuring there is no moisture in cabinet joints or crevices.
- Do not press on the surface or the display with sharp objects.

### Door

- Wash with a damp cloth on the outside and inside and then dry with a soft cloth.

## ⚠ WARNING

- Do not attempt to separate any panels or disassemble the appliance. Do not apply any sharp objects to the control panel in order to operate the appliance.

## Cleaning the Drum

This is a special function to help clean the inside of the appliance by soaking, washing, rinsing and spinning.

Run this function **once a month** (or more often if needed) to reduce build-up of detergent and softener and other residue.

- If there is a bad smell or mildew inside the appliance, run this function **once a week for 3**

**weeks** in addition to the regularly prompted intervals.

**NOTE**

- The **ErrL** message will be displayed to alert to the recommendation of operating this function.

- 1 Remove any clothing or items from the appliance and close the door.
- 2 Open the dispenser drawer and add anti limescale powder to the main wash compartment.
  - Tablets can be placed directly into the drum as an alternative to powder.
- 3 Close the dispenser drawer slowly.
- 4 Turn on the power, and then press the **Tub Clean** button.
- 5 Press the **Start/Pause** button to start.
- 6 Leave the door open to dry the inside of the appliance completely.
  - When the inside of the appliance is not dried completely, it may cause a bad smell or mildew.

**⚠ WARNING**

- Leave the door open to dry inside of the appliance only if the children are supervised at home.

**Cleaning the Water Inlet Filter**

The water inlet filter collects lime or any sediment that may be in water that is supplied to the appliance. Clean the inlet filter every six months or

so, or more often if the water is very hard or contains traces of limescale.

- Turn off the water supply taps to the appliance if the appliance is to be left for a certain period of time (e.g. holiday), especially if there is no floor drain (gully) in the immediate vicinity.
- If error message will be displayed on the control panel when the water is not entering the detergent drawer.

- 1 Turn off the power and the water tap and then unscrew the water inlet hose.

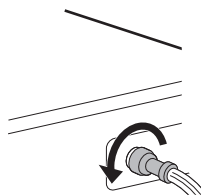

- 2 Remove the water inlet filter with small pliers and then clean the filter using a medium bristle tooth brush.

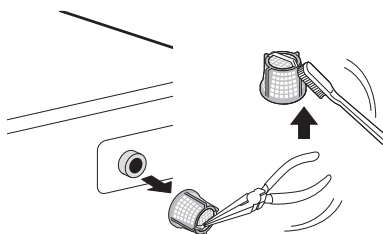

**Cleaning the Drain Pump Filter and Performing an Emergency Water Evacuation**

The drain filter collects threads and small objects that may have been accidentally left in the clothes. Make sure that the filter is clean every six months to ensure smooth running of your appliance.

Allow the water to cool before cleaning the drain pump filter. Open the door in an emergency or perform an emergency water evacuation.

- 1 Unplug the appliance.

- 2 Open the cover cap and pull out the drain tube.

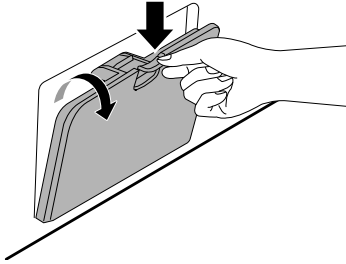

- 3 Remove the drain plug from the drain tube first ①, and then drain the water. Then slowly unscrew the drain pump filter ② to drain the remaining water and then proceed to remove any debris or objects from the filter.

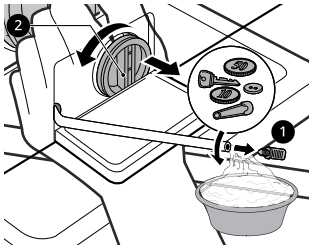

- 4 After cleaning the drain pump filter, carefully reinsert the filter and screw the drain cap back in clockwise carefully to avoid cross threading and leakage. Reinsert the plug back into the drain tube and place the tube into its holder.

- 5 Close the cover cap.

### ⚠ CAUTION

- Be careful when draining, as the water may be hot.
- Run the drum cleaning programme once a month (or more often, as needed) to remove excess detergent and other debris.

## Cleaning the ezDispense Drawer

Clean the **ezDispense** compartments **every time** you refill the detergent/softener or change to a new type of detergent/softener.

Remove and clean the detergent dispenser drawer **once or twice a month**. Leaving detergent in the detergent dispenser drawer for an extended period or using the washing machine for a long time may cause the build-up of residue in the detergent dispenser drawer.

### ⚠ WARNING

- Do not spray water inside the washing machine. Doing so may cause fire or electric shock.

- 1 Turn off the washing machine, and unplug the power cord.
- 2 Pull out the detergent dispenser drawer until it stops.
- 3 Press down the disengage button ① to completely remove the drawer.

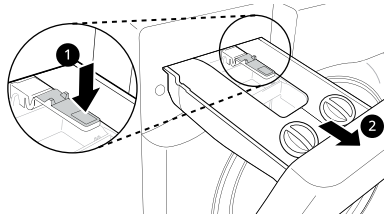

- 4 Remove the check valve to remove any residual detergent/softener and close the check valve.

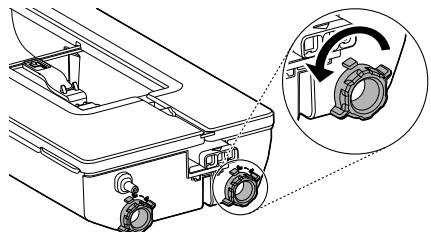

5 Open the lids.

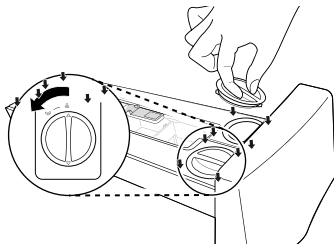

6 Clean the inserts with warm water.

- Rinse the drawer in warm water to dissolve the detergent residue or softener scale.
- Use a soft cloth or brush to remove any residue.
- Do not use soap when cleaning the drawer and inserts.

7 If the detergent or softener is hardened inside the **ezDispense** compartments, remove the covers on the drawer.

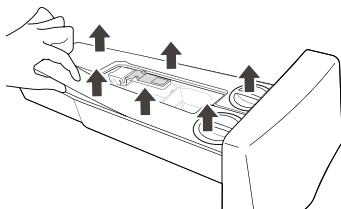

8 Clean the insides of the compartments with warm water.

- Use a soft cloth or brush to clean and to remove any residue.
- Do not use soap when cleaning the drawer and inserts.

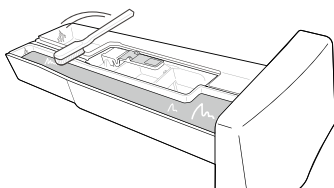

9 Securely close the covers on the **ezDispense** compartments.

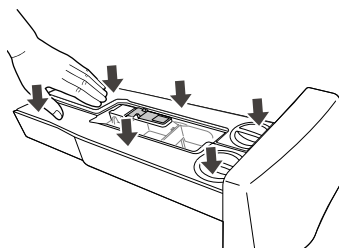

10 Wipe off any moisture with a dry towel or cloth after cleaning.

11 Reinsert the detergent dispenser drawer.

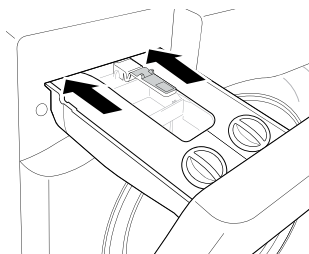

## Dryer

### ⚠ WARNING

- Remove the power plug when you clean the appliance. Not removing the plug may result in electric shock.

## Cleaning the Lint Filters

### ⚠ CAUTION

- Clean the lint filters in the proper way referring to the following instructions. Failure to do so, the lint that is accumulated on the heat exchanger may not be cleaned properly.

### NOTE

- Unload all of the laundries from the appliance before pull out the lint filters.
- Put the lint filters back in place after cleaning. If the lint filters are not in the appliance, you can not operate the appliance.
- when cleaning the filters, the lint should be thrown in the trash and not washed through the drain in order to avoid spreading microplastics in the used water system.

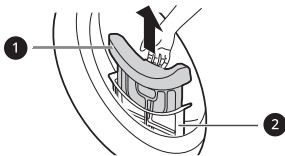

#### 1 Inner Filter

- Always clean the inner filter before and after use.

#### 2 Outer Filter

- Clean the outer filter after drying 10 times or when the lint is accumulated into the outer filter.
- A chime will sound when the lint has accumulated.

## Clean the inner filter

- Pull out the inner filter from the outer filter and then open the inner filter.
  - Open the filter by unfolding it in the direction of the arrows.

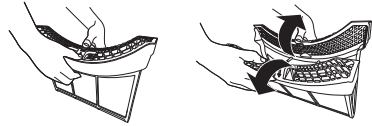

- Clean large cluster of lint first, then clean the residual lint by hand or using a vacuum cleaner.

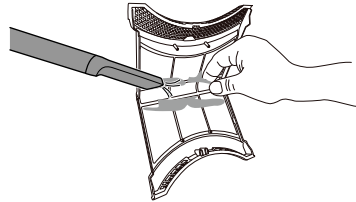

- Avoid using excessive force to prevent damaging the filter.
- Dry the filter completely if the filter is moist. Failure to do so, odour may occur in the appliance.
- Dispose of the used tissue in the trash.

- Close the filter completely by pushing down its center.

- Ensure the left and right side of the inner filter is closed properly.

- Insert the inner filter into the outer filter.

## Clean the outer filter

- 1 Remove the dust or lint around the filter inlet.

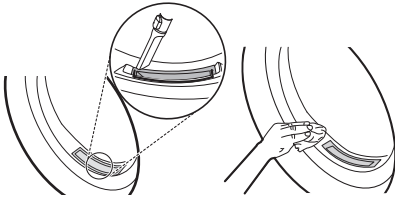

### ⚠ CAUTION

- When the lint drops into the filter inlet, it may cause less efficient drying performance and increase of drying time.

- 2 Pull out the outer filter.

- 3 Remove the inner filter.

- 4 Grab the top edge of the outer filter and spread open.

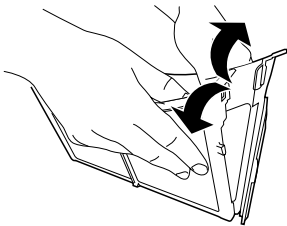

- 5 Clean the residual lint filter by hand or using a vacuum cleaner.

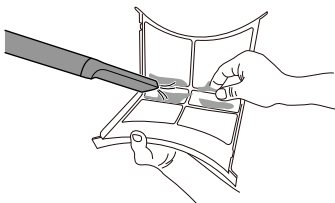

- Avoid using excessive force to prevent damaging the filter.
- Dry the filter completely if the filter is moist. Failure to do so, odour may occur in the appliance.
- Dispose of the used tissue in the trash.

- 6 Close them, and reinsert the both lint filters.

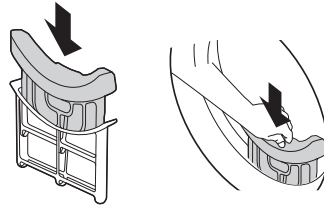

### ⚠ CAUTION

- Do not load or remove any clothes when the lint filter is not in a place. The clothes can drop into the filter inlet and it may cause the appliance to malfunction.

## Wiping the Moisture Sensor

This device senses the moisture level of the clothes during operation, which means it must be cleaned **once every six months** to remove any build-up of lime scale on the surface of the sensor.

Wipe the sensors inside the drum.

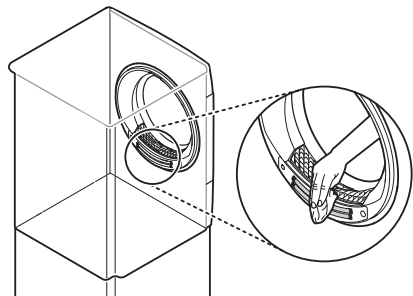

**⚠ CAUTION**

- Do not wipe the moisture sensor with abrasive materials. Always clean the sensor with a dry rough acrylic sponge.

**Using Drum Clean Feature**

With time and use, the appliance may form unpleasant odours that leave your clothes smelling after drying. Using this cleaning function **once a month (or after drying 30 times)** helps to reduce the unpleasant odours from the appliance.

**⚠ CAUTION**

- Remove all of the clothes from the appliance.

**1** Turn on the appliance.

**2** Select the **Drum Clean** programme.

**3** Hold the **Start/Pause** button.

- This function operates for about 3 hours.

**4** Open the dryer's door to provide the appliance with enough air circulation for exhausting any remaining odours.

**⚠ WARNING**

- For safety reasons, do not allow children or animals to enter the appliance. It may cause damage or injury.

**Using Condenser Clean Feature**

The appliance washes lint, which builds up onto the surface of the condenser, automatically using water that is condensed from the clothes during operation. Using this cleaning function **once a month (or after drying 30 times)** helps to wash the lint.

**⚠ CAUTION**

- Remove all of the clothes from the appliance.

**1** Open the dryer's door and pull out both inner and outer filter.

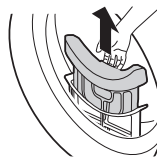

**2** Pour 1 litre of clean water slowly into the entrance.

- Do not pour the water quickly as it will spill out.
- Pouring more than 1.5 litres of water into the compartment will cause water to leak back out.

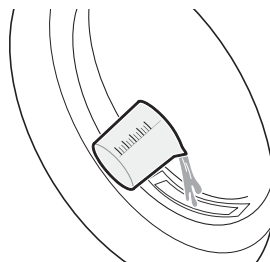

**3** Reinsert both inner and outer filter and close the dryer's door.

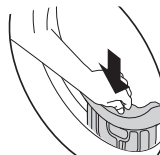

**4** Turn on the appliance.

**5** Press the **SETTINGS - Dryer Additional Settings - Condenser Care** button.

- 6 Hold the **Start/Pause** button to start the cleaning of the condenser.
    - The cleaning of the condenser proceeds for 1 hour.
  - 7 Open the dryer's door to provide the appliance with enough air circulation for more thorough drying of the tub after the cleaning has ended.
- 
- 3 Turn on the appliance and operate the **Normal Dry** programme about for 30 seconds. Then wait about 30 minutes.
  - 4 Operate the **Normal Dry** programme again. Check if the **No drainage** message will appear within 10 minutes after operating the appliance.
    - When the **No drainage** message appears go to step 2 and repeat procedure.
    - Nothing appears on the display when the thawing is done.
  - 5 Dry the clothes as usual.

## **⚠ WARNING**

- For safety reasons, do not allow children or animals to enter the appliance. It may cause damage or injury.

## Thawing out the Appliance

### Thawing out the appliance manually

- 1 Open the dryer's door and pull out both inner and outer filter.
- 2 Pour 1 litre of hot water at 60 °C into the lint filter compartment and then reinsert the both lint filters.

## **⚠ CAUTION**

- Pouring more than 1.5 litres of water into the compartment will cause water to leak back out.
- Pouring hot water over 60 °C will cause malfunctions to the appliance or burn.

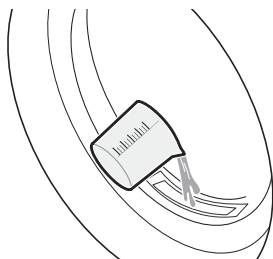

# TROUBLESHOOTING

Operation of your appliance can lead to errors and malfunctions. The following tables contain possible causes and notes for resolving an error message or malfunction. It is recommended to read the tables carefully below in order to save your time and money that may cost for calling to LG Electronics service centre.

## Washer

### Error Messages

Symptoms	Possible Cause & Solution
<b>Door open</b>	<p><b>The door is opened.</b></p> <ul style="list-style-type: none"> <li>Open and close the door again. If the message keeps appearing, unplug the power cord and call for service.</li> </ul>
<b>Door unlocked</b>	<p><b>The door is not secured.</b></p> <ul style="list-style-type: none"> <li>Check for objects around the door and door seal. If the message keeps appearing, unplug the power cord and call for service.</li> </ul>
<b>Water supply</b>	<p><b>Water supply faucets are not fully open.</b></p> <ul style="list-style-type: none"> <li>Make sure that the water faucets are fully open.</li> </ul>
	<p><b>Water inlet hoses are kinked, pinched, or crushed.</b></p> <ul style="list-style-type: none"> <li>Make sure that the hoses are not kinked, pinched or crushed behind or under the washer. Be careful when moving the washer during cleaning or maintenance.</li> </ul>
	<p><b>Water inlet filters are clogged.</b></p> <ul style="list-style-type: none"> <li>Clean the inlet filters. See <b>MAINTENANCE</b>.</li> </ul>
	<p><b>Water supply pressure to faucet or house is too low.</b></p> <ul style="list-style-type: none"> <li>Check another faucet in the house to make sure that household water pressure is adequate and flow is not restricted.</li> <li>Disconnect the water inlet hoses from the washer and run a few gallons of water through the hoses to flush out any dirt.</li> <li>If flow is too low, contact a plumber to have the water supply lines repaired.</li> </ul>
<b>Drainage</b>	<p><b>Water supply connected with leak-limiting hoses.</b></p> <ul style="list-style-type: none"> <li>The use of hoses designed to limit leaks is not recommended. Leak limiting hoses can trip falsely and prevent the washer from filling.</li> </ul>
	<p><b>Drain hose is kinked, pinched, or clogged.</b></p> <ul style="list-style-type: none"> <li>Make sure that the drain hose is free of clogs or kinks and is not pinched behind or under the washer.</li> </ul>

Symptoms	Possible Cause & Solution
<b>Drainage</b>	<p><b>The end of the drain hose is more than 96 inches (2.4 m) above the bottom of the washer.</b></p> <ul style="list-style-type: none"> <li>• Move the end of the drain hose so that it is lower than <b>96 inches (2.4 m)</b>. For best performance, the end of the drain hose should be no higher than 66 inches (168 cm).</li> </ul>
<b>Unbalance</b>	<p><b>The load is too small.</b></p> <ul style="list-style-type: none"> <li>• Add additional items to allow the washer to balance the load.</li> </ul>
	<p><b>Heavy articles are mixed with lighter items.</b></p> <ul style="list-style-type: none"> <li>• Always try to wash articles of somewhat similar weight to allow the washer to evenly distribute the weight of the load for spinning.</li> </ul>
	<p><b>The load is out of balance.</b></p> <ul style="list-style-type: none"> <li>• Manually redistribute the load if articles have become tangled, preventing the automatic rebalancing from working properly.</li> </ul>
<b>No water detected</b>	<p><b>The water level sensor is not working correctly.</b></p> <ul style="list-style-type: none"> <li>• Close the water faucets, unplug the washer, and call for service.</li> </ul>
<b>Motor error</b>	<p><b>A motor error has occurred.</b></p> <ul style="list-style-type: none"> <li>• Allow the washer to stand for 30 minutes and then restart the cycle.</li> <li>• If the error code is still displayed, call for service.</li> </ul>
<b>Water too high</b>	<p><b>Water level is too high due to a faulty water valve.</b></p> <ul style="list-style-type: none"> <li>• Close the water faucets, unplug the washer, and call for service.</li> </ul>
<b>Freeze error</b>	<p><b>Inlet hose, drain hose or drain pump is frozen.</b></p> <ul style="list-style-type: none"> <li>• See Care in Cold Climates.</li> </ul>
<b>No temp detected</b>	<p><b>Control error.</b></p> <ul style="list-style-type: none"> <li>• Unplug the washer and wait 60 minutes. Reconnect power and try again.</li> <li>• If the error code is still displayed, call for service.</li> </ul>
<b>Vibration sensor</b>	<p><b>Vibration sensor is malfunctioning.</b></p> <ul style="list-style-type: none"> <li>• Call for service.</li> </ul>
<b>Turbidity sensor</b>	<p><b>Turbidity sensor is malfunctioning.</b></p> <ul style="list-style-type: none"> <li>• Call for service.</li> </ul>
<b>Steam error</b>	<p><b>The steam function did not work properly.</b></p> <ul style="list-style-type: none"> <li>• Call for service.</li> </ul>

## ezDispense Error Messages

Symptoms	Possible Cause & Solution
Check Detergent Tank	<p><b>The amount of liquid detergent in the detergent compartment did not decrease.</b></p> <p><b>After putting the detergent into the detergent compartment, it was left for a long time and the detergent hardened.</b></p> <ul style="list-style-type: none"> <li>• Clean the detergent compartment thoroughly, fill it with liquid detergent, install it in the drawer, and run a wash programme. If the error is displayed continuously, call for service.</li> </ul>
No Detergent	<p><b>The automatic detergent injection function does not work properly.</b></p> <ul style="list-style-type: none"> <li>• Call for service.</li> </ul>
Check Softener Tank	<p><b>The amount of fabric softener in the softener compartment did not decrease.</b></p> <p><b>After putting the fabric softener into the softener compartment, it was left for a long time and the fabric softener hardened.</b></p> <ul style="list-style-type: none"> <li>• Clean the softener compartment thoroughly, fill it with liquid fabric softener, install it in the drawer, and run a wash programme. If the error is displayed continuously, call for service.</li> </ul>
No Softener	<p><b>The automatic softener injection function does not work properly.</b></p> <ul style="list-style-type: none"> <li>• Call for service.</li> </ul>
ezDispense™ Error	<p><b>The ezDispense did not work properly.</b></p> <ul style="list-style-type: none"> <li>• Call for service.</li> </ul>
Drawer Open	<p><b>The washer was operated without completely closing the drawer.</b></p> <p><b>The drawer was opened during the washer operation.</b></p> <ul style="list-style-type: none"> <li>• Push the drawer completely closed. If the error is displayed continuously, call for service.</li> </ul>

## Noises You Might Hear

Symptoms	Possible Cause & Solution
Rattling and clanking noise	<p><b>Foreign objects, such as keys, coins, or safety pins may be in the drum.</b></p> <ul style="list-style-type: none"> <li>• Stop the appliance, check the drum for foreign objects. If the noise continues after the appliance is restarted, call for service.</li> </ul>
Thumping sound	<p><b>Heavy clothes may produce a thumping sound. This is usually normal.</b></p> <ul style="list-style-type: none"> <li>• If the sound continues, the appliance is probably out of balance. Stop and redistribute the clothes.</li> </ul>
	<p><b>The clothes may be out of balance.</b></p> <ul style="list-style-type: none"> <li>• Pause the programme and redistribute the clothes after the door unlocks.</li> </ul>

Symptoms	Possible Cause & Solution
Vibrating noise	<b>Package materials are not removed.</b> <ul style="list-style-type: none"> <li>Remove package materials.</li> </ul>
	<b>The clothes may be unevenly distributed in the drum.</b> <ul style="list-style-type: none"> <li>Pause the programme and redistribute the clothes after the door unlocks.</li> </ul>
	<b>Not all levelling feet are resting firmly and evenly on the floor.</b> <ul style="list-style-type: none"> <li>See the <b>Levelling the Appliance</b> instruction to adjust the levelling of the appliance.</li> </ul>
	<b>Floor not rigid enough.</b> <ul style="list-style-type: none"> <li>Check if the floor is solid and does not flex. See the <b>Installation Place Requirements</b> to select the proper location.</li> </ul>

## Operation

Symptoms	Possible Cause & Solution
Water is leaking.	<b>House drain pipes are clogged.</b> <ul style="list-style-type: none"> <li>Unclog waste pipes. Contact plumber if necessary.</li> </ul>
	<b>Leakage is caused by improper installation of drain hose or clogged drain hose.</b> <ul style="list-style-type: none"> <li>Clean and straighten the drain hose. Check and clean the drain filter regularly.</li> </ul>
	<b>Drain pump filter cap is not fitted correctly.</b> <ul style="list-style-type: none"> <li>Refit the drain pump filter.</li> </ul>
Appliance does not operate.	<b>Control panel has powered off due to inactivity.</b> <ul style="list-style-type: none"> <li>This is normal. Press the <b>Power</b> button to turn the appliance on.</li> </ul>
	<b>Appliance is unplugged.</b> <ul style="list-style-type: none"> <li>Make sure that the cord is plugged securely into a working outlet.</li> </ul>
	<b>Water supply is turned off.</b> <ul style="list-style-type: none"> <li>Turn the water supply tap completely.</li> </ul>
	<b>Controls are not set properly.</b> <ul style="list-style-type: none"> <li>Make sure that the programme is correctly set. Close the door and press the <b>Start/Pause</b> button.</li> </ul>
	<b>Door is open.</b> <ul style="list-style-type: none"> <li>Close the door and make sure that nothing is caught under the door preventing it from closing completely.</li> </ul>

Symptoms	Possible Cause & Solution
<b>Appliance does not operate.</b>	<b>Circuit breaker/fuse is tripped/blown.</b> <ul style="list-style-type: none"> <li>• Check house circuit breakers/fuses. Replace fuses or reset breaker. The appliance should be on a dedicated branch circuit. The appliance will resume the programme where it stopped once power is restored.</li> </ul>
	<b>Control needs to be reset.</b> <ul style="list-style-type: none"> <li>• Press the <b>Power</b> button, then reselect the desired programme and press the <b>Start/Pause</b> button.</li> </ul>
	<b>Start/Pause was not pressed after a programme was set.</b> <ul style="list-style-type: none"> <li>• Press the <b>Power</b> button, then reselect the desired programme and press the <b>Start/Pause</b> button. The appliance is turned off if the <b>Start/Pause</b> button is not pressed within a certain time.</li> </ul>
	<b>Start/Pause button and OK button were not pressed within 60 seconds.</b> <ul style="list-style-type: none"> <li>• The appliance is equipped with a 2-button start safety feature; after the <b>Start/Pause</b> button is pressed, if <b>OK</b> button is not touched within 60 seconds, the feature will reset. In this case, repeat the steps and make sure to press both buttons within 60 seconds of each other.</li> </ul>
	<b>Extremely low water pressure.</b> <ul style="list-style-type: none"> <li>• Check another tap in the house to make sure that household water pressure is adequate.</li> </ul>
	<b>Appliance is heating the water or making steam.</b> <ul style="list-style-type: none"> <li>• The drum may stop operating temporarily during certain cycles, while water is safely heated to a set temperature.</li> </ul>
<b>Buttons may not function properly.</b>	<b>The Control Lock option is activated.</b> <ul style="list-style-type: none"> <li>• Deactivate the <b>Control Lock</b> option if necessary.</li> </ul>
<b>Door does not open.</b>	<b>The door cannot be opened for safety reasons once the appliance starts.</b> <ul style="list-style-type: none"> <li>• This is normal. You can safely open the door after  turns off.</li> </ul>
<b>Appliance is not filling properly.</b>	<b>Inlet filter clogged.</b> <ul style="list-style-type: none"> <li>• Make sure the inlet filters on the fill valves are not clogged.</li> </ul>
	<b>Inlet hoses may be kinked.</b> <ul style="list-style-type: none"> <li>• Check that inlet hoses are not kinked or clogged.</li> </ul>
	<b>Insufficient water supply.</b> <ul style="list-style-type: none"> <li>• Make sure that both hot and cold water taps are turned on all the way.</li> </ul>
	<b>Hot and cold supply hoses are reversed.</b> <ul style="list-style-type: none"> <li>• Check supply hose connections.</li> </ul>
<b>Appliance does not drain water.</b>	<b>Kinked drain hose.</b> <ul style="list-style-type: none"> <li>• Ensure that the drain hose is not kinked.</li> </ul>

Symptoms	Possible Cause & Solution
<b>Appliance does not drain water.</b>	<p><b>Drain located higher than 1.2 m above the floor.</b></p> <ul style="list-style-type: none"> <li>• Make sure that the drain hose is no higher than 1.2 m above the bottom of the appliance.</li> </ul>
<b>Detergent is not dispensed incompletely or not dispensed at all.</b>	<p><b>Too much detergent is used.</b></p> <ul style="list-style-type: none"> <li>• Follow the guidelines provided by the detergent manufacturer.</li> </ul>
	<p><b>Drain Pump Filter may be blocked.</b></p> <ul style="list-style-type: none"> <li>• Clean the Drain filter.</li> </ul>
<b>Cycle time is longer than usual.</b>	<p><b>The load is too small.</b></p> <ul style="list-style-type: none"> <li>• Add more items to allow the appliance to balance the loads.</li> </ul>
	<p><b>Heavy articles are mixed with lighter items.</b></p> <ul style="list-style-type: none"> <li>• Always try to wash articles with similar weight in order to allow the appliance to evenly distribute the weight of the load for spinning.</li> </ul>
	<p><b>The load is out of balance.</b></p> <ul style="list-style-type: none"> <li>• Manually redistribute the load if articles have become tangled.</li> </ul>
<b>Cycle end is delayed.</b>	<p><b>Unbalance is detected or suds removing programme is on.</b></p> <ul style="list-style-type: none"> <li>• This is normal. The time remaining shown on the display is only an estimated duration. Actual time may vary.</li> </ul>

## Performance

Symptoms	Possible Cause & Solution
<b>Poor stain removal</b>	<p><b>Previously set stains.</b></p> <ul style="list-style-type: none"> <li>• Articles that have been previously washed may have stains which have been set. These stains may be difficult to remove and may require hand washing or pre-treating to aid in stain removal.</li> </ul>
<b>Staining</b>	<p><b>Bleach or softener is dispensed too soon.</b></p> <ul style="list-style-type: none"> <li>• Dispenser compartment is overfilled. It makes bleach or softer dispensed rapidly. Always measure bleach or softener to prevent overfilling.</li> <li>• Close the detergent dispenser slowly.</li> </ul>
	<p><b>Bleach or softener was added directly to the clothes in the drum.</b></p> <ul style="list-style-type: none"> <li>• Always use the detergent dispenser to ensure that bleach or softener is properly dispensed at the right time in the programme.</li> </ul>
	<p><b>Clothes were not properly sorted.</b></p> <ul style="list-style-type: none"> <li>• Always wash dark colours separately from light colours and whites to prevent discoloration.</li> <li>• Never wash heavily soiled items with lightly soiled items.</li> </ul>

Symptoms	Possible Cause & Solution
<b>Wrinkling</b>	<b>Appliance is not unloaded promptly.</b> <ul style="list-style-type: none"> <li>Always remove items from the appliance as soon as the programme is complete.</li> </ul>
	<b>Appliance is overloaded.</b> <ul style="list-style-type: none"> <li>The appliance can be fully loaded, but the drum should not be tightly packed with items. The door of the appliance should be closed easily.</li> </ul>
	<b>Hot and cold water supply hoses are reversed.</b> <ul style="list-style-type: none"> <li>Hot water rinse can set wrinkles in garments. Check the supply hose connections.</li> </ul>
	<b>Spin speed may be too high.</b> <ul style="list-style-type: none"> <li>Set the spin speed to suit the garment type.</li> </ul>

## Odour

Symptoms	Possible Cause & Solution
<b>Musty or mildewy odour in appliance</b>	<b>Inside of drum is not cleaned properly.</b> <ul style="list-style-type: none"> <li>Run the <b>Tub Clean</b> function regularly.</li> </ul>
	<b>Odours can occur if the drain hose is not properly installed, causing siphoning (water flowing back inside of the appliance).</b> <ul style="list-style-type: none"> <li>When installing the drain hose, make sure that it does not get kinked or blocked.</li> </ul>
	<b>If the detergent dispenser is not cleaned regularly, odours can occur from mold or foreign substances.</b> <ul style="list-style-type: none"> <li>Remove and clean the detergent dispenser, especially the top and bottom of the dispenser's opening.</li> </ul>

# Dryer

## Error Messages

Symptoms	Possible Cause & Solution
Door open / Door unlocked	<p><b>The door has been opened while the appliance is in operation or the appliance is being operated without the door being closed properly.</b></p> <ul style="list-style-type: none"> <li>• Close the door completely.</li> <li>• If <b>Door open / Door unlocked</b> is not released, call for service.</li> </ul>
Door open	<p><b>Door switch detection is not working properly.</b></p> <ul style="list-style-type: none"> <li>• Unplug the power plug and call for service.</li> </ul>
Temp sensor error 1 / Temp sensor error 2 / Temp sensor error 3 / Temp sensor error 4 / Temp sensor error 5 / Temp sensor error 6	<p><b>Temperature Sensor has malfunctioned.</b></p> <ul style="list-style-type: none"> <li>• Unplug the power plug and call for service.</li> </ul>
Drum temp error	<p><b>The temperature inside the drum has risen suddenly.</b></p> <ul style="list-style-type: none"> <li>• Unplug the power plug and call for service.</li> </ul>
Drum motor error	<p><b>The motor has stopped suddenly.</b></p> <ul style="list-style-type: none"> <li>• Check if the amount of clothes exceeds the maximum load capacity.</li> <li>• Unplug the power plug and call for service.</li> </ul>
Compressor error 1 / Compressor error 2	<p><b>The compressor has stopped suddenly.</b></p> <ul style="list-style-type: none"> <li>• Unplug the power plug and call for service.</li> </ul>
Fan motor error	<p><b>The drying fan has stopped suddenly.</b></p> <ul style="list-style-type: none"> <li>• Unplug the power plug and call for service.</li> </ul>
No drainage	<p><b>The drain pump motor has malfunctioned.</b></p> <ul style="list-style-type: none"> <li>• Unplug the power plug and call for service.</li> </ul>
	<p><b>The surrounding temperature for installation is below zero.</b></p> <ul style="list-style-type: none"> <li>• The recommended surrounding temperature for installation is 5 - 35 °C.</li> </ul>
Insert the filter	<p><b>The lint filter is not in the appliance.</b></p> <ul style="list-style-type: none"> <li>• Insert the lint filter.</li> </ul>
Service cover error	<p><b>This is caused by the dryer service cover not being assembled properly.</b></p> <ul style="list-style-type: none"> <li>• Unplug the power plug and call for service.</li> </ul>

## Operation

Symptoms	Possible Cause & Solution
Appliance will not turn on.	<b>Power cord is not properly plugged in.</b> <ul style="list-style-type: none"> <li>Make sure that the power plug is securely plugged into a grounded outlet matching the appliance's rating plate.</li> </ul>
	<b>House fuse is blown, circuit breaker has tripped, or power outage has occurred.</b> <ul style="list-style-type: none"> <li>Reset circuit breaker or replace fuse. Do not increase fuse capacity. If the problem is a circuit overload, have it corrected by a qualified electrician.</li> </ul>
Appliance does not heat.	<b>House fuse is blown, circuit breaker has tripped, or power outage has occurred.</b> <ul style="list-style-type: none"> <li>Reset circuit breaker or replace fuse. Do not increase fuse capacity. If the problem is a circuit overload, have it corrected by a qualified electrician.</li> </ul>
Water leaks.	<b>The optional drain hose is not connected correctly.</b> <ul style="list-style-type: none"> <li>Connect the optional drain hose correctly.</li> </ul>
	<b>The door is closed while clothes or foreign substance is caught in the door.</b> <ul style="list-style-type: none"> <li>Check if clothes or foreign substance is caught in the door before using the appliance. If water leaks continuously, contact the LG Electronics Customer Information Centre.</li> </ul>
Appliance runs and pauses by itself after the drying cycle finishes.	<b>This is how the wrinkle care option works.</b> <ul style="list-style-type: none"> <li>Make sure that the wrinkle care option has been set. The option is designed to prevent creases that are formed when the clothes are not unloaded promptly after the drying cycle. When the option is set, the appliance runs for 10 seconds and pauses for 5 minutes. The option is works for up to 2 hours.</li> </ul>

## Performance

Symptoms	Possible Cause & Solution
Clothes take too long to dry.	<b>Load is not properly sorted.</b> <ul style="list-style-type: none"> <li>Separate heavy items from lightweight items. Larger and heavier items take longer to dry. Light items in a load with heavy items can fool the sensor because the light items dry faster.</li> </ul>
	<b>Large load of heavy fabrics.</b> <ul style="list-style-type: none"> <li>Heavy fabrics take longer to dry because they tend to retain more moisture. To help reduce and maintain more consistent drying times for large and heavy fabrics, separate these items into smaller loads of a consistent size.</li> </ul>

Symptoms	Possible Cause & Solution
<b>Clothes take too long to dry.</b>	<b>Appliance controls are not set properly.</b> <ul style="list-style-type: none"> <li>Use the appropriate control settings for the type of load you are drying. Some loads may require an adjustment of the dry level setting for proper drying.</li> </ul>
	<b>Lint filter needs to be cleaned.</b> <ul style="list-style-type: none"> <li>Remove the lint from the lint filter after every cycle. With the lint removed, hold the lint filter up to a light to see if it is dirty or clogged. With some loads that produce high amounts of lint, such as new bath towels, it may be necessary to pause the cycle and clean the filter during the cycle.</li> </ul>
	<b>House fuse is blown, circuit breaker has tripped, or power outage has occurred.</b> <ul style="list-style-type: none"> <li>Reset circuit breaker or replace fuse. Do not increase fuse capacity. If the problem is a circuit overload, have it corrected by a qualified electrician.</li> </ul>
	<b>Appliance is overloaded.</b> <ul style="list-style-type: none"> <li>Divide extra large loads into smaller loads for better drying performance and efficiency.</li> </ul>
<b>Drying time is not consistent.</b>	<b>Heat settings, load size, or dampness of clothing is not consistent.</b> <ul style="list-style-type: none"> <li>The drying time for a load will vary depending on the type of heat used (electric), the size of the load, the type of fabrics, the wetness of the clothes, and lint filter. Even an unbalanced load in the appliance can cause poor spinning, resulting in wetter clothes which will take longer to dry.</li> </ul>
<b>Greasy or dirty spots are left on clothes.</b>	<b>Fabric softener is used incorrectly.</b> <ul style="list-style-type: none"> <li>When washing clothes that are to be dried in the appliance, use the correct amount of fabric softener as recommended by the manufacturer of the fabric softener.</li> </ul>
	<b>Clean and dirty clothes are being dried together.</b> <ul style="list-style-type: none"> <li>Use the appliance to dry only clean items. Soil from dirty clothes can transfer to the clean clothes in the same or later loads.</li> </ul>
	<b>Clothes were not properly cleaned or rinsed before being placed in the appliance.</b> <ul style="list-style-type: none"> <li>Stains on dried clothes could be stains that were not removed during the washing process. Make sure that clothes are being completely cleaned or rinsed according to the instructions for your washing machine and detergent. Some difficult soils may require pre-treating prior to washing.</li> </ul>
<b>Clothes are wrinkled.</b>	<b>Clothes have dried too long (overdried).</b> <ul style="list-style-type: none"> <li>Over drying a load of clothes can lead to wrinkled clothes. Try a shorter drying time.</li> </ul>
	<b>Clothes have been left in the appliance for too long after cycle ends.</b> <ul style="list-style-type: none"> <li>Use the <b>Wrinkle Care</b> option.</li> </ul>

Symptoms	Possible Cause & Solution
<b>Clothes are shrinking.</b>	<p><b>Garment care instructions are not being followed.</b></p> <ul style="list-style-type: none"> <li>To avoid shrinking your clothes, always consult and follow fabric care instructions. Some fabrics will naturally shrink when washed. Other fabrics can be washed but will shrink when dried in the appliance. Use a low or no heat setting.</li> </ul>
<b>Lint is left on clothes.</b>	<p><b>Lint filter has not been cleaned properly.</b></p> <ul style="list-style-type: none"> <li>Remove the lint from the lint filter after every cycle. With the lint removed, hold the lint filter up to a light to see if it is dirty or clogged. If it looks dirty, follow the cleaning instructions. With some loads that produce high amounts of lint, it may be necessary to clean the lint filter during the cycle.</li> </ul>
	<p><b>Clothes have not been sorted properly.</b></p> <ul style="list-style-type: none"> <li>Some fabrics are lint producers (i.e., a fuzzy white cotton towel) and should be dried separately from clothes that are lint trappers (i.e., a pair of black linen pants).</li> </ul>
	<p><b>Appliance is overloaded.</b></p> <ul style="list-style-type: none"> <li>Divide extra large loads into smaller loads for drying.</li> </ul>
	<p><b>Tissue, paper, etc., has been left in pockets.</b></p> <ul style="list-style-type: none"> <li>Check pockets thoroughly before drying clothes.</li> </ul>
<b>Excess static in clothes after drying.</b>	<p><b>Clothes have dried for too long (overdried).</b></p> <ul style="list-style-type: none"> <li>Overdrying a load of clothes can cause a buildup of static electricity. Adjust settings and use a shorter drying time.</li> </ul>
	<p><b>Drying synthetics, permanent press, or synthetic blends.</b></p> <ul style="list-style-type: none"> <li>These fabrics are naturally more prone to static buildup. Try using fabric softener, or use shorter Timed Drying time settings.</li> </ul>
<b>Clothes have damp spots after a Dry programme.</b>	<p><b>Very large load or very small load. Single large item such as a blanket or comforter.</b></p> <ul style="list-style-type: none"> <li>If items are too tightly packed or too sparse the sensor may have trouble reading the dryness level of the load. Use a Timed Drying programme for very small loads.</li> <li>Large, bulky items such as blankets or comforters can sometimes wrap themselves into a tight ball of fabric. The outside layers will dry and register on the sensors, while the inner core remains damp. When drying a single bulky item, it may help to pause the cycle once or twice and rearrange the item to unwrap and expose any damp areas.</li> <li>To dry a few remaining damp items from a very large load or a few damp spots on a large item after a Dry programme has completed, empty the lint filter, then set a Timed Drying programme to finish drying the item(s).</li> </ul>

## Common

### Wi-Fi

Symptoms	Possible Cause & Solution
<p><b>Your home appliance and smartphone are not connected to the Wi-Fi network.</b></p>	<p><b>The password for the Wi-Fi that you are trying to connect to is incorrect.</b></p> <ul style="list-style-type: none"> <li>Find the Wi-Fi network connected to your smartphone and remove it, then register your appliance on <b>LG ThinQ</b>.</li> </ul>
	<p><b>Mobile data for your smartphone is turned on.</b></p> <ul style="list-style-type: none"> <li>Turn off the <b>Mobile data</b> of your smartphone and register the appliance using the Wi-Fi network.</li> </ul>
	<p><b>The wireless network name (SSID) is set incorrectly.</b></p> <ul style="list-style-type: none"> <li>The wireless network name (SSID) should be a combination of English letters and numbers. (Do not use special characters).</li> </ul>
	<p><b>The router frequency is not 2.4 GHz.</b></p> <ul style="list-style-type: none"> <li>Only a 2.4 GHz router frequency is supported. Set the wireless router to 2.4 GHz and connect the appliance to the wireless router. To check the router frequency, check with your internet service provider or the router manufacturer.</li> </ul>
	<p><b>The distance between the appliance and the router is too far.</b></p> <ul style="list-style-type: none"> <li>If the distance between the appliance and the router is too far, the signal may be weak and the connection may not be configured correctly. Move the location of the router so that it is closer to the appliance.</li> </ul>

# Memo

# Memo

# Memo

# Memo

