

# Pet Grooming Kit

PC15(RFC-676+RFC-677)

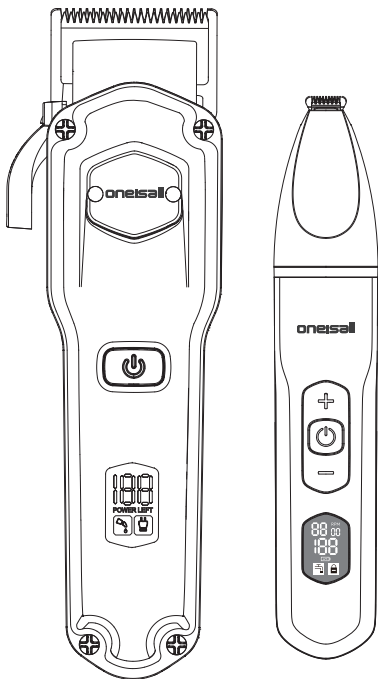

If you have any questions, you can contact us:  
[support@oneisall.com](mailto:support@oneisall.com)

# Safety Warning

---

1. **Read Before Use:** Before using the clippers, please read all safety and operating instructions.

2. **Electrical Safety:** Ensure that the voltage indicated on the rating label matches your electrical outlet. Do not immerse the appliance in water or any other liquids to avoid electric shock.

**WARNING:** Keep the appliance dry.

3. **Supervision:** This appliance can be used by children aged from 8 years and above and persons with reduced physical, sensory or mental capabilities or lack of experience and knowledge if they have been given supervision or instruction concerning use of the appliance in a safe way and understand the hazards involved. Children shall not play with the appliance. Cleaning and user maintenance shall not be made by children without supervision.

4. **Regular Checks:** Periodically check the clippers for damage. If the appliance or power cord shows any sign of damage, do not use it. Contact the service center for repair or replacement.

5. **Regular Maintenance:** Disconnect the clippers from the power source before cleaning, changing accessories, or performing any maintenance. Keep the blades clean and well-oiled to avoid overheating and ensure optimal performance. Replace blades as needed.

**WARNING:** Cutting blades may become hot after prolonged use.

6. **Storage:** After use, unplug and store the clipper in a dry place, away from pets and children.

7. **Handling:** Avoid touching the blades directly with your fingers. Always switch off the appliance when not in active use.

8. **Use for Intended Purpose:** These clippers are designed for trimming pet hair only. Do not use them for any other purpose.

9. **Disposal:** Dispose of the clipper and its accessories according to local regulations for electronic waste.

# Overview

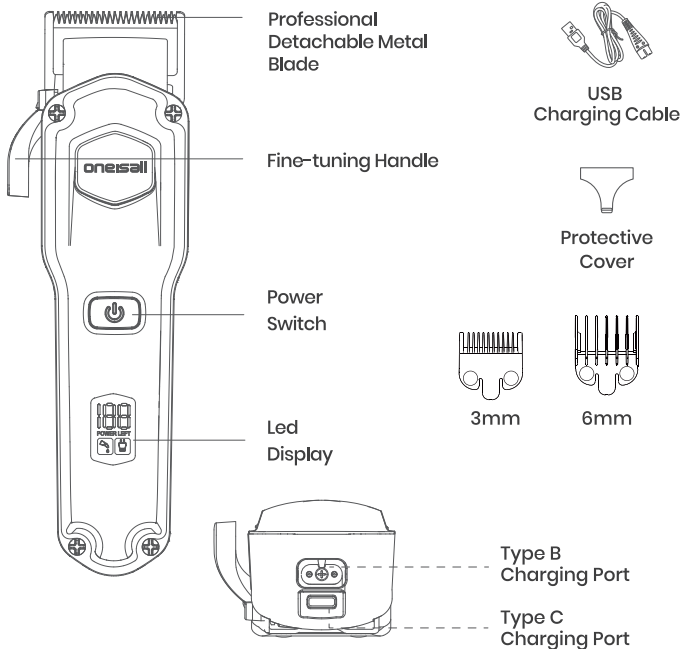

## Limited Combs

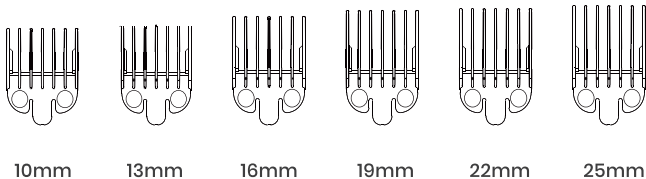

## Customize your pet's trim with versatile length options:

1. Short-haired breeds: Skip the comb or use a 1-3mm comb for light trims.
2. Medium/long-haired: Opt for a 5-10mm comb for balanced cuts, preserving natural looks.
3. Long-haired breeds: Start with 10-30mm comb for initial shaping, adjusting with shorter combs as needed.
4. Double-coated: Use 15-25mm comb on top coat, switch to 5-10mm for undercoat care.
5. Detailed styling: For paws, face, tails, use 1-5mm combs or freehand clip without a comb.

## Using Methods

---

1. Press the power and the display lights up.

2. Fine-tune the cutter. Adjust the cutter by rotating the taper lever from forward.

### 3. Travel lock function

Press and hold the switch for 3 seconds, the product is locked, and the red indicator light flashes for 3 seconds; Press and hold the switch for 3 seconds while the red indicator light flashes for 3 seconds, the product is turned on.

### 4. Cleaning & Maintenance

For every 60 minutes of use, the oil bottle symbol flashes to indicate adding lubricating oil.

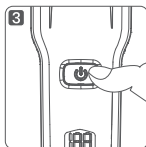
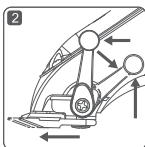
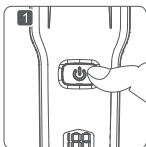

## 5. Remove the metal blade:

Gently push the metal blade outward to separate it from the clipper body.

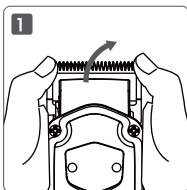

## 6. Install the metal blade:

- (1) Slide the slot of the blade down until it catches the clipper
- (2) Press the blade down slightly until you hear a "click" sound.

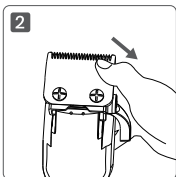
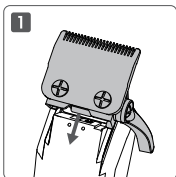

## 7. How to install the comb:

- (1) Slide the slot of the comb down until it catches the blade.
- (2) Press the comb down slightly until you hear a "click" sound.

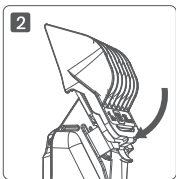
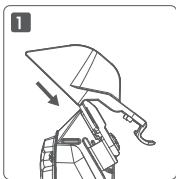

## 8. Remove the comb:

- (1) Pull the clasp of the comb outward to separate the comb from the blades.
- (2) Slide the comb upwards to remove it.

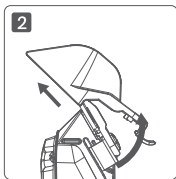
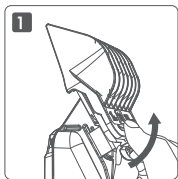

### Attention:

Please do not use excessive force, as this may damage the comb's snap.

## Tips

---

1. To ensure the normal operation of the blade, please do not disassemble the cutter head!
2. To clean the blade, you can use the matching brush to gently sweep away the excess hair.
3. The blade can be washed under the faucet.
4. After rinsing, please wipe clean with a dry cloth.
5. Drip matching lubricating oil on the blade.
6. After maintenance, put the protective cover on the cutter head for protection.

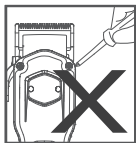

1

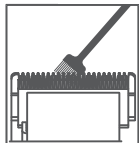

2

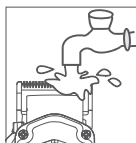

3

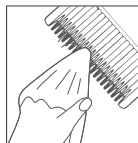

4

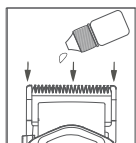

5

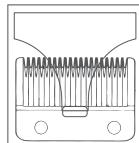

6

## Plug-in Using Methods

1. Turn off the machine, then plug the USB cable into a 5V/1A adapter (or other USB-enabled power supplies such as desktop computers/mobile power banks) to charge — the charging indicator will light up.

2. The display will show the charging status, just unplug the charging cable after it is fully charged.

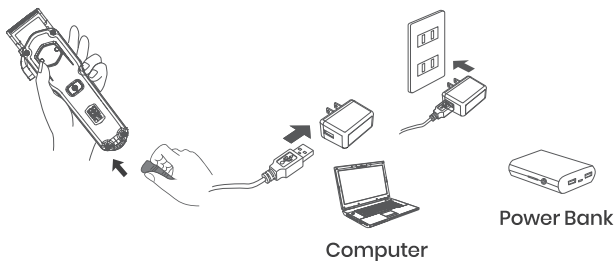

6

## LCD screen display



Battery percentage display (0%-100%)

The battery indicator flashes when power is below 5%.



Left      Right

Left-Add oil indication

Add oil to the blade when this light is on.

Right-Charging indication

Charging light will flash when power is less than 15%. Please charge immediately



① For safety, power off the device before charging.

② Charge-while-use is supported; power on if needed.

## Charging Instructions

---

1. Please charge for 3 hours when purchasing a new product for the first time. After 3 to 4 times of full charge and discharge, the battery capacity will reach the best condition.

Specifications	Product Name: Dog Clippers	Model: RFC-676
	Voltage: 3.7V	Working Time: 4H
	Input: 5V = 1A	Charging Time: 3H
	Battery Capacity: 2000 mAh	

2. The best ambient temperature for charging use is between 5°-40°C.

# Overview

---

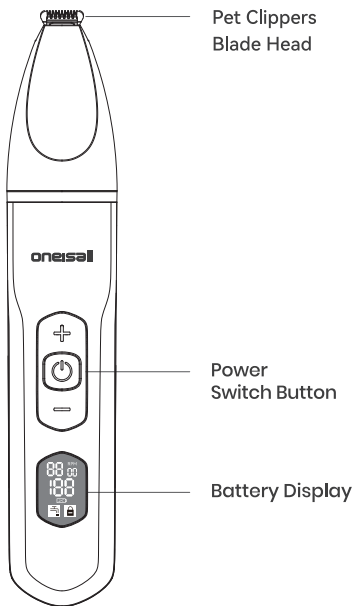

Carving Head

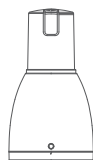

Nail Grinder



Guide Comb for  
Curved Head



Brush



Oil Bottle



Type-C  
Charging Cable

# High performance lithium battery

---

---

Working Voltage:	3.7V
Battery:	1200mAh
Charging Time:	90min
Working Time:	150min (Low speed mode)
Input:	5V $\equiv$ 1A
Speed Gear:	Three Gear Levels
Waterproof Level:	IPX6

## Introduction to the Blade Heads

---

---



### Foot Hair Trimmer Head

Ideal for detailed trimming on large and medium-sized pets, such as around the eyes, ears, feet, and buttocks. Use with the clipper blade head for customized shapes. Attach a guide comb for precise hair length control. (3mm)



### Detailed Trimmer Head

Designed for precise trimming on pets, perfect for detailing around paws, legs, tails, and sensitive areas like eyes and ears. The safety cap helps reduce dust and prevents over-trimming.

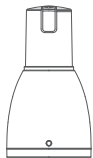

### **Nail Grinder**

Gently and safely trim your pet's nails with our specialized nail grinder. This ergonomic designed tool provides a stress-free experience for both you and your pet. The safety cap helps reduce dust and prevents over-trimming.

## **Installation and Removal of the Blade Heads:**

---

### **Installation and Removal of the Blade Heads:**

Please view the video tutorial to operate.

- ① **Installation:** Align the end with the clipper and rotate it counterclockwise to install the cutter head.
- ② **Removal:** Clockwise rotate and pull out the blade head, and the blade head can be washed underwater.



### **LCD Screen Display:**

- ① Battery percentage display(0%-100%)
- ② 3 Speed levels display(6000/6500/7000RPM)



### Optional Speeds to Match Different Blade Heads:

- ① 6000RPM speed mode is suitable for ear/face/foot trimming
- ② 6500RPM speed mode is suitable for back shaving
- ③ 7000RPM speed mode is suitable for foot nail polishing

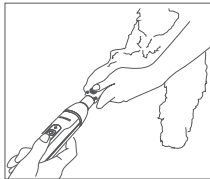
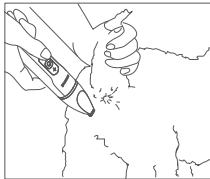

## Cleaning & Maintenance

---

### Cleaning & Maintenance

#### How to Clean

1. Clear up the blade with the cleaning brush.
2. The blade can be removed for cleaning.
3. Before or after use, drop some oil on the tip position of the blade to maintain the blade. (Oil included)
4. Install the blade back to the Head.

### Charging Indicator:

Charging Indicator: The battery level will keep flashing every 5% during the charging process. Once the battery is fully charged and reaches 100%, the flashing will cease.

Please charge in an environment between 41°F and 104°F. For the first use or unused it for more than three months, please fully charge the pet clipper before use.

To avoid affecting the life of the product, unplug the USB Type-C charging cable from the power outlet after the battery is fully charged, and do not leave the clipper connected to an external power source for a long time.

Note: Use 5V-1A adapter to connect the charging cable for charging.

Problem	Problem Causes	Solution
The product heats up during use	Trimming parts attached to debris	support@oneisall.com
Does not work	The battery is broken	please contact the e-mail: <b>support@oneisall.com</b>
	Other	please contact the e-mail: <b>support@oneisall.com</b>

# Contact Us

---

## WE ARE READY TO HELP

Oneisall offers a standard 2-year warranty. If you have any issues with your Oneisall product, please do not hesitate to contact us. Be sure to include your proof of purchase, model number, and any relevant photos or videos in your message to expedite the process. Our Oneisall support team is available 7 days a week and will respond to your inquiry within 24 hours. Thank you for choosing Oneisall.

Please note that the Oneisall warranty does not apply to used products or purchases made from unauthorized sellers. It's important to be aware that the warranty also does not cover consumable parts such as blades, guards, filters, brushes, and similar items. These parts may require regular replacement or maintenance.

✉ [support@oneisall.com](mailto:support@oneisall.com)

☎ +1 877-522-8578 (US) Mon-Fri 8am-5pm(PST)

🌐 [www.oneisall.com](http://www.oneisall.com)



Online support



@Oneisall Official

# GPSR Product Information

---



Name: APEX CE SPECIALISTS LIMITED  
Add: 6f East Union Street, Manchester, England, M16 9AE  
Contact: Wells  
Tel: +441616371080  
E-Mail: Info@apex-ce.com



Name: Apex CE Specialists GmbH  
Add: Grafenberger Allee 277-287,40237 Düsseldorf,DE  
Contact Person: Wells Yan  
Tel: +353212066339  
E-Mail: Info@apex-ce.de

## GPSR-Manufacturer info:

Business Name: Shenzhenbenfendianzishangwuyouxiangongsi  
Manufacturer's address: CN, 518000, GuangDong Sheng, Shenzhen,  
Longhua District, Minxin Community Bishui Longting Building 6 Unit, 7B  
Tel: +86 185 6587 6424  
E-Mail: topservice4u@hotmail.com

Product Name: Pet Grooming Kit

Brand: Oneisall

Product Model: PC15 (RFC-676+RFC-677)

Rated Voltage: 3.7V

Input: 5V  $\overline{\text{---}}$  1A

## FCC Statement:

---

This device complies with part 15 of the FCC Rules. Operation is subject to the following two conditions:

1. This device may not cause harmful interference, and
2. This device must accept any interference received, including interference that may cause undesired operation.



Made in China



Any problems you have, please contact us :  
[support@oneisall.com](mailto:support@oneisall.com)



ON-D209