

HD 280 PRO



Quick Guide
Kurzanleitung
Guide rapide
Guida rapida

Instrucciones resumidas
Beknopte handleiding
Краткая инструкция
快速指南

 **SENNHEISER**

Further information | Weitere Informationen |
Autre information | Altra informazione |
Información adicional | Niederländisch |
Russisch | Chinesisch



In the box

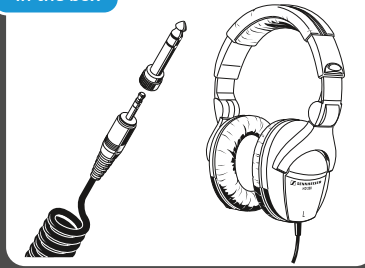

Adjusting

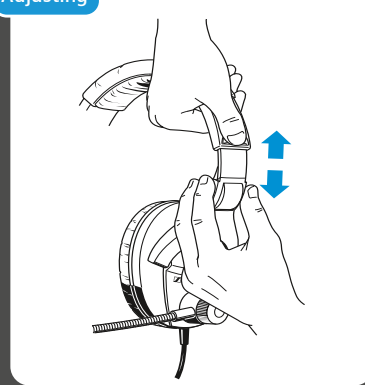

Folding up the headphones

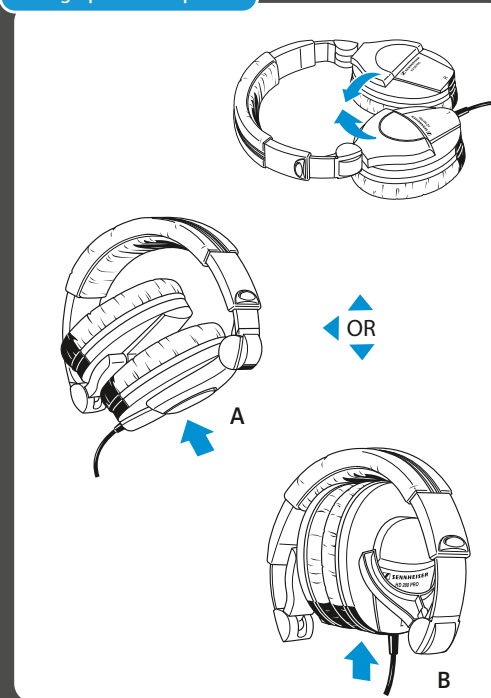

Replacing spare parts

Headband padding

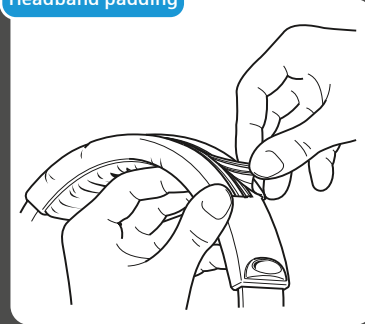

Ear cushions

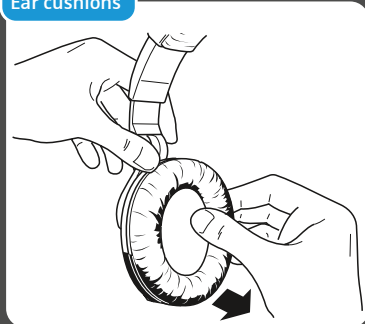

Specifications

Headphone HD 280 PRO

Acoustic principle	dynamic, closed
Impedance	64 Ω
Ear coupling	circumaural
Frequency response (-10 dB at 1 kHz)	8 - 25,000 Hz
Ambient noise attenuation	max. 32 dB
THD	<0.1% (at 1 kHz, 100 dB SPL)
Weight (w/o cable)	approx. 220 g
Contact pressure	approx. 6 N
Length of coiled cable	min. 1 m / max. 3 m
Temperature	10 °C to 70 °C

Sennheiser electronic GmbH & Co. KG

Am Labor 1, 30900 Wedemark, Germany
www.sennheiser.com

Printed in Germany, Publ. 01/16, 566630/A01

