

sen | si™ Connect  
to Comfort



**SENSI™ ROOM SENSOR**  
Installation guide



Follow these directions to pair up to 15 Sensi room sensors to your Sensi Touch 2 smart thermostat.

**STEP 1**

Add sensor to your thermostat

At the thermostat, tap on the menu icon in the top left corner.

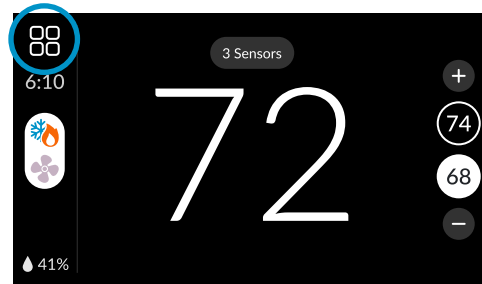

Tap on **Remote Sensors**.

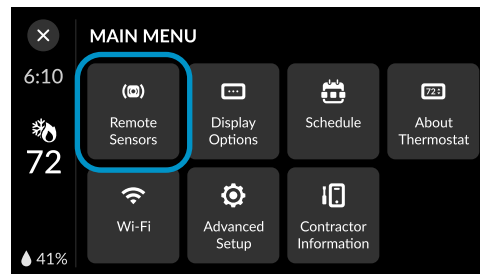

Tap on **Add Sensor**.



## STEP 2

### Connect your sensor

Insert batteries into the sensor and tap **OK** on the Touch 2 screen.

- If the sensor already had batteries or was already paired, press and hold the **Reset** button located in the battery compartment for 5 seconds.

Compatible sensors will appear on your Touch 2 screen. Tap **Connect** next to a sensor to pair it.

**Pro Tip:**

Pair one sensor at a time so you know which one you're setting up, if you have multiple sensors.

It may take a minute to connect. If the connection is successful, you'll see a **green check mark**.

You will then be prompted to go into your Sensi app to rename the sensor.

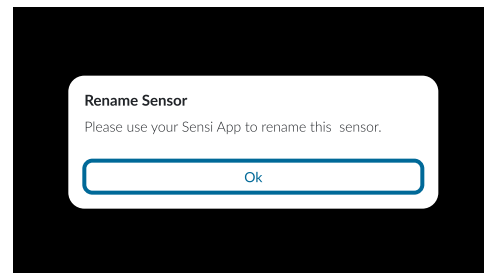
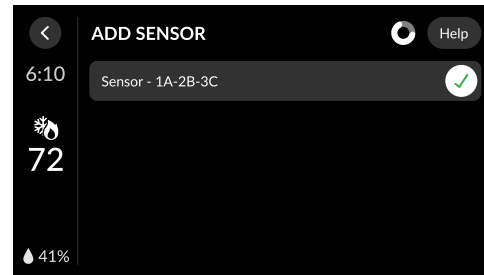
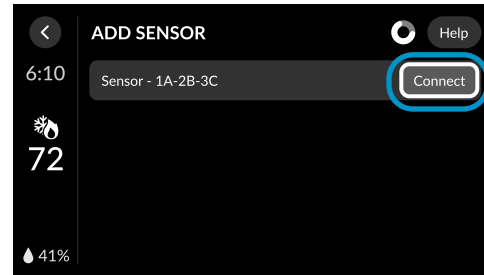
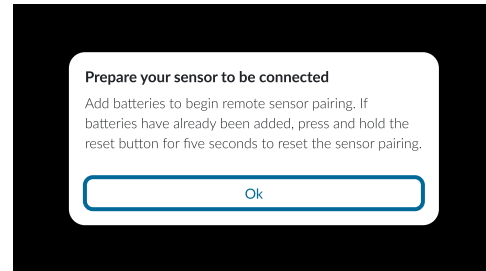

### STEP 3

## Name your sensors

In the Sensi app, tap on your **Touch 2 thermostat**. You will see your sensors above the room temperature. Tap **Sensors** to view your sensor status and rename them.

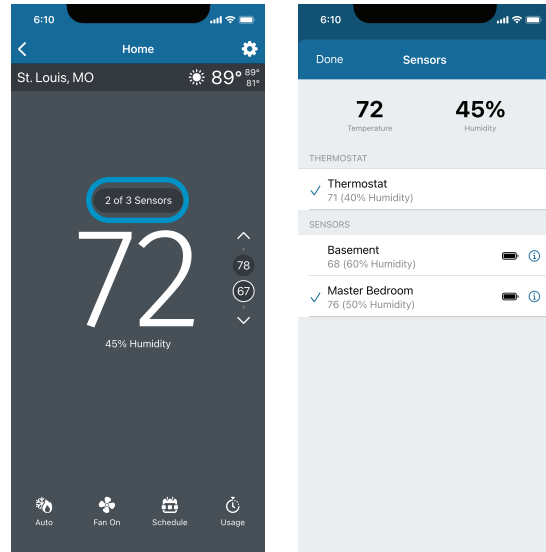

#### IOS

- Tap the **i** icon next to the sensor

#### Android

- Tap the **3 vertical dots**.

In the **Sensor Name** field, rename the sensor to something that helps you remember where it is in your home such as living room, kids' bedroom, etc.

Tap **Save** to save the name change.

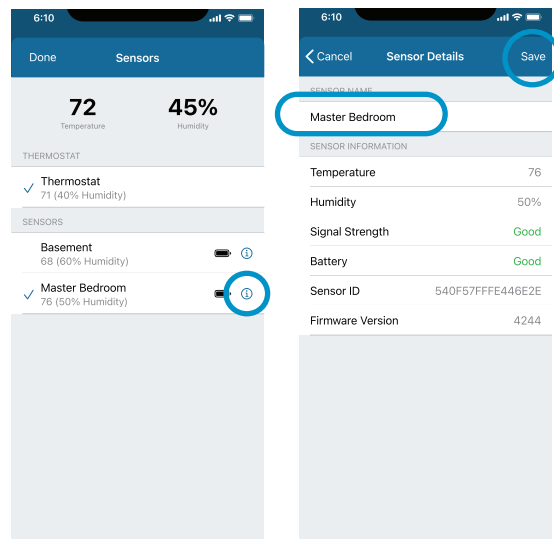

## STEP 4

### Place or mount your sensors

Place your sensors in their corresponding room locations. You can choose from several install options:

- Mount the wall on using the enclosed hardware
- Assemble the enclosed stand by sliding the sensor onto the base and snap into place
- Simply place the sensor on a flat surface such as a table or shelf

For the best placement of your Sensi room sensor, make sure the sensor is 5 feet off the ground in a location facing the room with good airflow.

Avoid locations that could impact the temperature reading such as in direct sunlight, near air vents, windows or direct heat sources.

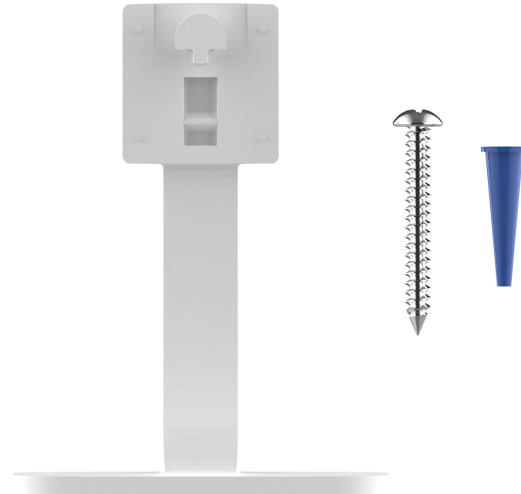

## STEP 5

### Prioritize your sensors

After installing your sensors, by default, there will be a **checkmark** next to all sensors and the thermostat in the mobile app. This means that your temperature setpoint will be comprised of a average temperature across all of the selected devices.

To prioritize the temperature and humidity of a certain room or sensor, ensure only the sensors you want to prioritize are selected.

The temperature and humidity shown on the top of your app screen will display the average temperature across all selected devices in your home.

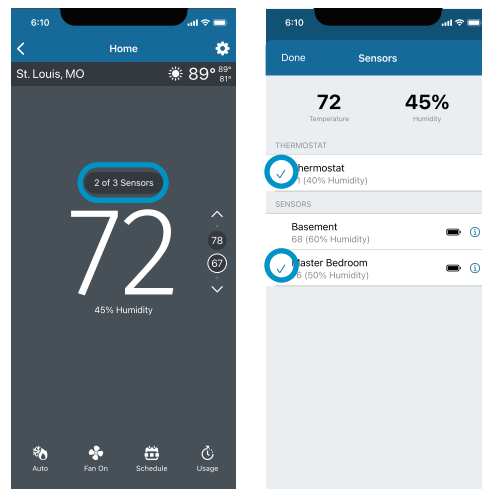

## Troubleshooting

### ***My sensor won't connect***

If you see a **failed** message or your sensor does not appear on the screen after the thermostat looks for it, try this:

- Hold the **Reset** button on the sensor for 5 seconds and then try to connect again.
- If resetting the sensor does not work, replace with 2 new AAA batteries.

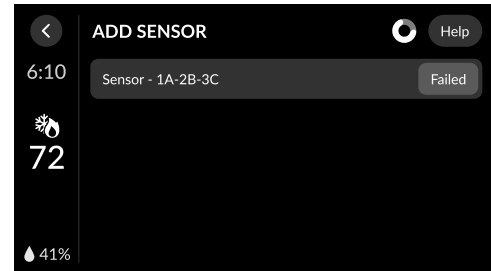

### ***My sensor has lost connection***

Remove the batteries for 5-10 seconds to power cycle it and put them back in.

### ***Where should I place my sensors to get the most accurate temperature readings?***

For the best placement of your Sensi room sensor, make sure the sensor is 5 feet off the ground in a location facing the room with good airflow.

Avoid locations that could skew the temperature reading. Also, do not paint or spray anything on your sensor or it may not function as expected.

Sensi room sensors use low frequency radio waves, not Wi-Fi, for secure connection to your Sensi Touch 2 smart thermostat. Ensure that the thermostat is within 45 feet from the thermostat, and avoid obstacles like thick walls or other devices broadcasting on a low frequency (~900MHz) like cordless phones, baby monitors, etc.

Avoid placing sensor:

- In direct sunlight
- Near air vents
- Near heat sources like stoves or hot water pipes/radiators
- Do not install a sensor in an area where temperatures are not within our operating standards (in a refrigerator or greenhouse)
- On or near a window
- On or near an uninsulated surface or wall
- Enclosed area where the air won't circulate – in a closet, behind books or wall art, etc.

## Technical support

For problems connecting your Sensi thermostat, call or email the Sensi Technical Support team, and they will be happy to help you or your contractor walk through any steps needed to troubleshoot the Sensi thermostat.

[sensi.emerson.com/en-us/support](https://sensi.emerson.com/en-us/support)

(888) 605.7131

[support@sensicomfort.com](mailto:support@sensicomfort.com)