

TRU-BOLT®

USER MANUAL



08172016-v4

Index

INSTALLATION INSTRUCTIONS

Package Contents / Tools Required.....	Page 1
Prepare Door and Jamb.....	Page 2
Adjusting Deadbolt Latch Set.....	Page 3
Installing Deadbolt Latch Set.....	Page 4
Preparing Interior Assembly.....	Page 5
Installing Exterior Assembly.....	Page 6
Installing Interior Assembly.....	Page 7-8

OPERATION INSTRUCTIONS

Exterior Assembly Overview.....	Page 9
Locking and Unlocking / Changing Programming Code / Adding User Codes.....	Page 10
Deleting User Codes / Automatic Lock Function / Temporarily Disable Auto Lock.....	Page 11
Vacation Mode / Sound On and Off / Secure Lock-out Period.....	Page 12
Restore Factory Settings / Low Battery Warning / Consumer Friendly Message Guide.....	Page 13
Installation Trouble Shooting.....	Page 14
Template.....	Page 15-16
Consumer Assistance.....	Page 17
Programming Record.....	Page 18-19
Limited Warranty.....	Page 20

INSTALLATION INSTRUCTIONS

Package Contents

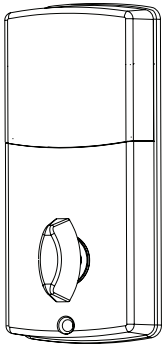

Interior Assembly

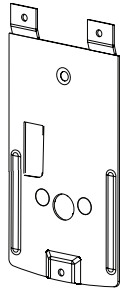

Mounting Plate



Entry keys (2 ea.)

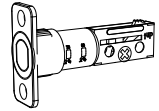
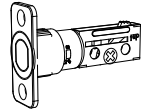

Deadbolt Latch Set (Adjustable)
2-3/8" (60mm) to 2-3/4" (70mm)

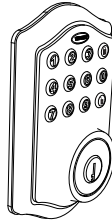

Exterior Assembly

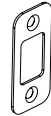

Deadbolt Strike Plate



5/16" (8mm) Screws - 2 ea.



7/8" (22mm) Screws - 2 ea.

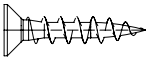

3/4" (19mm) Screws - 5 ea.



1" (25mm) Screw - 1 ea.

Tools Required

Tools Required for Installation on Pre-drilled Doors:

- Phillips Head Screwdriver

Tools Required for Installation on Doors That Require Drilling:

- Drill
- Tape Measure
- Pencil
- 2-1/8" (54mm) Drill Hole Saw
- 1" (25mm) Drill Bit
- 1/16" (2mm) Drill Bit
- Chisel
- Hammer
- Phillips Head Screwdriver

Batteries (not included)

Electronic lock requires (4) High Quality AA Alkaline batteries. When all 4 batteries are installed in the correct position, hear 2 beeps and the keypad will illuminate blue. **DO NOT TOUCH** the keypad until the keypad stops illuminating.

NOTE: For installation on doors with pre-drilled holes skip to page 4.

1. TEMPLATE

- Cut out template printed on page 15 & 16 of this Manual (Figure 1a).
- Fold template and place on door 36" (915mm) from the ground as marked (Figure 1b).



Figure 1a

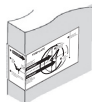

Figure 1b

2. MARK THE DOOR FOR DRILLING

- Mark center hole on door edge through guide on template for 1" (25mm) latch bolt (Figure 2a).
- Mark center hole on door face through guide on template for 2-3/8" (60mm) or 2-3/4" (70mm) backset (Figure 2b).

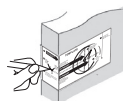

Figure 2a



Figure 2b

3. DRILL AND CHISEL DOOR

- Drill 2-1/8" (54mm) hole through door face as marked for lock set (Figure 3a).
- Drill 1" (25mm) hole in center of door edge for Deadbolt Latch Assembly (Figure 3b).
- Insert Deadbolt Latch Assembly in hole keeping it parallel to face of door. Mark outline and remove latch (Figure 3c).
- Chisel 1/8" (3mm) deep or until latch face is flush with door edge (Figure 3d).

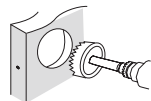

Figure 3a

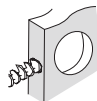

Figure 3b

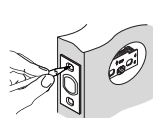

Figure 3c

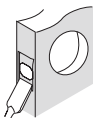
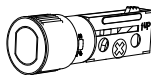

Figure 3d



NOTE: For Drive in Latch, drill hole size indicated on template and press until it is flush with door edge.



4. MARK AND DRILL DOOR JAMB

- Mark center hole on edge of jamb even with the center of the Latch Bolt on door edge. (Figure 4a).
- Drill 1" (25mm) hole 1-3/16" (30mm) deep in door jamb on center mark (Figure 4b).
- Outline outside edges of Strike Plate (Figure 4c).
- Chisel 1/8" (3mm) deep for Strike Plate or until flush (Figure 4d).
- Install Strike Plate using two 3/4" (19mm) screws provided (Figure 4e).

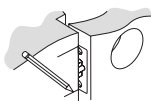

Figure 4a



Figure 4b

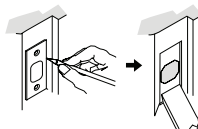

Figure 4c

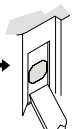

Figure 4d

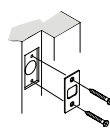

Figure 4e

ADJUSTING DEADBOLT LATCH SET

NOTE: Deadbolt Latch Set is shipped with the backset set at 2-3/8" (60mm)

Measure the backset (backset is distance between edge of the door and the center of Lock).

1. TO CONVERT FROM 2-3/8" (60mm) BACKSET TO 2-3/4" (70mm) BACKSET

- Hold latch with numbers facing forward and thumb pressing on the bolt (Figure 1a).
- Rotate the cylinder cover clockwise (Figure 1b).
- Pull and twist the extension plate all the way out (Figure 1c).
- Rotate the cylinder cover counter clockwise so that the marking aligns with the 2-3/4" (70mm) position indicator (Figure 1d).



NOTE: Do not extend Cylindrical Cover past 2-3/4" (70mm)

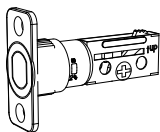

Figure 1a

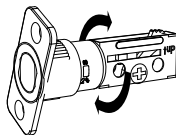

Figure 1b

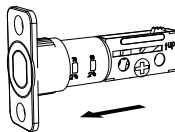
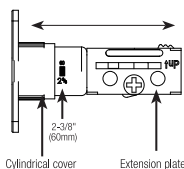

Figure 1c

Your latch is now set 2-3/4" (70mm) backset



Cylindrical cover

Extension plate

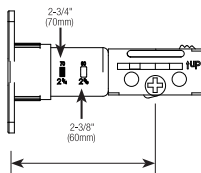

Figure 1d

2. TO CONVERT FROM 2-3/4" (70mm) BACKSET TO 2-3/8" (60mm) BACKSET

- Hold latch with numbers facing forward and thumb pressing on the bolt (Figure 2a).
- Rotate the cylinder cover clockwise (Figure 2b).
- Push and twist the extension plate all the way in (Figure 2c).
- Rotate the cylinder cover counter clockwise so that the marking aligns with the 2-3/8" (60mm) position indicator (Figure 2d).

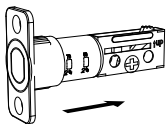

Figure 2a

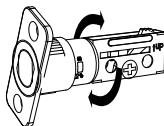
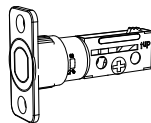
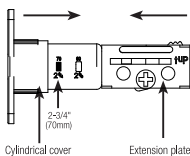

Figure 2b



Your latch is now set 2-3/8" (60mm) backset

Figure 2c



Cylindrical cover

Extension plate

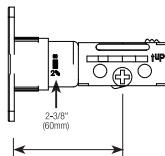
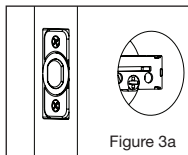

Figure 2d

INSTALLING DEADBOLT LATCH SET

3. INSTALLING THE DEADBOLT LATCH SET (need phillips head screwdriver)

- Insert Deadbolt Latch Set into door edge hole with the word "UP" and the arrow on the extension plate facing UP. Cross shaped spindle connector will be at the bottom of the Deadbolt Latch Set (Figure 3a).
- Make sure the face plate sits flush with the door. Do not force the latch into the mortise flush. Chisel out excess material if necessary for a flush fit.
- Using two 3/4" (19mm) screws provided, screw the latch into the door with a hand held screwdriver. DO NOT OVER TIGHTEN.



NOTE: Deadbolt Latch must be retracted when installing

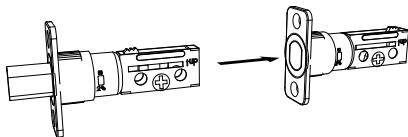

Deadbolt Latch Extended

Deadbolt Latch Retracted

4. IDENTIFYING YOUR DOOR HANDING

Stand outside the door.

- If the hinges are on the left your door is Left Handed (Figure 4a and 4b).
- If the hinges are on the right your door is Right Handed (Figure 4a and 4b).

OUT SWING DOOR

Left Handed Door
Hinges are on the left side

Right Handed Door
Hinges are on the right side

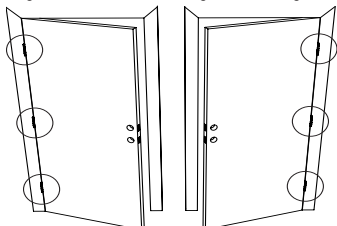

Figure 4a

IN SWING DOOR

Left Handed Door
Hinges are on the left side

Right Handed Door
Hinges are on the right side

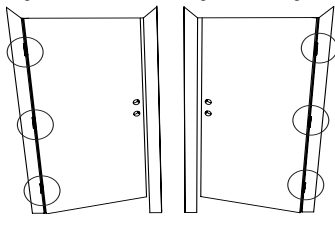

Figure 4b



NOTE: You are standing outside the door

PREPARING THE INTERIOR ASSEMBLY

5. UNPACK THE INTERIOR ASSEMBLY

- Remove the battery cover by sliding the cover upward.
- Locate the screws holding the Mounting Plate to the Interior Assembly. Remove the screws to release the Mounting Plate from the Interior Assembly.

6. SET THE ENTRY SWITCH FOR LEFT OR RIGHT HANDED DOOR

- Gently move the switch to "L" for Left Handed Door (Figure 6a).
- Gently move the Switch to "R" for Right Handed Door (Figure 6b).

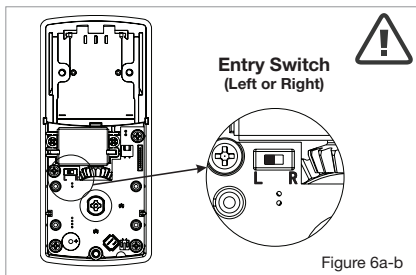

7. SET THE INTERIOR KNOB POSITION FOR LEFT OR RIGHT HAND HINGED DOORS

- The Interior Knob goes in the Horizontal position for Left Handed Doors (Figure 7a).
- The Interior Knob goes in the Vertical position for Right Handed Doors (Figure 7b).

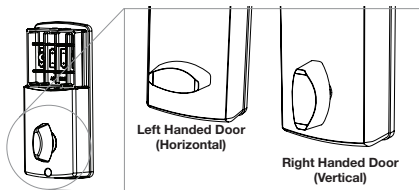

NOTE: Make sure deadbolt Latch is retracted

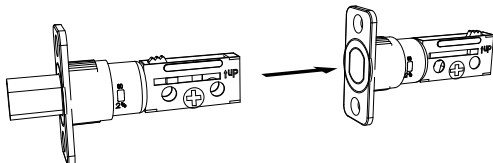

INSTALLING EXTERIOR ASSEMBLY

8. INSTALLING THE EXTERIOR ASSEMBLY

Work with the Door Open for easy access.

- Unpack the Exterior Assembly. Use care to not scratch the green circuit board during handling and installation.
- Check that the Rubber Gasket is properly seated on the Exterior Assembly (Figure 8a-b).
- Insert the Exterior Assembly onto the door with the tailpiece going through the Deadbolt Latch Set cross shaped spindle connector in the **VERTICAL POSITION**. Route the Control Wire through the door over the Deadbolt Latch Set (Figure 8c).

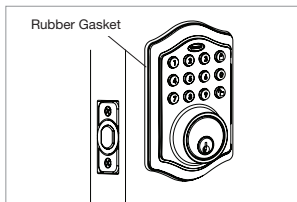

Figure 8a-b

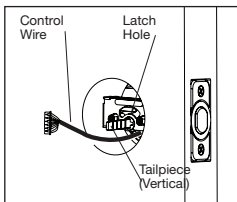

Figure 8c



NOTE: Tailpiece must be positioned vertically

9. SECURING THE EXTERIOR ASSEMBLY TO THE DOOR

- From the side marked "This side against door", route the Control Wire through the rectangular slot in the Mounting Plate (Figure 9a).
- Place Mounting Plate against door with tailpiece passing through the center hole in the three hole set (Figure 9b).
- Secure the Mounting Plate to the Exterior Assembly using two 1-1/8" (28mm) Screws (Figure 9c).
- Hand tighten with a Phillips Head Screwdriver leaving loosely connected (Figure 9d).
- Check that the Rubber Gasket is properly aligned and correct as necessary (Figure 9e).
- Check vertical alignment of the lock (Figure 9f).
- Tighten securely with a hand held Phillips Head Screwdriver.

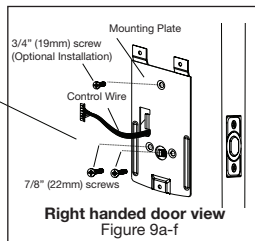

DO NOT OVER TIGHTEN

10. OPTIONAL INSTALLATION

- Using a 1/16" (2mm) drill bit, drill a pilot hole in your door using the Mounting Plate upper hole as a guide (Figure 10a).
- Insert one 3/4" (19mm) screw and tighten.

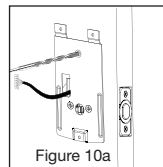

NOTE: Lock and unlock using the key to see if the Deadbolt Latch is opening and closing easily.

11. ATTACH THE CONTROL WIRE TO THE INTERIOR ASSEMBLY

- Use care to attach the Control Wire male plug to the Interior Assembly female socket connector (Figure 11a).
- Do not force the Control Wire male plug into the Interior Assembly female socket connector (Figure 11b).
- The Control Wire male plug has two alignment tabs on the smooth side of the plug which is the top of the plug (Figure 11c).
- The Control Wire male plug is inserted with the smooth side up into the Interior Assembly female socket connector (Figure 11d).

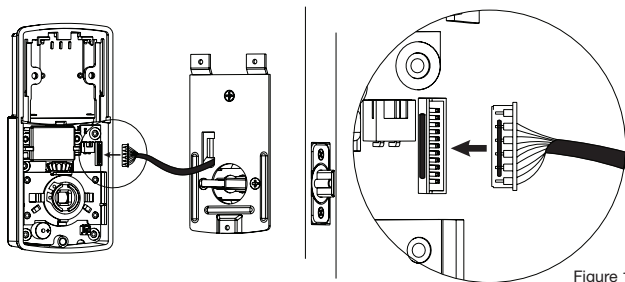

Figure 11a-d

12. ATTACH THE INTERIOR ASSEMBLY TO DOOR

- Position the Interior Assembly over the tailpiece and push the Interior Assembly against the door (Figure 12a).
- Using two 5/16" (8mm) screws and one 1" (25mm) screw, attach the Interior Assembly to the Mounting Plate. **DO NOT OVER TIGHTEN SCREWS** (Figure 12b).

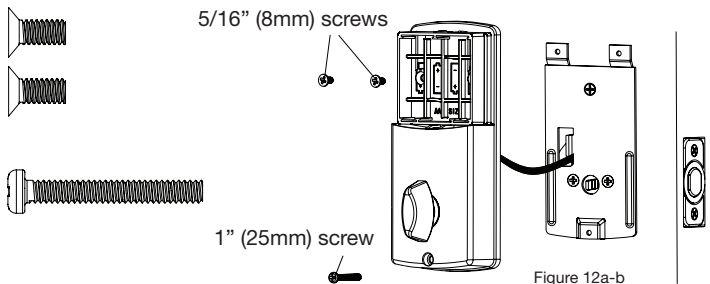

Figure 12a-b



NOTE: Lock and unlock using Interior Knob to see if the latch is opening and closing easily.

13. Installing Batteries

- Insert 4 AA high quality Alkaline batteries into the Battery Compartment in the direction noted +/- on the Compartment. The Lock will beep 2 times, the keypad will illuminate blue, and the Light Indicator will flash green twice to signify that it has received power (Figure 13a).

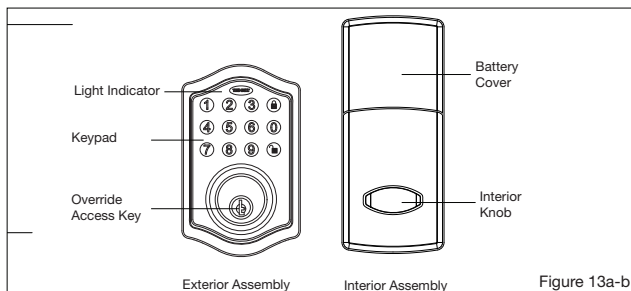

NOTE: Do not touch the Keypad until the blue light turns off. Do not use rechargeable batteries or non-alkaline batteries.

- Slide the Battery Cover down into the track on the Interior Assembly to cover the batteries (Figure 13b).



14. Testing Lock

With the Door Open

- Test the Lock using the Interior Knob. The bolt should move smoothly.
- Test the lock using the Keypad. To lock press  and then press "1234"  to unlock.

INSTALLATION OVERVIEW

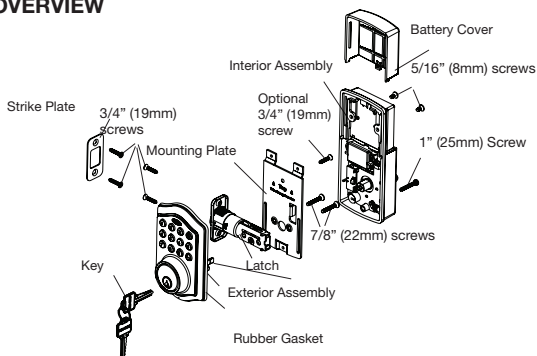

OPERATION INSTRUCTIONS

Exterior Assembly Overview

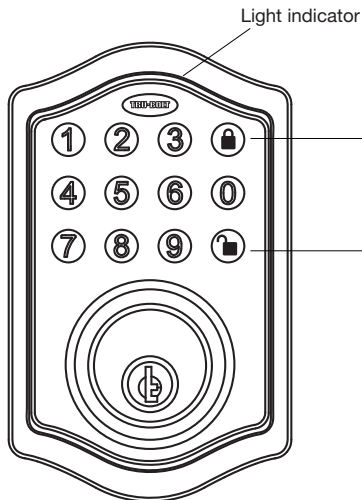

Green

- Indicates Successful Programming Step
- Indicates Unlocking is Successful

Red

- Indicates Failed Programming Step
- Indicates Locking is Successful

Lock button

Lock - Used to lock door

Clear - Used to clear wrong keypad entries

Unlock button

Unlock - Used to unlock door

Programming - Used in programming steps

Batteries (not included)

Electronic lock requires (4) High Quality AA Alkaline batteries. When all 4 batteries are installed in the correct position, hear 2 beeps and the keypad will illuminate blue. **DO NOT TOUCH** the keypad until the keypad stops illuminating.

Programming Symbols

 Lock / Clear

 Unlock / Programming

 Programming Code

 User Code (4-8 digits)

 User ID (01-50, 2 digits)

Factory Settings



The lock comes factory preset with a:

 Programming code - 123456

 User code - 1234

 User ID - 01



Please change the Programming Code  and the User Code  as soon as possible after installation to insure security.

Programming Tips



5 Seconds - Complete all the programming steps in the programming mode within 5 seconds.

Clear - Use the  key to clear entries in case a wrong button is pushed.

Deleting User Codes

DELETE ONE EXISTING OR PRESET USER CODE

The unit comes with a factory User ID  = 01 for User Code  = 1234.

IMPORTANT: To delete 1 User Code , the lock must have more than 1 User Code  in its database.

 →  → 2 →  → Existing  →  re-enter  → 

Hear 1 beep and Light Indicator illuminates green.

DELETE ALL USER CODES

IMPORTANT: this will delete the user codes but not the programming code, enter the following.





 →  → 3 →  → re-enter  → 

Hear 1 beep and Light Indicator illuminates green.

Automatic Lock Function





SET OR CANCEL AUTO LOCK

You can set the lock to automatically close after each time the lock is opened. Time value range = 20 - 900 seconds, enter the following:

Set Auto Lock:  →  → 5 →  → Time Value → 

Hear 1 beep and Light Indicator illuminates green.

To cancel Auto Lock set the time to 00, enter the following:

Cancel Time Value Auto Lock:  →  → 5 →  → 00 → 

Hear 1 beep and Light Indicator illuminates green.

Temporarily Disable Auto-Lock

DISABLE:

While in Auto-Lock mode, unlock door using , within 10 seconds you must turn the locking knob by hand to the locked position, wait more than 2 seconds then turn the locking knob back to the unlock position. The Auto-Lock mode is now disabled.

RESTORE:

To restore the Auto-Lock function, turn the locking knob by hand to the locked position, wait more than 2 seconds or press the  Lock button on the keypad.

Vacation Mode

With Vacation Mode enabled, the system enters into low-power consumption mode. During this mode, all buttons and functions will be invalid until they are re-enabled (see steps below).

ENABLE:

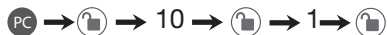

Hear 1 beep and Light Indicator illuminates green then lock door

DISABLE:

To disable the Vacation Mode, you must press and hold Lock for more than 3 seconds, then input PC to unlock the door. Vacation Mode is now disabled.



NOTE: If you only press the Lock for more than 3 seconds but do not input PC, the system will remain in Vacation Mode.

Sound On and Off

You can “mute” or turn the “sound on” on your lock by entering the following. (Factory setting is sound on).





Sound Off (1) - Light Indicator illuminates green.

Sound On (2) - Hear 1 beep and Light Indicator illuminates green.

Secure Lock-out Period

Warning sounds and LED flashes red after 4 incorrect code attempts: Keypad shuts down for 30 seconds.

Restore Factory Settings

To reset the lock to the original factory settings including the Programming Code  and all User Codes  remove one battery for 10 seconds. Reinsert the battery and wait for a long and short beep. Press  3 times within 3 seconds. The lock will beep and the light indicator will turn green.

Low Battery Warning

Beeps and LED flashes red for 5 seconds. Replace with good quality alkaline batteries.
Note: Removing batteries does not erase active Programming or User Codes.

Consumer Friendly Message Guide

Unlock / Valid programming	1 long beep and LED illuminates green
Lock	2 short beeps and LED illuminates red
Invalid Programming	2 short beeps and LED flashes red twice
Low Voltage	Beeps for 5 seconds (7/9 times depends on operation is unlock/lock)
Super Low Voltage	4 short beeps and LED flashes red four times
4 Incorrect code entry attempts	2 short beeps and LED illuminates red each attempt
Power on	1 long beep and 1 short beep and LED illuminates green
Chip Reset	1 long beep and 1 short beep and LED illuminates green (may occur several times or once in a while)
Lock Error	3 long beeps LED flashes red three times
Repeat operation after Lock Error	2 short beeps three times LED flashes red six times

NOTE: When battery is under low voltage, the lock will give the (Low Battery Warning: Beeps and LED flashes red for 5 seconds). During this time your lock can still work. However once the voltage is lower than 4.3V (called Super-Low Voltage), the operation of the locking and unlocking will not work, user must replace batteries immediately.

INSTALLATION TROUBLE SHOOTING

Issue	Solution
Latch Working Backwards- Lock unlocks when lock button is pushed or locks when unlock button or code is pushed.	<p>Direction switch is set to incorrect setting. Remove the Interior Assembly and move the switch to the opposite direction.</p> <ul style="list-style-type: none">• Check that your switch is set in the correct position Left or Right Handed door. <p>If Correct</p> <ul style="list-style-type: none">• Rotate Interior Knob and reinstall Interior Assembly. Retest again while holding Interior Assembly in place.
Interior Knob will not turn.	<p>Knob or vertical tailpiece is installed in incorrect position. Remove Interior Assembly and reposition the Interior Knob. With the Deadbolt Latch retracted verify that the tailpiece is vertical.</p>
Lock will not function electronically.	<ul style="list-style-type: none">• Check that all batteries are fresh high quality Alkaline Batteries.• Check for proper polarity (+ -) of all batteries.• Check that the Control Wire is attached to the Interior Assembly.
Lock gives error signal when opening or locking and Deadbolt Latch will not extend or retract completely when door is closed.	<p>Unlock door using Key or Interior Knob. While door is open, check that the Deadbolt Latch operates smoothly. Check for proper alignment of the strike plate, adjust as needed to assure there is no binding against the Deadbolt Latch.</p>
Deadbolt Latch is sticking.	<p>Installation screws of the lock may be too tight and have to be loosened.</p> <ul style="list-style-type: none">• Remove Interior Assembly.• Slightly loosen the Mounting Plate screws.• Lock and unlock using the Key.• Reattach Control Wire and Interior Assembly.

TEMPLATE

**FOLD HERE ON
DOOR EDGE**

● MARK
FOR
 $1\frac{3}{8}$ " (45mm)
DOOR

● MARK
FOR
 $1\frac{3}{8}$ " (35mm)
DOOR

FOR INSTALLING
ENTRY LOCK AND DEADBOLTS

$2\frac{3}{8}$ " BACKSET

$2\frac{3}{4}$ " BACKSET

● THEN DRILL $1\frac{1}{2}$ " (25mm) HOLE
IN CENTER OF DOOR EDGE
(2" IN DEPTH)

MARK CENTER
OF HOLE ON
DOOR FACE

● DRILL
HOLE
 $2\frac{1}{8}$ " (54mm)

IMPORTANT!
PLACE TEMPLATE
ON HIGH EDGE OF
DOOR BEVEL



Back of Template

CONSUMER ASSISTANCE

EMAIL: LHICustomerService@lewishymaninc.com

WEBSITE: www.truboltlocks.info

ADDRESS: Consumer Assistance Dept.
Lewis Hyman, Inc., 860 East Sandhill Avenue Carson, CA 90746 USA

TELEPHONE: US/Canada 800-860-1677 (Toll Free)

CALL CENTER HOURS: US/Canada 7am – 5pm (Pacific**) Mon – Fri
(Subject to change)

CALL BACK HOURS: Other Countries 7am – 8pm (Pacific**) Mon – Fri
(Subject to change)

Pacific**- Local time in Los Angeles, CA, USA

** Local Time based on Los Angeles California USA

Programming Record

My Codes:

Date Created

Programming Code	___	___	___	___	___	___	(6 digits)	/	/
User Code 01	___	___	___	___	___	___	(4-8 digits)	/	/
User Code 02	___	___	___	___	___	___	(4-8 digits)	/	/
User Code 03	___	___	___	___	___	___	(4-8 digits)	/	/
User Code 04	___	___	___	___	___	___	(4-8 digits)	/	/
User Code 05	___	___	___	___	___	___	(4-8 digits)	/	/
User Code 06	___	___	___	___	___	___	(4-8 digits)	/	/
User Code 07	___	___	___	___	___	___	(4-8 digits)	/	/
User Code 08	___	___	___	___	___	___	(4-8 digits)	/	/
User Code 09	___	___	___	___	___	___	(4-8 digits)	/	/
User Code 10	___	___	___	___	___	___	(4-8 digits)	/	/
User Code 11	___	___	___	___	___	___	(4-8 digits)	/	/
User Code 12	___	___	___	___	___	___	(4-8 digits)	/	/
User Code 13	___	___	___	___	___	___	(4-8 digits)	/	/
User Code 14	___	___	___	___	___	___	(4-8 digits)	/	/
User Code 15	___	___	___	___	___	___	(4-8 digits)	/	/
User Code 16	___	___	___	___	___	___	(4-8 digits)	/	/
User Code 17	___	___	___	___	___	___	(4-8 digits)	/	/
User Code 18	___	___	___	___	___	___	(4-8 digits)	/	/
User Code 19	___	___	___	___	___	___	(4-8 digits)	/	/
User Code 20	___	___	___	___	___	___	(4-8 digits)	/	/
User Code 21	___	___	___	___	___	___	(4-8 digits)	/	/
User Code 22	___	___	___	___	___	___	(4-8 digits)	/	/
User Code 23	___	___	___	___	___	___	(4-8 digits)	/	/
User Code 24	___	___	___	___	___	___	(4-8 digits)	/	/
User Code 25	___	___	___	___	___	___	(4-8 digits)	/	/

Programming Record (Cont.)

My Codes:

Date Created

User Code 26	___	___	___	___	___	___	___	___	(4-8 digits)	/	/
User Code 27	___	___	___	___	___	___	___	___	(4-8 digits)	/	/
User Code 28	___	___	___	___	___	___	___	___	(4-8 digits)	/	/
User Code 29	___	___	___	___	___	___	___	___	(4-8 digits)	/	/
User Code 30	___	___	___	___	___	___	___	___	(4-8 digits)	/	/
User Code 31	___	___	___	___	___	___	___	___	(4-8 digits)	/	/
User Code 32	___	___	___	___	___	___	___	___	(4-8 digits)	/	/
User Code 33	___	___	___	___	___	___	___	___	(4-8 digits)	/	/
User Code 34	___	___	___	___	___	___	___	___	(4-8 digits)	/	/
User Code 35	___	___	___	___	___	___	___	___	(4-8 digits)	/	/
User Code 36	___	___	___	___	___	___	___	___	(4-8 digits)	/	/
User Code 37	___	___	___	___	___	___	___	___	(4-8 digits)	/	/
User Code 38	___	___	___	___	___	___	___	___	(4-8 digits)	/	/
User Code 39	___	___	___	___	___	___	___	___	(4-8 digits)	/	/
User Code 40	___	___	___	___	___	___	___	___	(4-8 digits)	/	/
User Code 41	___	___	___	___	___	___	___	___	(4-8 digits)	/	/
User Code 42	___	___	___	___	___	___	___	___	(4-8 digits)	/	/
User Code 43	___	___	___	___	___	___	___	___	(4-8 digits)	/	/
User Code 44	___	___	___	___	___	___	___	___	(4-8 digits)	/	/
User Code 45	___	___	___	___	___	___	___	___	(4-8 digits)	/	/
User Code 46	___	___	___	___	___	___	___	___	(4-8 digits)	/	/
User Code 47	___	___	___	___	___	___	___	___	(4-8 digits)	/	/
User Code 48	___	___	___	___	___	___	___	___	(4-8 digits)	/	/
User Code 49	___	___	___	___	___	___	___	___	(4-8 digits)	/	/
User Code 50	___	___	___	___	___	___	___	___	(4-8 digits)	/	/

Limited 1-Year Electronic Warranty

Limited Lifetime Mechanical and Finish Warranty

This Tru-Bolt® product comes with a 1-Year Limited Warranty on Electronic Parts and a Limited Lifetime Mechanical and Finish Warranty against defects in materials and workmanship under normal use to the original residential user. Simply bring this product with the original sales receipt back to your nearest Menards® retail store. At its discretion, Tru-Bolt® agrees to have the product or any defective part[s] repaired or replaced with the same or similar Tru-Bolt® product or part[s] free of charge. This warranty is non transferable, and applies to the original purchaser only, as long as the original purchaser occupies the residential premises upon which the product[s] was originally installed. Proof of purchase and ownership is required for the warranty to be in effect. Requests for credit for defective item[s] must be made to any Menards® retail store. This warranty DOES NOT COVER removal and reinstallation of product[s], scratches, abrasions, deterioration due to the use of paints, solvents or other chemicals, abuse, misuse, or product[s] used in commercial applications, does not cover any losses, injuries to persons/property or costs, and shipping and freight expenses required to return product[s] to nearest Menards® retail store. In no event shall Tru-Bolt® be liable for any special, incidental or consequential damages. Customers will receive instructions as to the disposition of the defective item[s]. Menards® reserves the rights, which may vary from state to state. If this product[s] is considered a consumer product, please be advised that some local and state laws do not allow limitations on incidental or consequential damages or how long an implied warranty lasts, so that the above limitations may not fully apply. Refer to your local laws for your specific rights under this warranty.

Package Warranty:

Limited Lifetime Mechanical & Finish Warranty:

This Tru-Bolt® product[s] comes with a 1-Year Limited Warranty on Electronic Parts and a Limited Lifetime Mechanical and Finish Warranty against defects in materials and workmanship under normal use to the original residential user. Simply bring this product[s] with the original sales receipt back to your nearest MENARDS® retail store and we'll replace it with the same or similar Tru-Bolt® product or part. See installation instructions for full terms and conditions.



Manufactured by:
Lewis Hyman Inc.
860 East Sandhill Avenue
Carson, CA 90746