

BLUETOOTH OPERATION

IMPORTANT:

Prior to use Bluetooth function, your speaker should be paired firstly with your Bluetooth device. ("Pairing" means establish connection between Bluetooth devices such as MOBILE PHONE, TABLETS, PC, ETC.)

- Press the **MODE** button to switch into the **BT MODE** (Bluetooth mode). (fig. 1)
- In **BT MODE**, a sound indication will announce that Bluetooth pairing mode is ready. Then the micro system will search automatically for Bluetooth devices.
- Turn on Bluetooth functionality on your device and make it discoverable (see your device's instructions to add or setup a Bluetooth device).
- Search for Bluetooth equipment: **BOM-666** is your speaker identification. (fig. 2)
A sound indication will announce that Bluetooth devices are successfully paired. (During the pairing, if a password is required, you need to input code "0000").
Your Bluetooth device stores the trolley speaker unique identification at the same time.

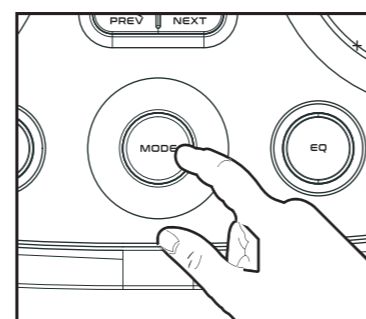

(fig. 1)

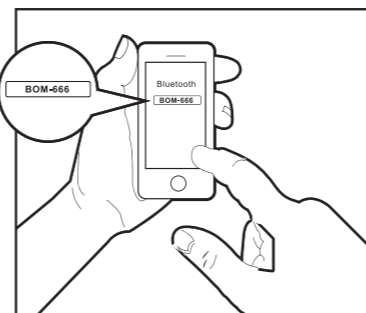

(fig. 2)

TROUBLE SHOOTING GUIDE

If a fault occurs, first check the points listed below before taking the speaker to repair.

Do not open the speaker as there is a risk of electric shock.

If you are unable to remedy a problem by following these hints, consult your dealer or service center.

SYMPTOM	CAUSE	CORRECTION
Sound	No sound	No input sound source. Use a better music signal.
		Volume is too low. Adjust volume.
		Volume too high. Turn down the volume.
Distortion of sound	Speaker may be damaged	If speaker is damaged, repair or replace it.
Karaoke	Karaoke does not work	Microphone plug is not fully inserted. Plug microphone properly into the socket.
		Microphone switch is not on. Turn on microphone switch.
		Microphone volume knob is at the lowest position. Adjust microphone volume properly.
		Wireless microphone has low battery. Replace battery.
MP3	MP3 does not play	The song format in the USB disc is incorrect. Transform song format into MP3 format.
		Improper operation has caused a process disorder. Reboot the machine.
		USB disk/Micro SD is disconnected. Insert USB disc/Micro SD properly.
Remote control	The remote control does not work properly	The remote control is too far from the unit. Operate the remote control within about 6m.
		There is an obstacle in the path of the remote control and the unit. Remove the obstacle.
		The battery in the remote control is exhausted. Replace the battery with new one.

WARNING!

Under no circumstances should you try to repair the set yourself, as this will invalidate the warranty.

MANUAL



BOM-666

Portable BT Speaker System

SAFETY PRECAUTIONS

Thank you for purchasing **BOM-666**:

This is your assurance of quality, performance and value. Our engineers have included many useful and convenient features in this product. Please be sure to read this instruction Manual completely to make sure you are getting the maximum benefit from each feature.

This product was manufactured using the highest quality components and standards of workmanship. It was tested by inspectors and found to be in perfect working order before it left our factory.

TO PREVENT FIRE OR SHOCK HAZARD DO NOT EXPOSE THIS APPLIANCE TO RAIN OR MOISTURE.

Notes:

The images appearing in this manual are for reference only.

Due to continual revision and improvement on our products design and specifications are subject to change without further notice.

CHARGER AND BATTERY

CHARGING THE SPEAKER

When charging, connect a matched power adapter to **DC-5V**

Charging time is approximately 4 to 6 hours. Once fully charged unplug the power supply as leaving a full battery on charge may cause damage to the battery.

BATTERY CHARGE INDICATOR

LED panel has battery status indicator. In the middle of the shape of the battery have four horizontal lines, each horizontal line represents **25%** of electricity remaining.

When no horizontal line in the shape of the battery or the shape flashes, please power off and promptly charge to avoid damage to the battery.

When charging, the battery indicator on LED display panel flashes.

The indicator stop blinking after full charged. Then please continue to charge the battery for 1-2 hours to extend the battery life.

WARNING!

If the battery is under voltage, please fully charge it within 48 hours.

If the speaker have to be left unused for a long time, please let the battery fully charged, otherwise it will cause damage to the battery!



(100%)

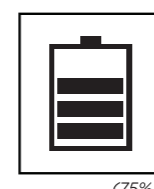

(75%)



(50%)

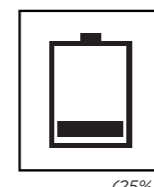

(25%)

TECHNICAL SPECIFICATION

MODEL:

Rated Voltage:
Rated Power:
Input sensitivity:
Battery:
Charging time:
Working time:
Frequency response:
Audio S/N:

BOM-666

DC-5V
≤ 100W
750±50mV
11.1V 5200mAh
4-6h
3-5h
60Hz-18KHz
≥ 71dB

DESCRIPTION OF REMOTE CONTROL

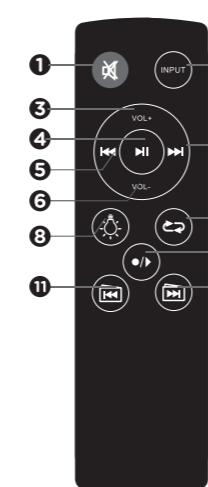

- MUTE (M)**
Mute or restart the speaker sound.
- INPUT (INPUT SELECTION)**
Input selection (AUX input / Bluetooth / Micro SD / USB / FM function).
- VOL+ (INCREASE VOLUME)**
Increase the volume.
- PLAY / PAUSE / SCAN (▶|◀)**
In play mode, press to suspend playing songs. Press this button again to continue play.
Scan and save radio stations in **FM Radio** input mode.
- PREVIOUS (◀◀)**
Change to previous song.
Change to previous channel in **FM Radio** input mode.
- VOL- (DECREASE VOLUME)**
Decrease the volume.
- RECORD / PLAY RECORDING (▶|◀)**
Start recording, long press it to play the recordings.
- PREVIOUS FOLDER (◀◀)**
Change to the previous folder on **USB** or **Micro SD**.
- NEXT FOLDER (▶▶)**
Change to the next folder on **USB** or **Micro SD** input mode.
- REPEAT (↺)**
Repeat one, repeat all, repeat folder.

DESCRIPTION OF CONTROLS

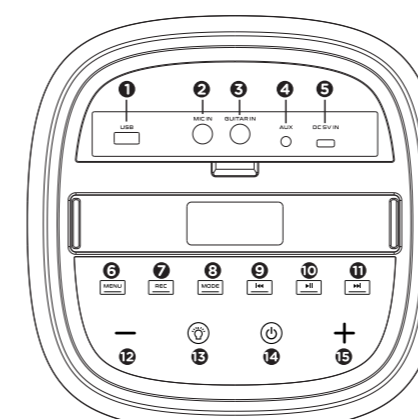

- USB PLAY SLOT**
Insert USB, play the music.
- MIC SLOT**
Use to connect the microphone.
- GUITAR SLOT**
Use to connect the guitar jack.
- AUX INPUT**
Could be connected with personal computer, mobile phone, DVD, VCD, CD, LD, TV, MP3, radio, electric piano and any devices which have audio output.
- DC IN**
Connect type C charging cord.
- MENU**
Press menu then press + to: Adjust the treble, bass, Adjust the microphone treble, bass, echo, volume; Adjust the guitar.
- RECORD / PLAY RECORDING (▶|◀)**
Start recording, long press it to play the recordings.
- MODE**
With a short press on the button, select the input mode (AUX input / Bluetooth / USB / TF / FM radio).
- PREVIOUS (◀◀)**
Change to previous song.
Change to previous channel in **FM radio** input mode.
- PLAY / PAUSE / SCAN (▶|◀) / TWS**
In play mode: press to suspend playing songs. Press this button again to continue play.
Scan and save radio stations in **FM radio** input mode.
Short press to turn on/off TWS function.
- NEXT (▶▶)**
Change to next song.
Change to next channel in **FM radio** input mode.
- VOLUME (—)**
Press - to reduce the volume.
- LED LIGHT CONTROL**
Short press to change the light mode.
Long press to turn on/off the LED.
- POWER ON/OFF**
Turn the speaker on or off.
- VOLUME (< +)**
Press + to increase the volume.

MICROPHONE CONTROLS AND BASIC OPERATION

WIRELESS MICROPHONE

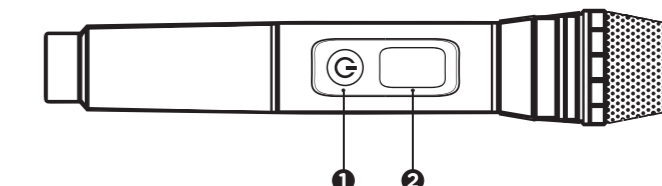

- MICROPHONE ON/OFF
- LED INDICATOR WINDOW

FUNCTIONS

RECORDING FUNCTION

Press **▶|◀** to record the voice into the external memory like USB disk / Micro SD on the speaker.

If the external memory is first time used, the system will automatically built a new folder named VOICE, and recording files in it will be named RECO01, RECO02, and so on.

In record mode, press **▶|◀** / **INPUT** to stop recording.

Long press **▶|◀** to play the recordings in the external memory, press **PREV** and **NEXT** to choose the recordings to play.

FM FUNCTION

Choose **INPUT** to switch to **FM RADIO**. Search and tune automatically to radio stations by pressing **▶|◀** on the remote control or long press the **▶|◀** button on the speaker.

Switch channels, by pressing **◀◀** and **▶▶** on the speaker or the remote control.

TWS FUNCTION

- Select the Bluetooth mode on the two speakers you wish to pair.
- Note: The two speakers need to be exactly the same in order to pair under TWS mode.
- Select any one of the speakers and long press the **▶|◀** button
- A sound will be heard and the main speaker display will indicate "BLUE" in a still mode confirming that the two speakers are now paired.
- The slave speaker display should indicate "SLAV" in a still mode.
- To disconnect the TWS function. Long press the **▶|◀** button on the main speaker.
- The slave speaker display indicator should indicate "BT" in a flashing mode.

For COMMUNICATION TERMINAL:

Federal Communications Commission (FCC) Statement

This device complies with part 15 of the FCC Rules. Operation is subject to the following two conditions: (1) This device may not cause harmful interference, and (2) this device must accept any interference received, including interference that may cause undesired operation.

Note: This equipment has been tested and found to comply with the limits for a Class B digital device, pursuant to part 15 of the FCC Rules. These limits are designed to provide reasonable protection against harmful interference in a residential installation. This equipment generates, uses and can radiate radio frequency energy and, if not installed and used in accordance with the instructions, may cause harmful interference to radio communications. However, there is no guarantee that interference will not occur in a particular installation. If this equipment does cause harmful interference to radio or television reception, which can be determined by turning the equipment off and on, the user is encouraged to try to correct the interference by one or more of the following measures:

- Reorient or relocate the receiving antenna.
- Increase the separation between the equipment and receiver.
- Connect the equipment into an outlet on a circuit different from that to which the receiver is connected.
- Consult the dealer or an experienced radio/TV technician for help.

Warning: Changes or modifications made to this device not expressly approved by

may void the FCC authorization to operate this device.

Note: The manufacturer is not responsible for any radio or TV interference caused by unauthorized modifications to this equipment. Such modifications could void the user's authority to operate the equipment.

RF exposure statement:

The transmitter must not be colocated or operated in conjunction with any other antenna or transmitter. This equipment complies with the FCC RF radiation exposure limits set forth for an uncontrolled environment. This equipment should be installed and operated with a Minimum distance of 20cm between the radiator and any part of your body.