

Minla

HC258 Instructions

High Chair Mode:

Suitable for children up to 3 years old. Maximum weight 40 lb (18.1 kg). Stop using recline positions when child can sit up unassisted or is 20 lb (9.1 kg).

Booster Seat Mode: Suitable for children who can sit up unassisted (approximately 6 months) to 5 years, up to 50 lb (22.7 kg). Always use booster seat mode in the upright position.

Child Chair Mode: 3 years to 50 lb (22.7 kg) max weight.

Note: Actual fit may vary. Not all children will comfortably fit in the seat for the full weight and height ranges listed.



MAXI-COSI[®]

We Carry the Future

- **READ** all instructions before assembly and use of product.
- **KEEP** instructions for future use.
- Discontinue use if damaged, broken or if parts are missing.
- Adult assembly required.

Using the High Chair

WARNING

FALL HAZARD: Children have suffered **severe** head injuries including skull fractures when falling from high chairs. Falls can happen suddenly if child is not restrained properly.

- **ALWAYS** use restraints, and adjust to fit snugly.
- Tray is not designed to hold the child in the chair.
- Stay near and watch child during use.
- Stay near and watch baby during use. This product is not safe for sleep or unsupervised use. If baby falls asleep, remove baby as soon as possible and place baby on a firm, flat sleep surface such as a crib or bassinet.
- The child should be secured in the high chair at all times by the restraint system, both in the reclined and upright positions.
- It is recommended that the high chair be used in the upright position only by children capable of sitting upright unassisted.
- **DO NOT** lift or move high chair with child in it.
- **NEVER** use near stairs.
- **ALWAYS** lock wheels while child is in high chair.
- **DO NOT** adjust seat position with child in it.
- **NEVER** use high chair in reclined positions when child is able to sit upright unassisted or weighs more than 20 lb (9.1kg).

Using the Booster Seat

- **Booster Seat fits most kitchen and dining room chairs with a minimum measurement of 14.2" (36 cm) W x 16.5" (42 cm) D and backrest height of 9.8" (25 cm) H.**

WARNING

Children have suffered **head injuries**, including skull fractures, **after falling** with or from booster seats.

- Check that booster is **securely attached** to adult chair **before each use**.
- **ALWAYS** use restraints until child is able to get in and out of booster seat without help. Adjust to **fit snugly**.
- **NEVER** allow child to **push away from table**.
- **NEVER** lift and **carry** child in booster seat.
- **Stay near** and **watch** your child during use.
- **ALWAYS** fasten seat and back straps securely to adult chair.
- This booster seat is only to be used with standard kitchen or dining room chairs. **NEVER** use this product as a car seat or bath seat, on a tabletop, stool, swivel chair, or any other seating surface where the straps cannot secure it properly.
- Until child is able to get in and out of the booster seat without help (about 2 1/2 years old), the child should be secured in the booster seat at all times by the restraining system. The tray is not designed to hold the child in the chair.
- **ALWAYS** use booster seat in upright position.
- Use this product only for children capable of sitting upright unassisted.
- **ALWAYS** ensure that all protector pads are located completely on the adult chair surface.

CONTINUED ON NEXT PAGE

Using the Booster Seat, Continued

- It is recommended that the booster seat be used in the upright position only by children capable of sitting upright unassisted.
- Test for proper assembly before placing child in seat.
- **ALWAYS** check that legs are fully extended and foot rest is folded inward.
- **ALWAYS** remove child before adjusting booster seat.
- **ALWAYS** ensure height adjustments are set to the same height.
- Prevent serious injury or death. Do not use in motor vehicles.

Using the Child Chair NOT FOR ADULT USE

WARNING

FALL HAZARD: Children have suffered **severe** head injuries including skull fractures when falling from Child Chair.

- This product is **ONLY** for children who are 3 years or older, up to 50 lbs (22.7kg).
- **ALWAYS** lock wheels to prevent movement when child is on seat.
- This stool is only to be used on the floor.
- This toddler seat is only for use with the high chair base.
- Stay near and watch child during use.
- **NEVER** use Child Chair without toddler seat in place and locked in position.
- **NEVER** allow a child to push away from the table/ furniture.
- Recommended for indoor use only.
- **NEVER** lift or move Child Chair with child on it.
- **NEVER** use near stairs.
- **NEVER** allow child to stand on Child Chair.
- Only use for a child that is able to get in and out of the chair unassisted.
- Make sure Toddler Seat is assembled correctly and securely. Test for proper assembly before placing child in Child Chair.

Index



7



8



10



20



26



- Lay out and identify all parts.
- Do not return this product to the place of purchase. If any parts are missing, call Consumer Care at 1-800-544-1108, text 1-812-652-2525, email support@djgusa.com, or visit our website at www.maxi-cosi.com.
- Include the model number (HC258) and manufacture date (found on the underside of the tray) and a brief description of the part.
- Keep these instructions for future use.





Assembling

1.

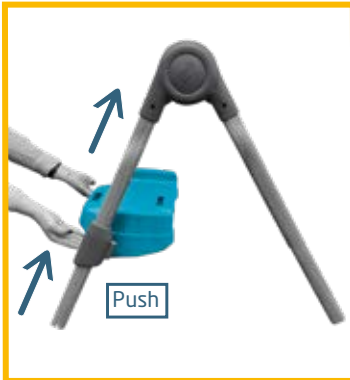
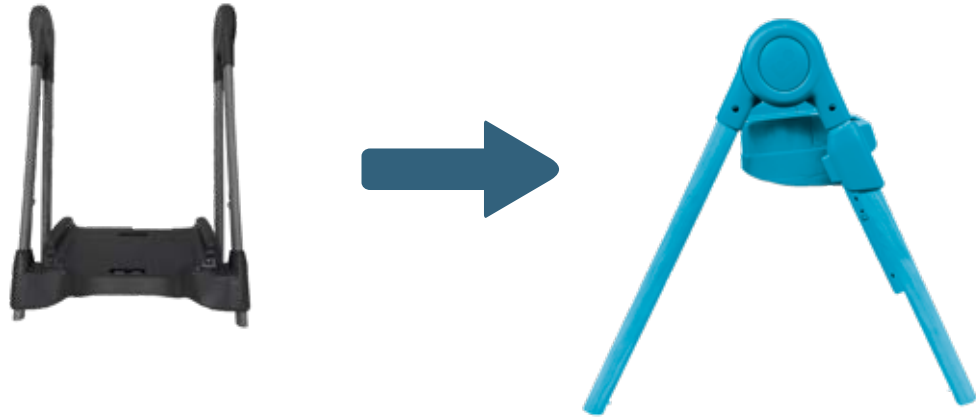

Assembling



2.

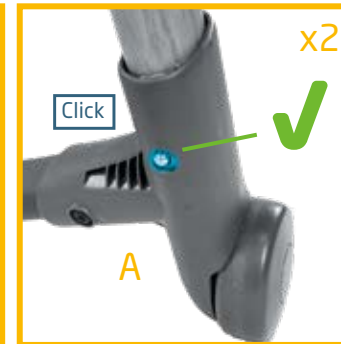
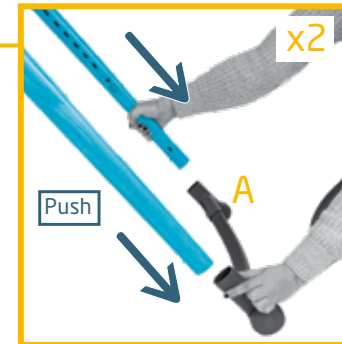
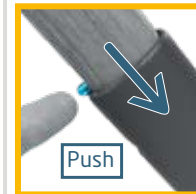
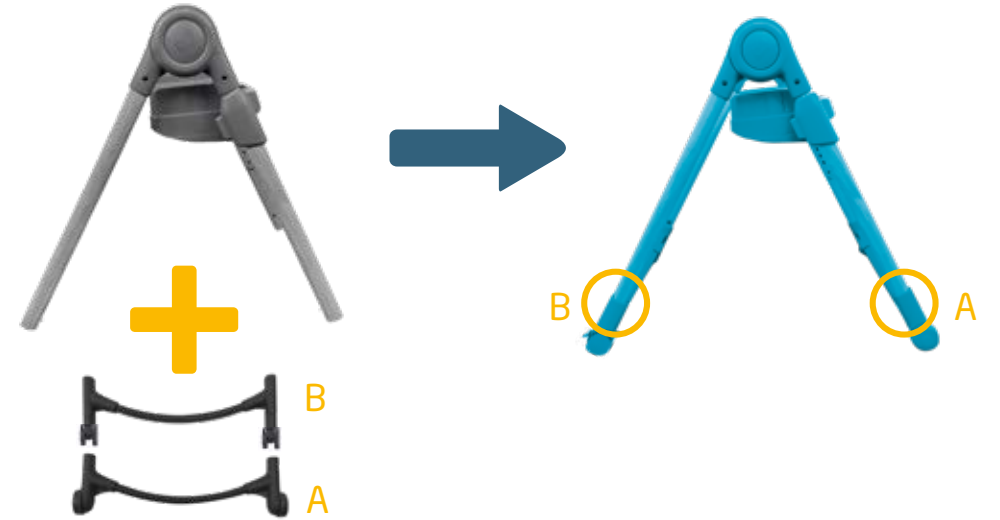



Assembling

3.

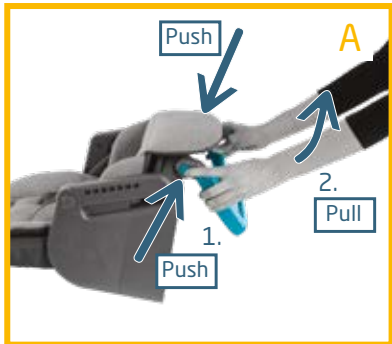
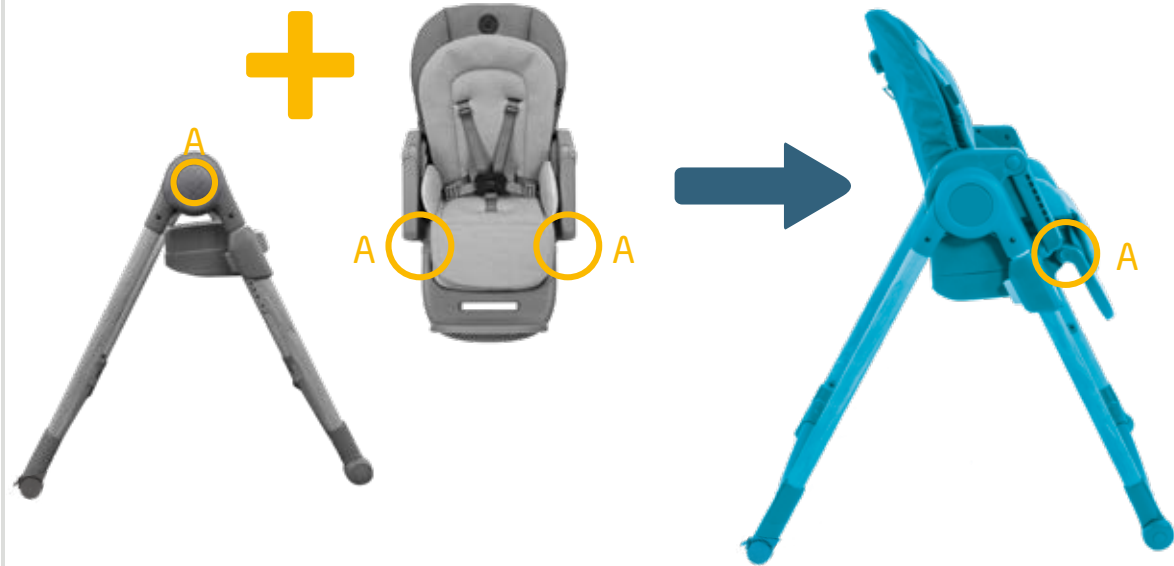

Assembling



4.

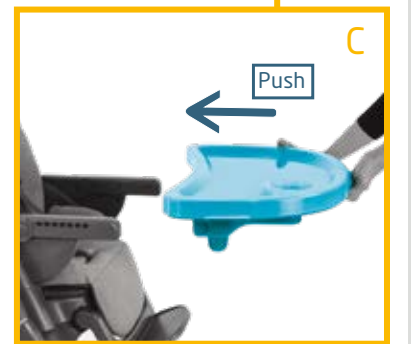
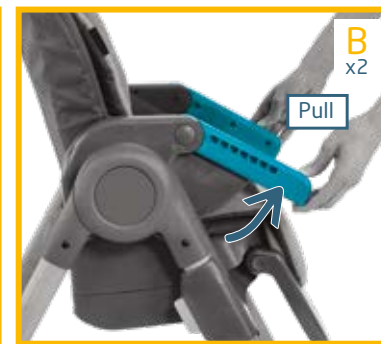
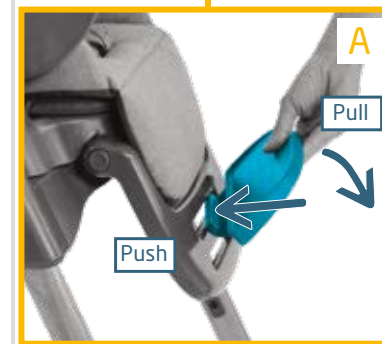
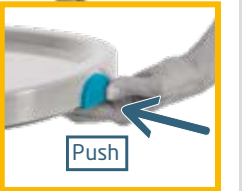
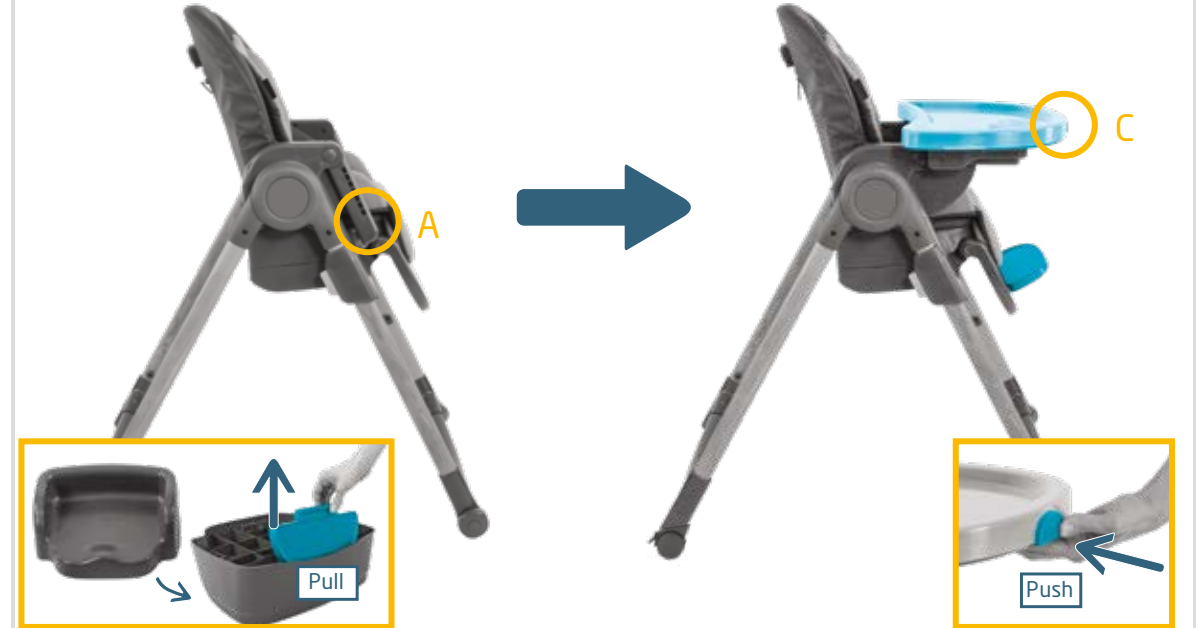



Use

1.

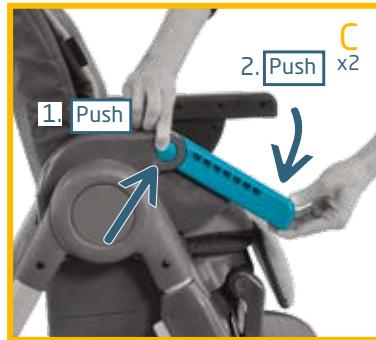
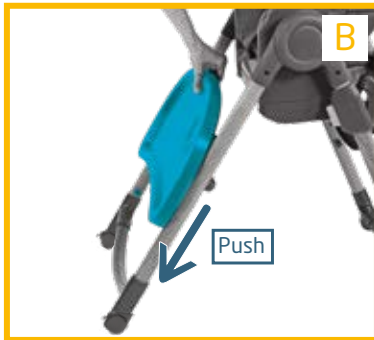
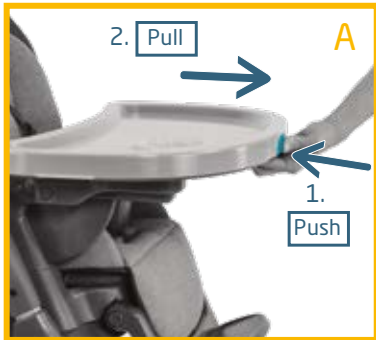
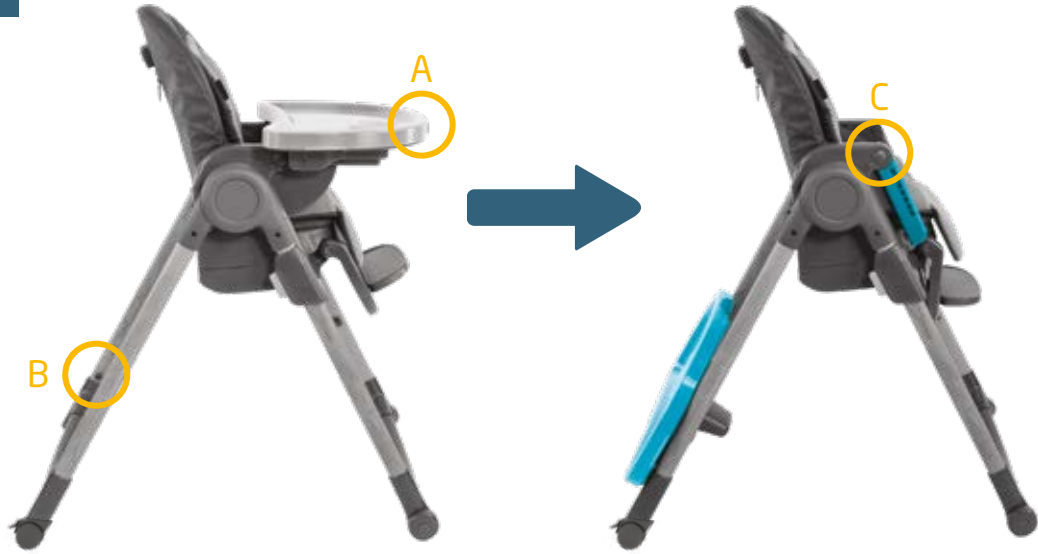

2.

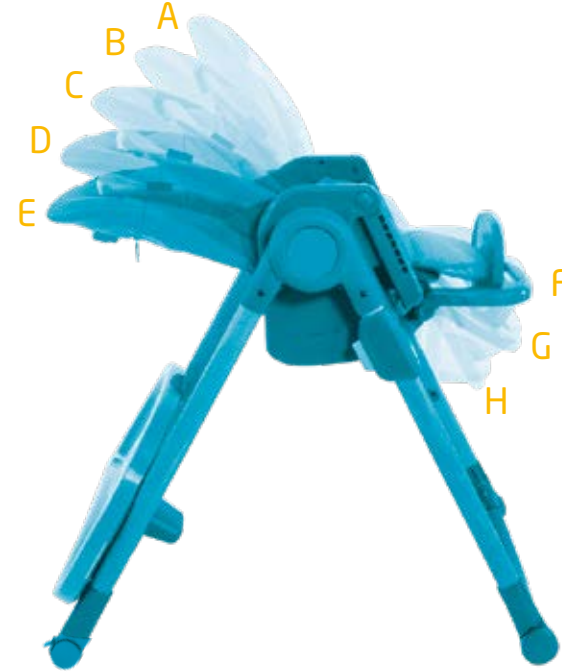

! WARNING

NEVER use high chair in reclined positions, (modes B, C, D, and E) when child is able to sit upright unassisted or weighs more than 20 lb (9.1kg).

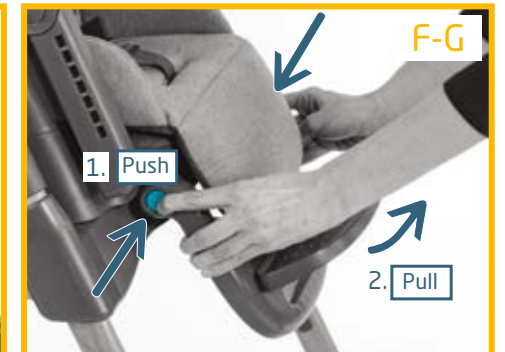
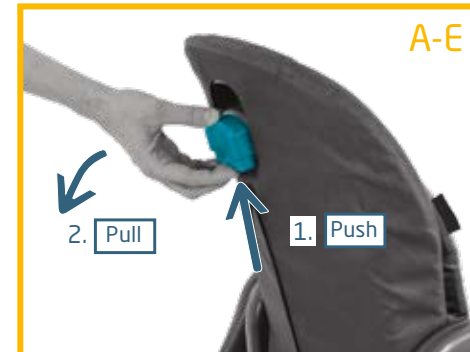



Use

3.

⚠ WARNING

DO NOT adjust seat position with child in it.

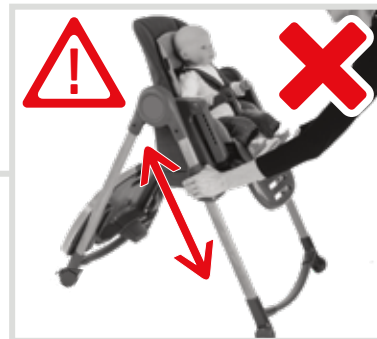
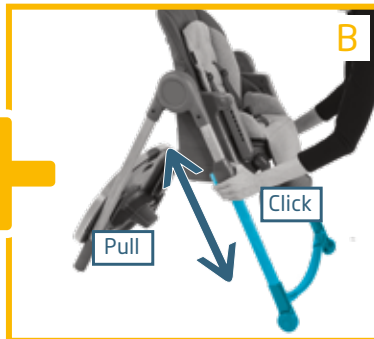
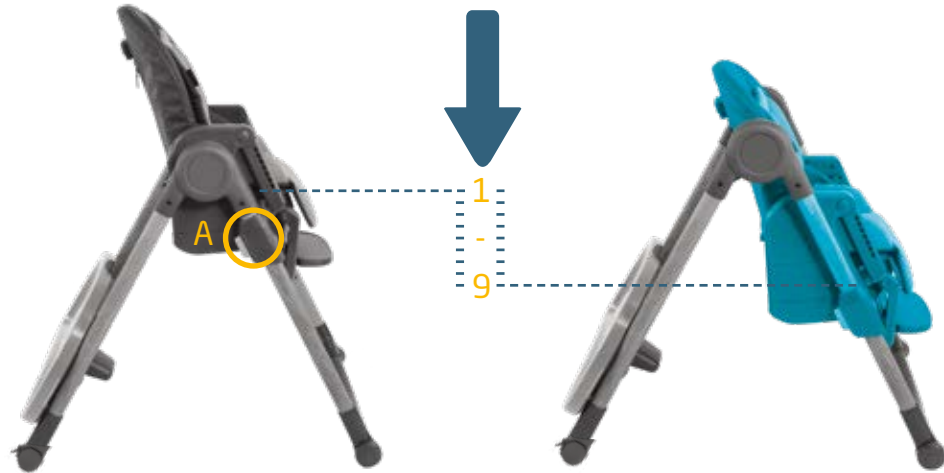

Use



4.

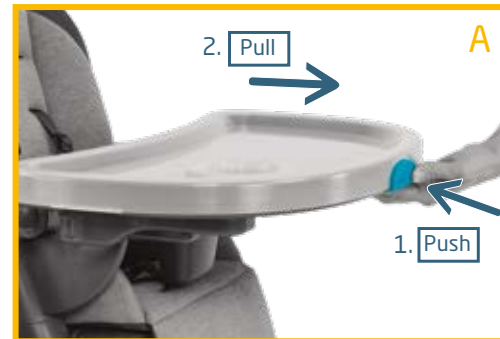
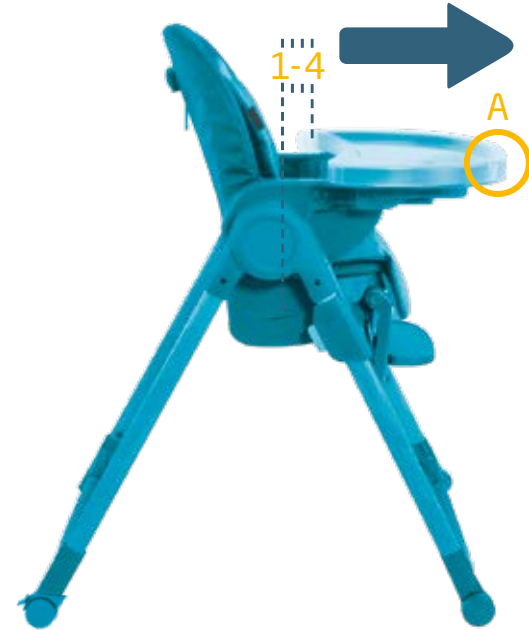



Use

5.

A x2

B x2

C x2

Push

Push

Pull



Use

6.

A

B

C

1. Push

2. Pull

Pull

Pull



Use



Use





Use



Use





Child Installation

⚠ WARNING

- **ALWAYS** secure child in the restraint belt. Adjust to fit snugly.
- **DO NOT** use tray as the only restraint.

Child Installation

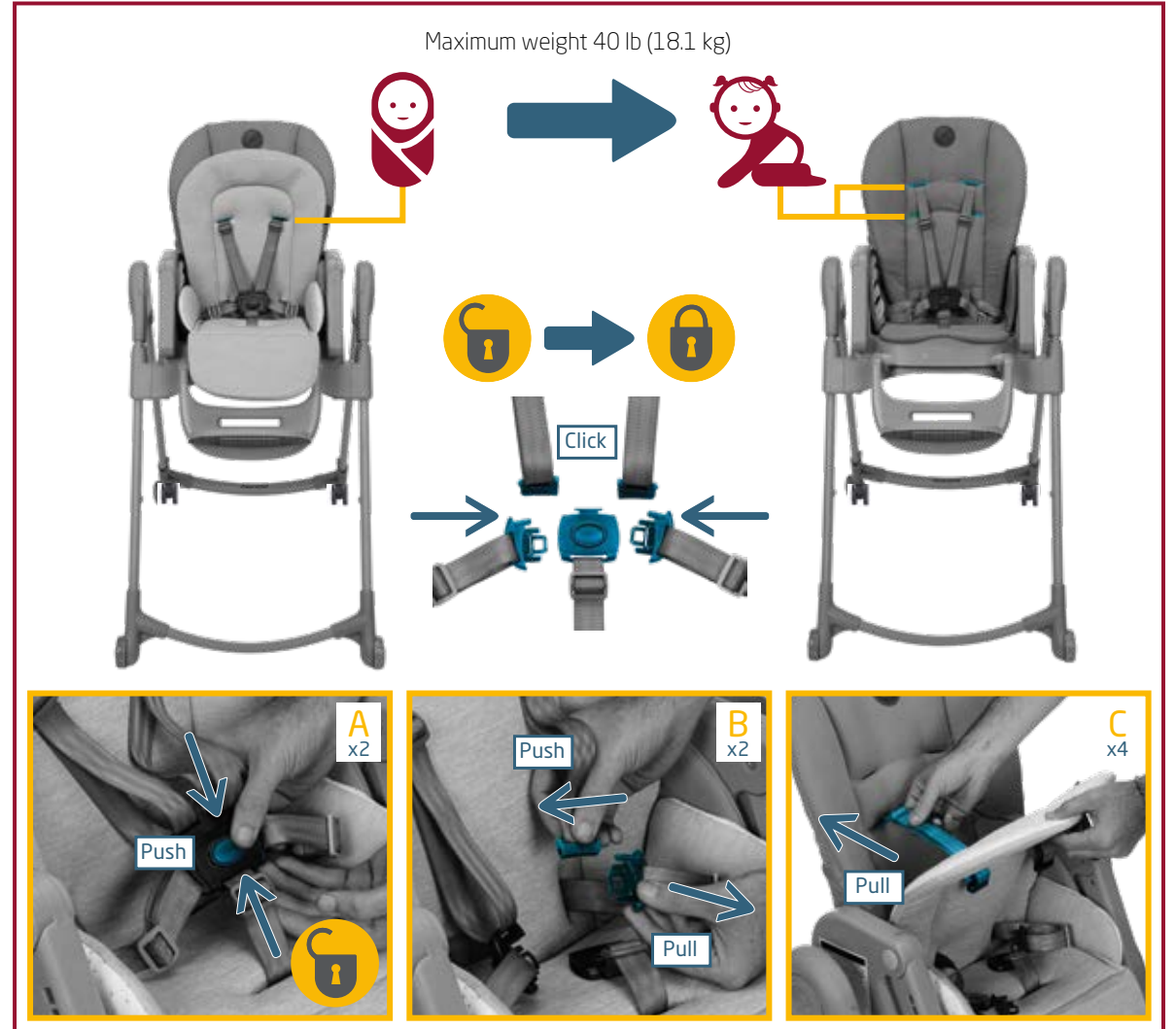



Child Installation

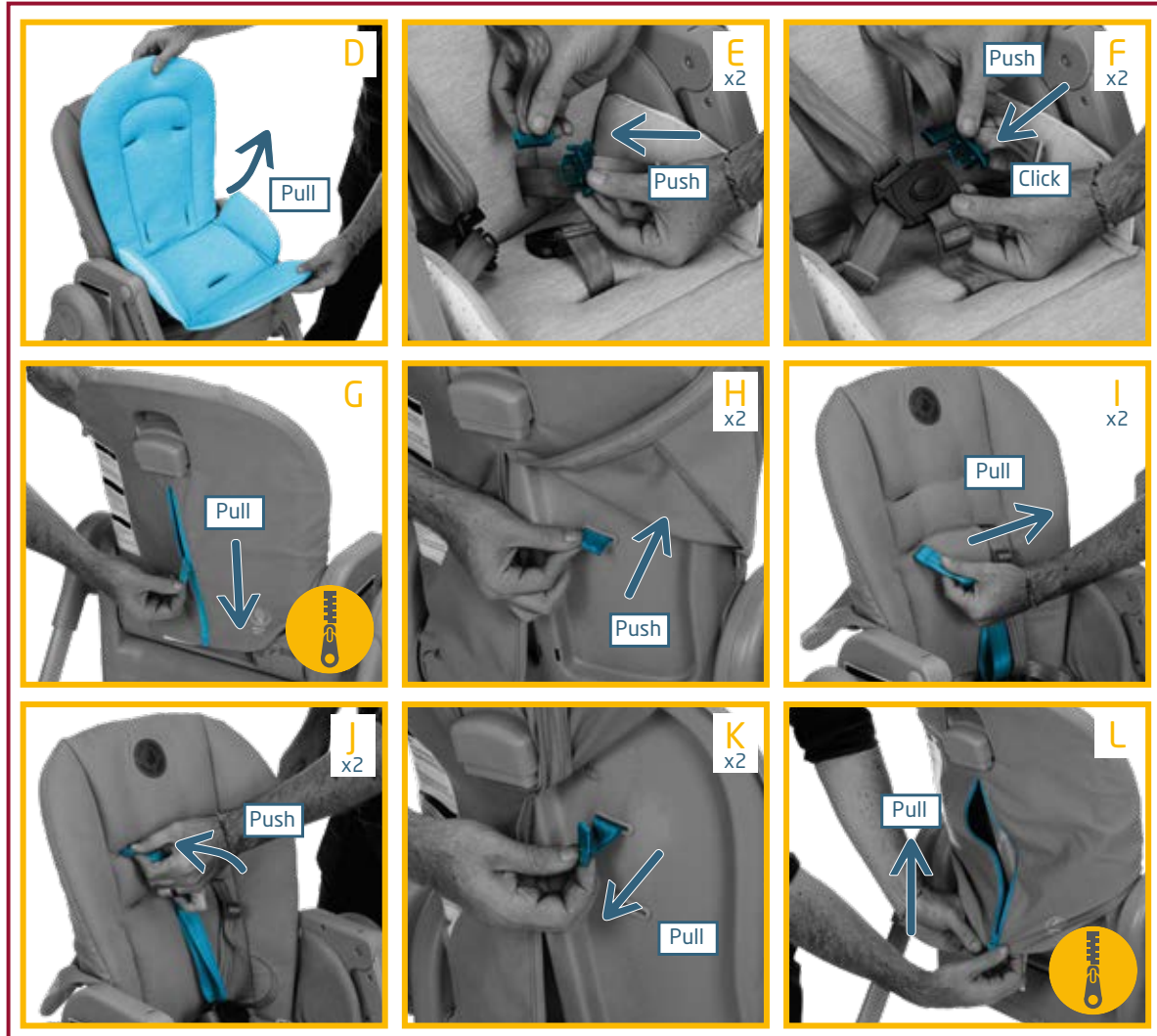

Child Installation





Child Installation

3.



Maximum weight 40 lb (18.1 kg)



4.



Maximum weight 50 lb (22.7 kg)



The chair must be a minimum of:

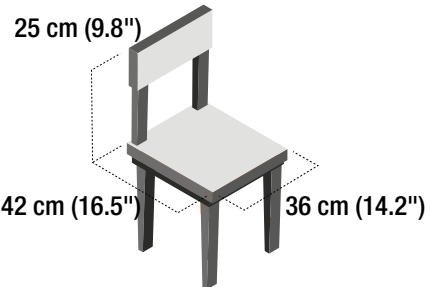

5.



Maximum weight 50 lb (22.7 kg)



The chair must be a minimum of:

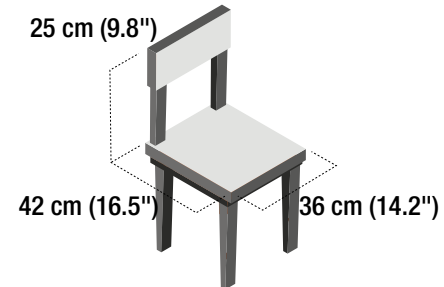

6.



Maximum weight 50 lb (22.7 kg)











Child Installation





Washing

-  Spot clean
-  Hand wash
-  Machine wash, gentle
-  Do not wash
-  Do not bleach
-  Do not tumble dry
-  Do not iron
-  Do not dry clean

Two-Year Limited Warranty

Dorel Juvenile Group, Inc. warrants to the original purchaser that this product (Minla) is free from material and workmanship defects when used under normal conditions for a period of two (2) years from the date of purchase. Should the product contain defects in material or workmanship Dorel Juvenile Group, Inc., will repair or replace the product, at our option, free of charge. Purchaser will be responsible for all costs associated with packaging and shipping the product to Dorel Juvenile Group Consumer Relations Department at the address noted on the front of this document and all other freight or insurance costs associated with the return. Dorel Juvenile Group will bear the cost of shipping the repaired or replaced product to the purchaser. Product should be returned in its original package accompanied by a proof of purchase, either a sales receipt or other proof that the product is within the warranty period. This warranty is void if the owner repairs or modifies the product or the product has been damaged as a result of misuse. This warranty excludes any liability other than that expressly stated previously, including but not limited to, any incidental or consequential damages.

SOME STATES DO NOT ALLOW THE EXCLUSION OR LIMITATION OF INCIDENTAL OR CONSEQUENTIAL DAMAGES, SO THE ABOVE LIMITATION OR EXCLUSION MAY NOT APPLY TO YOU.

THIS WARRANTY GIVES YOU SPECIFIC LEGAL RIGHTS, AND YOU MAY ALSO HAVE OTHER RIGHTS THAT MAY VARY FROM STATE TO STATE.



Minla

©2025 Dorel Juvenile Group, Inc. (800) 544-1108 www.maxicosi.com. Styles and colors may vary. Los estilos y los colores pueden variar. Made in CHINA. Hecho en CHINA. Distributed by (distribuido por) Dorel Juvenile Group, Inc., 2525 State St., Columbus, IN 47201-7494. Dorel Juvenile Canada, 2233 Argentia Road, Suite 110, Mississauga, ON L5N 2X7. Importado y Distribuido en Chile por: DOREL JUVENILE CHILE S.A. - Av. El Retiro 9800, Parque Los Maitenes Sur, Pudahuel, Santiago, Chile - Fono: 56 2 24971500 www.infanti.cl - www.dorel.cl. Importado y distribuido en Perú por: COMEXA COMERCIALIZADORA EXTRANJERA S.A. SUCURSAL DEL PERÚ - Los Libertadores 455, San Isidro, Lima 27, Lima, Perú RUC 20431062870 - Fono: 4413029 - www.infanti.com.pe. En Centro América, Caribe y Ecuador por: Best Brands Group S.A. - Av. Balboa, Bay Mall Plaza, Planta Baja, local 9, Panamá. - Fono: (507) 300 2884. En Colombia por: Baby Universe S.A.S. - Vía 40 No. 77-29, Barranquilla, Colombia - Fono: (575) 353 1110 Importador: DJGM, S.A. DE C.V. Gabriel Mancera No. 1041 Col. Del Valle, Benito Juárez C.P. 03100 México, Ciudad de México R.F.C. DJG140305GN9 Tel. (55) 67199202 05/25 4358-8715



www.maxicosi.com