

REFRIGERATOR

4.6 cu ft

HME030362N

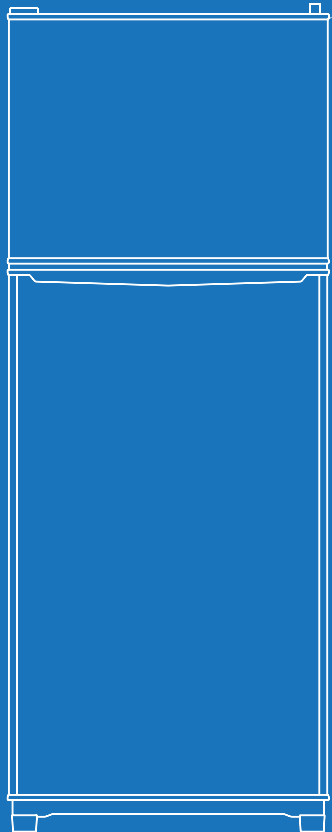

Thank you for selecting our quality appliance. Please be sure to read this user manual carefully before using. Any question, please contact the professional service for help.

BEFORE FIRST USE:

To prevent any internal damage, it is very important to keep refrigeration units (like this one) upright throughout their journey. Please leave it standing upright and outside the box for **24 HOURS** before plugging it in.

TABLE OF CONTENTS

Important Safety Instructions	6-7
Operating Instructions	8-10
Cleaning and Maintenance	11-12
Troubleshooting	13
Specifications	14
Warranty	15
Manufacturing Info	15
Warning	15
Contact Us	15

Congratulations

on bringing home your new appliance!



Don't forget to register your product at homelabs.com/reg for updates, coupons, and other relevant information.

Although greatly appreciated, product registration is not required to activate any warranty.

Important Safety Instructions

SAVE THESE INSTRUCTIONS For Household Use Only

When using your appliance, basic safety precautions should always be followed to reduce the risk of fire, electrical shock, and/or injury to persons. Incorrect operation due to ignoring instructions may cause harm or damage.

1. This appliance must be grounded. Connect only to properly grounded outlet. This appliance must be grounded due to the event of an electrical short circuit. This appliance is equipped with a cord having a grounding wire with a grounding plug. The plug must be plugged into an outlet that is properly installed and grounded.
2. Install or locate this refrigerator only in accordance with the provided Installation Instructions.
3. To protect against electric shock, do not place cord, plug, or refrigerator in water or other liquid.
4. The refrigerant of this product is R600a, which is flammable. Make sure not to damage the cooling system during the transportation and installation.
5. Please note that servicing shall be done by factory authorized service personnel, so as to minimize the risk of possible ignition due to incorrect parts or improper service.
6. This appliance can be used by children aged from 8 years and above and persons with reduced physical, sensory or mental capabilities or lack of experience and knowledge if they have been given supervision or instruction concerning use of the appliance in a safe way and understand the hazards involved. Children shall not play with the appliance. Cleaning and user maintenance shall not be made by children without supervision.

Warnings related to disposal

Suffocation Hazard: Remove doors from your old refrigerator. Failure to do so can result in death or brain damage.

Before you throw away your old refrigerator or freezer.

- Take off the doors;
 - Leave the shelves in place so that children may not easily climb inside.
- All refrigeration products contain refrigerants, which under federal law must be removed prior to product disposal. If you are getting rid of an old refrigeration product, check with a qualified disposal company for instructions.

Warnings related to Electrical Shock Hazard

- Plug into a grounded 3 prong outlet.
- Do not remove ground prong.
- Do not use an adapter.
- Do not use an extension cord.
- Failure to follow these instructions can result in death, fire, or electrical shock.

Three-pronged
(grounding) plug

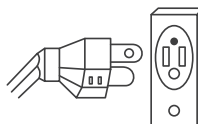

Properly polarized and
grounded outlet

Important Safety Instructions

Location requirements

It is recommended that you do not install the refrigerator near an oven, radiator, or other heat source.

Do not install in a location where the temperature will fall below 55°F (13°C). For best performance, do not install the refrigerator behind a cabinet door.

Warnings related to Explosion Hazard

Keep flammable materials and vapors, such as gasoline away from refrigerator. Failure to do so can result in death, explosion, or fire.

Do not store explosive substances such as aerosol cans with a flammable propellant in this appliance. Do not use electrical appliance inside the food storage compartments of the appliance, unless they are of the type recommended by the manufacture.

Note:

- When there is gas leak, do not pull the plug out or in. It may cause sparks and fire calamities.
- Don't splash water on the rear of the appliance. It may cause malfunction or electric shock.
- Do not place bottled beverage in the freezer. It might break.
- Do not place object on the top of appliance which is magnetic, heavy, or filled with water. Electronic components may not work steadily if water gets inside.



Operating Instructions

PARTS DESCRIPTION

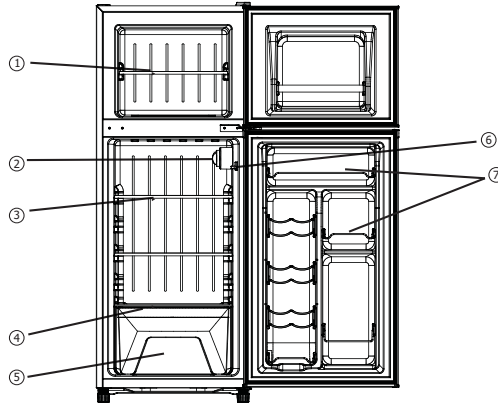

- ① Freezer
- ② Lamp and temperature control knob
- ③ Shelf
- ④ Crisper glass cover
- ⑤ Vegetable crisper
- ⑥ Lamp switch
- ⑦ Door bar

- Remove the tape of the drawers, balconies, egg tray, and the drain tube plug. Clean the inside of the refrigerator.
- Do not pull or push the drawers and balconies fiercely during use to prevent possible damage.
- Do not open the refrigerator door continually if it is in the normal working situation.
- Keep the combination of drawers, baskets and shelves of the refrigerator in its original place.

INSTALLATION

1. Choose a location where it is not exposed to sunlight, heat source or humidity, as humidity may cause stain.
2. Pull out the bottom panel before installation.
3. Make sure the refrigerator is placed in a well-ventilated, indoor environment on flat, sturdy ground (turning the leveling legs clockwise to raise the appliance, and counter-clockwise to lower the appliance). Put a sheet under the appliance to isolate the heat emission if it is located onto a carpet.
4. Make sure the leveling legs are clung to the floor. Set the appliance slope backward slightly to keep the doors closed tightly.

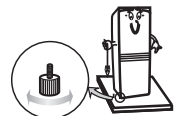
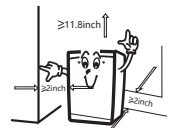

Operating Instructions

REVERSING THE DOOR

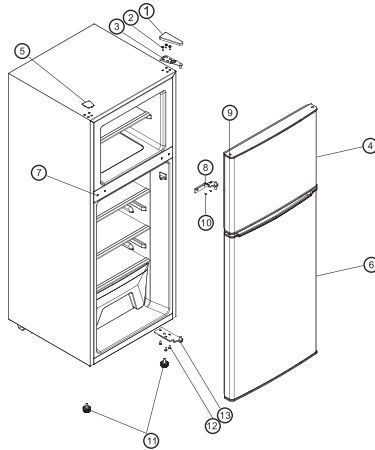

① Top Hinge Cover	⑧ Middle Hinge
② Top Hinge Screws	⑨ Refrigerator Door Plug
③ Top Hinge	⑩ Middle Hinge Screws
④ Freezer Door	⑪ Leveling Legs
⑤ Cabinet Plugs	⑫ Bottom Hinge Screws
⑥ Refrigerator Door	⑬ Bottom Hinge
⑦ Middle Plug	

Follow steps below if you want to change the door orientation:

1. Remove top hinge cover and 3 top hinge screws which are below it. Then remove top hinge.
2. Remove Freezer Door
3. Remove 2 cabinet plugs and 1 door handle plug.
4. Remove middle hinge screws and middle hinge
5. Remove the refrigerator door.
6. Remove right and left leveling legs.
7. Remove 3 bottom hinge screws and the bottom hinge.
8. Install the bottom hinge on the other side of the leveling legs with 3 bottom hinge screws.
9. Install right and left leveling legs. There are two holes below the refrigerator to fit the two leveling legs.
10. Install the refrigerator door.
11. Install the middle hinge on the other side.
12. Install freezer door and fix the top hinge with 3 top hinge screws and fix the top hinge cover.
13. Adjust the leveling legs.

Operating Instructions

PLACEMENT OF FOOD

1. Leave free space between food items inside for proper air circulation.
2. It is recommended to keep fresh food in sealed package to avoid becoming dry or catching odor.
3. Hot food should be cooled down before placing into the appliance. Otherwise, interior temperature and electronic consumption will increase.
4. Reduce the frequency of door opening will efficiently save electronic consumption.

TEMPERATURE CONTROL

The temperature of refrigerator can be controlled manually by the knob. However, the number shown on the knob does not directly represent the temperature. The larger the number, the lower the temperature. 0 stops the cooling but does not turn off the power. Usually, turn the knob to level 4 in a normal condition. Turn to level 5-7 if a lower interior temperature is required. Turn to level 1-3 for a higher temperature.

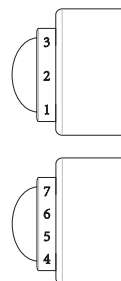

MOVING

WARNING:

Excessive Weight Hazard

Use two or more people to move and install refrigerator. Failure to do so can result in back or other injury.

1. Before using the refrigerator for the first time, remove all of the packing materials, including the foam base and adhesive tape holding accessories in place.
2. The refrigerator should be located on a firm, flat surface that is strong enough to support the refrigerator when it is fully loaded.
3. Leave a minimum of 1/2" between each side of the appliance and the wall. The top and back of the appliance should have a minimum of 1 1/2" clearance. This allows for proper air circulation. This appliance is intended to be free-standing and should not be built-in or placed in a recessed area.
4. The refrigerator legs must be adjusted during installation in order to function properly. The leveling legs on the front corners can be adjusted by turning clockwise to raise the appliance, and counter-clockwise to lower it. Be sure to have the appliance slope slightly backward to ensure that the door closes tightly.

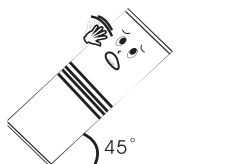

Cleaning and Maintenance

The appliance should be maintained and cleaned frequently. For your safety, pull the plug out of the socket before cleaning.

CLEANING YOUR APPLIANCE

Dusting behind the refrigerator and on the ground will improve the cooling effect and save energy. The interior of the refrigerator should be cleaned to avoid any odor. Follow the cleaning procedure below:

1. Unplug the refrigerator.
2. Wipe the door and door seal with warm water and mild detergent. Rinse thoroughly and dry with a clean, soft cloth.
3. Use a mixture of warm water and baking soda (about 1-2 tablespoons per quart of water) to clean the interior of the refrigerator.
4. Use a sponge or soft cloth and make sure to wipe excess moisture out before cleaning around the controls.
5. Rinse thoroughly with warm water and dry with a clean soft cloth.
6. Reconnect the refrigerator when it is clean and dry.

Note:

Do not use hard brushes, wire brushes, abrasives, organic solvents, boiling water, acid, or alkaline items as this may damage the refrigerator surface and interior. Cleansers such as soap powder, abrasive cleaning powder, alkali cleansers, chemical cloth, thinner, alcohol, acid petroleum product and hot water may damage the painted cover and plastics.

REPLACING INTERIOR LIGHT

To replace interior light, uninstall the cover and replace with a new lamp of 120V/10W. Check following pictures for replacement:

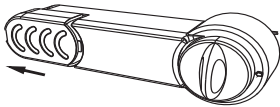

- 1) Slide the lamp cover 1.2-2 inch according to arrow direction.

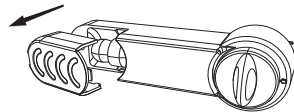

- 2) Take out the lamp cover.

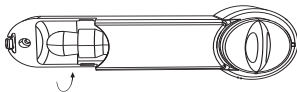

- 3) Rotate and take out the bulb in counterclockwise direction.

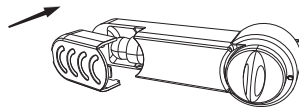

- 4) Replace the bulb and reinstall the lamp cover.

Cleaning and Maintenance

DEFROST

The heavy frost will influence the refrigerating effect and increase the energy consumption. Defrosting is needed when the frost is as thick as 0.2 inch.

For manual defrosting, please follow these steps:

1. Take all the food and ice cube tray out of the compartments.
2. Unplug the refrigerator.
3. Defrosting may take several hours. Open the door to speed up the process.
4. Wipe out the water with dry cloth when defrosting is completed.

WARNING:

Do not use sharp objects to accelerate the defrosting process. It may destroy the compartment walls and cooling system. This will void warranty.

POWER FAILURE

After power failure, the refrigerator is still able to store food for several hours.

1. Discontinuation during power failure
After power failure, do not put additional food in the appliance and reduce the frequency of door opening. Put some ice cubes in a container in the top part of the fridge if the power failure was known beforehand.
2. Discontinuation during vacation
Take out perishable food before short vacation. Close the door firmly. Take out all food and cut off the power during long vacations.
3. Stop using
If you do not want to use the refrigerator for a long time, unplug it and clean up the appliance. The door should be kept open in order to prevent unpleasant smell caused by food residuals.

ATTENTION:

Get rid of the gasket of the door before the disposal. The disposed parts should be handled by professional staff, as it may be harmful to the environment.

WARNING:

1. Do not splash water on the refrigerator, as it will cause oxidation and malfunction. Electronic component such as On/off button should be kept dry.
2. Smear can damage the interior plastic component, so wipe it as soon as possible.

Troubleshooting

Problem	Possible Causes & Solutions
The refrigerator does not work	It may not be connected to the power supply (plug, power cut or fuse); Voltage is too low. Unplug, wait for 10 seconds and plug again. Or consult a professional service provider.
The refrigerator does not work efficiently as expected	It may be caused by heavy frost, or by warm temperature setting, or by frequently door operating. Lower the temperature. Make sure the door is closed.
Vibration noise	The appliance is placed on uneven ground, or by resonance between the appliance and other ambient objects. Adjust the leveling legs, or move away from the object.
The compressor runs too long or cycles on/off frequently	The environment temperature may be too high. The doors may be opened frequently or they are left open. The temperature setting in high level (4-7) can also increase the working time of compressor. Adjust temperature to a warmer setting.
Odor in the refrigerator	Food with strong odor should be packed tightly before putting inside the appliance. Check whether there is any deteriorated food or whether the liners are left dirty for a long time.
Heavy frost occurs on the rear of the appliance	Putting humid or hot food into the appliance may cause this problem.
Water leaks from the bottom of the refrigerator	The drain tube is jammed. Use a proper tool to clean it.

It is normal that:

- Moisture may form dew on the outside of the product during the humid season.
- The sides of product get warm as a result of the cooling pipeline working.
- The flow of refrigerant through the coils causes noise.

If the supply cord is damaged, it must be replaced by the manufacturer, its service agent or similarly qualified persons in order to avoid a hazard.

Specifications

Climate class		N/ST
Electric shock protection type		I
Voltage (V)		120
Frequency (Hz)		60
Current (A)		0.96
Voice [dB(A)]		≤42
Energy consumption (kW.h/24 hours)		0.89
Refrigerant		R600a/1.06oz
Net Weight (lbs)		70.4
Interior temperature (°F)	Freezer	≤5
	Refrigerator	32~46.4
Dimension (inch)	Width	19.13
	Depth	21.61
	Height	48.09

Warranty

hOme™ offers a limited two-year warranty (“warranty period”) on all of our products purchased new and unused from hOme Technologies, LLC or an authorized reseller, with an original proof of purchase and where a defect has arisen, wholly or substantially, as a result of faulty manufacture, parts or workmanship during the warranty period. The warranty does not apply where damage is caused by other factors, including without limitation: (a) normal wear and tear; (b) abuse, mishandling, accident, or failure to follow operating instructions; (c) exposure to liquid or infiltration of foreign particles; (d) servicing or modifications of the product other than by hOme™; (e) commercial or non-household use.

The hOme™ warranty covers all costs related to restoring the proven defective product through repair or replacement of any defective part and necessary labor so that it conforms to its original specifications. A replacement product may be provided instead of repairing a defective product. hOme™’s exclusive obligation under this warranty is limited to such repair or replacement.

A receipt indicating the purchase date is required for any claim, so please keep all receipts in a safe place. We recommend that you register your product on our website, homelabs.com/reg. Although greatly appreciated, the product registration is not required to activate any warranty and product registration does not eliminate the need for the original proof of purchase. The warranty becomes void if attempts at repair are made by non-authorized third parties and/or if spare parts, other than those provided by hOme™, are used. You may also arrange for service after the warranty expires at an additional cost.

These are our general terms for warranty service, but we always urge our customers to reach out to us with any issue, regardless of warranty terms. If you have an issue with a hOme™ product, please contact us at 1-800-898-3002, and we will do our best to resolve it for you.

This warranty gives you specific legal rights, and you may have other legal rights which vary from state to state, country to country or province to province. The customer may assert any such rights at their sole discretion.

Manufacturing Info

This manual is to be used with all items with the model number

HME030362N

SKU# : HME030362N

Rated voltage/Frequency: 120V~ 60Hz 0.96A

Warning

Keep all plastic bags away from children.

Contact Us

 CHAT WITH US

homelabs.com/chat

 CALL US

1-(800)-898-3002

 EMAIL US

help@homelabs.com



For household
Use Only

1-800-898-3002
help@homelabs.com
homelabs.com/help

© 2016 hOme Technologies, LLC
37 East 18 Street, 7th Floor
New York, NY 10003

All rights reserved. hOme®. Printed in China.

