



Introduction in English1

Introduction in German7

Introduction in Japanese13

Introduction in Korean19

Data Measurement25

USB Driver Installation26

ASIO Plug-in Installation30

Footar2000 Settings31

Frequently Asked Questions33

Cautions & Contact39

Q: What's the function of VU meter? What is the difference between VU meter and volume meter, anyway?

A: VU meter, volume meter and amplifier all refer to a level indication meter. Some indicate voltage, some indicate decibels, some indicate current. The P1PLUS uses VU meter to indicate the level of audio signal.

Cautions

- Don't open the case without permission. Improper operation may cause electric shock.
- Don't play of output tubes during TV use, otherwise the tubes in P1PLUS will be damaged.
- Please don't replace mismatched tube models, otherwise the tubes and P1PLUS will be damaged.
- Please use the regular manufacturer's switching power supply. Poor quality power adapters may result in noise or failure to P1PLUS.
- Don't put P1PLUS in the environment of high temperature or high humidity.

Contact information

Website: www.doukaudio.com
 Email: doukaudio@foxmail.com
 WeChat/WhatsApp: qq-1119436202
 Address: Room 1129, Wang Chong Building, Long Guan East Road, Long Hui District, Shen Zhen, Guangdong, China, 518000

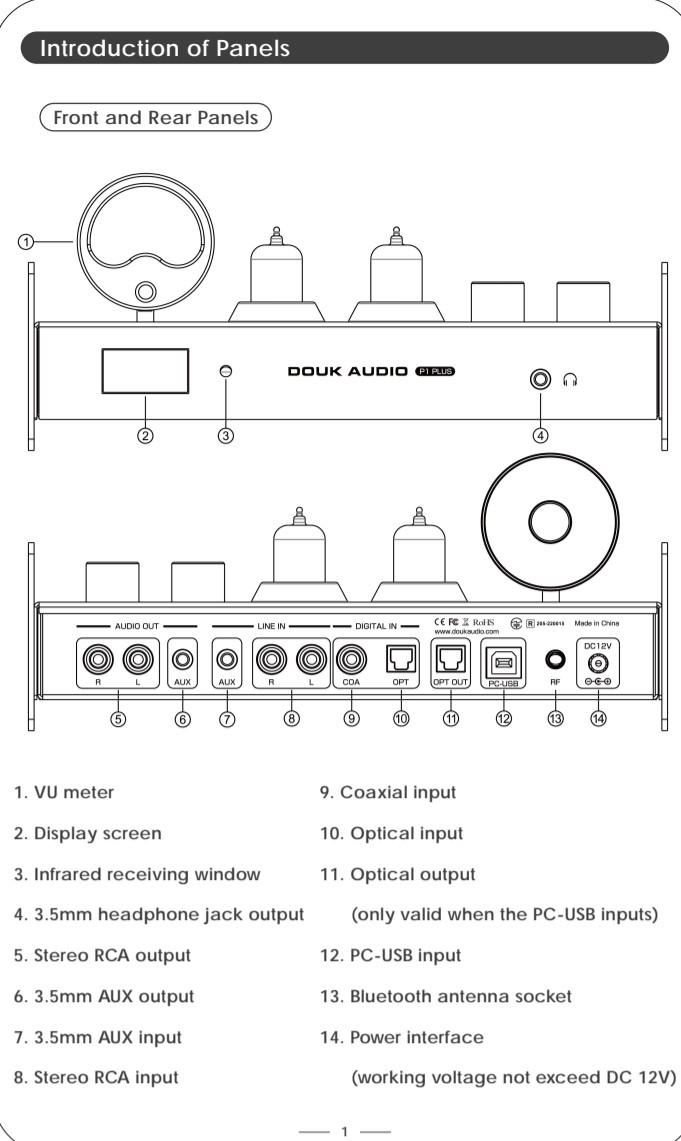

off. As the internal capacitors will be discharged for a while after shutdown, I am of the preamp first and then turn off amplifier, impact sound will be easily caused which may damage the amplifier or speaker.

Q: Why does the volume of different audio sources/each changing CD player to phonos) differ the volume of the P1PLUS unchanged?

A: Different audio devices can output different signal amplitudes, for example, the phone usually is 0.20V while CD player is 1V.

Q: Why is there a start sound when the volume is turned up to the maximum without installing the tubes?

A: Preamp is an audio signal amplification, other components such as capacitors or resistors will add produce a weak signal coupling although no tubes are plugged in. Please install the tube correctly before use.

Q: How long is the service life of vacuum tube? Can I replace them by long press turn off?

A: The service life of the vacuum tubes is about 4000-4500 hours, they are not easy to break as long as not damaged by external forces. Before replacing, please confirm the model that can be replaced.

Q: The P1PLUS is the commonly used vacuum tubes can be replaced by what model?

A: Commonly the tubes of P1PLUS can be replaced by: 6X1, 6X2, 6X3, 6X4, 6X5, 6X6, 6X7, 6X8, 6X9, 6X10, 6X11, 6X12, 6X13, 6X14, 6X15, 6X16, 6X17, 6X18, 6X19, 6X20, 6X21, 6X22, 6X23, 6X24, 6X25, 6X26, 6X27, 6X28, 6X29, 6X30, 6X31, 6X32, 6X33, 6X34, 6X35, 6X36, 6X37, 6X38, 6X39, 6X40, 6X41, 6X42, 6X43, 6X44, 6X45, 6X46, 6X47, 6X48, 6X49, 6X50, 6X51, 6X52, 6X53, 6X54, 6X55, 6X56, 6X57, 6X58, 6X59, 6X60, 6X61, 6X62, 6X63, 6X64, 6X65, 6X66, 6X67, 6X68, 6X69, 6X70, 6X71, 6X72, 6X73, 6X74, 6X75, 6X76, 6X77, 6X78, 6X79, 6X80, 6X81, 6X82, 6X83, 6X84, 6X85, 6X86, 6X87, 6X88, 6X89, 6X90, 6X91, 6X92, 6X93, 6X94, 6X95, 6X96, 6X97, 6X98, 6X99, 6X100.

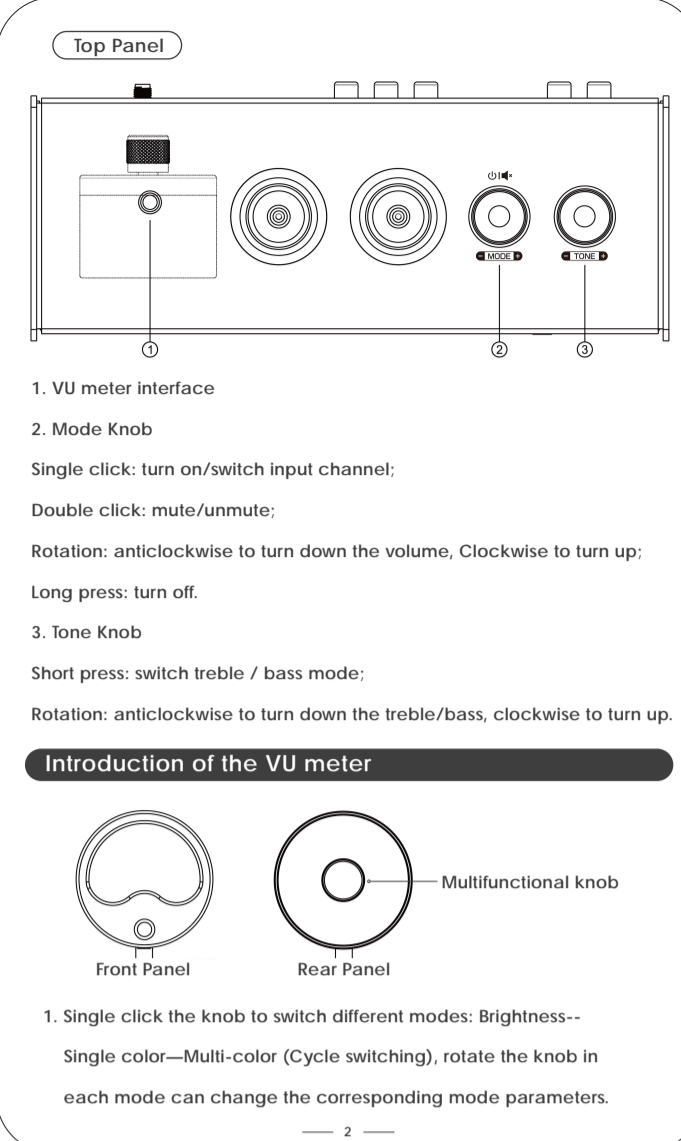

Q: There is no sound output when browsing webpage video, but the FOOTAR play is normal.

A: Please close the Bluetooth antenna to install correctly. Make sure check whether the Bluetooth antenna is installed correctly. If there is no sound output when optical and coaxial inputs are used? (The color of the VU meter will change automatically.) In this mode, rotate the knob to adjust the color change speed.

Introduction of the OLED Display Screen

- Input channel (USB/Ethernet/COAX/OPT/RC/AUX)
- Gain (0-99)
- Sampling rate (Display when no signal input)
- Volume progress bar
- tone
- Gain

Introduction of the remote control

- Turn on/off
- Input selection
- Volume
- Gain
- Mode
- Short press: switch left / Bass mode
- Long press: turn off

Q: The sample rate displayed on the product is the real-time sample rate of the playback device. If not match, please switch the output sample rate.

Q: Why is there no sound output when optical and coaxial inputs are used? (The color of the VU meter will change automatically.) In this mode, rotate the knob to adjust the color change speed.

Warm Tips

- ASIO analog audio outputs will work at the same time no matter what audio input is selected. While the optical output will only work when PC-USB inputs.
- Only USB input supports PCM 384KHz/220Hz DSD256, coaxial and optical inputs only support PCM 192KHz/220Hz at the highest.
- For best PC-USB only can be recognized when the driver is installed. For other systems, the driver is only required when playing DSD files.
- P1PLUS is designed with pluggable tube sockets, default comes with JAN8454 tubes. Can be replaced by 6X1, 6X2, 6X3, 6X4, 6X5, 6X6, 6X7, 6X8, 6X9, 6X10, 6X11, 6X12, 6X13, 6X14, 6X15, 6X16, 6X17, 6X18, 6X19, 6X20, 6X21, 6X22, 6X23, 6X24, 6X25, 6X26, 6X27, 6X28, 6X29, 6X30, 6X31, 6X32, 6X33, 6X34, 6X35, 6X36, 6X37, 6X38, 6X39, 6X40, 6X41, 6X42, 6X43, 6X44, 6X45, 6X46, 6X47, 6X48, 6X49, 6X50, 6X51, 6X52, 6X53, 6X54, 6X55, 6X56, 6X57, 6X58, 6X59, 6X60, 6X61, 6X62, 6X63, 6X64, 6X65, 6X66, 6X67, 6X68, 6X69, 6X70, 6X71, 6X72, 6X73, 6X74, 6X75, 6X76, 6X77, 6X78, 6X79, 6X80, 6X81, 6X82, 6X83, 6X84, 6X85, 6X86, 6X87, 6X88, 6X89, 6X90, 6X91, 6X92, 6X93, 6X94, 6X95, 6X96, 6X97, 6X98, 6X99, 6X100.

Q: Why is there no sound output when browsing webpage video, but the FOOTAR play is normal.

A: Please close the Bluetooth antenna to install correctly. Make sure check whether the Bluetooth antenna is installed correctly. If there is no sound output when optical and coaxial inputs are used? (The color of the VU meter will change automatically.) In this mode, rotate the knob to adjust the color change speed.

Warm Tips

- ASIO analog audio outputs will work at the same time no matter what audio input is selected. While the optical output will only work when PC-USB inputs.
- Only USB input supports PCM 384KHz/220Hz DSD256, coaxial and optical inputs only support PCM 192KHz/220Hz at the highest.
- For best PC-USB only can be recognized when the driver is installed. For other systems, the driver is only required when playing DSD files.
- P1PLUS is designed with pluggable tube sockets, default comes with JAN8454 tubes. Can be replaced by 6X1, 6X2, 6X3, 6X4, 6X5, 6X6, 6X7, 6X8, 6X9, 6X10, 6X11, 6X12, 6X13, 6X14, 6X15, 6X16, 6X17, 6X18, 6X19, 6X20, 6X21, 6X22, 6X23, 6X24, 6X25, 6X26, 6X27, 6X28, 6X29, 6X30, 6X31, 6X32, 6X33, 6X34, 6X35, 6X36, 6X37, 6X38, 6X39, 6X40, 6X41, 6X42, 6X43, 6X44, 6X45, 6X46, 6X47, 6X48, 6X49, 6X50, 6X51, 6X52, 6X53, 6X54, 6X55, 6X56, 6X57, 6X58, 6X59, 6X60, 6X61, 6X62, 6X63, 6X64, 6X65, 6X66, 6X67, 6X68, 6X69, 6X70, 6X71, 6X72, 6X73, 6X74, 6X75, 6X76, 6X77, 6X78, 6X79, 6X80, 6X81, 6X82, 6X83, 6X84, 6X85, 6X86, 6X87, 6X88, 6X89, 6X90, 6X91, 6X92, 6X93, 6X94, 6X95, 6X96, 6X97, 6X98, 6X99, 6X100.

Q: Why is there no sound output when browsing webpage video, but the FOOTAR play is normal.

A: Please close the Bluetooth antenna to install correctly. Make sure check whether the Bluetooth antenna is installed correctly. If there is no sound output when optical and coaxial inputs are used? (The color of the VU meter will change automatically.) In this mode, rotate the knob to adjust the color change speed.

Warm Tips

- ASIO analog audio outputs will work at the same time no matter what audio input is selected. While the optical output will only work when PC-USB inputs.
- Only USB input supports PCM 384KHz/220Hz DSD256, coaxial and optical inputs only support PCM 192KHz/220Hz at the highest.
- For best PC-USB only can be recognized when the driver is installed. For other systems, the driver is only required when playing DSD files.
- P1PLUS is designed with pluggable tube sockets, default comes with JAN8454 tubes. Can be replaced by 6X1, 6X2, 6X3, 6X4, 6X5, 6X6, 6X7, 6X8, 6X9, 6X10, 6X11, 6X12, 6X13, 6X14, 6X15, 6X16, 6X17, 6X18, 6X19, 6X20, 6X21, 6X22, 6X23, 6X24, 6X25, 6X26, 6X27, 6X28, 6X29, 6X30, 6X31, 6X32, 6X33, 6X34, 6X35, 6X36, 6X37, 6X38, 6X39, 6X40, 6X41, 6X42, 6X43, 6X44, 6X45, 6X46, 6X47, 6X48, 6X49, 6X50, 6X51, 6X52, 6X53, 6X54, 6X55, 6X56, 6X57, 6X58, 6X59, 6X60, 6X61, 6X62, 6X63, 6X64, 6X65, 6X66, 6X67, 6X68, 6X69, 6X70, 6X71, 6X72, 6X73, 6X74, 6X75, 6X76, 6X77, 6X78, 6X79, 6X80, 6X81, 6X82, 6X83, 6X84, 6X85, 6X86, 6X87, 6X88, 6X89, 6X90, 6X91, 6X92, 6X93, 6X94, 6X95, 6X96, 6X97, 6X98, 6X99, 6X100.

Q: Why is there no sound output when browsing webpage video, but the FOOTAR play is normal.

A: Please close the Bluetooth antenna to install correctly. Make sure check whether the Bluetooth antenna is installed correctly. If there is no sound output when optical and coaxial inputs are used? (The color of the VU meter will change automatically.) In this mode, rotate the knob to adjust the color change speed.

Warm Tips

- ASIO analog audio outputs will work at the same time no matter what audio input is selected. While the optical output will only work when PC-USB inputs.
- Only USB input supports PCM 384KHz/220Hz DSD256, coaxial and optical inputs only support PCM 192KHz/220Hz at the highest.
- For best PC-USB only can be recognized when the driver is installed. For other systems, the driver is only required when playing DSD files.
- P1PLUS is designed with pluggable tube sockets, default comes with JAN8454 tubes. Can be replaced by 6X1, 6X2, 6X3, 6X4, 6X5, 6X6, 6X7, 6X8, 6X9, 6X10, 6X11, 6X12, 6X13, 6X14, 6X15, 6X16, 6X17, 6X18, 6X19, 6X20, 6X21, 6X22, 6X23, 6X24, 6X25, 6X26, 6X27, 6X28, 6X29, 6X30, 6X31, 6X32, 6X33, 6X34, 6X35, 6X36, 6X37, 6X38, 6X39, 6X40, 6X41, 6X42, 6X43, 6X44, 6X45, 6X46, 6X47, 6X48, 6X49, 6X50, 6X51, 6X52, 6X53, 6X54, 6X55, 6X56, 6X57, 6X58, 6X59, 6X60, 6X61, 6X62, 6X63, 6X64, 6X65, 6X66, 6X67, 6X68, 6X69, 6X70, 6X71, 6X72, 6X73, 6X74, 6X75, 6X76, 6X77, 6X78, 6X79, 6X80, 6X81, 6X82, 6X83, 6X84, 6X85, 6X86, 6X87, 6X88, 6X89, 6X90, 6X91, 6X92, 6X93, 6X94, 6X95, 6X96, 6X97, 6X98, 6X99, 6X100.

Specifications

Brand	Douk Audio
Model	P1PLUS
Audio Input	Bluetooth / PC-USB Coaxial / Optical / Stereo RCA / 3.5mm AUX / Coaxial/Optical supported
Audio output	Digital / Stereo RCA / 3.5mm AUX / 3.5mm headphone jack
Chipset	CS5323-568137L / ES9018K2M-TPA612B
Max. Sampling rate USB supported	PCM 384KHz/220Hz / DSD256
Max. Sampling rate Coaxial/Optical supported	PCM 192KHz/220Hz
PC-USB supported	W7 / W8 / W16 / MAC / Linux
Bluetooth version	5.1 (Support APTX/PTX/LL/ACC)
Frequency response	20Hz-20KHz(±0.8dB)
THD	<±0.01%
SNR	>100dB
Input sensitivity	600mV
Output power	2W
Maximum impedance of headphones	16-600Ω
Output power of headphone jack	100mW
Working voltage	DC 12V (±1.5A)
Net weight	95g / 2.98oz
Dimensions(W*H*D)	120*60*30mm / 4.72*2.36*1.18in
Package weight	140g / 3.25oz
Package dimensions(W*H*D)	160*200*100mm / 7.87*7.87*3.94in

2. Check whether the device from P1PLUS is amplifier/speaker or headphone are connected correctly the volume of them is in the minimum state or not.

3. If the above are all normal, please check whether the input signal of audio source is muted, paused, or the volume is in the minimum state or not?

Q: Why is the sound distorted?

A: P1PLUS with preamplification function. Distortion usually occurs when the volume of audio source, P1PLUS and the amplifier/speaker are adjusted to the maximum state, but turn down the volume of one of them. In general, adjust the volume of amplifier to about 60%, then turn-down the volume of preamp (distortion will be greatly reduced in this way).

Q: Why is there a faint current sound or buzzing sound on the speaker?

A: 1. Please use the original power supply. Many power supplies in the market have interference, which will cause current sound.

2. When using unshielded signal cable in the three loudspeakers, there will be interference signals. Please use the shielded signal cable or unplug them.

3. If there is still noise after eliminating above situation, please confirm whether it is external noise or internal noise. Disconnect all input and only retain power supply and power cable. If the noise disappears, it is from audio input; if the noise is still there, it is probably distributed by power supply or generated by the internal of product.

Q: Why Bluetooth cannot be searched? How to switch to Bluetooth mode?

A: 1. Brightness and color of the VU meter should be pressed "SELECT" button on remote control to switch to BT mode. There will be BT flashing in the screen, then use your phone to install to search for "Douk Audio P1PLUS", click and connect it, then play music.

Operation Steps

- Install the equipped vacuum tubes into the tube sockets, before insertion please align the pins to tube to be defined or not. (Please check whether the tube pins are the hollow or solid.)
- Connect audio output.
- Connect audio input.
- Please connect the audio source or other devices to the input of the P1PLUS, and then plug it to the wall socket.
- If you want to use Bluetooth input, please do it after the 5th step.
- Connect the power amplifier or active speaker to the RCA or 3.5mm AUX output of the P1PLUS, and then plug the headphone into its 3.5mm headphone jack output.
- Turn on the power.
- Adjust the volume of amplifier and high-quality audio cable.
- When using unshielded signal cable in the three loudspeakers, there will be interference signals. Please use the shielded signal cable or unplug them.
- If there is still noise after eliminating above situation, please confirm whether it is external noise or internal noise. Disconnect all input and only retain power supply and power cable. If the noise disappears, it is from audio input; if the noise is still there, it is probably distributed by power supply or generated by the internal of product.
- Short press the Mode Knob to enter the bass mode, and then rotate to adjust the bass / treble or volume knob to turn down and clockwise to turn up. The volume also can be adjusted by pressing the volume button +/- on the remote control.
- Short press the Mode Knob to enter the bass mode, and then rotate to adjust the bass / treble or volume knob to turn down and clockwise to turn up. The volume also can be adjusted by pressing the volume button +/- on the remote control.
- Brightness and color of the VU meter should be pressed "SELECT" button on remote control to switch to BT mode. There will be BT flashing in the screen, then use your phone to install to search for "Douk Audio P1PLUS", click and connect it, then play music.

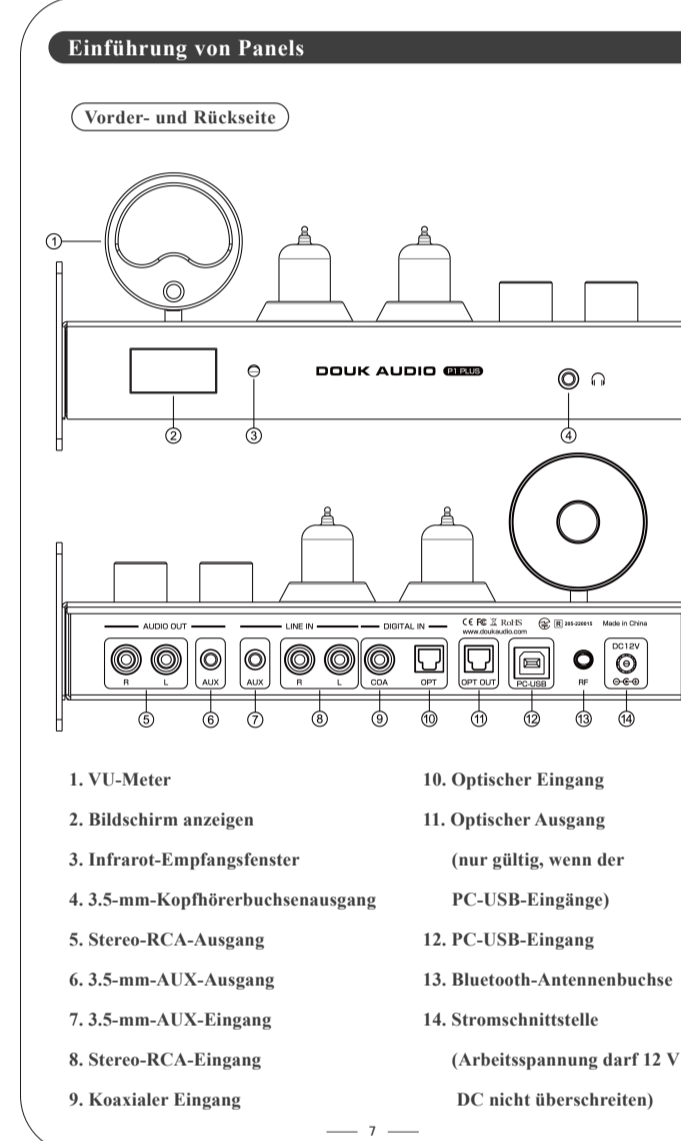
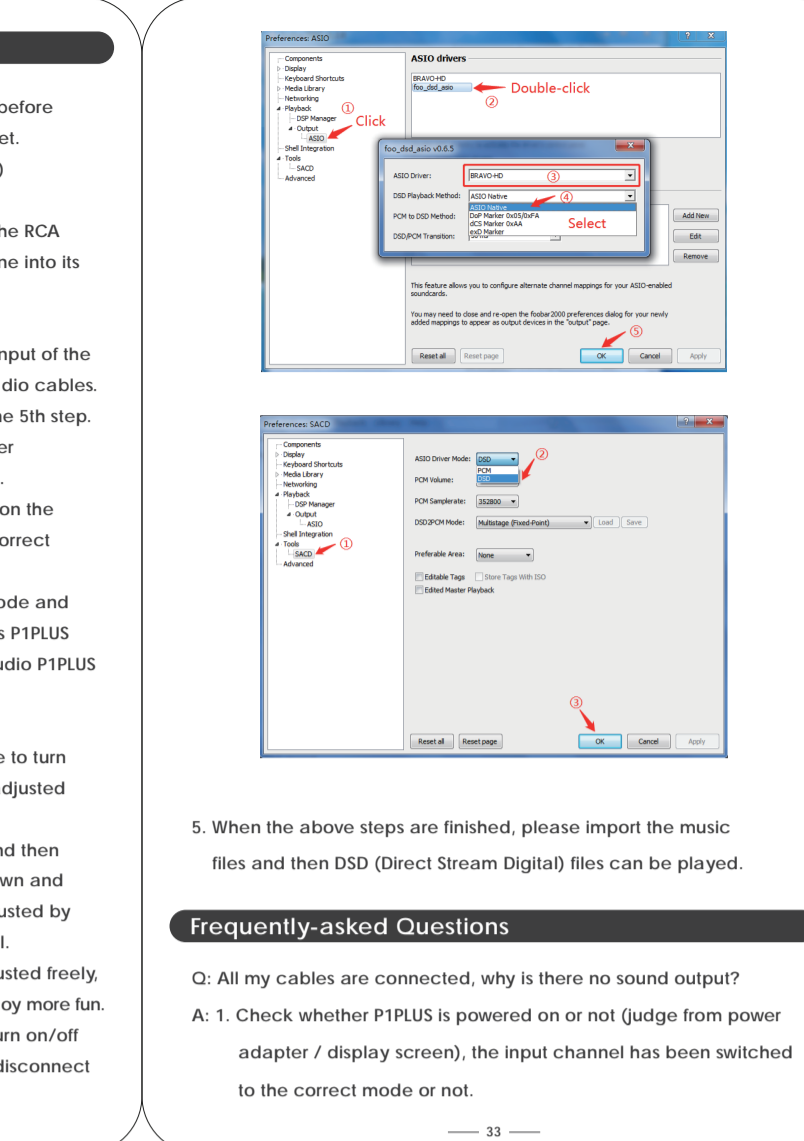

Q: What's the function of VU meter? What is the difference between VU meter and volume meter, anyway?

A: VU meter, volume meter and amplifier all refer to a level indication meter. Some indicate voltage, some indicate decibels, some indicate current. The P1PLUS uses VU meter to indicate the level of audio signal.

Cautions

- Don't open the case without permission. Improper operation may cause electric shock.
- Don't play of output tubes during TV use, otherwise the tubes in P1PLUS will be damaged.
- Please don't replace mismatched tube models, otherwise the tubes and P1PLUS will be damaged.
- Please use the regular manufacturer's switching power supply. Poor quality power adapters may result in noise or failure to P1PLUS.
- Don't put P1PLUS in the environment of high temperature or high humidity.

Contact information

Website: www.doukaudio.com
 Email: doukaudio@foxmail.com
 WeChat/WhatsApp: qq-1119436202
 Address: Room 1129, Wang Chong Building, Long Guan East Road, Long Hui District, Shen Zhen, Guangdong, China, 518000

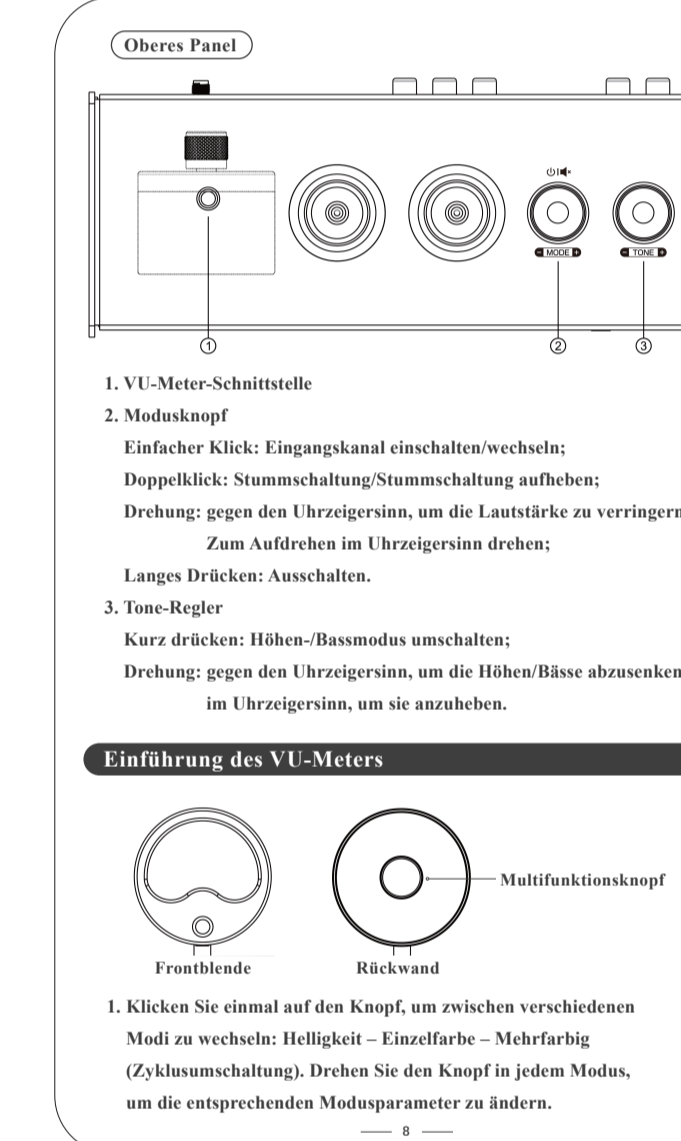

Q: There is no sound output when browsing webpage video, but the FOOTAR play is normal.

A: Please close the Bluetooth antenna to install correctly. Make sure check whether the Bluetooth antenna is installed correctly. If there is no sound output when optical and coaxial inputs are used? (The color of the VU meter will change automatically.) In this mode, rotate the knob to adjust the color change speed.

Warm Tips

- ASIO analog audio outputs will work at the same time no matter what audio input is selected. While the optical output will only work when PC-USB inputs.
- Only USB input supports PCM 384KHz/220Hz DSD256, coaxial and optical inputs only support PCM 192KHz/220Hz at the highest.
- For best PC-USB only can be recognized when the driver is installed. For other systems, the driver is only required when playing DSD files.
- P1PLUS is designed with pluggable tube sockets, default comes with JAN8454 tubes. Can be replaced by 6X1, 6X2, 6X3, 6X4, 6X5, 6X6, 6X7, 6X8, 6X9, 6X10, 6X11, 6X12, 6X13, 6X14, 6X15, 6X16, 6X17, 6X18, 6X19, 6X20, 6X21, 6X22, 6X23, 6X24, 6X25, 6X26, 6X27, 6X28, 6X29, 6X30, 6X31, 6X32, 6X33, 6X34, 6X35, 6X36, 6X37, 6X38, 6X39, 6X40, 6X41, 6X42, 6X43, 6X44, 6X45, 6X46, 6X47, 6X48, 6X49, 6X50, 6X51, 6X52, 6X53, 6X54, 6X55, 6X56, 6X57, 6X58, 6X59, 6X60, 6X61, 6X62, 6X63, 6X64, 6X65, 6X66, 6X67, 6X68, 6X69, 6X70, 6X71, 6X72, 6X73, 6X74, 6X75, 6X76, 6X77, 6X78, 6X79, 6X80, 6X81, 6X82, 6X83, 6X84, 6X85, 6X86, 6X87, 6X88, 6X89, 6X90, 6X91, 6X92, 6X93, 6X94, 6X95, 6X96, 6X97, 6X98, 6X99, 6X100.

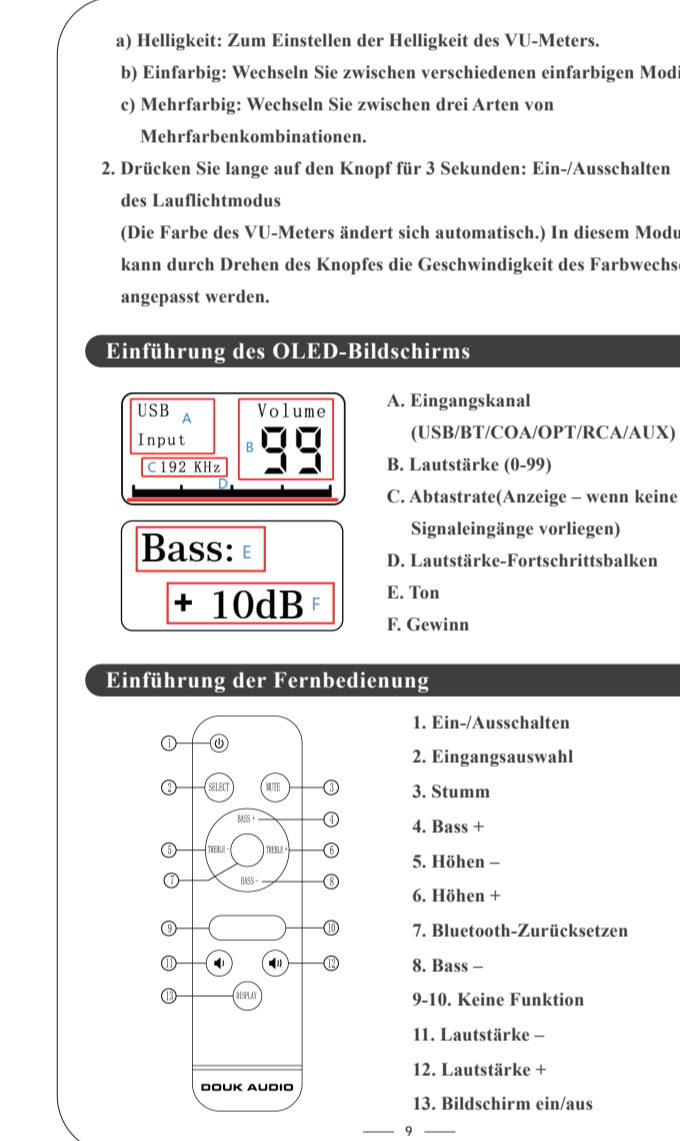

Q: Why is there no sound output when browsing webpage video, but the FOOTAR play is normal.

A: Please close the Bluetooth antenna to install correctly. Make sure check whether the Bluetooth antenna is installed correctly. If there is no sound output when optical and coaxial inputs are used? (The color of the VU meter will change automatically.) In this mode, rotate the knob to adjust the color change speed.

Warm Tips

- ASIO analog audio outputs will work at the same time no matter what audio input is selected. While the optical output will only work when PC-USB inputs.
- Only USB input supports PCM 384KHz/220Hz DSD256, coaxial and optical inputs only support PCM 192KHz/220Hz at the highest.
- For best PC-USB only can be recognized when the driver is installed. For other systems, the driver is only required when playing DSD files.
- P1PLUS is designed with pluggable tube sockets, default comes with JAN8454 tubes. Can be replaced by 6X1, 6X2, 6X3, 6X4, 6X5, 6X6, 6X7, 6X8, 6X9, 6X10, 6X11, 6X12, 6X13, 6X14, 6X15, 6X16, 6X17, 6X18, 6X19, 6X20, 6X21, 6X22, 6X23, 6X24, 6X25, 6X26, 6X27, 6X28, 6X29, 6X30, 6X31, 6X32, 6X33, 6X34, 6X35, 6X36, 6X37, 6X38, 6X39, 6X40, 6X41, 6X42, 6X43, 6X44, 6X45, 6X46, 6X47, 6X48, 6X49, 6X50, 6X51, 6X52, 6X53, 6X54, 6X55, 6X56, 6X57, 6X58, 6X59, 6X60, 6X61, 6X62, 6X63, 6X64, 6X65, 6X66, 6X67, 6X68, 6X69, 6X70, 6X71, 6X72, 6X73, 6X74, 6X75, 6X76, 6X77, 6X78, 6X79, 6X80, 6X81, 6X82, 6X83, 6X84, 6X85, 6X86, 6X87, 6X88, 6X89, 6X90, 6X91, 6X92, 6X93, 6X94, 6X95, 6X96, 6X97, 6X98, 6X99, 6X100.

Q: Why is there no sound output when browsing webpage video, but the FOOTAR play is normal.

A: Please close the Bluetooth antenna to install correctly. Make sure check whether the Bluetooth antenna is installed correctly. If there is no sound output when optical and coaxial inputs are used? (The color of the VU meter will change automatically.) In this mode, rotate the knob to adjust the color change speed.

Warm Tips

- ASIO analog audio outputs will work at the same time no matter what audio input is selected. While the optical output will only work when PC-USB inputs.
- Only USB input supports PCM 384KHz/220Hz DSD256, coaxial and optical inputs only support PCM 192KHz/220Hz at the highest.
- For best PC-USB only can be recognized when the driver is installed. For other systems, the driver is only required when playing DSD files.
- P1PLUS is designed with pluggable tube sockets, default comes with JAN8454 tubes. Can be replaced by 6X1, 6X2, 6X3, 6X4, 6X5, 6X6, 6X7, 6X8, 6X9, 6X10, 6X11, 6X12, 6X13, 6X14, 6X15, 6X16, 6X17, 6X18, 6X19, 6X20, 6X21, 6X22, 6X23, 6X24, 6X25, 6X26, 6X27, 6X28, 6X29, 6X30, 6X31, 6X32, 6X33, 6X34, 6X35, 6X36, 6X37, 6X38, 6X39, 6X40, 6X41, 6X42, 6X43, 6X44, 6X45, 6X46, 6X47, 6X48, 6X49, 6X50, 6X51, 6X52, 6X53, 6X54, 6X55, 6X56, 6X57, 6X58, 6X59, 6X60, 6X61, 6X62, 6X63, 6X64, 6X65, 6X66, 6X67, 6X68, 6X69, 6X70, 6X71, 6X72, 6X73, 6X74, 6X75, 6X76, 6X77, 6X78, 6X79, 6X80, 6X81, 6X82, 6X83, 6X84, 6X85, 6X86, 6X87, 6X88, 6X89, 6X90, 6X91, 6X92, 6X93, 6X94, 6X95, 6X96, 6X97, 6X98, 6X99, 6X100.

Q: Why is there no sound output when browsing webpage video, but the FOOTAR play is normal.

A: Please close the Bluetooth antenna to install correctly. Make sure check whether the Bluetooth antenna is installed correctly. If there is no sound output when optical and coaxial inputs are used? (The color of the VU meter will change automatically.) In this mode, rotate the knob to adjust the color change speed.

Warm Tips

- ASIO analog audio outputs will work at the same time no matter what audio input is selected. While the optical output will only work when PC-USB inputs.
- Only USB input supports PCM 384KHz/220Hz DSD256, coaxial and optical inputs only support PCM 192KHz/220Hz at the highest.
- For best PC-USB only can be recognized when the driver is installed. For other systems, the driver is only required when playing DSD files.
- P1PLUS is designed with pluggable tube sockets, default comes with JAN8454 tubes. Can be replaced by 6X1, 6X2, 6X3, 6X4, 6X5, 6X6, 6X7, 6X8, 6X9, 6X10, 6X11, 6X12, 6X13, 6X14, 6X15, 6X16, 6X17, 6X18, 6X19, 6X20, 6X21, 6X22, 6X23, 6X24, 6X25, 6X26, 6X27, 6X28, 6X29, 6X30, 6X31, 6X32, 6X33, 6X34, 6X35, 6X36, 6X37, 6X38, 6X39, 6X40, 6X41, 6X42, 6X43, 6X44, 6X45, 6X46, 6X47, 6X48, 6X49, 6X50, 6X51, 6X52, 6X53, 6X54, 6X55, 6X56, 6X57, 6X58, 6X59, 6X60, 6X61, 6X62, 6X63, 6X64, 6X65, 6X66, 6X67, 6X68, 6X69, 6X70, 6X71, 6X72, 6X73, 6X74, 6X75, 6X76, 6X77, 6X78, 6X79, 6X80, 6X81, 6X82, 6X83, 6X84, 6X85, 6X86, 6X87, 6X88, 6X89, 6X90, 6X91, 6X92, 6X93, 6X94, 6X95, 6X96, 6X97, 6X98, 6X99, 6X100.

Specifications

Mark	Douk Audio
Model	P1PLUS
Audio Input	Bluetooth / PC-USB / Coaxial / Optical / Stereo RCA / 3.5mm AUX / 3.5mm-Kopfhöreranschlusung
Chipset	CS5323-568137L / ES9018K2M-TPA612B
Max. Sampling rate USB supported	PCM 384KHz/220Hz / DSD256
Max. Sampling rate Coaxial/Optical supported	PCM 192KHz/220Hz
PC-USB supported	W7 / W8 / W16 / MAC / Linux
Bluetooth version	5