

Kinglucky Earbuds User Guide

1. First-Time Pairing

FIRST-TIME PAIRING

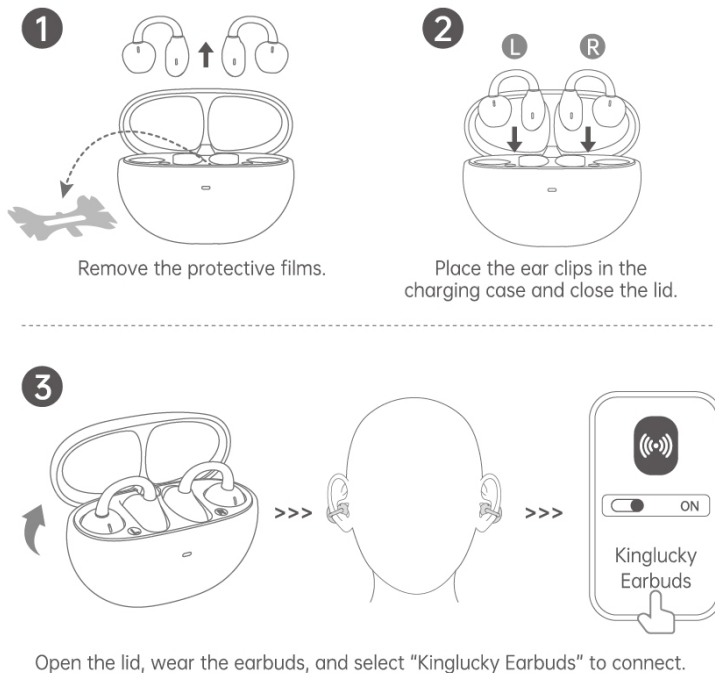

1. Remove Insulation Films

Peel off the clear insulation films located inside the charging case or on the bottom of the earbuds. Without removing these, the earbuds will not charge or power on.

2. Open the Charging Case Keep the earbuds inside and open the lid. The earbuds will automatically power on and enter pairing mode.

3. Enable Bluetooth on Your Device Go to your phone's Bluetooth settings, find "**Kinglucky Earbuds**" and tap to connect.

4. After Successful Pairing Once paired, the earbuds will reconnect automatically the next time you open the charging case.

2. One Side Not Working / Bluetooth Not Connecting

RESET & RECONNECT

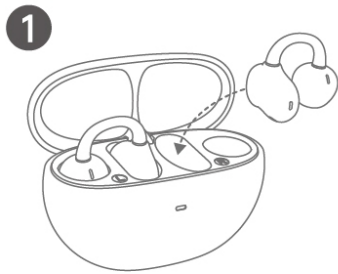

Place earbuds into the case

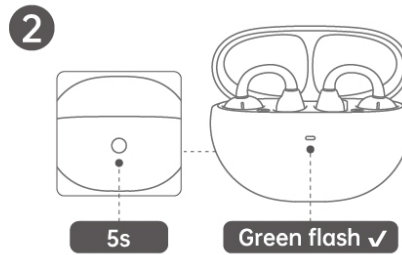

Hold the reset button

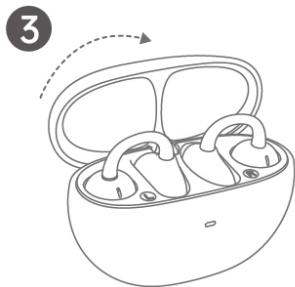

Close the lid, then open it again



Re-pair with your phone

1. Check Insulation Films: Confirm that the films on BOTH earbuds and inside the case are removed. This is the most common cause of one-sided issues.

2. Forget Device: In your phone's Bluetooth list, find "Kinglucky Earbuds" and select "Forget This Device."

3. Reset the Earbuds:

- Place both earbuds into the charging case. Keep the lid open.

- Press and hold the reset button for 5–8 seconds until the indicator changes from orange to flashing green.

4. Re-pair: Close the lid for a few seconds, reopen it, and select "Kinglucky Earbuds" on your phone to reconnect.

3. Not Charging / Short Battery Life

1. Clean the Charging Contacts

Use a dry cloth or cotton swab to gently clean the metal contacts on both the earbuds and the charging case.

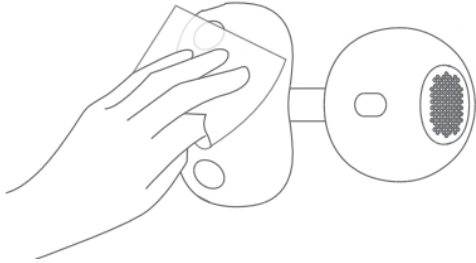

2. Reinsert the Earbuds

Make sure the earbuds are properly seated in the charging slots and that the indicator light turns on.

3. Use the Original Cable and Adapter

Third-party cables may cause poor connection or slow charging.

4. Avoid Extreme Temperatures

Avoid charging in very hot or cold environments, as it can affect battery performance.

5. Fully Charge Before First Use

Before first use or after long storage, fully charge both the earbuds and the case

4. Need more help?

If you're still experiencing issues, please contact Kinglucky Customer Support before returning the product. We'll help you resolve it quickly and can provide a free replacement or exchange if needed.

1. Scroll down and find the **Kinglucky** store link, then tap to open it.

2. Under “**Have a question for Kinglucky?**”, click “**Ask a question**”.

3. Message the seller with your question. Our customer support team will reply and make sure your issue is fully resolved.

12:02

Search or ask a question

Or Prime members get FREE delivery **Saturday, January 31**. Order within 1 hr. [Join Prime](#)

Deliver to New York 10001

In Stock

Quantity: 1

Add to cart

Buy Now

Ships from Amazon
Sold by Kinglucky®
Returns FREE 30-day refund/replacement
Gift options Available at checkout
See more

Add to List

View newer model

 Kinglucky New A1 Open Ear Clip On ...
★★★★★ (81)
\$35.99
In Stock

Report an issue with this product or seller

Home, Profile, Cart, Menu, Notifications

12:01

Search or ask a question

Kinglucky®

Visit the Kinglucky® storefront

★★★★★ | 100% positive in the last 12 months (206 ratings)

About Seller

About Kinglucky

Kinglucky – Elevate Every Musical Moment. 🎵

Founded in 2017, Kinglucky is dedicated to designing high-quality, innovative, and stylish home entertainment products.

Innovation is more than what we do — **it defines who we are**. Driven by curiosity and creativity, we continually push the boundaries of exceptional sound. As passionate music lovers and karaoke technology specialists, we're constant...

See more

Have a question for Kinglucky®?

Ask a question



Reviews

Home, Profile, Cart, Menu, Notifications